

U-PROX
2BLQF-482026137EOG
Access Control System



U-Prox 2BLQF-482026137EOG Access Control System User Manual

[Home](#) » [U-PROX](#) » U-Prox 2BLQF-482026137EOG Access Control System User Manual 

Contents

- 1 U-Prox 2BLQF-482026137EOG Access Control System
- 2 Product Usage Instructions
- 3 Functional parts of the device
- 4 TECHNICAL SPECIFICATIONS
- 5 WARRANTY
- 6 PROGRAMMING
- 7 INSTALLATION
- 8 CONNECTION
- 9 SET OR RESET ENGINEER PASSWORD
- 10 FCC STATEMENT
- 11 More Information
- 12 FAQ
- 13 Documents / Resources
 - 13.1 References

U-PROX

U-Prox 2BLQF-482026137EOG Access Control System

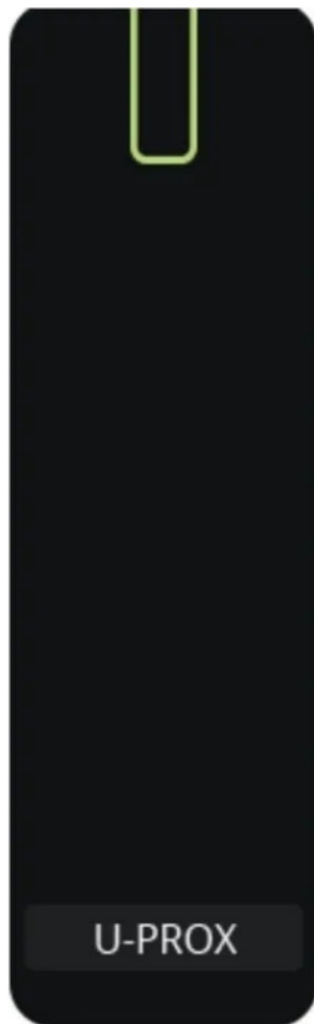

Product Usage Instructions

- Locate a suitable mounting position for the U-PROX SE slim reader.
- Connect the necessary cables according to the provided wiring diagram.
- Ensure the reader is securely installed and all connections are properly made.
- Access the configuration settings by connecting to the reader via RS-232 or other supported interfaces.
- Configure the reader settings such as card formats, access levels, and communication protocols.
- Save the configuration changes and ensure they are applied successfully.
- Present a valid card or mobile ID to the U-PROX SE slim reader within the specified range.
- The reader will authenticate the access credentials and grant or deny access accordingly.
- In case of any issues, refer to the user manual for troubleshooting steps.

UNIVERSAL READER

- U-PROX access control system
- Manufacturer: LLC INTEGRATED TECHNICAL VISION
- Mykoly Hrinchenka str. 2/1, 03038, Kyiv, Ukraine
- LLC INTEGRATED TECHNICAL VISION declares, that the U-PROX SE slim complies with the Radio Equipment Directive 2014/53/EU and with the Directive 2011/65/EU (RoHS). The original Declaration of Conformity is available on the website www.u-prox.systems in the Certificates section.



U-PROX SE slim – the adjustable universal SmartLine reader for mobile credentials and proximity identifiers in conjunction with the U-PROX Mobile ID application and U-PROX IDs allow any access control system to use smartphones as access system credentials.

The device is configured with the U-PROX Config mobile app



Functional parts of the device

1. Mount plate;
2. Reader;
3. Fixing screw

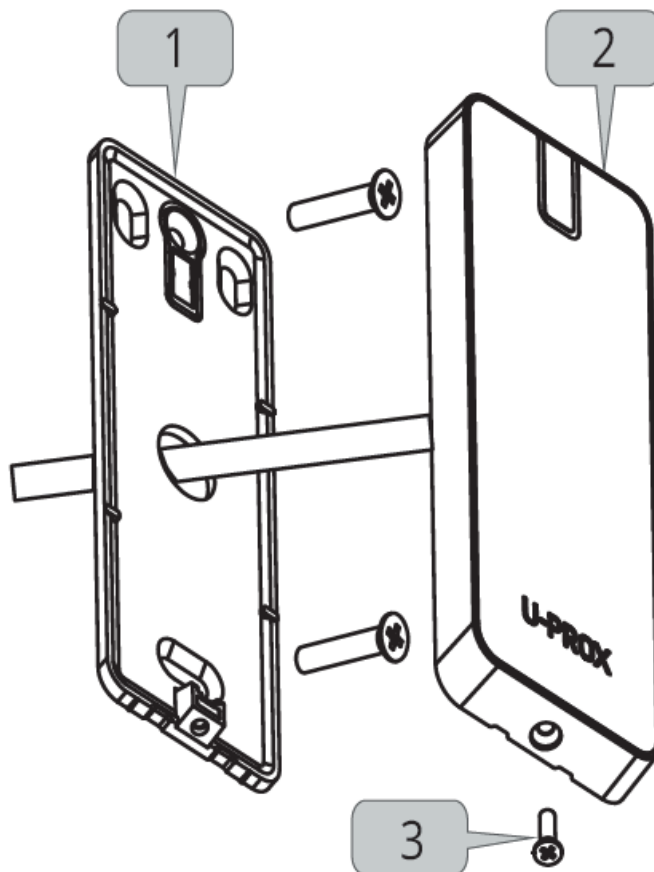

FW	30.xx
OSDP	+
Wiegand	+
Touch-Memory	+
RS-232	+
Mifare	+
ASK/FSK	+
Tags	+
Mobile ID	+
NFC	+
Payment cards	+

TECHNICAL SPECIFICATIONS

- **Reads (Supported formats depend on firmware)**

- Mifare®, 13.56 MHz, ISO14443A, 4, 7, 10 bytes
- UID: Mifare®Classic 1K/4K, Mifare®Standard,
- Mifare®Ultralight, Mifare®Hi-Memory, Mifare®
- Plus S 2K, Mifare®Plus S 4K, Mifare®Plus SE 1K,
- Mifare®Plus X 2K, Mifare®Plus X 4K, Mifare®
- Plus EV1 2K, Mifare® Plus EV1 4K, Mifare®
- DESfire, Mifare®DESfire EV1, Mifare®DESfire EV2
- NFC, 13.56 MHz, ISO 14443/15693;
- Payment cards: PayPass, PayWave
- RFID, 125 kHz: ASK y FSK;
- 2.4 GHz mobile ID, U-PROX Tag / Auto Tag

- **Read range:** NFC, Mifare and RFID 125 kHz – up to 5 cm, 2.4 GHz radio – adjustable 10 cm – 15 m

- **Interfaces:** Wiegand Auto, 26, 32, 34, 37, 40, 42, 56, 58, 64, 80 bits, RS-232, TouchMemory and OSDP v 2.2

- **Ambient:** IP65, -40°C to +60°C

- **Power:** +9...+15 VDC, consumption < 80 mA

- **Dimensions & weight:** 47.5 x 123.4 x 13.3 mm & 130 grams

- **Case material & colour:** ABS+PC plastic, Gorilla Glass & black

- **Wiring and distance:** 8 wire cable, TouchMemory – up to 30 m, Wiegand – up to 150 m, OSDP – up to 1000 m

COMPLETE SET

1. U-PROX SE slim;
2. Mounting kit;
3. Quick start guide

WARRANTY

- Warranty for U-PROX devices (except batteries) is valid for two years after the purchase date.
- If the device operates incorrectly, please contact support@u-prox.systems at first, maybe it can be solved remotely.

PROGRAMMING

- The reader is supplied without the engineering password



INSTALLATION

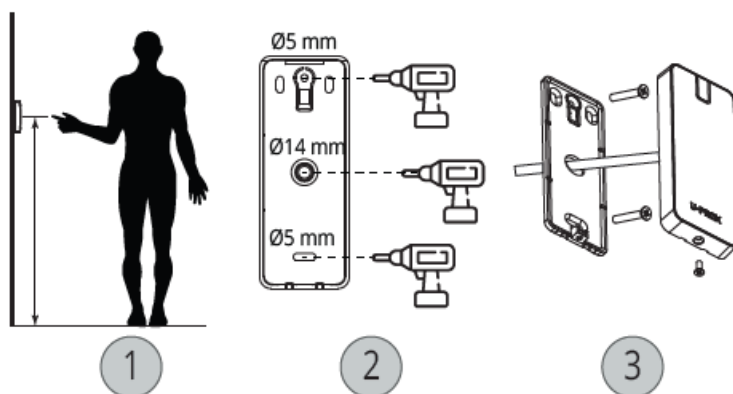

- Range decreases on metal

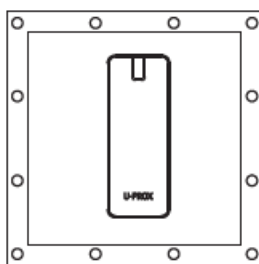

- Connect the yellow wire for synchronization

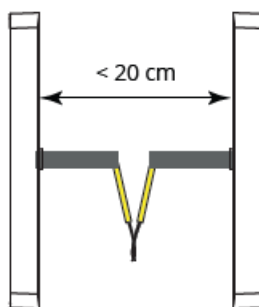

CONNECTION



Wiegand

+12V	red
GND	black
Data0 (WD0)	green
Data1 (WD1)	white
Red LED (RD)	brown
Green LED (GN)	orange
Beep	blue
Hold or sync	yellow

Using twisted pair



+12V	red
GND	black
iButton	green

Red LED (RD)	brown
Green LED (GN)	orange
Beep	blue
Hold or sync	yellow

Using twisted pair



+12V	red
GND	black
Rx	green
Tx	white

+12V	red
GND	black
A+	green
B-	white

Using twisted pair



SET OR RESET ENGINEER PASSWORD



“PROXIMITY-DOOR” MODE FOR 2.4 GHZ

- Reader is activated by the presence sensor.
- Read range 5-10 cm

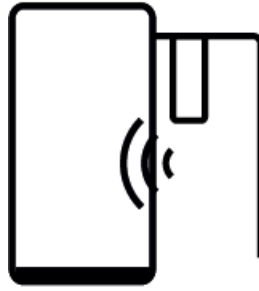

“DOOR” MODE

- Reader is always active.
- Read range 50-60 cm

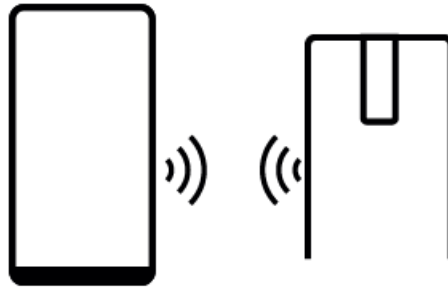

“GATE/BARRIER” MODE FOR 2.4 GHZ

- Reader is always active.
- Read range 1 – 15 m

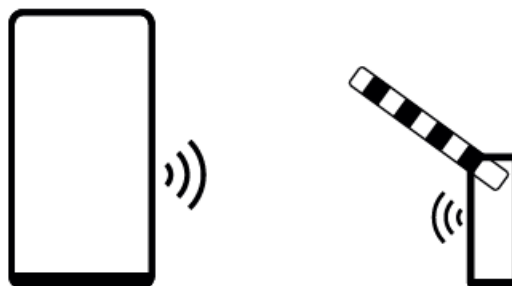

U-PROX MOBILE ID

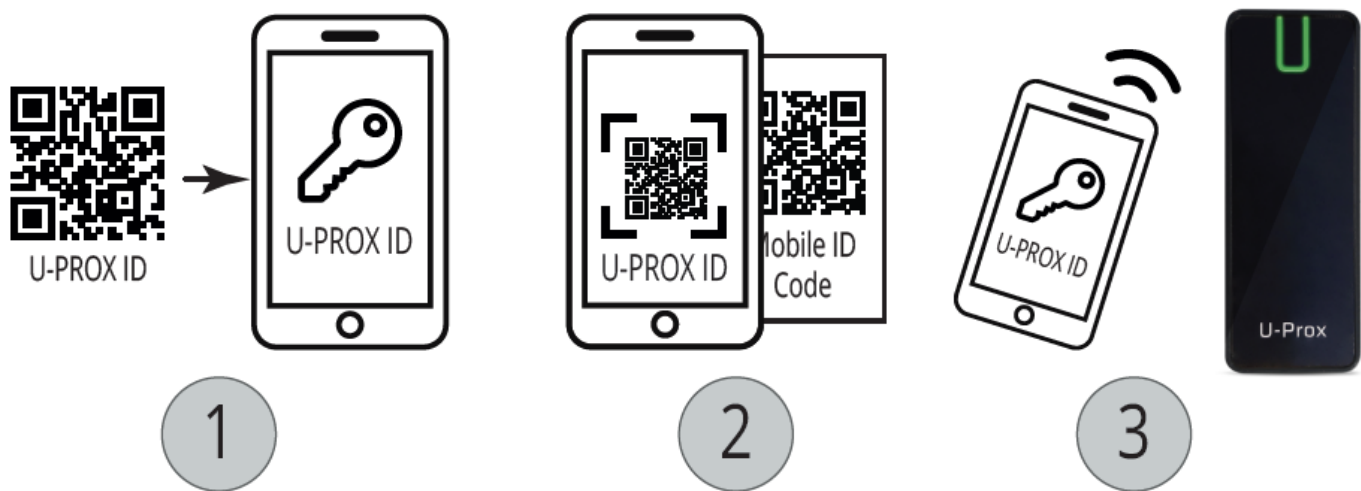

FCC STATEMENT

This equipment has been tested and found to comply with the limits for a Class B digital device, under Part 15 of the FCC Rules. These limits are designed to provide reasonable protection against harmful interference in a residential installation.

This equipment uses and can radiate radio frequency energy and, if not installed and used by the instructions, may cause harmful interference to radio communications. However, there is no guarantee that interference will not occur in a particular installation.

If this equipment does cause harmful interference to radio or television reception, which can be determined by turning the equipment off and on, the user is encouraged to try to correct the interference by one or more of the following measures:

- Reorient or relocate the receiving antenna.
- Increase the separation between the equipment and receiver.
- Connect the equipment into an outlet on a circuit different from that to which the receiver is connected.
- Consult the dealer or an experienced radio/TV technician for help.

This device complies with part 15 of the FCC Rules. Operation is subject to the following two conditions:

1. This device may not cause harmful interference,
2. This device must accept any interference received, including interference that may cause undesired operation.

Changes or modifications not expressly approved by the party responsible for compliance could void the user's authority to operate the equipment.

IC STATEMENT

This device contains licence-exempt transmitter(s)/receiver(s) that comply with Innovation, Science and Economic Development Canada's licence-exempt RSS(s).

Operation is subject to the following two conditions

1. This device may not cause interference.
2. This device must accept any interference, including interference that may cause undesired operation of the device

RF warning for Portable device

The device has been evaluated to meet general RF exposure requirement. The device can be used in portable exposure conditions without restriction.

More Information

- www.u-prox.systems
- support@u-prox.systems
- www.u-prox.systems/doc_seslim



FAQ

- **Q: How can I reset the U-PROX SE slim reader to factory settings?**
 - **A:** To reset the reader, locate the reset button on the device and press it for at least 10 seconds until the LED indicators flash.
- **Q: Can the U-PROX SE slim reader be used with third-party access control systems?**
 - **A:** Yes, the reader supports integration with various third-party access control systems through its compatible interfaces.
- **Q: What should I do if the U-PROX SE slim reader shows an error code during operation?**
 - **A:** Refer to the user manual for a list of error codes and their corresponding troubleshooting steps. If the issue persists, contact customer support for assistance.

Documents / Resources

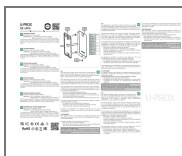

[U-Prox 2BLQF-482026137EOG Access Control System](#) [pdf] User Manual
2BLQF-482026137EOG, 2BLQF482026137EOG, 482026137eog, 2BLQF-482026137EOG Access Control System, 2BLQF-482026137EOG, Access Control System, Control System, System

References

- [User Manual](#)

[Manuals+](#), [Privacy Policy](#)

This website is an independent publication and is neither affiliated with nor endorsed by any of the trademark owners. The "Bluetooth®" word mark and logos are registered trademarks owned by Bluetooth SIG, Inc. The "Wi-Fi®" word mark and logos are registered trademarks owned by the Wi-Fi Alliance. Any use of these marks on this website does not imply any affiliation with or endorsement.