



twinkly WI-FI Power Line Controller User Guide

[Home](#) » [Twinkly](#) » twinkly WI-FI Power Line Controller User Guide 



WI-FI Power Line Controller User Guide

Contents

- [1 READ AND FOLLOW ALL SAFETY INSTRUCTIONS](#)
- [2 USE AND CARE INSTRUCTIONS](#)
- [3 ATTENTION – REDUCE THE RISK OF FIRE AND ELECTRIC SHOCK](#)
- [4 TECHNICAL SPECIFICATIONS](#)
- [5 setup requirements](#)
- [6 connect light strings](#)
- [7 power up the controller](#)
- [8 connection modes](#)
- [9 multi-controller setup](#)
- [10 App download](#)
- [11 Documents / Resources](#)
 - [11.1 References](#)
- [12 Related Posts](#)

READ AND FOLLOW ALL SAFETY INSTRUCTIONS

1. Read and follow all safety instructions.
2. Do not use seasonal products outdoors unless marked as suitable for indoor and outdoor use. When products are used in outdoor applications, connect the product to a Ground Fault Circuit Interrupting (GFCI) outlet. If one is not provided, contact a qualified electrician for proper installation.
3. This seasonal use product is not intended for permanent installation or use.

4. Do not mount or place near gas or electric heaters, fireplaces, candles, or other similar sources of heat.
5. Do not secure the wiring of the product with staples or nails, or place on sharp hooks or nails.
6. Do not let lamps rest on the supply cord or on any wire.
7. This is an electric product – not a toy! To avoid the risk of fire, burns, personal injury, and electric shock it should not be played with or placed where small children can reach it.
8. Do not use this product for other than its intended use.
9. Do not hang ornaments or other objects from the cord, wire, or light string.
10. Do not cover the product with cloth, paper, or any material not part of the product when in use.
11. Do not close doors or windows on the product or extension cords as this may damage the wire insulation.
12. Read and follow all instructions that are on the product or provided with the product.
13. Save these instructions.

USE AND CARE INSTRUCTIONS

- a. When the product is placed on a live tree, the tree should be well maintained and fresh. Do not place on live trees in which the needles are brown or break off easily. Keep the live tree holder filled with water.
- b. Once the product is placed, the installation should be well secured and stable.
- c. Before using or reusing, inspect the product carefully. Discard any products that have cut damaged, or frayed wire insulation or cords, cracks in the lamp holders or enclosures, loose connections, or exposed copper wire.
- d. When storing the product, carefully remove the product from wherever it is placed, including trees, branches, or bushes, to avoid any undue strain or stress on the product conductors, connections, and wires.
- e. When not in use, store neatly in a cool, dry location protected from sunlight.

ATTENTION – REDUCE THE RISK OF FIRE AND ELECTRIC SHOCK

- a. Do not install on surfaces having sharp edges, or coverings of metal or materials which look like metal.
- b. Do not mount or support wires in a manner that can cut or damage wire insulation.

Class A Disclaimer: This equipment has been tested and found to comply with the limits for a Class A digital device, pursuant to Part 15 of the FCC Rules. These limits are designed to provide reasonable protection against harmful interference in a residential installation. This equipment generates, uses, and can radiate radio frequency energy and, if not installed and used in accordance with the instructions, may cause harmful interference to radio communications. However, there is no guarantee that interference will not occur in a particular installation. If this equipment does cause harmful interference to radio or television reception, which can be determined by turning the equipment off and on, the user is encouraged to try to correct the interference by one or more of the following measures:

- i. Reorient or relocate the receiving antenna.
- ii. Increase the separation between the equipment and the receiver.
- iii. Connect the equipment into an outlet on a circuit different from that to which the receiver is connected.
- iv. Consult the dealer or an experienced radio/television technician for help.



WARNING!

Do not connect the light string to the power supply while it is in the packaging.

The connecting cable cannot be repaired or replaced. THE LAMPS ARE NOT REPLACEABLE. The lighting chain must not be used without all gaskets being in place. Lighting chains are not intended for interconnection. Do not connect this light string electrically to devices from another manufacturer. CAUTION! Strangulation hazard. Keep out of reach of young children.



■ The crossed-out wheeled bin symbol indicates that the item should be disposed of separately from household waste. The item should be handed in for recycling in accordance with local environmental regulations for waste disposal.

The manufacturer, Leadworks Srl, declares that this device complies with the (LVD) 2014/35/EU, (EMC) 2014/30/EU, (RoHS) 2011/65/EU directives. The full text of the EU declaration of conformity is available at the

following Internet address: www.twinkly.com/certifications

TECHNICAL SPECIFICATIONS

No. of ports	1 (*)
IP rating	IP65
Connectivity	Wi-Fi Bluetooth®
Power rating	48 W MAX
Adapter input voltage	120 – 240 VAC MAX 50/60Hz
Temperature range	-15°C / 40°C 5°F / 104°F
Storage temperature range	-20°C / 60°C -4°F / 140°F
Certification	US EU JP AU certified
Warranty	24 months

(*) extendible to 2 with Twinkly PLUS Port Splitter

setup requirements

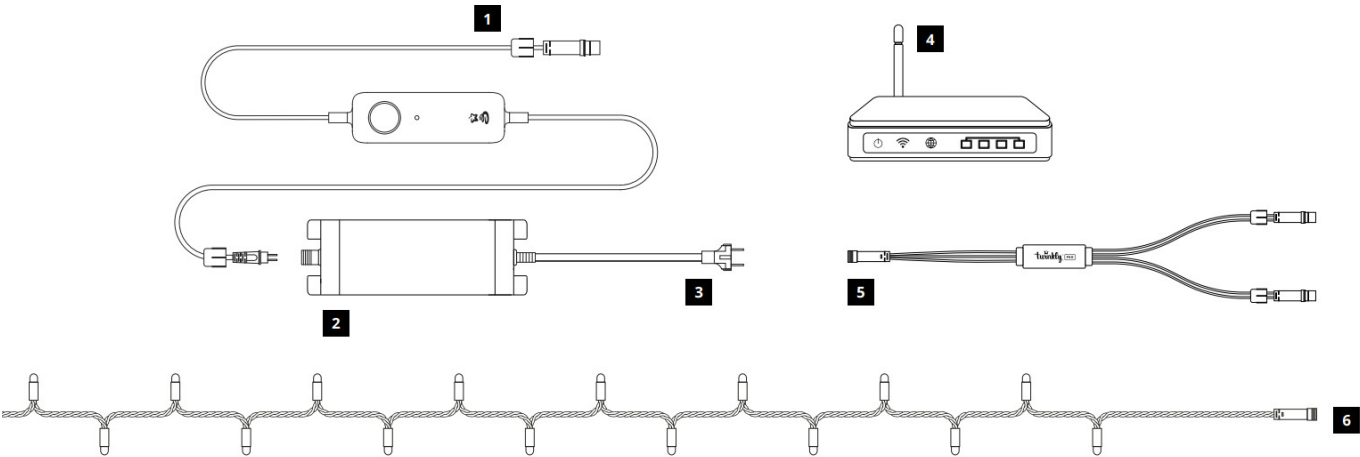

- 1. Twinkly PLUS Power Line Controller
- 2. Power adapter
- 3. Plug [1]
- 4. Internet Router [1] [2]
- 5. Twinkly PLUS Port Splitter
- 6. Twinkly PRO Lights [1]

[1] NOT INCLUDED IN THIS BOX

connect light strings

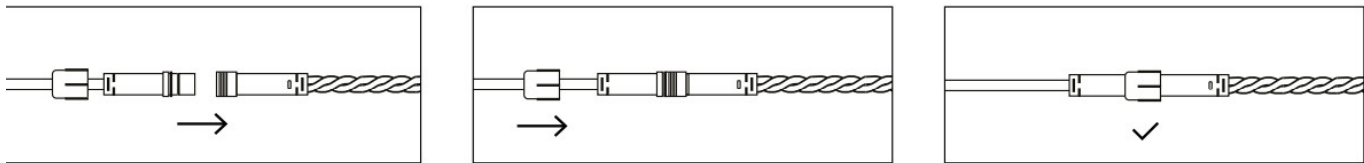





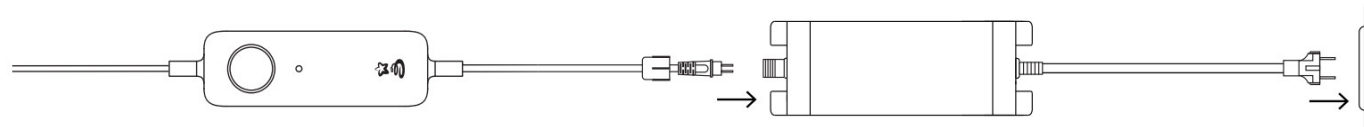

Connect the light strings to the controller following the numbered order on the side of the case.

power up the controller



Connect the power adapter to the controller. Plug in a power source. When the controller is powered up, the LED on top turns on.

STATUS LED

					
Green -Blinking Direct Wi-Fi mode , not connected	Green – Steady Direct Wi-Fi mode, connected	Light Blue -Steady Set up mode, Bluetooth ON	Blue – Blinking Wi-Fi network mode, connection in progress	Blue – Steady Wi-Fi network mode, connected	Red – Wi-Fi mode, connection error

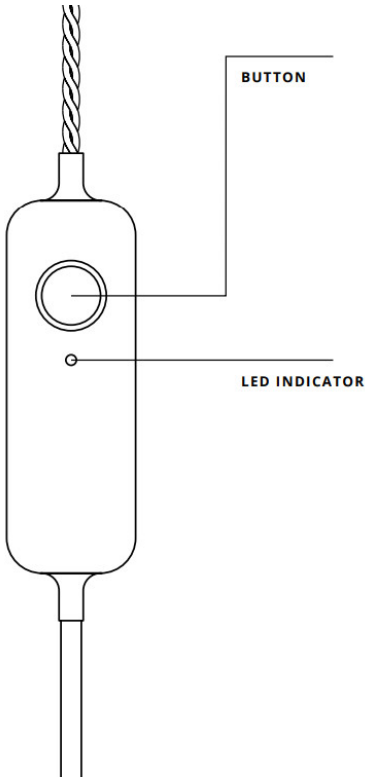

connection modes

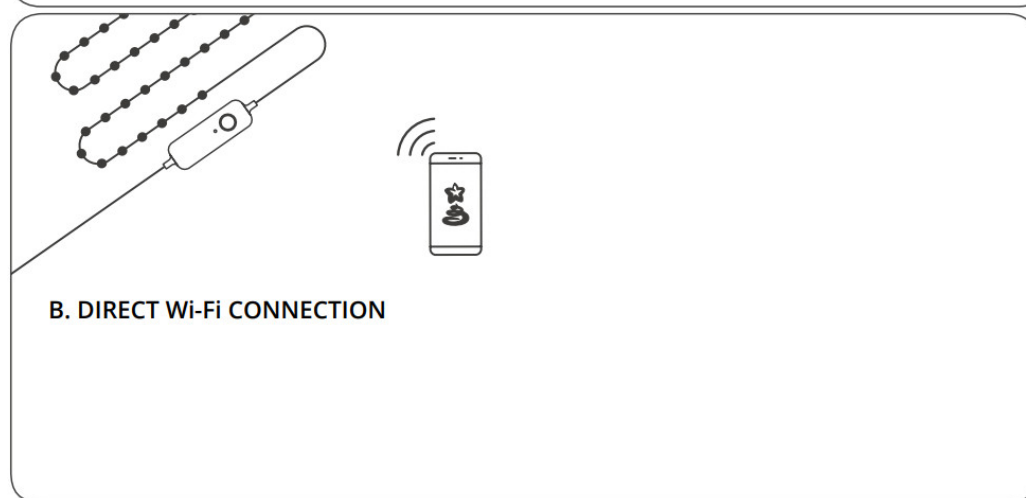
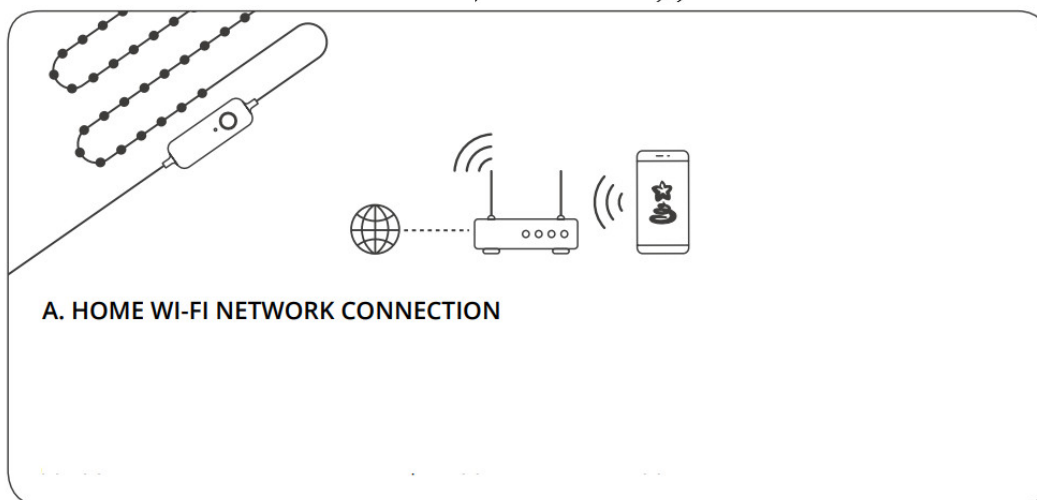
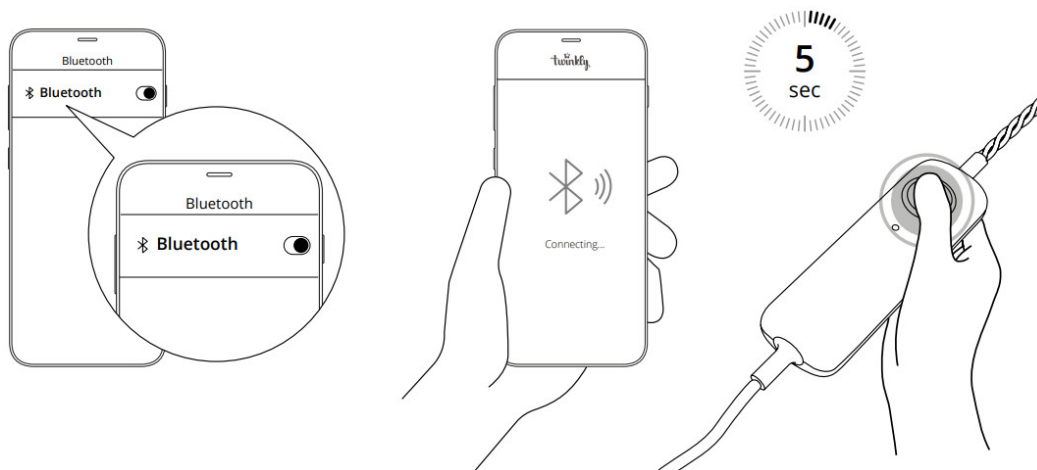

Twinkly uses Bluetooth for the setup process only. Wi-Fi connection is required for operation.

You can use:

A. Home Wi-Fi network connection (recommended): Connect with your home/office WiFi from the list of available networks.

B. Direct Wi-Fi connection: Select “Twinkly_xxxxxx” WiFi from the list of available networks. Password: **Twinkly2019**

(NOTE: the internet on your phone will not be available in this case)

factory reset

While holding the button disconnect and reconnect the controller’s plug, then keep holding the button until all LEDs turn red (or amber for AWW), then release the button.

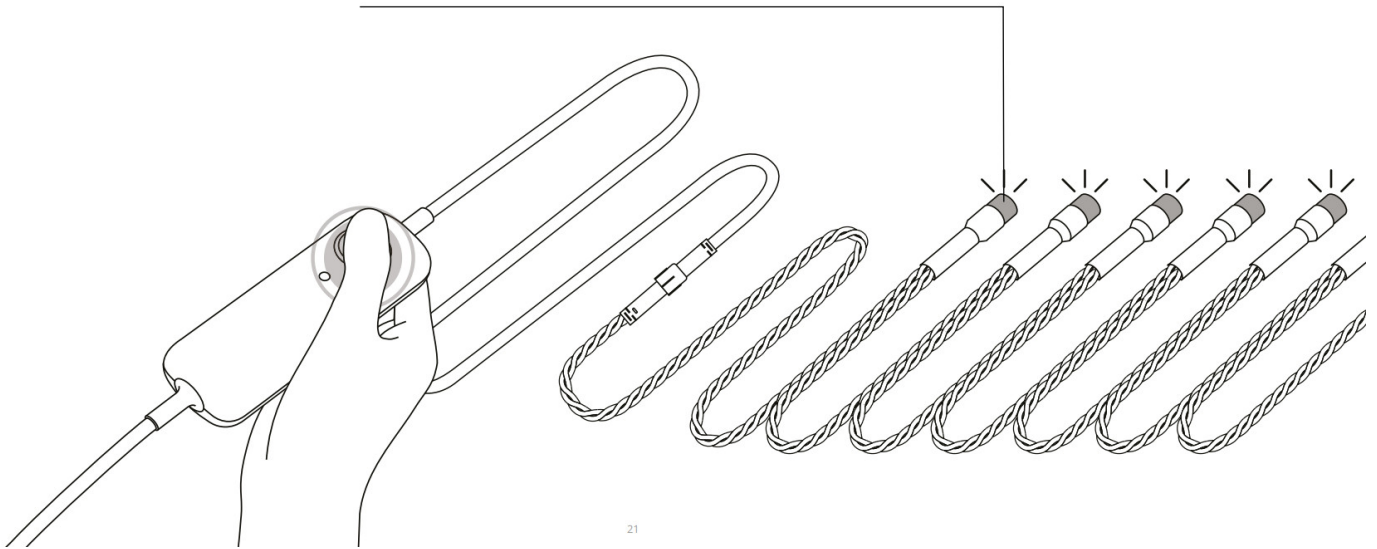

21

multi-controller setup

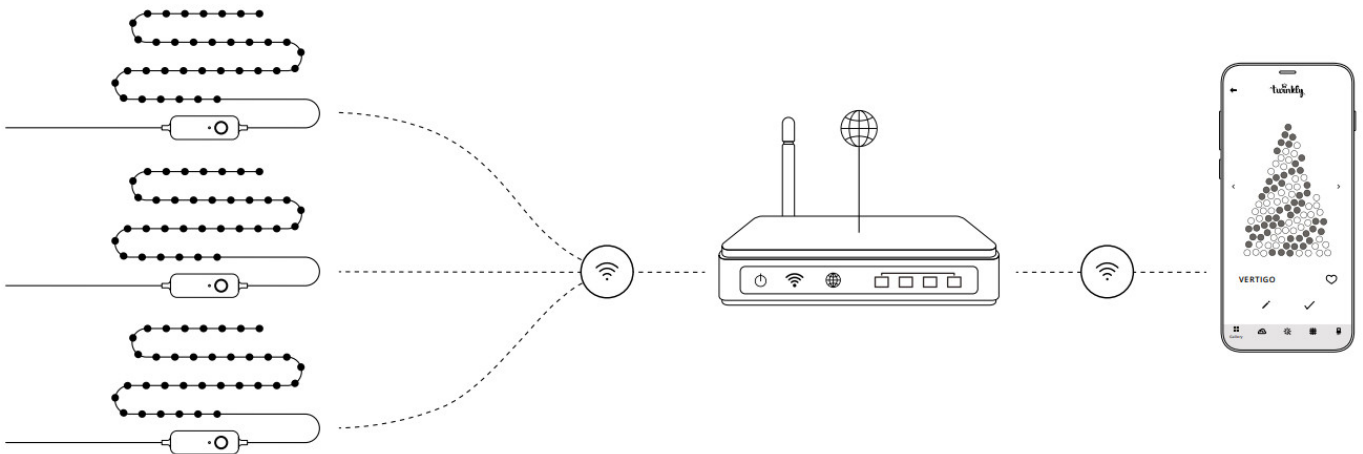

NETWORKING LAYOUT

Join multiple controllers together by connecting them to the same Internet connection and create a group in the Twinkly App. For optimal performance, we recommend not grouping more than 10 controllers together.

App download



<http://twinkly.com/qr/0016.php>

Go to the App Store or scan the QR code above.
Download and install the Twinkly App.

Launch the Twinkly App and follow the onboarding process on the app.
FOR ANY PROBLEM WRITE US AT SUPPORT@TWINKLY.COM

LEADWORKS
Via Tortona, 37 – 20144
Milano – Italy
MORE INFO

 www.twinkly.com/support

Documents / Resources

	twinkly WI-FI Power Line Controller [pdf] User Guide WI-FI, Power Line Controller, Line Controller, Power Controller, Controller, WI-FI
---	--

References

-  FUMI.com