



F4 Gravity Sensing Timer



TVCmall F4 Gravity Sensing Timer User Manual

[Home](#) » [TVCmall](#) » TVCmall F4 Gravity Sensing Timer User Manual 

Contents

- [1 TVCmall F4 Gravity Sensing Timer](#)
- [2 Product Overview](#)
- [3 Gravity sensing mode/countdown operation](#)
- [4 Manual mode](#)
- [5 Countdown setting](#)
- [6 Timer operation illustration](#)
- [7 Documents / Resources](#)
 - [7.1 References](#)
- [8 Related Posts](#)



TVCmall F4 Gravity Sensing Timer



Product Overview

Please read this manual carefully before using the product To ensure that the product is used correctly

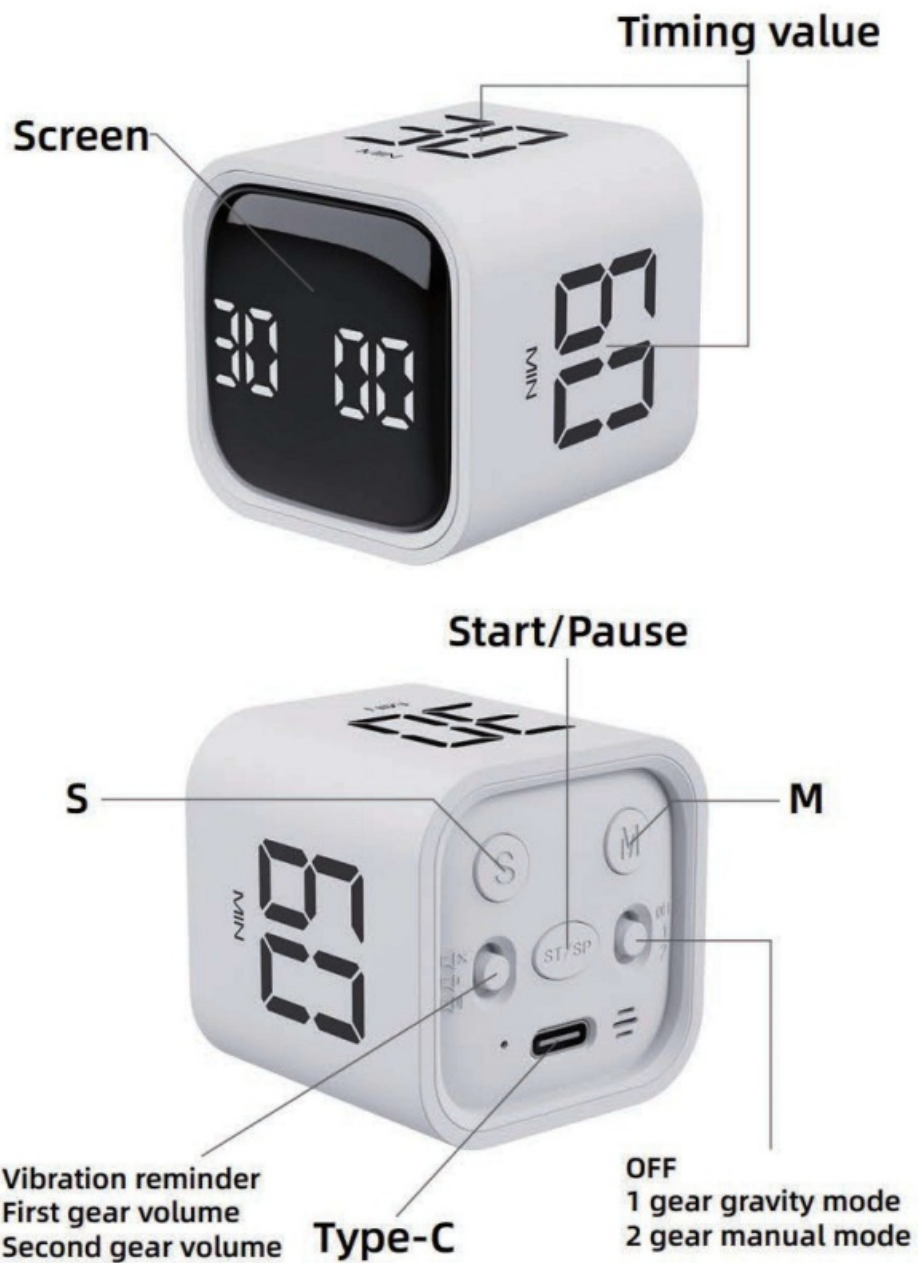

Gravity sensing mode/countdown operation

Gravity mode: Toggle button to mode 1

Turn 5-10-30-60 minutes up, the countdown automatically starts, the screen turns up to pause, on the contrary, the screen turns down to timekeeping is zeroed out (as shown)



Transfer the value to
Corresponding position



Value up
Start the countdown



Screen up
time-out



Screen down
Timekeeping is zeroed out

Manual mode

Manual mode: Toggle button to mode 2

Adjustable M/S button, click the center button to start the countdown

S(second) key:
00, 01, 02-59 seconds
Cyclic regulation

M(minutes) button:
00,01,02 -99 minutes
Cyclic regulation



Positive timing:

1. When the display shows 00:00 seconds, short press the [SP/ST] button to start the positive timing.
2. During the timing process, short press the [SP/ST] button to pause/start the timing.;
3. In a paused state, long press the [ST/SP] button to timekeeping is zeroed out.

Countdown setting

1. Short press the [M/S] button to adjust the countdown time, long press the [M/S] button to adjust the countdown time quickly, and after setting, short press the [SP/ST] button to start the countdown.
2. During the counting process, short press the [SP/ST] button to pause/start the countdown;
3. In a paused state, long press [SP/ST] button to timekeeping is zeroed out.
4. After the countdown time reaches 00:00, there will be up to one-minute alarm reminder ("di di di" LED screen lights up / sound stops LED screen off – these two prompts 1-second group – so the cycle). Silent mode vibration reminder.
5. Memory mode: After the countdown is finished, short press again the [SP/ST] button to display the current setting time. If you need to reset the timer, long press and ST/SP button. Short press again to cycle the operation

Positive timer operation explanation:

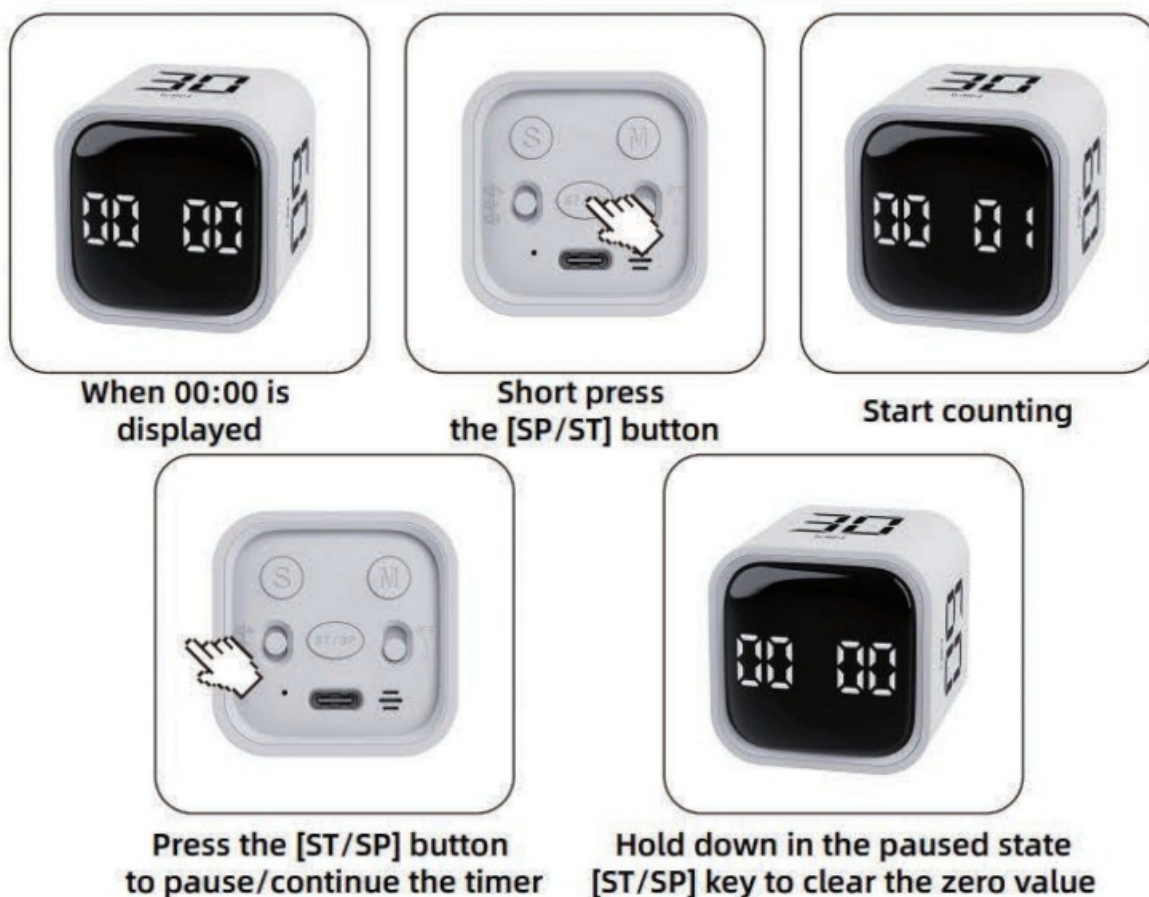

Timer operation illustration



Short press the [M/S]
button to set the time



Long press for fast
incremental time



Start counting



Pressing the [ST/SP] button
during timing
Can pause/continue timing



In a paused state
long press the [ST/SP] button to
timekeeping is zeroed out.



Countdown time
There's a bell for one minute
(Silent mode is vibration reminder)

Documents / Resources



[TVCMALL F4 Gravity Sensing Timer](#) [pdf] User Manual
F4 Gravity Sensing Timer, F4, Gravity Sensing Timer, Sensing Timer, Timer

References

- [User Manual](#)

[Manuals+](#), [Privacy Policy](#)

This website is an independent publication and is neither affiliated with nor endorsed by any of the trademark owners. The "Bluetooth®" word mark and logos are registered trademarks owned by Bluetooth SIG, Inc. The "Wi-Fi®" word mark and logos are registered trademarks owned by the Wi-Fi Alliance. Any use of these marks on this website does not imply any affiliation with or endorsement.