



tuya WiFi SOS Button Smart Wireless Sensor Alarm User Manual

[Home](#) » [Tuya](#) » tuya WiFi SOS Button Smart Wireless Sensor Alarm User Manual 

Contents

- 1 tuya WiFi SOS Button Smart Wireless Sensor Alarm
- 2 Product Introduction
- 3 Product Function
- 4 App operation and monitoring
- 5 Registration
- 6 Network and configuration
- 7 App Model Alternative and Connecting
- 8 Device Detail
- 9 Low Battery Indicator
- 10 Technical Parameter
- 11 Documents / Resources
- 12 Related Posts

Tuya

tuya WiFi SOS Button Smart Wireless Sensor Alarm



Product Introduction

This Tuya SOS button, adopts WiFi connection, remote monitoring by APP, which can detect trigger signals from the button accurately and clearly. Suitable for villas, leisure centers, hotels, offices, houses, etc .

Product Function

1. WIFI wireless connection
2. . It can configure the corresponding receiving host via RF wireless transmission (It will send the wireless signal to the pairing host, when triggering happens.)
3. The button provides instant feedback of operations to App via network

App operation and monitoring

Scan the QR as below, or search TuyaSmart on APP Store or Google Play, download and install the APP.



Registration

Please register an account, if it's your first time to use the APP.

Network and configuration

1. Connect your mobile to the WiFi router, make sure it works.
2. Enter [All Devices] page of the APP, tap on [Add Device].



3. Select [Security & Sensor], tap on [Emergency Button].



4. Long press [RESET] on the back of SOS button with phone sim card needle, LED indicator rapidly blink, means it enter the status of WiFi configuration.

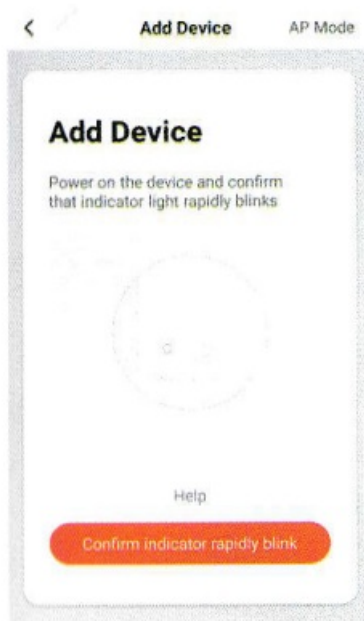

5. Tap on [Confirm indicator rapidly blink].
6. Tap on [Confirm].



7. Wait till it's connected, then tap on [Done].

App Model Alternative and Connecting

Note: Please make sure the button is not in low battery.

1. Tap on the[+], Select [Security & Sensor], tap on **[Emergency Button]**.



2. Tap on [AP Mode].

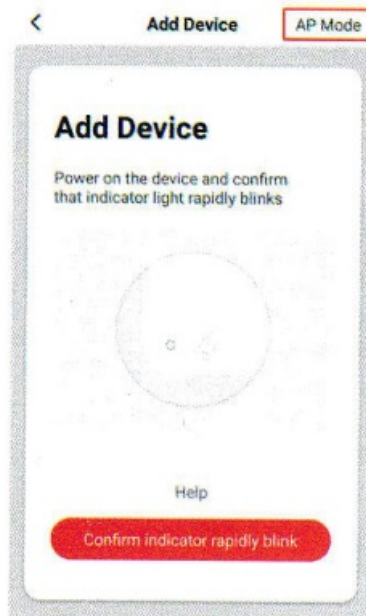

3. Press [RESET] and button at the same time, till the LEO indicator slowly blink.



4. Tap on [Confirm indicator slowly blink], then [Confirm].



5. Tap on [Go to connect], then select [Smartlife_XXXX], and tap on [CONNECT].



6. Select a name, such as [Living Room], then tap on [Done].

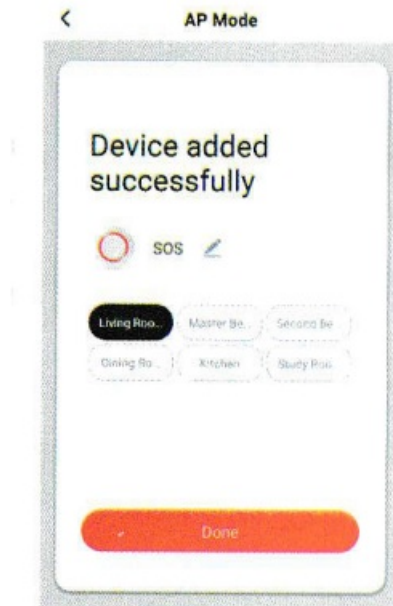

Device Detail

Tap on Lon the device page, you could set the followings.

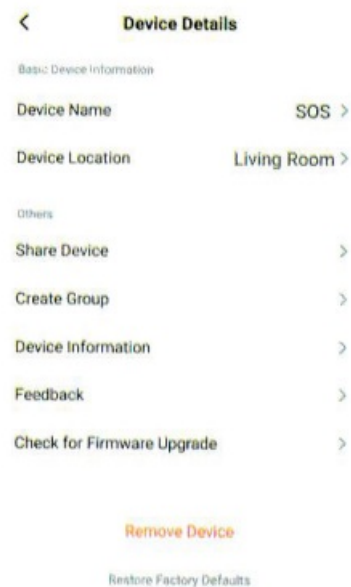

Low Battery Indicator

The device will enter semi-dormant status when low battery, LED indicator blinks 4 times every 60 seconds, means you should replace the battery, the APP will receive an indication too.

Technical Parameter

- Working voltage: 3.6V (LIR2450 rechargeable battery) RF frequency: 433.92MHz
- WIFI frequency: 2.4GH
- Standby current: <50uA
- Working current: <1 00mA



[tuya WiFi SOS Button Smart Wireless Sensor Alarm](#) [pdf] User Manual
WiFi SOS Button Smart Wireless Sensor Alarm