



## tuya TYGWBS-01N Bluetooth MESH(SIG) Gateway User Guide

[Home](#) » [Tuya](#) » tuya TYGWBS-01N Bluetooth MESH(SIG) Gateway User Guide 



### TYGWBS-01N Bluetooth MESH(SIG) Gateway User Guide

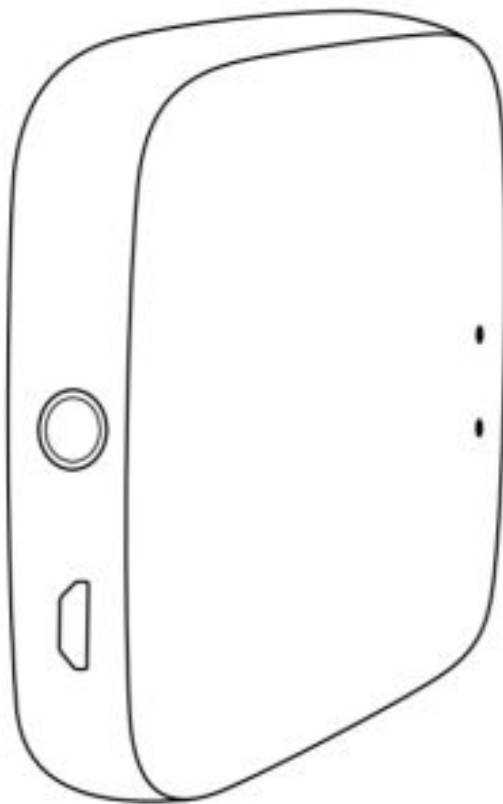

WORKS WITH  
alexa



WORKS WITH  
Google Assistant

## Contents

[1 Product Description](#)

[2 Specifications](#)

[3 Packing list](#)

[4 Status indicator and reset](#)

[5 Documents / Resources](#)

[6 Related Posts](#)

## Product Description

Bluetooth MESH (SIG) gateway is composed of a highly integrated wireless WIFI module, Low energy wireless Bluetooth module, and mainboard. Through the Tuya Smart APP, users can implement device addition, device reset, third-party control, and Bluetooth (single point & mesh) group control to meet smart home and other applications.

## Specifications

Physical features	
Size	65*65*14.5mm
Net weight	29g
Status LED indicator	2 LED
Button	1 (reset)
Power	Micro USB DC5V
Working current	<1A
Adaptor output	5V 1 A
Working temperature	-10-55°C
Working humidity	10%-90WoRH (non-condensing)
Storage temperature	-20-60°C
Storage humidity	5%-90%RH (non-condensing)
Hardware interface	1 Micro-USB
Wireless technology	WIFI 802.11 b/g/n
	Bluetooth single point & Mesh
Antenna type	Built-in onboard antenna

## RF characteristics

	WIFI	Bluetooth single point&Mesh
Wireless frequency	2.400 -2.4835GHz	2.400-2.4835 GHz
Network standard	WIFI 802.11 b/g/n	Bluetooth single point&Mesh
Transmission power	21dBm	7dBm
Channel	CH1-CH11	CHO-CH39 channel 2402MHz;2404 MHz; 2406MHz;2408MHz; 2410MHz;2480MHz one channel is added every 2MHz.
Transmission speed	11b:1,2,5.5,11 (Mbps) 11g:6,9,12,18,24, 36,48,54(Mbps) 11n:HT20 MCSO-7 11 n:HT40 MCSO-7	1Mbps (BLE 4.2) 2Mbps (BLE5.0)

## Network performance

Wireless encryption	AES 128bit encryption
	WPA-PSK/WPA2-PSK, WPA/WPA2 security Mechanism
Network management	long distance App configuration
	WIFI module firmware upgrade
	bluetooth module firmware upgrade

## Packing list

- Bluetooth MESH SIG gateway x1
- Power cable x1
- User manual x1

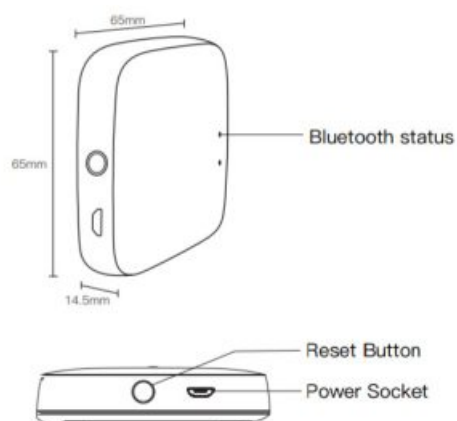

## Status indicator and reset

### Blue: bluetooth status

- Flashing means to be connected and allowed to connect to the network

- keep “on” for a long time, which means the device is activated
- keep “off” for a long time, which means the device is not activated

**Reset method:** Press and hold the button for 5 seconds and see the blue indicator flashing several times,which means the reset is successful.

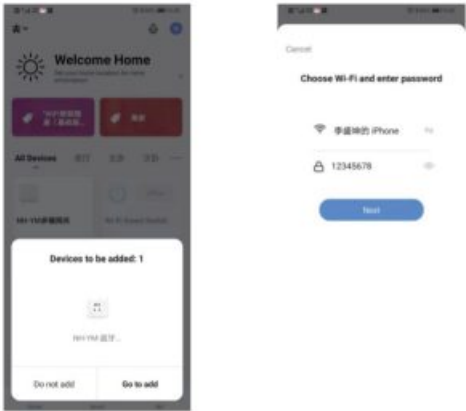

- Select 2.4GHz Wi-Fi network and enter a password.
- Please confirm the blue indication is flashing for normal pairing.
- The connection will take about 30-120 seconds, depending on your network condition
- Once the device has been added successfully, you will be able to find the device on the “My Home” page

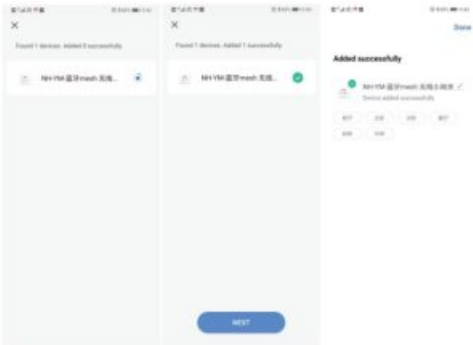

## Documents / Resources

	<p><a href="#">tuya TYGWBS-01N Bluetooth MESH(SIG) Gateway</a> [pdf] User Guide            TYGWBS-01N, Bluetooth MESH SIG Gateway, TYGWBS-01N Bluetooth MESH SIG Gateway</p>
---	--