

tuya[®]
MSA-2 Smart
WiFi Video
Intercom
System



tuya MSA-2 Smart WiFi Video Intercom System Instruction Manual

[Home](#) » [Tuya](#) » tuya MSA-2 Smart WiFi Video Intercom System Instruction Manual 

Contents

- [1 tuya MSA-2 Smart WiFi Video Intercom System](#)
- [2 Specifications](#)
- [3 Matters needing attention](#)
- [4 Installation Instructions](#)
- [5 Product structure](#)
- [6 Product parameters](#)
- [7 Frequently Asked Questions](#)
- [8 Documents / Resources](#)
 - [8.1 References](#)

tuya[®]

tuya MSA-2 Smart WiFi Video Intercom System



Specifications

P r o j e c t	M o d e l	R e s o l u t i o n	P o w e r S u p p l y	P o w e r P a r a m e t e r	V i e w A n g l e	N i g h t V i s i o n S e n s i t i v i t y	N i g h t V i s i o n D i s t a n c e	N i g h t V i s i o n	O p e r a t i n g T e m p e r a t u r e	R a i n p r o o f L e v e l	I n s t a l l a t i o n M a t e r i a l	N e t w o r k C a b l e L e n g t h	S i z e
M S A - 2 /3 /4	1. 0 M P	15 V 1. 2 A	Standby: 2W Operating: 5W	2M	White Light Full Color Night Vision	-30~60	IP65	Embedded Installation Aluminum alloy +ABS plastic	100 M	173*85*41mm			

Matters needing attention

a.Test before installation

Open the package, check whether the accessories are complete, and use the original test cable for the outdoor unit and indoor unit, whether it works normally, and then install.

Note: The wiring must be strictly by the connection diagram of the manual, otherwise the function not be used normally, or even damage the equipment; please refer to the purchased access control power supply manual for the use of the access control power supply, which is not included in the set.

b.Maintenance

1. Don't use it with any product not produced by our company;
2. Users shall follow the user manual strictly to install and test the product. Please call our company for technical support if you have any questions.

Wiring requirements

• A . Extension cable parameter requirements

1-30 Meter	RVV4*0.30
31-50 Meter	RVV4*0.50
51-100 Meter	RVV4*1.0

Colors and functions of wiring terminals:

Yellow --- Video Blue --- Audio

Black --- Ground wire Red --- VCC

Green— Intercom between the screens

• B. Separate wiring from AC

- It's not allowed to arrange power supply wiring and AC or other high-frequency wire in the same conduit, and the spacing distance shall be larger than 60cm;
- The power supply wire for the indoor unit may be laid with intercom wiring in the same conduit;
- Suggestion Rvv wire or Cat5/6 network cable connection (2 cores make 1 core connection).

VI. Floor / nameplate placement instructions

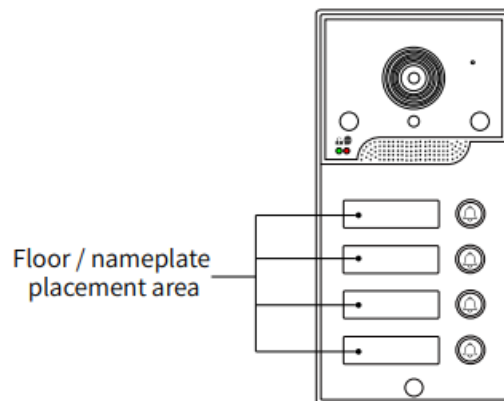

1. You can fill in floor / nameplate and other information as you like.

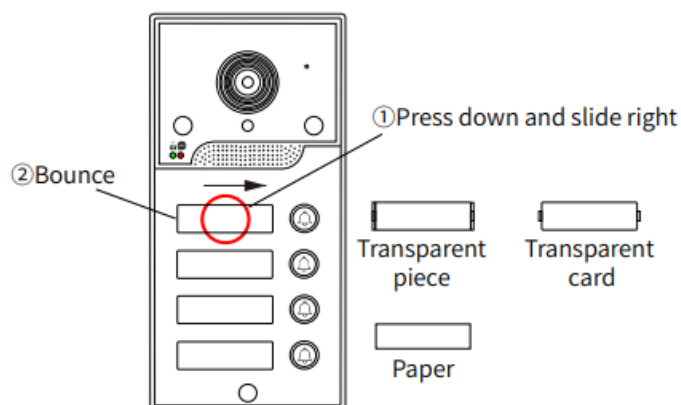

1. Press down the middle area of the transparent part and slide right;
2. The transparent piece bounces, and remove the built-in transparent card and paper;
3. Fill in the information and put it back into the card slot to complete the operation.

Installation Instructions

1. Determine the location and height for installation; the reference height is 145-160cm from the Camera center

toground;

2. It's required to avoid installing the outdoor unit at any place with strong direct sunlight;
3. Locate the position and groove the wall with a percussion drill, with a depth of about 3 cm;
4. Embed the required power cord.

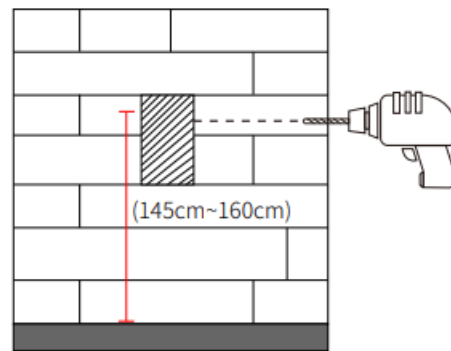

- Route the power cable through the built-in bottom box of the outdoor unit;
- Arrange and finish power cord and fix the bottom box on the wall slot position;
- Attach the box to the wall with expansion screws.

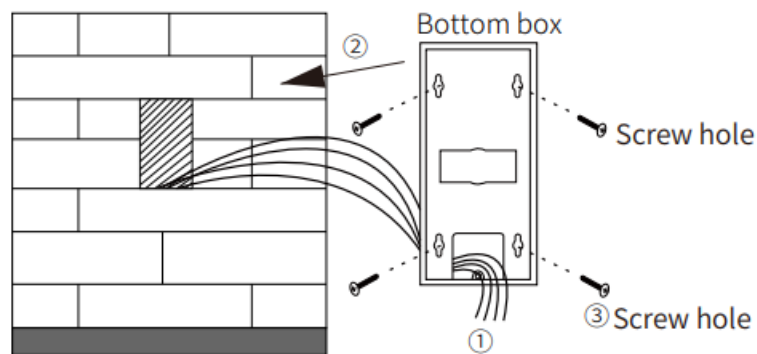

1. Correctly connect the power cable to wiring terminals on the back of the outdoor unit;
2. Buckle the outdoor unit into the bottom box that has been fixed on the wall.

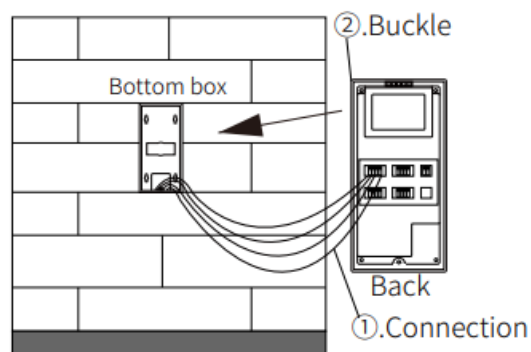

- Fix the outdoor unit and bottom box with screws ;
- Seal the periphery of the outdoor unit with sealant to ensure waterproof edges;
- The installation is completed.

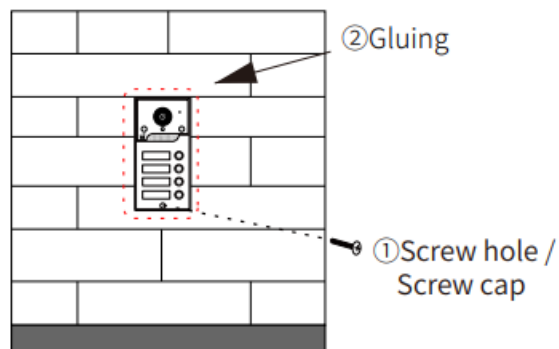

Product structure

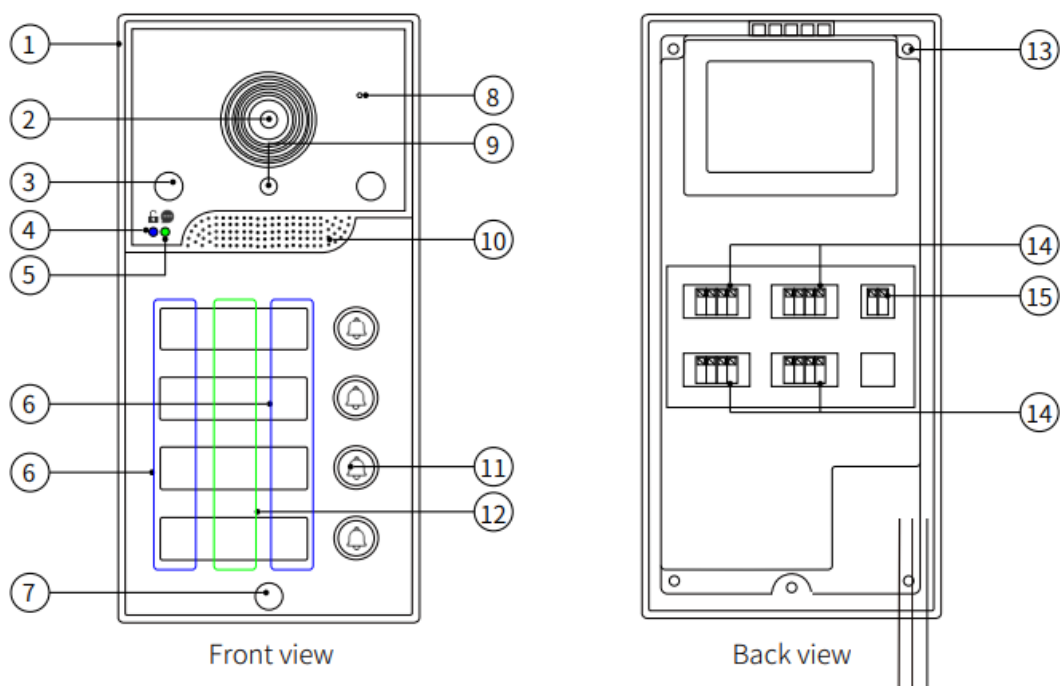

1. Rain cover
2. Camera
3. White light color night vision
4. Blue indicator unlock status
5. Green indicator Call / Monitor status
6. Blue indicator standby status/ indicator unlock status
7. Screw cap
8. Microphone
9. Photoresistance
10. Loudspeaker
11. Call button
12. Green indicator Call / Monitor status
13. Screw hole
14. 4P connector socket
15. 2P port Output 12V voltage signal

Functions of indoor unit

1. The power supply on the indoor unit of this product is DC15 V 1.2 A, and its outdoor unit doesn't need a separate power source
2. Outdoor unit cable connection→The wiring sequence is from left to right Red Power →Black GND)→Blue Audio →Yellow Video Figure 2 , Figure 3
3. The product runs normally and the blue standby indicator on the front of the outdoor unit remains on after the power supply is connected(Figure 1).
4. Press any call button, so the red and green call/monitoring status indicator is lit up 5 12 Figure 1. Figure 1 , and the display is also lit up meanwhile hang up after talkback, and then the call/monitoring indicator is off
5. Press the unlocking key of the indoor unit, “🔓”so the green unlocking status indicator of the outdoor device flashes for one time Figure 1) 4
6. No more than 4 screens can be connected to the indoor unit in series. Indoor units in series can talk to each other. The cable length of two cores merging to one core can reach 200 m if the network cable of the Unshielded Twisted Pair is used.

Wiring schematics

A.Push type wiring diagram

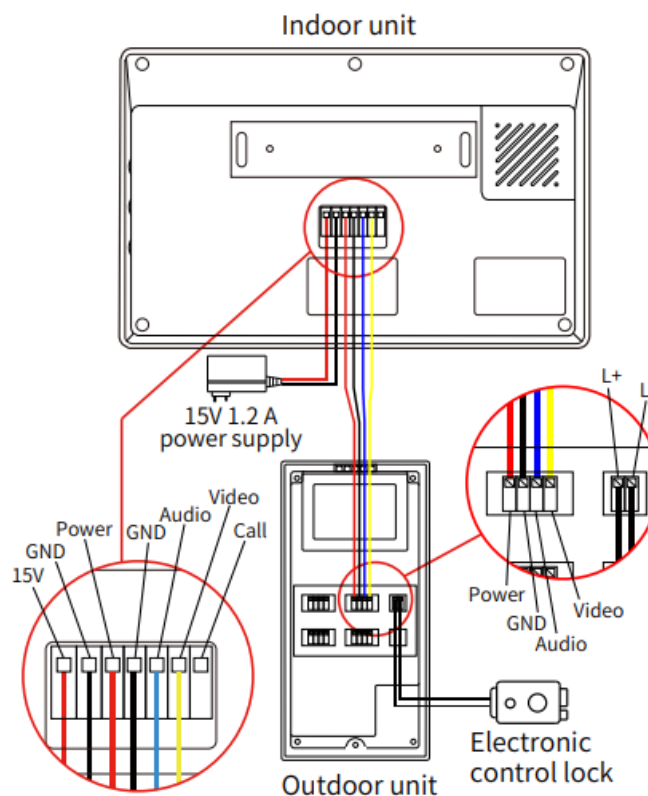

B.Port type wiring diagram

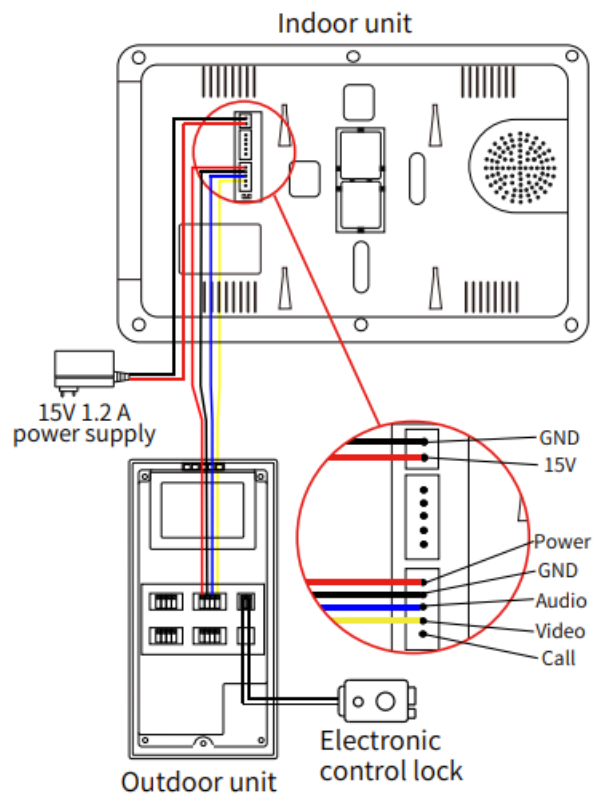

Figure 3

C. Wiring Diagram of Entry Electronic control lock

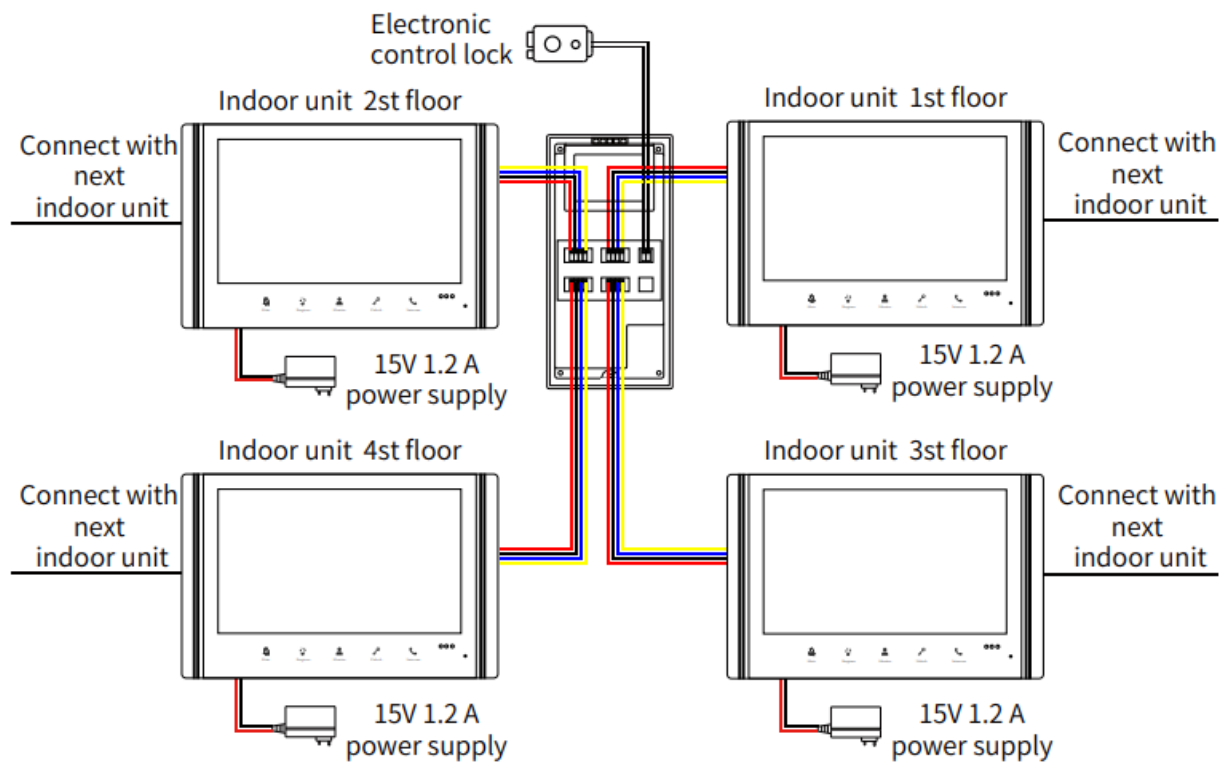

Figure 4

D. Wiring diagram of door access control system (serial connection between indoor unit, up to 4 indoor units)

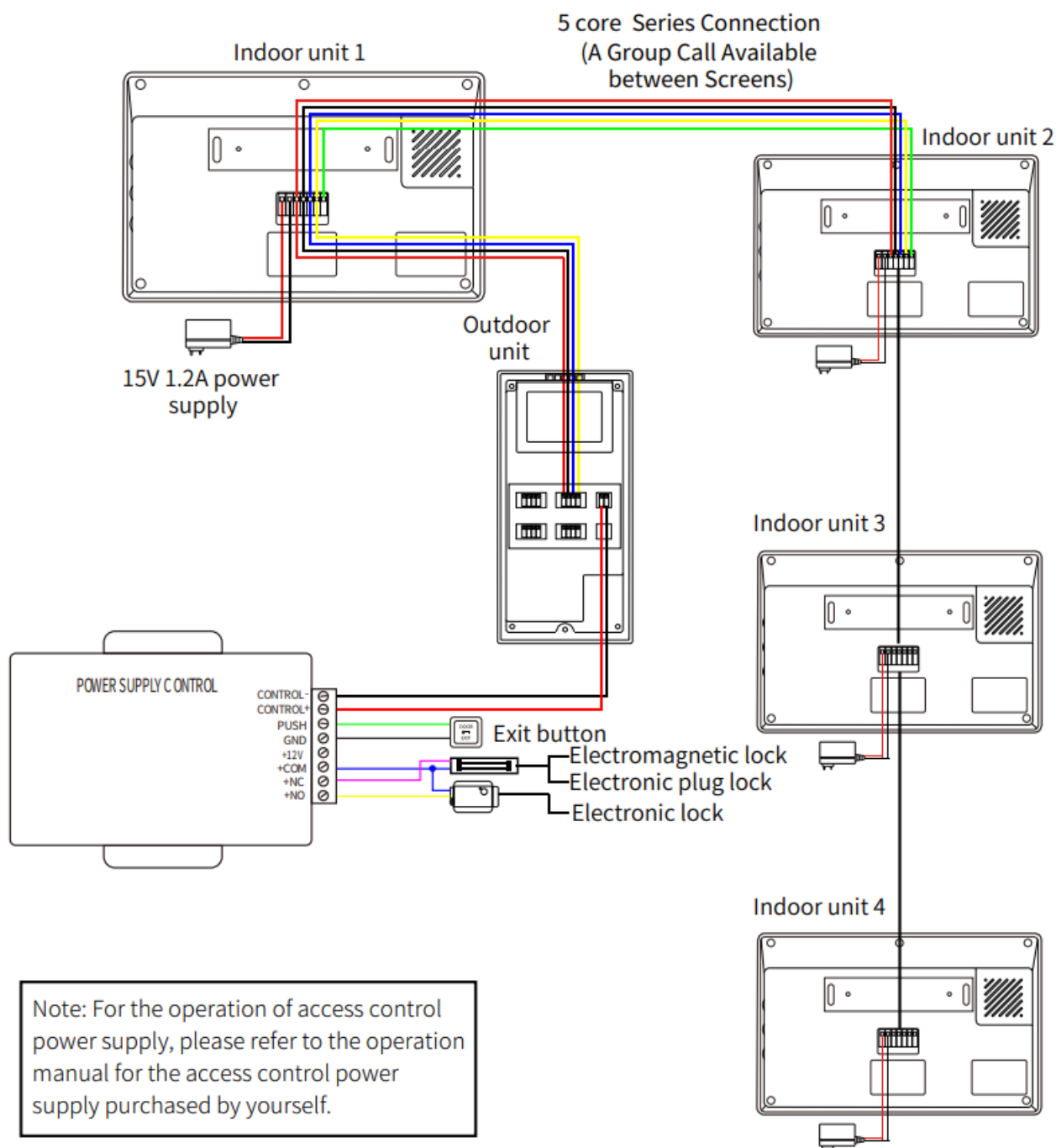

Figure 5

Note: As a calling line, the Call line can not be connected if one indoor unit is just required or talkback doesn't need between screens.

Product parameters

Project	Parameter
Model	MSA-2/3/4
Resolution	1.0MP
Power supply	Indoor Unit Power Supply 15V 1.2A
Power	Standby: ≤2W Operating: ≤5W
View Angle	120°
Night vision sensitivity	0.01 Lux
Night vision distance	2M
Night vision	White Light Full Color Night Vision
Operating temperature	-30°C~60°C
Rainproof level	IP65
Installation	Embedded Installation
Material	Aluminum alloy +ABS plastic
Network cable length	100 M
Size	173*85*41mm

Please read this instruction carefully before use to ensure the correct use of this product

Frequently Asked Questions

- **Q: Can I use this product with third-party accessories?**
 - A: It is recommended to strictly follow the user manual and only use accessories provided by the manufacturer for proper functionality and safety.
- **Q: What is the operating temperature range of the product?**
 - A: The operating temperature range is between -30°C to 60°C, ensuring functionality in various weather conditions.
- **Q: How far does the night vision feature allow visibility?**
 - A: The night vision feature provides visibility up to 2 meters, supported by white light full-color night vision technology.

Documents / Resources

	tuya MSA-2 Smart WiFi Video Intercom System [pdf] Instruction Manual MSA-2, MSA-2 Smart WiFi Video Intercom System, Smart WiFi Video Intercom System, WiFi Video Intercom System, Video Intercom System, Intercom System, System
---	---

References

- [User Manual](#)

Manuals+. Privacy Policy

This website is an independent publication and is neither affiliated with nor endorsed by any of the trademark owners. The "Bluetooth®" word mark and logos are registered trademarks owned by Bluetooth SIG, Inc. The "Wi-Fi®" word mark and logos are registered trademarks owned by the Wi-Fi Alliance. Any use of these marks on this website does not imply any affiliation with or endorsement.