



## tuya FH-MC400A WiFi Smart Multi Function Door Magnetic Sensor User Manual

[Home](#) » [Tuya](#) » tuya FH-MC400A WiFi Smart Multi Function Door Magnetic Sensor User Manual 

tuya FH-MC400A WiFi Smart Multi Function Door Magnetic Sensor User Manual



- Please read this manual carefully before use it, and keep it for future reference

## Contents

- [1 Specification](#)
- [2 How to use](#)
- [3 Documents / Resources](#)
- [4 Related Posts](#)

## Specification

Input Voltage: DC3V LR03 Static Current:  $\leq 35\mu\text{A}$  Alarm Current:  $\leq 135\text{mA}$  Low-voltage notification:  $\leq 2.4\text{V}$  WIFI: 802.11b/g/n

Magnetic Control Distance:  $\leq 20\text{MM}$  illumination range to detect: 0-10000Lux Working Temperature:  $-10^{\circ}\text{C}\sim+50^{\circ}\text{C}$  Working Humidity: Max 95%RH

## How to use

1. Download SmartLife App in Application store, or scan below QR code;



Android/iOS

2. Push the mounting bracket upward and take out the bracket, then insert the battery.



- Put the battery into the battery bin and place it according to the graphics in the battery bin. After two batteries are loaded, the indicator lights are always on and then of

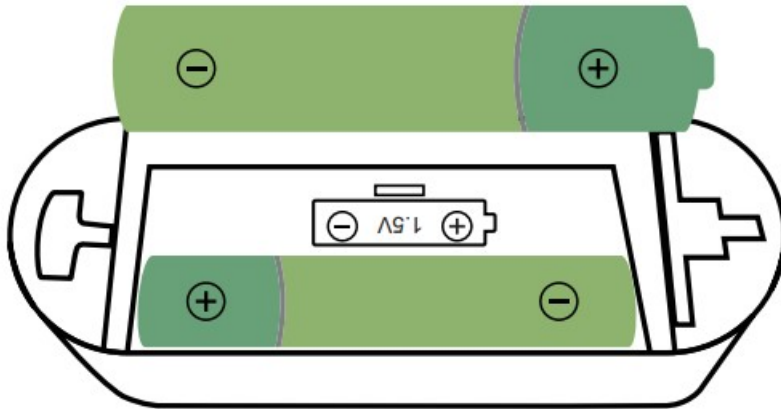

- Register with mobile phone number and log in to APP.

### **Bluetooth Network Configuration**

- Turn on mobile phone Bluetooth; Use the PIN to press RESET till the LED indicator flashes quickly, App will search devices nearby automatically. The device will display once found.



- Click 'Go to add' to enter the WiFi password according to prompt. And click 'Next' to start connection.

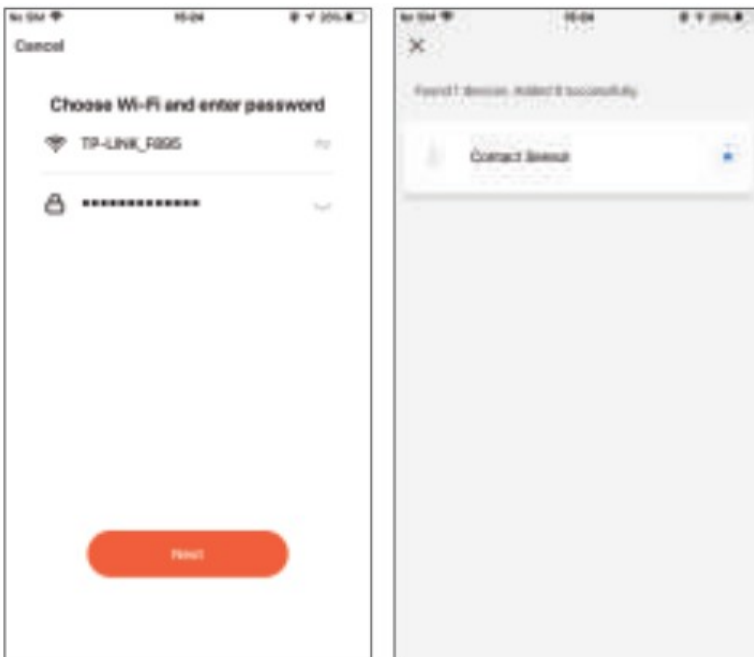

### \* WiFi Network Configuration\* WiFi Network Configuration

7. Register with mobile phone number and log in to App; Click “My Home” interface “+” or click “Add Devices” in the middle blank. Select ‘Sensor’ and choose ‘Sensor (Wi-Fi)’.

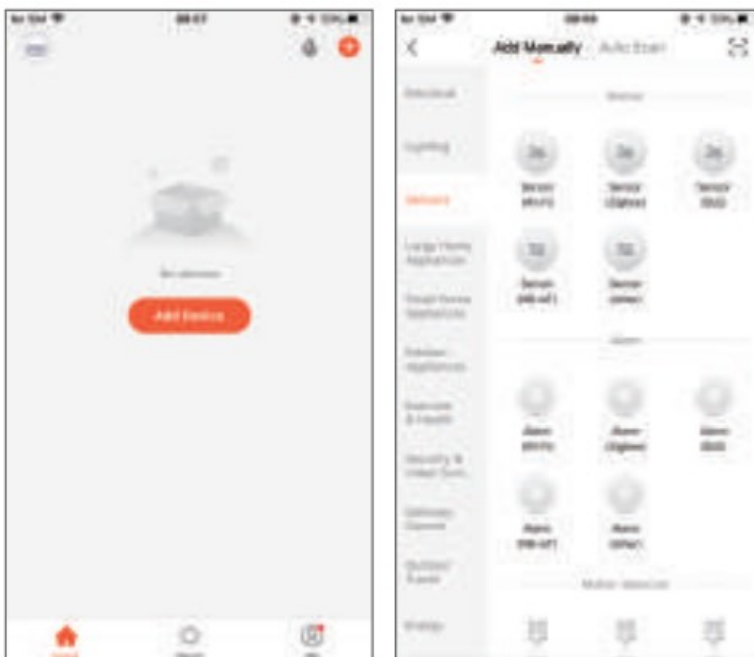

8. Use the card PIN in the accessory package to hold RESET for more than 5 seconds, the indicator flashes quickly and waiting for network configuration. Enter the WiFi password according to the prompt, and click to ‘Next’ to start adding device.



9. When the indicator flashes quickly (EZ Mode as default), holds RESET for another 5 seconds with card PIN, the indicator flashes slowly, device enter manual network configuration (AP mode). App choose AP Mode, tick 'Confirm the indicator is blinking slowly' and click 'Next'. Click 'Go to Connect', mobile phone will switch to WLAN, find 'SmartLife-XXX' and click to connect. Return to APP current interface to continue adding device.

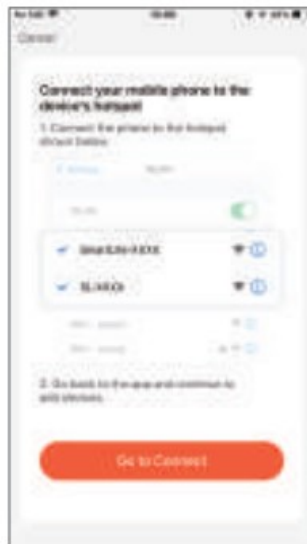

10. Network connection successfully, click 'DONE' to enter the interface of Door sensor.

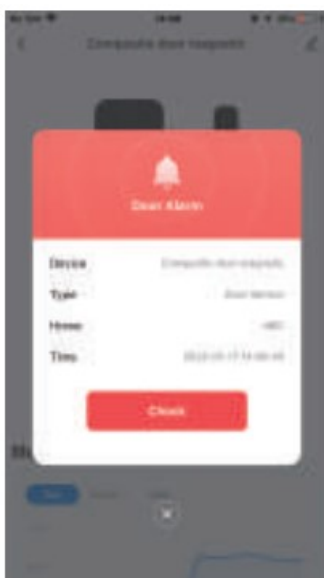

Documents / Resources

	<a href="#">tuya FH-MC400A WiFi Smart Multi Function Door Magnetic Sensor</a> [pdf] User Manual FH-MC400A, WiFi Smart Multi Function Door Magnetic Sensor, FH-MC400A WiFi Smart Multi F unction Door Magnetic Sensor, Smart Multi Function Door Magnetic Sensor, Multi Function Doo r Magnetic Sensor, Door Magnetic Sensor, Magnetic Sensor, Sensor
---	---

[Manuals+](#).