

tuya DH Series Bluetooth Plus WiFi Intelligent Switch

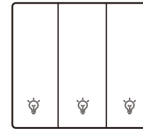

tuya DH Series Bluetooth Plus WiFi Intelligent Switch Instruction Manual

[Home](#) » [Tuya](#) » tuya DH Series Bluetooth Plus WiFi Intelligent Switch Instruction Manual 

Contents

- 1 tuya DH Series Bluetooth Plus WiFi Intelligent Switch
- 2 Product Introduction
- 3 Product parameters
- 4 Installation guide
- 5 Wiring Method for Zero Fire Plate Switch
- 6 Switch networking method
- 7 Register or login
- 8 Add Device
- 9 FCC Information
- 10 Documents / Resources
 - 10.1 References
- 11 Related Posts



tuya DH Series Bluetooth Plus WiFi Intelligent Switch

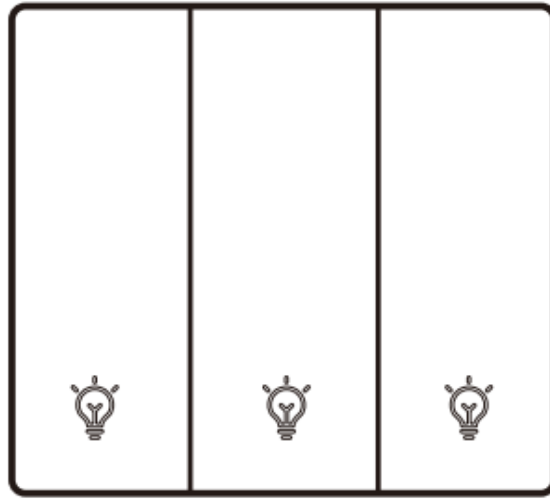

Product Introduction

The wall switch (Bluetooth+WIFI intelligent switch) is a light control switch that uses Bluetooth+WIFI communication protocol. It is easy to install, without changing the original lighting equipment and wiring. It can directly replace traditional switches and achieve remote control, timing control, situational control, and other functions. In addition, this product can be paired with a Bluetooth intelligent speaker to achieve voice interaction control.

Installation precautions

- For your safety, please turn off the installation switch of the main power supply. It is strictly prohibited to install with electricity. Only after confirming the safety of the installation can the main power supply be turned on.
- This product should be installed and debugged by formally qualified professionals under the requirements of electrical specifications and product manuals.

Product parameters

- **Working voltage:** 100V-240V -, 50Hz/60Hz (zero live wire)
- **Working current:** 10A Max (pure resistive load) – zero live wire
- **Load type:** 300W circuit for incandescent lamps, 120W circuit for LED lamps, and 200W circuit for energy-saving lamps.
- **Product Material:** Fireproof PC Shell
- **Operating environment:** temperature 0°C~40 ° C, relative humidity less than 95%
- **Communication protocol:** Bluetooth+WiFi
- Wireless frequency WiFi 2.4Hzb/g/n, RF433

Installation guide

1. Use your hand to break open the button panel.

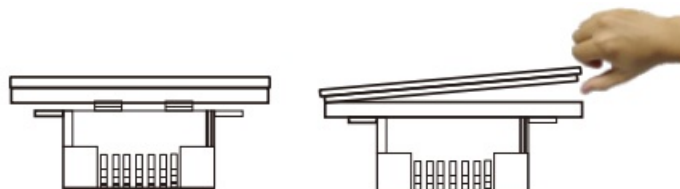

Wiring Method for Zero Fire Plate Switch

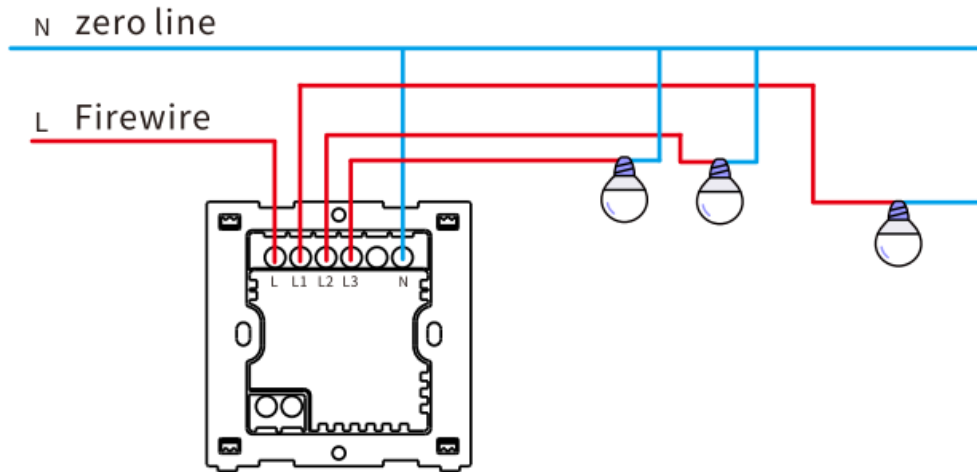

N is the zero line, L is the live line input, 1. L2.L3 is the control light line output, (the zero line can only be connected to point N and cannot be connected to L.L123, otherwise it will cause a short circuit)

Switch networking method

1. Scan the QR code to download the app or application market, download “Doodle Intelligence” or “Smart Life”, register an account and log in.

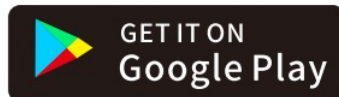

Register or login

1. Download Graffiti Smart or Smart Life
2. Enter the registration/login interface: Click “Register” to create an account by entering your phone number to obtain a verification code and set a password. If you already have a Smart Life account, please choose to log in

Note: If you are already connected to a 5G network, please disconnect the SG network and connect to a 2.4G network first. Fill in the correct password for the 24G WF account (SG WF cannot be used)

Add Device

Press and hold any key of the switch for approximately 7 seconds until all blue indicator lights on the switch flash quickly after 3 seconds. Then the switch can enter the distribution network state for the graffiti app or smart life app distribution network

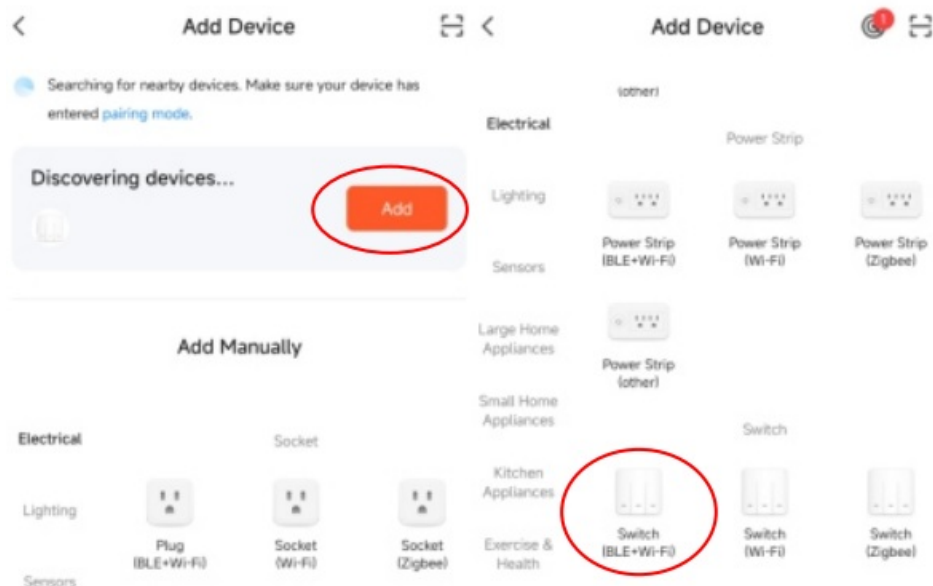

1. Click on the "+" button in the upper right corner of the doodle app or smart life app to enter the add device page, and choose to automatically search for devices or manually add devices.

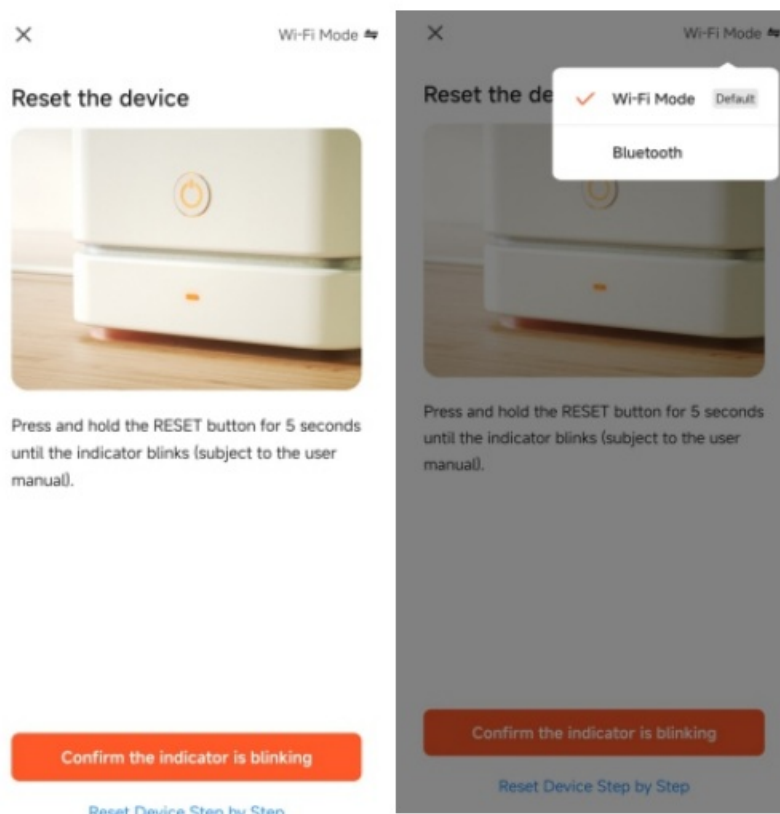

2. Confirm that the blue indicator light on the switch flashes quickly (twice per second), select WF distribution network or Bluetooth distribution network, and then click to confirm that the indicator light flashes, and select Flash.

Connecting Device

Power on the device.

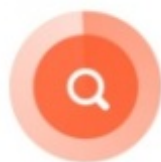

01:59



3. Based on your network condition, the connection will take approximately 10-120 seconds to complete

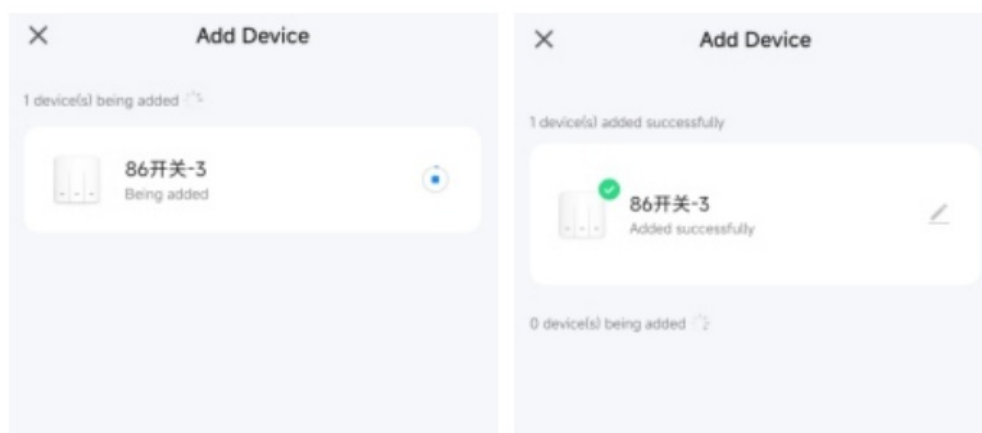

4. After pairing is completed, the switch will be displayed on the application program

How to reset/redistribute the network

Press and hold any key of the switch for approximately 6-8 seconds until all blue indicator lights on the switch flash quickly after 3 seconds, indicating that the switch has been successfully reset/re wired

Random pairing/code clearing method

Pairing: After the switch is powered on, press and hold the button on the switch for 3-5 seconds until the white indicator light on the switch quickly flashes, then release. Within 10 seconds, press the button that you want to pair with randomly and control it. The white indicator light quickly flashes for 3 times and then goes out, indicating successful code matching. (Pairing keys one-on-one)

Clear code: Press the button on the switch five times continuously until the white indicator light on the switch quickly flashes 8 times and then goes out, which means clear code. Just click on it again and paste it without any

response. (Press the button to clear the code one-on-one)

FCC Information

This equipment has been tested and found to comply with the limits for a Class B digital device, under part 15 of the FCC Rules. These limits are designed to provide reasonable protection against harmful interference in a residential installation. This equipment generates,uses, and can radiate radio frequency energy and, if not installed and used under the instructions, may cause harmful interference to radio communications. However, there is no guarantee that interference will not occur in a particular installation. If this equipment does cause harmful interference to radio or television reception, which can be determined by turning the equipment off and on, the user is encouraged to try to correct the interference by one or more of the following measures:

- Reorient or relocate the receiving antenna.
- Increase the separation between the equipment and the receiver.
- Connect the equipment into an outlet on a circuit different from that to which the receiver is connected.
- Consult the dealer or an experienced radio/TV technician for help.

This device complies with part 15 of the FCC Rules. Operation is subject to the following two conditions:

1. This device may not cause harmful interference, and
 2. this device must accept any interference received, including interference that may cause undesired operation.
- changes or modifications not expressly approved by the party responsible for compliance could void the user's authority to operate the equipment.

This equipment complies with FCC exposure limits set forth for an uncontrolled environment. This equipment should be installed and operated with minimum distance of 20 cm between the radiator and your body. This transmitter must not be co-located or operating in conjunction with any other antenna or transmitter.

Documents / Resources

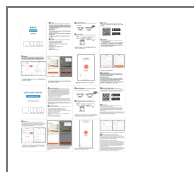

[tuya DH Series Bluetooth Plus WiFi Intelligent Switch](#) [pdf] Instruction Manual
DH Series, DH Series Bluetooth Plus WiFi Intelligent Switch, Bluetooth Plus WiFi Intelligent Switch, WiFi Intelligent Switch, Intelligent Switch, Switch

References

- [User Manual](#)

Manuals+, Privacy Policy

This website is an independent publication and is neither affiliated with nor endorsed by any of the trademark owners. The "Bluetooth®" word mark and logos are registered trademarks owned by Bluetooth SIG, Inc. The "Wi-Fi®" word mark and logos are registered trademarks owned by the Wi-Fi Alliance. Any use of these marks on this website does not imply any affiliation with or endorsement.