



# TURTLE BEACH TBS-0710-05-QSG-E Stealth Ultra Wireless Controller User Guide

[Home](#) » [TURTLE BEACH](#) » TURTLE BEACH TBS-0710-05-QSG-E Stealth Ultra Wireless Controller User Guide 

TURTLE BEACH TBS-0710-05-QSG-E Stealth Ultra Wireless Controller



## Contents

- 1 CONTENTS & PRODUCT TOUR
- 2 SETUP FOR XBOX
- 3 SETUP FOR PC
- 4 COMMAND DISPLAY MAIN MENU
- 5 COMMAND DISPLAY DASHBOARD
- 6 CONTROL CENTER 2
- 7 CHARGING
- 8 CUDTOMER SUPPORT
- 9 Documents / Resources
- 9.1 References

## CONTENTS & PRODUCT TOUR

- A Adjustable trigger locks
- B USB cable port
- C Command display
- D Guide button Press (2s) = power on/of
- E Connection LED
- F Input focus button
- G Headset port
- H Mappable action buttons

- 
- The diagram illustrates the components of the PlayStation Move motion controller system. It includes:
- Move Controller (Top Left):** A detailed view of the controller with labels A (LT), B (RT), C (LB), D (RB), E (X), F (Y), G (A), H (B), I (LT), J (RT), K (LB), L (RB), M (X), N (Y), O (A), P (B), Q (LT), R (RT), S (LB), T (RB), U (X), V (Y), W (A), X (B), Y (LT), Z (RT), AA (LB), AB (RB), AC (X), AD (Y), AE (A), AF (B), AG (LT), AH (RT), AI (LB), AJ (RB), AK (X), AL (Y), AM (A), AN (B), AO (LT), AP (RT), AQ (LB), AR (RB), AS (X), AT (Y), AU (A), AV (B), AW (LT), AX (RT), AY (LB), AZ (RB), BA (X), BB (Y), BC (A), BD (B), BE (LT), BF (RT), BG (LB), BH (RB), BI (X), BJ (Y), BK (A), BL (B), BM (LT), BN (RT), BO (LB), BP (RB), BQ (X), BR (Y), BS (A), BT (B), BU (LT), BV (RT), BW (LB), BX (RB), BY (X), BZ (Y), CA (A), CB (B), CC (LT), CD (RT), CE (LB), CF (RB), CG (X), CH (Y), CI (A), CJ (B), CK (LT), CL (RT), CM (LB), CN (RB), CO (X), CP (Y), CQ (A), CR (B), CS (LT), CT (RT), CU (LB), CV (RB), CW (X), CX (Y), CY (A), CZ (B), DA (LT), DB (RT), DC (LB), DD (RB), DE (X), DF (Y), DG (A), DH (B), DI (LT), DJ (RT), DK (LB), DL (RB), DM (X), DN (Y), DO (A), DP (B), DQ (LT), DR (RT), DS (LB), DT (RB), DU (X), DV (Y), DW (A), DX (B), DY (LT), DZ (RT), EA (LB), EB (RB), EC (X), ED (Y), EE (A), EF (B), EG (LT), EH (RT), EI (LB), EJ (RB), EK (X), EL (Y), EM (A), EN (B), EO (LT), EP (RT), EQ (LB), ER (RB), ES (X), ET (Y), EU (A), EV (B), EW (LT), EX (RT), EY (LB), EZ (RB), FA (X), FB (Y), FC (A), FD (B), FE (LT), FF (RT), FG (LB), FH (RB), FI (X), FJ (Y), FK (A), FL (B), FM (LT), FN (RT), FO (LB), FP (RB), FQ (X), FR (Y), FS (A), FT (B), FU (LT), FV (RT), FW (LB), FX (RB), FY (X), FZ (Y), GA (LB), GB (RB), GC (X), GD (Y), GE (A), GF (B), GG (LT), GH (RT), GI (LB), GJ (RB), GK (X), GL (Y), GM (A), GN (B), GO (LT), GP (RT), GQ (LB), GR (RB), GS (X), GT (Y), GU (A), GV (B), GW (LT), GX (RT), GY (LB), GZ (RB), HA (X), HB (Y), HC (A), HD (B), HE (LT), HF (RT), HG (LB), HH (RB), HI (X), HJ (Y), HK (A), HL (B), HM (LT), HN (RT), HO (LB), HP (RB), HQ (X), HR (Y), HS (A), HT (B), HU (LT), HV (RT), HW (LB), HX (RB), HY (X), HZ (Y), IA (LB), IB (RB), IC (X), ID (Y), IE (A), IF (B), IG (LT), IH (RT), II (LB), IJ (RB), IK (X), IL (Y), IM (A), IN (B), IO (LT), IP (RT), IQ (LB), IR (RB), IS (X), IT (Y), IU (A), IV (B), IW (LT), IX (RT), IY (LB), IZ (RB), JA (X), JB (Y), JC (A), JD (B), JE (LT), JF (RT), JG (LB), JH (RB), JI (X), JJ (Y), JK (A), JL (B), JM (LT), JN (RT), JO (LB), JP (RB), JQ (X), JR (Y), JS (A), JT (B), JU (LT), JV (RT), JW (LB), JX (RB), JY (X), JZ (Y), KA (LB), KB (RB), KC (X), KD (Y), KE (A), KF (B), KG (LT), KH (RT), KI (LB), KJ (RB), KK (X), KL (Y), KM (A), KN (B), KO (LT), KP (RT), KQ (LB), KR (RB), KS (X), KT (Y), KU (A), KV (B), KW (LT), KX (RT), KY (LB), KZ (RB), LA (X), LB (Y), LC (A), LD (B), LE (LT), LF (RT), LG (LB), LF (RB), LI (X), LJ (Y), LK (A), LL (B), LM (LT), LN (RT), LO (LB), LP (RB), LQ (X), LR (Y), LS (A), LT (B), LU (LT), LV (RT), LW (LB), LX (RB), LY (X), LZ (Y), MA (LB), MB (RB), MC (X), MD (Y), ME (A), MF (B), MG (LT), MH (RT), MI (LB), MJ (RB), MK (X), ML (Y), MM (A), MN (B), MO (LT), MP (RT), MQ (LB), MR (RB), MS (X), MT (Y), MU (A), MV (B), MW (LT), MX (RT), MY (LB), MZ (RB), NA (X), NB (Y), NC (A), ND (B), NE (LT), NF (RT), NG (LB), NH (RB), NI (X), NJ (Y), NK (A), NL (B), NM (LT), NN (RT), NO (LB), NP (RB), NQ (X), NR (Y), NS (A), NT (B), NU (LT), NV (RT), NW (LB), NX (RB), NY (X), NZ (Y), OA (LB), OB (RB), OC (X), OD (Y), OE (A), OF (B), OG (LT), OH (RT), OI (LB), OJ (RB), OK (X), OL (Y), OM (A), ON (B), OO (LT), OP (RT), OQ (LB), OR (RB), OS (X), OT (Y), OU (A), OV (B), OW (LT), OX (RT), OY (LB), OZ (RB), PA (X), PB (Y), PC (A), PD (B), PE (LT), PF (RT), PG (LB), PH (RB), PI (X), PJ (Y), PK (A), PL (B), PM (LT), PN (RT), PO (LB), PP (RB), PQ (X), PR (Y), PS (A), PT (B), PU (LT), PV (RT), PW (LB), PX (RB), PY (X), PZ (Y), QA (LB), QB (RB), QC (X), QD (Y), QE (A), QF (B), QG (LT), QH (RT), QI (LB), QJ (RB), QK (X), QL (Y), QM (A), QN (B), QO (LT), QP (RT), QQ (LB), QR (RB), QS (X), QT (Y), QU (A), QV (B), QW (LT), QX (RT), QY (LB), QZ (RB), RA (X), RB (Y), RC (A), RD (B), RE (LT), RF (RT), RG (LB), RH (RB), RI (X), RJ (Y), RK (A), RL (B), RM (LT), RN (RT), RO (LB), RP (RB), RQ (X), RR (Y), RS (A), RT (B), RU (LT), RV (RT), RW (LB), RX (RB), RY (X), RZ (Y), SA (LB), SB (RB), SC (X), SD (Y), SE (A), SF (B), SG (LT), SH (RT), SI (LB), SJ (RB), SK (X), SL (Y), SM (A), SN (B), SO (LT), SP (RT), SQ (LB), SR (RB), SS (X), ST (Y), SU (A), SV (B), SW (LT), SX (RT), SY (LB), SZ (RB), TA (X), TB (Y), TC (A), TD (B), TE (LT), TF (RT), TG (LB), TH (RB), TI (X), TJ (Y), TK (A), TL (B), TM (LT), TN (RT), TO (LB), TP (RB), TQ (X), TR (Y), TS (A), TT (B), TU (LT), TV (RT), TW (LB), TX (RB), TY (X), TZ (Y), UA (LB), UB (RB), UC (X), UD (Y), UE (A), UF (B), UG (LT), UH (RT), UI (LB), UJ (RB), UK (X), UL (Y), UM (A), UN (B), UO (LT), UP (RT), UQ (LB), UR (RB), US (X), UT (Y), UU (A), UV (B), UW (LT), UX (RT), UY (LB), UZ (RB), VA (X), VB (Y), VC (A), VD (B), VE (LT), VF (RT), VG (LB), VH (RB), VI (X), VJ (Y), VK (A), VL (B), VM (LT), VN (RT), VO (LB), VP (RB), VQ (X), VR (Y), VS (A), VT (B), VU (LT), VV (RT), VW (LB), VX (RB), VY (X), VZ (Y), WA (LB), WB (RB), WC (X), WD (Y), WE (A), WF (B), WG (LT), WH (RT), WI (LB), WJ (RB), WK (X), WL (Y), WM (A), WN (B), WO (LT), WP (RT), WQ (LB), WR (RB), WS (X), WT (Y), WU (A), WV (B), WW (LT), WX (RT), WY (LB), WZ (RB), XA (X), XB (Y), XC (A), XD (B), XE (LT), XF (RT), XG (LB), XH (RB), XI (X), XJ (Y), XK (A), XL (B), XM (LT), XN (RT), XO (LB), XP (RB), XQ (X), XR (Y), XS (A), XT (B), XU (LT), XV (RT), XW (LB), XX (RB), XY (X), XZ (Y), YA (LB), YB (RB), YC (X), YD (Y), YE (A), YF (B), YG (LT), YH (RT), YI (LB), YJ (RB), YK (X), YL (Y), YM (A), YN (B), YO (LT), YP (RT), YQ (LB), YR (RB), YS (X), YT (Y), YU (A), YV (B), YW (LT), YX (RT), YY (LB), YZ (RB), ZA (X), ZB (Y), ZC (A), ZD (B), ZE (LT), ZF (RT), ZG (LB), ZH (RB), ZI (X), ZJ (Y), ZK (A), ZL (B), ZM (LT), ZN (RT), ZO (LB), ZP (RB), ZQ (X), ZR (Y), ZS (A), ZT (B), ZU (LT), ZV (RT), ZW (LB), ZX (RB), ZY (X), ZZ (Y).

## SETUP FOR XBOX

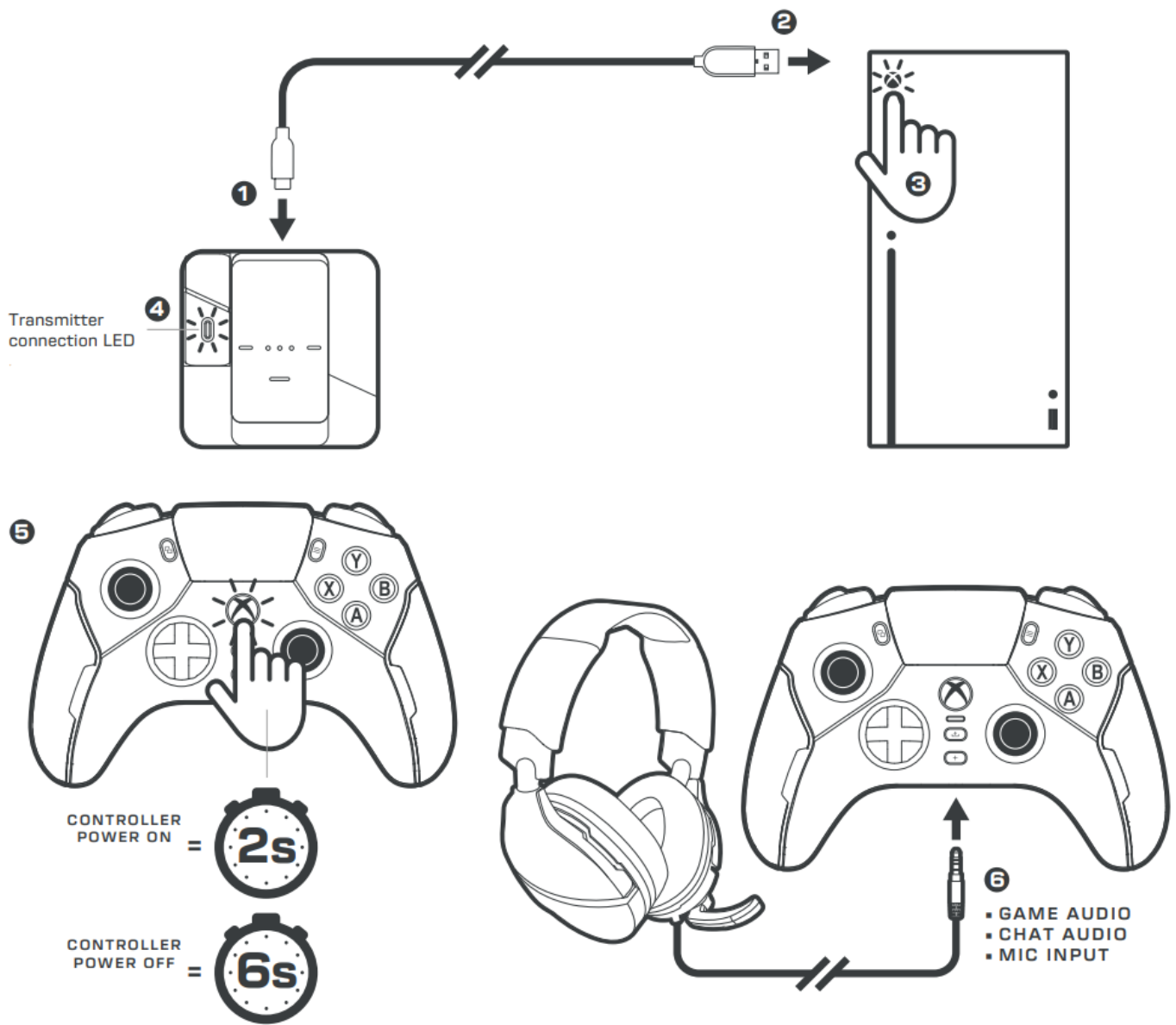

## SETUP FOR PC

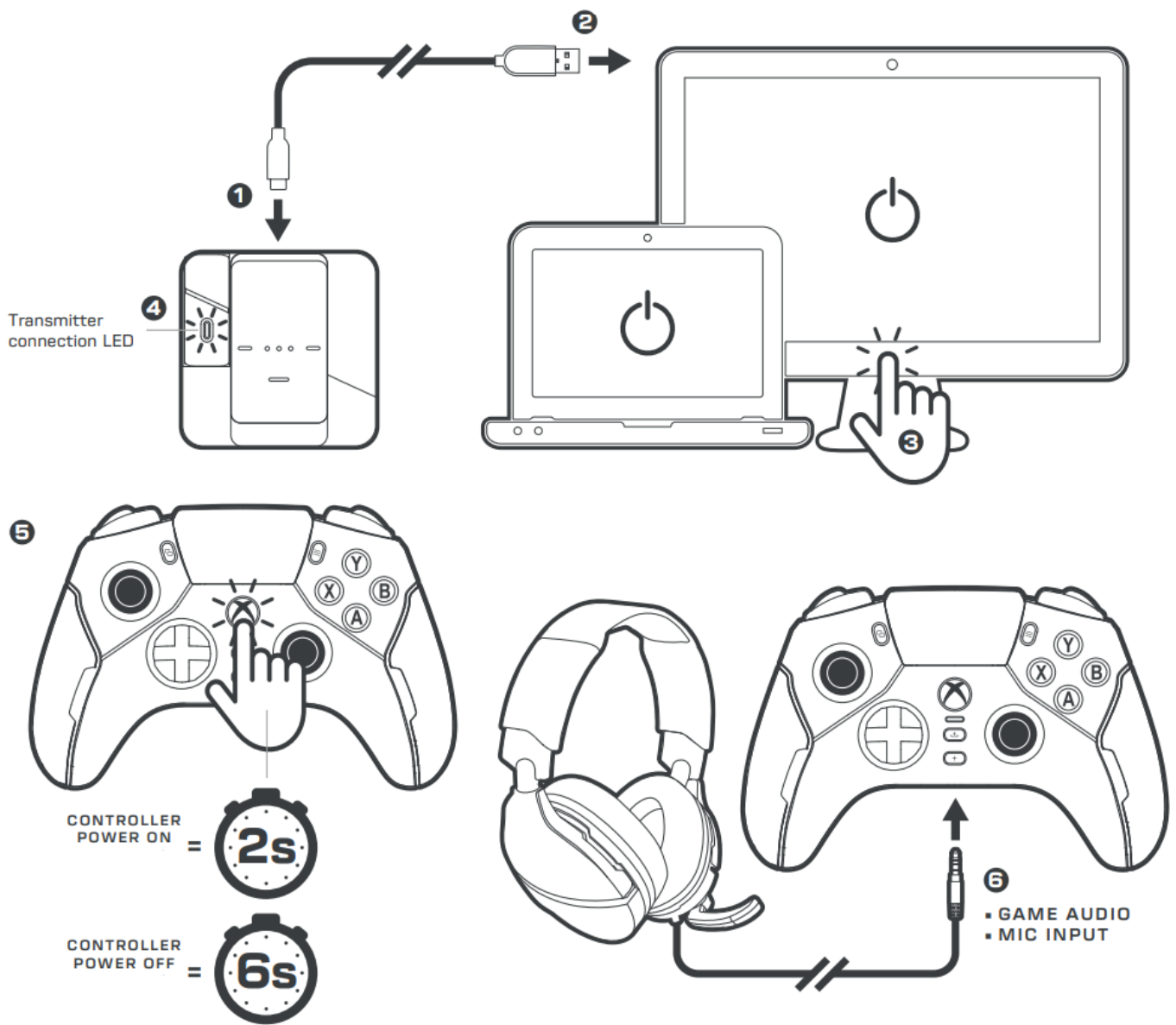



## COMMAND DISPLAY MAIN MENU

Make in-depth adjustments via the Main Menu.

Switch focus to the COMMAND DISPLAY then press **Y** to access the main menu.

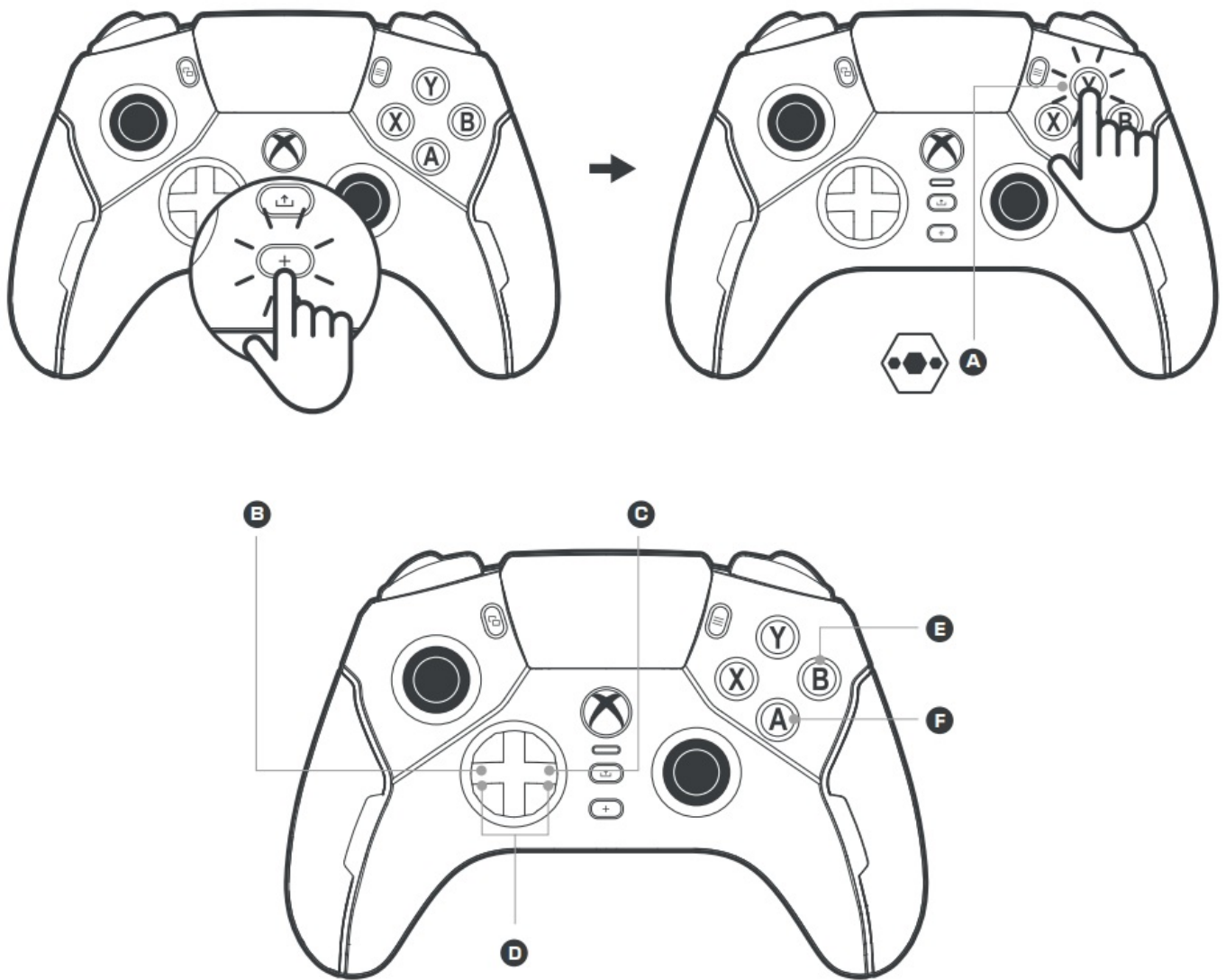
- A** Open main menu
- B** Previous menu item
- C** Next menu item
- D** Adjust feature
- E** Back/cancel
- F** Select/accept



Press  to return focus to the game.

## COMMAND DISPLAY DASHBOARD

Make quick adjustments via the DASHBOARD.

Press  to switch focus to the COMMAND DISPLAY.

- A** Profile –
- B** Profile +
- C** Open main menu
- D** EQ cycle
- E** Social feed
- F** Mic mute
- G** Chat mix +
- H** Chat mix –
- I** Volume +
- J** Volume –



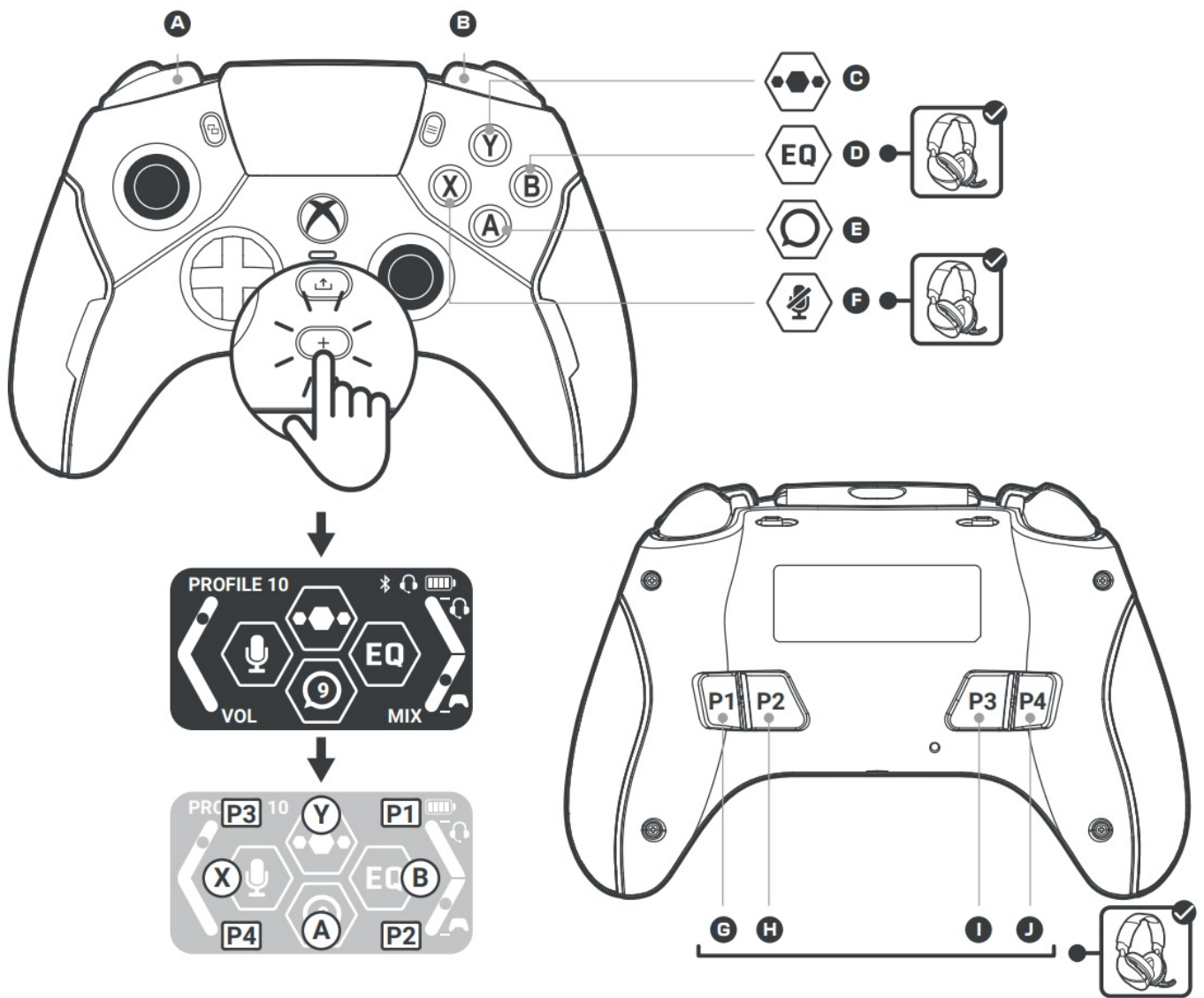

Press  to return focus to the game.

## CONTROL CENTER 2

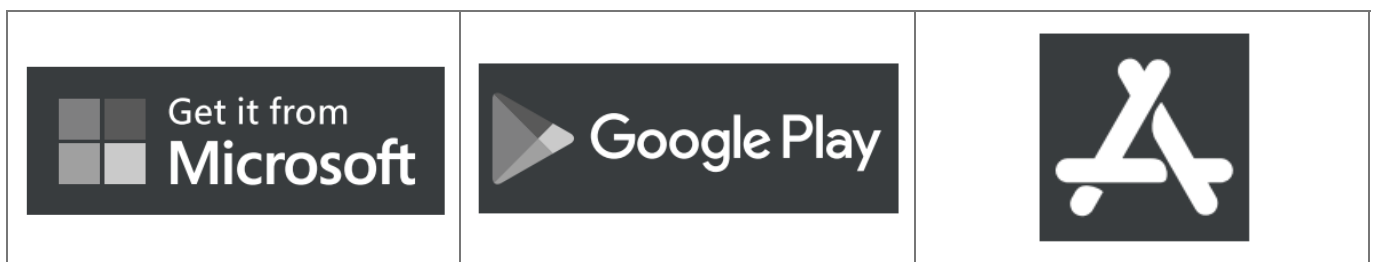

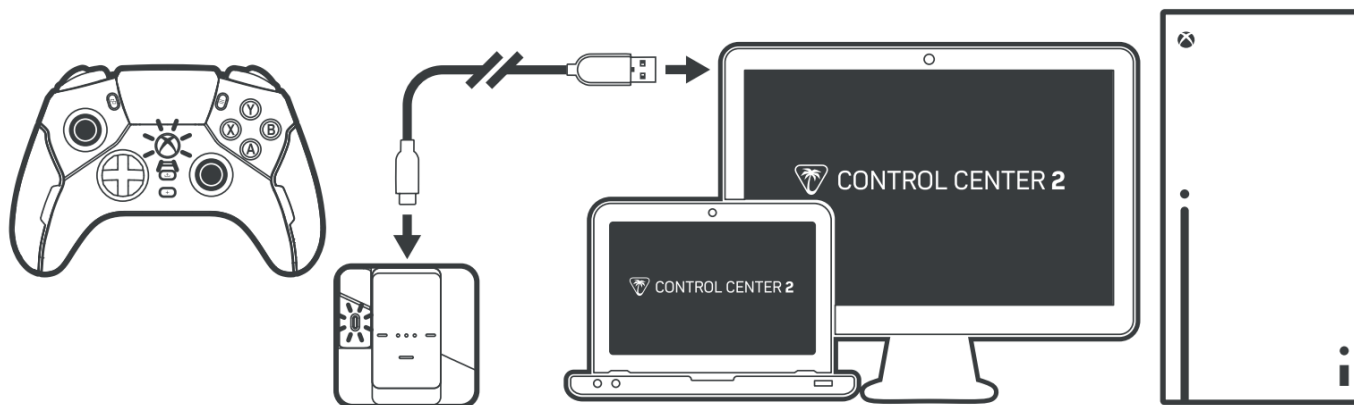

Search for Stealth Ultra and Control Center 2 app on Microsoft Store, Play Store and App Store. Keep your controller up to date and customize performance settings on Xbox and Windows. Tune on board memory profiles and configure social notifications on Android and iOS.

1. Initiate APP LINK pairing from the COMMAND DISPLAY main menu.



2. Pair to your mobile smart device.



2

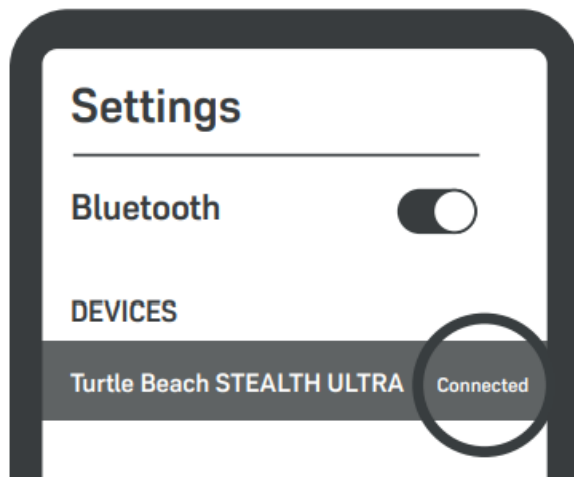

3. Launch the Control Center 2 app.

3

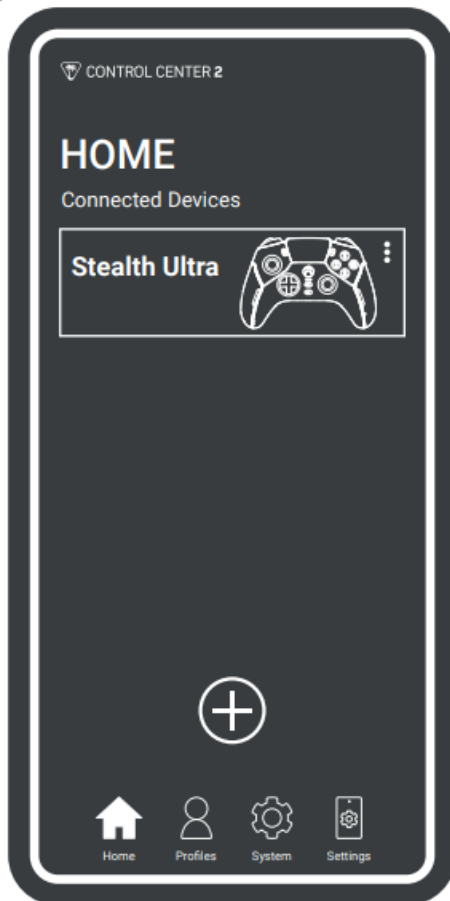

## CHARGING

When battery level is low, controller LEDs will flash red.

1. Use the dock to charge the controller. Controller LEDs will turn green when it is fully charged.

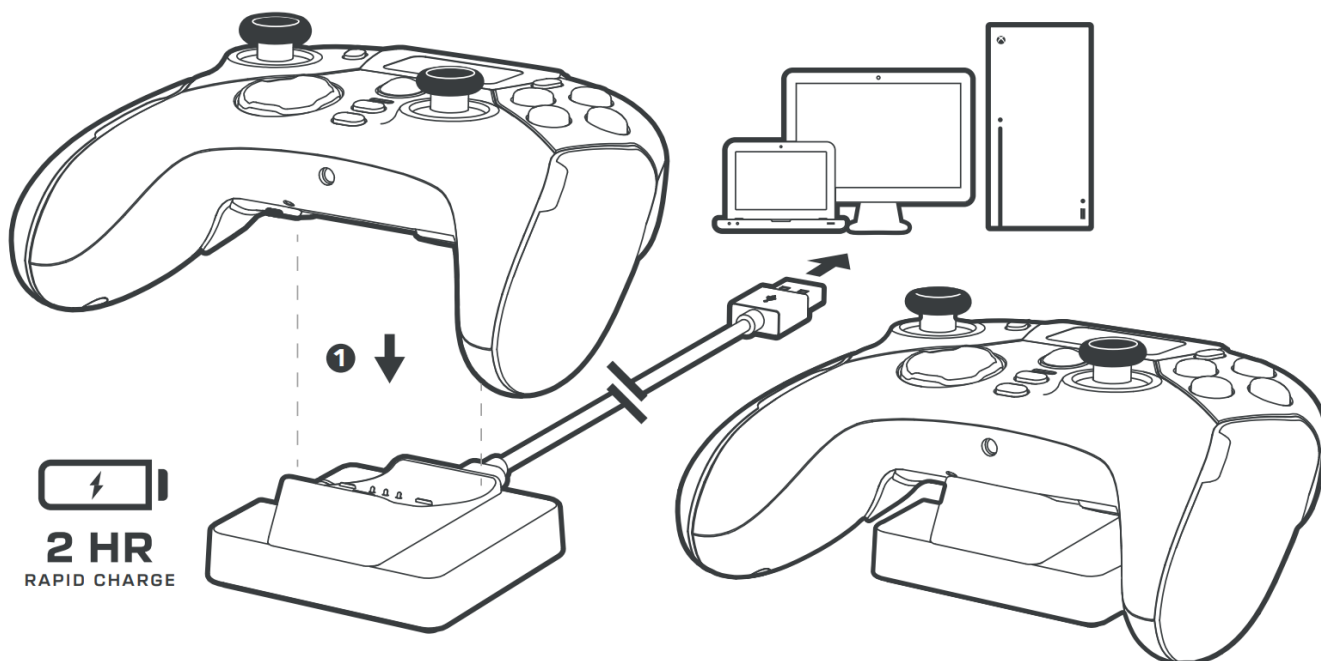

2. Or use the USB cable to Play & Charge. In this mode, STEALTH ULTRA will function as a wired device.

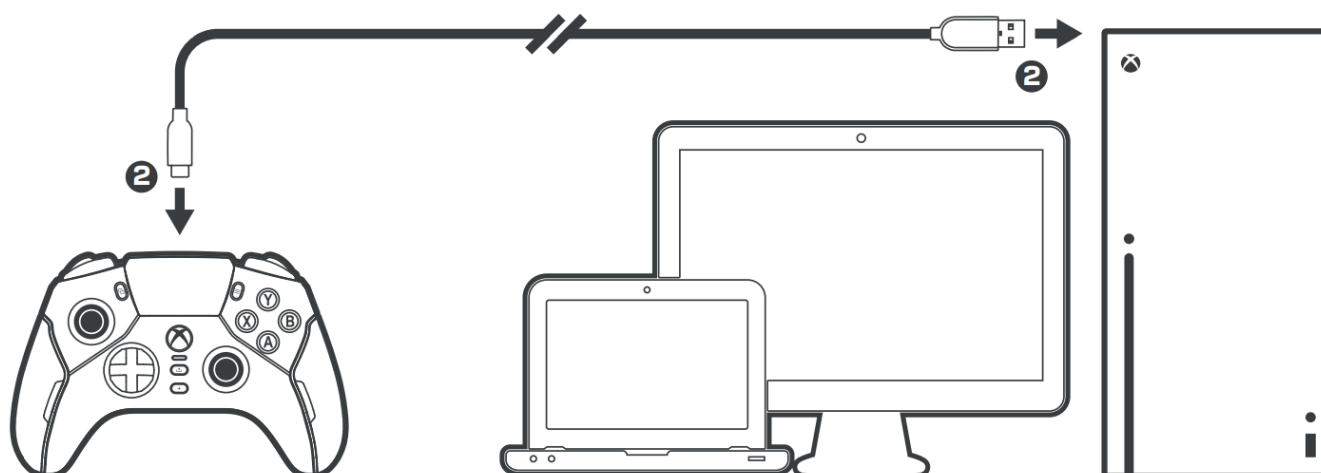

## Regulatory Compliance Statements for the Stealth Ultra

### Local Restrictions on Radio Usage

Caution: Due to the fact that the frequencies used by wireless devices may not yet be harmonized in all countries, these radio products are designed for use only in specific countries, and are not allowed to be operated in countries other than those of designated use. As a user of these products, you are responsible for ensuring that the products are used only in the countries for which they were intended and for verifying that they are configured with the correct selection of frequency and channel for the country of use. Any deviation from the permissible power and frequency settings for the country of use is an infringement of national law and may be punished as such.

To determine whether you are allowed to use your wireless network device in a specific country, please check to see if the radio type number that is printed on the identification label of your device is listed in the manufacturer's OEM Regulatory Guidance document at the following URL <http://www.turtlebeach.com/homologation> or contact Turtle Beach directly.



Federal Communications Commission (FCC) Compliance Notices This section includes the following FCC statements for the Stealth Ultra:

- Non-Modification Statement

- Class B Interference Statement
- RF Radiation Exposure & Hazard Warning

## **FCC Caution**

- Any changes or modifications not expressly approved by the party responsible for compliance could void the user's authority to operate this equipment.
- This transmitter must not be co-located or operating in conjunction with any other antenna or transmitter.

## **Radiation Exposure Statement**

The product is a low power device and its output power is lower than FCC SAR exemption level.

**IMPORTANT NOTE:** In the event that this condition cannot be met (for example certain laptop configurations or co-location with another transmitter), then the FCC authorization is no longer considered valid and the FCC ID cannot be used on the final product. In these circumstances, the OEM integrator will be responsible for re-evaluating the end product (including the transmitter) and obtaining a separate FCC authorization.

## **Federal Communication Commission Interference Statement**

This device complies with Part 15 of the FCC Rules. Operation is subject to the following two conditions: (1) This device may not cause harmful interference, and (2) this device must accept any interference received, including interference that may cause undesired operation..

**Note:** This equipment has been tested and found to comply with the limits for a Class B digital device, pursuant to Part 15 of the FCC Rules. These limits are designed to provide reasonable protection against harmful interference in a residential installation. This equipment generates, uses and can radiate radio frequency energy and, if not installed and used in accordance with the instructions, may cause harmful interference to radio communications. However, there is no guarantee that interference will not occur in a particular installation. If this equipment does cause harmful interference to radio or television reception, which can be determined by turning the equipment off and on, the user is encouraged to try to correct the interference by one of the following measures:

- Reorient or relocate the receiving antenna.
- Increase the separation between the equipment and receiver.
- Connect the equipment into an outlet on a circuit different from that to which the receiver is connected.
- Consult the dealer or an experienced radio/TV technician for help.

## **RF Radiation Exposure & Hazard Statements**

This equipment complies with FCC radiation exposure limits set forth for an uncontrolled environment. End users must follow the specific operating instructions for satisfying RF exposure compliance. This transmitter must not co-located or operating in conjunction with any other antenna or transmitter.

## **RF warning for Portable device**

The device has been evaluated to meet general RF exposure requirement. The device can be used in portable exposure condition without restriction.

## **Non-Modification Statement**

Use only the supplied Internal antenna. Unauthorized antenna's, modifications, or attachments could damage the Stealth Ultra and violate FCC regulations. Any changes or modifications not expressly approved by the party responsible for compliance could void the user's authority to operate this equipment. Please contact Turtle Beach for a list of approved 2.4 GHz antennas.

following ISED statements for Stealth Ultra:

- Class B Interference Statement
- RF Radiation Exposure & Hazard Warning

## **IC: 3879A-VOSTICK**

### **Industry Canada statement**

This device complies with Industry Canada license-exempt RSS standard(s). Operation is subject to the following two conditions:

1. This device may not cause interference, and
2. This device must accept any interference, including interference that may cause undesired operation of the device.

### **RF Radiation Exposure & Hazard Statement**

The product complies with Canada portable RF exposure limits set forth for an uncontrolled environment and are safe for intended operation as described in this manual. The further RF exposure reduction can be achieved if the product can be kept as far as possible from the user body or set the device to lower output power if such function is available.

### **European Union and European Fair Trade Association (EFTA) Regulatory Compliance**

This equipment may be operated in the countries that comprise the member countries of the European Union and the European Fair Trade Association. These countries, listed below, are referred to as The European Community throughout this document: AUSTRIA, BELGIUM, BULGARIA, CYPRUS, CZECH REPUBLIC, DENMARK, ESTONIA, FINLAND, FRANCE, GERMANY, GREECE, HUNGARY, IRELAND, ITALY, LATVIA, LITHUANIA, LUXEMBOURG, MALTA, NETHERLANDS, POLAND, PORTUGAL, ROMANIA, SLOVAKIA, SLOVENIA, SPAIN, SWEDEN, UNITED KINGDOM, ICELAND, LICHTENSTEIN, NORWAY, Switzerland's.



### **Declaration of Conformity**

Marking by this symbol:

declares that this product is in compliance with the essential requirements and other relevant provisions of Directive 2014/53/EU.



### **UKCA Conformity**

Radio Equipment Regulations 2017 (S.I. 2017/1206)

Operating frequency range: 2402-2480MHz

Max power: -0.99dBm

### **This equipment meets the following conformance standards:**

FCC PART15B

FCC47 CFR Part 15:2019TPCH(2021-2)

10 C.F.R. section 430.23(aa); Appendix Y to Subpart B of Part

ENERGY STAR Draft Test Method for Computers, Rev.

October 2019, California Code of Regulations, Title 20, Division 2, Chapter

CPSIA/H.R. 4040 Sec.108, CPSIA/H.R. 4040 Sec.101

EN 55032, EN55035

EN71-1, EN71-2, EN71-3

EN300328, 301489, 62479EN62368

REACH Regulation (EC) No 1907/2006 SVHC 235

Total Cadmium Content (Entry 23 of REACH Annex XVII)

IEC 62321-7-2:2017,

IEC 62321-8:2017,

IEC 62321-4:2013+A1:2017,

IEC62321-6:2015,  
IEC62321-5:2013,  
94/62/EC Toxic Elements in Packaging  
Polycyclic Aromatic Hydrocarbons (PAHs) (Entry 50 of REACH ANNEX XVII)  
BPA (toy < 3 or intended for place in the mouth)  
IC RSS-247 Issue 2 Feb.2017  
Canada IC test for toy with IC (ICES-003)  
NRCAN, Appendix Z to Subpart B of Part 430  
AS/NZS CISPR 32:2015+A1:2020  
BS EN IEC62368-1:2012+A11:2020  
USB 2.0 Full Speed Test  
Bluetooth Certification



■ Please visit the following URL for a complete copy of the Declaration of Conformity:

<http://www.turtlebeach.com/homologation>

This symbol on the product or its packaging indicates that this product must not be disposed of with your other household waste. Instead, it is your responsibility to dispose of your waste equipment by handing it over to a designated collection point for the recycling of waste electrical and electronic equipment. The separate collection and recycling of your waste equipment at the time of disposal will help conserve natural resources and ensure that it is recycled in a manner that protects human health and the environment. For more information about where you can drop off your waste for recycling, please contact your local authority, or where you purchased your product.

Veteran Turtle Beach Inc. is obligated as a producer with a main activity of selling under The Producer Responsibility Obligations (Packaging Waste) Regulations 2007. To fulfil our obligation we are registered with Comply Direct and their Recycling Room. Here you will find advice and information on packaging waste management, recycling symbols and the waste hierarchy principles of reduce, reuse and recycle.

<https://www.complydirect.com/the-recycling-room/>



#### **Attention**

Type-C output port is only used for data transmission, not for output on-load.

#### **Attention**

To avoid risk of fire, please just connect the product to a power supply of which output capability is less than 15W.

#### **Portable device**

Radiation Exposure Statement: The product comply with the Canada portable RF exposure limit set forth for an uncontrolled environment and are safe for intended operation as described in this manual.

The further RF exposure reduction can be achieved if the product can be kept as far as possible from the user body

or set the device to lower output power if such function is available.

## **CUSTOMER SUPPORT**



Any questions?

[www.turtlebeach.com/support](http://www.turtlebeach.com/support)

Please register your product to receive important updates.

[www.turtlebeach.com/productregistration](http://www.turtlebeach.com/productregistration)

For warranty, visit:

[www.turtlebeach.com/warranty](http://www.turtlebeach.com/warranty)

Points de collected sur [www.quefairedemesdechets.fr](http://www.quefairedemesdechets.fr)

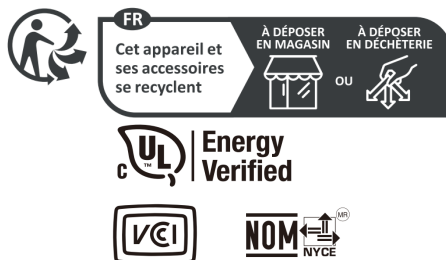

## Documents / Resources

A thumbnail image of a Turtle Beach support page showing a QR code and the text 'TURTLE BEACH'.	<p><a href="#">TURTLE BEACH TBS-0710-05-QSG-E Stealth Ultra Wireless Controller</a> [pdf] User Guide TBS-0710-05-QSG-E Stealth Ultra Wireless Controller, TBS-0710-05-QSG-E, Stealth Ultra Wireless Controller, Ultra Wireless Controller, Wireless Controller, Controller</p>
---	--

## References

- [Turtle Beach Support](#)
- [Turtle Beach Support](#)
- [Turtle Beach Support](#)
- [Turtle Beach Support](#)
- [User Manual](#)

### Manuals+, Privacy Policy

This website is an independent publication and is neither affiliated with nor endorsed by any of the trademark owners. The "Bluetooth®" word mark and logos are registered trademarks owned by Bluetooth SIG, Inc. The "Wi-Fi®" word mark and logos are registered trademarks owned by the Wi-Fi Alliance. Any use of these marks on this website does not imply any affiliation with or endorsement.