



TURTLE BEACH D001 Stealth Ultra Wireless Controller User Guide

[Home](#) » [TURTLE BEACH](#) » TURTLE BEACH D001 Stealth Ultra Wireless Controller User Guide 

Contents

- [1 TURTLE BEACH D001 Stealth Ultra Wireless Controller](#)
- [2 PRODUCT COMPATIBILITY](#)
- [3 PACKAGE CONTENTS & PRODUCT TOUR](#)
- [4 COMMAND DISPLAY DASHBOARD](#)
- [5 Documents / Resources](#)
 - [5.1 References](#)



TURTLE BEACH D001 Stealth Ultra Wireless Controller



Title/Topic: Support Guide
Product: Stealth Ultra
Date Issued: May 31, 2024

By Turtle Beach Technical Support

Find the most up-to-date articles, downloads, and troubleshooting online, accessible 24/7, at <https://support.turtlebeach.com/>

Need further assistance?

Get in touch with our Tech Support team: <https://www.turtlebeach.com/contactsupport>

IMPORTANT

PLEASE MAKE SURE YOUR HEADSET IS UPDATED WITH THE LATEST FIRMWARE

Download the Swarm II app to update your headset to the latest firmware and to customize settings. Available for Android, iOS, and Windows.

PRODUCT COMPATIBILITY

- Xbox Series X|S & Xbox One
- Windows 10/11
- Android Smart Device

PACKAGE CONTENTS & PRODUCT TOUR

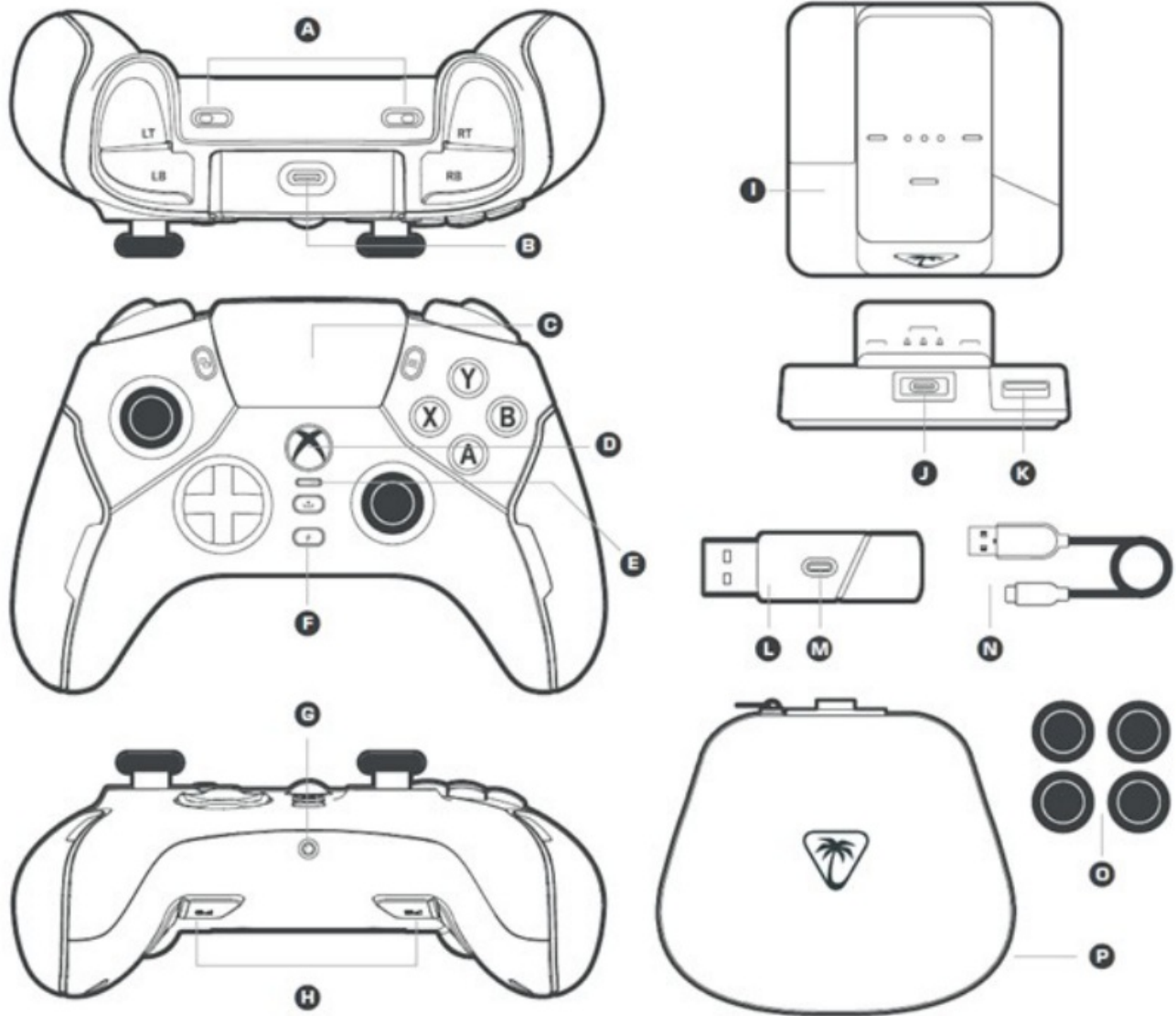

1. Adjustable Trigger Locks
2. USB Cable Port
3. Command Display
4. Guide Button
 1. Press 2s – Power On
 2. Press 6s – Power Off
5. Connection LED
6. Input Focus Button
7. Headset Port
8. Mappable Action Buttons
9. Rapid Charge Dock
10. USB-C Cable Port
11. Transmitter USB Port
12. Wireless Transmitter
13. Transmitter Connection LED and Pairing Button
14. 10'/3m USB-A to USB-C Cable
15. Thumbstick Grip Caps
16. Carry Case

SETUP FOR XBOX

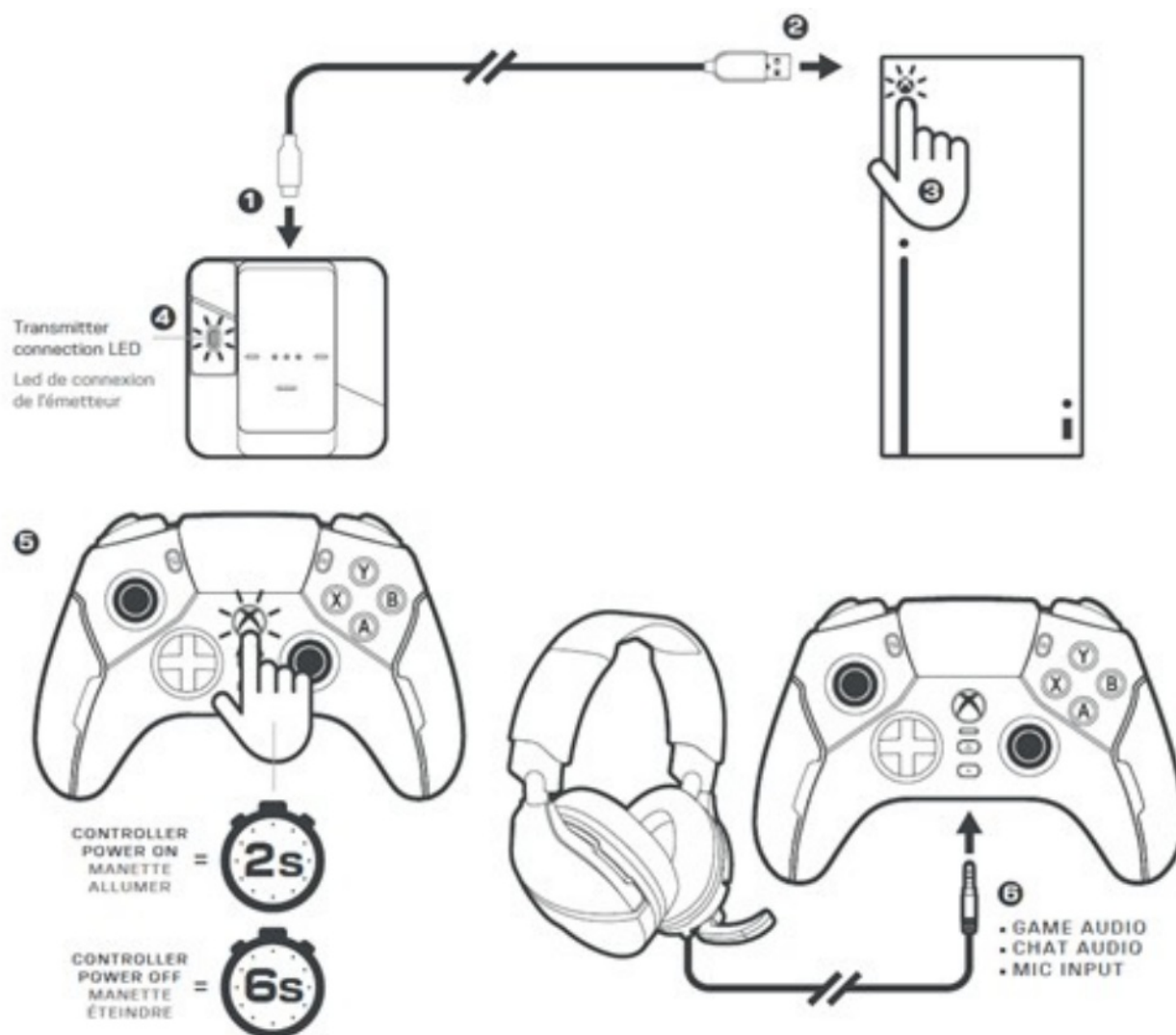

1. Plug the USB-C end of the cable into the Charge Dock.
2. Plug the USB-A end of that cable into the Xbox console.
3. Press the Power button on the Xbox console; the Xbox's LED will illuminate white.
4. Make sure the transmitter is plugged securely into the Charge Dock.
5. Press the controller's Guide button (Xbox logo button) for two seconds to power the Stealth Ultra controller. Pairing will start automatically. First, the LEDs on the controller and the transmitter will flash, indicating the controller and transmitter are searching for each other. Then the LED on the transmitter and headset will light up solid to indicate a successful pairing. (If the controller and transmitter aren't pairing, click here: [Stealth Ultra Pairing Instructions](#).)
6. If you are using a wired headset with the Stealth Ultra, plug the headset into the headset jack on the controller, and then adjust the Game Audio, Chat Audio, and Mic Input Levels within the controller's Command Display (see "COMMAND DISPLAY DASHBOARD" below).

SETUP FOR PC

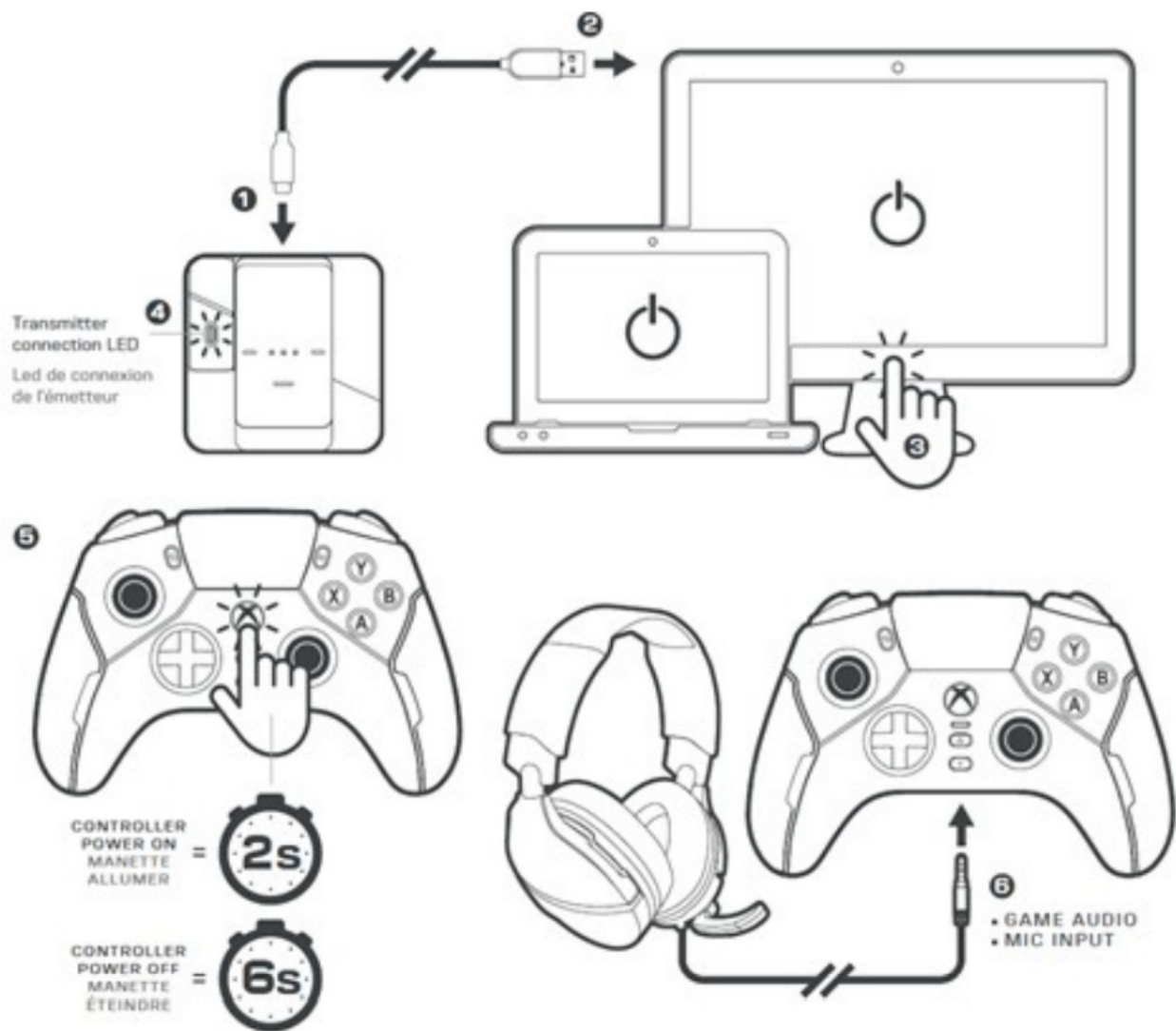

1. Plug the USB-C end of the cable into the Charge Dock.
2. Plug the USB-A end of that cable into the computer.
3. Make sure the computer is powered on.
4. Make sure the transmitter is plugged securely into the Charge Dock.
5. Press the controller's Guide button (Xbox logo button) for two seconds to power the Stealth Ultra controller. Pairing will start automatically. First, the LEDs on the controller and the transmitter will flash, indicating the controller and transmitter are searching for each other. Then the LED on the transmitter and headset will light up solid to indicate a successful pairing. (If the controller and transmitter aren't pairing, click here: [Stealth Ultra Pairing Instructions](#).)
6. If you are using a wired headset with the Stealth Ultra, plug the headset into the headset jack on the controller, and then adjust the Game Audio, Chat Audio, and Mic Input Levels within the controller's Command Display (see "COMMAND DISPLAY DASHBOARD" below).

COMMAND DISPLAY MAIN MENU

Make in-depth adjustments via the Main Menu on your Stealth Ultra controller.

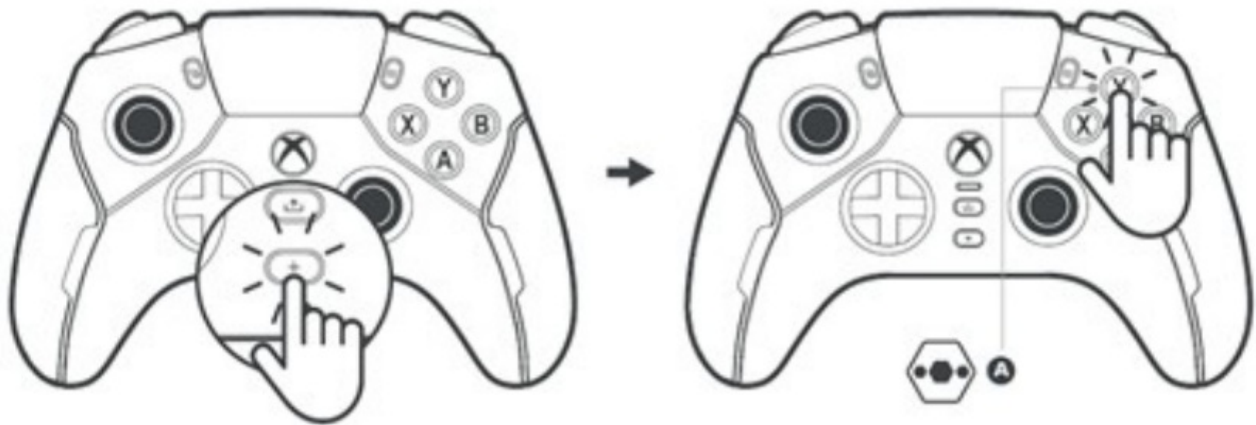

1. Press the + button on your controller to switch Focus to the Command Display, and then press the Y button to access the main menu.
 - A. Open Main Menu
 - B. Previous Menu Item
 - C. Next Menu Item
 - D. Adjust Feature
 - E. Back/Cancel
 - F. Select/Accept
2. Press the + button again to return focus to the game.

COMMAND DISPLAY DASHBOARD

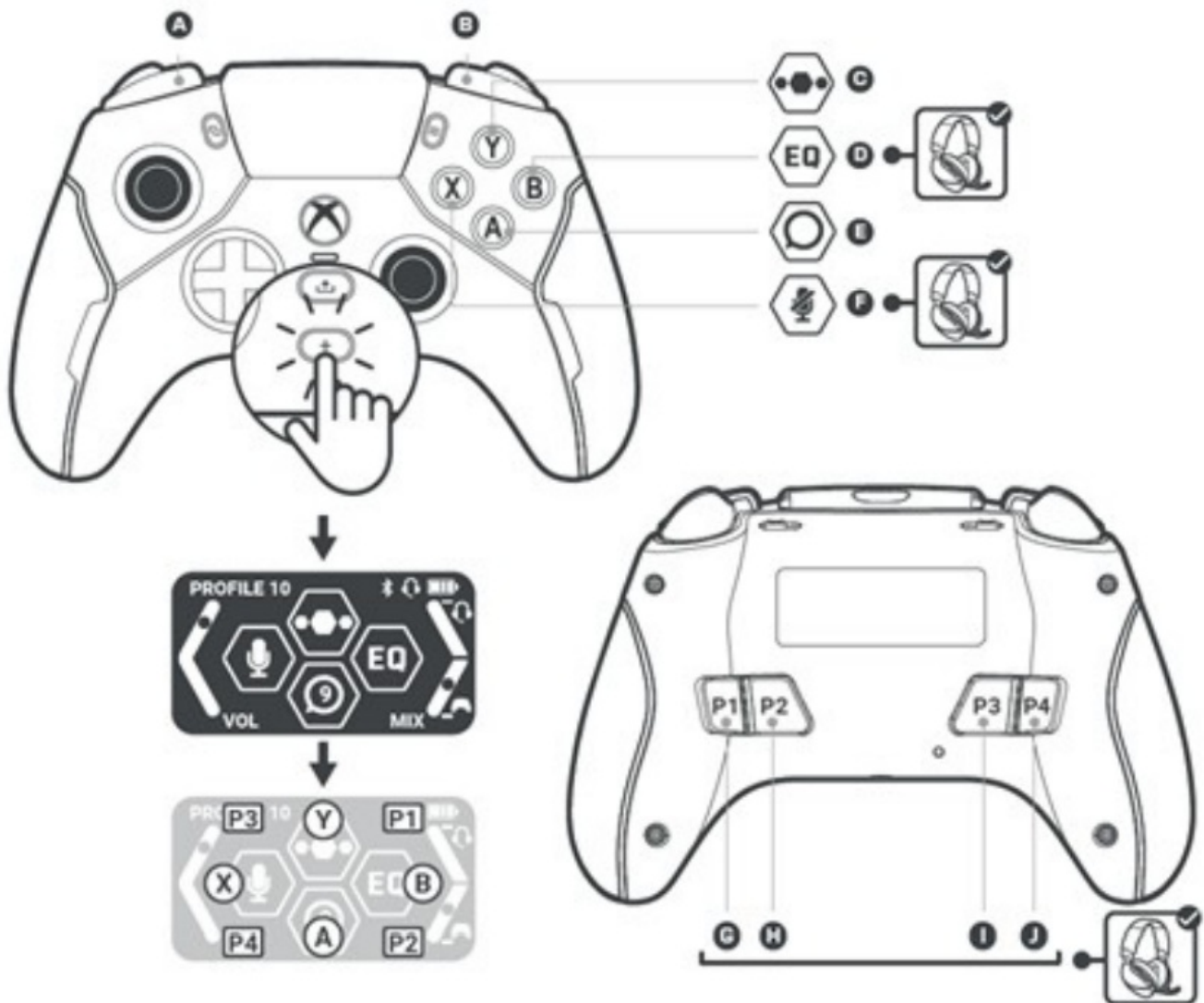

Make quick adjustments via the Dashboard.

1. Press the + button on your controller to switch Focus to the Command Display.

- A. Profile –
- B. Profile +
- C. Open Main Menu
- D. EQ Cycle
- E. Social Feed
- F. Mic Mute
- G. Chat Mix +
- H. Chat Mix –
- I. Volume +
- J. Volume –

2. Press the + button again to return focus to the game.

CONTROL CENTER 2

ON XBOX/PC

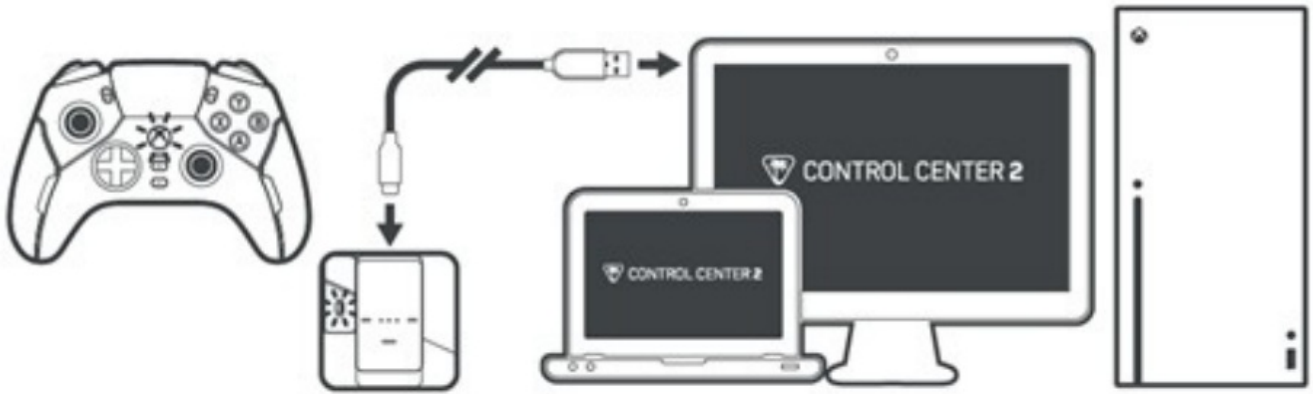

Search for Stealth Ultra and Control Center 2 app on the Microsoft Store, Play Store, and App Store. Keep your controller up to date and customize performance settings on Xbox and Windows. Tune onboard memory profiles and configure social notifications on Android and iOS.

ON XBOX/PC

1. Connect the USB-C to USB-A cable to the charging dock and a computer or Xbox.



2. Power the controller on.
3. Open the Control Center 2 app.

ON MOBILE

1. Initiate App Link Pairing from the Command Display main menu.
2. Pair to your mobile smart device.
3. Launch the Control Center 2 app on that device.

CHARGING

When the battery level is low, the controller LEDs will flash red.

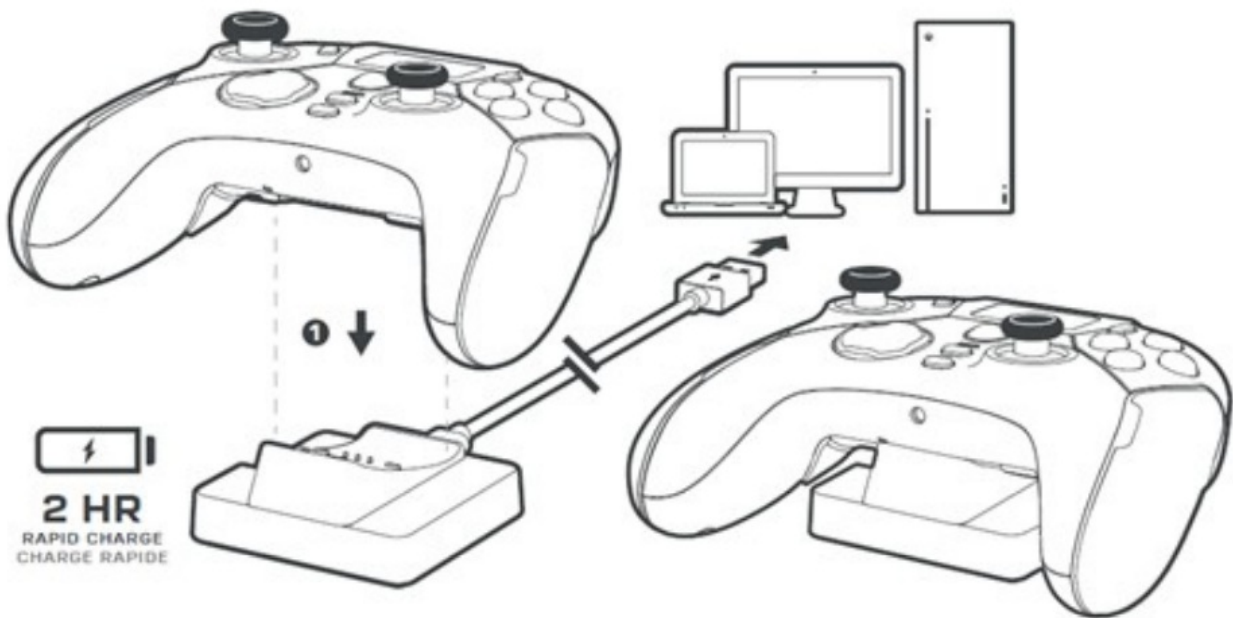

CHARGE VIA DOCK

Place the controller in the Charge Dock, making sure the controller is properly seated in the dock itself. The controller LEDs will turn green when the controller is fully charged.

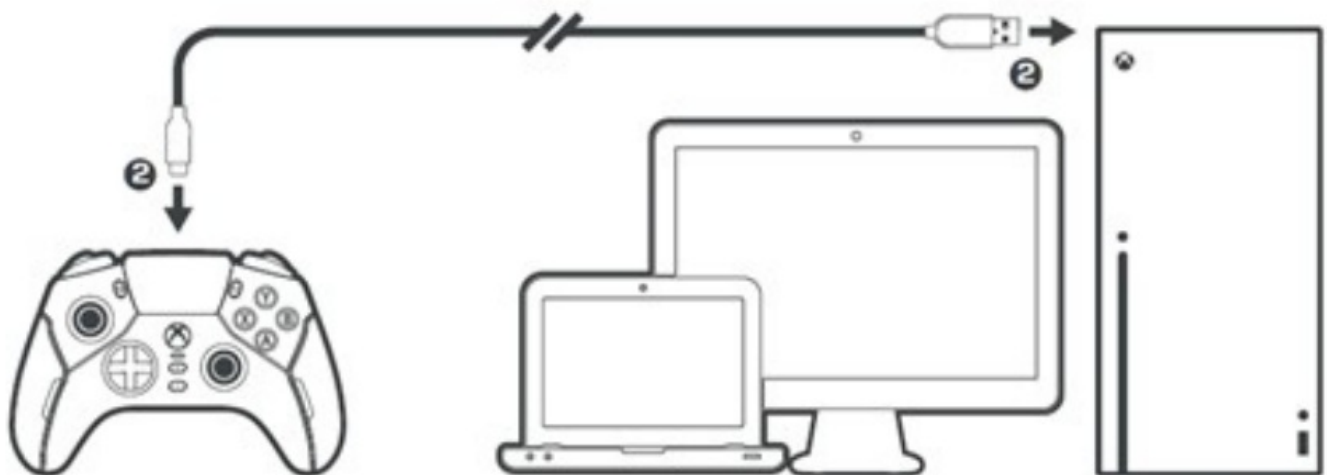

PLAY & CHARGE

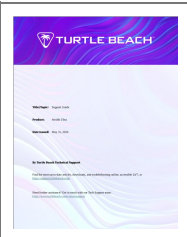

Plug the controller into the Xbox console or computer with the included USB-C to USB-A cable. In this mode, the controller will function as a wired device.

Documents / Resources

	<p>TURTLE BEACH D001 Stealth Ultra Wireless Controller [pdf] User Guide D001 Stealth Ultra Wireless Controller, D001, Stealth Ultra Wireless Controller, Ultra Wireless C ontroller, Wireless Controller</p>
---	--

References

- [Turtle Beach Support](#)

-  [Turtle Beach Support](#)
-  [Turtle Beach Support](#)
-  [Turtle Beach Support](#)
- [User Manual](#)

[Manuals+](#), [Privacy Policy](#)

This website is an independent publication and is neither affiliated with nor endorsed by any of the trademark owners. The "Bluetooth®" word mark and logos are registered trademarks owned by Bluetooth SIG, Inc. The "Wi-Fi®" word mark and logos are registered trademarks owned by the Wi-Fi Alliance. Any use of these marks on this website does not imply any affiliation with or endorsement.