



TurboTronic TT-48DSB Touchless Sensor Dustbin Instruction Manual

[Home](#) » [TurboTronic](#) » TurboTronic TT-48DSB Touchless Sensor Dustbin Instruction Manual 

TurboTronic TT-48DSB Touchless Sensor Dustbin



Contents

- [1 INTRODUCTIONS](#)
- [2 IMPORTANT SAFEGUARDS](#)
- [3 INSTRUCTIONS](#)
- [4 INDICATOR LIGHT \(LED LIGHT\)](#)
- [5 PARTS DESCRIPTION](#)
- [6 HOW THE SMART RETAINER RING WORKS](#)
- [7 HOW TO USE THE ACTIVATED CARBON DEODORIZER](#)
- [8 DISPOSAL OF OLD ELECTRICAL APPLIANCES](#)
- [9 LIMITED WARRANTY](#)
- [10 Documents / Resources](#)
 - [10.1 References](#)
- [11 Related Posts](#)

INTRODUCTIONS

Thank you for choosing iBIN touchless sensor dustbins by TurboTronic®



This automatic opening dustbin based on infrared technology removes this need. The touchless sensor operation promotes a germ-free environment. The Activated Carbon deodorizer neutralizes odors. The lid sensor uses invisible and harmless, patented infrared technology for accurate and responsive lid open and close operation. There are two buttons on the front of the lid, "OPEN" and "CLOSE", to open and close the lid manually, and an ON/OFF power switch on the back of the trash can lid. The infrared sensor on the lid will automatically open the lid when your hand or object is within 10 cm of the sensor. The lid will remain open if the sensor detects any object within its radius and will automatically close in 6 seconds after the object is withdrawn. The automatically opening and closing control system consists of computer chips, infrared detecting device, mechanical transmitting device and electrical drive system. It is a High-Performance device, which is low in energy consumption and will give a long service-life.

IMPORTANT SAFEGUARDS

HOUSEHOLD USE ONLY. READ ALL INSTRUCTIONS.





When using electrical appliance, basic safety precautions should always be followed, including the following: Read this user manual carefully, before you use the appliance, and keep it safely for future reference



WARNINGS

- Use this appliance only for its intended purpose as described in this manual.
- Do not immerse the Lid Cover in water because it is equipped with electronic components. You can clean it with a damp cloth.
- To prevent battery leak that potentially causes damage to the electronic components, remove batteries if the unit is not intended to be used for a long time.

- Avoid direct sunlight onto the infrared Sensor Ball.
- Do not use solvents or other chemicals to clean.
- Only use TurboTronic® power adapter with an output of 5.9V/500mA.
- Ensure the Sensor Ball is kept clean for normal function.
- Do not mix old and new batteries. Do not mix alkaline, standard (carbon-zinc), or rechargeable (ni cad, ni-mh, etc) batteries.
- Clean the trash can body only with products safe for use on stainless steel.
- Do not press or force the Lid Cover to close. Lid will close automatically after your hand is removed from the sensor zone.
- Replace batteries immediately when the indication light turns yellow/amber. This will ensure the lid continues to operate properly.
- Ensure there is enough room to operate the trash can without blocking the opening and closing of the lid.
- Do not use a power adapter that is not authorized by TurboTronic® , it may result in fire, electric shock or injury.
- Do not use power adapter and battery at the same time to operate the trash can. It can only be powered by one source at a time.
- Do not overstuff trash bag. It may cause tearing or difficulty removing.
- Automatic parts may not be suitable for small children or pets

	Indicates to read and review instructions to understand operation and use of product.
	Indicates the presence of a hazard that can cause personal injury, death or substantial property damage if the warning included with this symbol is ignored.
	Take care to avoid contact with hot surface. Always use hand protection to avoid burns.
	For indoor and household use only

SAVE THESE INSTRUCTIONS

INSTRUCTIONS

1. . Open the battery compartment under the lid of the bin and insert four “C” type ALKALINE batteries.
2. Turn on the power switch located at the back of the lid. The red indicator light will stay on for 3 seconds, and then flash once every three seconds to show it is in working order.
3. When you need to open the bin hold your hand about 10cm above the infrared panel. The lid will then open

automatically within 0.5 seconds, and close again automatically within 6 seconds of moving your hand away. If you do not move your hand away the lid will stay open.

4. If you touch the open button on the infrared panel (a button for manual operation), the lid will open and stay open without closing automatically. This manual function is for use when you need to frequently throw rubbish away, remove the rubbish bag or clean the bin. If you want to close the lid again simply touch the close button and the circuit system will return to automatic operation.
5. **A)** The indicator light in the normal waiting state flashes red (once every three seconds)
B) When the lid opens automatically, the indicator light shows six red lights.
C) After the lid closes automatically, the indicator light will be extinguished.
D) While the lid is opened by hand, the indicator light shows six red lights. They won't be extinguished until you touch the close button.
6. The batteries will last for an average of 6 months on the basis the bin is opened or closed 20 times each day. When the batteries are nearly flat, the indicator light will flash yellow (once every three seconds).

INDICATOR LIGHT (LED LIGHT)

1. In stand-by mode, the indicator light flashes red once every 3 seconds.
2. When the lid is opened using the "Open" button, the indicator light flashes green once every 3 seconds.
3. When the batteries are nearly depleted, the indicator light flashes yellow/amber once every 3 seconds

PARTS DESCRIPTION

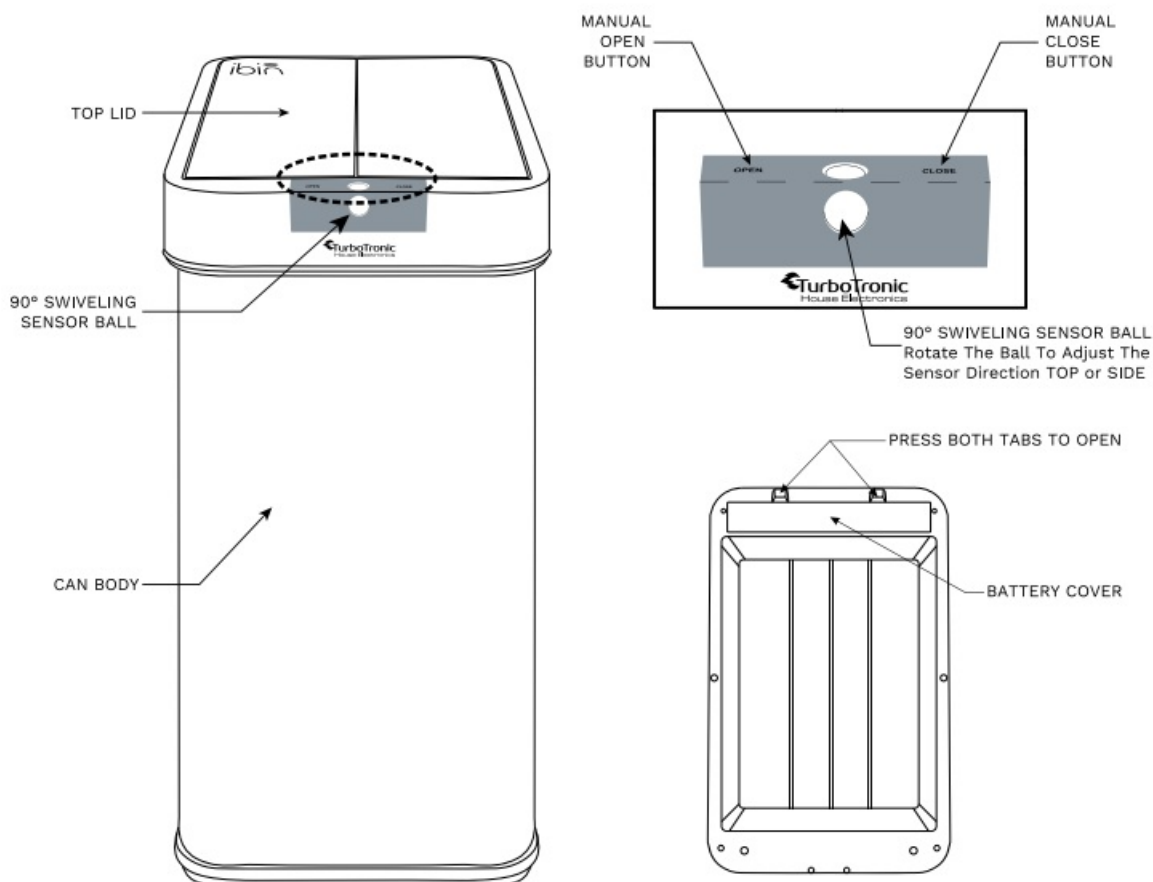

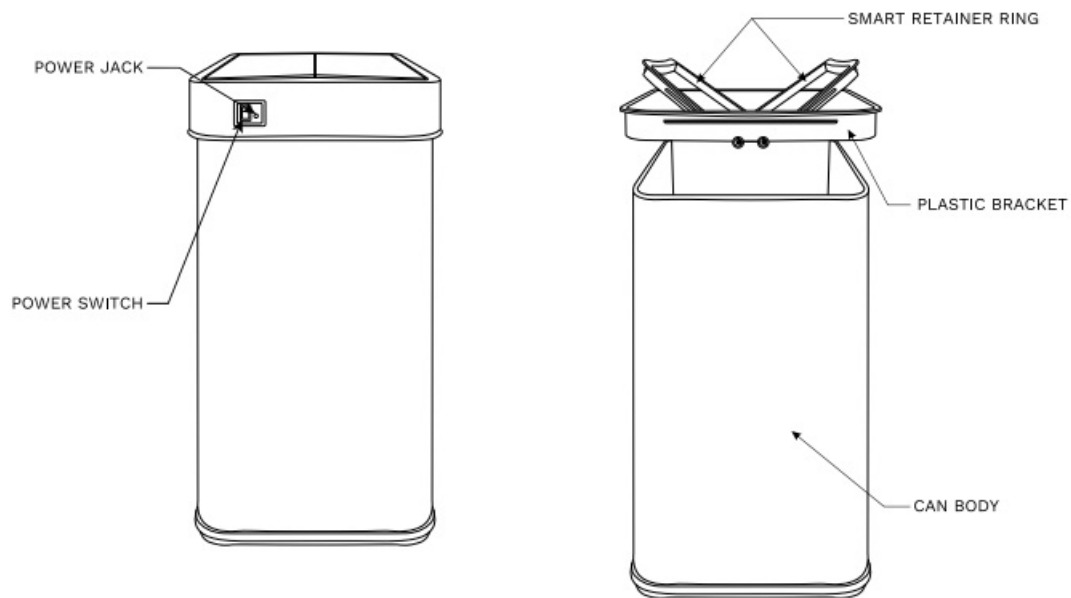

HOW THE SMART RETAINER RING WORKS

STEP 1: Place the garbage bag inside the can body, then wrap the top of the bag over the top.

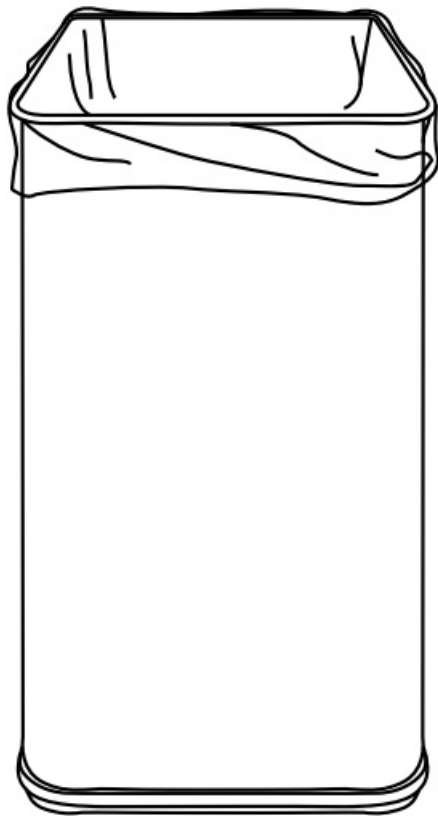

STEP 2: Place the plastic bracket on the top of the can body. The surplus will be folded up inside the can.

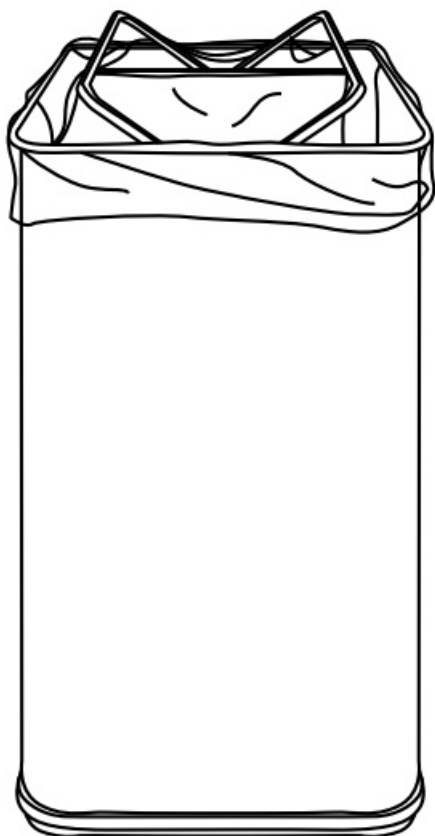

STEP 3: Pull up the smart ring and fix the bag on both sides.

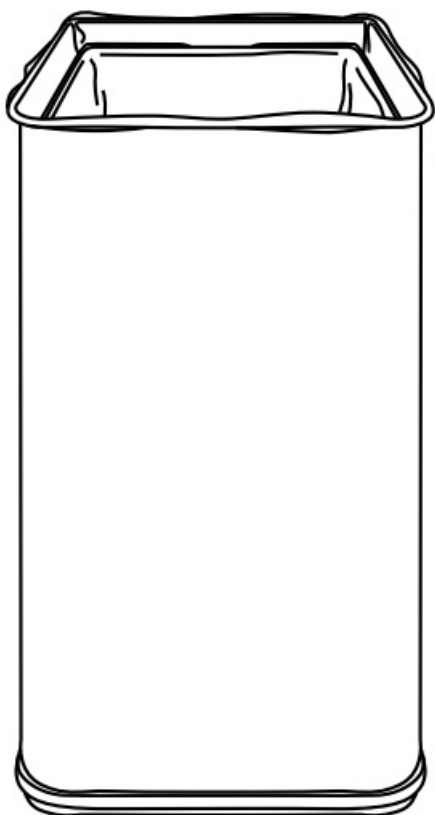

ATTENTION

1. If you want the front sensor panel, please turn the ball with the flow mark into the front.

2. If you want the top sensor panel, please turn the ball with the flow mark into the top.
3. To clean simply wipe with a damp cloth, but do not wash the outside of the dustbin, as it is equipped with many electronic components.
4. Do not press the lid of the dustbin when it is opening.
5. Remove batteries once flat to avoid seeping liquid damaging the electronic components.
6. Avoid direct sunlight to the infrared panel.



1. Purple ball with flow mark, you can turn it into top or front. If you turn it into the top, the sensor window will be on the top. If you turn it into the front, the sensor window will be in the front.
2. When you need to open the bin hold your hand about 10cm above the infrared panel. The lid will then open automatically within 0.5 seconds, and close again automatically within 6 seconds of moving your hand away. If you do not move your hand away the lid will stay open.
3. If you touch the open button on the infrared panel (a button for manual operation), the lid will open and stay open without closing automatically. This manual function is for use when you need to frequently throw rubbish away, remove the rubbish bag or clean the bin. If you want to close the lid again simply touch the close button and the circuit system will return to automatic operation.
4. When the lid opens automatically, the indicator light shows six red lights.
 - a. After the lid closes automatically, the indicator light will be extinguished.
 - b. While the lid is opened by hand, the indicator light shows six red lights. They won't be extinguished until you touch the close button.

HOW TO USE THE ACTIVATED CARBON DEODORIZER

The new Touchless Trash Can is equipped with a Deodorizer Compartment that houses the odor-neutralizing Activated Carbon Deodorizer. One (1) replaceable Activated Carbon Deodorizer is preinstalled inside the Deodorizer Compartment. Please follow

these instructions to maximize the Activated Carbon Deodorizer's effectiveness.



Fig. 1

these instructions to maximize the Activated Carbon Deodorizer's effectiveness.

1. Turn power switch to "Off" mode. Remove and turn Lid Cover upside down.
2. Slide Deodorizer Compartment (Fig.1) to the right (Fig.2) to remove.
3. Remove Activated Carbon Deodorizer from the Compartment.
4. Remove new Activated Carbon Deodorizer pouch from plastic bag (Do NOT cut open the Deodorizer pouch).



Fig. 2

5. Insert new Deodorizer pouch (Fig.3) into the Compartment
6. Return the Deodorizer Compartment to Lid Cover (Fig.1) and slide to the left (Fig.2) to lock the Deodorizer

Compartment in position.

7. Replace Activated Carbon Deodorizer every 3 months or when odor becomes too strong.

Cleaning Tips:



Fig. 3

- Deodorizer Compartment can be washed with soap and warm water (not intended for dishwasher cleaning).
- Used Deodorizer pouch should be disposed in a trash can

DISPOSAL OF OLD ELECTRICAL APPLIANCES



■ The European directive 2002/96/EC on Waste Electrical and Electronic Equipment (WEEE), requires that old household electrical appliances must not be disposed of in the normal unsorted municipal waste stream. Old appliances must be collected separately in order to optimize the recovery and recycling of the materials they contain, and reduce the impact on human health and the environment. The crossed out “wheeled bin” symbol on the product reminds you of your obligation, that when you dispose of the appliance, it must be separately collected. Consumers should contact their local authority or retailer for information concerning the correct disposal of their old appliance.

LIMITED WARRANTY

Limited Warranty applies to purchases made from authorized retailers of TurboTronic®.

TurboTronic® Warranty coverage applies to the original owner and to the original product only and is not transferable.

TurboTronic® warrants that the unit shall be free from defects in material and workmanship. Limited Warranty apply only when it is used under normal household conditions and maintained according to the requirements outlined in the Owner’s Guide, subject to the following conditions and exclusions:

What is covered by this warranty?

1. The original unit and/or non-wearable parts deemed defective, in TurboTronic® sole discretion, will be repaired or replaced
2. TurboTronic® reserves the right to replace the unit with one of equal or greater value

What is not covered by this warranty?

1. Normal wear and tear of wearable parts (such as blending vessels, lids, cups, blades, blender bases, removable pots, racks, pans, etc.), which require regular maintenance and/or replacement to ensure the proper functioning of your unit, are not covered by this warranty.
2. Any unit that has been tampered with or used for commercial purposes.
3. Damage caused by misuse, abuse, negligent handling, failure to perform required maintenance (e.g., failure to keep the well of the motor base clear of food spills and other debris), or damage due to mishandling in transit.
4. Consequential and incidental damages.
5. Defects caused by repair persons not authorized by TurboTronic®. These defects include damages caused in the process of shipping, altering, or repairing the TurboTronic® product (or any of its parts) when the repair is performed by a repair person not authorized by TurboTronic®.
6. Products purchased, used, or operated outside Europe. Illustrations may differ from actual product.

We are constantly striving to improve our products, therefore the specifications contained herein are subject to change without notice.

TurboTronic® and Z-Line® are registered trademarks of Z-GLOBAL B.V.B.A®. PRINTED IN PRC



Documents / Resources

 The image shows the cover of the TurboTronic iBin instruction manual. It features the TurboTronic logo at the top, followed by 'iBin' in a large, stylized font. Below that, it says 'INSTRUCTION MANUAL' and shows a small image of the iBin unit. At the bottom, there are some technical specifications and the website 'www.turbotronic.com'.	<p>TurboTronic TT-48DSB Touchless Sensor Dustbin [pdf] Instruction Manual TT-48DSB, TT-58DSB, TT-68DSB, TT-48ESB, TT-58ESB, TT-68ESB, TT-48DSB Touchless Sensor Dustbin, Touchless Sensor Dustbin, Sensor Dustbin, Dustbin</p>
---	--

References

-  [ZLine-World | TurboTronic](#)