



**202308 Smart Lock  
Management  
Software**



# TTLock 202308 Smart Lock Management Software User Manual

[Home](#) » [TTLock](#) » TTLock 202308 Smart Lock Management Software User Manual 

## Contents

- [1 TTLock 202308 Smart Lock Management Software](#)
- [2 Product Usage Instructions](#)
- [3 Frequently Asked Questions](#)
- [4 Introduction](#)
- [5 Download](#)
- [6 Registration and login](#)
- [7 Lock management](#)
- [8 Customer service](#)
- [9 Settings](#)
- [10 Overview of key features](#)
- [11 FCC Warning Statement](#)
- [12 Documents / Resources](#)
  - [12.1 References](#)
- [13 Related Posts](#)



**TTLock 202308 Smart Lock Management Software**



### Product Specifications:

- Product Name: TTLOCK
- App Version: VER.202308
- Developer: Hangzhou Sciener Intelligent Control Technology Co., Ltd.
- Supported Devices: Door locks, parking locks, safe locks, bicycle locks, etc.
- Communication: Bluetooth BLE
- Languages Supported: Chinese, Traditional Chinese, English, Spanish, Portuguese, Russian, French, Malay

### Product Usage Instructions

#### Download the App:

You can download the iOS version from the App Store and the Android version from Google Play or other platforms mentioned in the manual.

#### Registration and Login:

##### Register:

Users can register using their mobile phone number or email. A verification code will be sent for registration

completion.

### **Security Question Settings:**

Set up security questions during registration to enhance account security.

### **Lock Management:**

#### **Lock Adding:**

Add locks to the app for management and control.

#### **Settings:**

Configure various settings related to sound, touch to unlock, notification push, languages, screen lock, and more.

#### **Work With:**

Explore features like key management, passcodes, fingerprints, QR code unlocking, remote access, records, and more for comprehensive lock usage.

## **Frequently Asked Questions**

- **Q: Where can I find the download links for the TTLOCK App?**
  - A: The iOS version is available on the App Store and the Android version can be found on Google Play or other specified platforms in the manual.
- **Q: How can I register with the TTLOCK App?**
  - A: Users can register using their mobile phone number or email. A verification code will be sent for account verification.

Please read the manual carefully before installation and keep this manual at a secure place.

- Please refer to sales agents and professionals for information not included in this manual.

## **Introduction**

The App is a smart lock management software developed by Hangzhou Sciener Intelligent Control Technology Co., Ltd. It includes door locks, parking locks, safe locks, bicycle locks, and more. The App communicates with the lock via Bluetooth BLE, and can unlock, lock, firmware upgrade, read operation records, etc. The Bluetooth key can also open the door lock through the watch. The app supports Chinese, Traditional Chinese, English, Spanish, Portuguese, Russian, French, and Malay.



## Download

### APP

The iOS version can be found in the App Store and the Android version can be found in Google Play, App Store, Baidu, Alibaba, 360, Huawei and Xiaomi.



Scan to download The App

### Web

The web side can be logged in to <https://lock.sciener.com/> for management, it is recommended to use Google Chrome.

### Computer

Download [http://download.ttlock.com/appDownload/ttlock/TTLock\\_Card\\_Encoder\\_setup\\_1.2.0.exe](http://download.ttlock.com/appDownload/ttlock/TTLock_Card_Encoder_setup_1.2.0.exe)

## Registration and login

### Register

Users can register the account by mobile phone and Email which currently support 200 countries and regions on the world. The verification code will be sent to user's mobile phone or email, and the registration will be successful

after the verification. When you send an ekey to a phone number or email, and this phone number or email hasn't been registered yet, they will be registered automatically.

#### Phone

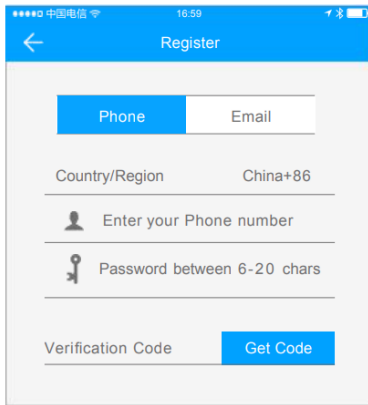

Register

Phone Email

Country/Region China+86

Enter your Phone number

Password between 6-20 chars

Verification Code [Get Code](#)

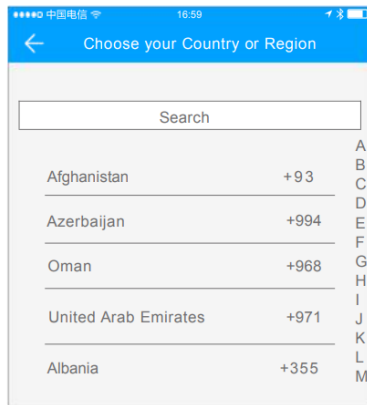

Choose your Country or Region

Search

Afghanistan	+93
Azerbaijan	+994
Oman	+968
United Arab Emirates	+971
Albania	+355

A B C D E F G H I J K L M

#### Email

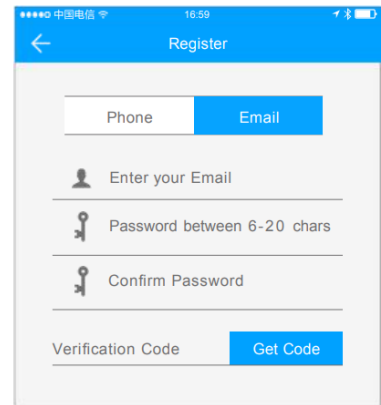

Register

Phone Email

Enter your Email

Password between 6-20 chars

Confirm Password

Verification Code [Get Code](#)

## Security question settings

You will be taken to the security question settings page when registration is successful. When log in on a new device, the user can authenticate himself by answering the above questions.

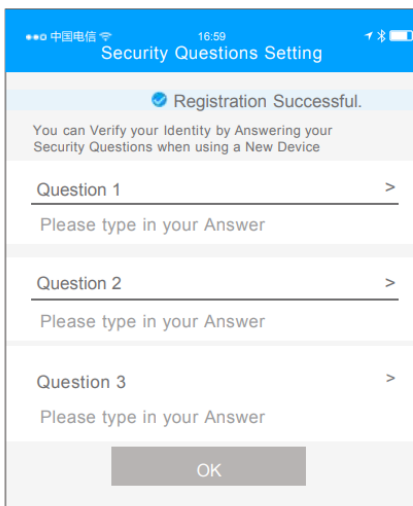

Security Questions Setting

Registration Successful.

You can Verify your Identity by Answering your Security Questions when using a New Device

Question 1 >

Please type in your Answer

Question 2 >

Please type in your Answer

Question 3 >

Please type in your Answer

OK

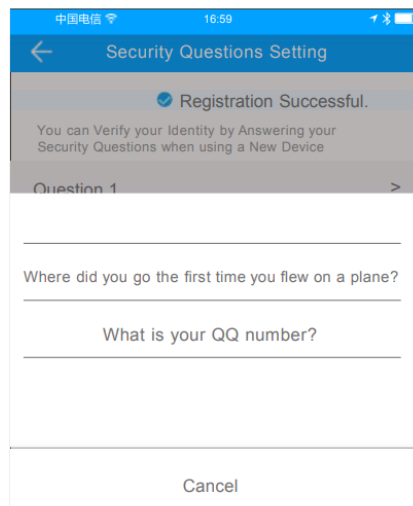

Security Questions Setting

Registration Successful.

You can Verify your Identity by Answering your Security Questions when using a New Device

Question 1 >

Where did you go the first time you flew on a plane?

What is your QQ number?

Cancel

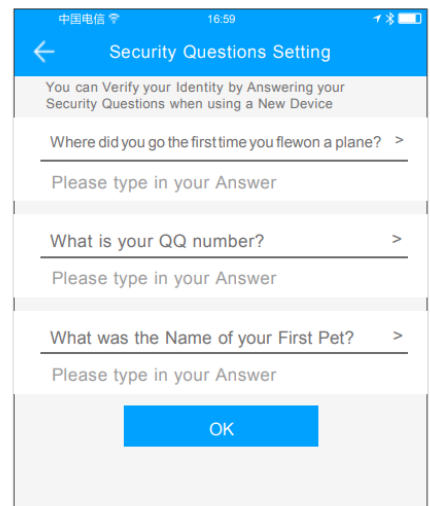

Security Questions Setting

You can Verify your Identity by Answering your Security Questions when using a New Device

Where did you go the first time you flew on a plane? >

Please type in your Answer

What is your QQ number? >

Please type in your Answer

What was the Name of your First Pet? >

Please type in your Answer

OK

## Login authentication

Log in with your mobile phone number or email account on the login page. The mobile phone number is automatically recognized by the system and does not input the country code. If you have forgotten your password, you can go to the password page to reset your password. When reset the password, you can receive a verification code from your mobile phone and email address. When the account is logged in on the new mobile phone, it needs to be verified. When it is passed, you can log in on the new mobile phone. All the data can be viewed and used on the new mobile phone

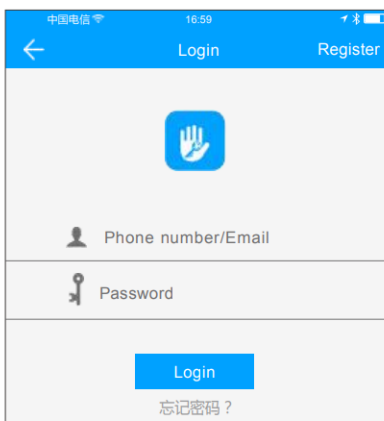

Login Register

Phone number/Email

Password

Login

忘记密码?

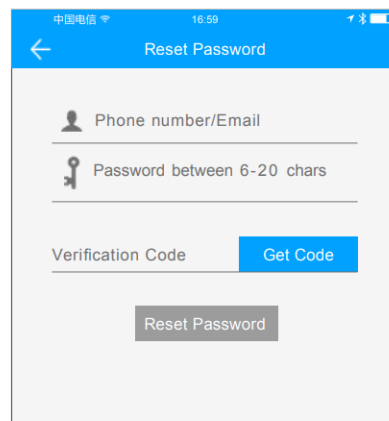

Reset Password

Phone number/Email

Password between 6-20 chars

Verification Code [Get Code](#)

Reset Password

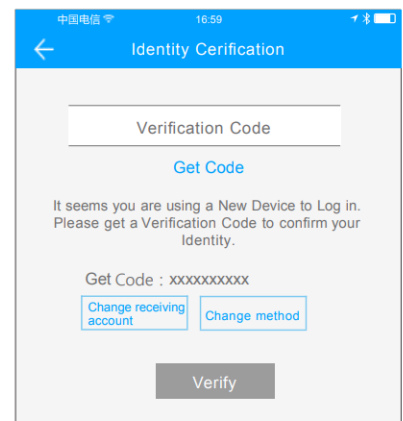

Identity Certification

Verification Code

[Get Code](#)

It seems you are using a New Device to Log in. Please get a Verification Code to confirm your Identity.

Get Code : xxxxxxxxxx

[Change receiving account](#) [Change method](#)

Verify

## Ways of identifying

There are two ways of security verification. One is the way to get the verification code via the account number, and the other is the way to answer the question. If the current account is set the “answer the question” verification, then when the new device is logged in, there will be an “answer question verification” option

### Verify with verification code ▼

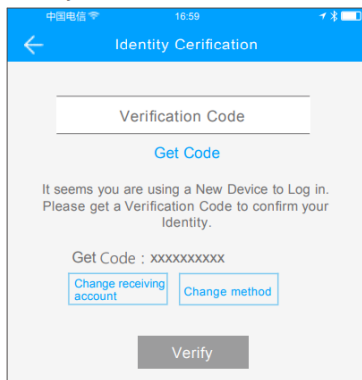

Identity Certification

Verification Code

[Get Code](#)

It seems you are using a New Device to Log in.  
Please get a Verification Code to confirm your Identity.

Get Code : xxxxxxxxxx

[Change receiving account](#) [Change method](#)

[Verify](#)

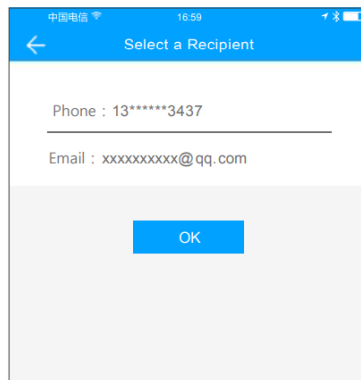

Select a Recipient

Phone : 13\*\*\*\*\*3437

Email : xxxxxxxxxx@qq.com

[OK](#)

### Verify by answering questions ▼

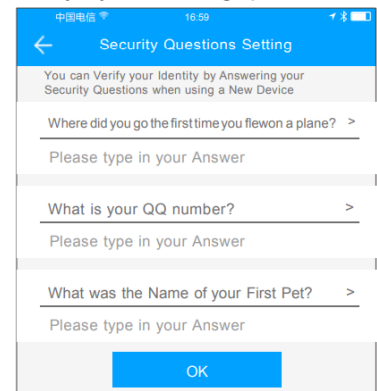

Security Questions Setting

You can Verify your Identity by Answering your Security Questions when using a New Device

Where did you go the first time you flew on a plane? >

Please type in your Answer

What is your QQ number? >

Please type in your Answer

What was the Name of your First Pet? >

Please type in your Answer

[OK](#)

## Lock management

The App supports multiple types of lock, including door locks, padlocks, safe locks, smart lock cylinders, parking locks, and bicycle locks. When adding a device, you must firstly select the lock type. The lock needs to be added to the app after entering the setting mode. A lock that has not been added will enter the setting mode as long as the lock keyboard is touched. The lock that has been added needs to be deleted on the App first. The added lock will be shown in the lock list, together with lock name and battery level. To add a lock, please wake it up first by touching the keypad, or swiping card. If the lock has been woken up but still not in setting mode, it may have been added by others yet. Please reset it first then try again.

### Lock adding

1. Call out menu interface in the upper left corner of the interface;
2. Select Add Lock;
3. Select the corresponding type of door lock to add it according to the prompt;
4. The door lock name has a “+” sign in black to indicate that it can be added.

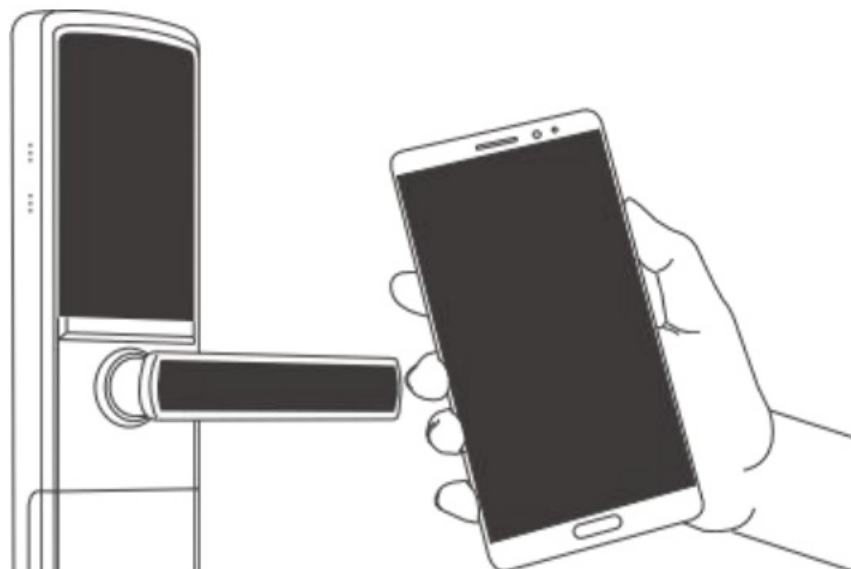

Note: Before adding, please make sure that your mobile phone's Bluetooth is turned on and the network is turned

on, if the network signal is not good, please add an environment with a strong signal and upload data according to the prompts. Locks that have already been added to the administrator cannot be added, so please remove the administrator or reset the lock after the lock is reset.

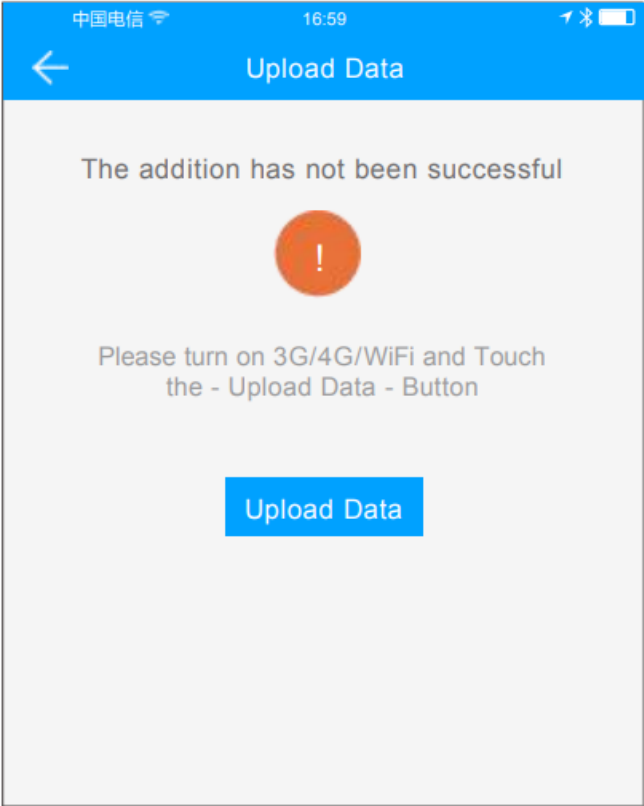
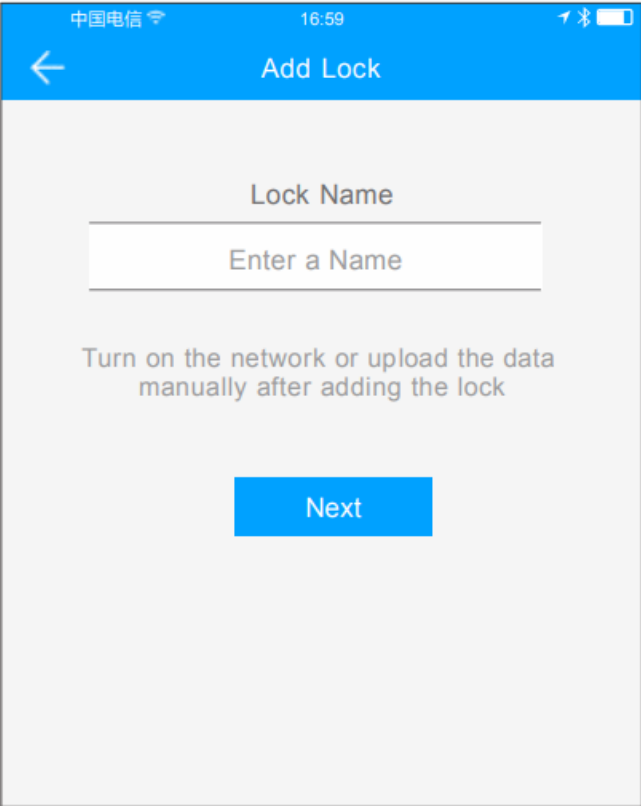
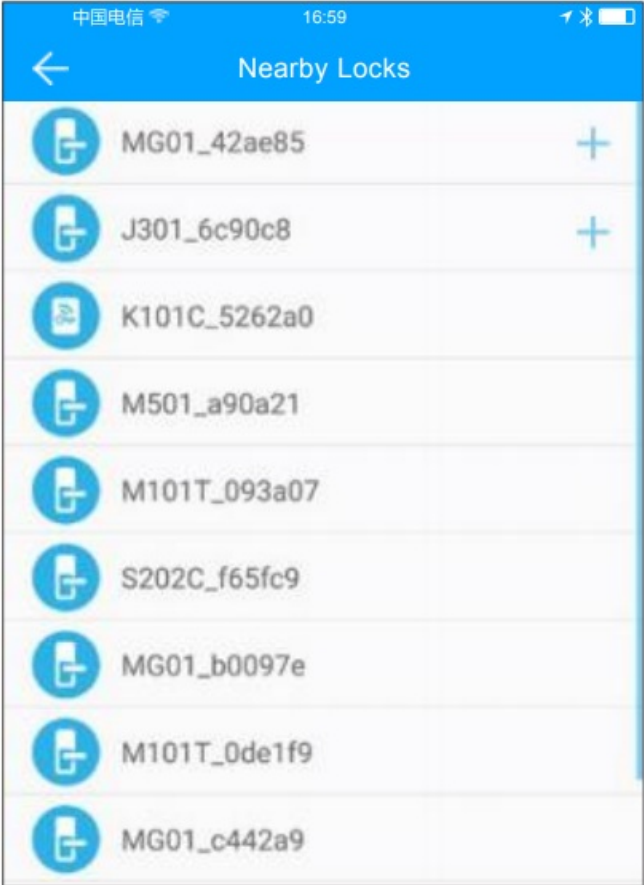
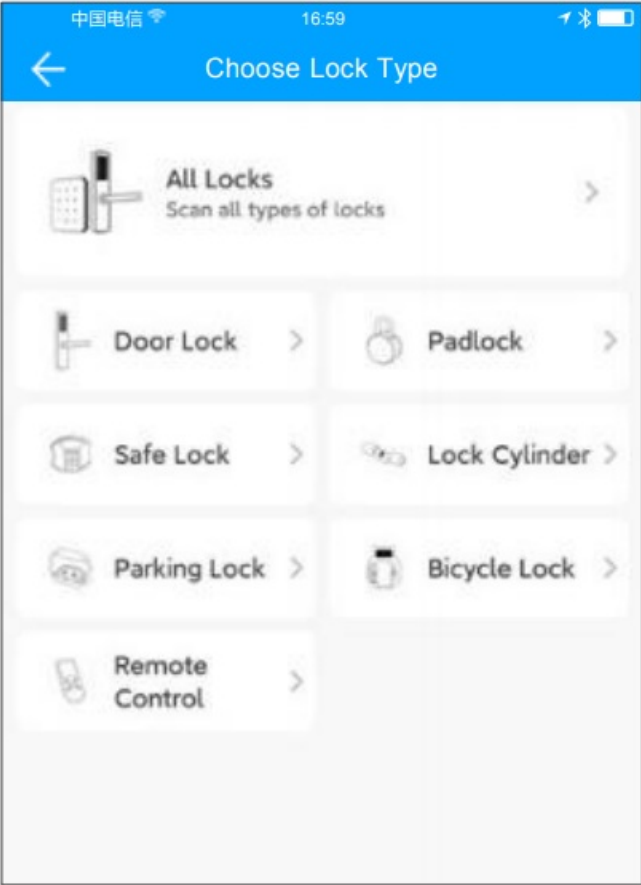

**Customer service**

The user can consult and give feedback through the AI customer service.

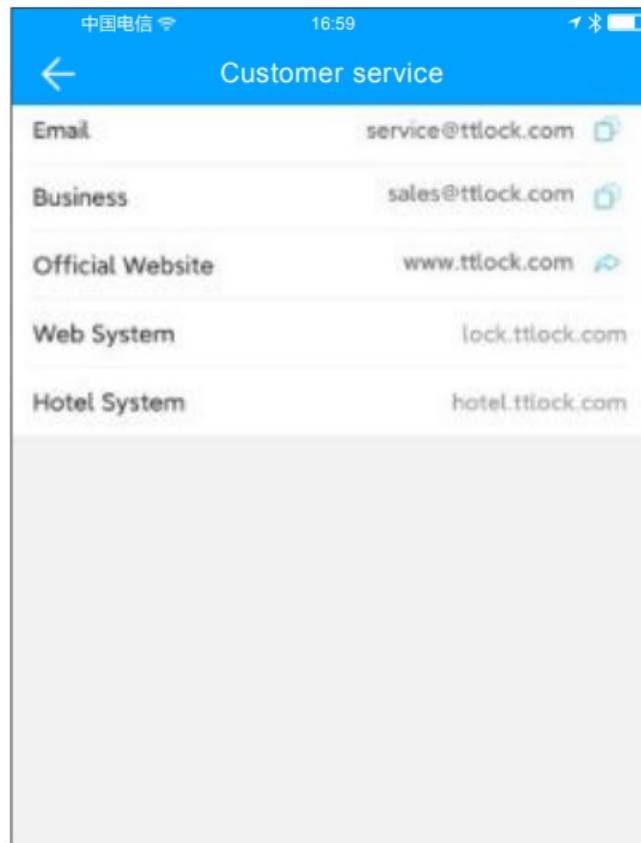

## Settings

### Sound

When using the TTLock APP to unlock, the phone will emit an alert tone, tap to set to turn on or off.

### Touch to unlock

There are lots of locks in your account, and you don't want to search for a lock to open everytime. Turn on the "Touch to Unlock" in the App "Settings" menu. With this option on, you can open door by just touching the lock to wake up it.

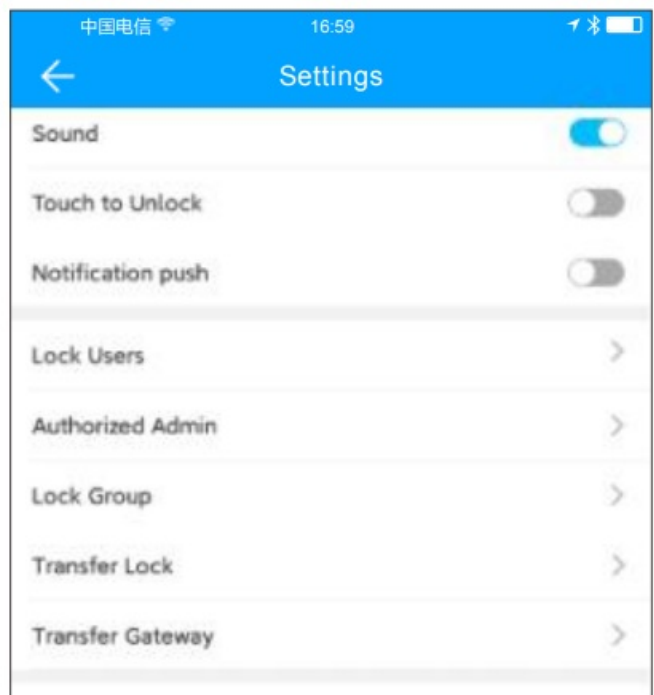
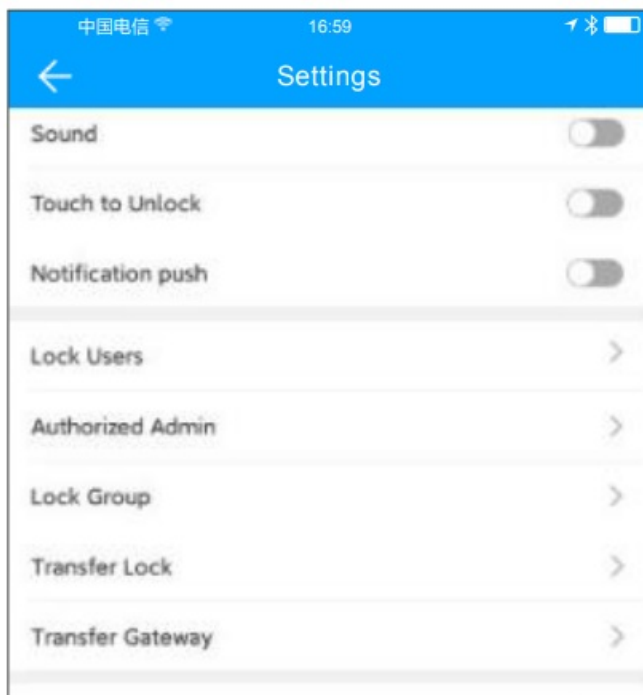



## Notification push

Receive the notification when someone opens the door Enable the “Unlock Notification” option in the lock’s “Settings” menu. Then the administrator will receive a notification when someone open the door.

## Lock Users

All users under the account can view the permissions that are about to expire, modify the validity period in time, and delete the user permissions

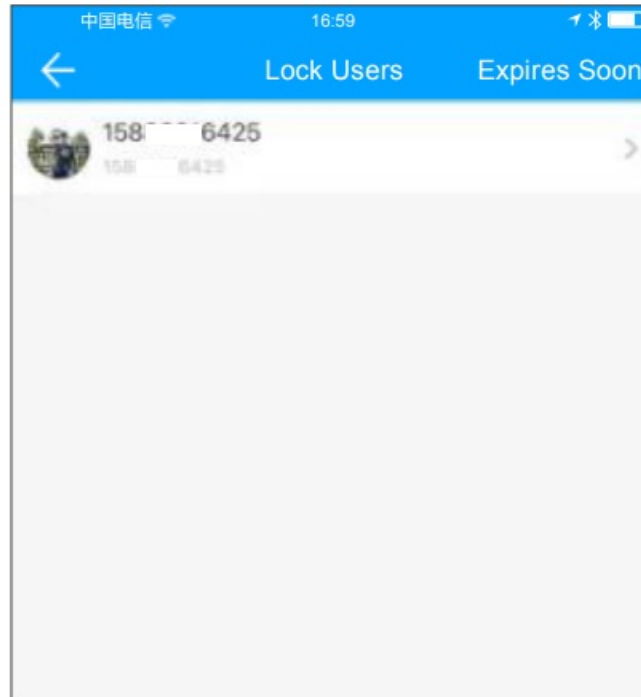

## Authorized Admin

Find the “Authorized Admin” in the App settings menu. You will see currently authorized administrators. Click the “+” icon at the top right to create a new admin. In the authorized admin’s detail page, you can freeze or de-authorize him, change the validity period, or change locks. Add authorized admin in batch

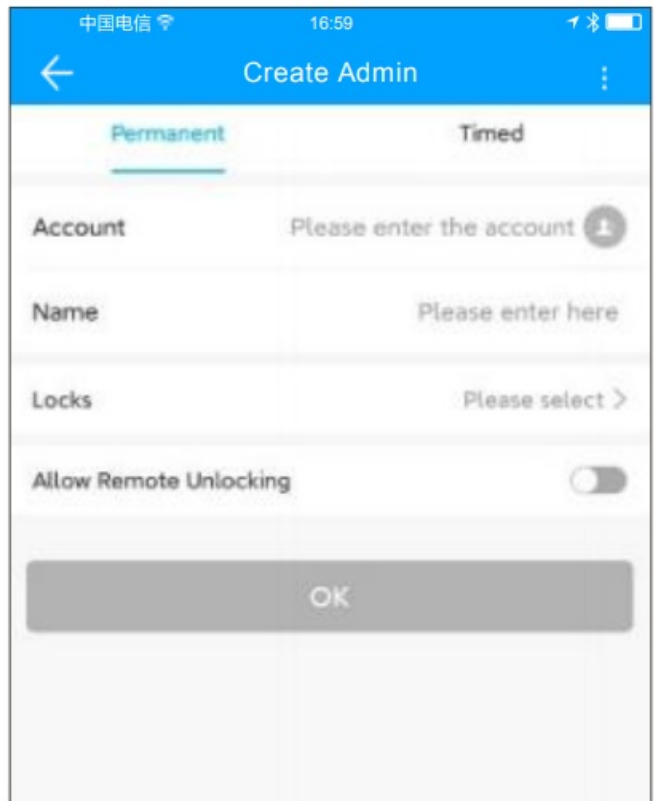
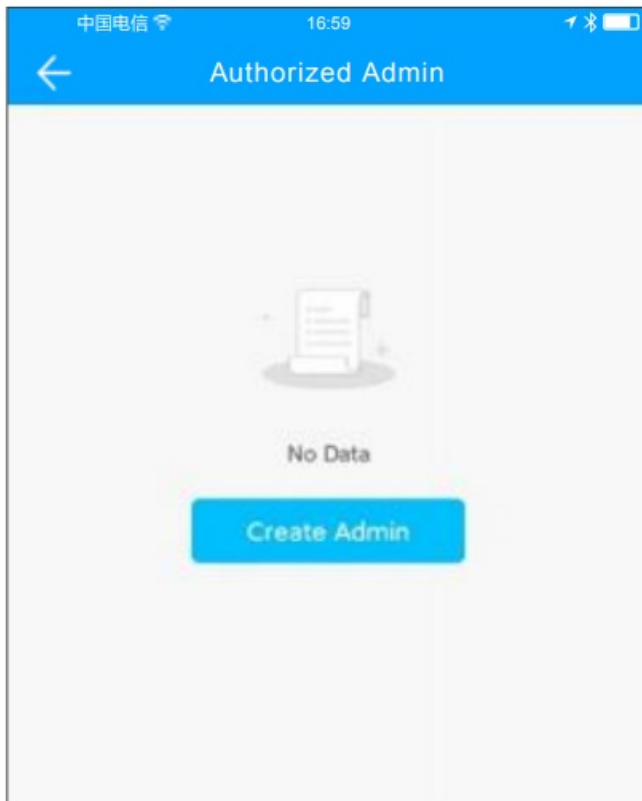

## Lock Group

Make the management easier when there are lots of locks. Find “Lock Group” in the App settings menu. You will see current groups. Click the “+” icon at the top right to create a new group. Click the new created group, then you can “add” locks to it.

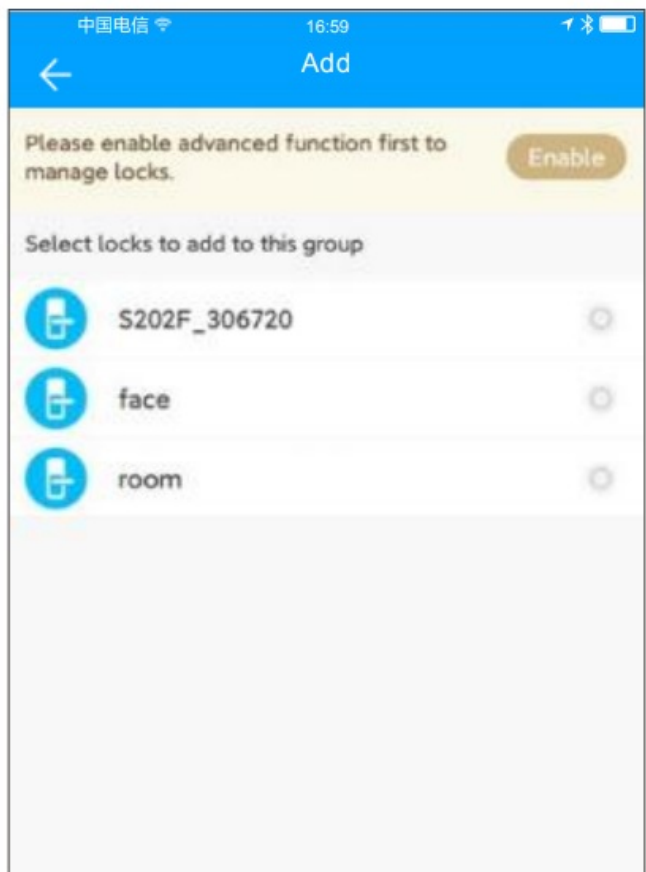
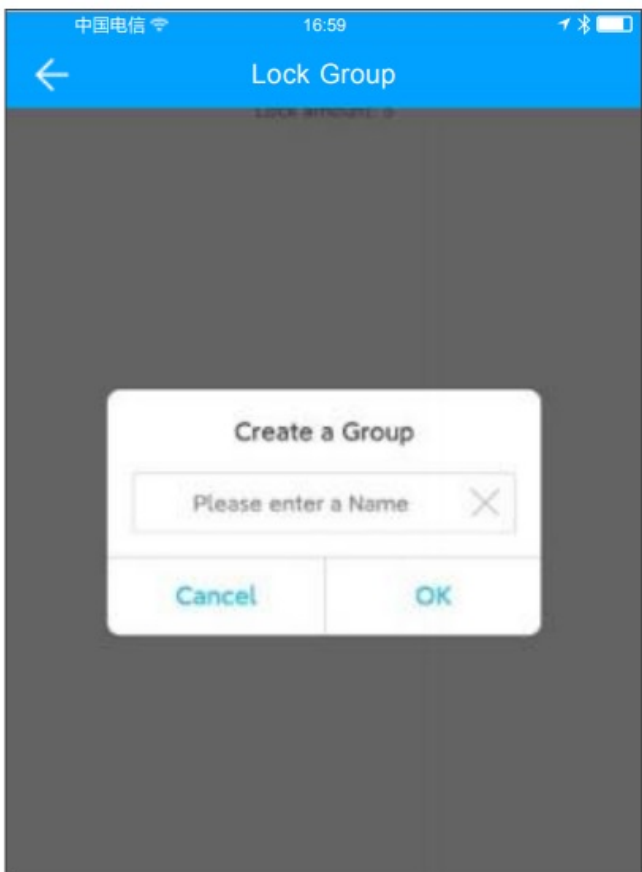

## Transfer Lock

Go to the App “Settings” menu, and find “Transfer Lock”. Select locks and enter the recipient account, the selected locks will be transferred to him. If you just want to remove some damaged locks from your account, please click “Move Faulty/Damaged Locks to Trash” at the bottom right.

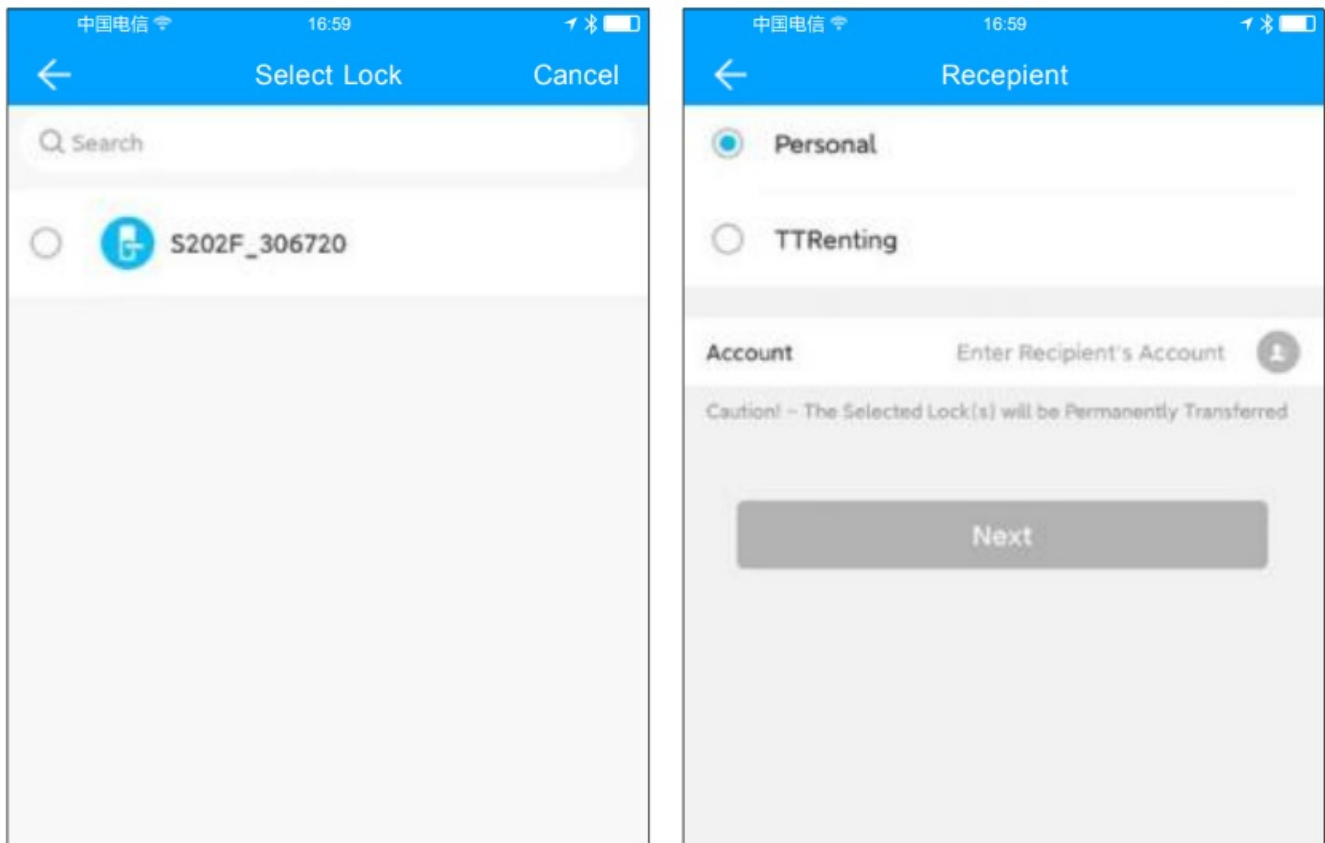

## Languages

TTLOCK currently supports multiple languages, you can call out the menu interface in the upper left corner of the interface, click Settings, select Multi-language, and set the following system or other languages as needed.



## Screen lock

This Feature allows you to access APP after being verified with Fingerprint/Face ID/Password.

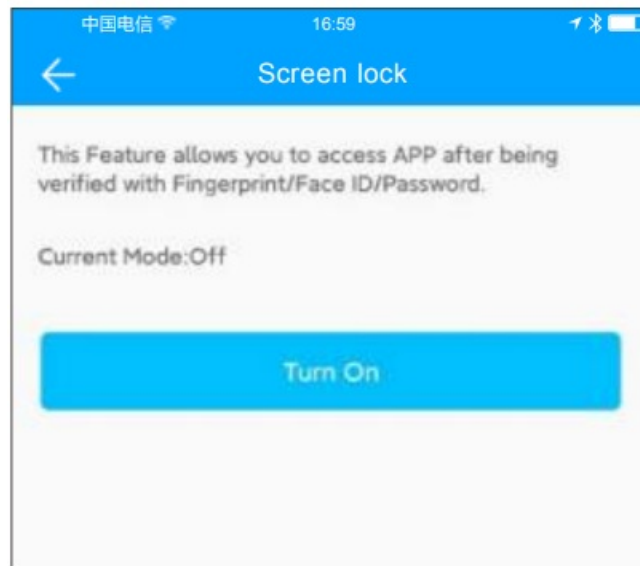

### Hide invalid access

This feature allows you to hide passcodes, keys, cards, and fingerprints that are invalid for a period of time.

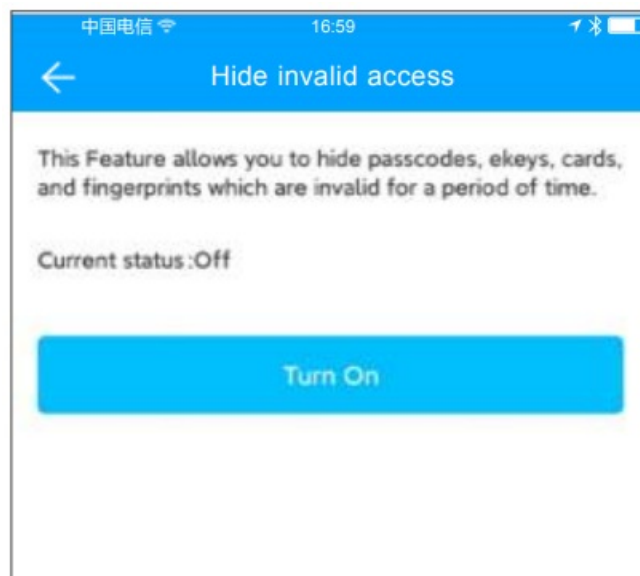

### Locks requiring ophone online

User's phone is required to be online to unlock these selected locks with the APP.

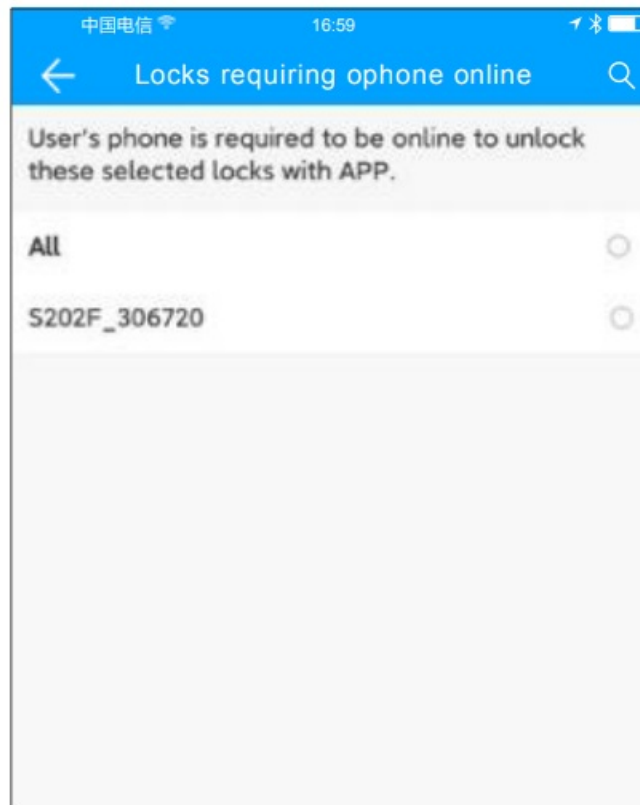

## Services

Call out the menu interface in the upper left corner of the interface, click Settings, select value-added services, you can purchase SMS, email and real-name authentication; You can also activate the premium version of the function, including SMS template, email template, batch authorization administrator, group key, and batch group function.

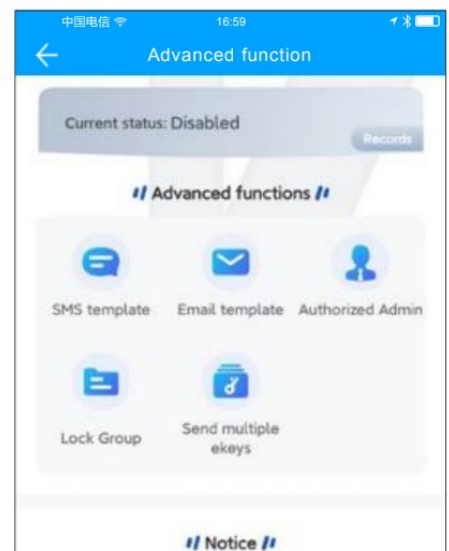
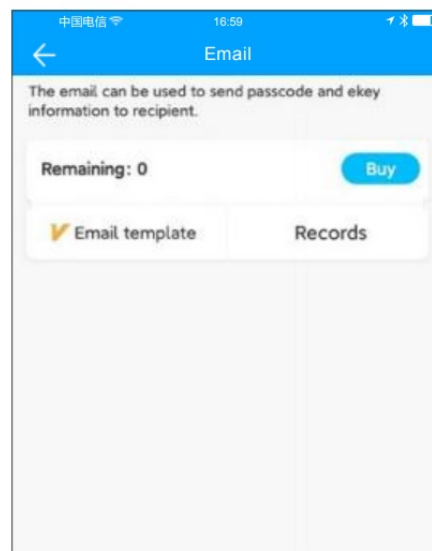
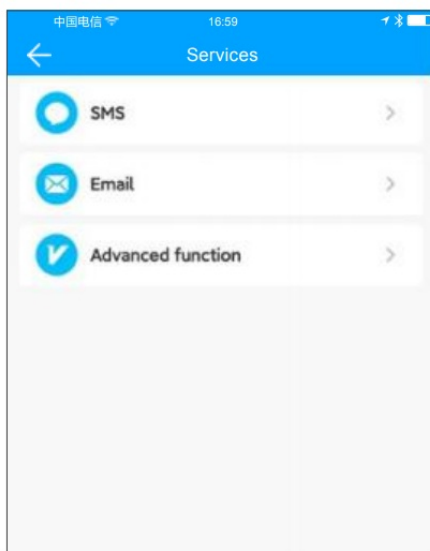

## About

Call out the menu interface in the upper left corner of the interface, click Settings, select About, you can view the version number and introduction of the TTlock APP, the privacy policy and user agreement, as well as the list of personal information collection, application permission description and third-party sharing information list.

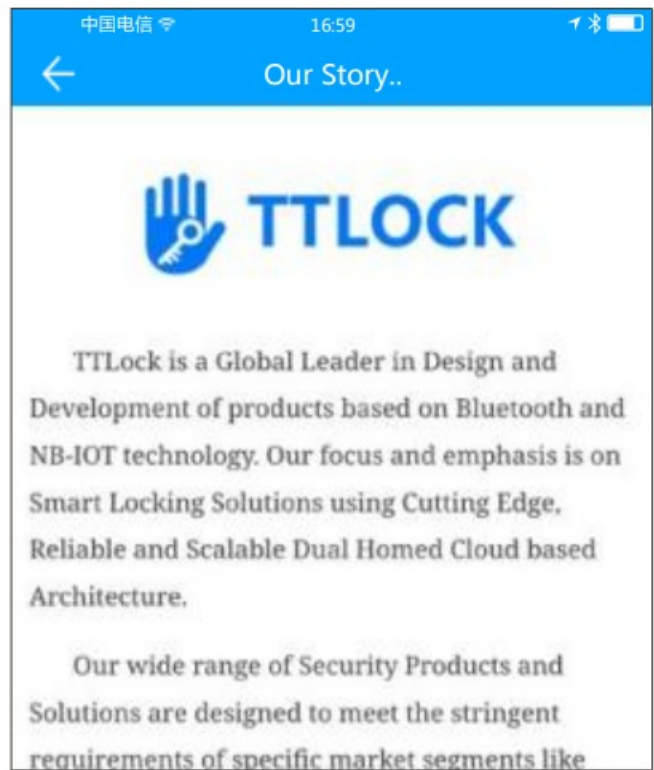
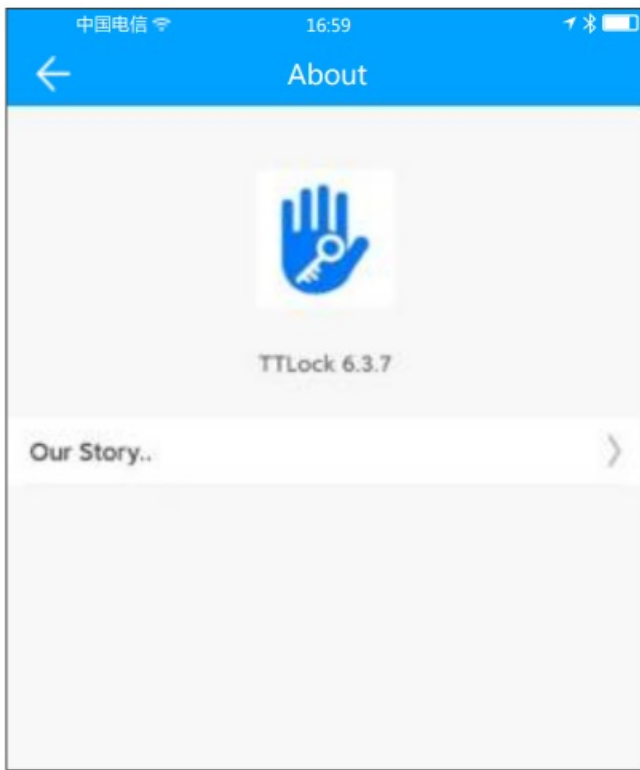

## Logout

Call out the menu interface in the upper left corner of the interface, click Settings, select Exit Account, and log out of the current account.

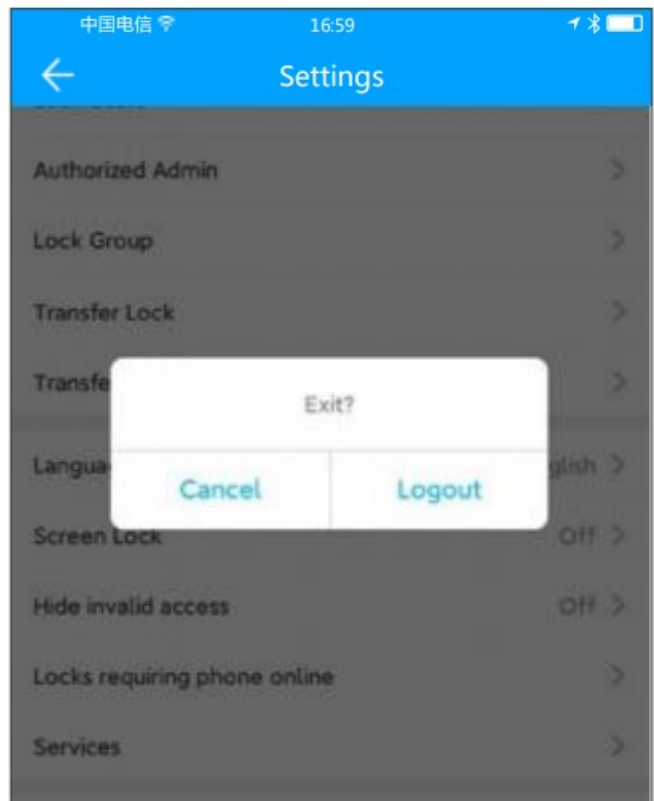

## Delete Account

All your Account Information will be removed from the Platform PERMANENTLY and cannot be Recovered. Do you want to Delete it?

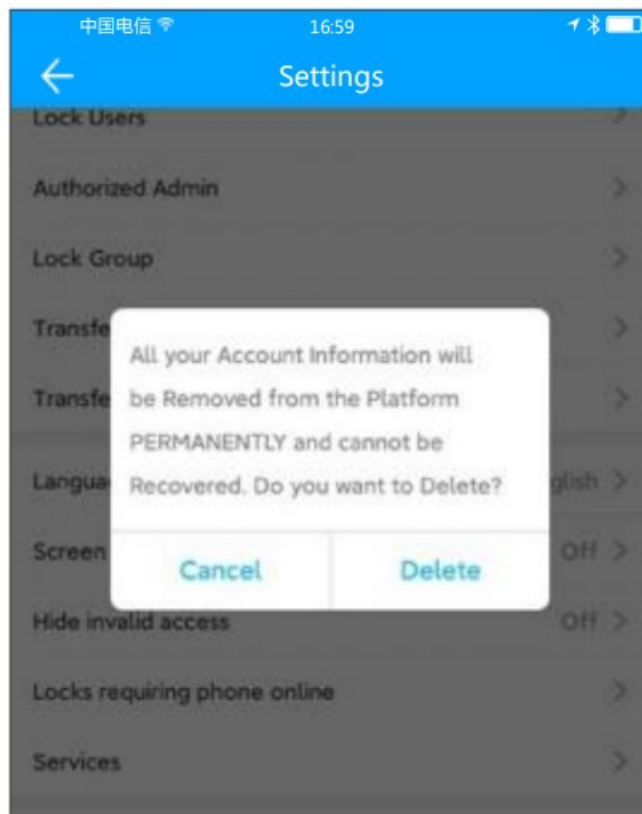

## Work with

Call out the menu interface in the upper left corner of the interface, select value-added services, you can purchase SMS and email; You can also activate the premium version of the function, including SMS template, email template, batch authorization administrator, group key, and batch group function

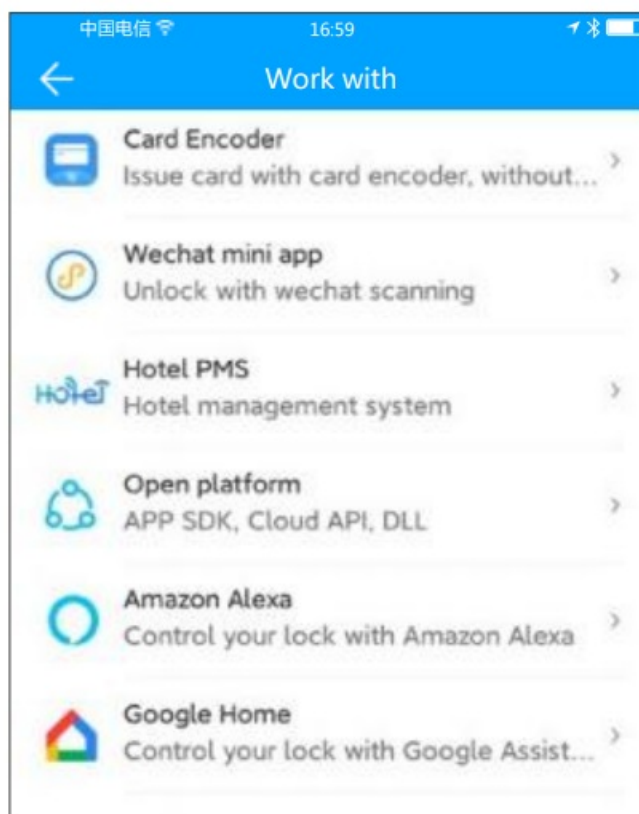

## Overview of key features

After adding a lock, you can grant access permissions to others, including ekey, passcode, fingerprint, face, and

etc.

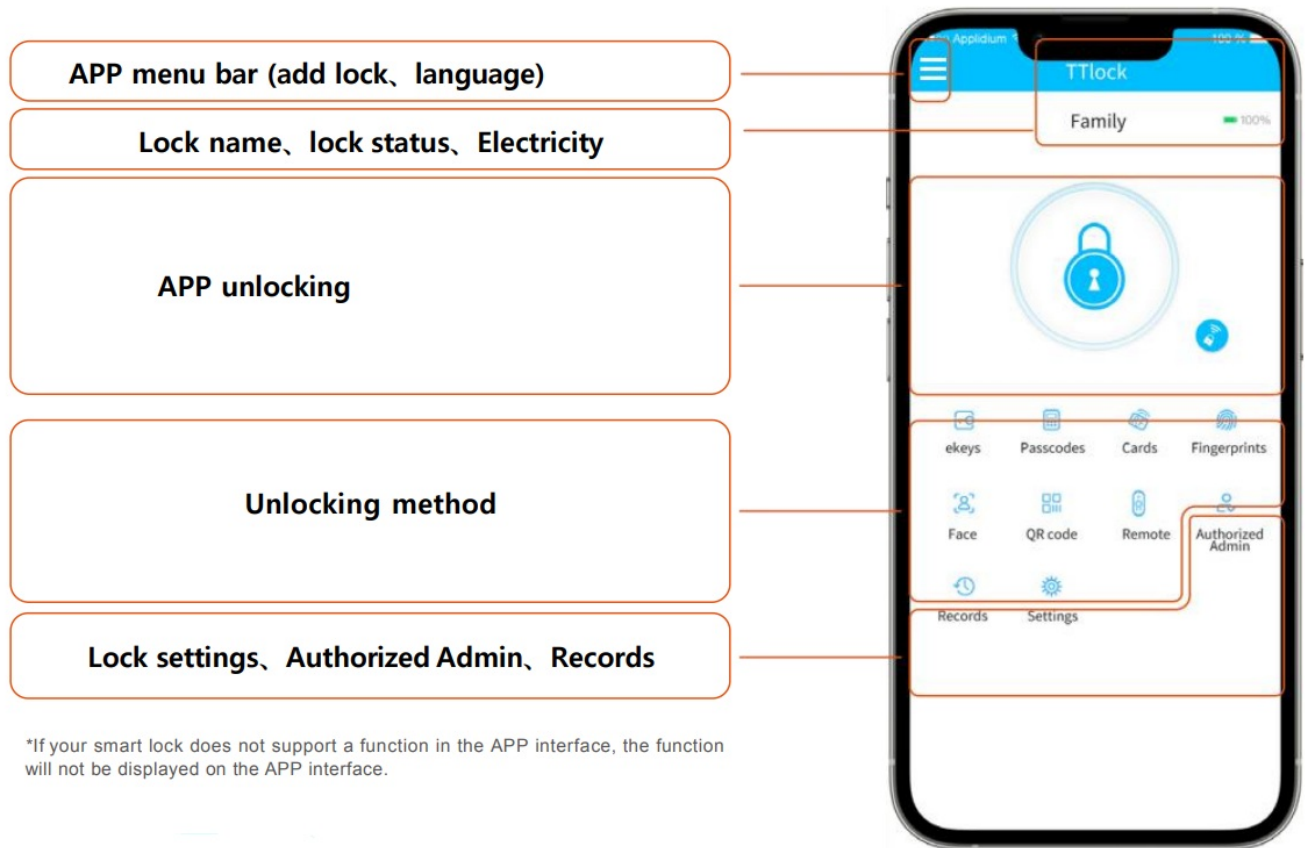

\*If your smart lock does not support a function in the APP interface, the function will not be displayed on the APP interface.

## key management

### Send ekey

You can see all ekeys here. Press “Reset” at the top right to delete all of them. In the ekey’s detail page, you can view, change, freeze, and delete it. Click “Send eKey” to send ekey to someone else. If the recipient account hasn’t been registered yet, it will be registered automatically. A SMS message or email with password will be sent

Remote unlock: A Gateway is needed to do remote unlock. Identity verification: (It only works in China).

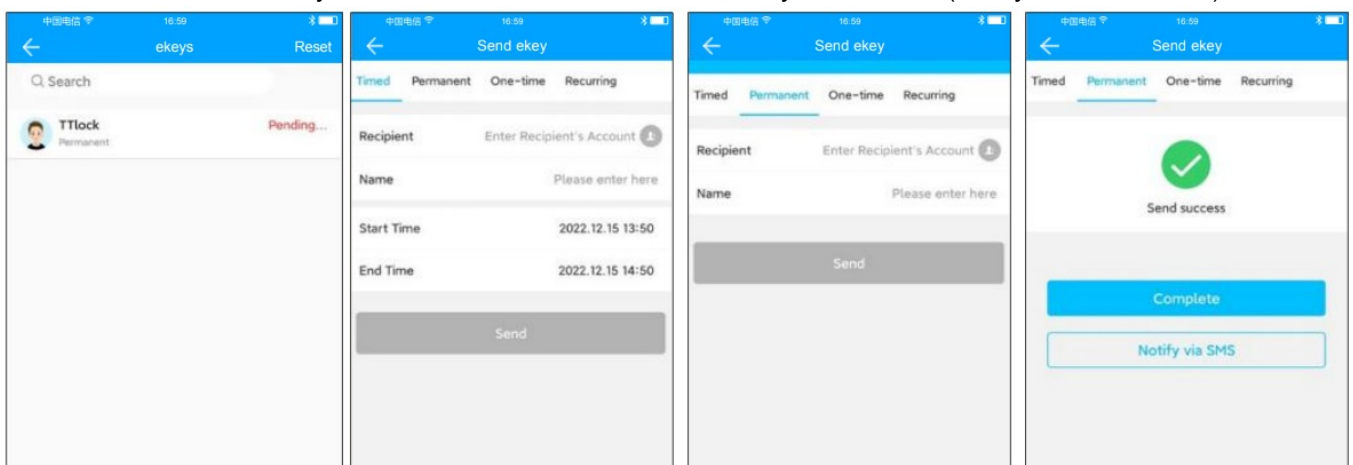

## Key management

In the keys detail page, you can view, change, freeze, and delete it. You can see all ekeys here. Press “Reset” at



the top right to delete all of them.

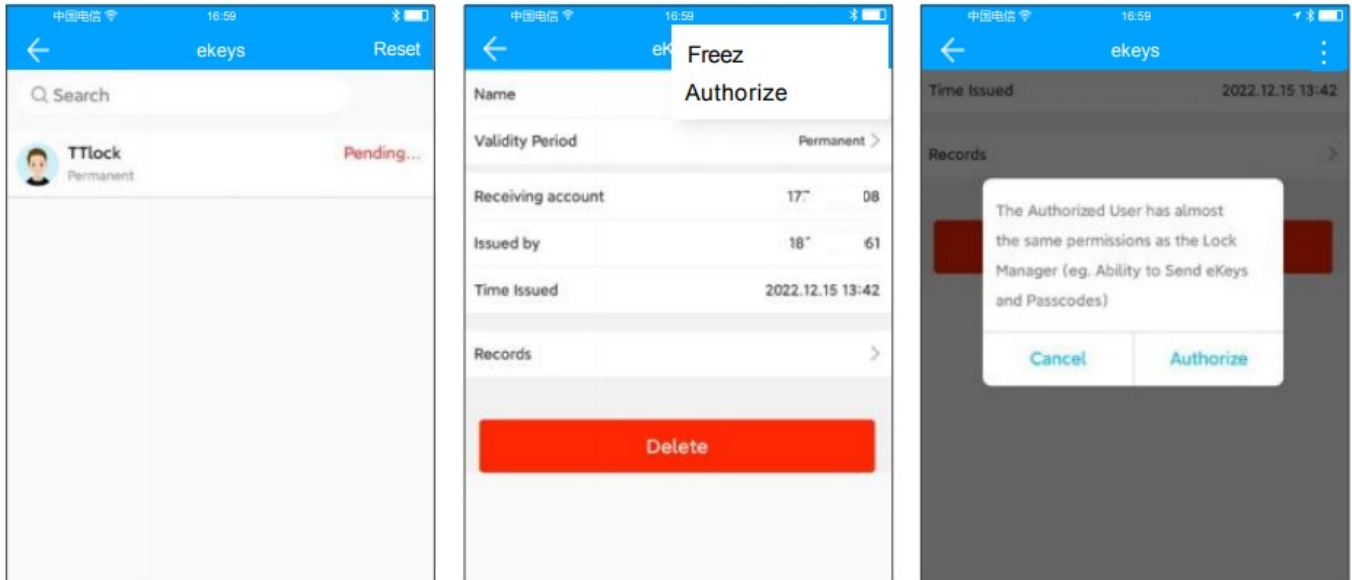

## Deadline warning

The system will show two colors for the deadline warning. The yellow means close to expiring and the red means it has expired

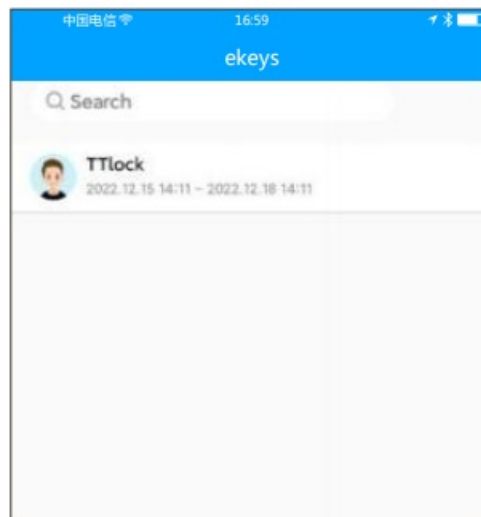

## Passcodes

### Generate passcode

You can see all the passcodes here. Press “Reset” at the top right to delete all of them. You can also create an “Erase” passcode to delete all other passcodes. Or create a custom passcode. Erase: When you input “Erase” passcode on lock, all other passcodes will be disabled. One-time passcode only works within 6 hours. The passcodes with type permanent, timed, and recurring should be used at least once after their “start time”. Or they will be invalidated.

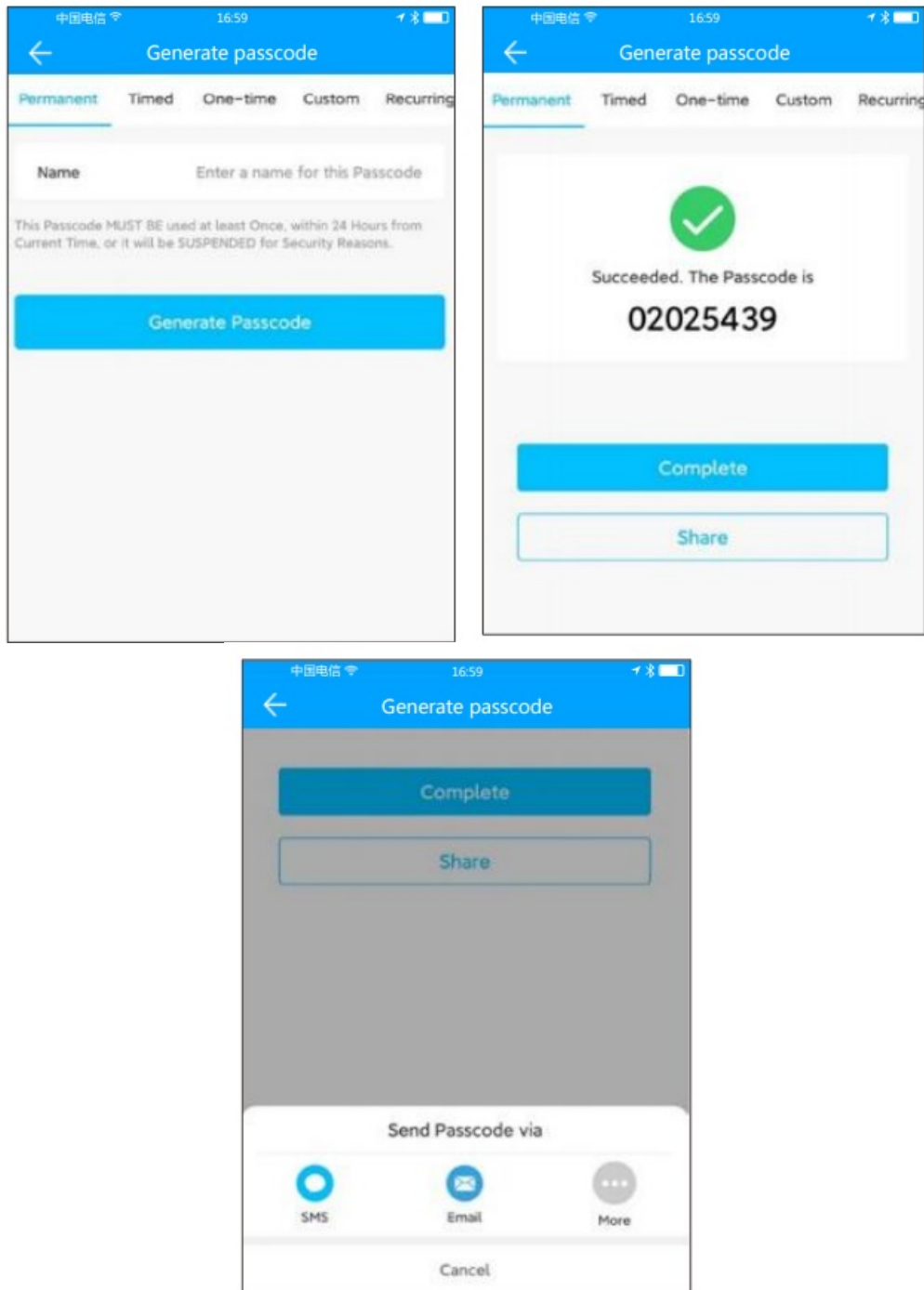

## Password management

In the passcode's detail page, you can view, change, share, and delete it. Only passcodes have been used on lock can be changed.

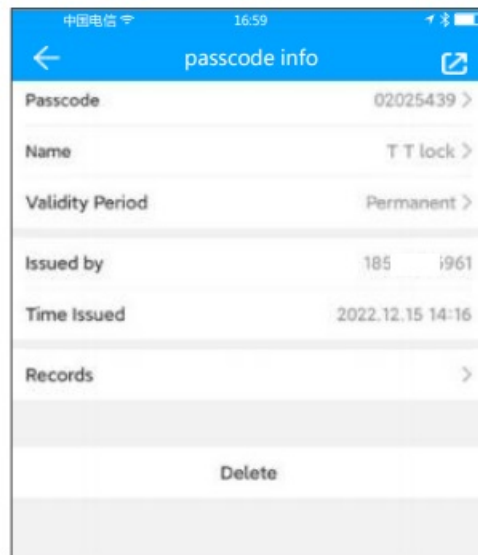

## Fingerprint

Fingerprint management is similar to IC card management. After adding a fingerprint, you can use the fingerprint to unlock the door.

## Face

- All faces of this lock will be listed here. Click “Reset” at the top right delete all of them. Click “Sensitivity” to set the sensitivity of the camera on the lock.
- In the face’s detail page, you can view, change, and delete it.

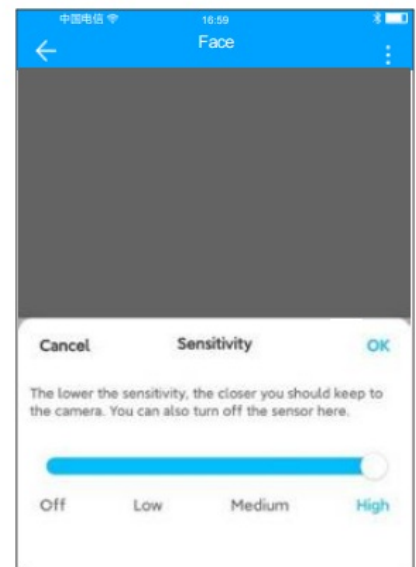
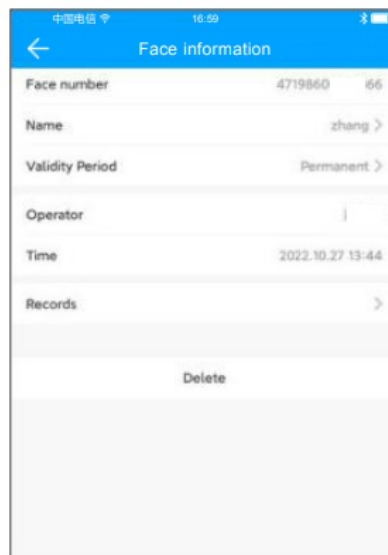
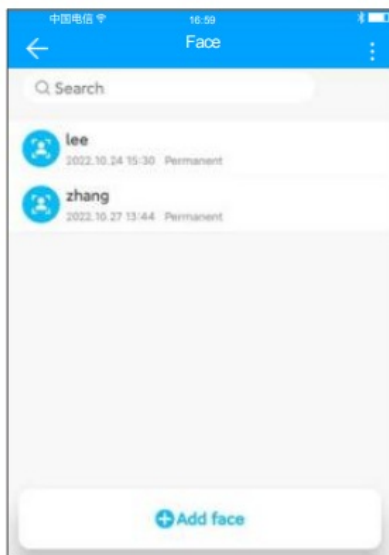

## FCC Warning Statement

Changes or modifications to this unit not expressly approved by the party responsible for compliance could void the user’s authority to operate the equipment. This equipment has been tested and found to comply with the limits for a Class B digital device, pursuant to Part 15 of the FCC Rules. These limits are designed to provide reasonable protection against harmful interference in a residential installation. This equipment generates, uses and can radiate radio frequency energy and, if not installed and used in accordance with the instructions, may cause harmful interference to radio communications. However, there is no guarantee that interference will not occur in a particular installation. If this equipment does cause harmful interference to radio or television reception, which can be determined by turning the equipment off and on, the user is encouraged to try to correct the interference by one

or more of the following measures:

- Reorient or relocate the receiving antenna.
- Increase the separation between the equipment and receiver.
- Connect the equipment into an outlet on a circuit different from that to which the receiver is connected.
- Consult the dealer or an experienced radio/TV technician for help.

**This device complies with Part 15 of the FCC Rules. Operation is subject to the following two conditions:**

1. this device may not cause harmful interference, and (2) this device must accept any interference received,
2. including interference that may cause undesired operation.

### FCC Radiation Exposure Statement

The antennas used for this transmitter must be installed to provide a separation distance of at least 20 cm from all persons and must not be co-located for operating in conjunction with any other antenna or transmitter

**There are two ways to add a face.**

- Select the type, enter the name, and select “From lock” as the add method. Follow the prompts to align the face with the lock’s camera.

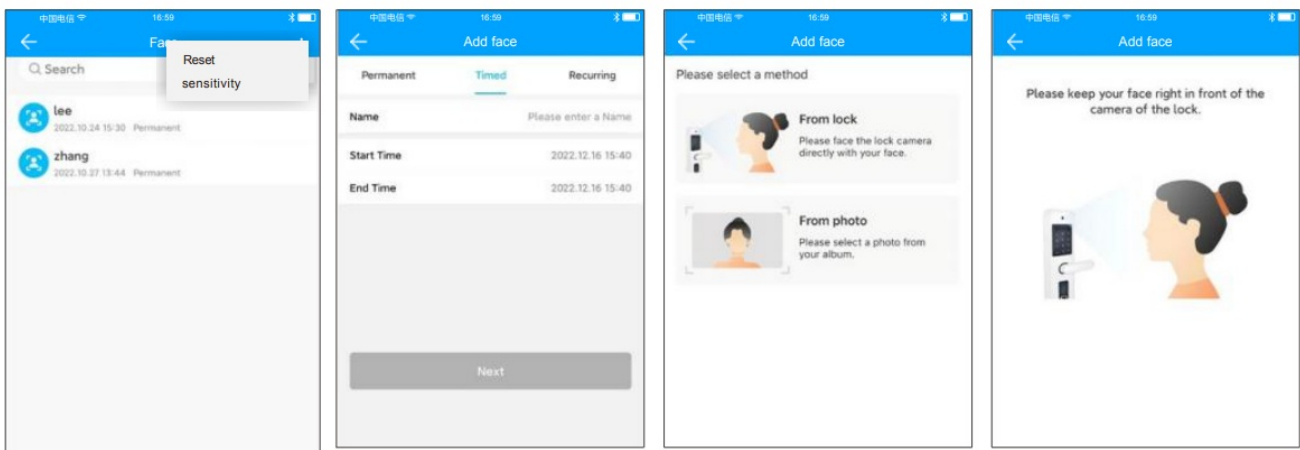

- Select “From photo” as the add method. Select a photo that meets the requirements and preview the effect. If you are not satisfied, you can “Replace”. Click “OK” to complete the addition

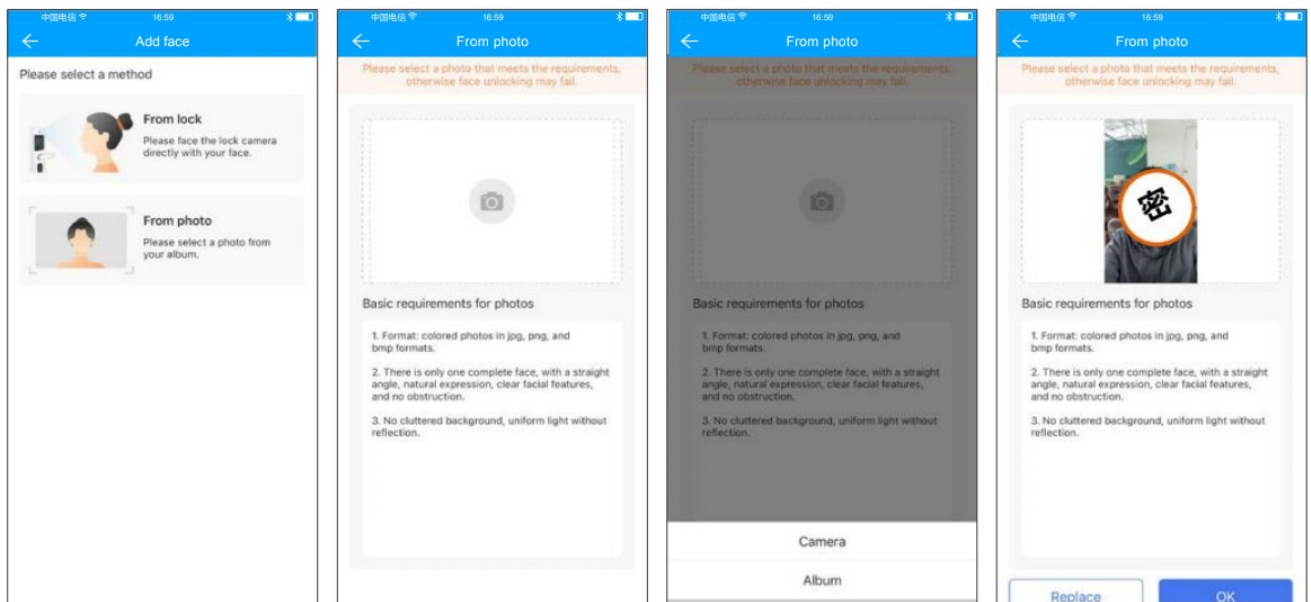

## Palm vein

- You can see the palm vein that has been added here. There are “Reset” and “Sensitivity” in the menu. Click “Reset” to delete all palm vein data; click “Sensitivity” to adjust the camera’s recognition sensitivity.
- You can enter the palm vein details page from the list to view, modify, and delete.
- Select the type, enter the name, follow the prompts to align your palm with the lock’s camera, and record the palm vein.

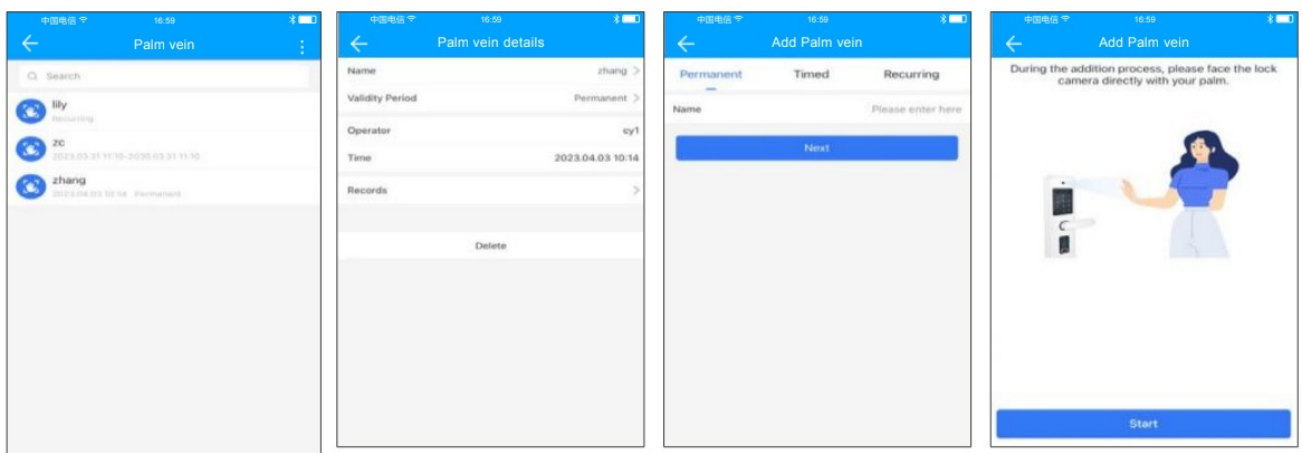

## QR code

### QR code lock unlocking

All the generated QR codes will be listed here. In the QR code’s detail page, you can view, change, share, and delete it. Select validity period type and enter the name to create a QR code. The QR code link can be sent to others via SMS, email, and etc.

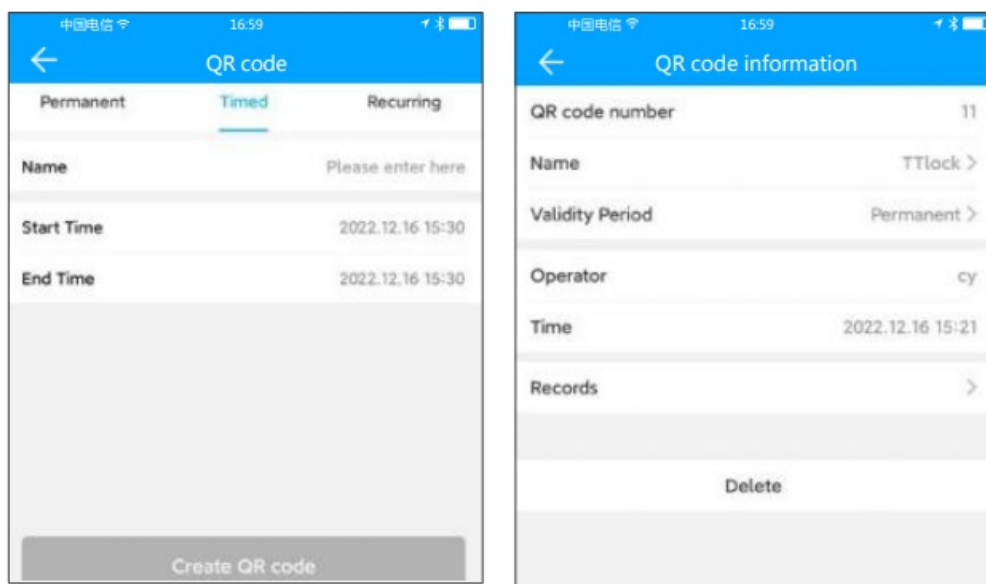

## Remote

All remote control of this lock will be listed here. Click “Reset” at the top right to delete all of them. In the remote control’s detail page, you can view, change, and delete it. Select validity period type and enter the name, then make the device into setting mode and add it to the app.

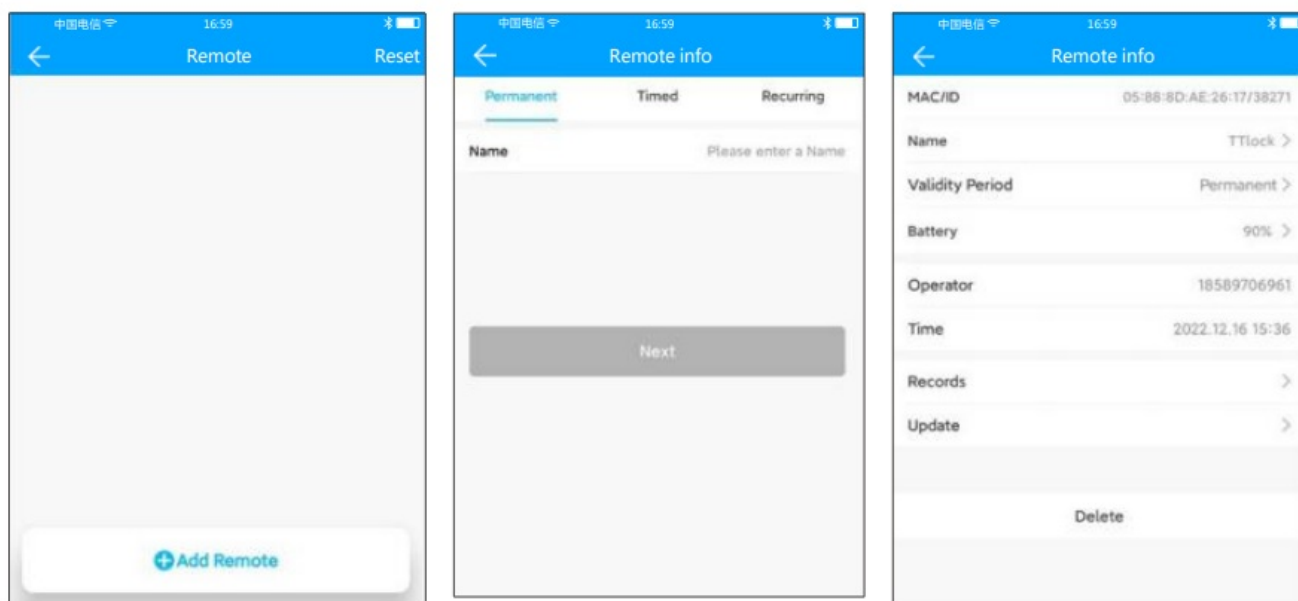

## Authorized Admin

There are three user levels: administrator, authorized administrator, and user. When you add a lock with App, you will be the administrator of this lock. The administrator can add others as the authorized administrators.

- Both the administrator and authorized administrator can grant access permission to others. Users have permission to unlock with App.
- First, select a lock and run into the console page.
- Click “Authorized admin”, you can see all currently authorized administrators of this lock.
- Click “Create admin”, enter the account and validity period, then click “Send”.
- The authorized administrator has almost the same permission as the administrator, except for some special functions

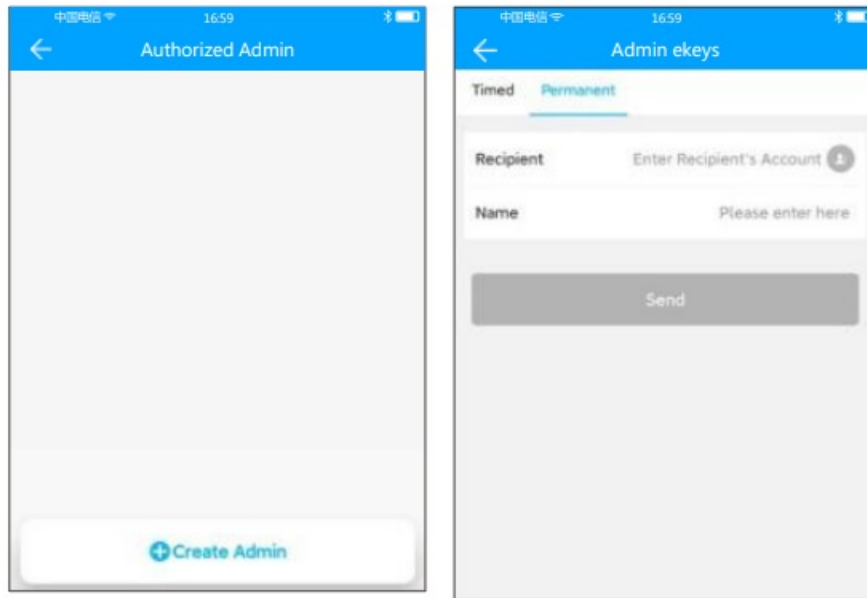

## Records

Look up all operations in the “Records” page. You can delete or export the records. The administrator can clear all the records. Click “Export records” at the top right menu. You can export the records of last half year. The administrator can query the unlock record of each key.

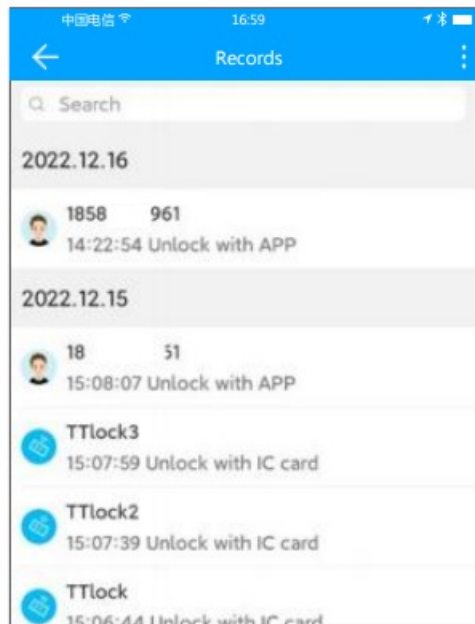

## Lock Settings

### Basics

Lock settings – basic information, you can view the lock number, MAC/ID, power level, expiration date, view or modify the lock name, group, view the administrator unlock password.

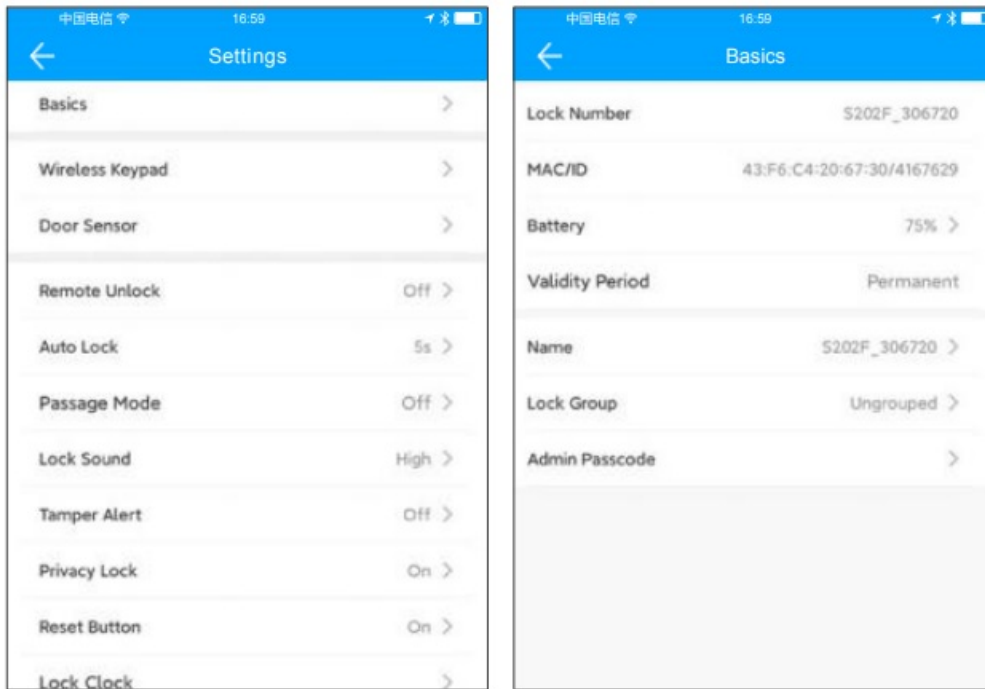

## Wireless Keypad

### Add method:

1. Lock settings;
2. Wireless keyboard ;
3. Add wireless keyboard;
4. Complete the addition according to the APP prompts.

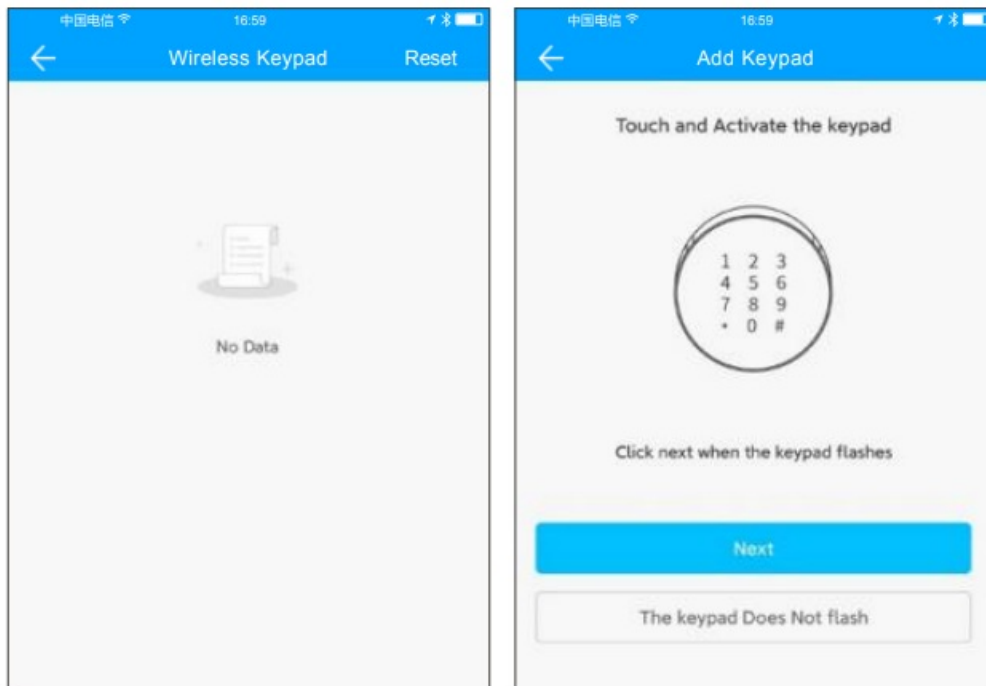

## Door Sensor

In the lock's setting menu, Click "Door Sensor", you will see this lock's door sensor, or you can add a door sensor here. In the door sensor page, you can see all its information, like battery level.



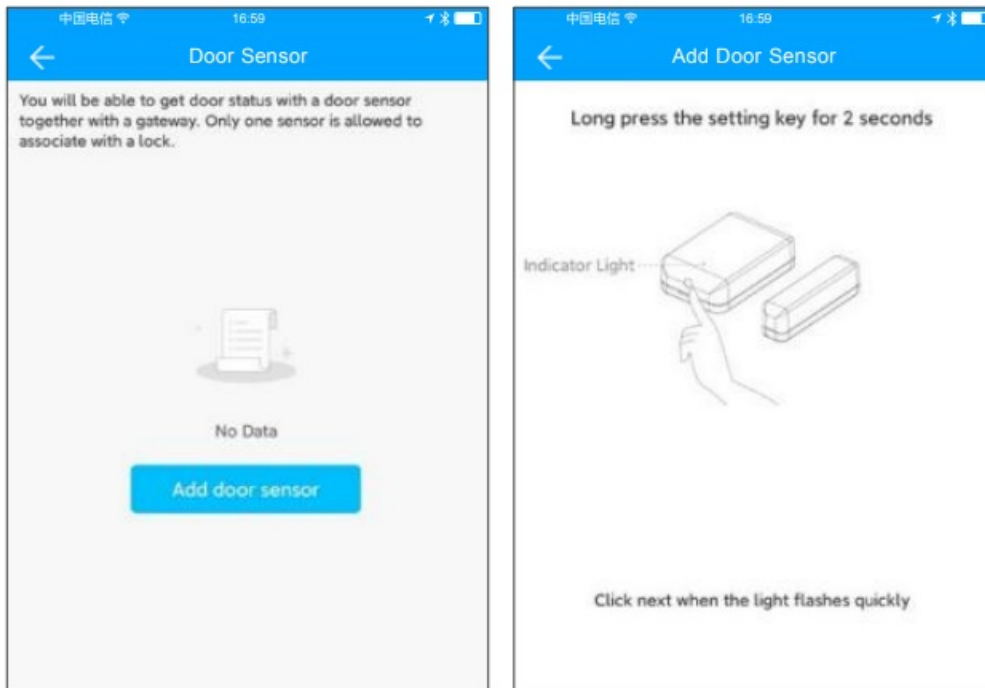

## Auto Unlock

Auto lock. When this feature is enabled, the lock will lock automatically after the set time. Find “Auto Lock” in the lock’s settings menu. Enable this feature by setting a time. Please unlock it for one time first to make the setting available.

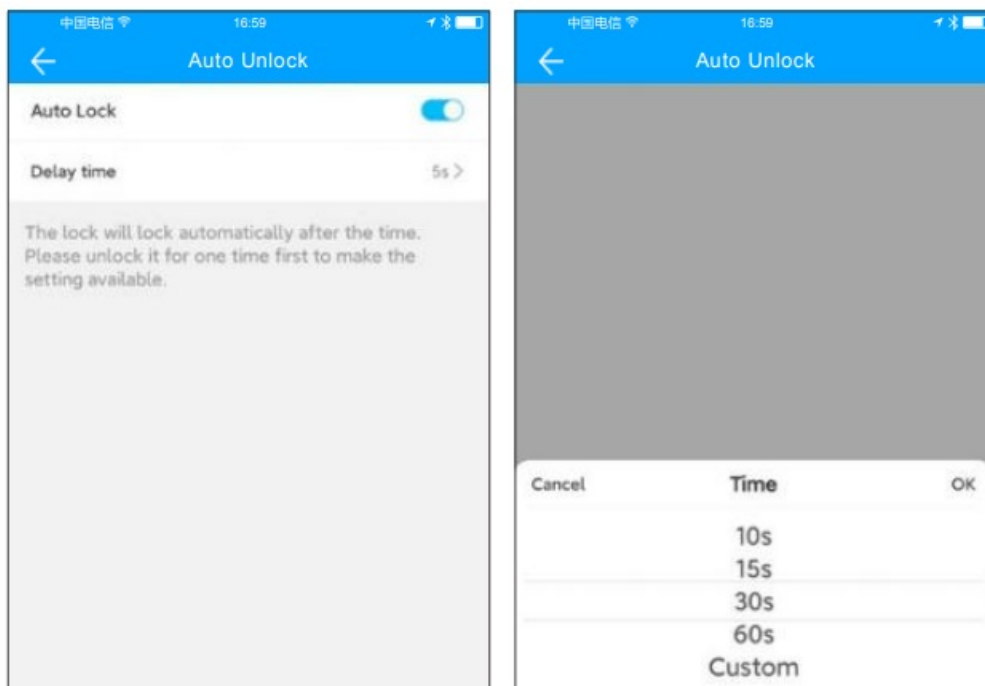

## Passage Mode

During the specific time period, the Lock will remain Unlocked until it is manually Locked.

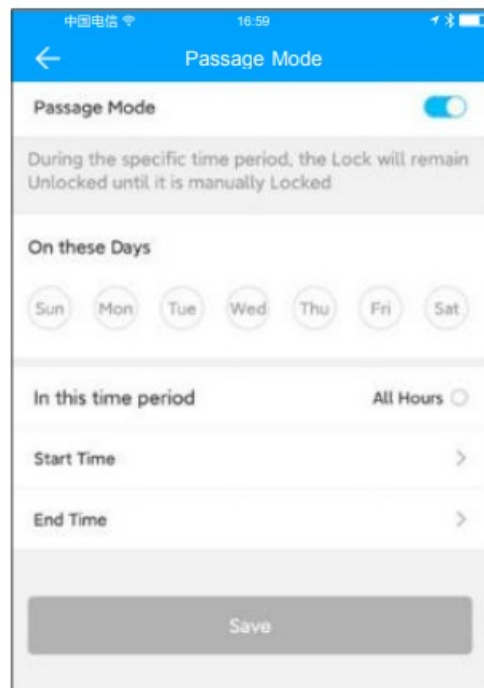
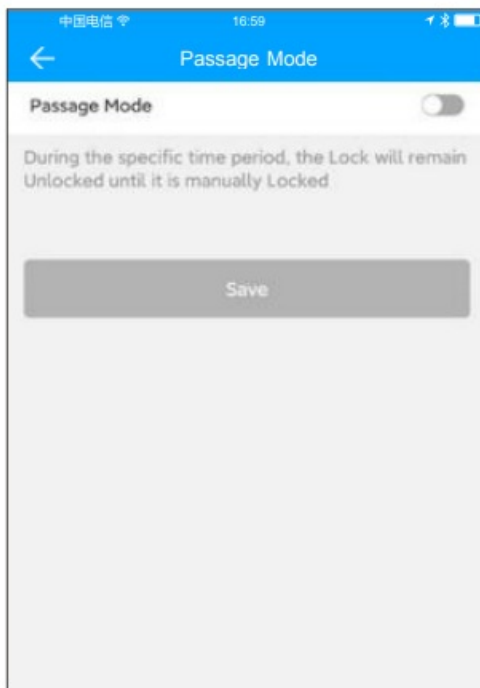

## Lock Sound

By Turning ON, you will hear the sound from the lock.

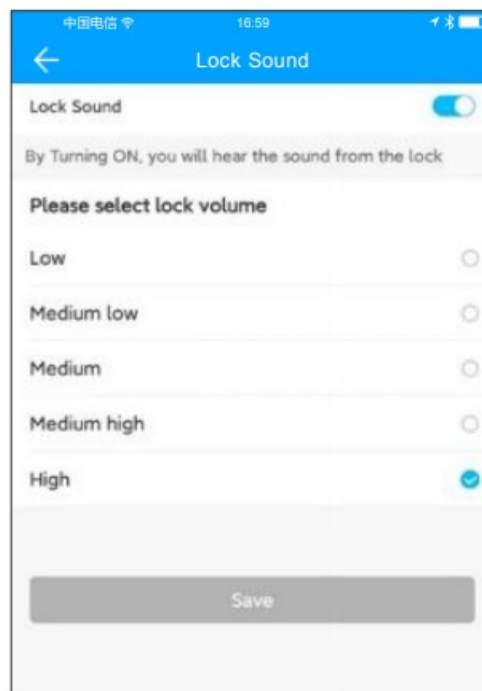

## Tamper Alert

By turning on, you enable the TAMPER alert.

## Privacy Lock

By turning on, you enable the Privacy Lock button.

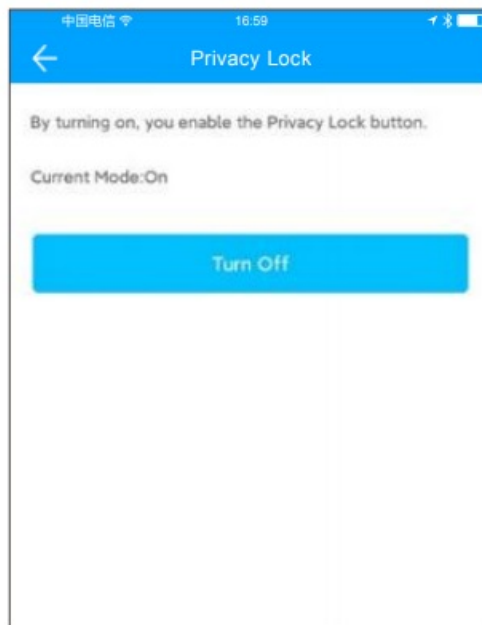
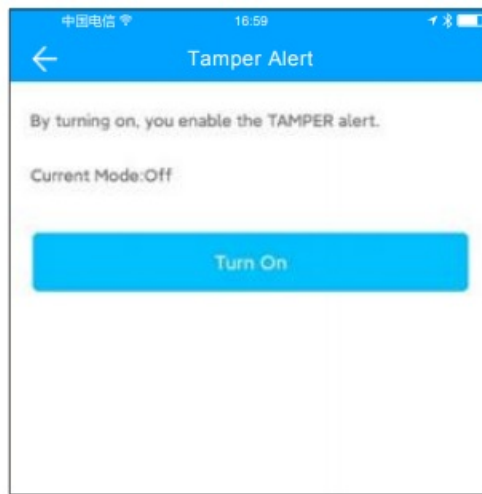

## Reset Button

By turning on, you can pair the lock again by long pressing the RESET button. By turning off, the RESET button is disabled.



## Diagnosis

Diagnostics will Upload the Config Data to our Servers for Root Cause Analysis of the problem. Please execute within 2 meters of the Lock.

## Upload Data

This Operation will Read all records stored in the Lock. It may take some time, please be patient.

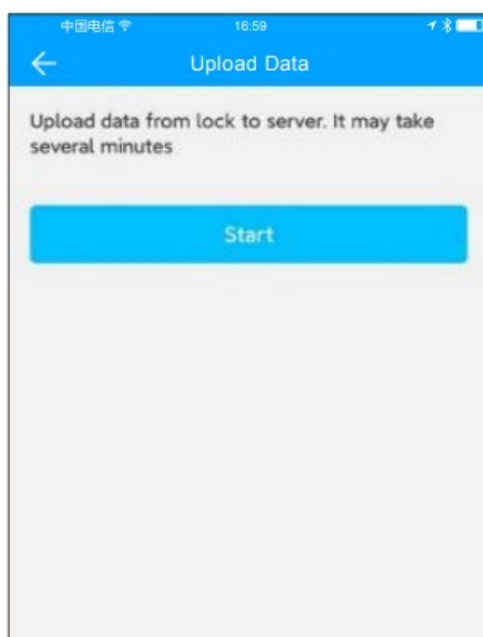
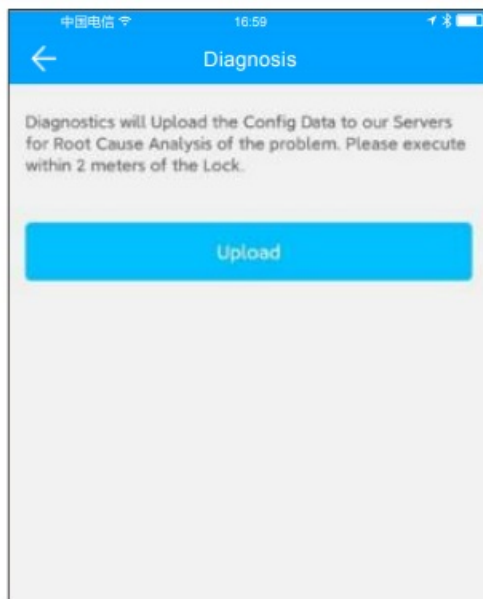

## Import from another lock

Replace old lock with a new one, and want the permissions on the old lock to work on the new lock. Click "Import from another lock" in the lock's "Settings" menu, select the old lock and start to import. It is done via bluetooth, so make sure you are near to the new lock.

## Firmware Update

The lock can be upgraded via the app. Firmware upgrades need to be made via Bluetooth next to the lock. After the upgrade is successful, the original key, password, IC card, fingerprint and other functions can continue to be used normally.

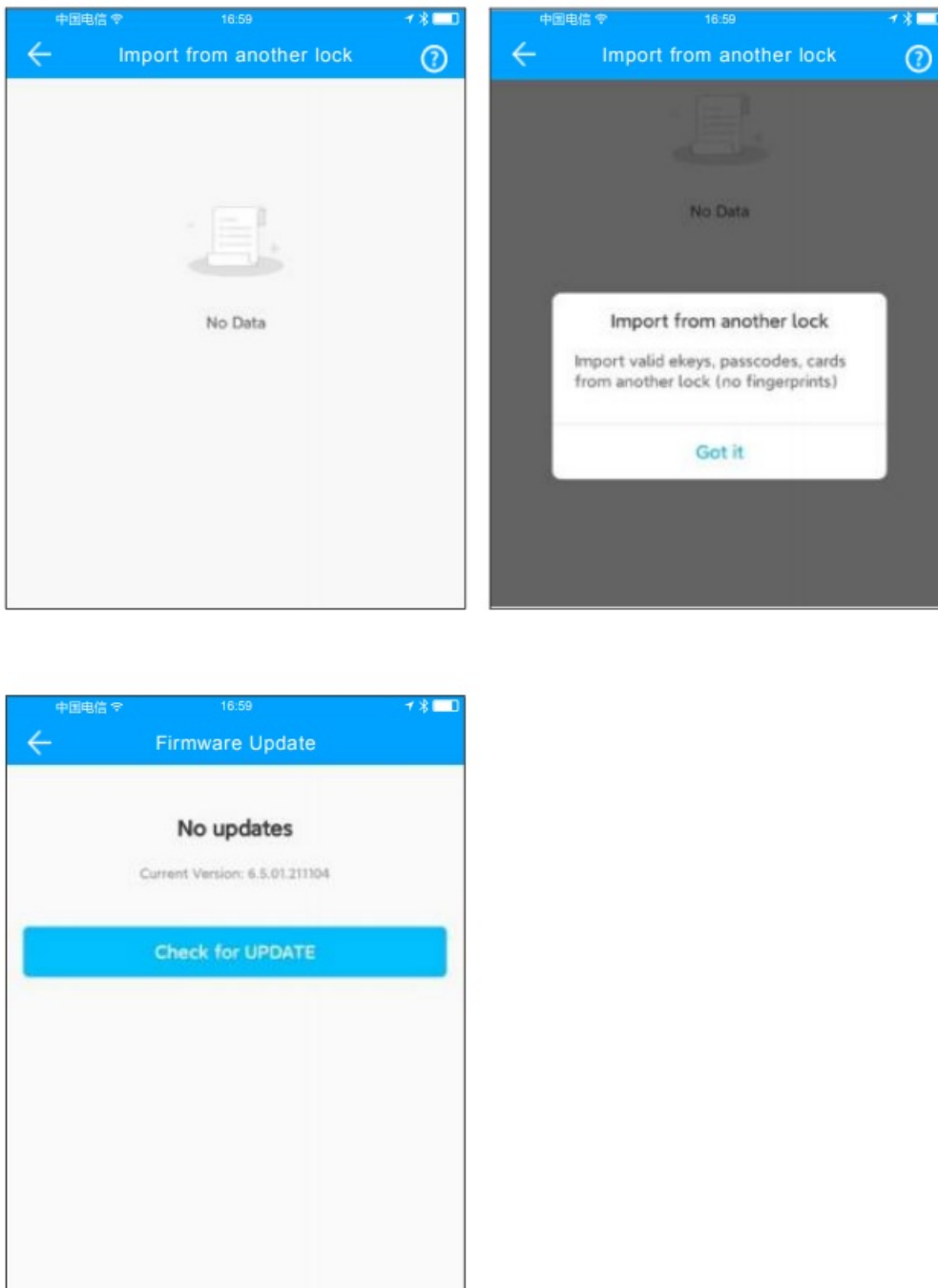

## Documents / Resources

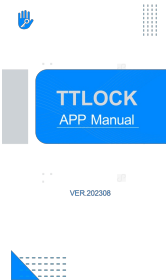
	<p><a href="#">TTLock 202308 Smart Lock Management Software</a> [pdf] User Manual  202308 Smart Lock Management Software, 202308, Smart Lock Management Software, Management Software, Software</p>
---	---

## References

- [lock.sciener.com/](https://lock.sciener.com/)
- [User Manual](#)

## **Manuals+. Privacy Policy**

This website is an independent publication and is neither affiliated with nor endorsed by any of the trademark owners. The "Bluetooth®" word mark and logos are registered trademarks owned by Bluetooth SIG, Inc. The "Wi-Fi®" word mark and logos are registered trademarks owned by the Wi-Fi Alliance. Any use of these marks on this website does not imply any affiliation with or endorsement.