

# TT COMBAT SFG183 Sci-Fi Gothic Battlesnap Outer Corner Upgrade Instructions

[Home](#) » [TT COMBAT](#) » TT COMBAT SFG183 Sci-Fi Gothic Battlesnap Outer Corner Upgrade Instructions 

## Contents

- [1 TT COMBAT SFG183 Sci-Fi Gothic Battlesnap Outer Corner Upgrade](#)
- [2 Instructions](#)
- [3 Installation](#)
- [4 Documents / Resources](#)
- [5 Related Posts](#)



## TT COMBAT SFG183 Sci-Fi Gothic Battlesnap Outer Corner Upgrade

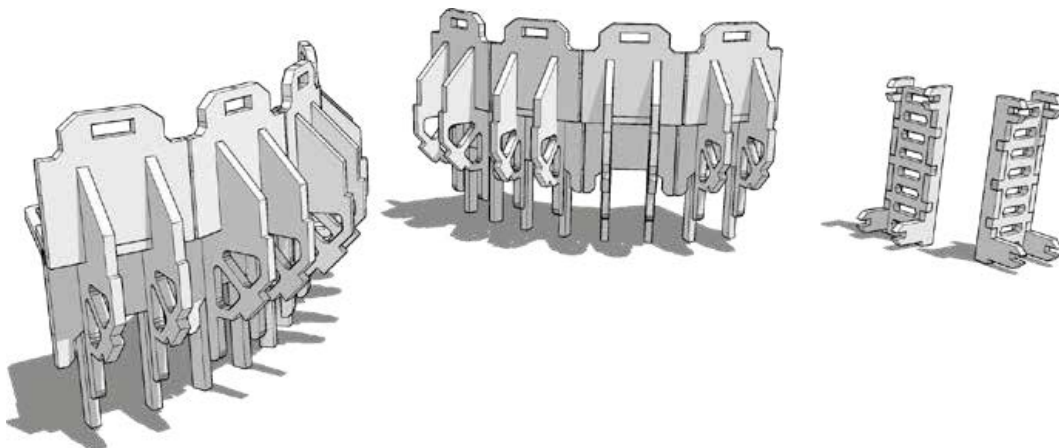

## Instructions

These are a series of icons that may be used throughout the instructions to help your assembly. If in doubt, scroll ahead to confirm.

- Do not glue this part

- Carefully score and fold this part
- This part – or its placement is completely optional

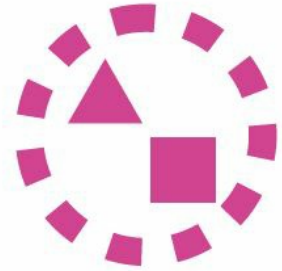

- Look closely at this step – The process order or part used, may be specific
- Repeat making this part the specified number of times
- The next instruction step will be the same assembly so far, but from a different angle



- Sub-assembly complete. This smaller construction is ready to add to the main kit
- Assembly Complete! There could be more optional parts – check to the very end of instructions
- FRAGILE: DO NOT BEND. “Bendy wood” is designed to curve around a designed frame only.



## Installation

**3**

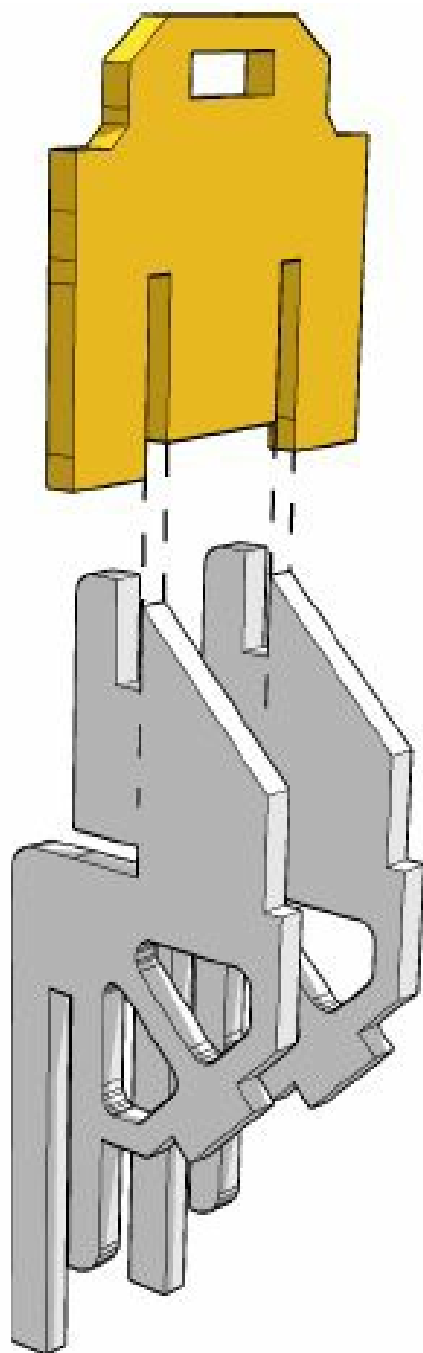

4

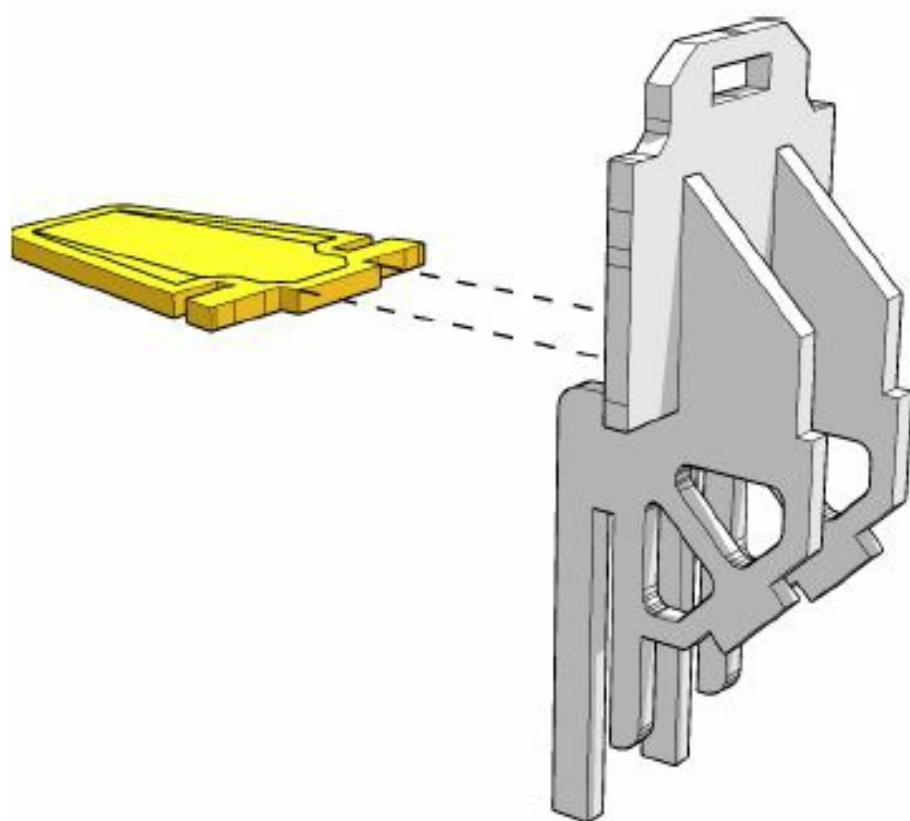

5

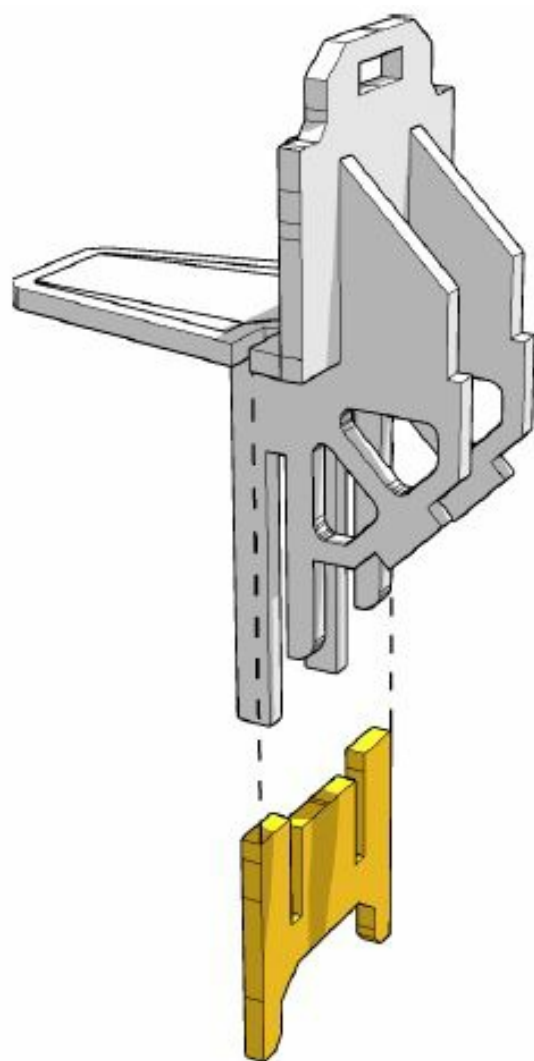

6

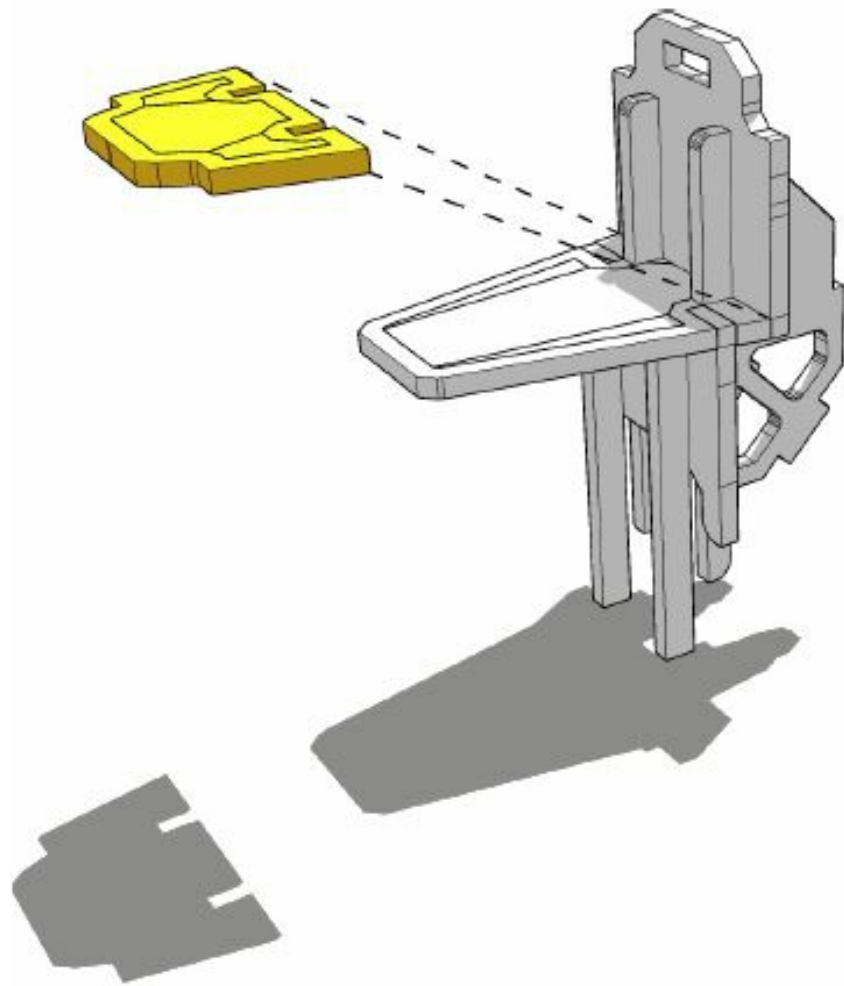

7

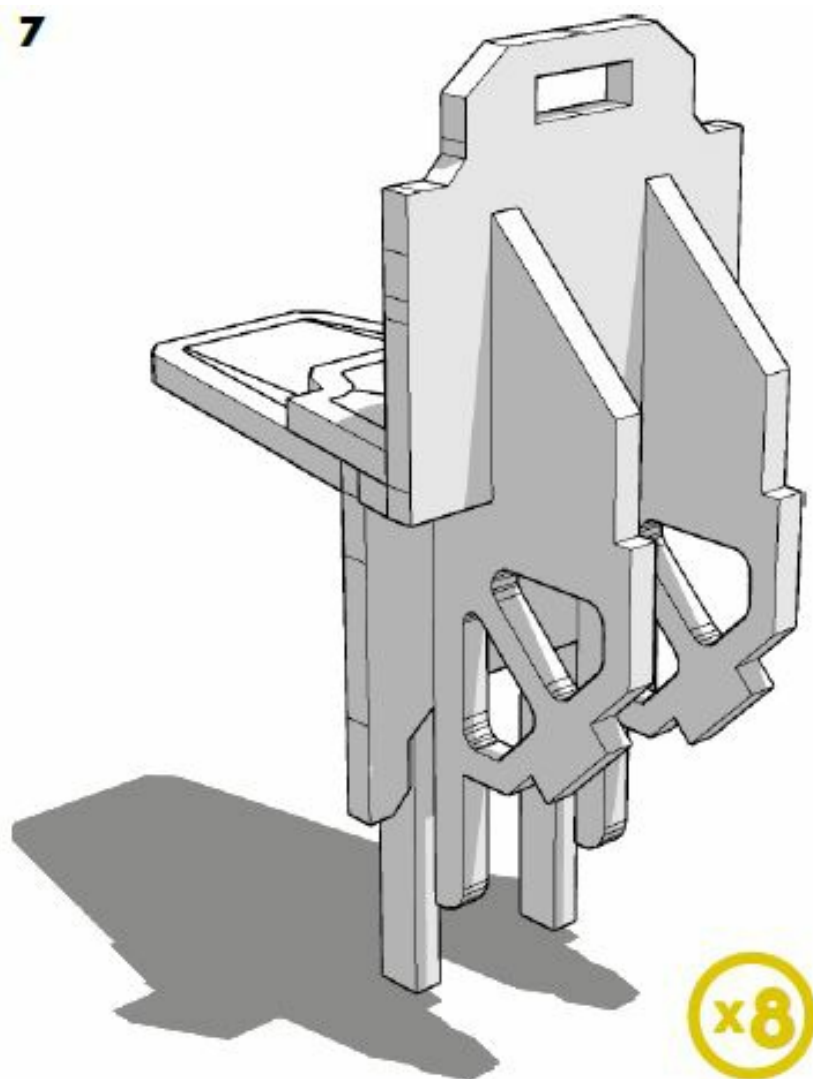

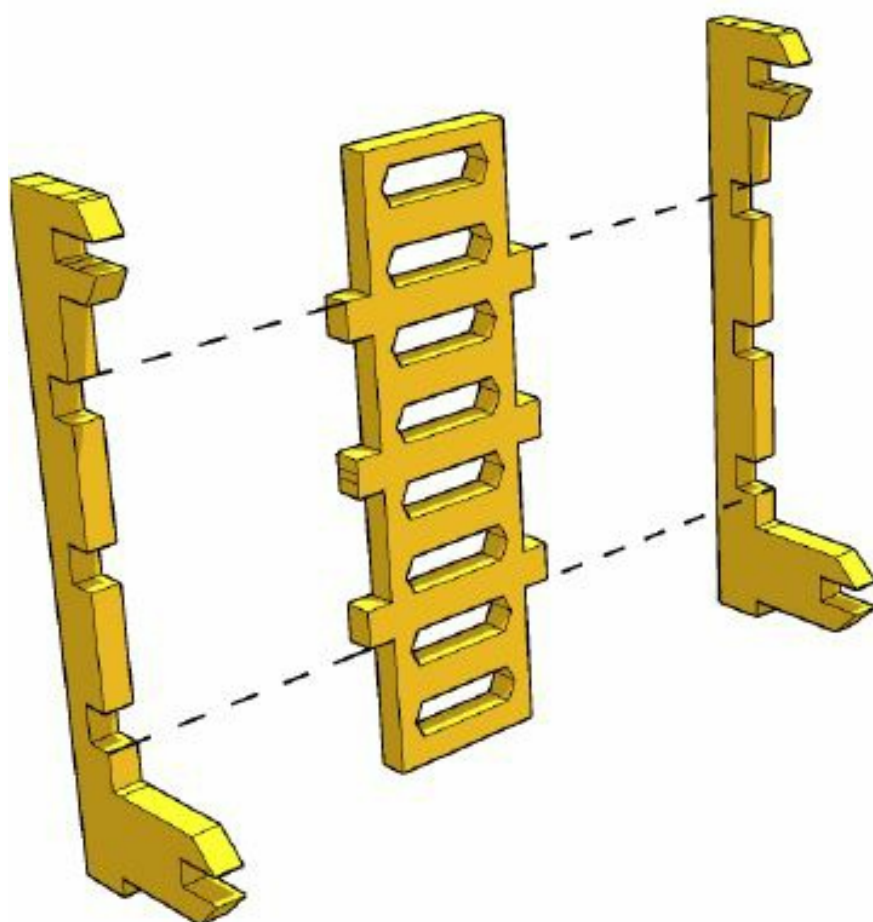



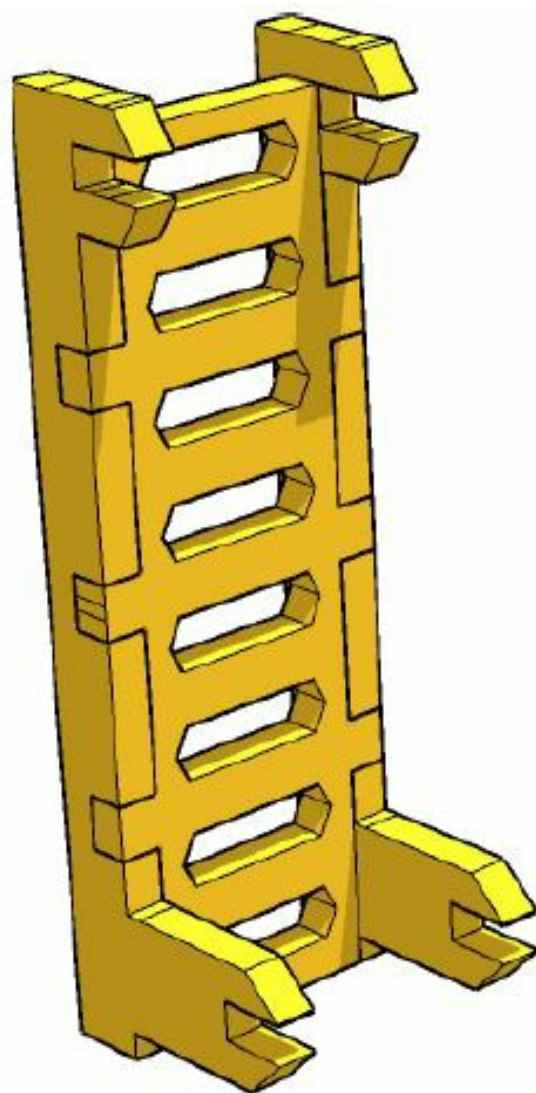

10

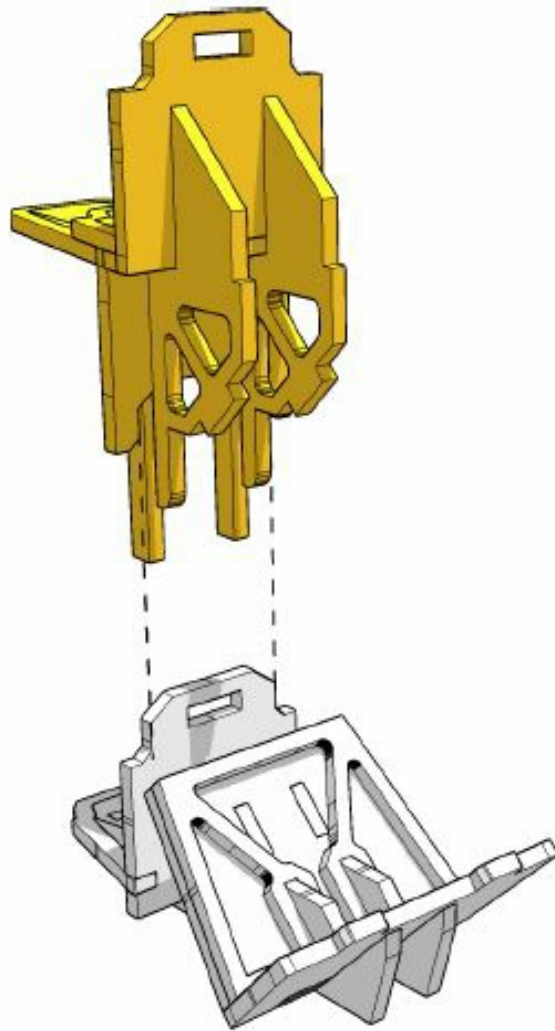

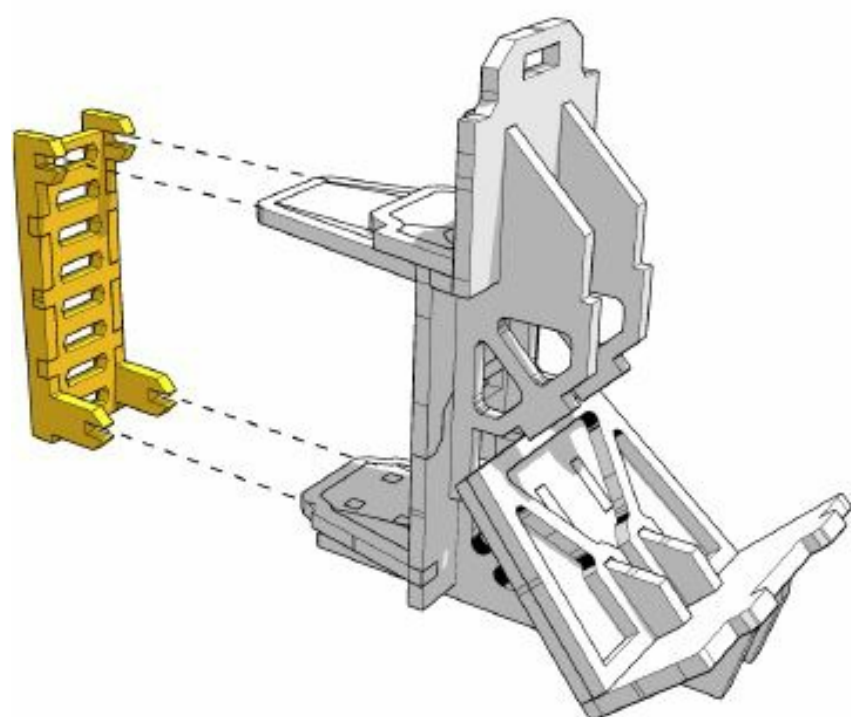

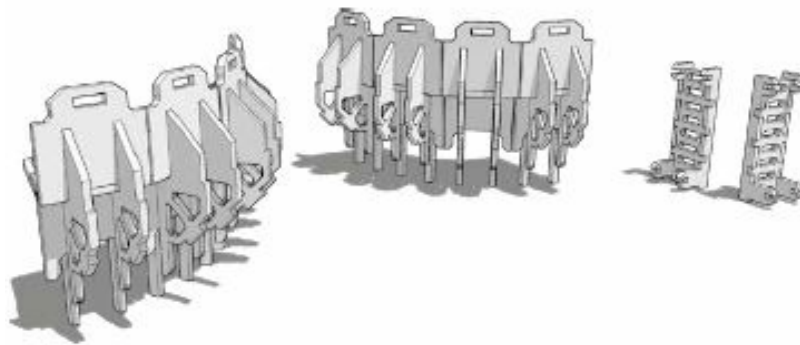

## Documents / Resources

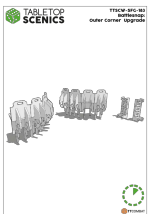

**[TT COMBAT SFG183 Sci-Fi Gothic Battlesnap Outer Corner Upgrade](#)** [pdf] Instructions  
SFG183 Sci-Fi Gothic Battlesnap Outer Corner Upgrade, SFG183, Sci-Fi Gothic Battlesnap Outer Corner Upgrade, Battlesnap Outer Corner Upgrade, Outer Corner Upgrade, Corner Upgrade, Upgrade