

TSIMSAFE WL101 7 Inch Touchscreen Multimedia Player



TSIMSAFE WL101 7 Inch Touchscreen Multimedia Player User Manual

[Home](#) » [TSIMSAFE](#) » TSIMSAFE WL101 7 Inch Touchscreen Multimedia Player User Manual 

Contents

- 1 [TSIMSAFE WL101 7 Inch Touchscreen Multimedia Player](#)
- 2 [Customer service](#)
- 3 [Features of This Product](#)
- 4 [Product Overview](#)
- 5 [Package Contents](#)
- 6 [Product Description](#)
- 7 [Specification requirements of SD card](#)
- 8 [Wiring instructions](#)
- 9 [Camera installation](#)
- 10 [Interface specification](#)
- 11 [Android Auto](#)
- 12 [Android Mirror](#)
- 13 [Troubleshooting](#)
- 14 [Product parameters](#)
- 15 [FAQ](#)
- 16 [FCC Statement](#)
- 17 [Documents / Resources](#)
 - 17.1 [References](#)
- 18 [Related Posts](#)

TSIMSAFE

TSIMSAFE WL101 7 Inch Touchscreen Multimedia Player



Customer service

Do not hesitate to get in touch with us if you meet any difficulties stalling the unit, we are always available to answer any of your questions and are more than happy to take your suggestions. We try our best to be as responsive as possible, You can always get in touch with us through: 1. Your order on Amazon, Contact Seller Service. Reply within 24 hours. 2. Email Service: mfktgtg@tsimsafe.com Reply within 24 hours.

Features of This Product



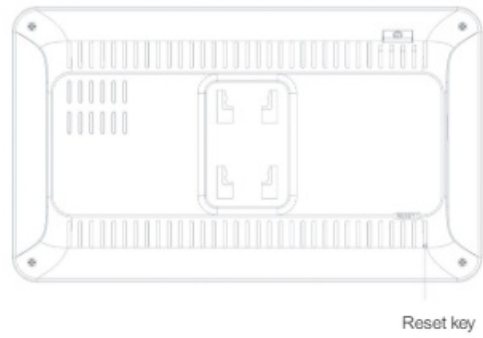
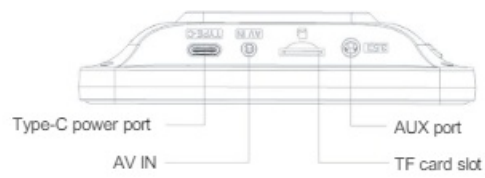

1. Support Wireless Carplay, Android Auto, Screen Mirroring
2. 1080P full HD multimedia decoder
3. Night Vision Backup Camera
4. Suitable for 12V~24V vehicles
5. BT Compatible; Voice Control
6. User-friendly Digital Control Interface
7. Support TF card & AUX IN Connectivity
8. EQ Audio Setting
9. Multiple Language Settings
10. Date and Time Setting
11. Easy installation with included mount
12. Allow transfer sound to your car's speaker

Product Overview

This portable car stereo is equipped with a sturdy adhesive mount, which can be installed on the dashboards with 90°adjustable. You don't need to disassemble the car central console, keep the car's original radio, and coexist perfectly. This 7" car multimedia player supports wireless Apple CarPlay & Android Auto, wireless mirroring, backup camera, TF card playback, voice control, BT music, AUX out, etc.



Package Contents

name	graphic	instructions	number
Car Multimedia Player		FHD display (1024*600) / touch control / Bluetooth / Wi-Fi / FM Transmitter / Type C interface power supply	1
Power cable		Type C power cable / 12V-24V / 3A current / integrated line / cigarette lighter	1
Back-up Camera		PAL (640P)	1
AUX Cable		You can use this Aux cable to transmit the audio to your car's speaker	1
Adhesive Mount		To support the display and fix it on the center console	1

Product Description

Project	Function introduction	Performance indicators
system	language	English / Simplified Chinese / French / German / Arabic / Italian / Japanese / Russian / Spanish / etc...
	Operation interface	Graphical menu operation
	Mode of operation	Touch
Video display	Real-time display	FHD IPS screen, 1024 x 600
Reverse display	Reverse display	Automatically switches to the rear view
Smart connected	Wi-Fi	Supports Apple CarPlay / Android Auto / Apple AirPlay / MirrorCast
	Bluetooth	Support Bluetooth music playback
	FM	FM Transmitter support, transmit audio to your car's speaker
Pre-content storage	SD card	Play movies and music; SD card is not included
Audio part	The microphone	Support voice control
Power part	The power input	The voltage drop line supports 12V- 24V wide voltage and has power protection circuits such as surge, overload, overvoltage, undervoltage and short circuit
Other	Working temperature	-4~149°F
	The cooling way	Passive cooling

Specification requirements of SD card

SD card can be used to store movies and music, which can be played after being inserted into the machine. please use SD cards from major brands such as SanDisk, Kingston, Toshiba, and Samsung, Speed certification must be at least Class10.

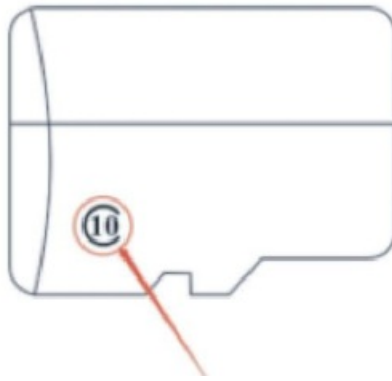

Wiring instructions



The details are as follows

Port	Instructions
Type C interface	Monitor power supply interface
Cigarette charger	<p>The cigarette lighter takes power directly</p> <p>Note: The product comes with a cigarette charger as standard. If you do not use our original charger, you need to buy a compliant high-quality cigarette charger, otherwise, it is easy to damage the machine or cause other injuries due to insufficient voltage and heat. and FM Transmitter function cannot work normally.</p>

Camera installation

Fix the camera to the rear of the car with screws, the reversing trigger wire (red thin wire) needs to be connected to the positive pole of the reversing light, and finally, use the camera extension cable to connect to the monitor.

Note: If you have any issues installing the backup camera, please contact us for help.



Interface specification

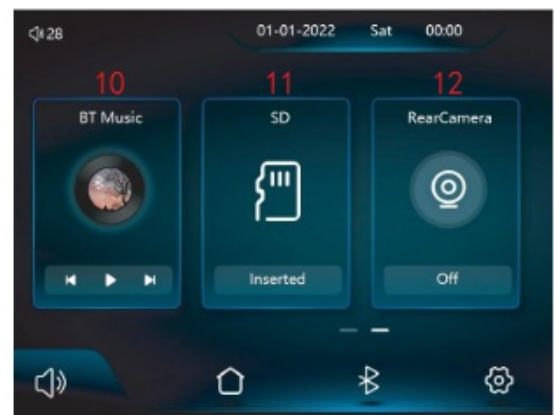
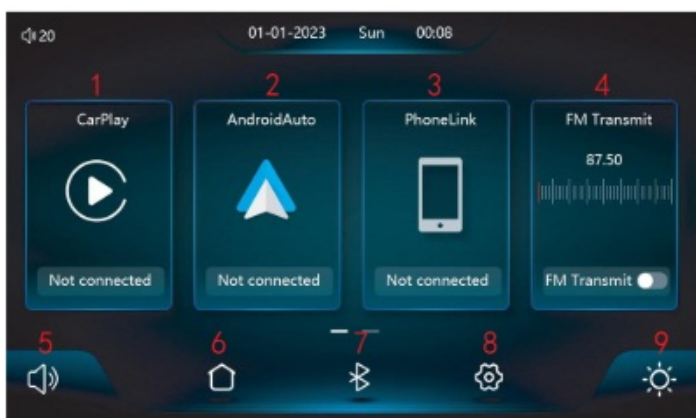

1. **CarPlay**: click to check the details of how to connect to wireless Apple carplay
2. **Android Auto**: click to check the details of how to connect to wireless Android Auto
3. **Phone Link**: Click to enter the mirroring function for iPhone and Android phones.
4. **FM Transmit**: When turned on, the device will transmit the sound to the original vehicle. (you can long-press the above icons to change the order of these icons.)
5. **Volume**: Click to adjust the volume, slide the volume bar to adjust it
6. **Menu**: Directly back to the main menu page.
7. **BT**: Click to enter the BT phone dial interface.
8. **Setup**: Click to enter the setup interface.
9. **Brightness**: tap to adjust screen brightness, slide the bar to adjust it
10. **BT Music**: Play music in Bluetooth mode
11. **SD**: View the SD card contents
12. **Rear Camera**: The screen will show a reversing image after you click this icon. (You need to connect the camera correctly.)

Apple Carplay

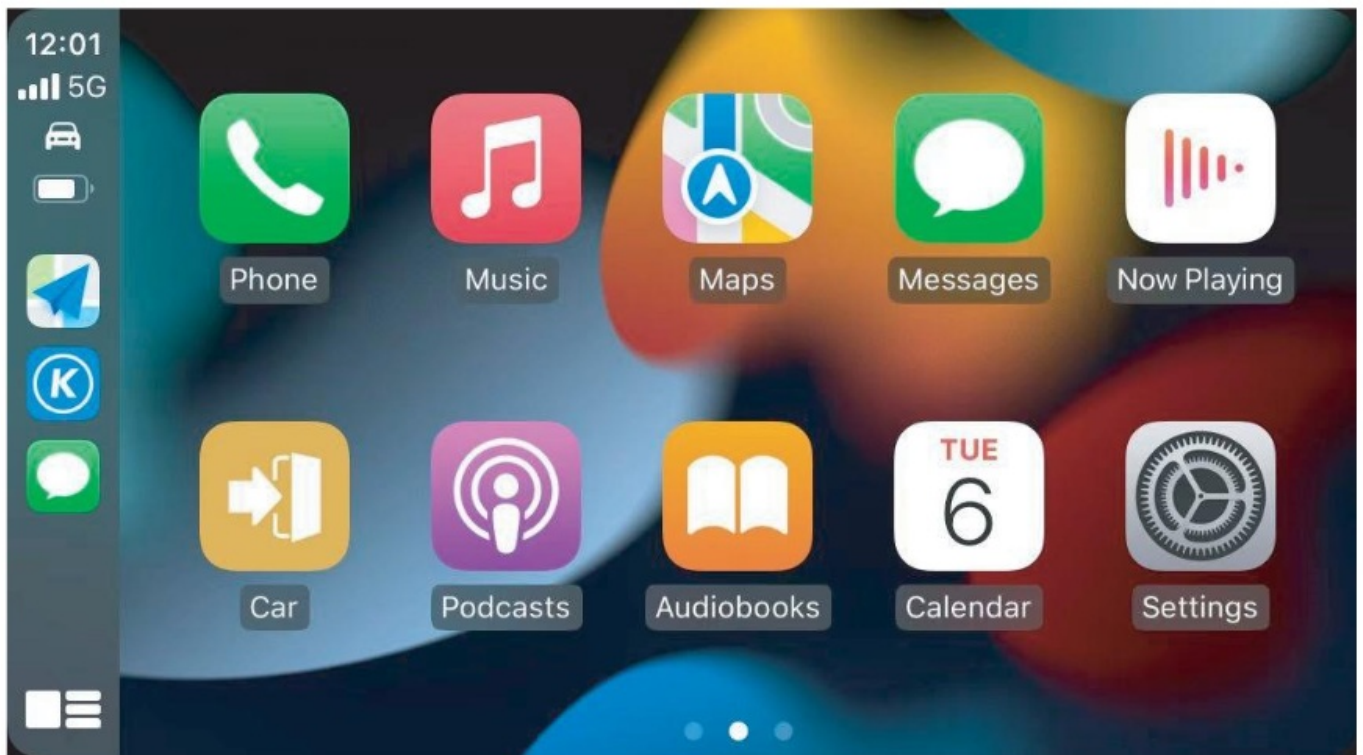

- Wireless Carplay-supported phone models that should be above IOS 9 and phone compatible with Carplay:
- iPhone 14 iPhone 14 Plus iPhone 14 Pro iPhone 14 Pro-Max iPhone 13 Pro
- iPhone 13 Pro-Max iPhone 13 iPhone 13 mini iPhone 12 Pro iPhone 12
- iPhone 12 mini iPhone 11 Pro iPhone 11 Pro Max iPhone 11 iPhone XS
- iPhone XS-Max iPhone XR iPhone X iPhone 8 iPhone 8 Plus iPhone 7
- iPhone 7 Plus iPhone 6s iPhone 6s-Plus iPhone 6 iPhone 6Plus iPhone SE
- iPhone 5s iPhone 5c iPhone 5

Note: Currently, lower versions of the IOS system may not be able to use the Carplay application. If you encounter compatibility issues with your phone's Carplay, please try upgrading the IOS system.

How to set-up

1. Click the CarPlay icon on the main menu of the car stereo.
2. Turn on the Wi-Fi and Bluetooth of the mobile phone first; Find the Bluetooth name "CarKit-xxxx" in the Bluetooth list, click to pair, (If need a pin code, try 0000)
3. The pop-up "Allow Contacts and Favorites Sync" will pop up on your iPhone, please click "Allow".
4. The pop-up "Use Carplay with "IVT" will pop up on your iPhone, please click "Use Carplay", and then the car stereo will automatically enter into the car play interface

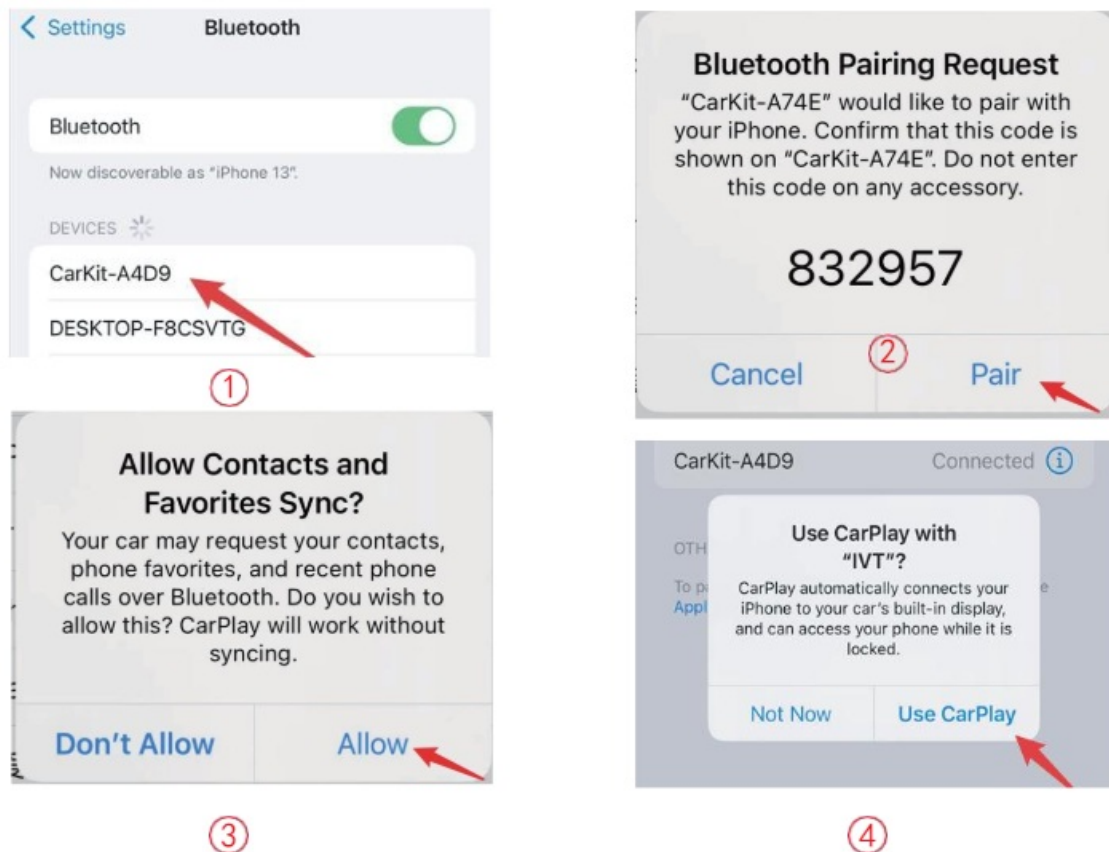

ADDITIONAL EXPLANATION

Working Principle

Wireless CarPlay uses Bluetooth to set up the connection between the phone and the vehicle and then it switches to using WiFi for the actual functionality. After the Bluetooth pairing is successful, the phone's WiFi will automatically connect to the car player's WiFi, and then disconnect the Bluetooth connection by default. When the car stereo is powered on, it will try to automatically connect to the last connected phone.

Based on the working principle of the car player, please pay attention to the following:

1. When enjoying the wireless CarPlay/Android Auto function, the phone's WiFi will be occupied by the car player, other WiFi cannot be used during this period. If there is a conflict between other WiFi and car stereo's WiFi, you may need to manually disconnect the connection of other WiFi to keep the wireless CarPlay/Android Auto use.
2. The auto-connection function of the car stereo requires you to keep the WiFi and Bluetooth of the mobile phone available. In addition, please set the WiFi network of the car stereo to "Auto-Join".
3. Since the car stereo will disconnect the Bluetooth connection after pairing, your phone's Bluetooth may automatically connect to other devices, which may cause car stereo mic input or sound playing to be unavailable. You may need to manually disconnect your phone from the other Bluetooth or switch off the Bluetooth directly to fix it. (Bluetooth plays a pairing role in the work of the car player. When the pairing is completed, it only needs WiFi to keep working, so it doesn't matter to turn off Bluetooth. But when you use it next time, you still need to turn on Bluetooth, so that the car stereo can be automatically paired and connected.)

Note: In the drop-down menu of the mobile phone, you need to click to turn off Bluetooth first, and then click the Turnoff WiFi button to disconnect. Just turn off the WiFi button alone, and the car player will keep trying to reconnect.



Android Auto



Wireless Android Auto-supported phone models that should support 5Ghz WIFI and Google service:

1. Android 11.0 or above system version,
2. Google or Samsung phones with Android 10.0
3. Samsung Galaxy S8; Galaxy S8+; Note 8 with Android 9.0

Important Note: Open Android Phone Settings – Connection Settings, Check if Android Auto exists, or search for Android Auto on the Settings page. If there is an Android Auto option, it means that the protocol connection is supported. If not, try restarting your phone and logging back into the Google Play store to see if Android Auto can be found. If it still cannot be found or cannot be installed and used properly, it may be due to local policies/laws that do not support the application. Please ensure that your country or region supports Android Auto wireless services.

How to setup

1. Click the Android Auto icon on the main menu of the car stereo.
2. Turn on the Wi-Fi and Bluetooth of the mobile phone first; Pair the new device and find the Bluetooth name “CarKit-xxxx” in the Bluetooth list, click to pair, (If need a pin code, try 0000)
3. The pop-up “Pair with CarKit-xx” will pop up on your phone, please click “Pair”.
4. The pop-up “Allow access to messages?” will pop up on your phone, please click “Allow”; and then the car player will automatically enter into the Android Auto interface. When the car player is powered on, it will try to automatically connect to the last connected phone.

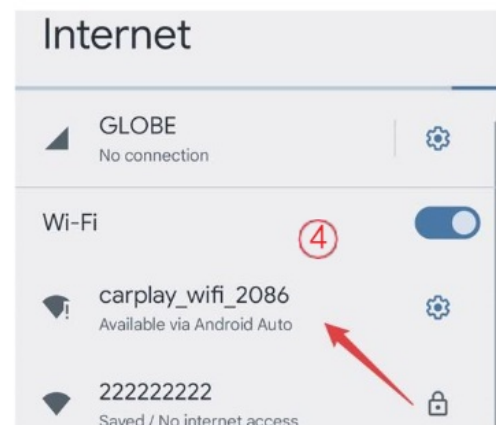
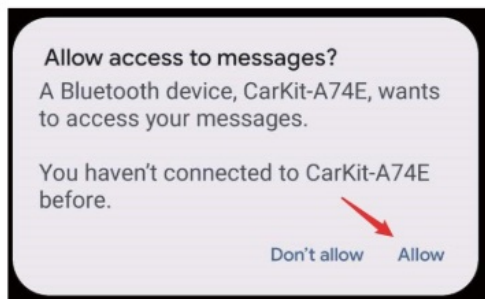
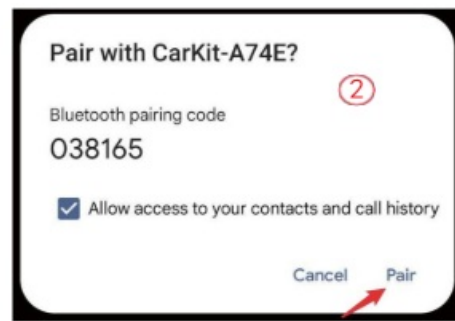
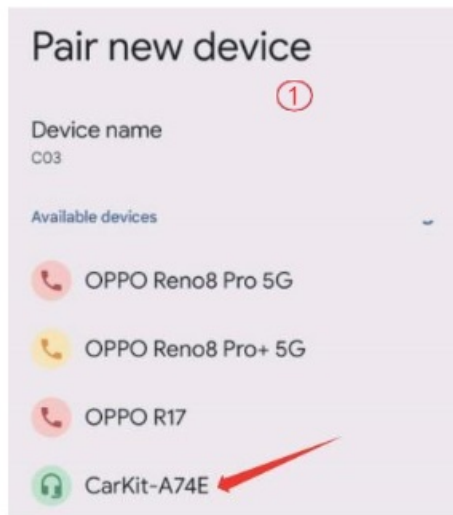

(Turn off Wi-Fi button to disconnect) After replacing the mobile phone, the connection data of the previous mobile phone will be erased.

iPhone Mirror

iPhone Mirror can transmit video, audio, and pictures from iPhone devices to car equipment. The carrier of transmission is WiFi, which is fundamentally different from Bluetooth wireless.

1. Requires an iPhone to connect to WiFi, wifi name is "carplay_wifi_xxxx"; wifi password is 12345678
2. Select Smart-screen in Screen Mirroring in the iPhone Control Center

Note: Only support iPhone

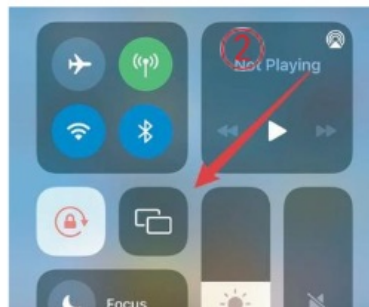
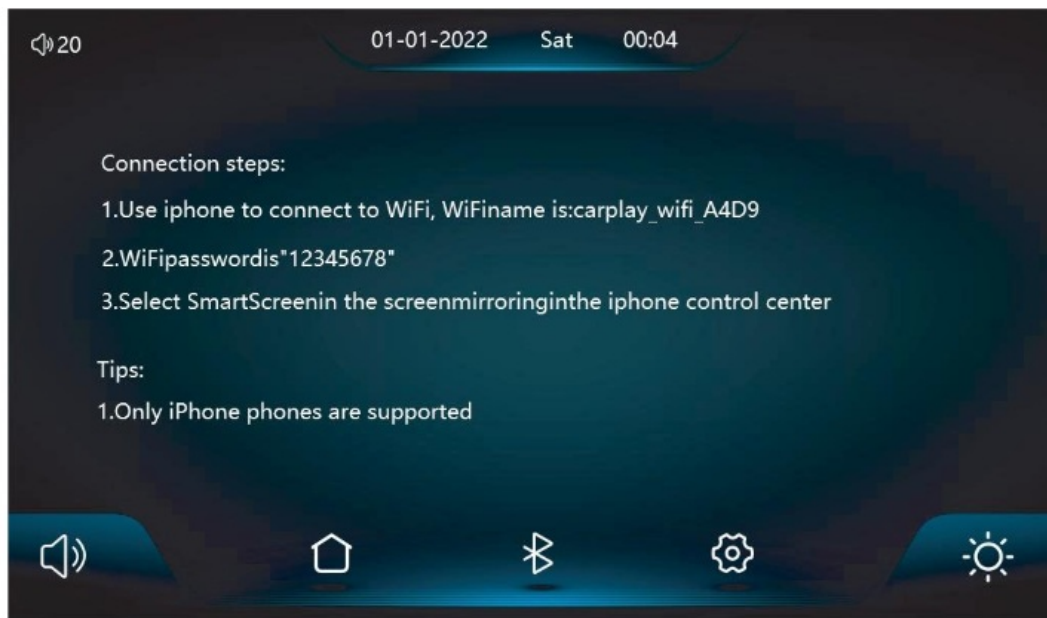

Android Mirror

It can realize the mirror projection of the mobile phone and the car machine. You need to scan the code with your Android mobile phone to download, install, and run the "Mirroring" application.

1. Click the "PhoneLink" option in the Menu, and then click the "Mirror" option under Android.
2. Scan QR code and download APK.
3. Turn on hotspots on your phone, name 'car', and set the password as 12345678
4. Open Phone Mirror APK on your phone.

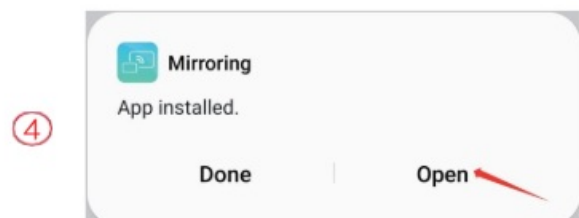
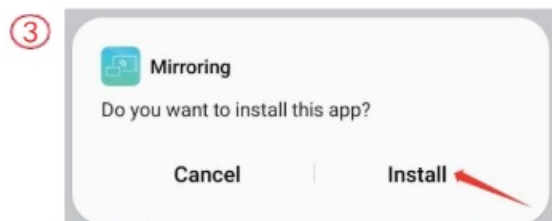
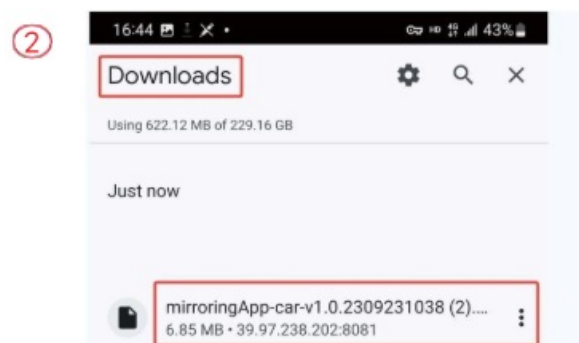
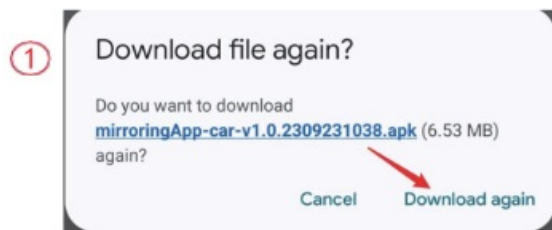

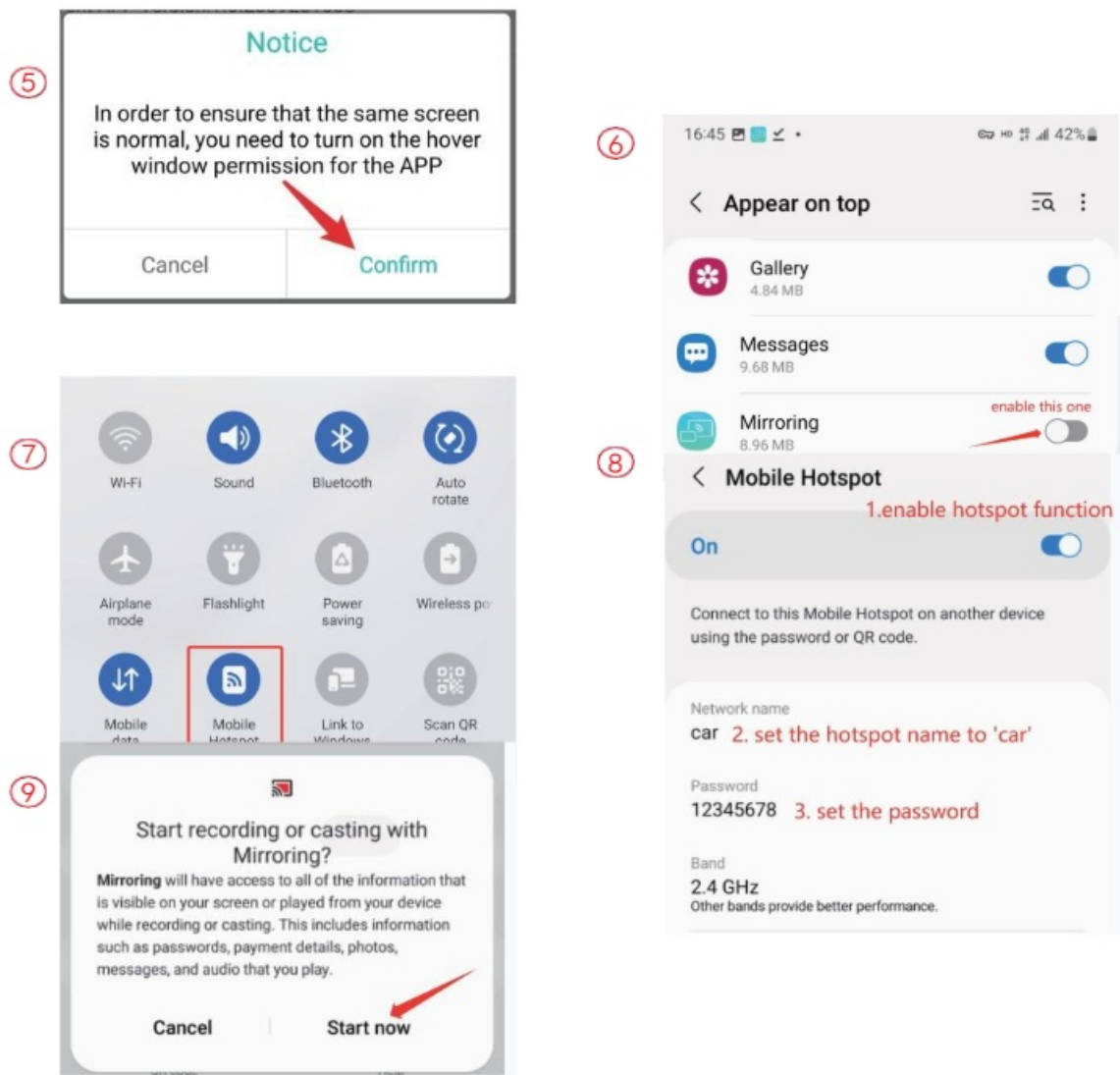

FM Transmitter

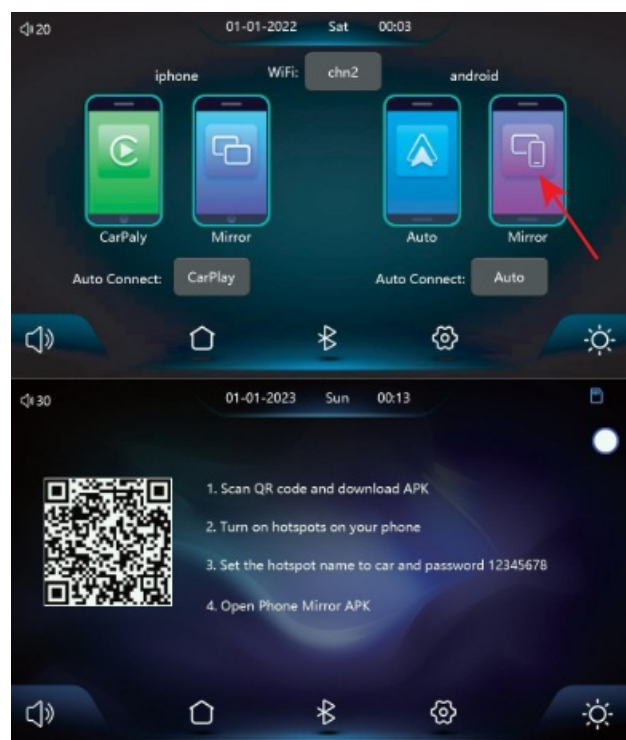

As shown in the picture, click the [FM Transmit] button to enter the FM Transmitter function: it can transfer the

sound of the car stereo to the original car audio system, and play it through the original car speakers, enjoying the original car level. When you turn on the FM Transmitter option, the monitor will no longer emit any sound. At this time, you need to turn off the FM Transmitter or match the sound to the car's built-in stereo to have sound.

Not using the original power cord will cause the FM Transmitter signal to deteriorate or the function cannot be used.









1. Click the Open device [] button.
2. Selects the frequency band to be emitted, for example, the FM 106.0 MHZ.
3. Car radio also adjusts the acceptance band to FM 106.0 MHZ.
4. Car radio can connect to the FM Transmitter signal of the upper system.

After the FM launch connection is successful, all sounds will be sent to the original car speaker for play. On behalf of FM mode, please adjust the volume on the original car

Setup

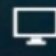

 Basic Setup	You can restore factory if the car player doesn't work as expected. You can set some parameters for the rear-view camera.
 Factory Set	The input password is "112345".
 Sound Setup	You can change the sound effect if you want, available effect: Jazz, Classic, Rock, Pop, Flat, User.
 Display settings	You can adjust the brightness, contrast, hue, saturation.
 language	Choose the language you want.
 Time Setup	Setup the time or date for the car player.
 Background	You can change the background if you need.
 Version	Check the system version of the car player.

Troubleshooting

Item	Problem	Solution
1	Unable to turn on the car player	① Check whether the DC head of the cigarette lighter power cord is damaged or aging. ② Check whether the fuse of the power plug is disconnected or burned.
2	Touch screen is not responding	① Please reset the unit to factory mode and try again. ② Please contact seller for a replacement.
3	The rear view camera has no image	① Make sure you have connected it right. ② Whether the AV IN interface is inserted to the bottom ③ Check if the camera format matches. Make sure the camera is CVBS signal and plug into the AV IN port.
4	Machine getting hot after some time use	① Avoid direct sunlight or exposure to sunlight during use. The normal operating temperature of this car player is -4 ~149 °F. After disconnecting the power supply, the temperature of this car player will be lower than 149 °F and work normally.
5	Car play cannot connect	① The first connection takes a little longer. ② Only iPhone supports Carplay. ③ Check that the WiFi and Bluetooth functions of the mobile phone are normal. ④ Enter Settings-General-Carplay vehicle, delete all records and reconnect. ⑤ Restart the iPhone and reconnect it.
6	Android Auto cannot connect	① Only Android phones are supported. ② Update Auto and related applications on mobile phones to the latest version. ③ Do not enable VPN on the mobile phone. ④ Check that the WiFi and Bluetooth functions of the mobile phone are normal.
7	The bluetooth music	① Please set the screen casting mode to Bluetooth music. Other modes do not support Bluetooth music.

Product parameters

Master control	Hight performance SOC
Wireless function	Apple Carplay / Android Auto / Apple AirPlay / Mirror Cast
Screen	IPS material, 1024*600 resolution
Storage	SD ≤ 256 G Class 10
Wireless module	WIFI, Bluetooth, FM launch module
Camera	Rear camera
Horn	2W speaker
FM emission	Supported frequency band: 87.5MHZ-108MHZ
Reversing video	Automatic reversing video display
Working voltage	12V- 24V
Power	Less than 10W
Size	190*110*22mm
Weight	320g
Material	ABS/PC

FAQ

The car stereo doesn't have sound

- Please turn off the FM transmission function.
- Please check if you set the volume to zero, or mute the radio.

Wireless Android Auto function cannot be used

Please contact the seller to update the device to the newest version Make sure your Android phone has downloaded the Mirroring app as mentioned.

I cannot see the Bluetooth of the device or I cannot connect to the Bluetooth successfully.

Please try to check if other phones have connected to the car stereo (or if other phones are trying to auto-connect to this car stereo), if yes, this situation may happen. In this case, you need to disconnect the Bluetooth or WiFi between other phones and this car stereo, and then try to connect with your desired phone.

Volume is not sufficient.

If you think the built-in speaker isn't loud enough. Please use the AUX cable to connect to your car to transfer the sound to your car speaker; you can also use the FM transmission function to transmit sound from this portable car screen to your original car audio system.

The screen gets stuck I cannot do anything or click on anything.

If the unit crashes and the screen gets stuck, please restart the unit by using a small needle to insert into the 'RESET' hole at the back of the unit. Or you can simply cut off the power and turn on the unit to try again.

How to change the bootup logo

1. Prepare an empty TF card and create a folder named 'update' in the root directory.
2. Prepare your car logo picture with a size of 1024 x 600 pixels, name it: stalogo.jpg, and put it in the update folder.
3. Insert the prepared TF card into the multimedia car player after the unit is powered on. It will automatically update the new boot logo.
4. Disconnect the power supply, and then connect the power supply again. The screen will display a new custom logo, indicating that the setting is successful.

No sound

Please check if you have turned on the FM transmission function, but your car's original radio didn't tune the same band frequency to receive the sound. Kindly note that when you turn on the FM Transmitter option, the carplay screen will no longer emit any sound. At this time, you need to turn off the FM Transmitter or tune the same band frequency on your car's original radio to receive the sound.

The player cannot turn it off by itself

Kindly note this is not the issue of the CarPlay screen. It has something related to your car. Some cars still provide power to the cigarette lighter after turning off the key. In this case, you may need to turn off the carplay screen manually or buy a 12V battery saver.

Warning

Changes or modifications to this unit not expressly approved by the party responsible for compliance could void the user's authority to operate the equipment.

NOTE

This device complies with part 15 of the FCC Rules. Operation is subject to the following two conditions: (1) This device may not cause harmful interference, and (2) this device must accept any interference received, including interference that may cause undesired operation.

FCC Statement

This equipment has been tested and found to comply with the limits for a Class B digital device, under part 15 of the FCC Rules. These limits are designed to provide reasonable protection against harmful interference in a residential installation. This equipment generates, uses, and can radiate radio frequency energy and, if not installed and used by the instructions, may cause harmful interference to radio communications. However, there is no guarantee that interference will not occur in a particular installation. If this equipment does cause harmful interference to radio or television reception, which can be determined by turning the equipment off and on, the user is encouraged to try to correct the interference by one or more of the following measures:

- Reorient or relocate the receiving antenna.
- Increase the separation between the equipment and the receiver.
- Connect the equipment to an outlet on a circuit different from that to which the receiver is connected.
- Consult the dealer or an experienced radio/TV technician for help.

The equipment complies with the FCC Radiation exposure limit set forth for uncontrolled environments. This equipment should be installed and operated with a minimum distance of 20cm between the radiator and your body.

Documents / Resources

