



TruVision M Series Fixed IP Wedge Camera Installation Guide

[Home](#) » [TruVision](#) » TruVision M Series Fixed IP Wedge Camera Installation Guide 

Contents

- [1 TruVision M Series Fixed IP Wedge Camera](#)
- [2 What's In The Box](#)
- [3 Installation environment](#)
- [4 Camera description](#)
- [5 Installation](#)
- [6 Wiring](#)
- [7 Technical specifications](#)
- [8 Legal information](#)
- [9 More Information](#)
- [10 Documents / Resources](#)
 - [10.1 References](#)
- [11 Related Posts](#)



TruVision M Series Fixed IP Wedge Camera



What's In The Box

- TVGP-M01-0201-WED-G
- TVGP-M01-0401-WED-G
- TVGP-M01-0401-WED-W
- TVGP-M01-0401-WED-B

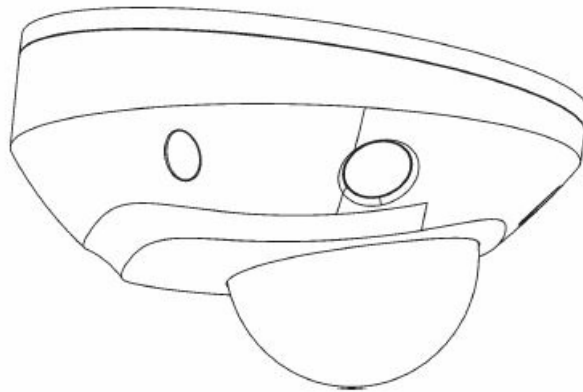

Installation environment

When installing your product, consider these factors:

- **Electrical:** Install electrical wiring carefully. It should be done by qualified service personnel. Always use a proper PoE switch, a 12 VDC UL listed Class 2, or CE certified power supply to power the camera. Do not overload the power cord or adapter
- **Ventilation:** Ensure that the location planned for the installation of the camera is well-ventilated.
- **Temperature:** Do not operate the camera beyond the specified temperature, humidity or power source ratings. The operating temperature of the indoor camera is between -30 °C to +60 °C. Humidity is 95% or less (non-condensing).
- **Servicing:** Do not attempt to service this camera yourself. Any attempt to dismantle or remove the covers from this product will invalidate the warranty and may also result in serious injury. Refer all servicing to qualified service personnel.
- **Moisture:** Do not expose the camera to rain or moisture, or try not to operate it in wet areas. Turn the power off immediately if the camera is wet and ask a qualified service person for servicing. Moisture can damage the camera and also create the danger of electric shock.

Camera description

See Figure 1 on page 2.

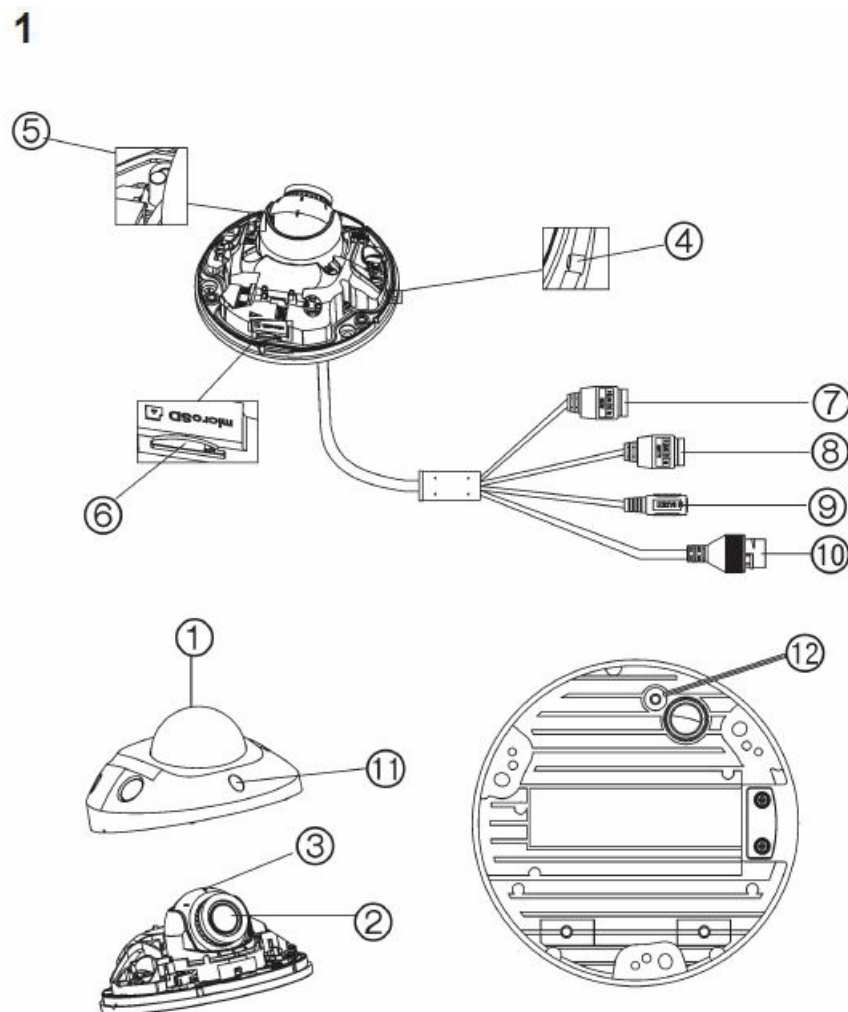

1. Housing cover
2. Lens assembly
3. Camera assembly

4. MIC (microphone)
5. Reset button
6. SD memory card slot
7. Audio 1 input / 1 output
8. Alarm 1 input / 1 output
9. 12 VDC power input
10. Network connector
11. IR illuminators
12. Ground

Installation

2

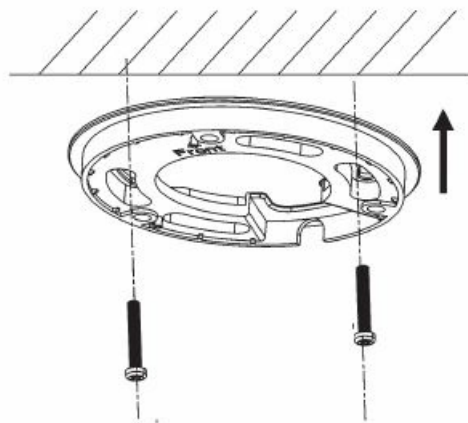
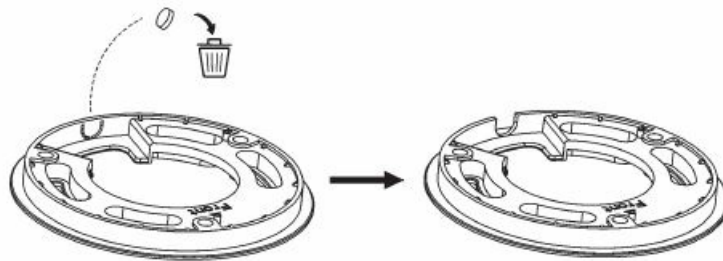

3

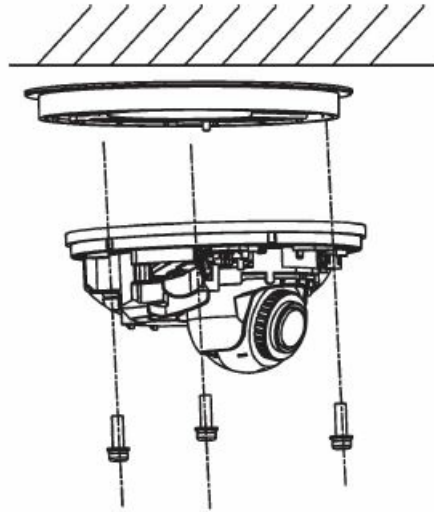

4

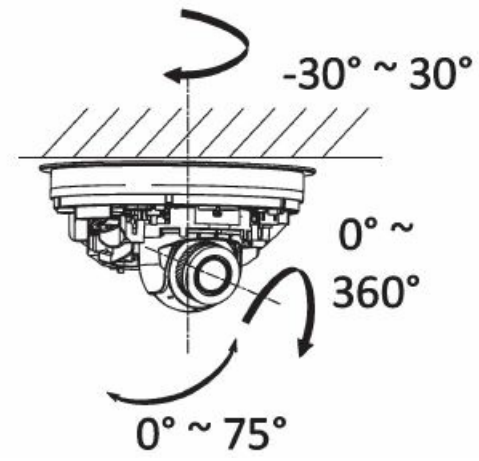

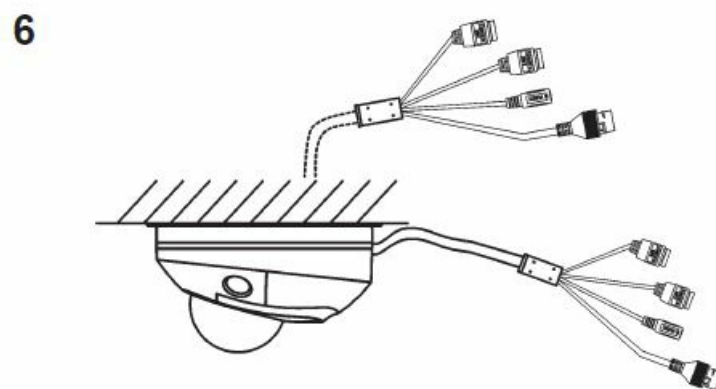
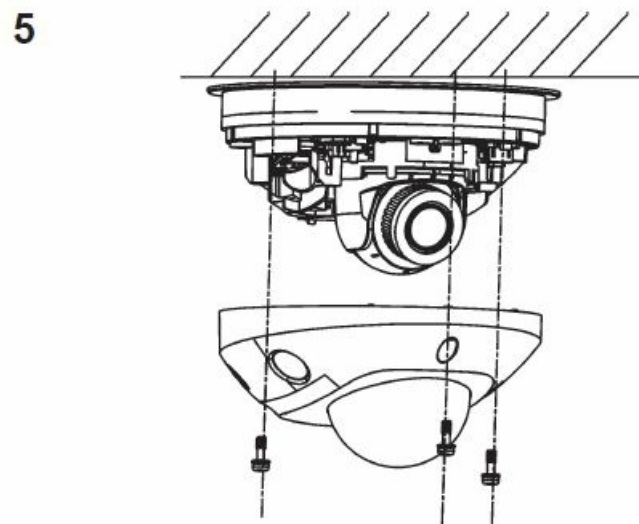

Wiring

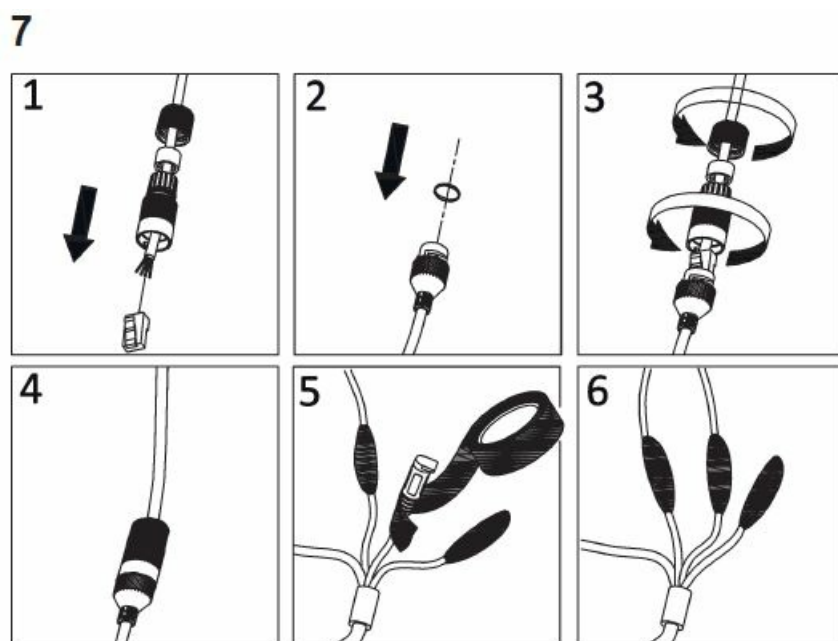

Technical specifications

Electrical	
Voltage input	12 VDC, PoE (802.3af)
Power consumption	6.5 W
Miscellaneous	
Connectors	Network Port (PoE)
Operating temperature	-30 to 60 °C
Dimensions	Ø 110 × 57 mm
Weight	380 g
Environmental rating	IP67

Legal information

© 2021 Carrier. All rights reserved. Specifications are subject to change without prior notice.

TruVision names and logos are a product brand of Aritech, a part of Carrier. Other trade names used in this document may be trademarks or registered trademarks of the manufacturers or vendors of the respective products.



While every precaution has been taken during the preparation of this manual to ensure the accuracy of its contents, Carrier assumes no responsibility for errors or omissions.

More Information



<https://firesecurityproducts.com/en/bu/video>.

Documents / Resources

<div>  </div> <div>  TruVision M Series Fixed IP Wedge Camera </div> <div> <div>EN</div> <div>Installation Guide</div> </div> <div> <div>DE</div> <div>Installationsanleitung</div> </div> <div> <div>ES</div> <div>Guía de instalación</div> </div> <div> <div>FI</div> <div>Asennusohje</div> </div> <div> <div>FR</div> <div>Guide d'installation</div> </div> <div> <div>IT</div> <div>Guida all'installazione</div> </div> <div> <div>NL</div> <div>Installatiegids</div> </div> <div> <div>PL</div> <div>Instrukcja instalacji</div> </div> <div> <div>PT</div> <div>Guia de instalação</div> </div> <div> <div>RU</div> <div>Руководство по установке</div> </div> <div> <div>TR</div> <div>Kullanım kılavuzu</div> </div> <div> <div>PRN 1000 ALL - REV B - 035 08/2021/2021</div> </div>	<div> TruVision M Series Fixed IP Wedge Camera [pdf] Installation Guide </div> <div> M Series Fixed IP Wedge Camera, M Series, Fixed IP Wedge Camera, IP Wedge Camera, We dge Camera, Camera </div>
---	---

References

- [🌐 Video & Transmission - Fire Security Products](#)

Manuals+.