

TRUclad



INSTALLATION GUIDE

Contents [[hide](#)]

- [1 Installing Cladding Horizontally](#)
- [2 Installing Cladding Vertically](#)
- [3 Documents / Resources](#)
 - [3.1 References](#)

Installing Cladding Horizontally

1.



Install wooden / aluminium or composite battens to desired area at 400mm centres.

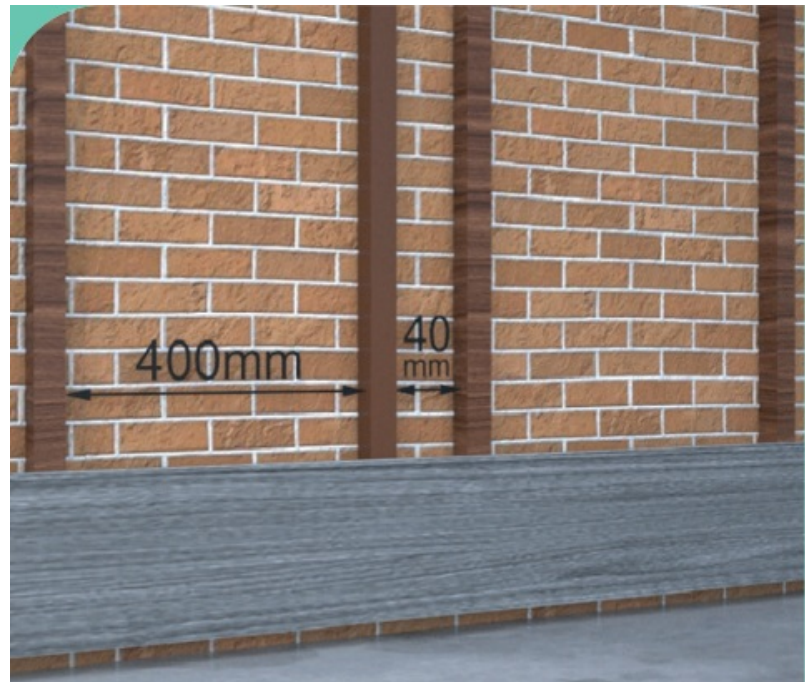

2. Please ensure where boards butt together additional battens are added as per photo.



3. Install starter bar, ensuring that it is at least 30mm from the ground.

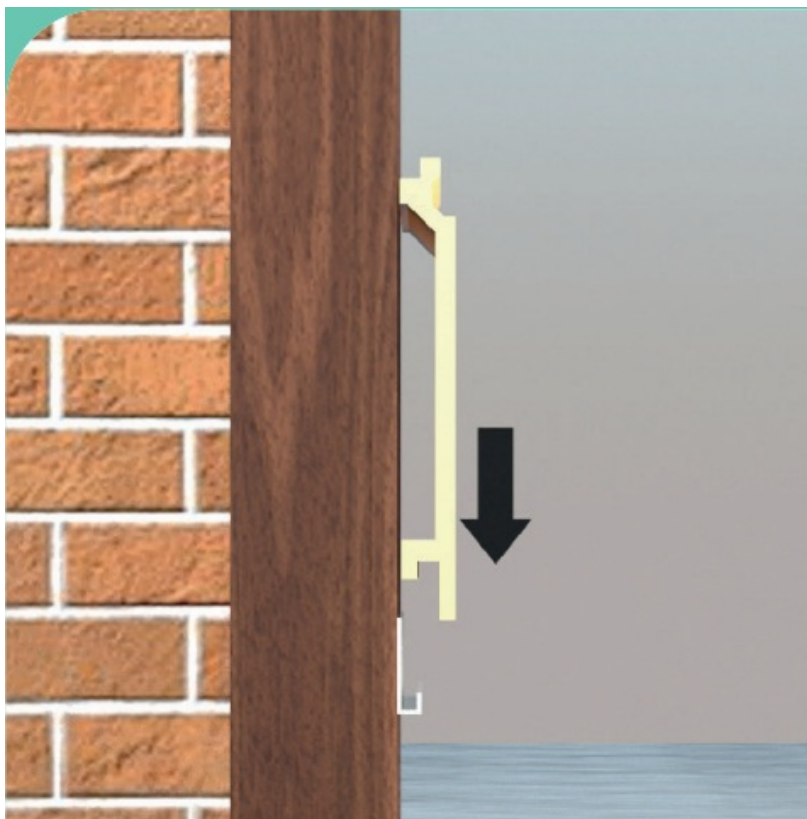

4. Now install cladding board, ensuring the cladding board is resting into the starter trim.



5. Secure cladding board in place by screwing supplied screws in pre drilled holes. Please remember not to screw to tight, TRUclad needs to be able to expand and contract.

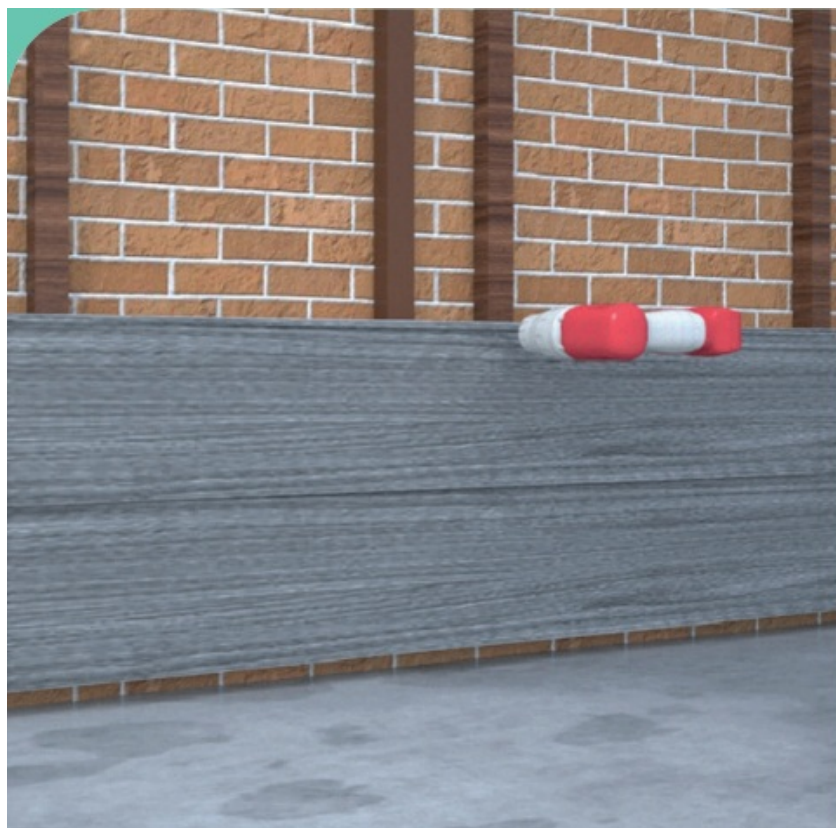

6. Repeat process to achieve desired height.



7. Finish cladding area by using angle trim, secure using coloured screws, please ensure you use countersink drill bit supplied in order to pre drill holes.

TRUclad is owned by Falcon Timber, a Consolidated Timber Holdings Group Member. Falcon Timber Ltd will take no responsibility for installation issues that arise where installer(s) have not followed the installation guide, resulting in the warranty being voided.

Falcon Timber Ltd will take no responsibility for scratching and/or poor maintenance of TRUclad composite cladding.

For more information please visit www.falcon-timber.com or email truclad@falcon-timber.com

Installing Cladding Vertically

- 1.



Install wooden / aluminium or composite battens to desired area at 400mm centres.



2. Please ensure where boards butt together additional battens are added as per photo.



3. Install starter bar, ensuring that it is at least 30mm from the ground.



4. Now install cladding board, ensuring the cladding board is resting into the starter trim.

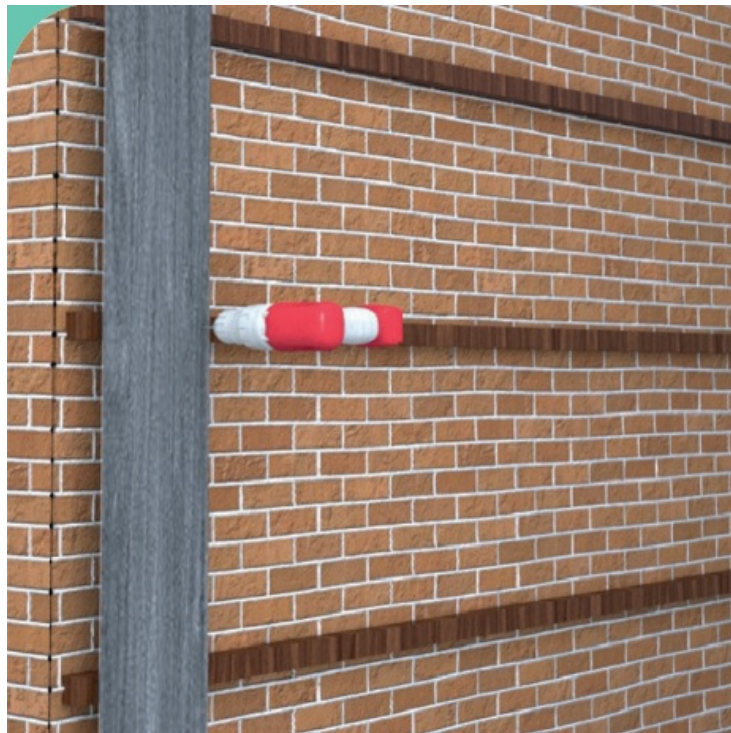

5. Secure cladding board in place by screwing supplied screws in pre drilled holes. Please remember not to screw to tight, TRUclad needs to be able to expand and contract.



6. Repeat process to achieve desired length.

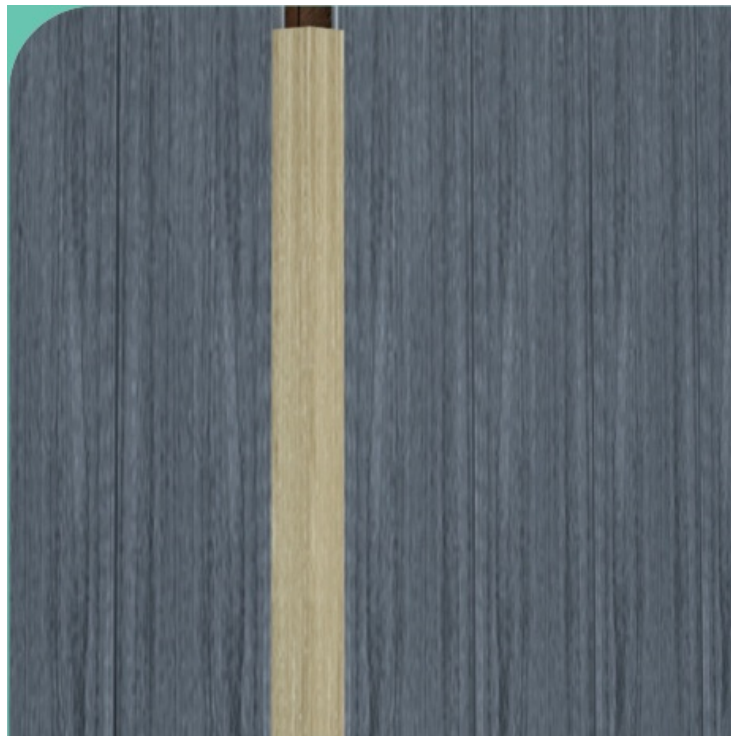

7. Finish cladding area by using angle trim, secure using coloured screws, please ensure you use countersink drill bit supplied in order to pre drill holes.

TRUclad is owned by Falcon Timber, a Consolidated Timber Holdings Group Member. Falcon Timber Ltd will take no responsibility for installation issues that arise where installer(s) have not followed the installation guide, resulting in the warranty being voided.

Falcon Timber Ltd will take no responsibility for scratching and/or poor maintenance of TRUclad composite cladding.

For more information please visit www.falcon-timber.com or email truclad@falcon-timber.com

For more details and technical information about TRUclad – please get in touch with your local distributor.



TRUclad is owned by Falcon Timber, a Consolidated Timber Holdings Group Member

For more information, please visit www.falcon-timber.com

Falcon Timber Ltd reserves the right to alter specifications without notice.

Documents / Resources



[TRUclad Composite Cladding \[pdf\]](#) Installation Guide

Composite Cladding, Cladding

References

- [User Manual](#)

📁 Cladding, Composite Cladding,

📁 TRUclad TRUclad

Leave a comment

Your email address will not be published. Required fields are marked *

Comment *

Name

Email

Website

☐ Save my name, email, and website in this browser for the next time I comment.

Post Comment

Search:

e.g. whirlpool wrf535swhz

Search

[Manuals+](#) | [Upload](#) | [Deep Search](#) | [Privacy Policy](#) | [@manuals.plus](#) | [YouTube](#)

This website is an independent publication and is neither affiliated with nor endorsed by any of the trademark owners. The "Bluetooth®" word mark and logos are registered trademarks owned by Bluetooth SIG, Inc. The "Wi-Fi®" word mark and logos are registered trademarks owned by the Wi-Fi Alliance. Any use of these marks on this website does not imply any affiliation with or endorsement.