

**TRU
BLOCKOUT**
Push 15 Remote,
Push Pro Remote
TruBlockout Motor



TRU BLOCKOUT Push 15 Remote, Push Pro Remote TruBlockout Motor Instruction Manual

[Home](#) » [TRU BLOCKOUT](#) » TRU BLOCKOUT Push 15 Remote, Push Pro Remote TruBlockout Motor Instruction Manual 

Contents

- 1 TRU BLOCKOUT Push 15 Remote, Push Pro Remote TruBlockout Motor
- 2 Specifications
- 3 General Information
- 4 Programming
- 5 Pair the motor with the controller
- 6 Check the motor direction
- 7 Set Limits
- 8 Adjust the upper limit
- 9 Set a favorite position
- 10 Decrease Motor Speed
- 11 Turn Charging LED ON/OFF
- 12 SLEEP MODE
- 13 TROUBLESHOOTING
- 14 Frequently Asked Questions
- 15 Documents / Resources
 - 15.1 References



TRU BLOCKOUT Push 15 Remote, Push Pro Remote TruBlockout Motor



Specifications

- **Product Name:** TruBlockout Motor
- **Website:** www.trublockout.com.au
- **Programming Options:** Push 15 Remote, Push Pro Remote
- **Programming Date:** 1st July 2024

General Information

Please read the installation instructions and programming instructions completely prior to proceeding with installation and programming. This mapping-out process will reduce set-up time and make the installation easier. Decide the Channels and or additional Remotes to be assigned to each TruBlockout blind in the installation. Have the necessary Remotes and controls ready prior to proceeding. Each TruBlockout blind should be completely programmed before moving to the next. Be prepared to stop the TruBlockout blind during programming. The TruBlockout blind will move continuously during some of these steps. You will need to be prepared to stop the motor using the Remote control. Failure to do so may result in blindness or motor damage. Motors with built-in batteries that are not being programmed should remain, or be put into Sleep mode to avoid possible interference with the motor being programmed. All Motors programmed to the same RF channel will operate at the same time. If you want individual control of the Motor, you must use separate Channels on Multi-channel Remotes or separate single-channel Remotes. Remote controls are generally considered to be dummy devices as they do not store any motor or programming information. The Motors are the intelligent devices that store the TruBlockout blind operation limits in their memory. The Motors also memorise the specific Remotes or Channels assigned to control them. Motor...The program button (P1 Button) is on the Motor head alongside the Micro-USB charging port. There is also a small LED light right near the programming button.

Programming

Establish Communication & Pairing

Motor state test

This table describes the function of a short P1 Button press/release (<2 seconds) depending on the current motor

configuration.

P1 Press	Condition	Function Achieved	Visual Feedback	Audible Feedback	Function Described
Short Press	If limit is NOT set	None	No Action	None	No Action
	If limits are set	Operational control of motor, run to limit. Stop if running	Motor Runs	None	Operational control of motor after pairing and limit setting is completed first time
	If motor is in "Sleep Mode" & limits are set	Wake and control	Motor wakes and runs in a direction	None	Motor is restored from Sleep Mode and RF control is active

Motor configuration options

The P1 Button is utilized to administer motor configurations as described below. Hold P1 button on motor head.

Hold **P1** button on motor head.

Activate Pairing Mode



Sleep Mode



Reverse Direction

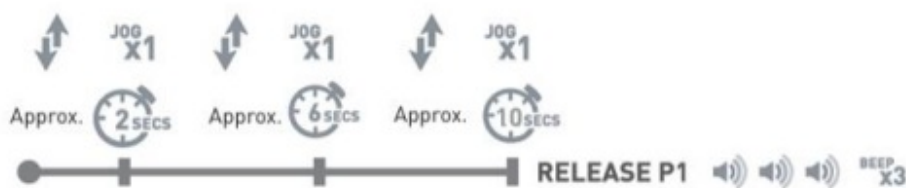

Reset To Factory Settings

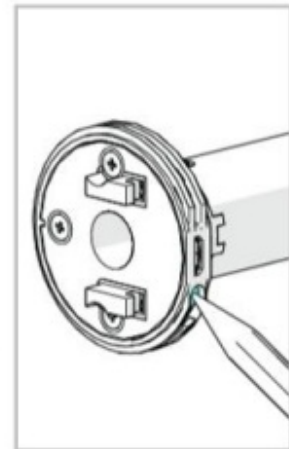

P1 button on

Pair the motor with the controller

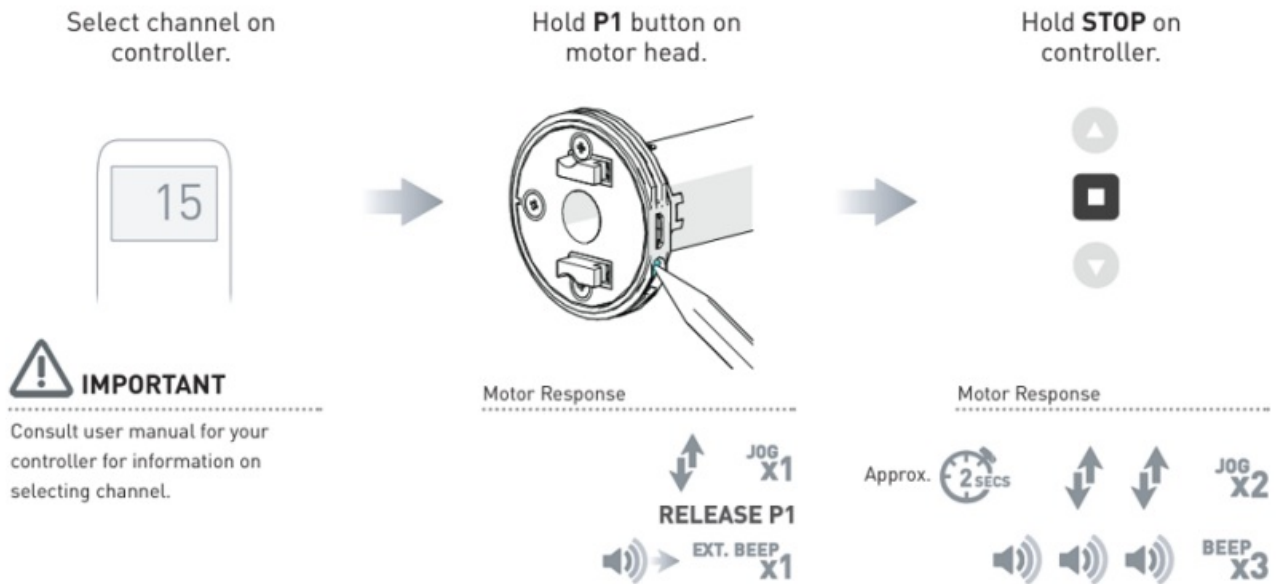

IMPORTANT

Consult the user manual for your controller for information on selecting a channel.

- Motor is now in step mode and ready for setting limits

Check the motor direction

- To check the travel direction of the shade, press UP or DOWN on the controller.
- To reverse shade direction, hold both UP and DOWN. Until the motor responds



- Quick Press = Step
- Long Press = Continuous Travel



IMPORTANT

Damage to the shade may occur when operating the motor prior to setting limits. Attention should be given.

IMPORTANT

Reversing motor direction using this method is only possible during initial setup.

Set Limits

IMPORTANT

Cycle shade up and down prior to setting limits to settle the fabric.

- To save the upper limit, hold UP and STOP.



- Move the shade to the desired highest or lowest position by pressing the UP or DOWN buttons on the controller.

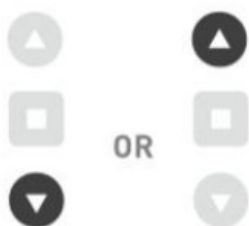

Motor Response

Approx. 5 SECS



- Move the shade to the desired highest or lowest position by pressing the UP or DOWN buttons on the controller.
- To save the lower limit, hold DOWN and STOP.

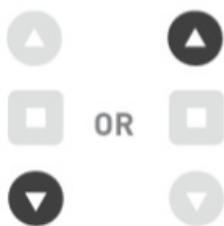

Motor Response

Approx. 5 SECS



IMPORTANT

After setting limits, the motor will automatically exit from the initial set-up mode.

Adjust the upper limit

- Hold UP and STOP on the controller.
- Move the shade to the desired highest position by pressing the UP or DOWN button.
- To save the upper limit, hold UP and STOP.

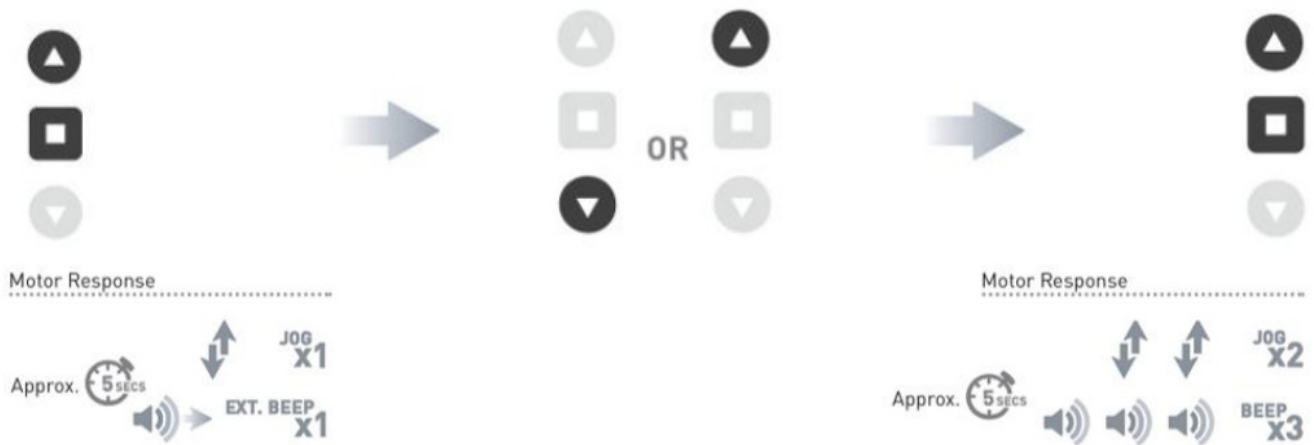

Adjust lower limit

- Hold DOWN and STOP on the controller.
- Move shade to the desired lowest position by pressing the UP or DOWN button.
- To save the lower limit, hold DOWN and STOP.



Using P2 Button on existing controller to add a new controller or channel

- A = Existing controller or channel (to keep)
- B = Controller or channel to add or remove
 - Press P2 on controller A.
 - Press P2 on controller A.
 - Press STOP on a new controller to add it.



Using a pre-existing controller to add or delete a controller or channel

- A = Existing controller or channel (to keep)
- B = Controller or channel to add or remove
 - Press P2 on controller A.
 - Press P2 on controller A.
 - Press P2 on the controller B to remove

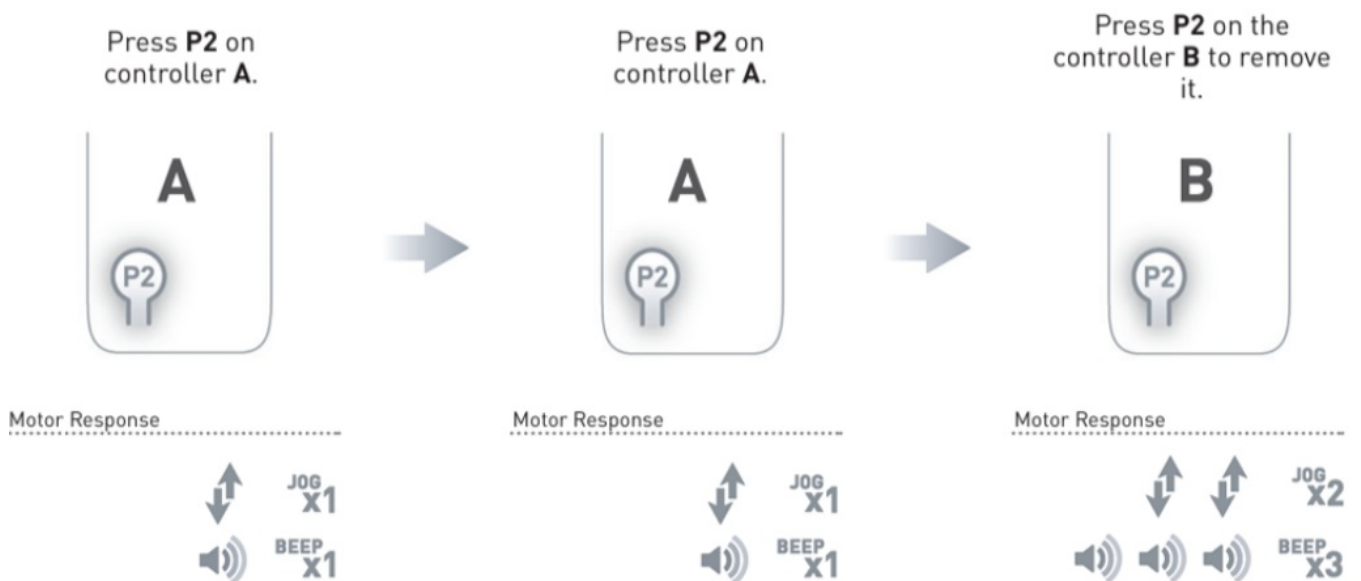

Set a favorite position

Move the shade to the desired position by pressing the UP or DOWN button on the controller.

Move shade to the desired position by pressing the **UP** or **DOWN** button on the controller.

Press **P2** on controller.



Press **STOP** on controller.

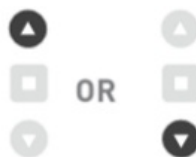

Press **STOP** on controller.



Motor Response



Motor Response



Motor Response



Send shade to favorite position



Delete favorite position

- Press P2 on the controller.
- Press STOP on the controller.
- Press STOP on the controller.

Press **P2** on controller.



Press **STOP** on controller.



Press **STOP** on controller.



Motor Response



Motor Response



Motor Response



Increase Motor Speed

Default motor mode is the slowest speed.

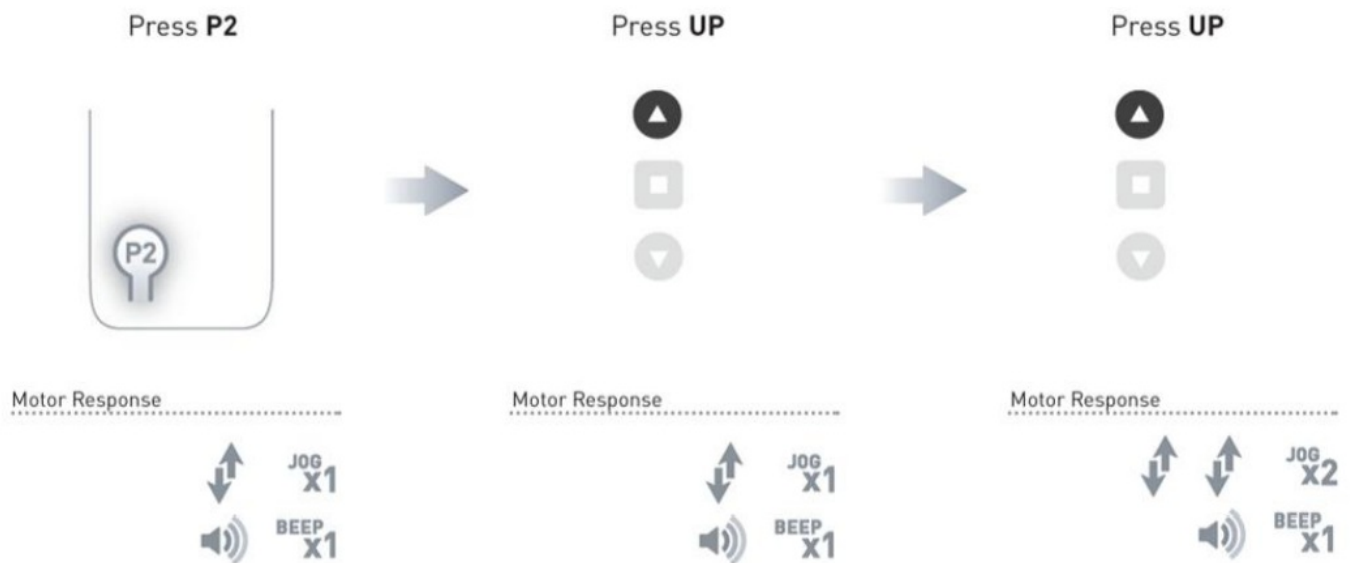

Decrease Motor Speed

- Press P2
- Press DOWN
- Press DOWN



Turn Soft Stop OFF

Motor must be in slowest speed to turn Soft Stop OFF.

Press **P2**



Press **DOWN**



Press **DOWN**



Motor Response



Motor Response



Motor Response



Turn Soft Stop ON

Motor must be in fastest speed to turn Soft Stop ON.

Press **P2**



Press **UP**



Press **UP**



Motor Response



Motor Response



Motor Response

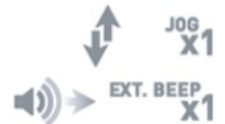

Send Shade to battery charge level

- Shade must be at Upper Limit.

Shade must be at Upper Limit.

Hold **UP**



Motor Response

Approx. 5 SEC

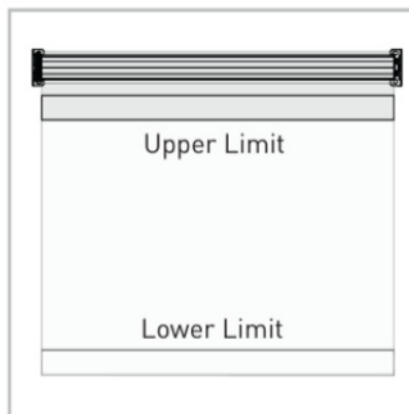

Shade must be at Upper Limit
Hold **UP** for Approx. 5s

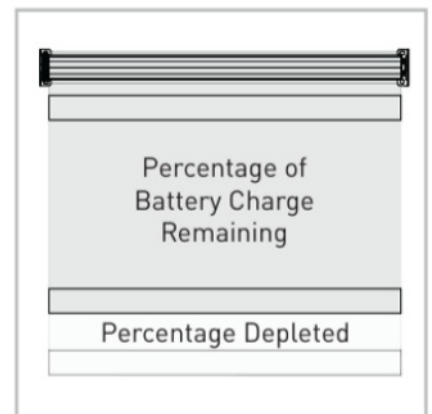

Shade moves to percentage of
battery charge remaining

NOTE: This feature is can only be used with a DC motor when it is using a Battery Pack as its power source.

Turn Charging LED ON/OFF

The motor must be at the Lower Limit.

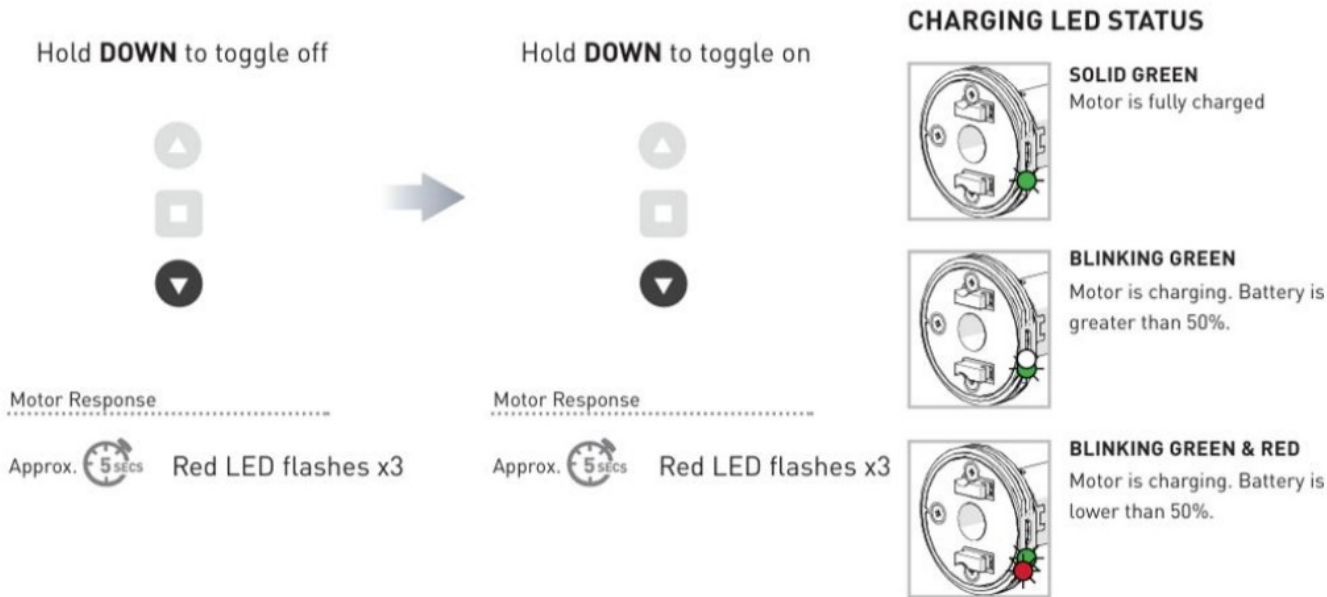

CHARGING LED STATUS



SOLID GREEN
Motor is fully charged



BLINKING GREEN
Motor is charging. Battery is greater than 50%.



BLINKING GREEN & RED
Motor is charging. Battery is lower than 50%.

SLEEP MODE

If multiple motors are grouped on a single channel, Sleep Mode may be used to put all but 1 motor to sleep, allowing programming of just the one motor that remains “Awake”. See page 6 for detailed P1 functions.

Enter Sleep Mode

Sleep mode is utilized to prevent a motor from incorrect configuration during another motor setup.



Hold P1 button on the motor head

Motor Response



Exit Sleep Mode: Method 1

- Exit sleep mode once the shade is ready.
- Press and release P1 button on the motor head

Exit Sleep Mode: Method 2

Remove power and then repower the motor.

TROUBLESHOOTING

Problem	Cause	Remedy
Motor is not responding	Battery in motor is depleted	Recharge with a compatible charger
	Insufficient charging from solar PV panel	Check connection and orientation of PV panel
	Transmitter battery is discharged	Replace battery
	Battery is inserted incorrectly into transmitter	Check battery polarity
	Radio interference/shielding	Ensure transmitter is positioned away from metal objects and the aerial on motor or receiver is kept straight and away from metal
	Receiver distance is too far from transmitter	Move transmitter to a closer position
	Charging failure	Check power supply to motor is connected and active
Motor beeps x10 when in use	Battery voltage is low	Recharge with a compatible charger
Cannot program a single motor (multiple motors respond)	Multiple motors are paired to the same channel	Always reserve an individual channel for programming functions. Use Sleep Mode to program individual motors.

Frequently Asked Questions

Q: What should I do if the blind keeps moving continuously during programming?

A: Be prepared to stop the blind using the Remote control to prevent any potential damage to the blind or motor.

Q: How can I ensure individual control of each Motor?

A: Use separate Channels on Multi-channel Remotes or separate single-channel Remotes for individual control of each Motor.

Q: Do Remote controls store programming information?

A: No, Remote controls are considered dummy devices; Motors store operation limits and assigned control information.

Documents / Resources

	<p>TRU BLOCKOUT Push 15 Remote, Push Pro Remote TruBlockout Motor [pdf] Instruction Manual</p> <p>Push 15 Remote, Push Pro Remote, Push 15 Remote Push Pro Remote TruBlockout Motor, Push 15 Remote Push Pro Remote, TruBlockout Motor, Motor</p>
---	---

References

- [User Manual](#)

Manuals+, Privacy Policy

This website is an independent publication and is neither affiliated with nor endorsed by any of the trademark owners. The "Bluetooth®" word mark and logos are registered trademarks owned by Bluetooth SIG, Inc. The "Wi-Fi®" word mark and logos are registered trademarks owned by the Wi-Fi Alliance. Any use of these marks on this website does not imply any affiliation with or endorsement.