



TROY-BILT TB22 Curved Shaft String Trimmer User Guide

[Home](#) » [TROY-BILT](#) » TROY-BILT TB22 Curved Shaft String Trimmer User Guide 



NEED HELP? CALL 1-800-828-5500

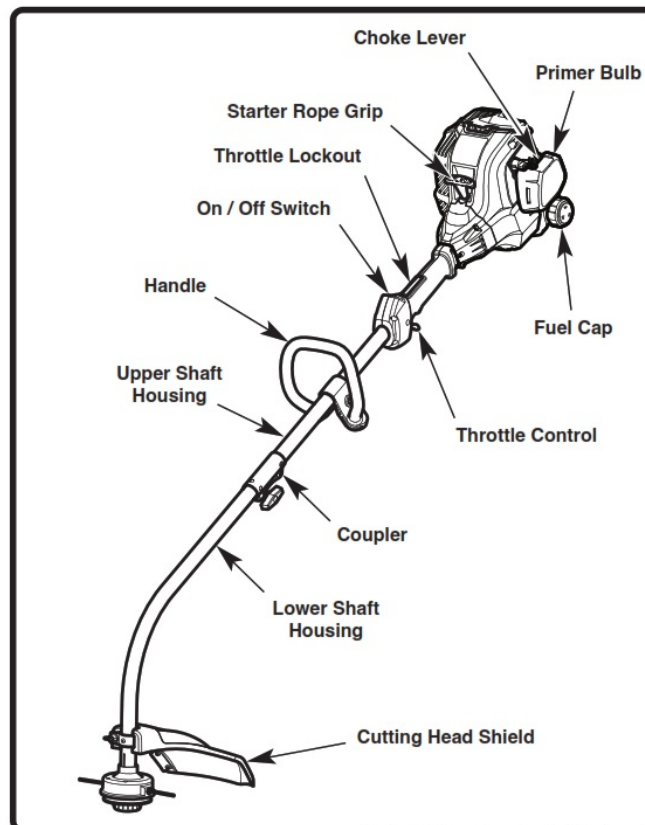

Contents

1 ASSEMBLY TOOLS

REQUIRED

2 ASSEMBLY

3 STARTING

4 Documents / Resources

5 Related Posts

ASSEMBLY TOOLS REQUIRED

- Flat-head screwdriver

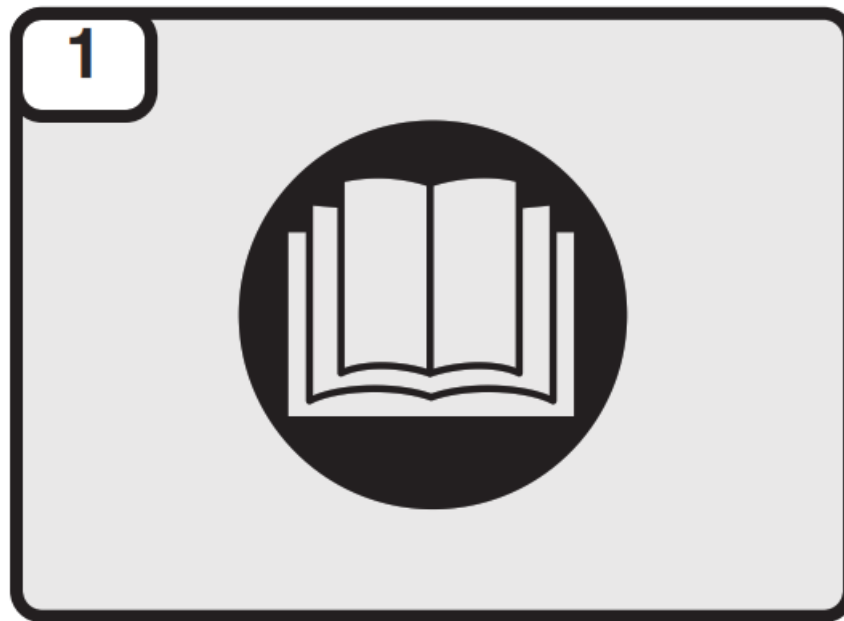

Read the operator's manual thoroughly before operating the unit. Follow all warnings and safety instructions. This fast guide is intended as a reference for users that have already read the operator's manual and are familiar with the necessary safety precautions.

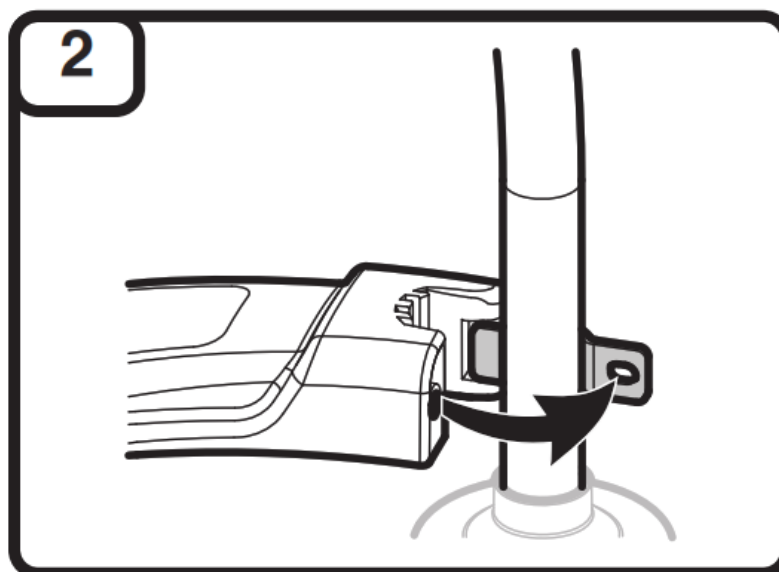

ASSEMBLY

Insert the short tab (the one without a hole) on the mount bracket into the slot on the cutting head shield. Rotate

the cutting head shield counterclockwise.

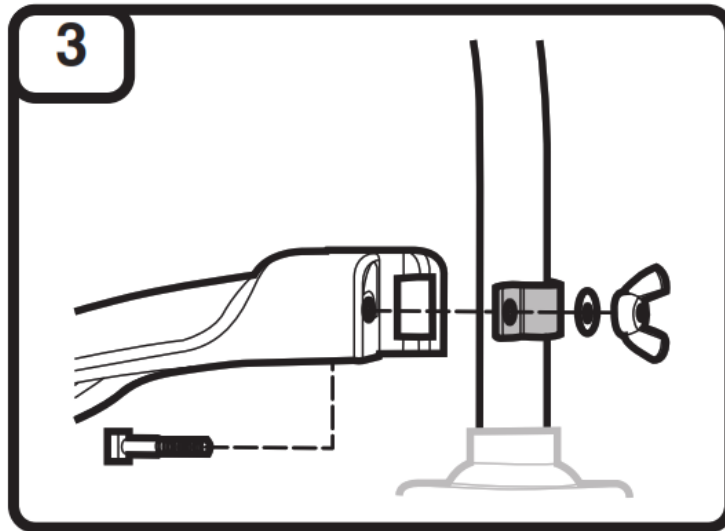

Insert the square bolt into the hole underneath the cutting head shield. Push the square bolt through the cutting head shield and mount bracket. Place the washer and wing nut onto the square bolt. Tighten the wing nut securely.

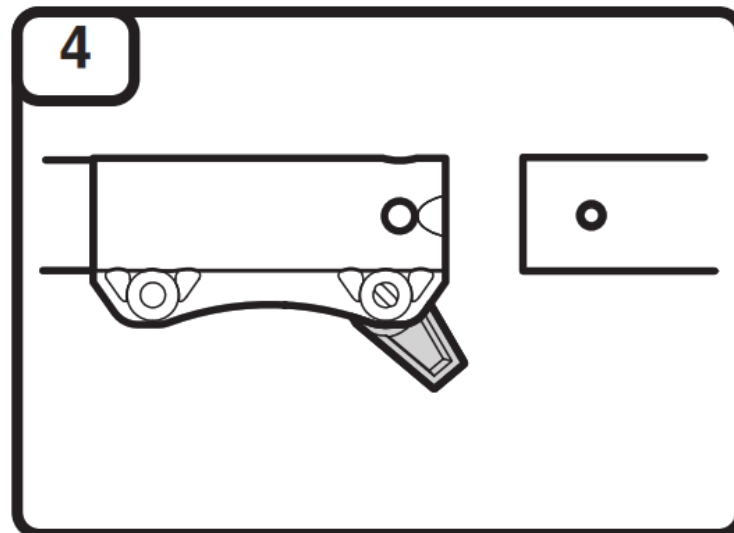

Remove the hanger cap from the attachment. If present, remove the gray spacer from the coupler. Turn the knob counterclockwise to loosen the couple

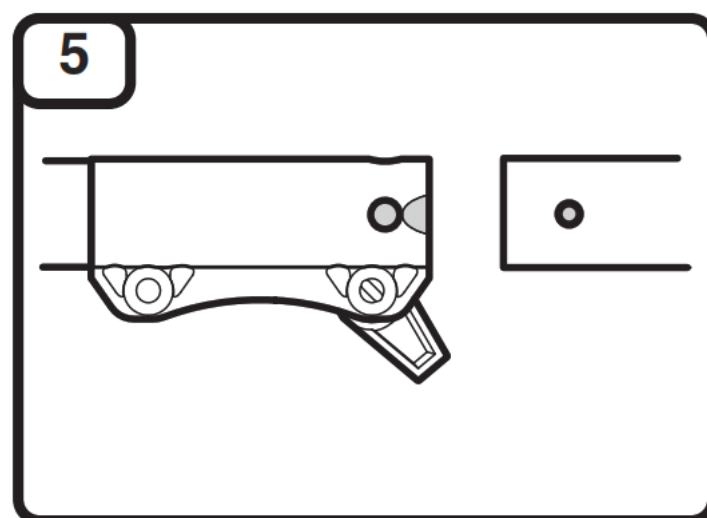

Align the release button with the guide recess. Push the attachment straight into the coupler until the release

button snaps firmly into the primary hole. Turn the knob clockwise to tighten the coupler.

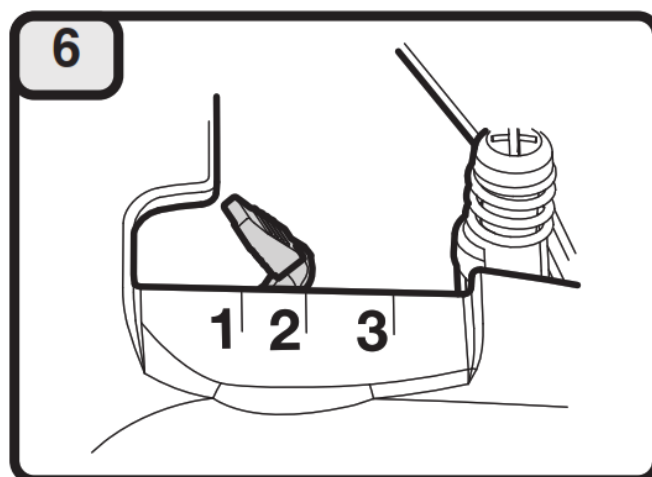

Push the handle down onto the upper shaft housing. Make sure the bolt hole faces to the right. Insert the bolt into the bolt hole. Tighten the bolt with a flat-head screwdriver, but do not tighten the bolt completely.

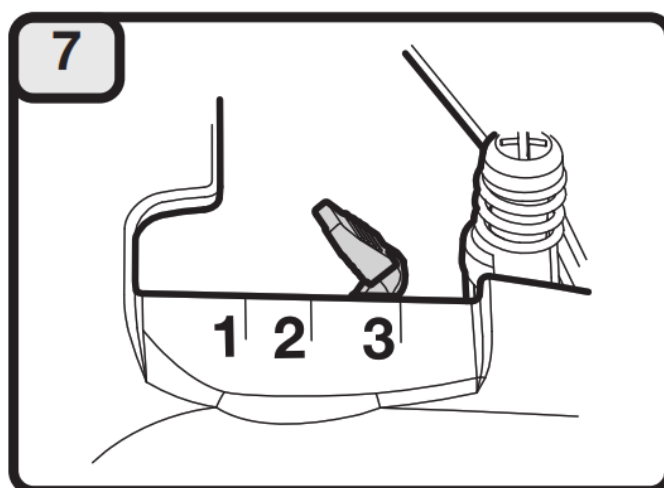

Move the handle to a comfortable location. Make sure the handle is positioned beyond the end of the safety label. Tighten the bolt until the handle is secure.

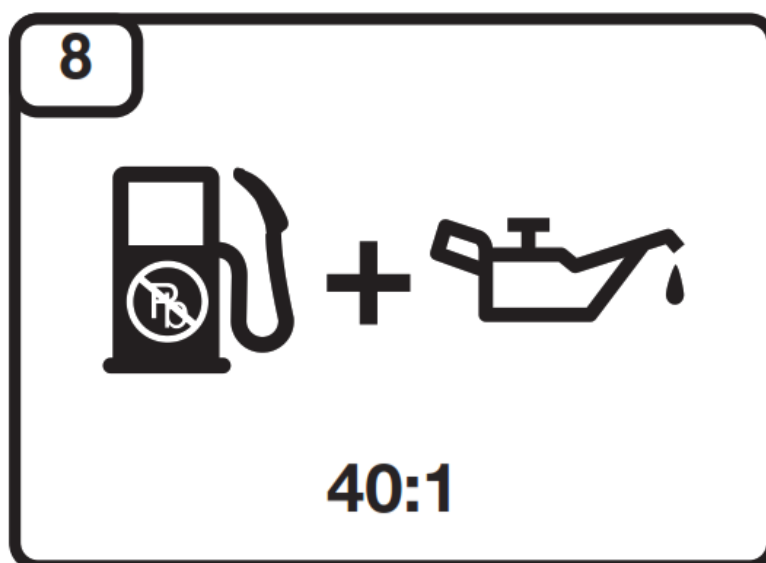

Mix thoroughly in a separate fuel can: – 3.2 fl. oz. of 2-cycle engine oil – 1 gallon of fresh unleaded gasoline (less

than 30 days old)

NOTE: Do not mix directly in the unit fuel tank.

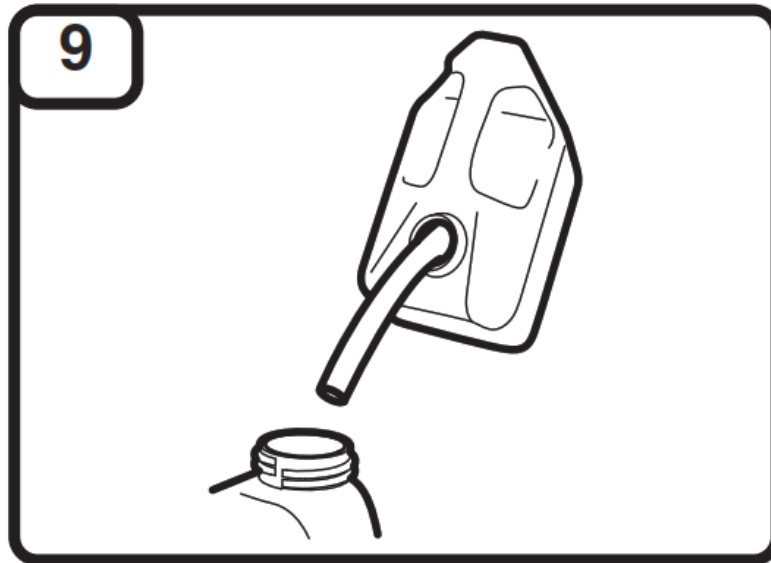

Position the unit with the fuel cap facing up. Slowly remove the fuel cap. Fill the fuel tank. Reinstall the fuel cap. Move the unit at least 30 ft. (9.1 m) from the fuel container and the fueling site before starting the engine.

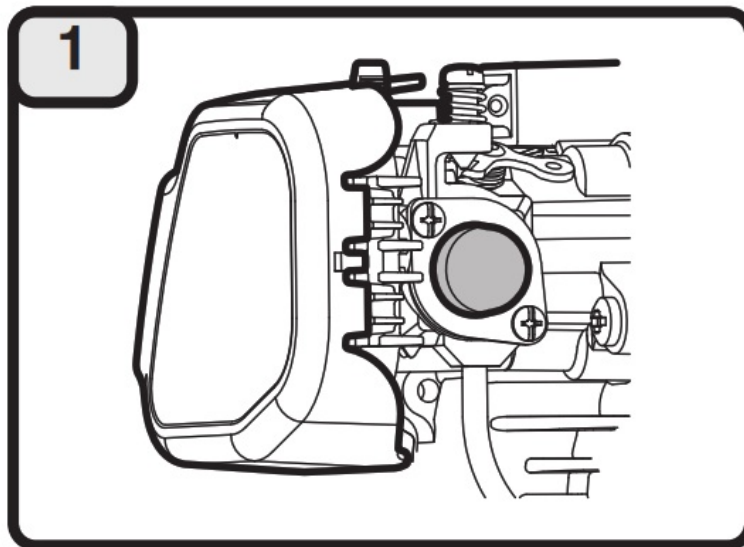

STARTING

PRIME:

Slowly press and release the primer bulb **10 times, or until the fuel is visible.**

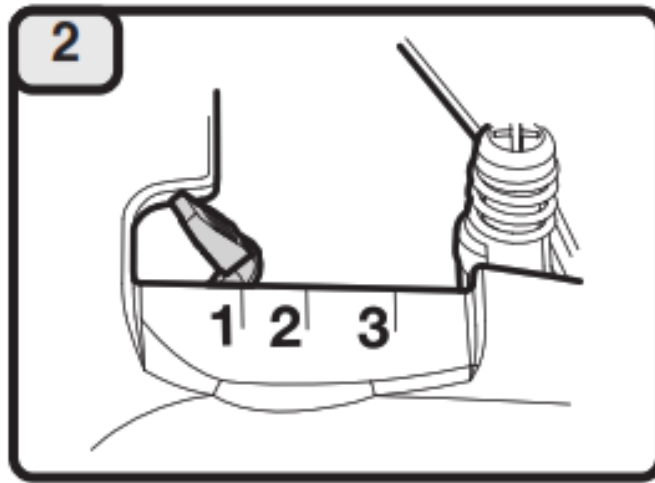

PRIME:

Move the choke lever to Position 1.



PRIME:

Crouch in the starting position.

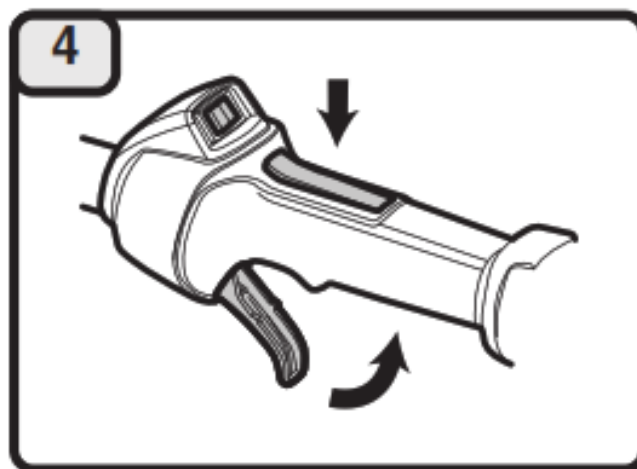

PRIME:

Press and hold the throttle lockout. Squeeze and hold the throttle control. NOTE: Continue to SQUEEZE and HOLD the throttle lockout and the throttle control for ALL further steps.

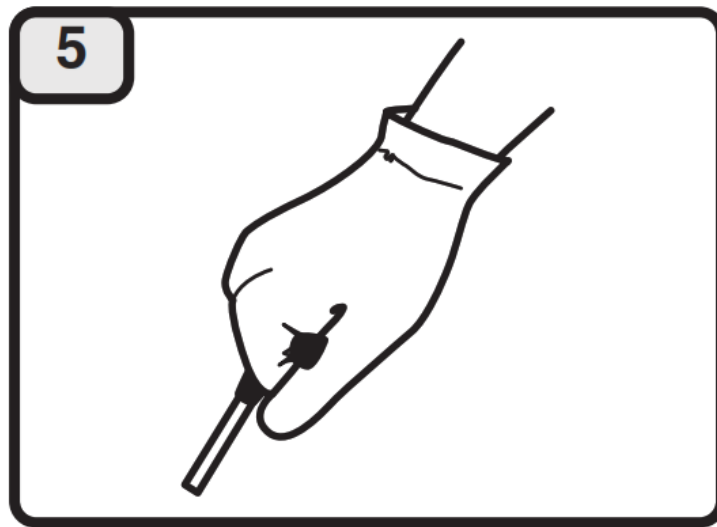

PRIME:

Pull the starter rope with a controlled and steady motion 5 times. DO NOT pull the starter rope more than 5 times.

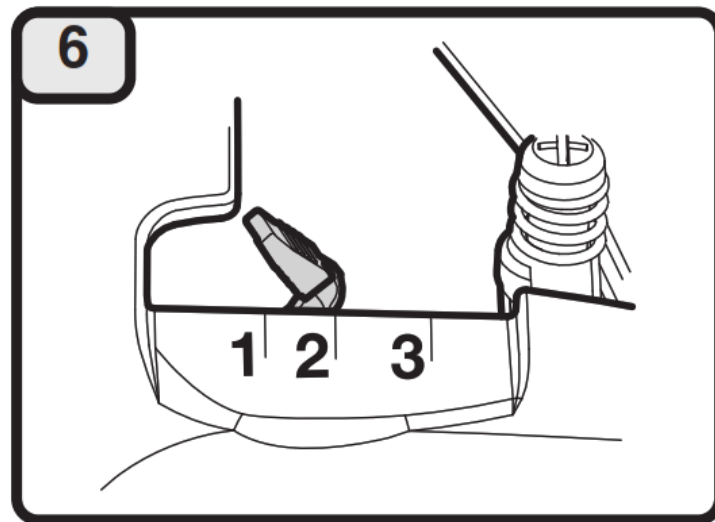

START:

Move the choke lever to Position 2. Pull the starter rope with a controlled and steady motion 5 to 10 times to start the engine. Allow the engine to warm up for 60 seconds.

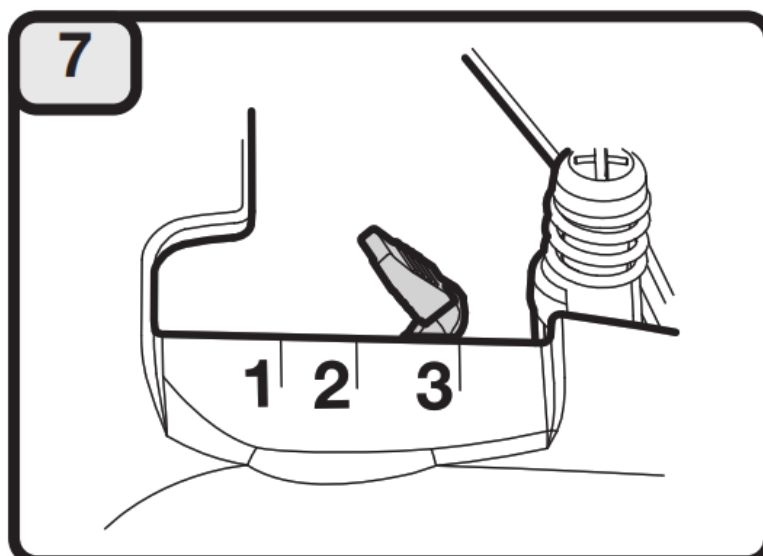

START:

Move the choke lever to Position 3.

Allow the engine to warm up for an additional 60 seconds. The unit may be used during this time.

DIDN'T START?

Repeat the starting instructions. If the unit still fails to start, refer to the operator's manual for additional starting and troubleshooting information.



IMPORTANT: READ THE OPERATOR'S MANUAL THOROUGHLY AND FOLLOW THE SAFE OPERATION PRACTICES WHILE OPERATING THE UNIT.



Documents / Resources



[TROY-BILT TB22 Curved Shaft String Trimmer](#) [pdf] User Guide

TB22, Curved Shaft String Trimmer, TB22 Curved Shaft String Trimmer, Shaft String Trimmer, String Trimmer, Trimmer

[Manuals+.](#)