



TROVE T2KHK3F12 12-Door Access and Power Integration Kit Instruction Manual

[Home](#) » [TROVE](#) » TROVE T2KHK3F12 12-Door Access and Power Integration Kit Instruction Manual 

TROVE T2KHK3F12 12-Door Access and Power Integration Kit



Contents

- [1 Models Include](#)
- [2 Overview](#)
- [3 Configuration Chart](#)
- [4 Installation Instructions](#)
- [5 Configuration of Kantech Boards](#)
- [6 Enclosure Dimensions](#)
- [7 Documents / Resources](#)
 - [7.1 References](#)
- [8 Related Posts](#)

Models Include

T2KHK3F12

12 Door Kit with Fused Outputs Fully assembled kit includes:

- Trove2 enclosure with TKH2 Altronix/Kantech backplane
- One (1) eFlow6NB – Power Supply/Charger
- One (1) T1618300K – Transformer
- One (1) ACM4 – Fused Access Power Controller
- One (1) ACM8 – Fused Access Power Controller

T2KHK3F12D

12 Door Kit with PTC Outputs Fully assembled kit includes:

- Trove2 enclosure with TKH2 Altronix/Kantech backplane

- One (1) eFlow6NB – Power Supply/Charger
- One (1) T1618300K – Transformer
- One (1) ACM4CB – PTC Access Power Controller
- One (1) ACM8CB – PTC Access Power Controller

All components of these Trove kits are UL Listed sub-assemblies.
Please refer to the included corresponding Sub-Assembly Installation Guides for further information.

All registered trademarks are property of their respective owners.

Rev. 040819

Installing Company: _____

Service Rep. Name: _____

Address: _____

Phone #: _____

Overview

Altronix T2KHK3F12 and T2KHK3F12D Trove Kantech kits are pre-assembled and consist of Trove2KH2 enclosure/backplane with factory installed Altronix power supply/charger and sub-assemblies. T2KHK3F12 and T2KHK3F12D also accommodate various combinations of Kantech boards for up to twelve (12) doors in a single enclosure.

TKH2 accommodates a combination of the following Kantech boards:

- Up to four (4) KT-MOD-INP16 or KT-MOD-OUTP16.
- Up to four (4) KT300.
- Up to three (3) KT400.

Configuration Chart

Altronix Model Number	Power Supply Board Input Fuse Rating	Power Supply Board Battery Fuse Rating	120V AC 60 Hz Input Current (A)	Maximum Supply Current for Main and Aux. Outputs on Power Supply board and ACM4(CB)/ACM8(CB) Access Power Controllers' outputs	Nominal DC Output Voltage		Fail-Safe / Fail-Secure or Dry Form "C" Outputs	ACM4 (CB) Board Input Fuse Rating	ACM4 Board Output Fuse Rating	ACM4 Board Output PT C Rating	ACM8 (CB) Board Input Fuse Rating	ACM8 Board Output Fuse Rating	ACM8 Board Output PTC Rating
					[DC]	[Aux]							
					Output Range (VDC)	Output Range (VDC)							
T2KHK3F12	5A /250V	10 A/32V	3.5	24VDC @ 5.4A	20.17-26.4	20.28-26.4	12	10 A/32V	3A /32V	–	10 A/250V	2.5 A/250V	–
T2KHK3F12D									–	2.5 A		–	2.5 A

Installation Instructions

Wiring methods shall be in accordance with the National Electrical Code/NFPA 70/ANSI, and with all local codes and authorities having jurisdiction. Product is intended for indoor use only.

1. Remove backplane from enclosure. Do not discard hardware.
2. Mark and predrill holes in the wall to line up with the top three keyholes in the enclosure. Install three upper fasteners and screws in the wall with the screw heads protruding. Place the enclosure's upper keyholes over the three upper screws, level and secure. Mark the position of the lower three holes. Remove the enclosure. Drill the lower holes and install the three fasteners. Place the enclosure's upper keyholes over the three upper screws. Install the three lower screws and make sure to tighten all screws.
3. Mount included UL Listed tamper switch (Altronix Model TS112 or equivalent) in desired location, opposite hinge.
Slide the tamper switch bracket onto the edge of the enclosure approximately 2" from the right side (Fig. 1, pg. 2).

Fig. 1

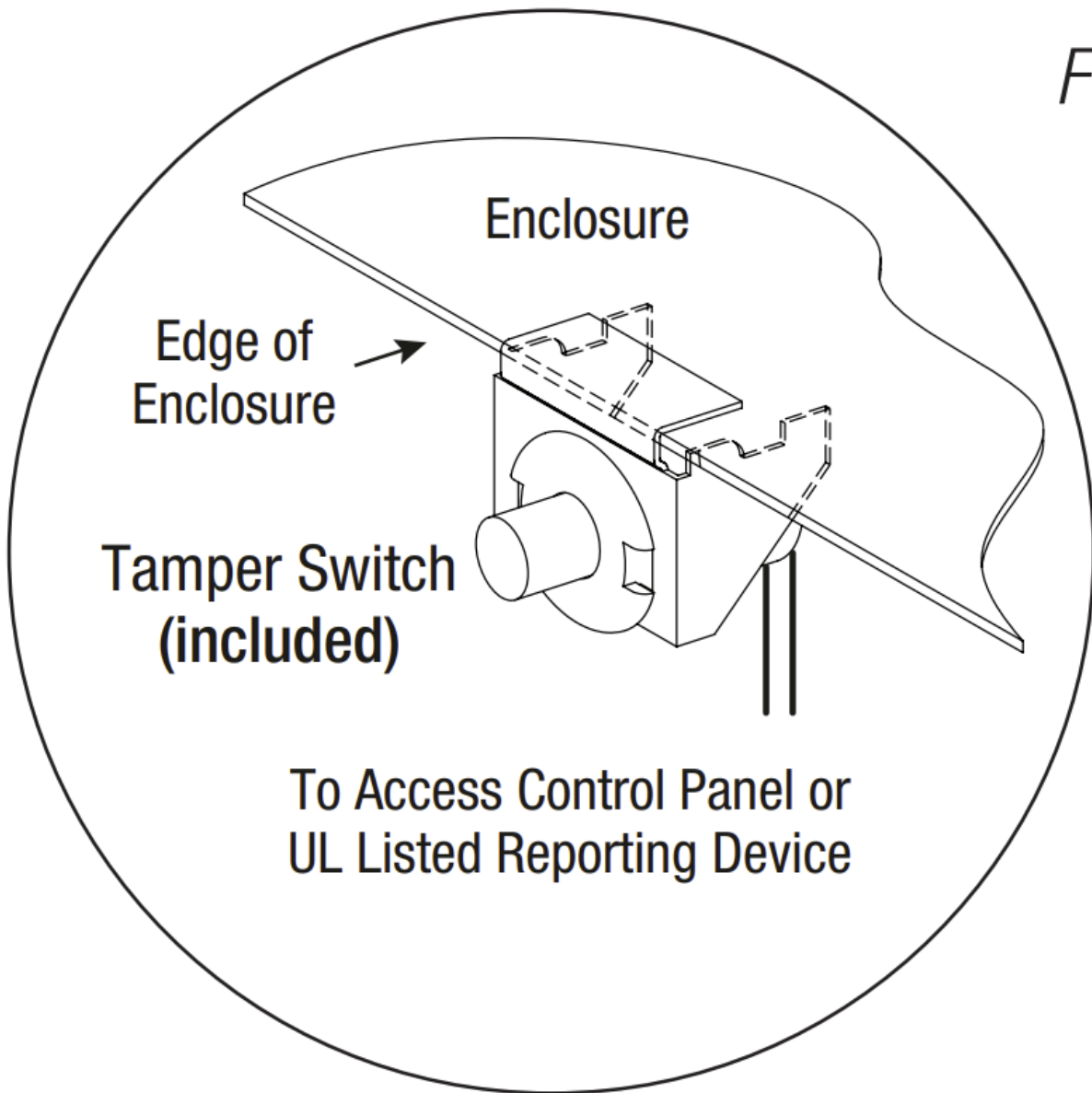

Connect tamper switch wiring to the Access Control Panel input or the appropriate UL Listed reporting device. To activate alarm signal open the door of the enclosure.

4. Mount Kantech boards to TKH2 backplane, refer to page 3.
5. Refer to the eFlow Power Supply/Charger Installation Guide for eFlow6NB and corresponding Sub-Assembly. Installation Guides for the following models: ACM8(CB), ACM4(CB) and T1618300K for further installation instructions.

Configuration of Kantech Boards

1. Align Kantech boards on the backplane to match the boards' mounting holes with corresponding holes in backplane.
 - a. Position spacer over appropriate hole on the rear of backplane and depress it until it locks in place (Fig. 2a, pg. 3, Step 1a).

Fig. 2a

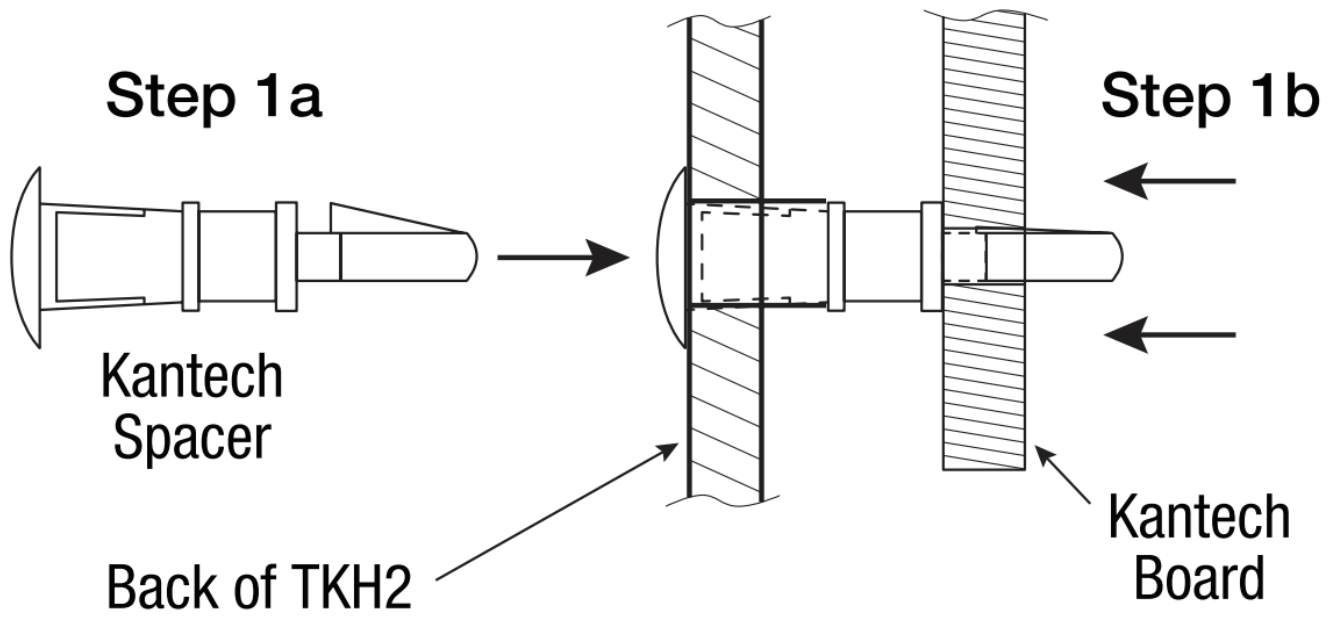

- b. Depress down on board to secure it to the spacer (Fig. 2a, pg. 3, Step 1b).
2. Fasten backplane to Trove2 enclosure utilizing pan head screws (provided).

Kantech Access Controller Position Chart for the Following Models:

Kantech Board	Pem Mounting
KT-400 Door Controller	A
KT-300 Door Controller	B
KT-MOD-INP16 or KT-MOD-OUTP16 Expansion Boards	C

Fig. 2

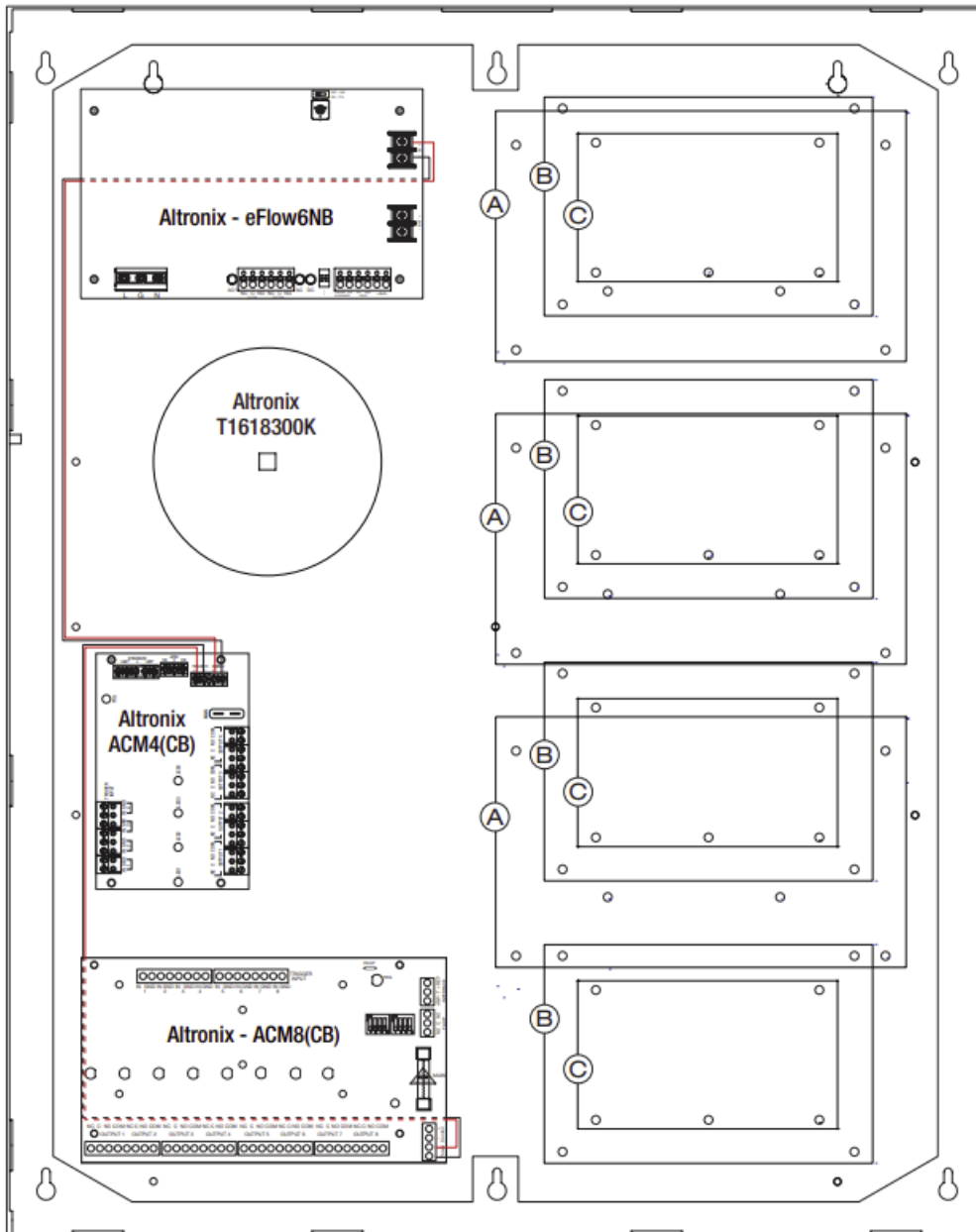

Enclosure Dimensions

(H x W x D)

27.25" x 21.75" x 6.5" (692.2mm x 552.5mm x 165.1mm)

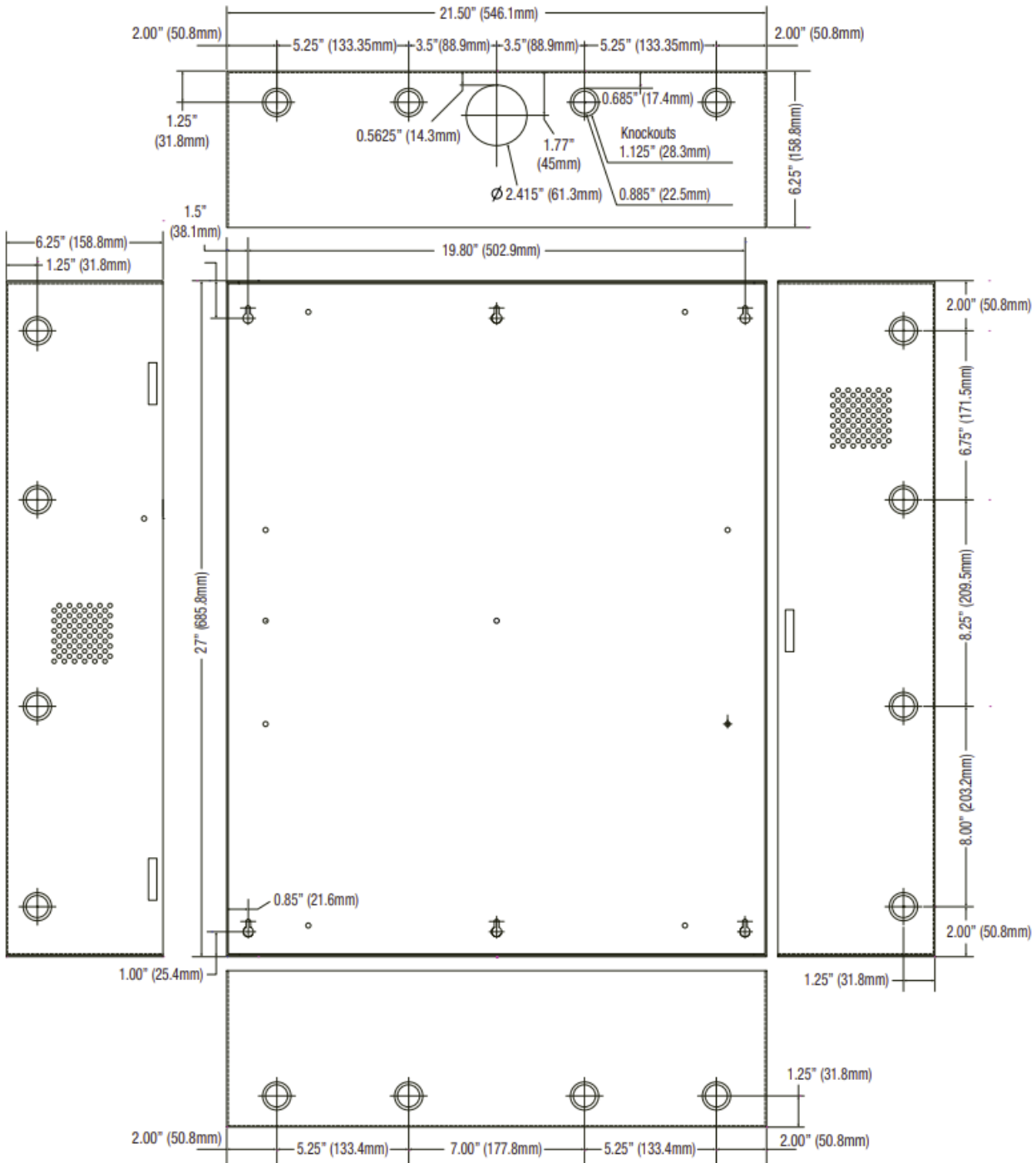

Altronix is not responsible for any typographical errors.

140 58th Street, Brooklyn, New York 11220 USA | phone: 718-567-8181 | fax: 718-567-9056
 web site: www.altronix.com | e-mail: info@altronix.com | Lifetime Warranty
 IIT2KHK3F12(D)



More than just power.™

TROVE™

Access & Power Integration

Documents / Resources

 Altronix/Kentech Kits Models include: T2KHK3F12 T2KHK3F12D Installation Guide Altronix	TROVE T2KHK3F12 12-Door Access and Power Integration Kit [pdf] Instruction Manual T2KHK3F12 12-Door Access and Power Integration Kit, T2KHK3F12, 12-Door Access and Power Integration Kit, Access and Power Integration Kit, Power Integration Kit, Integration Kit
--	--

References

-  [Altronix Home](#)