



TROPHY RIDGE AS713DL19 Digital React Sight User Guide

[Home](#) » [TROPHY RIDGE](#) » TROPHY RIDGE AS713DL19 Digital React Sight User Guide 



RIDGE AS713DL19 Digital React Sight User Guide

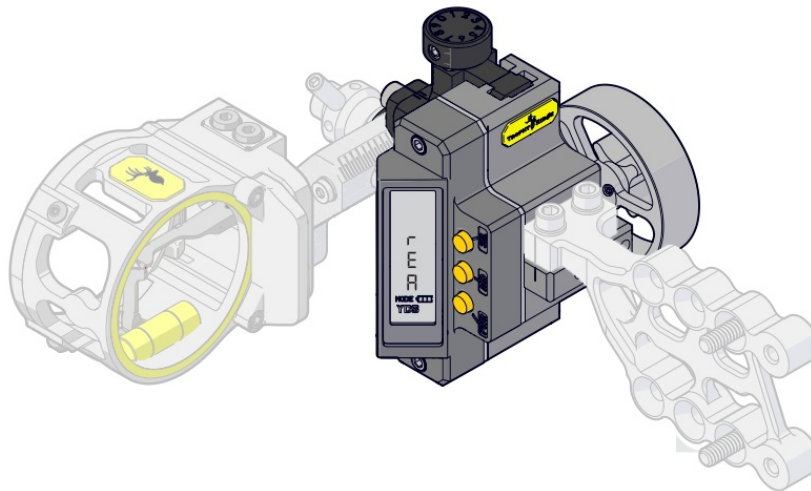

DIGITAL REACT SIGHT SET UP – YARDAGE

Contents

- [1 AS713DL19 Digital React Sight](#)
- [2 BEGIN](#)
- [3 Documents / Resources](#)
- [4 Related Posts](#)

AS713DL19 Digital React Sight

NOTE

For best results before using the sight charge the battery for 8 hours. Leave sight off while charging. Sight in your vertical or bottom pin using the toolless micro adjust windage and elevation knobs at 40 yards.

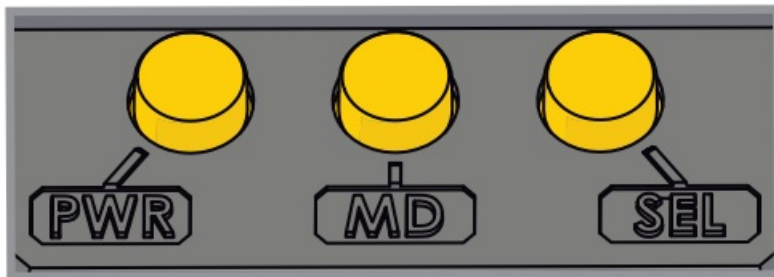

PWR = Power on/off button

MD = Mode button

SEL = Select button

BEGIN

- Power on — press power (PWR) once and the screen will flash, sight is powering up.
- Once powered on you will see a number or you will see rEA.
- If you see rEA then press select (SEL). See Detail A.

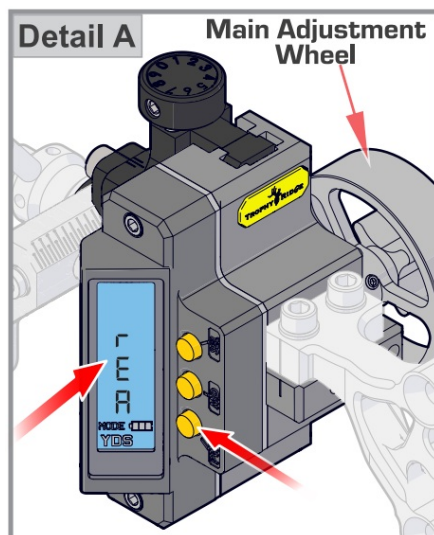

NOTE

If you see a number press and hold the mode (MD) button until you see rEA. If at any time you wish to start over, press and hold the MD button until you see rEA for React mode.

-Screen will show 1ST. See Detail B.

-Press SEL.

-20 yards will flash blue. The screen indicates the 20-yard setting. Use the SEL button to increase the number to 40.

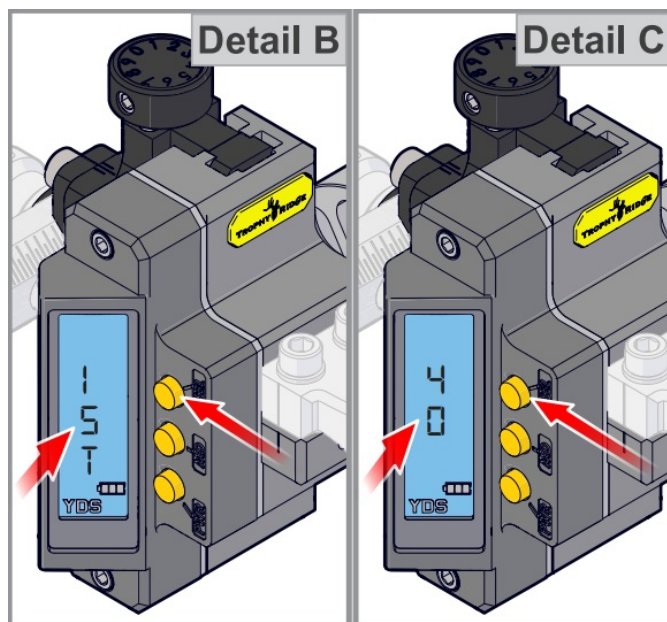

NOTE

If you do not select within 10 seconds the backlight will go off and the number will no longer be flashing. The site is still awaiting input.

- Press and hold SEL. You will see 1ST. Now you have set your 40-yard pin location.
- Once 1ST distance is set, move to 50 yards. -Press MD until you see 2ND. See Detail D.
- Press SEL. The screen will then turn purple and display the current distance. See Detail E.

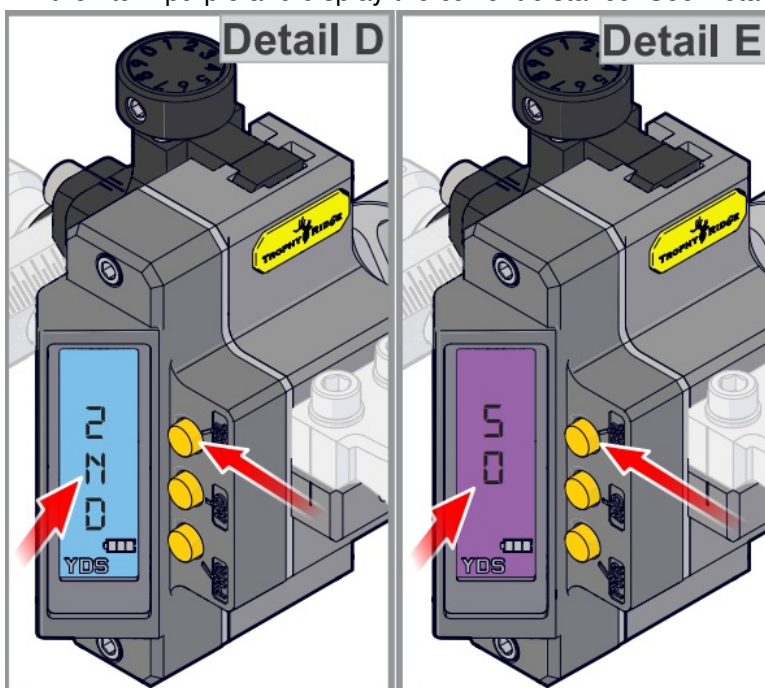

- Turn Main Adjustment wheel to 50 yards showing on the screen.
- At the 50-yard distance shoot your bow. Adjust your sight using the main dial until you are on target at 50 yards. The screen may show a different distance.

NOTE

Make sure that your pin adjustment is accurately 50 yards. Even if the number on the screen is higher or lower than 50.

- Once your bow is sighted in at 50 yards, press and hold SEL for 2 flashes, release, and the screen will turn blue. See Detail F.
- Press SEL to increase the number or MD to decrease the number to adjust the sight reading to 50 yards.
- Press and hold SEL for 2 flashes and the screen will turn grey. See Detail G.
- Your sight is now calibrated for all distances and is ready to use.

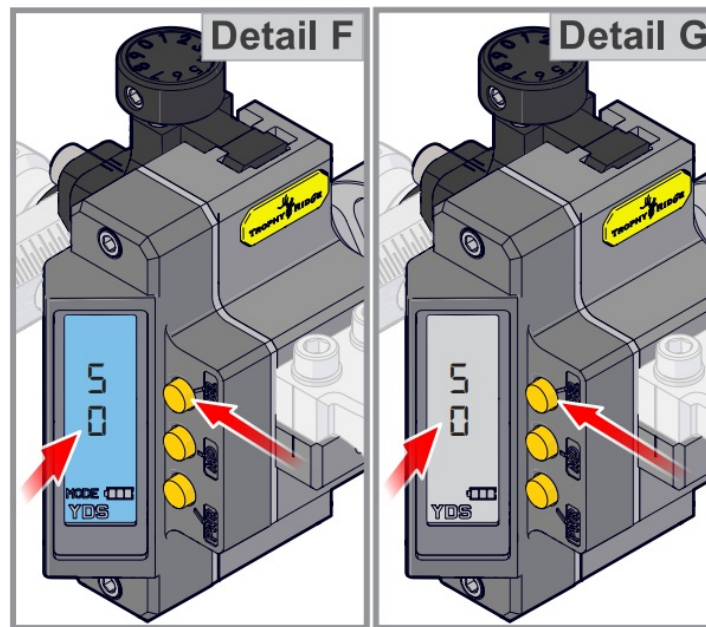

Note

If you do not select it within 10 seconds.

After 10 seconds it will be a solid number and not a color.

Press SEL to increase the number and press MD to decrease the number. Continue to press SEL or MD until you get to the number 40 yards. Stop pressing SEL or MD and then press and hold SEL. The number will flash x2 and you can release the SEL button.

You will then see 1ST. 1ST pin is now set. If you accidentally change the number from 40 or another number do the following. Continue to press SEL or MD until you get to the number you need. Stop pressing SEL or MD and then press and hold SEL.

Once you have sighted in the yardage markers from 40 — 100 you can now go back and sight in the 20 and 30-yard horizontal pins. Using the yardage selector knob roll the sight to its highest up position. You will not use any windage or elevation knobs for this step. Do not adjust windage or elevation Using an Allen wrench, insert it into the #1 micro adjust location on the top of the sight hood and move the pin up or down into position for 20 yards. Once complete with the top pin adjust the second pin to 30 yards with an Allen wrench, the same way you set the 20-yard pin Once these last two pins are complete your sight is then sighted in.



RIDGE AS713DL19 Digital React Sight User Guide

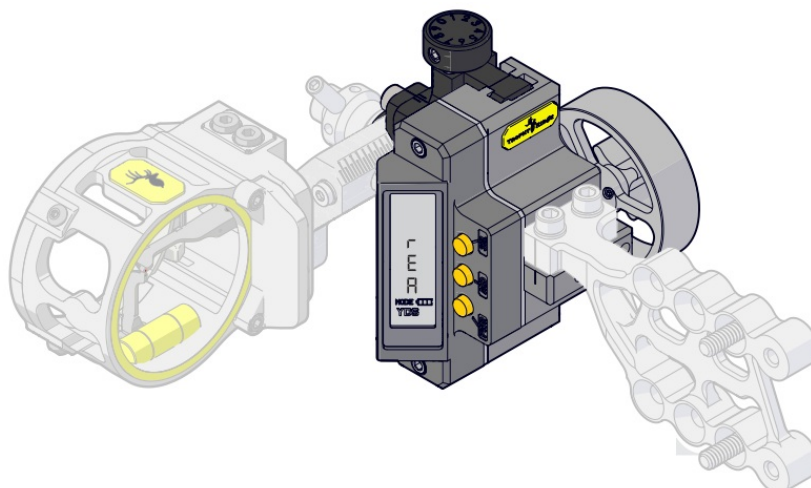

DIGITAL REACT SIGHT SET UP – YARDAGE

NOTE

For best results before using the sight charge the battery for 8 hours. Leave sight off while charging. Sight in your vertical or bottom pin using the toolless micro adjust windage and elevation knobs at 40 yards.

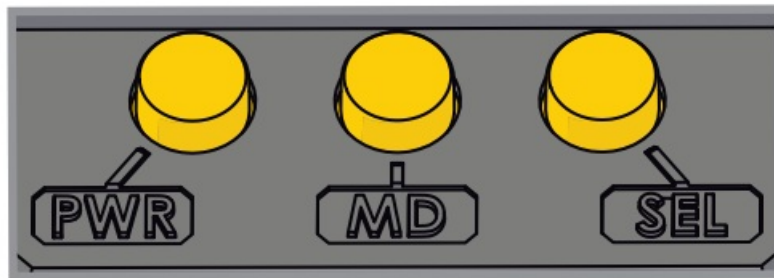

PWR = Power on/off button

MD = Mode button

SEL = Select button

BEGIN

-Power on — press power (PWR) once and the screen will flash, sight is powering up.

-Once powered on you will see a number or you will see rEA.

-If you see rEA then press select (SEL). See Detail A.

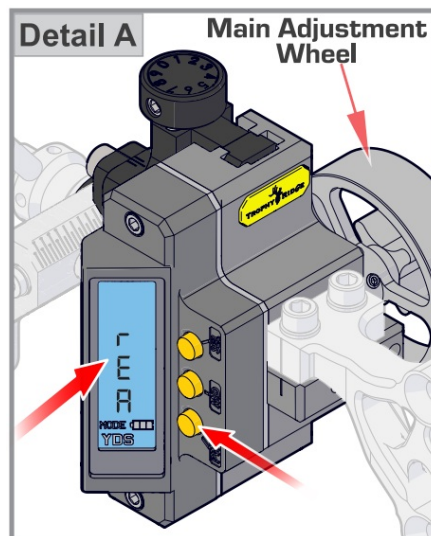

NOTE

If you see a number press and hold the mode (MD) button until you see rEA. If at any time you wish to start over, press and hold the MD button until you see rEA for React mode.

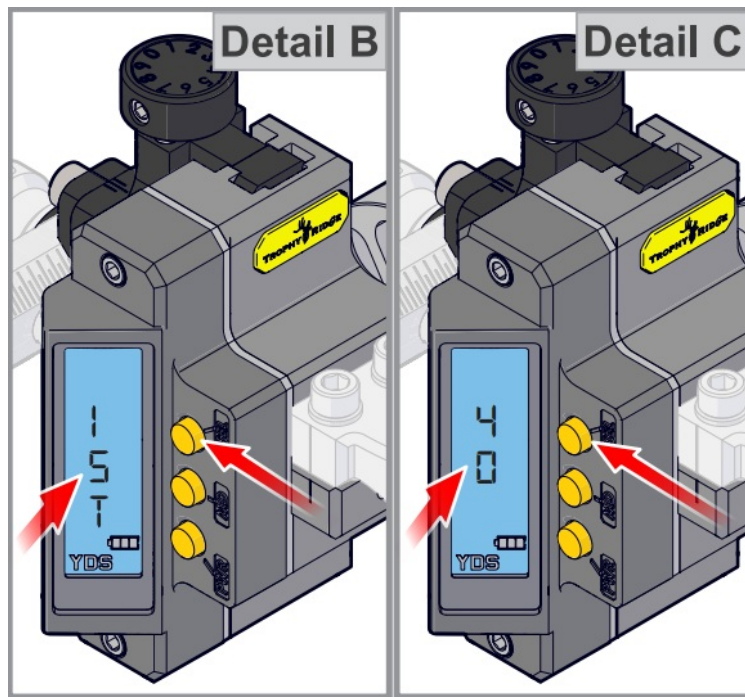

- Press SEL.
- Screen will show 1ST. See Detail B.
- Press SEL.
- 20 yards will flash blue. The screen indicates the 20 yard setting. Use the SEL button to increase the number to 40.

NOTE if you do not select within 10 seconds the backlight will go off and the number will no longer be flashing. The site is still awaiting input.

- Press and hold SEL. You will see 1ST. now you have set your 40-yard pin location.

- Once 1ST distance is set, you can now enter your bow and arrow speed, which was measured on the chronograph.

- Press MD until you see SPD. See Detail D.
- Press SEL. The number will be in blue and represents the speed of your bow in FPS. See Detail E.
- Adjust the FPS with SEL to increase and MD to decrease the number until you see the correct speed.

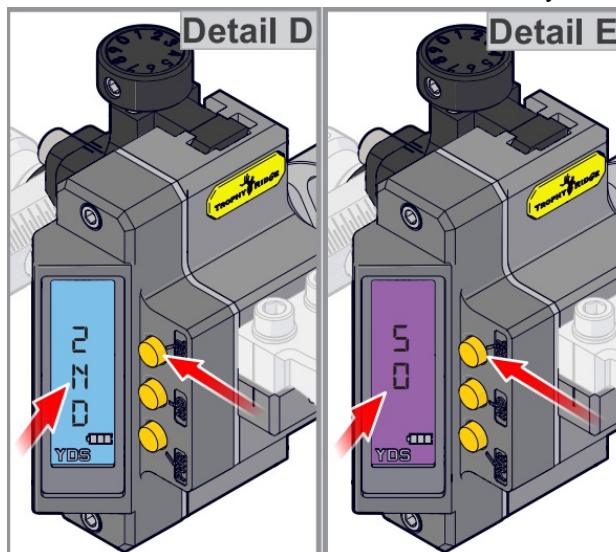

- Press and hold SEL for 2 flashes, and the screen will turn grey. See Detail F. -Your sight is now calibrated for all distances and is ready to use.

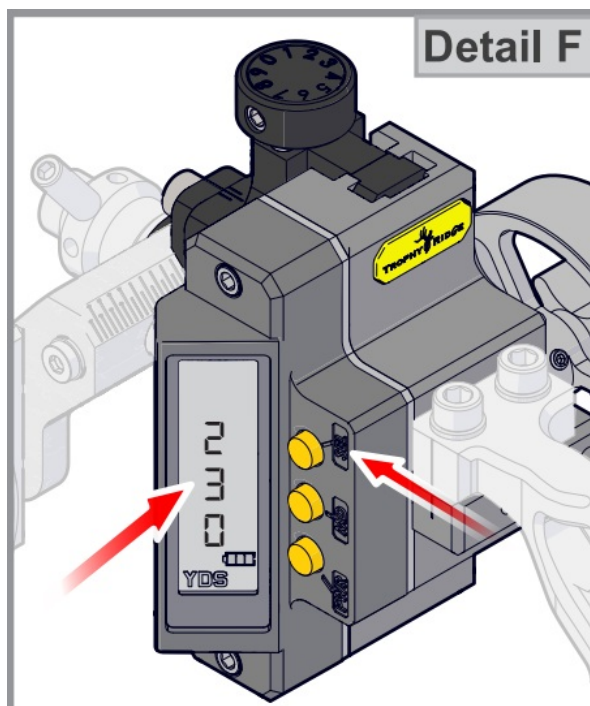

NOTE If you do not select it within 10 seconds. After 10 seconds it will be a solid number and not color. Press SEL to increase the number and press MD to decrease the number. Continue to press SEL or MD until you get to the number 40 yards. Stop pressing SEL or MD and then press and hold SEL. The number will flash x2 and you can release the SEL button. You will then see 1ST. 1ST pin is now set. If you accidentally change the number from 40 or another number do the fog. Continue to press SEL or MD until you get to the number you need. Stop pressing SEL or MD and then press and hold SEL.

NOTE For improved accuracy at longer distances, additional yardage adjustments may be needed. Please see the adjusting for accuracy section in the manual. NOTE This device complies with part 15 of the FCC Rules. Operation is subject to the following two conditions: (1) This device may not cause harmful interference, and (2) this device must accept any interference received, including interference that may cause undesired operation.

Once you have sighted in the yardage markers from 40 — 100 you can now go back and sight in the 20 and 30-yard horizontal pins. Using the yardage selector knob roll the sight to its highest up position. You will not use any windage or elevation knobs for this step. Do not adjust windage or elevation Using an Allen wrench, insert it into the #1 micro adjust location on the top of the sight hood and move the pin up or down into position for 20 yards. Once complete with the top pin adjust the second pin to 30 yards with an Allen wrench, the same way you set the 20-yard pin. Once these last two pins are complete your sight is then sighted in.

Documents / Resources

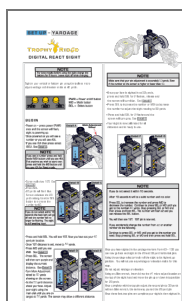

[TROPHY RIDGE AS713DL19 Digital React Sight \[pdf\] User Guide](#)
AS713DL19, Digital React Sight, AS713DL19 Digital React Sight