



TROPHY RIDGE AS701DR19 Digital React Sight User Guide

[Home](#) » [TROPHY RIDGE](#) » TROPHY RIDGE AS701DR19 Digital React Sight User Guide 

TROPHY RIDGE AS701DR19 Digital React Sight User Guide



Contents

- [1 SET UP – YARDAGE](#)
- [2 SET UP – SPEED](#)
- [3 Documents / Resources](#)
- [4 Related Posts](#)

SET UP – YARDAGE

NOTE

For best results before using the sight charge the battery for 8 hours. Leave sight off while charging.

With main adjustment wheel, roll sight to top position. Sight in your pin using the tool-less micro adjust windage and elevation knobs at 20 yards.



PWR = Power on/off button

MD = Mode button

SEL = Select button

BEGIN

- Power on — press power (PWR) once and the screen will flash, sight is powering up.
- Once powered on you will see a number or you will see rEA.
- If you see rEA then press select (SELL. See Detail A.

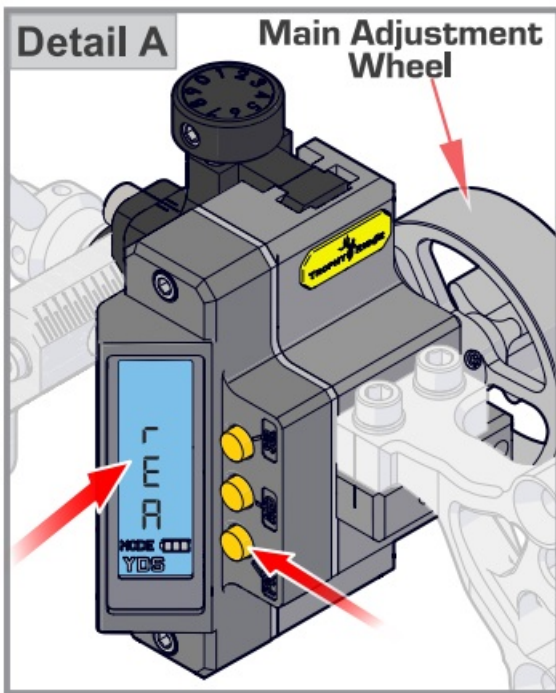

NOTE

If you see a number press and hold mode (MD) button until you see rEA. If at anytime you wish to start over, press and hold the MD button until ou see rEA for React mode.

- Screen will show 1ST. See Detail B.
- Press SEL.
- 20 will flash on a blue screen indicating the 20 yard setting. See Detail C,

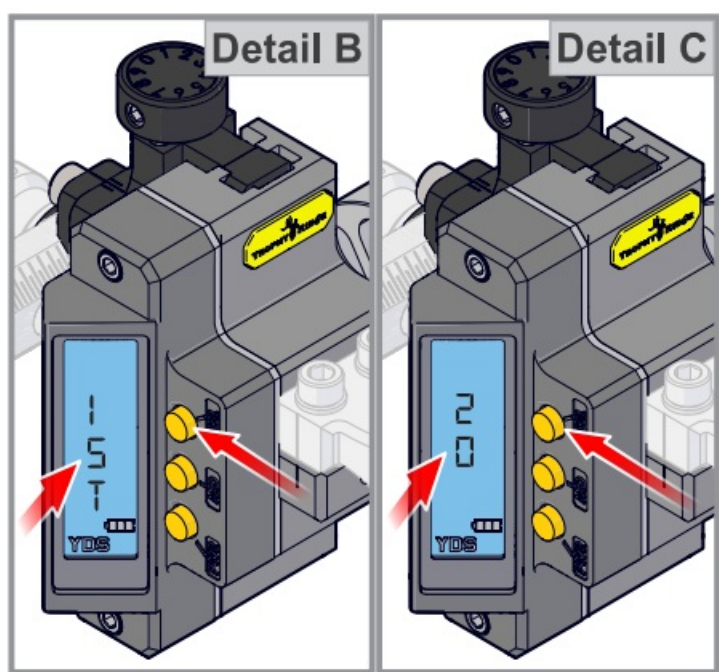

NOTE

If you do not select within 10 seconds the back light will go off and the number will no longer be flashing. The sight is still awaiting input.

- Press and hold SEL. You will see 1ST. Now you have set your 20 yard pin location.
- Once 1ST distance is set, move to 30 yards.
- Press MD until you see 2ND. See Detail D.
- Press SEL. The screen will then turn purple and display the current distance. See Detail E.
- Turn Main Adjustment wheel to 30 yards showing on the screen.
- At the 30 yard distance shoot your bow. Adjust your sight using the main dial until you are on target at 30 yards. The screen may show a different distance.

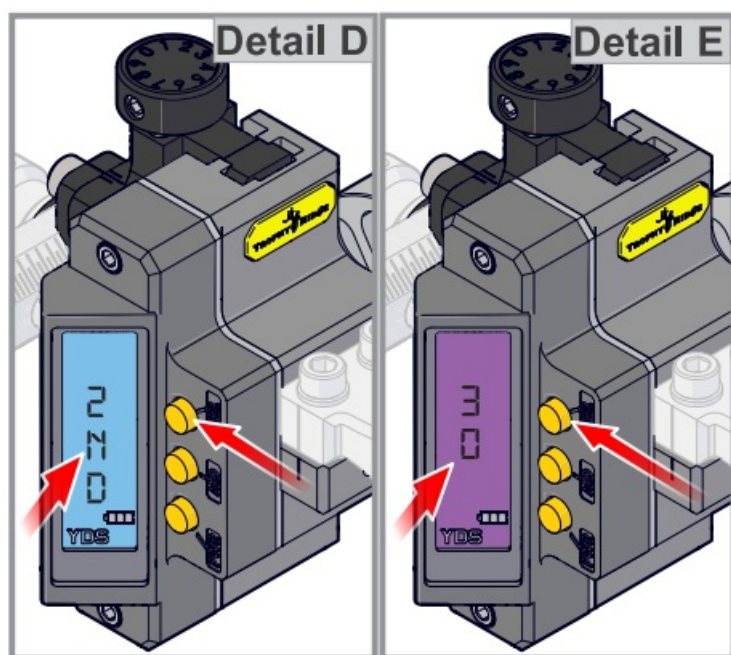

NOTE

Make sure that your pin adjustment is accurately 30 yards. Even if the number on the screen is higher or lower

than 30.

- Once your bow is sighted in at 30 yards, press and hold SEL for 2 flashes, release and the screen will turn blue. See Detail F.
- Press SEL to increase the number or MD to decrease the number to adjust the sight reading to 30 yards.
- Press and hold SEL for 2 flashes and the screen will turn grey. See Detail G.
- Your sight is now calibrated for all distances and is ready to use.

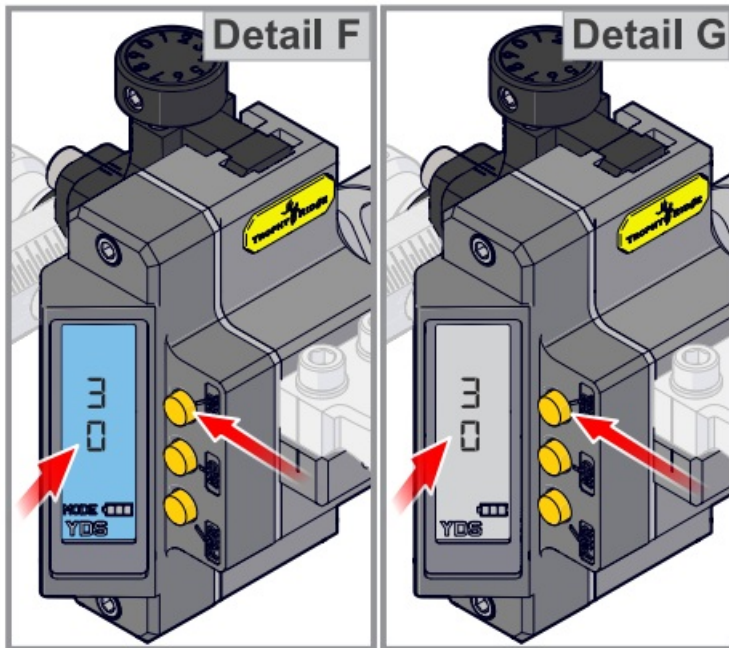

NOTE

If you do not select it within 10 seconds.

After 10 seconds it will be a solid number and not color.

Press SEL to increase the number and press MD to decrease the number. Continue to press SEL or MD until you get to the number 20 yards. Stop pressing SEL or MD and then press and hold SEL. The number will flash x2 and you can release the SEL button.

You will then see 1ST. 1ST pin is now set. If you accidentally change the number from 20 or another number do the following.

Continue to press SEL or MD until you get to the number you need. Stop pressing SEL or MD and then press and hold SEL.

SET UP – SPEED

NOTE

Before you begin For best results, be sure to verify your bow and arrow speed by shooting through a calibrated chronograph.

With main adjustment wheel, roll sight to top position. Sight in your pin using the tool-less micro adjust windage and elevation knobs at 20 yards.



PWR = Power on/off button

MD = Mode button

SEL = Select button

BEGIN

- Power on — press power (PWRI) once and the screen will flash, sight is powering up.
- Once powered on you will see a number or you will see rEA.
- If you see rEA then press select (SELL. See Detail A.

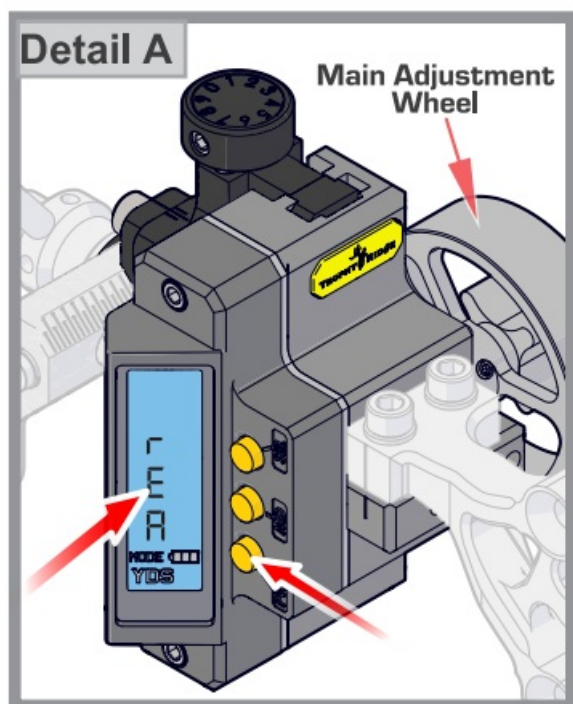

NOTE

If you see a number press and hold mode (MD) button until you see rEA. If at anytime you wish to start over, press and hold the MD button until you see rEA for React mode.

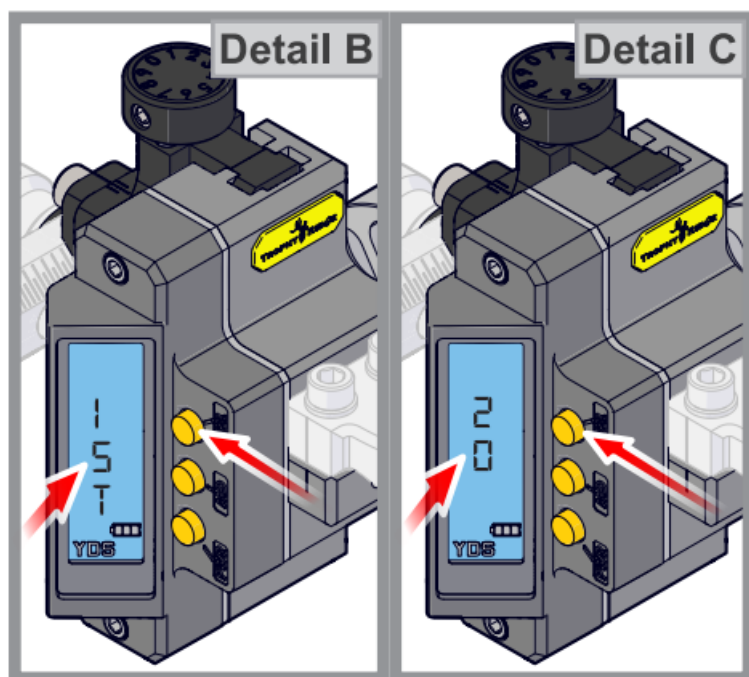

- Press SEL.
- Screen will show 1ST. See Detail B.

- Press SEL. -20 will flash on a blue screen indicating the 20 yard setting. See Detail C.

NOTE

If you do not select within 10 seconds the back light will go off and the number will no longer be flashing. The sight is still awaiting input.

Press and hold SEL. You will see 1ST. now you have set your 20 yard pin location.

- Once 1ST distance is set, you can now enter your bow and arrow speed, that was measured on the chronograph.
- Press MD until you see SPD. See Detail D. •Press SEL. The number will be in blue and represents the speed of your bow in FPS. See Detail E.
- Adjust the FPS with SEL to increase and MD to decrease the number until you see the correct speed.

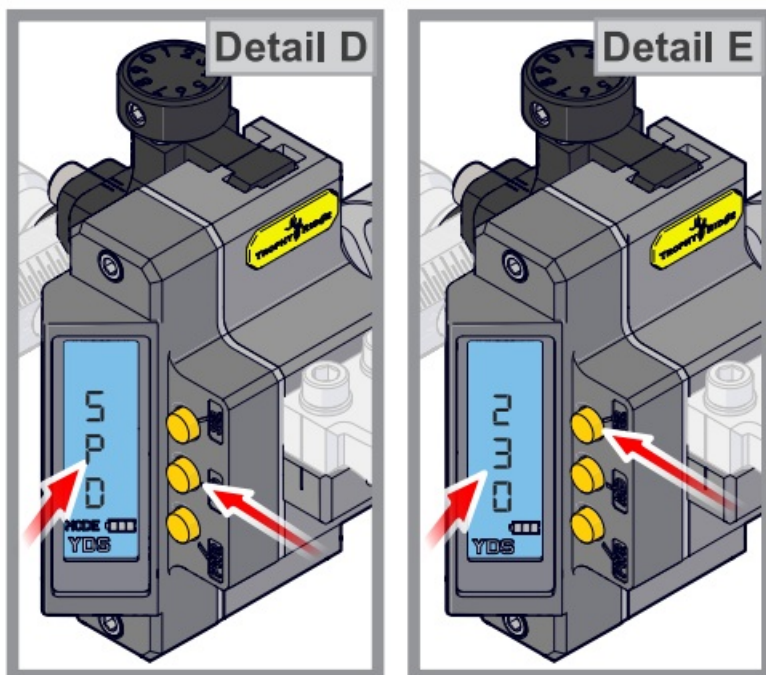

- Press and hold SEL for 2 flashes, the screen will turn grey. See Detail F.
- Your sight is now calibrated for all distances and is ready to use.

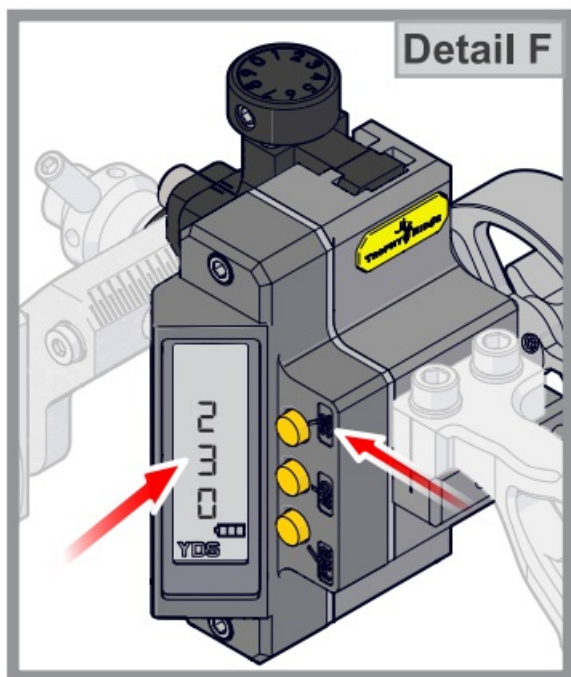

NOTE

If you do not select it within 10 seconds.

After 10 seconds it will be a solid number and not color.

Press SEL to increase the number and press MD to decrease the number. Continue to press SEL or MD until you get to the number 20 yards. Stop pressing SEL or MD and then press and hold SEL. The number will flash x2 and you can release the SEL button. You will then see 1ST. 1ST pin is now set. If you accidentally change the number from 20 or another number do the following. Continue to press SEL or MD until you get to the number you need. Stop pressing SEL or MD and then press and hold SEL.

NOTE

For improved accuracy at longer distances, additional yardage adjustments may be needed. Please see the adjusting for accuracy section in the manual.

NOTE

This device complies with part 15 of the FCC Rules. Operation is subject to the following two conditions: (1) This device may not cause harmful interference, and (2) this device must accept any interference received, including interference that may cause undesired operation.

Documents / Resources

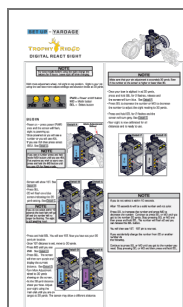

[TROPHY RIDGE AS701DR19 Digital React Sight](#) [pdf] User Guide
AS701DR19, Digital React Sight, AS701DR19 Digital React Sight, React Sight, Sight