

TROND TD EA US09-E Outlet Extender with Rotating Plug User Guide

[Home](#) » [TROND](#) » TROND TD EA US09-E Outlet Extender with Rotating Plug User Guide 

Contents

- [1 TROND TD EA US09-E Outlet Extender with Rotating Plug](#)
- [2 Specifications](#)
- [3 Product Features](#)
- [4 Safety Precautions](#)
- [5 Product Usage Instructions](#)
- [6 Frequently Asked Questions](#)
- [7 SAFETY PRECAUTIONS](#)
- [8 Product Diagram](#)
- [9 Specifications](#)
- [10 Product Features](#)
- [11 Frequently Asked Questions](#)
- [12 Documents / Resources](#)
 - [12.1 References](#)
- [13 Related Posts](#)



TROND TD EA US09-E Outlet Extender with Rotating Plug

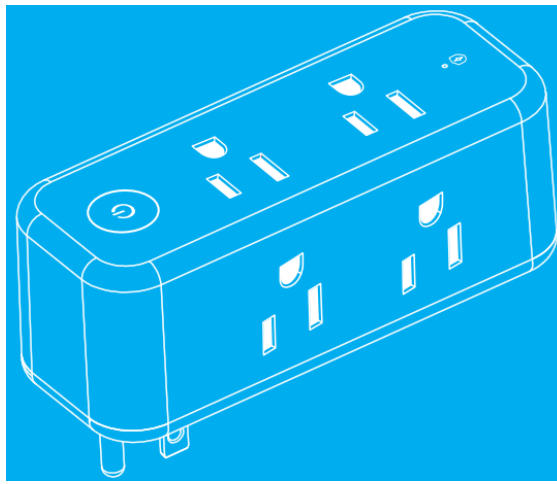

Specifications

- **Model:** TD EA US09E
- **Material:** UL94 V-0 Flame-Retardant PC + ABS
- **Input Voltage:** AC 100 – 250V, 50 / 60Hz
- **Rated Power:** 1875W (125V / 15A)
- **Surge Energy Rating:** 1440 Joules
- **Dimensions:** 4.65 x 1.79 x 1.75 in. (L*W*H)
- **Net Weight:** 0.31 lb / 0.14 kg

Product Features

- Outlet extender with rotating plug
- Designed for household indoor use only
- 4 grounded AC outlets (3-sided)
- 360-degree rotating plug
- Power switch with LED indicator (blue)
- Surge protection indicator (green)

Safety Precautions

- This product is intended for household indoor use only and should not be used commercially.
- Keep away from children.
- Plug into a standard 3-wire grounded outlet only.
- Do not use with a receptacle that does not align with the blades.
- Do not daisy-chain together in series with other power strips or surge protectors.
- Avoid using near water or any other source of moisture.
- Avoid placing near heat sources.
- Do not overload the product's outlets (max. load: 15A / 1875W).
- Do not open the housing as there are no user-serviceable parts inside.
- Do not use liquid or aerosol cleaners for cleaning.

Product Usage Instructions

Installation

1. Choose a suitable location for the outlet extender near a grounded wall outlet.
2. Plug the rotating plug of the outlet extender into the wall outlet.
3. Ensure that the slot opening of the receptacle aligns with the blades of the outlet extender.

Powering On and Off

To turn on the outlet extender, toggle the power switch to the “On” position. The LED indicator will light up in blue to indicate that it is powered on. To turn off the outlet extender, toggle the power switch to the “Off” position.

Surge Protection

The surge protection indicator will light up in green when the outlet extender is providing surge protection. If the indicator is not lit, it means that the surge protection has been compromised, and you should replace the outlet extender.

USB Charging

- The TD EA US09 model includes USB charging ports:
 - 2 USB A ports with a maximum output of 2.4A each
 - 1 USB C port with a maximum output of 3.0A
- To charge your device via USB, simply connect your device’s charging cable to one of the USB ports. The outlet extender supports smart charging technology, so it can charge any 5V device at full speed. However, it does not support Quick Charge QC2.0/3.0/4+ or Power Delivery technology, so charging speeds may be slower for devices that require these technologies.

Frequently Asked Questions

- **Which USB port should I use to charge my device?**

All the 2 USB A ports and 1 USB C port can support smart charging technology, and can charge any 5V device at full speed (USB A: 2.4A, USB C: 3.0A output max). For devices with different voltage requirements, please plug your power block into the AC outlets instead.

- **Can my phone be charged up quickly via USB?**

This product doesn’t support Quick Charge QC2.0/3.0/4+ or Power Delivery technology. Therefore, you may experience slow charging speed for your latest devices.

SAFETY PRECAUTIONS

Please read these instructions carefully and retain this welcome guide for future use. When using electrical appliances, the following safety precautions should always be observed to reduce the risk of fire, electric shock, or injury to persons:

- **WARNING – Intended Use**

This product is intended to be used in household indoor areas only, and not intended for commercial use. Do not use it in General Patient Care Areas or Critical Patient Care Areas. Keep away from children.

- **WARNING – Grounding and Polarization**

Plug into a standard 3-wire grounded outlet only, and do not use it with a receptacle in which the slot opening

does not align with the blades.

- **WARNING – Daisy Chaining**

This product must be plugged directly to a wall outlet, and should not be “daisy-chained” together in series with other power strips or surge protectors.

- **WARNING – Liquid**

This product should not be used with aquariums, near water or any other source of moisture. Do not operate this product, if liquid of any kind is spilled onto or inside it.

- **WARNING – Heat**

Do not place it near heat sources such as wall heaters. Never cover it with carpet, furniture or anything that would prevent air circulation or cause temperature increase.

- **WARNING – Overloading**

Do not overload the product’s outlets. The max. load should not exceed 15A / 1875W, whether plugged into a single outlet or spread out over multiple outlets.

- **WARNING – No User Serviceable Parts Inside**

Do not open the housing for any reason, as there’re no user-serviceable parts inside. Product warranty will be voided and no liability will be accepted if the product is dismantled.

- **WARNING – Proper Cleaning**

In general, the only cleaning necessary for this product is a light dusting. Unplug it from the wall outlet before cleaning it. Do not use any type of liquid or aerosol cleaners.

Product Diagram

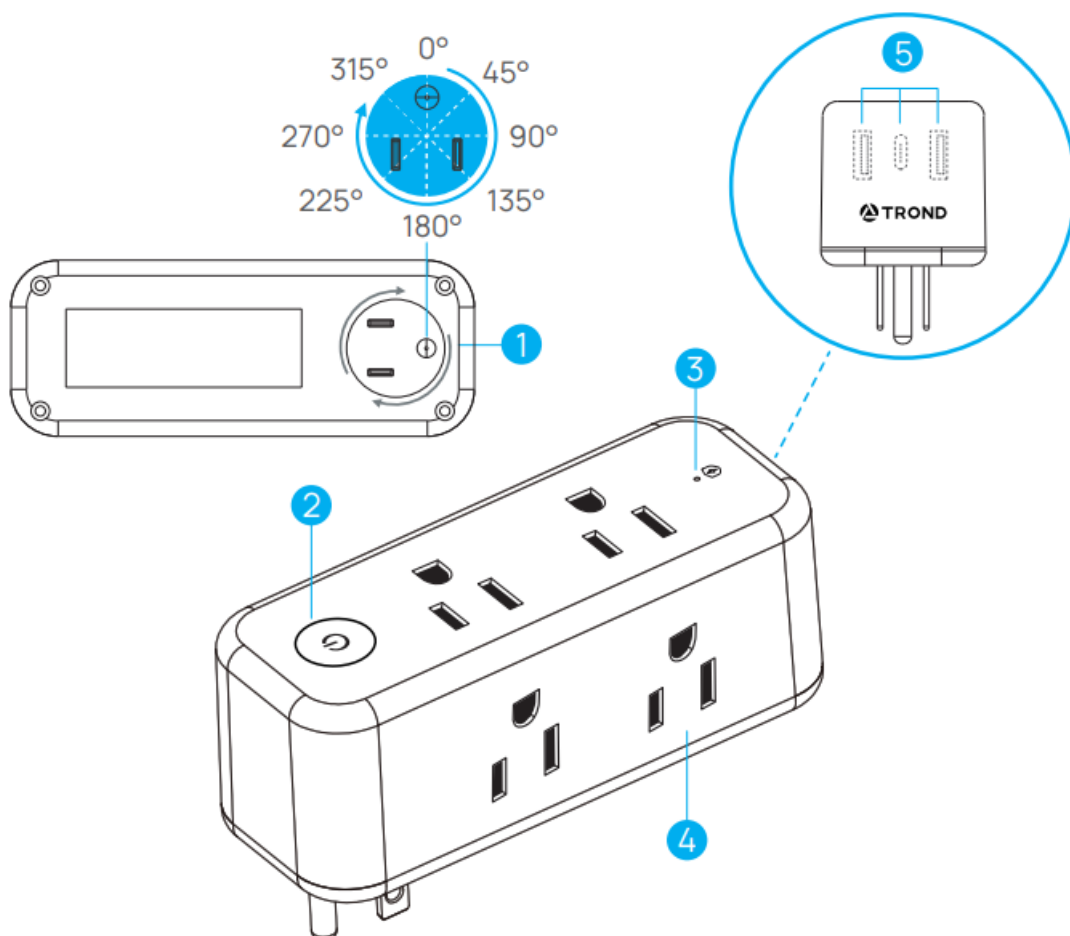

2. Power Switch w/ LED Indicator (Blue)
3. Surge Protection Indicator (Green)
4. 6 Grounded AC Outlets (3-Sided)
5. **TD-EA-US09**
(Smart: 17W / 3.4A; Quick Charge Not Supported)
TD-EA-US09E
(No USB Charging Ports Included)

Specifications

- **Model TD~EA~US09E**
 - **Material** UL94 V-0 Flame-Retardant PC + ABS
 - **Input Voltage** AC 100 – 250V, 50 / 60Hz
 - **Rated Power** 1875W (125V / 15A)
 - **Surge Energy Rating** 1440 Joules
 - **Dimensions** 4.65 x 1.79 x 1.75 in. (L*W*H)
 - **Net Weight** 0.31 lb / 0.14 kg
- **Model TD~EA~US09**
 - **Material** UL94 V-0 Flame-Retardant PC + ABS
 - **Input Voltage** AC 100 – 250V, 50 / 60Hz
 - **Rated Power** 1875W (125V / 15A)
 - **Surge Energy Rating** 1440 Joules
 - **USB~A Output** DC 5V 2.4A Max
 - **USB~C Output** DC 5V 3.0A Max
 - **USB Total Output** DC 5V 3.4A, 17W
 - **Dimensions** 4.65 x 1.79 x 1.75 in. (L*W*H)
 - **Net Weight** 0.37 lb / 0.17 kg

Product Features

- **Expand Your Outlets.** It turns one wall outlet into multiple AC Sockets or USB charging ports, which creates a powerful charging station for your various electronic devices;
- **Easy Access Design.** With the outlets on 3 sides, it could allow multiple bulky or standard plugs to be used at the same time. The 360-degree rotating AC plug makes it suitable for all power receptacles;
- **°TD~EA~US09) Each USB charging port can intelligently identify your mobile device, and seeks to maximize its charging speed °USB~A: 2.4A, USB~C: 3.0A output).** Power Delivery charge technology for USB~C is NOT supported;
- **Rated at 1440 Joules,** it can protect your computers or home/office electronics from power disturbances, such as lightning, surges and spikes.

Frequently Asked Questions

- **Which USB port should I use to charge my device?**
All the 2 USB~A ports and 1 USB~C port can support smart charging technology, and can charge any 5V device

at full speed °USB~A: 2.4A, USB~C: 3.0A output Max.). For those devices with different voltage requirements, please plug your power block into the AC outlets instead.

- **Can my phone be charged up quickly via USB?**

This product doesn't support Quick Charge °QC2.0/3.0/4+) or Power Delivery technology. Therefore you may experience slow charging speed for your latest devices.

- **Why can't the USB ports charge my devices properly?**

Please verify whether this product has been securely plugged into your wall outlet or whether your USB charging cable works properly. If yes, this product could become defective. In this case, please email us at support@etrond.com for the help.

- **What shall I do when the surge protection indicator doesn't light up?**

It means that the surge protection has been exhausted and it can no longer protect your electric devices from power disturbances. It's time to replace this unit for future protection.

- **How do I check my device's input current and voltage?**

Please refer to your device's user manual, original OEM charging adapter, or contact the device manufacturer to get this information.

Documents / Resources



[TROND TD EA US09-E Outlet Extender with Rotating Plug](#) [pdf] User Guide

TD EA US09-E Outlet Extender with Rotating Plug, TD EA US09-E, Outlet Extender with Rotating Plug, Extender with Rotating Plug, Rotating Plug

References

- [User Manual](#)