



# TRIPP-LITE PDUMV30HV2 Single Phase Metered 0U Power Distribution Unit Owner’s Manual

[Home](#) » [Tripp Lite](#) » **TRIPP-LITE PDUMV30HV2 Single Phase Metered 0U Power Distribution Unit Owner’s Manual** 



Manufacturing  
Excellence.  
Single-Phase Metered 0U  
Power Distribution Unit  
(Bank Measurements)  
200/240V MODELS

<b>PDUMV30HV2</b> (Series Number: AG-013F)	<b>PDUMV32HV</b> (Series Number: AG-0140)
---	--

**PROTECT YOUR INVESTMENT!**  
Register your product for quicker service and ultimate peace of mind.  
You could also win an ISOBAR6ULTRA surge protector— a \$100 value!  
[www.tripplite.com/warranty](http://www.tripplite.com/warranty)



<http://www.tripplite.com/warranty>

## Contents

- [1 Important Safety Instructions](#)
- [2 Installation](#)
- [3 Installation](#)
- [4 Features](#)
- [5 Service](#)
- [6 Warranty and Product Registration](#)
- [7 Documents / Resources](#)
- [8 Related Posts](#)

## Important Safety Instructions

### SAVE THESE INSTRUCTIONS



This manual contains instructions and warnings that should be followed during the installation, operation, and storage of this product. Failure to heed these instructions and warnings may affect the product warranty.

**CAUTION** Only those who are properly trained or qualified to use this device should do so. Anyone who is not trained or qualified should not use this device unless it is under the supervision of someone who is properly trained or qualified to do so.

Children must be supervised to ensure that they do not use the device as a toy.

Never use the device if the cord and plug are damaged; if it is not working properly, or if it has been dropped or damaged, take it to an authorized service center for inspection and repair.

If the power cord is damaged, it must be replaced by the manufacturer, its authorized service agent, or by qualified personnel in order to avoid danger.

- The PDU provides the convenience of multiple outlets, but DOES NOT provide surge or line noise protection for connected equipment.
- The PDU is designed for indoor use only, in a controlled environment, away from excess moisture, temperature extremes, conductive contaminants, dust or direct sunlight.
- Keep the indoor ambient temperature between 32°F and 122°F (0°C and 50°C).
- The PDU must be installed by a qualified technician only.
- Do not attempt to mount the PDU to an insecure or unstable surface.
- Install in accordance with National Electrical Code standards. Be sure to use the proper overcurrent protection for the installation, in accordance with the plug/equipment rating.
- Connect the PDU to an outlet that is in accordance with your local building codes and that is adequately protected against excess currents, short circuits and earth faults.
- The electrical outlets supplying power to the equipment should be installed near the equipment and easily accessible.
- Do not connect the PDU to an ungrounded outlet or to extension cords or adapters that eliminate the connection to the ground.
- Be sure to provide a local disconnect device on any models that are permanently installed without a plug that is easily accessible.
- Never attempt to install electrical equipment during a thunderstorm.
- Individual equipment connected to the PDU should not draw more current than the individual PDU's outlet's rating.
- The total load connected to the PDU must not exceed the maximum load rating for the PDU.
- Do not attempt to modify the PDU, input plugs, or power cables.
- Do not drill into or attempt to open any part of the PDU housing. There are no user-serviceable parts inside.
- Do not attempt to use the PDU if any part of it becomes damaged.
- Use of this equipment in life support applications where the failure of this equipment can reasonably be expected to cause the failure of the life support equipment or to significantly affect its safety or effectiveness is not recommended. Do not use this equipment in the presence of a flammable anesthetic mixture with air, oxygen or nitrous oxide.

## Installation

### Mounting the PDU

Note: The illustrations may differ somewhat from your PDU model. Regardless of configuration, the user must determine the fitness of hardware and procedures before mounting. The PDU and included hardware are designed for common rack and rack enclosure types and may not be appropriate for all applications. Exact mounting configurations may vary. Screws for attaching the mounting brackets to the PDU are included. Use only the screws supplied by the manufacturer or their exact equivalent.

**Note:** Mounting buttons come preinstalled to the PDU for toolless mounting.

**1-1** To mount the PDU using the pre-installed mounting buttons, position the PDU as desired in the rack enclosure, align the buttons with the rack mounting slots, and slide the PDU into position.

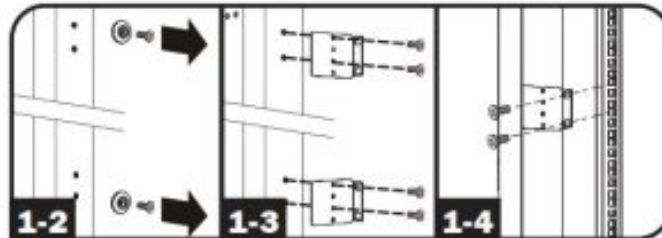
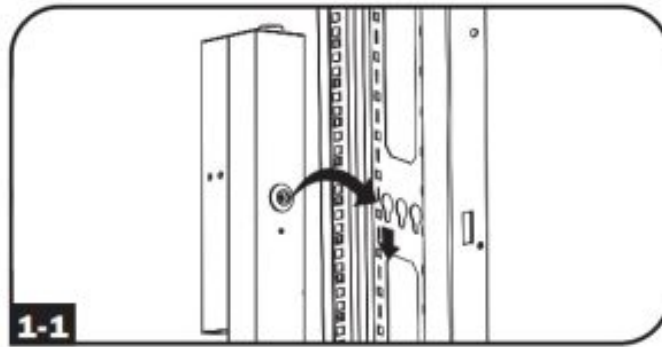

**1-2** To attach the mounting brackets to the PDU, remove the mounting buttons.

**1-3** Attach the mounting brackets to the PDU with the included screws.

**1-4** Attach the PDU to a vertical rail in your rack or rack enclosure. (Use the mounting hardware that came with your rack or rack enclosure to attach the mounting brackets to the rail.)

**1-5** To reinstall the mounting buttons for toolless mounting, remove the mounting brackets then install the mounting buttons onto the PDU.

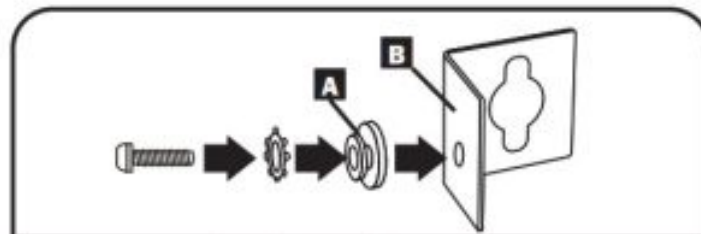
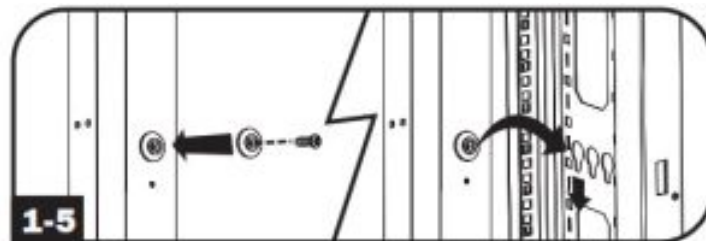

**Note:** Be sure to insert the 2 buttons into either the upper hole at each end of the PDU or into the lower hole at each end of the PDU.

**1-6** To install the PDU with its outlets facing the rear of the rack, use the included PDUMVROTATEBRKT accessory. First, attach the mounting button A to the V-shaped bracket B using the included screw and washer. Then, use the button-mount slot to attach the bracket to the PDU and the mounting button to attach the PDU to the rack. The bracket effectively repositions the mounting brackets allowing for the PDU outlets to face the rear of the rack.

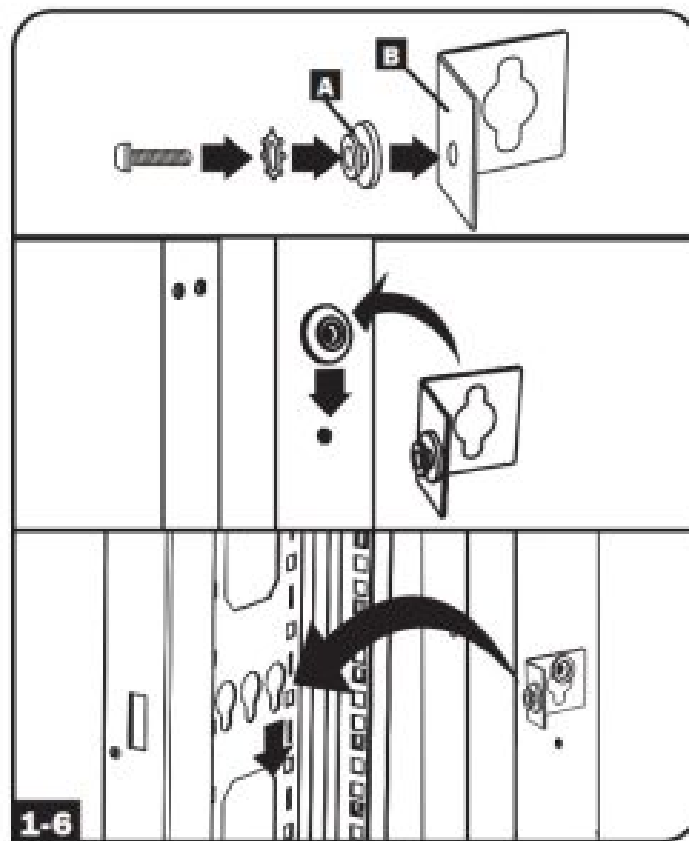

## Installation

### Connecting the PDU

**2-1** Each model is equipped with 1 of 2 different input plugs.

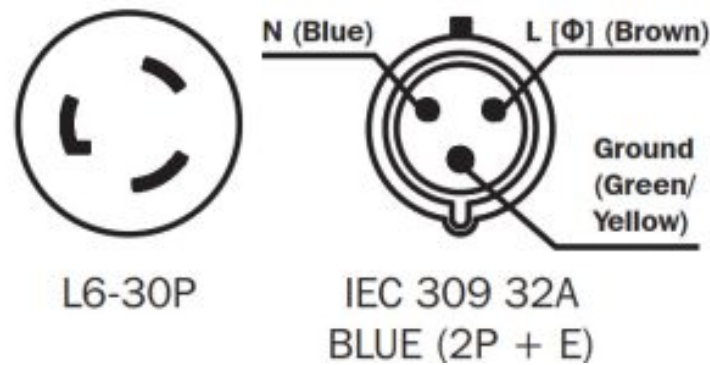

Model Name	Input Plug	Max Input Amps (Limited by Input Cord and Plug)	Input Voltage Range	Output Voltage Range	Breakers	Cord Length	Outlets
PDUMV3OH V2	L6-30P	—	200-240 V	200-240 V	2 x Double Pole. 20A Branch-Rated	10 ft. (3 “)	48 Total: 2 Banks of (4) C19 and (20) C13
PDUMV32HV	IEC 309 32A BLUE (2P + E)	32A	200-240 V	200-240 V	2 x Single Pole. 20A Branch-Rated		48 Total: 2 Banks of (4) C19 and (20) C13

**2-2** Connect the input plug to your facility's compatible AC power source.

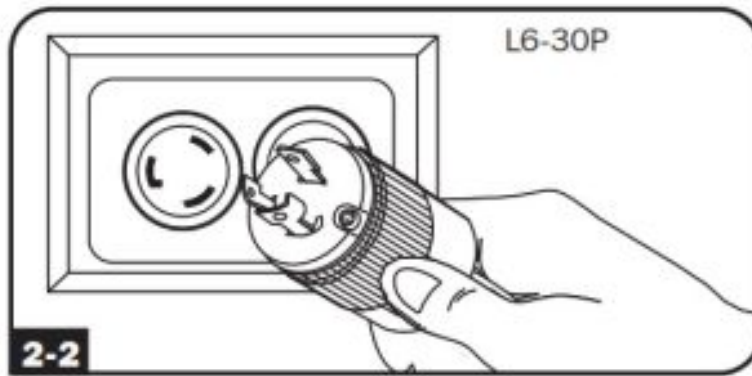

**2-3** Connect your equipment's input plugs to the appropriate outlets on the PDU.

**Note:** It is recommended that you do not connect a live load to the PDU. If the load you intend to connect has an ON/OFF switch, please turn the switch to OFF prior to connection.

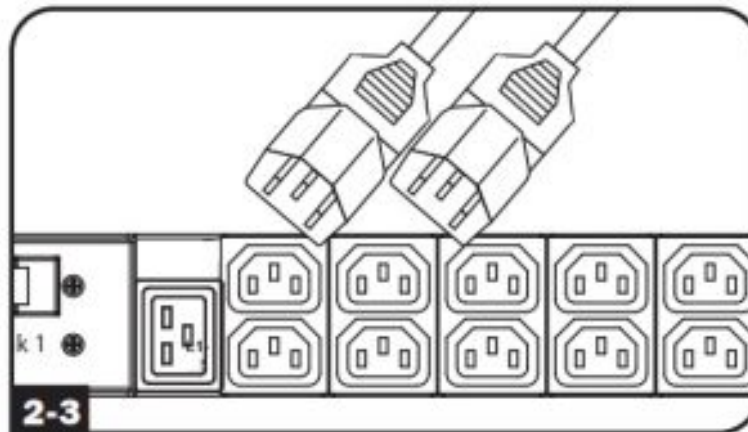

#### **2-4 Optional Cord Retention Procedure**

Use the included C14 and C20 plastic sleeves to secure plugs to receptacles. Attach the sleeve to the plug, making sure that the pull tabs A remain outside the plug and that the fit is secure. To unplug equipment properly, use the pull tabs to remove the plug and sleeve from the receptacle.

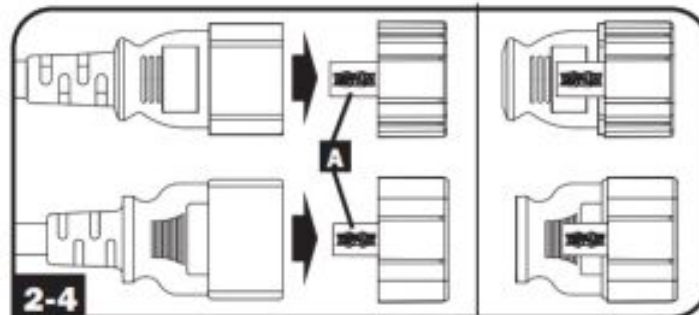

## **Features**

**Outlets:** During normal operation, the outlets distribute AC power to connected equipment.

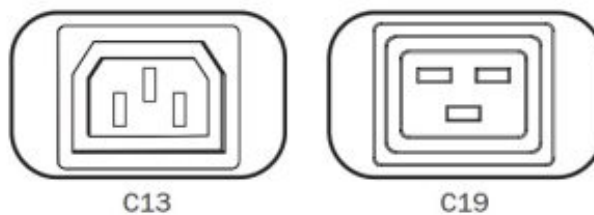

**Ammeter:** The electrical current used by each load bank will be displayed on the digital meter for that load bank in amperes.

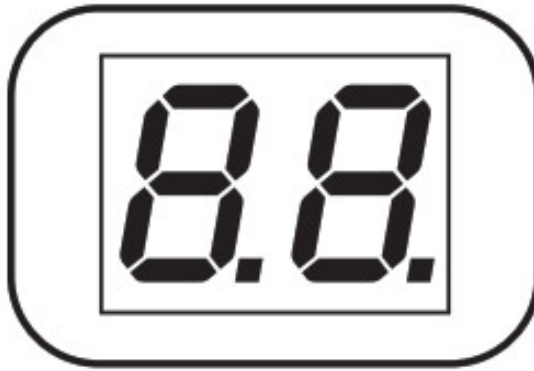

**Circuit Breaker (Select Models):** Each Load Bank is protected by a circuit breaker. If the connected equipment load exceeds the Maximum Load Rating for those banks of the PDU, the circuit breaker will trip. Disconnect excess load and reset the breaker.

**Note:** Each breaker comes equipped with a push-to-reset guard to prevent accidental breaker tripping. To turn off the breaker, insert a flathead screwdriver into the reset slot.

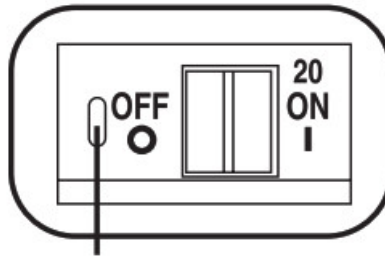

Push-to-Reset Guard

**Mounting Brackets:** Use these brackets as an alternate PDU mounting method.

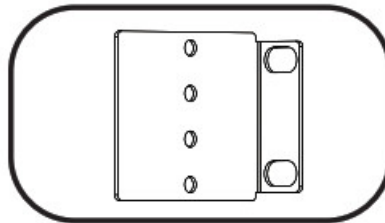

**Mounting Buttons:** Come pre-installed on the backside of the PDU and are used for toolless mounting. Note: Four additional mounting buttons are included for alternate rack styles.

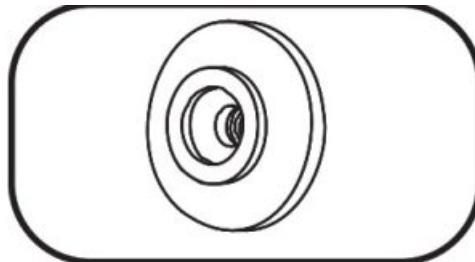

**PDUMVROTATEBRKT Mounting Accessory:** Use these V-shaped brackets to mount the PDU with its outlets facing the rear of the rack.

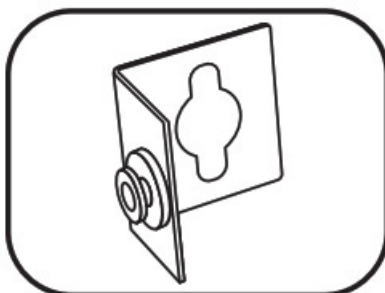

**C14 Plug Sleeve:** (Optional) Use the included C14 plastic sleeves to secure plugs to receptacles. Attach the sleeve to the plug making sure that the pull tabs remain outside the plug and that the fit is secure. To unplug equipment properly, use the pull tabs to remove the plug and sleeve from the receptacle.

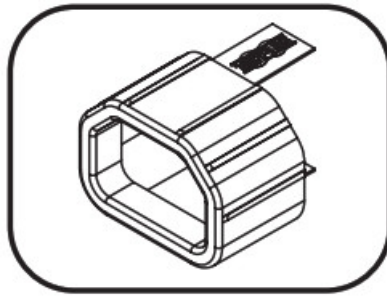

**C20 Plug Sleeve:** (Optional) Use the included C20 plastic sleeves to secure plugs to receptacles. Attach the sleeve to the plug making sure that the pull tabs remain outside the plug and that the fit is secure. To unplug equipment properly, use the pull tabs to remove the plug and sleeve from the receptacle.

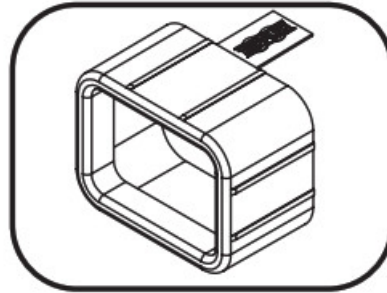

**Ground Screw:** Use this to connect any equipment that requires a chassis ground.



## Service

Your Tripp Lite product is covered by the warranty described in this manual. A variety of Extended Warranty and On-Site Service Programs are also available from Tripp Lite. For more information on the service, visit [www.tripplite.com/support](http://www.tripplite.com/support). Before returning your product for service, follow these steps:

1. Review the installation and operation procedures in this manual to ensure that the service problem does not originate from a misreading of the instructions.
2. If the problem continues, do not contact or return the product to the dealer. Instead, visit [www.tripplite.com/support](http://www.tripplite.com/support).
3. If the problem requires service, visit [www.tripplite.com/support](http://www.tripplite.com/support) and click the Product Returns link. From here you can request a Returned Material Authorization (RMA) number, which is required for service. This simple online form will ask for your unit's model and serial numbers, along with other general purchaser information. The RMA number, along with shipping instructions will be emailed to you. Any damages (direct, indirect, special or consequential) to the product incurred during shipment to Tripp Lite or an authorized Tripp Lite service center is not covered under warranty. Products shipped to Tripp Lite or an authorized Tripp Lite service center must have transportation charges prepaid. Mark the RMA number on the outside of the package. If the product is within its warranty period, enclose a copy of your sales receipt. Return the product for service using an insured carrier to the address given to you when you request the RMA.

## Warranty and Product Registration

### 2-YEAR LIMITED WARRANTY



Seller warrants this product, if used in accordance with all applicable instructions, to be free from original defects in material and workmanship for a period of 2 years from the date of initial purchase. If the product should prove defective in material or workmanship within that period, Seller will repair or replace the product, in its sole discretion. Service under this Warranty can only be obtained by your delivering or shipping the product (with all shipping or delivery charges prepaid) to: Tripp Lite, 1111 W. 35th Street, Chicago, IL 60609 USA. Seller will pay return shipping charges. Visit [www.tripplite.com/support](http://www.tripplite.com/support) before sending any equipment back for repair.

THIS WARRANTY DOES NOT APPLY TO NORMAL WEAR OR TO DAMAGE RESULTING FROM ACCIDENT, MISUSE, ABUSE OR NEGLIGENCE. SELLER MAKES NO EXPRESS WARRANTIES OTHER THAN THE WARRANTY EXPRESSLY SET FORTH HEREIN. EXCEPT TO THE EXTENT PROHIBITED BY APPLICABLE LAW, ALL IMPLIED WARRANTIES, INCLUDING ALL WARRANTIES OF MERCHANTABILITY OR FITNESS, ARE LIMITED IN DURATION TO THE WARRANTY PERIOD SET FORTH ABOVE; AND THIS WARRANTY EXPRESSLY EXCLUDES ALL INCIDENTAL AND CONSEQUENTIAL DAMAGES. (Some states do not allow limitations on how long an implied warranty lasts, and some states do not allow the exclusion or limitation of incidental or consequential damages, so the above limitations or exclusions may not apply to you. This Warranty gives you specific legal rights, and you may have other rights which vary from jurisdiction to jurisdiction).

**WARNING:** The individual user should take care to determine prior to use whether this device is suitable, adequate or safe for the use intended. Since individual applications are subject to great variation, the manufacturer makes no representation or warranty as to the suitability or fitness of these devices for any specific application.

### PRODUCT REGISTRATION

Visit [www.tripplite.com/warranty](http://www.tripplite.com/warranty) today to register your new Tripp Lite product. You'll be automatically entered into a drawing for a chance to win a FREE Tripp Lite product!\*

\* No purchase necessary. Void where prohibited. Some restrictions apply. See website for details.

### FCC Notice, Class A

This device complies with part 15 of the FCC Rules. Operation is subject to the following two conditions:

(1) This device may not cause harmful interference, and (2) this device must accept any interference received, including interference that may cause undesired operation.

**Note:** This equipment has been tested and found to comply with the limits for a Class A digital device, pursuant to part 15 of the FCC Rules. These limits are designed to provide reasonable protection against harmful interference when the equipment is operated in a commercial environment. This equipment generates, uses, and can radiate radio frequency energy and, if not installed and used in accordance with the instruction manual, may cause harmful interference to radio communications. Operation of this equipment in a residential area is likely to cause harmful interference in which case the user will be required to correct the interference at his own expense. The user must use shielded cables and connectors with this equipment. Any changes or modifications to this equipment not expressly approved by Tripp Lite could void the user's authority to operate this equipment.

### Regulatory Compliance Identification Numbers

For the purpose of regulatory compliance certifications and identification, your Tripp Lite product has been assigned a unique serial number. The serial number can be found on the product nameplate label, along with all required approval markings and information. When requesting compliance information for this product, always refer to the series number. The series number should not be confused with the marking name or model number of the product. WEEE Compliance Information for Tripp Lite **Customers and Recyclers (European Union)**



Under the Waste Electrical and Electronic Equipment (WEEE) Directive and implementing regulations, when customers buy new electrical and electronic equipment from Tripp Lite they are entitled to:

- Send old equipment for recycling on a one-for-one, like-for-like basis (this varies depending on the country)
- Send the new equipment back for recycling when this ultimately becomes waste Tripp Lite has a policy of continuous improvement. Specifications are subject to change without notice.





Manufacturing  
Excellence.

1111 W. 35th Street, Chicago, IL 60609 USA • [www.tripplite.com/support](http://www.tripplite.com/support)  
Copyright © 2018 Tripp Lite. All rights reserved.

## Documents / Resources

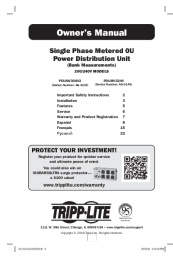
	<p><a href="#">TRIPP-LITE PDUMV30HV2 Single Phase Metered 0U Power Distribution Unit</a> [pdf] Owner's Manual</p> <p>PDUMV30HV2, PDUMV32HV, AG-013F, AG-0140, PDUMV30HV2 Single Phase Metered 0U Power Distribution Unit, Single Phase Metered 0U Power Distribution Unit, Metered 0U Power Distribution Unit, Power Distribution Unit, Distribution Unit</p>
--	---

[Manuals+](#)