



TRIPP LITE B156-004-HD-V3 DisplayPort 1.2 to HDMI MST Hub Owner's Manual

[Home](#) » [Tripp Lite](#) » TRIPP LITE B156-004-HD-V3 DisplayPort 1.2 to HDMI MST Hub Owner's Manual 



Owner's Manual
4-Port DisplayPort 1.2
to HDMI MST Hub
Model: B156-004-HD-V3

Contents

- [1 B156-004-HD-V3 DisplayPort 1.2 to HDMI MST Hub](#)
- [2 Package Contents](#)
- [3 Product Features](#)
- [4 System Requirements](#)
- [5 Product Overview](#)
- [6 Installation](#)
- [7 Troubleshooting](#)
- [8 Specifications](#)
- [9 Warranty and Product Registration](#)
- [10 Documents / Resources](#)
 - [10.1 References](#)

B156-004-HD-V3 DisplayPort 1.2 to HDMI MST Hub

WARRANTY REGISTRATION

Register your product today and be automatically entered to win an ISOBAR® surge protector in our monthly drawing!

1111 W. 35th Street, Chicago, IL 60609 USA • [tripplite.com/support](https://www.tripplite.com/support)

Copyright © 2023 Tripp Lite. All rights reserved.

[tripplite.com/warranty](https://www.tripplite.com/warranty)

Package Contents

- B156-004-HD-V3, 4-Port DisplayPort 1.2 to HDMI MST Hub
- External power supply (Input: 100–240V, 50/60 Hz, 0.35A; Output: 5V 2A)
- International plug adapters (North America, Europe, U.K. and Australia)
- Owner's Manual

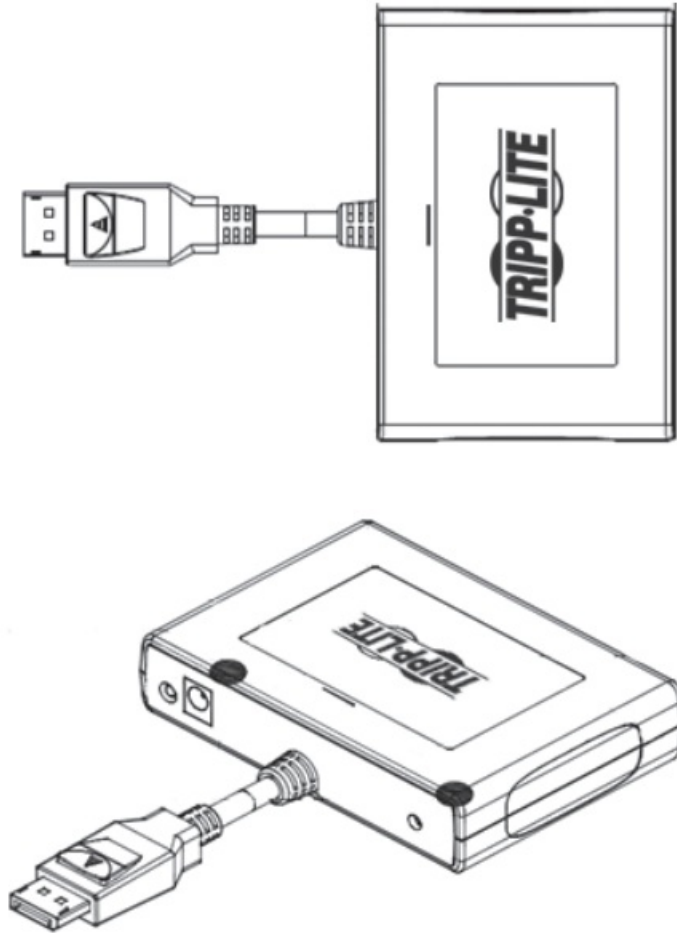

Product Features

- Connect multiple HDMI monitors via the DisplayPort output on your computer to display the same image on each monitor, extend the desktop across monitors, or combine as one enlarged monitor in video wall mode.*
- DisplayPort v1.2 and Multi-Stream Transfer (MST) Compliant.*
- Built-in cable connects directly to a DisplayPort source.
- DisplayPort and HDMI output models support 4K x 2K Ultra High Definition (UHD) resolutions up to 3840 x 2160 (60 Hz) – see System Requirements for more information.
- Supports up to 16-bit Deep Color.
- Supports 2-Channel LPCM. AC3. DTS. Bit depth up to 24 bits. Sample rate up to 192 kHz.
- Supports HDCP and DDC.
- Compliant with the Federal Trade Agreements Act (TAA) for GSA Schedule purchases.

* Backward compatible with most DisplayPort 1.1a equipment running current graphics drivers. The feature set is limited to the attached equipment's capabilities (e.g. you may be limited to displaying in Clone / Mirror mode only). Compatibility with older graphics cards is not guaranteed.*

System Requirements

A computer with a DisplayPort v1.2 compatible Graphics Card (e.g., AMD Radeon with AMD Eyefinity Technology). Backward compatible with most DisplayPort 1.1a equipment running current graphics drivers. The feature set is limited to that of the attached equipment (e.g., you may be limited to displaying in Clone / Mirror mode only). Compatibility with older graphics cards is not guaranteed.

- MacOS does not support MST for NVIDIA and Intel Graphics Processor Units, limiting video display on the connected monitors to mirror mode.
- DisplayPort MST Hub.
- External Power Supply (Input: 100-240V, 50/60 Hz, 0.5A;
Output: 5V 2A).

Optional Accessories

- P569-CERT Series High-Speed HDMI 2.0 Cables

Product Overview

Rear

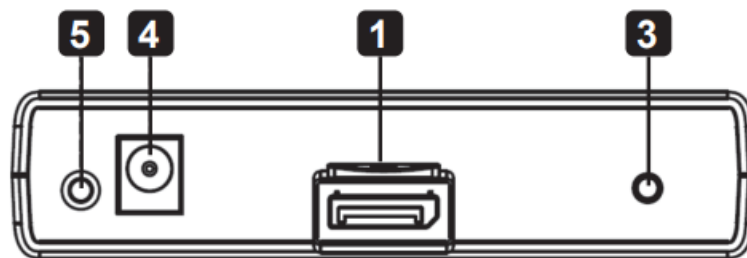

Front

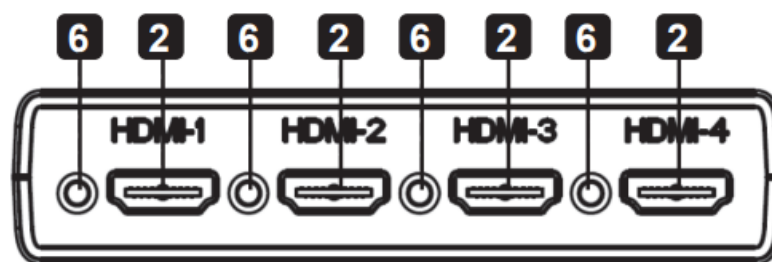

1. DisplayPort INPUT – Connect to DisplayPort source.
2. HDMI OUTPUT – Connect to HDMI Display, Monitor, TV, etc.
3. RESET – Use a ballpoint pen to reset the signal being sent to the connected displays.
4. POWER INPUT – Connect 5V 2ADC power supply.
5. Power LED Indicator – LED illuminates to indicate the switch is receiving power. The LED must illuminate solid green.
6. Display LEDs – LEDs illuminate to indicate that a display output is connected. The LED will illuminate orange.

Installation

Prior to installation, ensure your graphics driver is up to date by installing the latest driver available. The MST hub is backward compatible with most DisplayPort 1.1a equipment running current graphics drivers. The feature set is limited to the attached equipment's capabilities (e.g., you may be limited to displaying in Clone / Mirror mode only). Compatibility with older graphics cards is not guaranteed. Make sure the power to all connected devices is turned off prior to installation.

1. Connect the hub's built-in cable to the computer's DisplayPort output.
2. Connect the included external power supply to the hub and plug it into a Tripp Lite Surge Protector, Uninterruptible Power Supply (UPS) or Power Distribution Unit (PDU).
The Power LED will illuminate green.
3. Connect a monitor to an available output port on the hub.
Note: The maximum distance between the hub and the connected monitor must not exceed 15 ft. (4.6 m).
4. Repeat step 4 for each additional monitor you are connecting.
5. Turn ON the power to the connected monitors, then power on the source. The port LEDs will illuminate orange to indicate a signal is being received and video will appear on the connected monitors.
6. Use your video card's display settings screen to adjust how video is displayed on the connected monitors.

Troubleshooting

If you are unable to get an acceptable image after following the installation instructions, try the troubleshooting tips below.

1. Is your equipment running the latest graphics driver?
If not, download the latest graphics drivers for your equipment.
The MST hub is backward compatible with most DisplayPort 1.1a equipment running current graphics drivers. The feature set is limited to the attached equipment's capabilities (e.g., you may be limited to displaying in Clone / Mirror mode only).
Compatibility with older graphics cards is not guaranteed.
2. Press the hub's reset button to reset the signal being sent to the connected displays.
3. Is the included external power supply connected and plugged into a working power source? In order for the product to function properly, it must be connected and receiving power through the external power supply.
4. Was the power to the DisplayPort source and connected monitors turned off prior to installation?
If not, restart your computer.
5. What cable lengths are you using? The maximum cable length between the hub and the connected monitors should not exceed 15 ft. (4.6 m).
6. What type of cabling are you using? Inferior cabling can result in poor performance. It is important to use cables that support the video resolution you are trying to obtain.
It is recommended you use the Tripp Lite cables listed in the Optional Accessories section, as they have been tested to work with the MST Hubs.
7. Test your cables to ensure they are working properly.
For example, connect your DisplayPort cables between a source and monitor setup you know works to determine if the cable is functioning properly.

Specifications

Max Distance to Display	Up to 15 ft. (4.6 m)
Max Supported Color Depth	16-bit Deep Color
HDR Support	No
HDMI Specification	Version 1.4
Chroma Sub Sampling	4:04:04
HDCP	1.
3D Video Support	Yes
Audio Specification	2-Ch LPCM. AC3. DTS. Bit depth up to 24 bits. Sample rate up to 192 kHz.
Chipset	Yes
IR or RS-232 Extension Support	No
Consumer Electronic Control (CEO) Support	No
Driver Required	No
Operating Temperature Range	14°F to 157°F (-10°C to 75°C)
Storage Temperature Range	-4 F to 176°F (-20 C to 80°C)
Relative Humidity	0% to 85%, Non-Condensing
Material Construction	ABS Plastic
Connector/Contact Plating	Nickel/Gold

Warranty and Product Registration

3-Year Limited Warranty

Tripp Lite warrants its products to be free from defects in materials and workmanship for a period of three (3) years from the date of initial purchase. Tripp Lite's obligation under this warranty is limited to repairing or replacing (at its sole option) any such defective products. To obtain service under this warranty, you must obtain a Returned Material Authorization (RMA) number from Tripp Lite or an authorized Tripp Lite service center. Products must be returned to Tripp Lite or an authorized Tripp Lite service center with transportation charges prepaid and must be accompanied by a brief description of the problem encountered and proof of date and place of purchase.

This warranty does not apply to equipment, which has been damaged by accident, negligence or misapplication or has been altered or modified in any way.

EXCEPT AS PROVIDED HEREIN, Tripp Lite MAKES NO WARRANTIES, EXPRESS OR IMPLIED, INCLUDING WARRANTIES OF MERCHANTABILITY AND FITNESS FOR A PARTICULAR PURPOSE. Some states do not permit limitation or exclusion of implied warranties; therefore, the aforesaid limitation(s) or exclusion(s) may not apply to the purchaser.

EXCEPT AS PROVIDED ABOVE, IN NO EVENT WILL Tripp Lite BE LIABLE FOR DIRECT, INDIRECT, SPECIAL, INCIDENTAL OR CONSEQUENTIAL DAMAGES ARISING OUT OF THE USE OF THIS PRODUCT, EVEN IF ADVISED OF THE POSSIBILITY OF SUCH DAMAGE. Specifically, Tripp Lite is not liable for any costs, such as lost profits or revenue, loss of equipment, loss of use of equipment, loss of software, loss of data, costs of substitutes, claims by third parties, or otherwise.

PRODUCT REGISTRATION

Visit tripplite.com/warranty today to register your new Tripp Lite product. You'll be automatically entered into a drawing for a chance to win a FREE Tripp Lite product!*

* No purchase necessary. Void where prohibited.

Some restrictions apply. See website for details.

FCC Notice, Class B

This device complies with part 15 of the FCC Rules.

Operation is subject to the following two conditions:

(1) This device may not cause harmful interference, and (2) this device must accept any interference received, including interference that may cause undesired operation.

Note: This equipment has been tested and found to comply with the limits for a Class B digital device, pursuant to part 15 of the FCC Rules. These limits are designed to provide reasonable protection against harmful interference in a residential installation. This equipment generates, uses and can radiate radio frequency energy and, if not installed and used in accordance with the instructions, may cause harmful interference to radio communications. However, there is no guarantee that interference will not occur in a particular installation. If this equipment does cause harmful interference to radio or television reception, which can be determined by turning the equipment off and on, the user is encouraged to try to correct the interference by one or more of the following measures:

- Reorient or relocate the receiving antenna.
- Increase the separation between the equipment and receiver.
- Connect the equipment into an outlet on a circuit different from that to which the receiver is connected.
- Consult the dealer or an experienced radio/TV technician for help.

Any changes or modifications to this equipment not expressly approved by Tripp Lite could void the user's authority to operate this equipment.

Warranty and Product Registration

WEEE Compliance Information for Tripp Lite Customers and Recyclers (European Union)

Under the Waste Electrical and Electronic Equipment (WEEE) Directive and implementing regulations, when customers buy new electrical and electronic equipment from Tripp Lite they are entitled to:

- Send old equipment for recycling on a one-for-one, like-for-like basis (this varies depending on the country).
- Send the new equipment back for recycling when this ultimately becomes waste.

Use of this equipment in life support applications where failure of this equipment can reasonably be expected to cause the failure of the life support equipment or to significantly affect its safety or effectiveness is not recommended.

Tripp Lite has a policy of continuous improvement.

Specifications are subject to change without notice. Photos and illustrations may differ slightly from actual products.



1111 W. 35th Street, Chicago, IL 60609 USA • [tripplite.com/support](https://www.tripplite.com/support)

Documents / Resources

	<p>TRIPP LITE B156-004-HD-V3 DisplayPort 1.2 to HDMI MST Hub [pdf] Owner's Manual B156-004-HD-V3 DisplayPort 1.2 to HDMI MST Hub, B156-004-HD-V3, DisplayPort 1.2 to HDM I MST Hub, 1.2 to HDMI MST Hub, HDMI MST Hub, MST Hub</p>
---	--

References

- [ETN Help Center | Eaton](#)
- [ETN Product Registration | Eaton](#)
- [Manual-Hub.com - Free PDF manuals!](#)
- [User Manual](#)

[Manuals+](#), [Privacy Policy](#)

This website is an independent publication and is neither affiliated with nor endorsed by any of the trademark owners. The "Bluetooth®" word mark and logos are registered trademarks owned by Bluetooth SIG, Inc. The "Wi-Fi®" word mark and logos are registered trademarks owned by the Wi-Fi Alliance. Any use of these marks on this website does not imply any affiliation with or endorsement.