

Triple

**CBM-COAMAP-5
CBM Controller**



Triple CBM-COAMAP-5 CBM Controller Installation Guide

[Home](#) » [Triple](#) » Triple CBM-COAMAP-5 CBM Controller Installation Guide 

Contents

- [1 Triple CBM-COAMAP-5 CBM Controller](#)
- [2 Triple plus CBM system](#)
- [3 Controller description](#)
- [4 Batteries Installation](#)
- [5 Controller LED behavior](#)
- [6 FCC Statements](#)
- [7 Documents / Resources](#)
 - [7.1 References](#)

Triple

Triple CBM-COAMAP-5 CBM Controller



Welcome

Thank you for choosing Tripleplus CBM Controller.

Tripleplus CBM (Cloud Building Management) products family is the ultimate Water Management as well as Leak Damage Prevention cloud-based solution. The CBM Products family solution is managed via an App and is designed to manage water usage and prevent damage due to water leaks. Tripleplus offers you total peace of mind when you are in or away.

The Controller is the hub of the system. From the 915MHz radio side, it is connecting to all the sensors and other end devices. From the Ethernet connection side, if by Ethernet port or Wi-Fi connection or GSM connection, it communicates with the different Mobile and WEB applications through the cloud. The controller's role is to control and execute the system configuration rules and commands.

Please note

Please read these instructions carefully and follow the system's installation and commissioning steps. Maintain this document in a safe place for future reference.

Warning! This product was designed to manage and control Tripleplus devices to manage water usage and prevent water leak damage. It should be used for this purpose only.

Triple plus CBM system

Tripleplus CBM's line of products includes innovative battery-operated devices that enable the automated control of water valves. This is unified under the "Cloud Building Management" and "Smart Home" umbrella. The Tripleplus CBM Controller serves as a Gateway that ensures secured communication between the system devices, Tripleplus cloud, and App. Tripleplus CBM integrates easily into the Cloud Building Management and Smart Home IoT ecosystem, providing a unique cloud-based secured platform for Water management and Leak Management.

Triple plus CBM Controller technical specification

Part No.	CBM-COAMAP-5-xx
Product Description	Secured and reliable Tripleplus CBM The controller communicates with the connected devices and the Tripleplus Cloud.
Dimensions	25x68x131mm (1×2.68×5.16")
Weight	155gr (5.28 Oz)
Power supply	External Adaptor Input 110-240 V AC Optional PoE (Power Over Ethernet) – 802.3AF
Operation voltage	5V (2 x AA backup batteries. Up to 8 hours Or optional Rechargeable Battery)
Operating RF	868/915/916 MHz
Transmission range	Open space – up to 230 m (750 ft.) Indoor – up to 120 m (390 ft.) Avoid installing it in a metal cabinet.
Working Temperature	-20 to +50°C (-4 to +122°F)
Certifications	FCC ID: 2AFOICBMCOLR5 IC: 20798-CBMCOLR5

Controller description

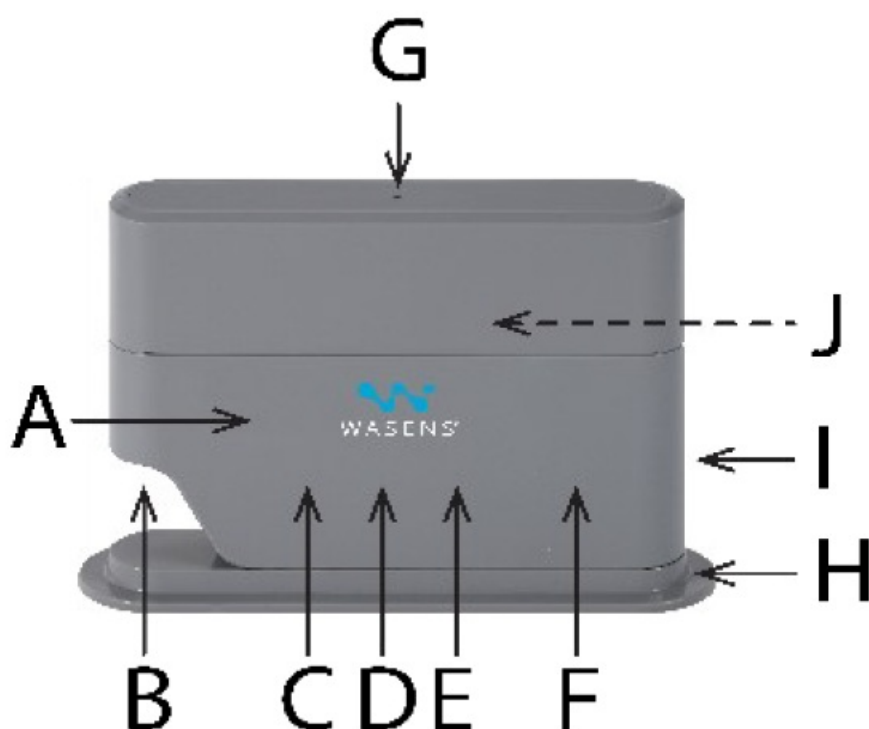

- A. WASENS– Tripleplus Water Sense Logo
- B. Power Plug Inlet
- C. Ethernet port, optional – PoE (Power Over Ethernet)
- D. Optional – SIM Card
- E. Terminal port
- F. AA Batteries, optional – rechargeable battery
- G. RGB LED indicator
- H. Table stand.
- I. Lower cover
- J. Wall mounting bracket (rear part)

Batteries Installation

1. Slide down the lower cover.
2. Insert 2 x AA batteries (included)
3. Slide back up the lower cover.

Warning! Do not attempt to rotate the HUB on the mounting to avoid physical damage to the enclosure.

Controller Wall Installation

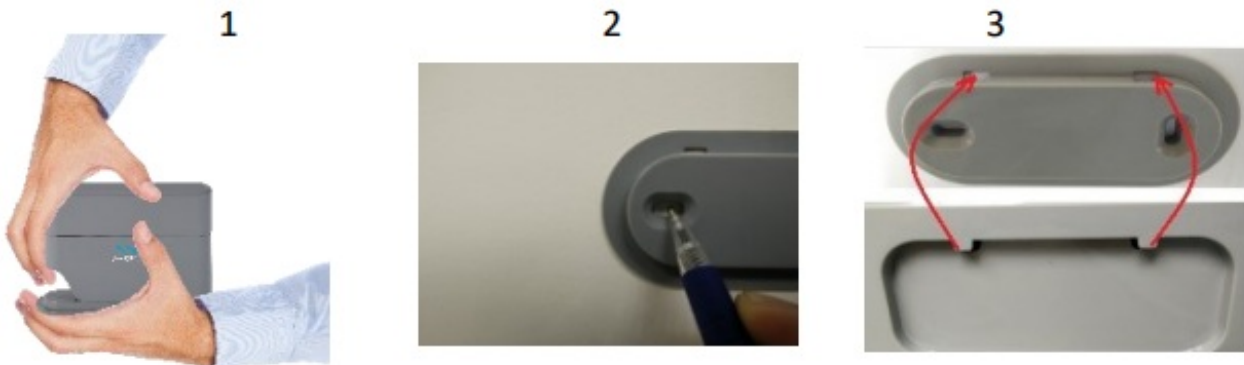

1. Detach the HUB from the table stand as shown here below.
2. Attach the wall mounting bracket to its location and mark the holes for the mounting screws.
3. Place the HUB's rear mounting pins close to the wall and gently slide down the wall mount dimples.

Controller Table installation

For table use, connect the table stand to the Controller and place it on the table.



Controller LED behavior

- GREEN flashes every 2 Sec – OK
- BLUE flashes every 2 Sec – Failure in communication with the Triple Plus Cloud or with any system's device
- RED flashes every 2 Sec – battery status warning / low battery, in Hub or one of the devices.
- System Component Synchronization and activationTriple pluss CBM devices are installed and activated using triple plus CBM installers or End-User APP available on AppStore and Google Play.
- This Controller is designed for indoor use only and should be installed by an authorized installer.

Warranty instructions

Please visit www.tripleplus.io/support for warranty, technical support, terms, and conditions, or troubleshooting.

Controller model table

Brand/Item	Type/Model	Short Product Description
Controller – Full configuration	CBM-COAMAP-5-01	Wi-Fi, Eth, PoE, GSM-M3, Terminal ports, Rechargeable Battery
Controller – partial configuration	CBM-COAMAP-5-02	Wi-Fi, Eth, PoE, AA Battery
Controller – partial configuration	CBM-COAMAP-5-03	Wi-Fi, Eth, PoE, Rechargeable Battery
Controller – partial configuration	CBM-COAMAP-5-04	Wi-Fi, ETH, Rechargeable Battery
Controller – partial configuration	CBM-COAMAP-5-05	Wi-Fi Only, Rechargeable Battery
Controller – partial configuration	CBM-COAMAP-5-06	Full configuration (Wi-Fi, Eth, PoE, GSM(M3), AA Battery
Controller – partial configuration	CBM-COAMAP-5-07	Wi-Fi, Eth, AA Battery
Controller – partial configuration	CBM-COAMAP-5-08	Wi-Fi Only, AA Battery

FCC Statements

This device complies with Part 15 of the FCC Rules. Operation is subject to the following two conditions:

1. This device may not cause harmful interference, and
 2. This device must accept any interference received, including interference that may cause undesired operation.
- Changes or modifications not expressly approved by the party responsible for compliance could void the user's authority to operate this equipment.

Note: This equipment has been tested and found to comply with the limits for a Class B digital dependent to part 15 of the FCC Rules. These limits are designed to provide reasonable protection against harmful interference in a residential installation. This equipment generates, uses, and can radiate radio frequency energy and, if not installed and used by the instructions may cause harmful interference to radio communications. However, there is no guarantee that interference will not occur in a particular installation. If this equipment does cause harmful interference to radio or television reception, which can be determined by turning the equipment off and on, the user is encouraged to try to correct the interference by one or more of the following measures:

- Reorient or relocate the receiving antenna.
- Increase the separation between the equipment and the receiver.
- Connect the equipment to an outlet on a circuit different from that to which the receiver is connected.
- Consult the dealer or an experienced radio/TV technician for help.

WARNING – RF EXPOSURE COMPLIANCE

This equipment should be installed and operated with a minimum distance of 20cm between the radiator and your body.

- This Class B digital apparatus complies with the Canadian ICES-003.

IC Statements

This device contains license-exempt transmitter(s)/receiver(s) that comply with Innovation, Science, and Economic Development Canada's license-exempt RSS(s).

Operation is subject to the following two conditions:
This device may not cause interference.

1. This device must accept any interference, including interference that may cause undesired operation of the device.

TriplePluss Ltd. | 5 Hamada St., High Tech Park, Yoqneam, 2069200, Israel
+972-(0)72-2211370
info@tripleplus.io | www.tripleplus.io

Documents / Resources

	<p>Triple CBM-COAMAP-5 CBM Controller [pdf] Installation Guide CBM-COAMAP-5 CBM Controller, CBM-COAMAP-5, CBM Controller, Controller</p>
--	--

References

- [User Manual](#)

[Manuals+](#), [Privacy Policy](#)

This website is an independent publication and is neither affiliated with nor endorsed by any of the trademark owners. The "Bluetooth®" word mark and logos are registered trademarks owned by Bluetooth SIG, Inc. The "Wi-Fi®" word mark and logos are registered trademarks owned by the Wi-Fi Alliance. Any use of these marks on this website does not imply any affiliation with or endorsement.