



TRIKES TP710 Dino Discovery, TP711 Unicorn Magic Instruction Manual

[Home](#) » [TRIKES](#) » TRIKES TP710 Dino Discovery, TP711 Unicorn Magic Instruction Manual 

TRIKES TP710 Dino Discovery, TP711 Unicorn Magic Instruction Manual



4in1

TP710 Dino Discovery
TP711 Unicorn Magic



Instructions for assembly, maintenance and safe use.

We constantly strive to improve our assembly instructions. To see the most current version of this instruction for assembly, maintenance and safe use. Please visit the product page at tptoys.com



This is a trike, **NOT** a stroller

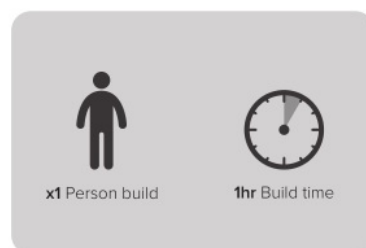

tptoys.com

tptoys.com

WARNINGS

- PLEASE READ THIS INSTRUCTION BOOKLET AND RETAIN AS IT CONTAINS IMPORTANT INFORMATION
- THIS IS A TRIKE NOT A STROLLER.

- UPON OPENING, THIS PRODUCT CONTAINS SMALL COMPONENT PARTS WHICH ARE CHOKING HAZARD SO IS NOT SUITABLE FOR CHILDREN UNDER 36 MONTHS UNTIL FULLY ASSEMBLED.
- THIS TOY IS INTENDED FOR CHILDREN FROM 10 MONTHS+ AND UP TO 23KGS/50LBS.
- TOY MUST BE ASSEMBLED BY AN ADULT BEFORE USE.
- REMOVE ALL PACKAGING BEFORE GIVING TO YOUR CHILDREN.
- CHILDREN MUST NOT USE THIS PRODUCT UNTIL PROPERLY ASSEMBLED.
- ADULT SUPERVISION IS REQUIRED AT ALL TIMES.
- THIS TOY HAS NO BRAK.E. RETAIN PACKAGING FOR FUTURE REFERENCE.
- THIS TOY HAS NO BRAKES.
- THIS TOY MUST NOT BE USED IN TRAFFIC.
- SHOES MUST BE WORN AT ALL TIMES.
- RIDE-ON TOYS SHOULD NOT BE USED NEAR MOTOR VEHICLES, STREETS, SWIMMING POOLS, ON OR NEAR STEPS, HILLS, ROADWAYS, OR INCLINES.
- ONLY ONE RIDER AT A TIME.
- CONTENTS, SPECIFICATIONS AND COLOUR MAY VARY FROM IMAGES.

In addition to the above warnings – important instructions for assembly, maintenance and safe use of the Trike.

Before Use

1. Read and understand this instruction booklet before letting your child use the product.
2. The product batch number is on the product frame. Record the batch number on the back page.
3. This product is a toy. Instruct the child how to use it correctly and explain sources of potential danger.
4. Make sure parent handle is securely attached before use. 5. This product is for private use only. No commercial or public use.
6. Toy must be assembled by an adult before use exactly in accordance with the instructions.
7. Remove all packaging before giving to your children.
8. Children must not use this product until properly assembled in accordance with this manual.

During Use

9. Maximum child weight: 23 kg (50lbs).
10. The age recommendation for this product is clearly stated on the packaging and in these instructions. Please adhere to it at all times.
11. Direct adult supervision at ALL times. It may be dangerous to leave the child unattended.
12. Excessive weight on the parent or child handle may cause a hazardous or unstable condition.
13. Protective safety equipment (such as a helmet, knee pads and elbow pads) is recommended.

14. Ensure children's clothing is appropriate for the play activity.
15. Ensure children wear strong closed shoes while using the product.
16. Product should be used with caution since the product only has 3 wheels and skill is required to avoid falls or collisions which may cause injury to the user or others.
17. Never allow more than one rider.
18. This product should only be used on safe ground. It should not be used near steps, slopes, traffic, roadways, public highways, swimming pools or wet areas.
19. Safeguard the product against rolling away, and avoid using the product during strong winds.
20. Never place this product near a fire.
21. Never push the product in excess of walking pace.
22. Unpredicted situations may arise when children are at play for which the manufacturer cannot be held liable for damage or injury.

Assembly and Maintenance Information

23. Check all parts are present before you start to assemble the product. Ensure your working area is free of danger. Place small parts on a tray or similar to ensure they are not lost.
24. The manufacturing process can very occasionally result in sharp edges/waste material so please take care when assembling this product.
25. Ensure that all components are out of the reach of children under 36 months until the product is fully assembled. A child playing with a plastic bag is exposed to the risk of suffocation.
26. Take caution when assembling the product. Tools can cause injury.
27. Regular safety checks should be carried out to ensure integrity of the assembly. Especially components that can potentially loosen or dislocate. Inspecting at regular intervals can prevent accidents.
28. Damaged components may endanger the safety of the child or shorten the lifespan of the product. Incorrect repairs or removal of other parts may be a source of danger to the user.
29. Changes to this toy (such as changing / adding an accessory) must be done in accordance with our instructions. Failure to do this will render your guarantee null and void and may make your product unsafe.
30. When you dispose of this product or packaging materials, please do so responsibly.
31. Never use corrosive or abrasive substances to clean the product. Never use substances which may pollute the environment.

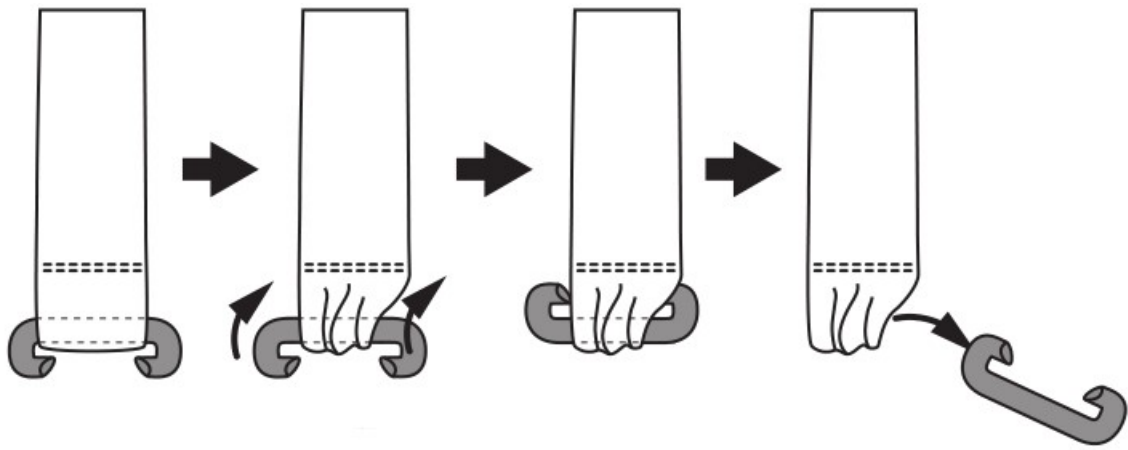

Harness must be assembled and removed by adult.

Contents



TP710 - CN7001
TP711 - CN7002

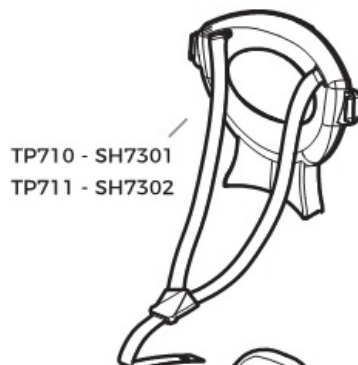

TP710 - SH7301
TP711 - SH7302

TP710 - SA7401
TP711 - SA7402



TP710 - PH7010
TP711 - PH7011

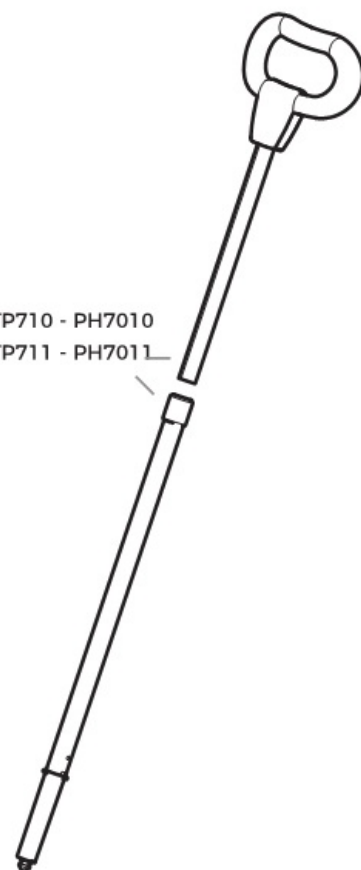

TP710 - CH7101
TP711 - CH7102



TP710 - ST7501
TP711 - ST7502



TP710 - WHR7701
TP711 - WHR7702



TP710 - RBT7601
TP711 - RBT7602

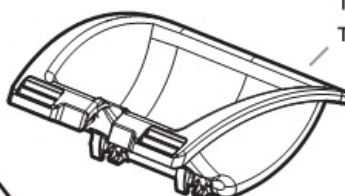

TP710 - MG7020
TP711 - MG7021



TP710 - MF7121
TP711 - MF7122



TP710 - WHL7801
TP711 - WHL7802

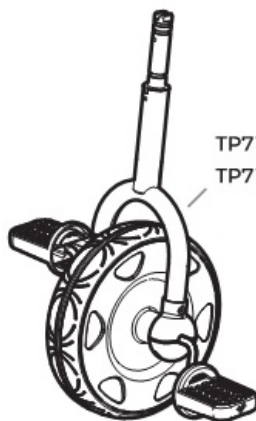

TP710 - WHF7901
TP711 - WHF7902



1

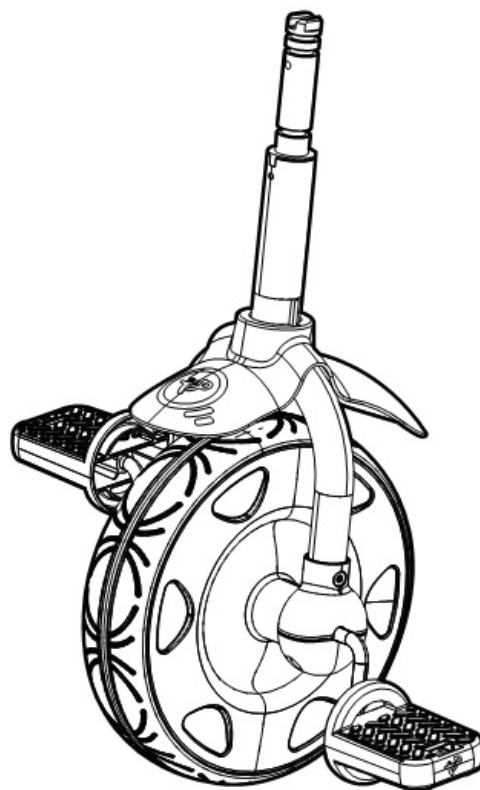
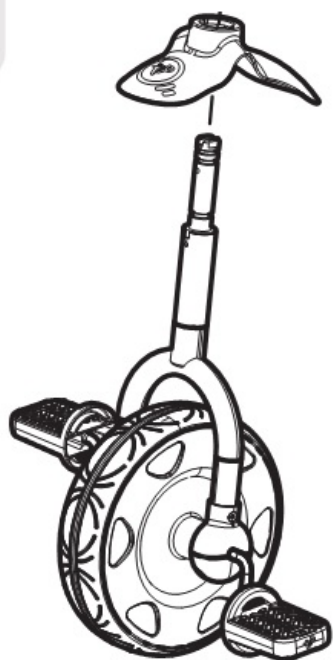

2

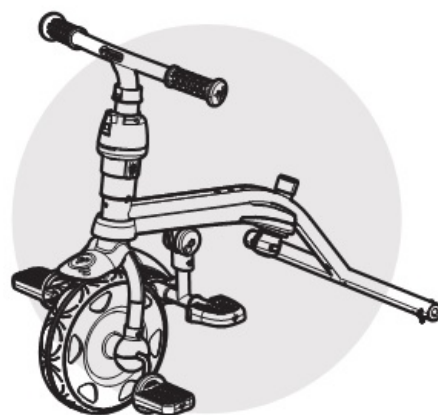
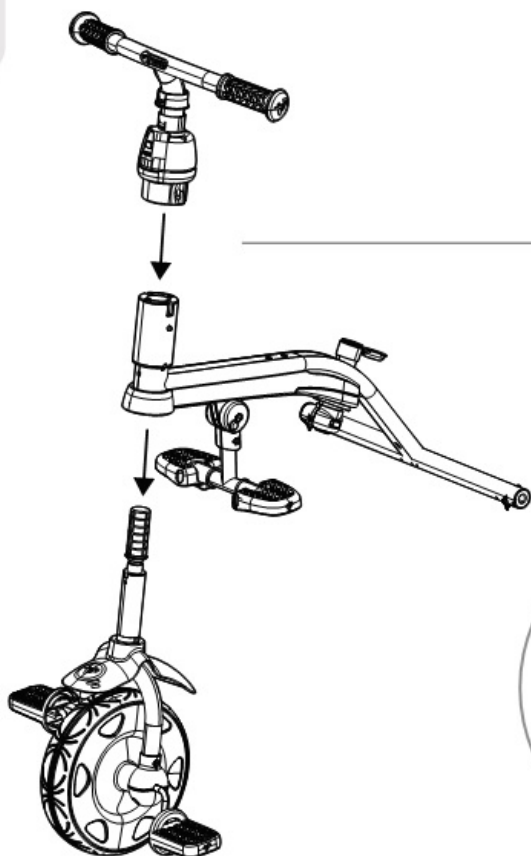

3

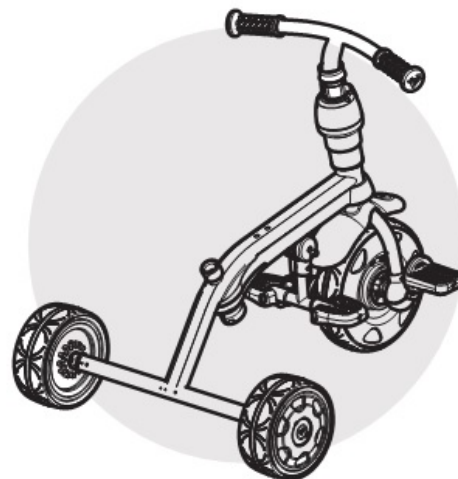
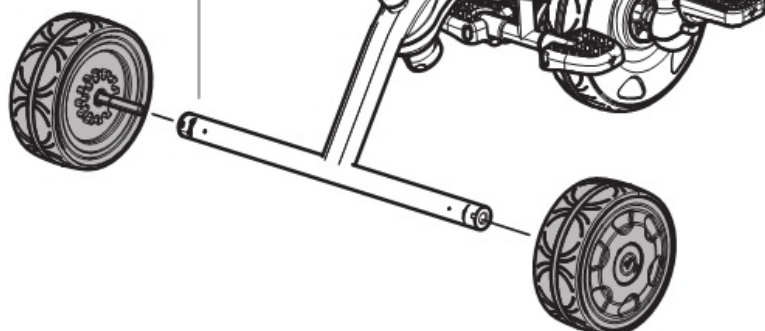

4

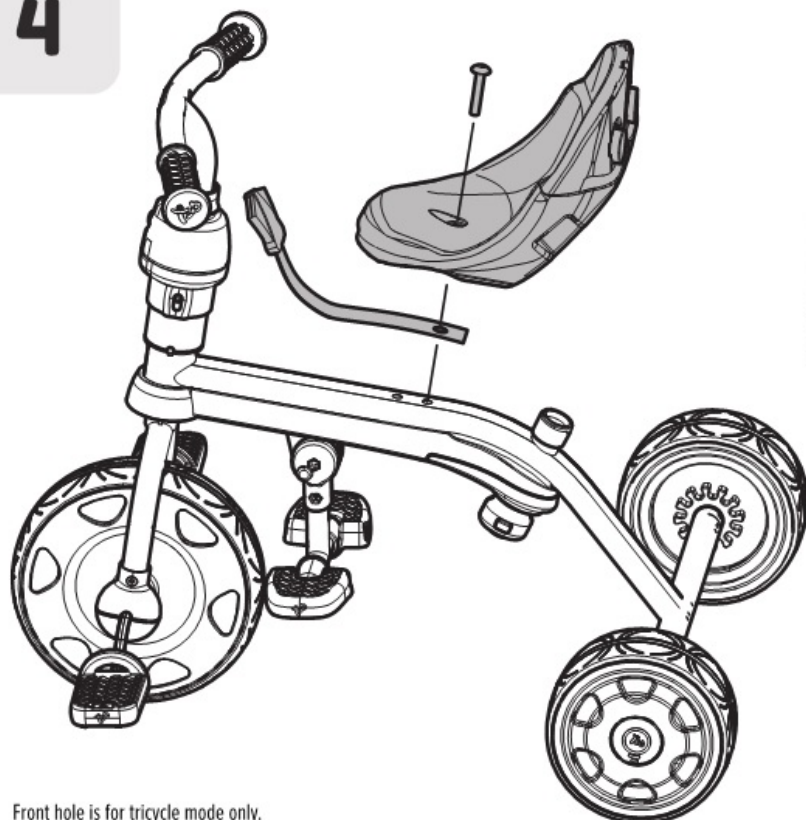

Front hole is for tricycle mode only.
See 24+ months on the inside back page.

FR L'orifice frontal est réservé au mode tricycle • DE Das vordere Loch ist nur für den Dreiradbetrieb vorgesehen • ES El orificio delantero es solo para el modo triciclo • IT Il foro anteriore è solo per la modalità triciclo • NL Het voorste gat is alleen voor driewielersmodus • PT O orificio frontal é para o modo triciclo apenas • PL Otwór z przodu jest przeznaczony tylko do trybu trójcykla • AR الثقب الأمامي مخصص للوضع ثلاثي العجلات فقط



5

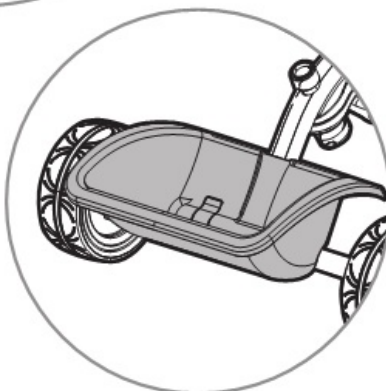
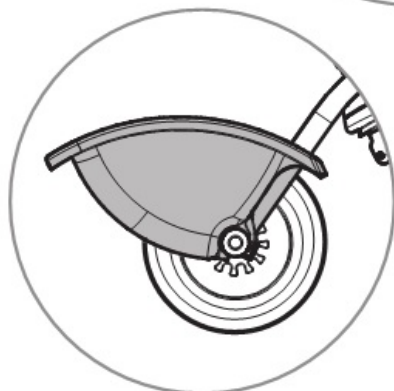
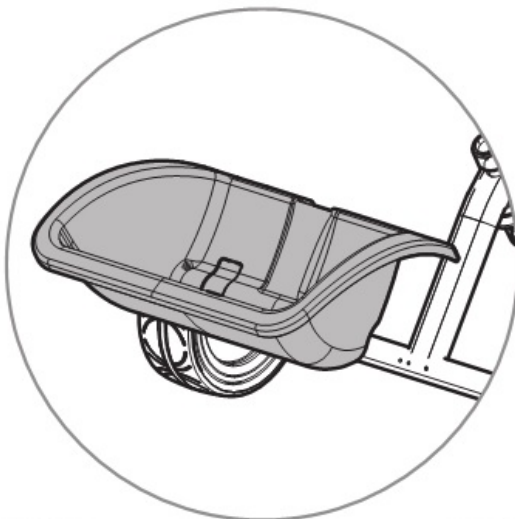

6

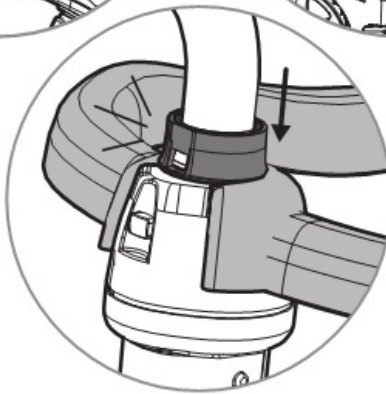
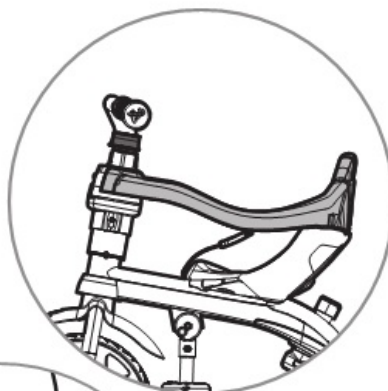

Do not push collar until
removable safety bar is
installed

7

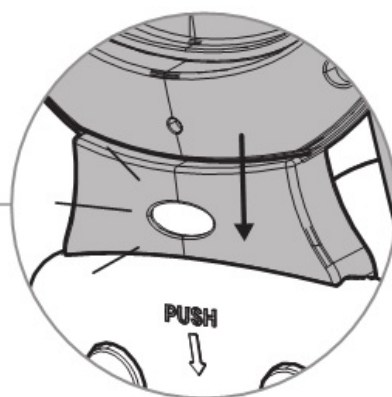
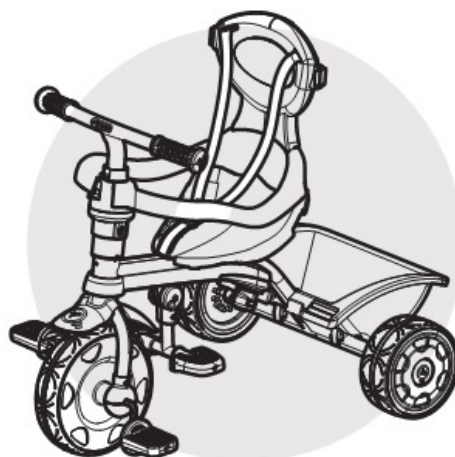
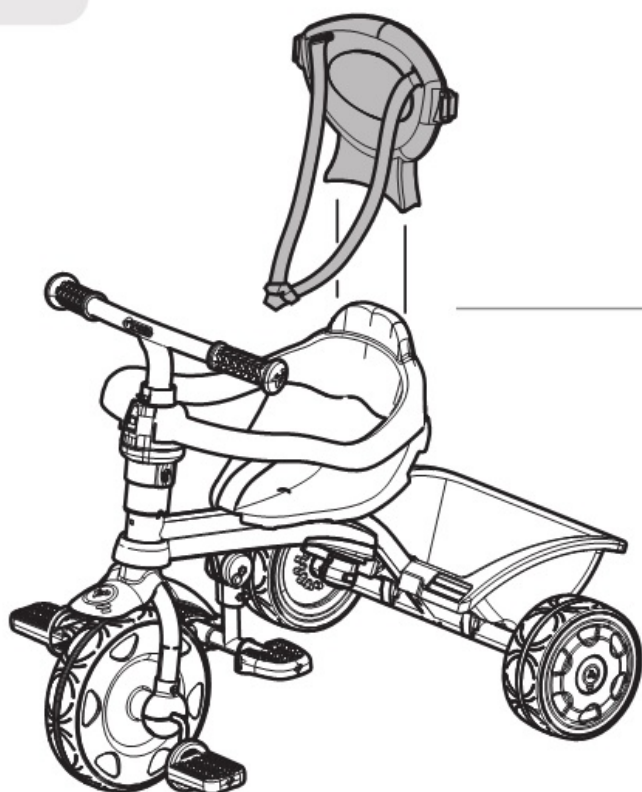

8

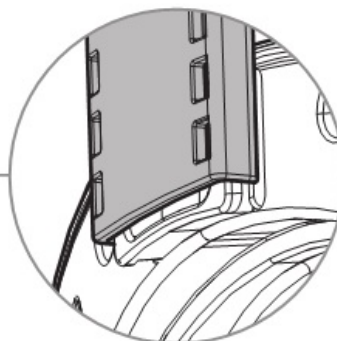
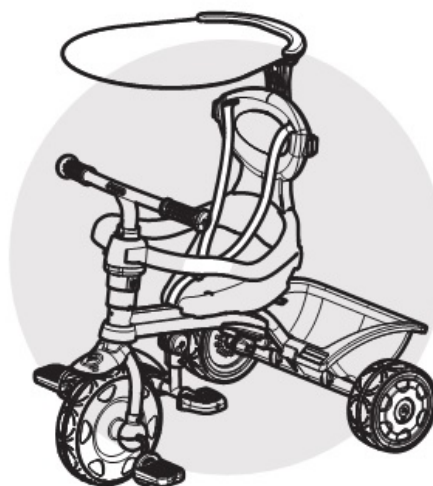
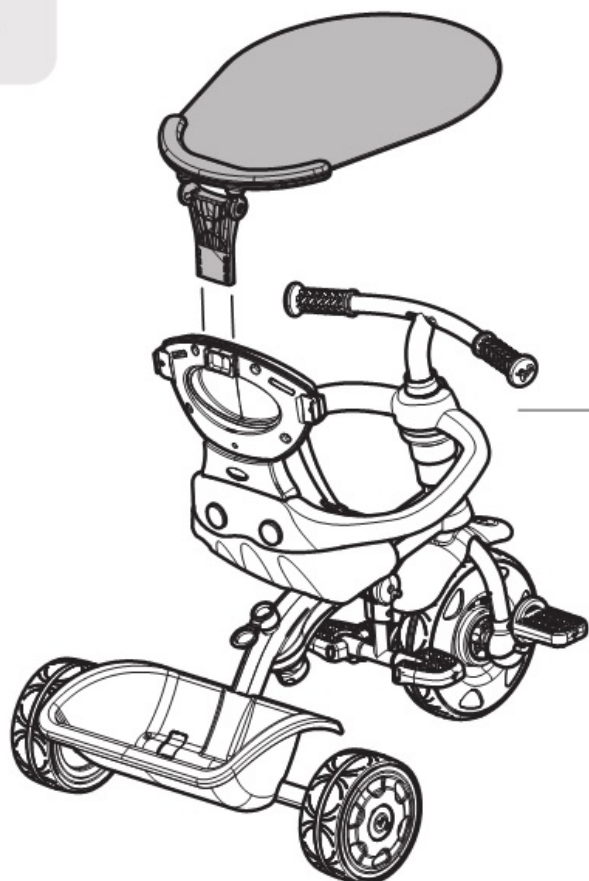

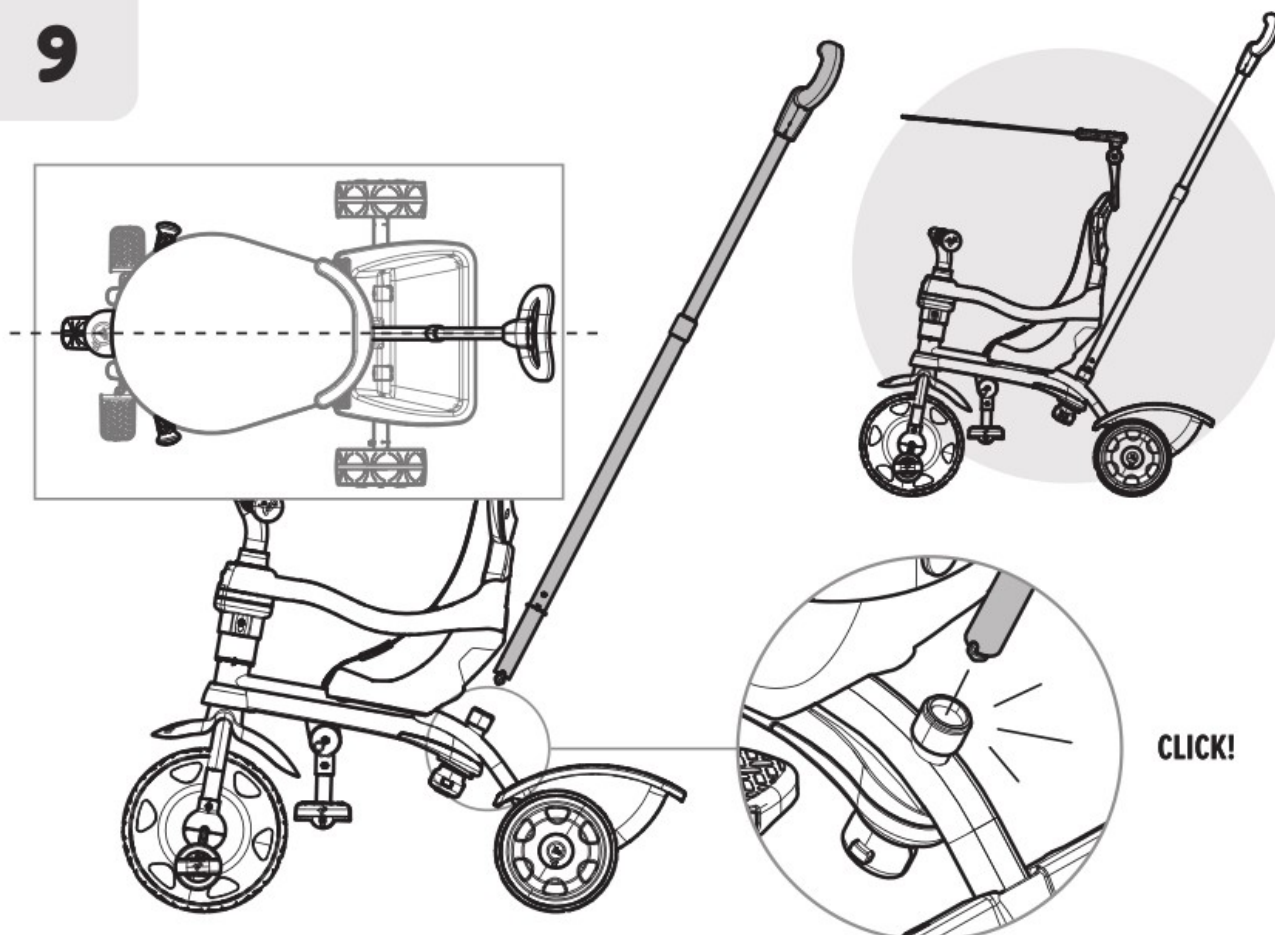

Pedal On/Off Feature

FR Fonction marche/arrêt pédale • DE Pedal ein/aus • ES Función de encendido/apagado del pedal • IT Funzione di encendido/apagado del pedal • NL Aan/uit-functie pedaal
PT Funcionalidade de Pedal Ligar/Desligar • PL Funkcja włączania/wyłączania pedałów • AR خاصية تشغيل / إيقاف البدالات

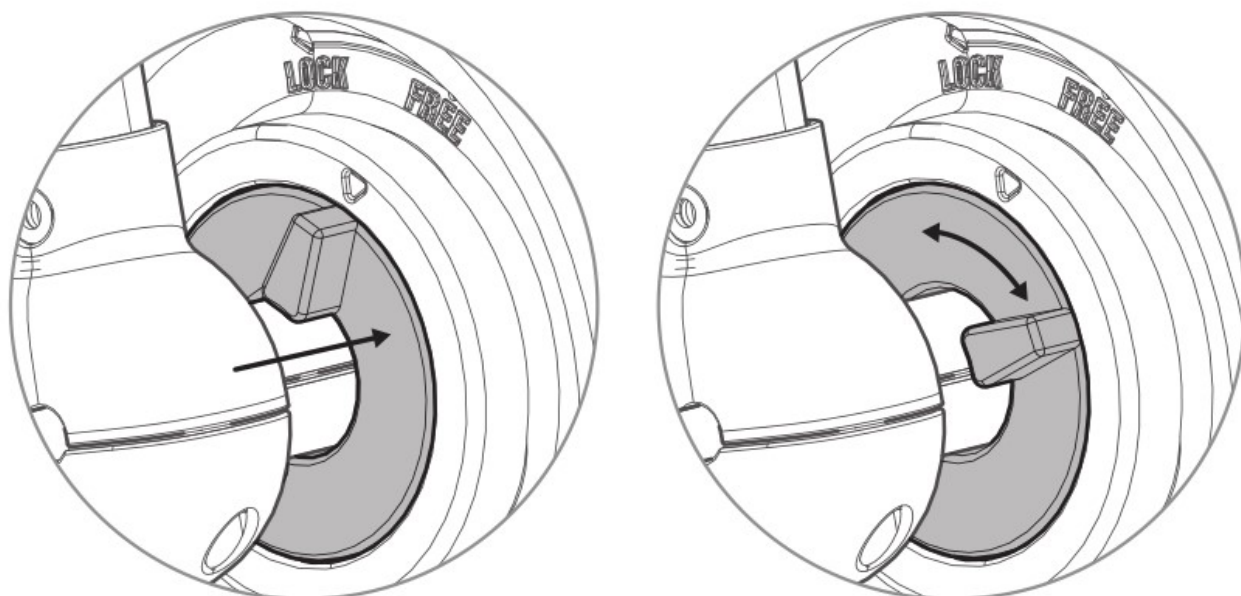

EN Apply pressure • FR Appliquer une pression • DE Druck ausüben • ES Aplicar presión • IT Applicare pressione • NL Druk uitoefenen • PT Aplique pressão •
PL Zastosuj nacisk • AR طغض لابل مق

Foot Rest Feature

FR Fonction repose-pieds • DE Fußstütze • ES Función de reposapiés • IT Funzione poggiapiedi
NL Voetensteunfunctie • PT Funcionalidade de Apoio para Pé • PL Funkcja podnózek • AR خاصية وضع القدم

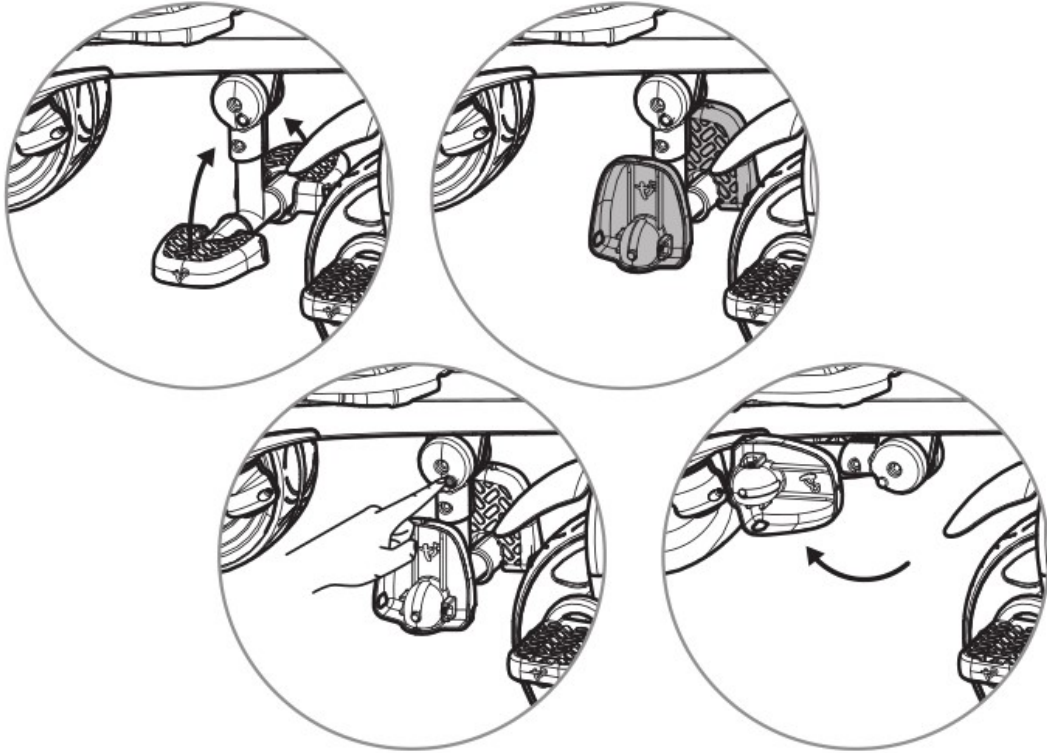

Steering On/Off Feature

FR Fonction marche/arrêt pilotage • DE Lenkung ein/aus • ES Función de encendido/apagado de la dirección • IT Funzione di attivazione/disattivazione del manubrio
NL Aan/uit-functie stuur • PT Funcionalidade de Direção Ligar/Desligar • PL Funkcja włączania/wyłączania układu kierowniczego • AR خاصية تشغيل / إيقاف مقبض القيادة

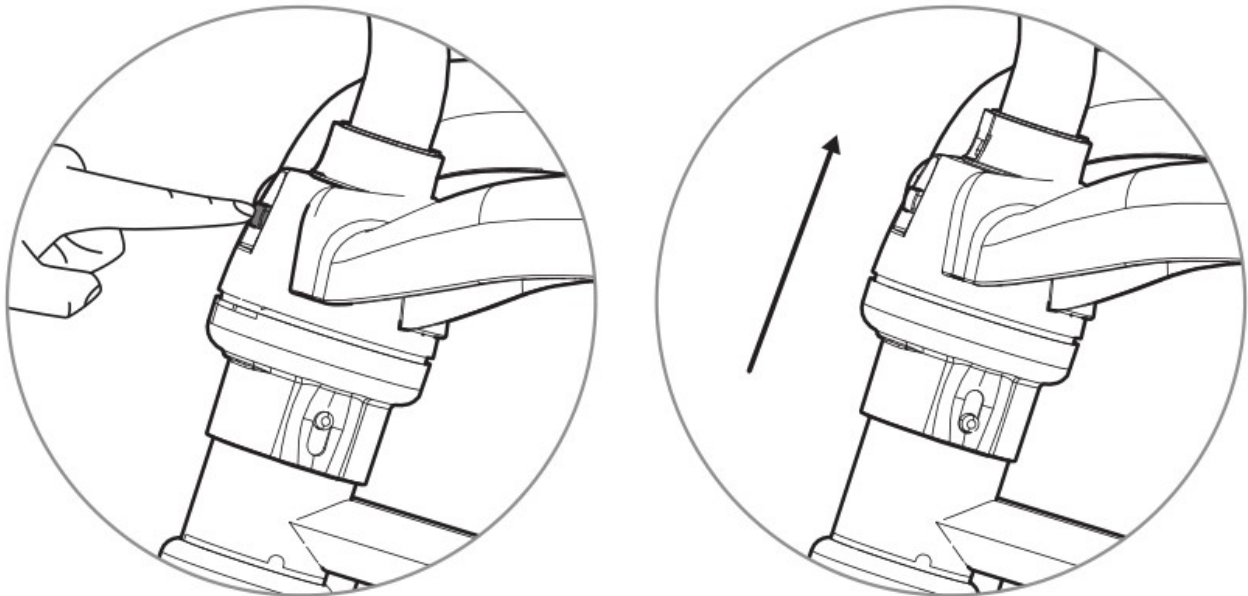

EN Apply pressure • FR Appliquer une pression • DE Druck ausüben • ES Aplicar presión • IT Applicare pressione • NL Druk uitoefenen • PT Aplique pressão •
PL Zastosuj nacisk • AR ضغط لابل مق

Safety Barrier On/Off Feature

FR Fonction marche/arrêt barrière de sécurité • DE Sicherheitssperre ein/aus • ES Función de encendido/apagado de la barrera de seguridad

IT Funzione di attivazione/disattivazione della barriera di sicurezza • NL Aan/uit-functie veiligheidsbarrière • PT Funcionalidade Barreira de Segurança Ligar/Desligar

PL Funkcja włączania/wyłączania barierki ochronnej • AR الثقب الأمامي مخصص للوضع ثلاثي العجلات فقط.

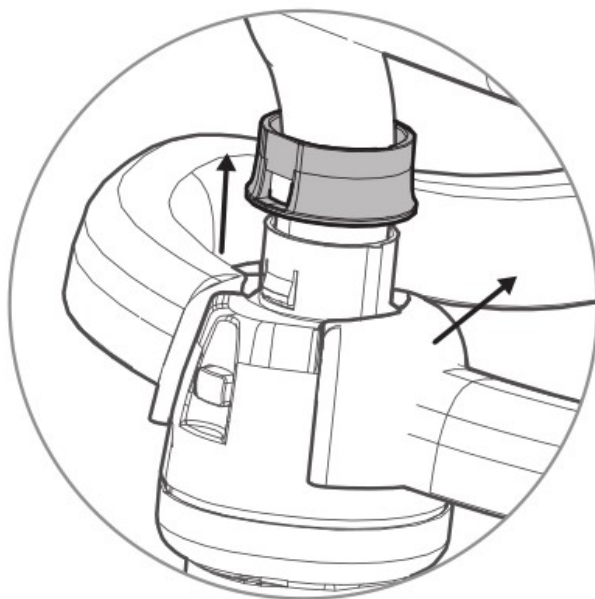
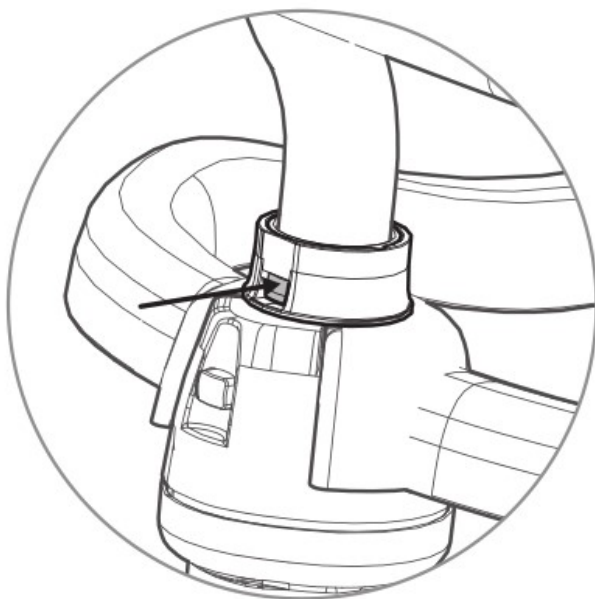

10 months+

Learn - parents can steer the trike with the steering and pedals disengaged so the child learns about the Trike while being unable to move or steer the trike.



18 months+

Steer - engage the handles so the toddler can now steer while the parent still has control using the parent push handle.



24 months+

Pedal - engage the pedals and disengage the foot rests so the toddler can now power the Trike independently.



30 months+

Ride - remove the parent handle to let the child pedal and steer on their own with parent supervision.

Ages specified are for guidance only – dependent on your child's personal development



Thank you!

Thank you for purchasing this product.

For Customer Service and help with your product please email customerservice@tp toys.com or use the contact us page www.tptoys.com/pages/contact-us

For product guarantee information visit www.tptoys.com/pages/guarantees

For spares & warranty enquiries for your product please visit www.tp spares.com or use the spares contact page www.tp spares.com/pages/contact-us

Robovision Ltd t/a TP Toys
Unit 11, Enterprise Way, Flitwick,
Bedfordshire, MK45 5BX, England, UK

UK: help@tp toys.com

EU: sav@tp toys.fr

www.tptoys.com

We reserve the right to alter the specification on this product without prior notice. The TP logo is a UK Registered trademark.

Mookie France

Espace Mistral B, 375 avenue du Mistral
13600 La Ciotat, France



Robovision Ltd t/a TP Toys protects their unique designs worldwide with patents and design registrations.

For full information on the intellectual property relating to TP products please visit www.tptoys.com/intellectualproperty

Made in China

Contents

[1 Documents /](#)







[Resources](#)

[1.1 References](#)

Documents / Resources

	<p>TRIKES TP710 Dino Discovery, TP711 Unicorn Magic [pdf] Instruction Manual TP710 Dino Discovery, TP711 Unicorn Magic, TP710, Dino Discovery, TP711, Unicorn Magic</p>
---	---

References

-  [Trampoline | Climbing Frames | Outdoor Toys | TP Toys](#)
-  [TP Spares](#)
-  [Contact Us – TP Spares](#)
-  [Trampoline | Climbing Frames | Outdoor Toys | TP Toys](#)
-  [Contact Us – TP Toys](#)
-  [Guarantees – TP Toys](#)

[Manuals+](#).