

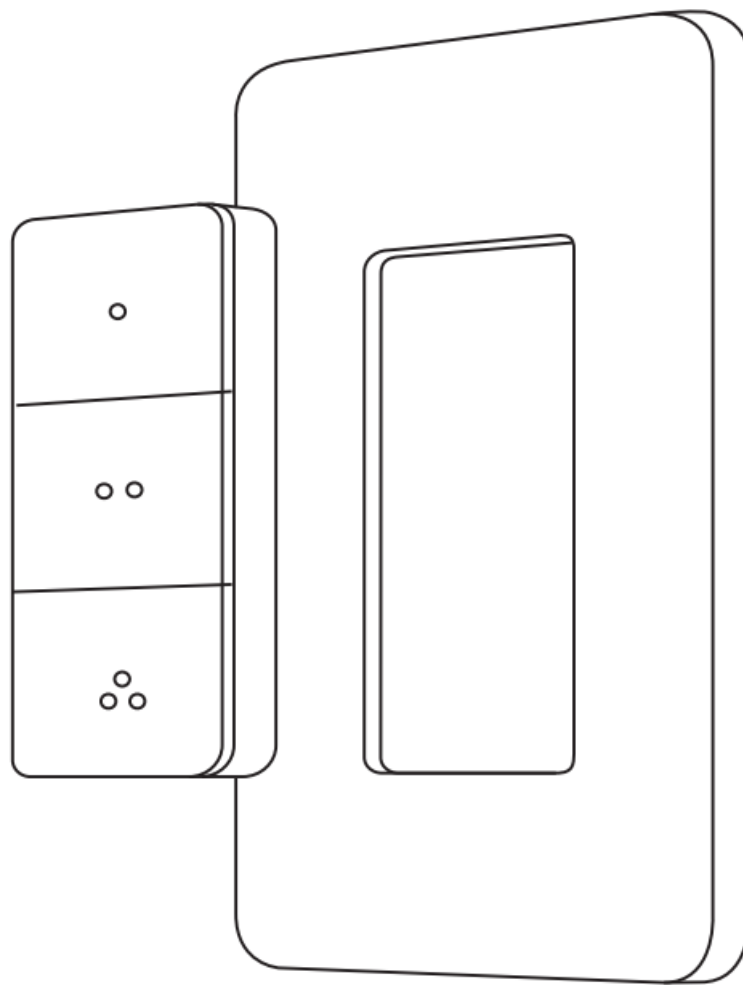

TREATLIFE Wireless Scene Switch Controller with Zigbee Hub User Manual

[Home](#) » [TREATLIFE](#) » TREATLIFE Wireless Scene Switch Controller with Zigbee Hub User Manual 





Scene Remote User Manual

Contents

- [1 Introduction](#)
- [2 What's in the box](#)
- [3 Getting started](#)
- [4 Quick setup](#)
- [5 Set up actions](#)
- [6 Example scenes](#)
- [7 Wall-mounting](#)
- [8 Changing the battery](#)
- [9 Troubleshooting](#)
- [10 Documents / Resources](#)
 - [10.1 References](#)

Introduction

Treatlife Scene Remote connects to the Treatlife App and allows you to control a group of lights across your home or trigger specific preset scenes, just press the button to light the way, even if you forget your phone. It can be mounted almost anywhere, or it can be used as a handheld remote.

What's in the box

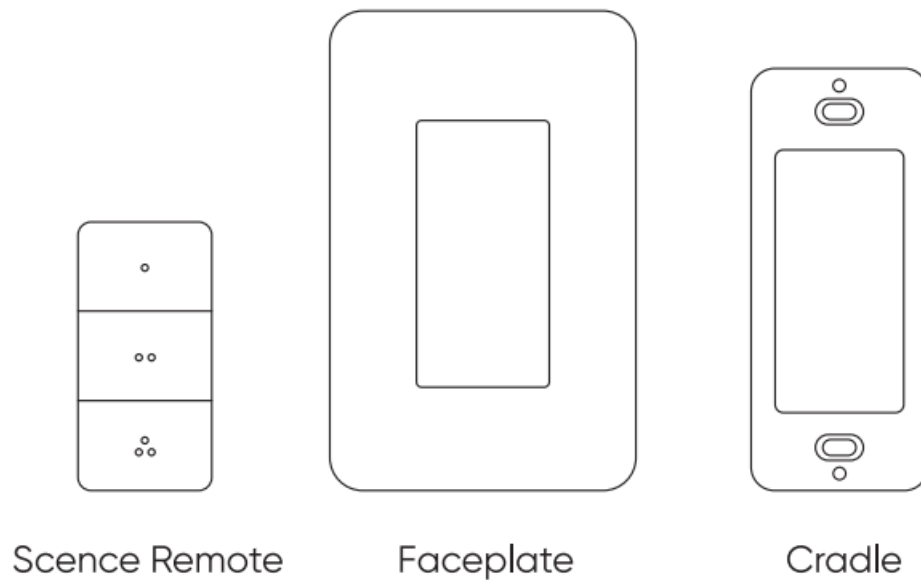

Accessories included:
adhesive tape, CR2032 battery, screw, setup guide.

Getting started

To get started make sure that you have:

1. AniOS or Android device
2. Good wifi signal
3. The Treatlife App, available on the App Store or Google Play
4. ATreatlife Smart Hub (Sold Separately)

Quick setup

11 Scan the QR code below or search Treatlife in the App Store or Google Play to download the App, and register an account according to the instruction on the Treatlife App.



<https://smartapp.tuya.com/oittm>

1.2 Connect the Smart Hub to the Treatlife App according to the quick guide for the hub.



1.3 Click "Add device" button on the top right, click the "Switch" on the left and select the "Scene Remote" and follow the setup guide to get it paired,

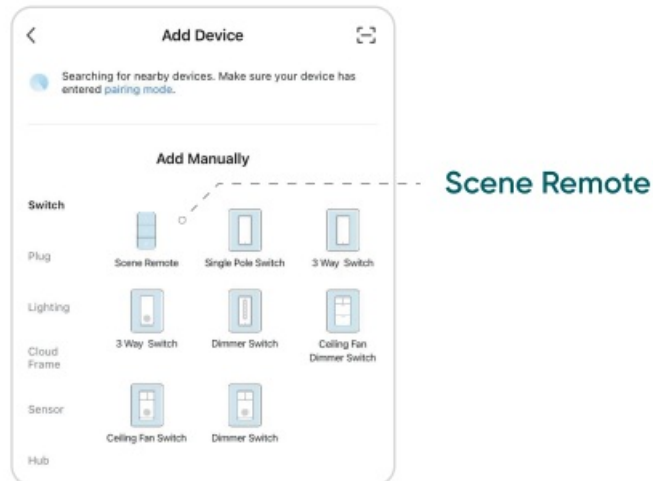

Set up actions

You can set up to 9 actions on the Treatlife Smart Scene Remote, 3 for each button (single press, double press and long press).

Open the Scene Remote page, click "Add", select one action you prefer, then assign a scene or device

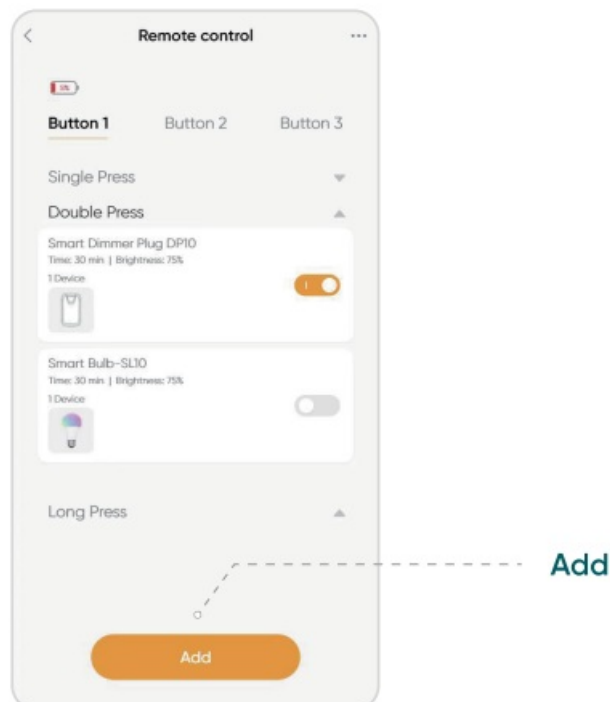

Example scenes



Bedtime:

Place the Scene Remote on your bedside table.
Before sleeping, press to turn off all your home lights,



Entertainment:

Place the Scene Remote on your coffee table.
When ready to party, press to dim the lights



Guest room on/off:

Give guests control of smart lights, from multiple locations:

Create Multi-way Control to Your Lights

Add the handheld remote to Treat the single pole or 3-way switch to control the lights from multiple locations.

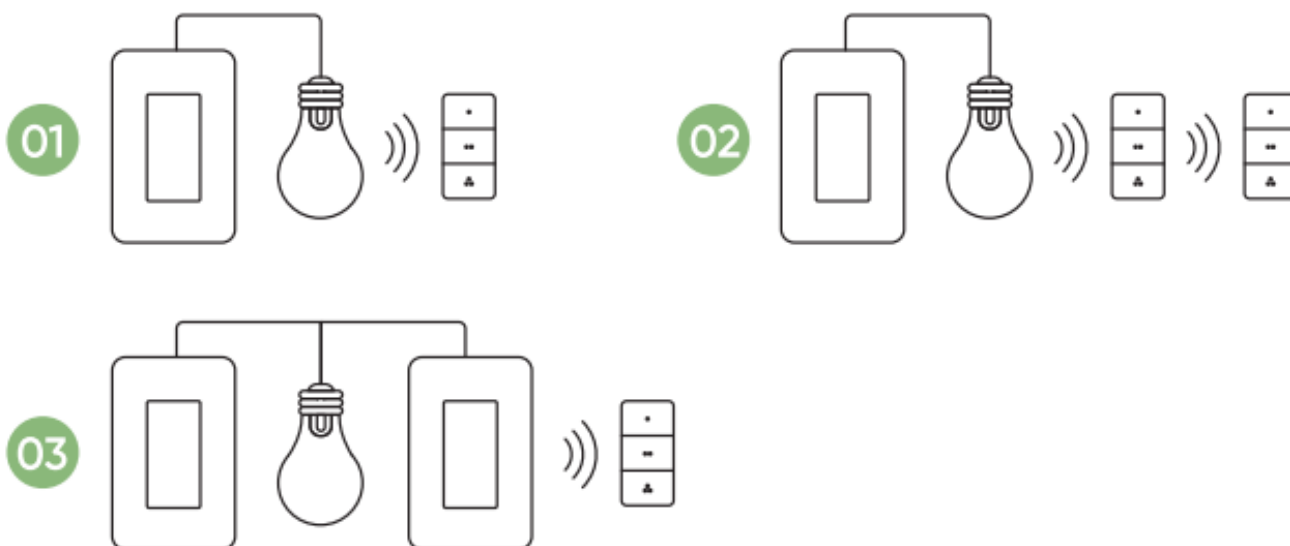

Wall-mounting

01

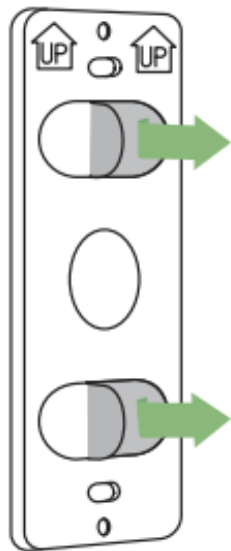

02

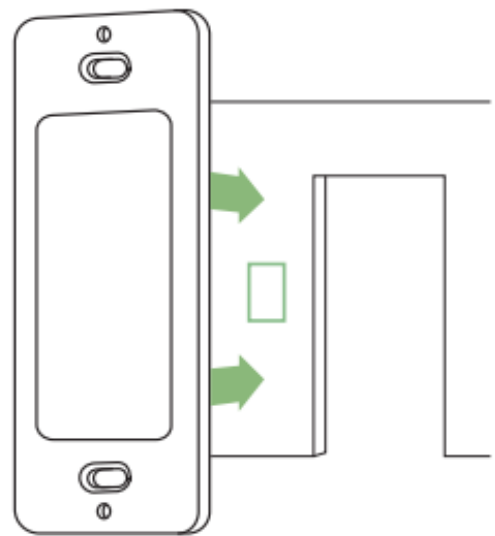

Thoroughly clean wall surface. Remove the paper from the adhesive strips on the back of the cradle

Attach the cradle to the wall

03

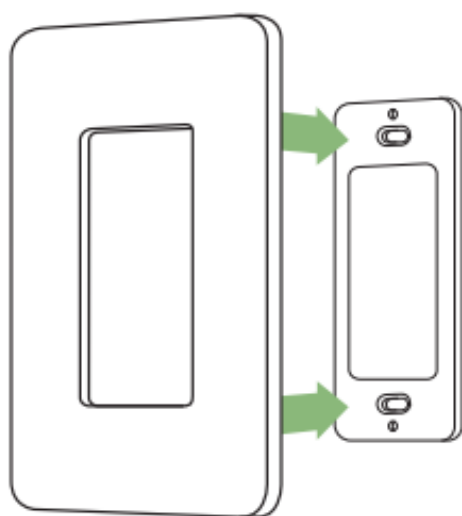

04

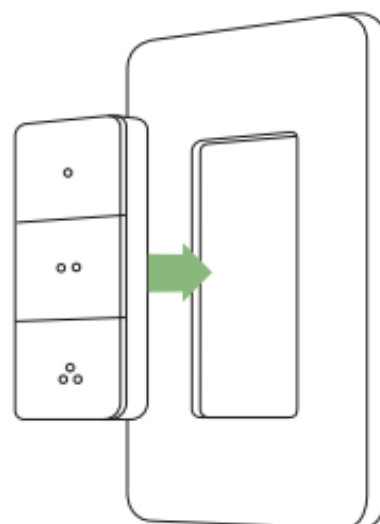

Snap the faceplate onto the mounted cradle.

A magnet in the controller holds it to the wall mount

Changing the battery

To change the battery you need to follow these steps:

Twisting the battery cover on the left to open. Remove the old battery and replace it with a new CR2032 battery with the '+' side up.

Place back the cover and twist to the right until it clicks.

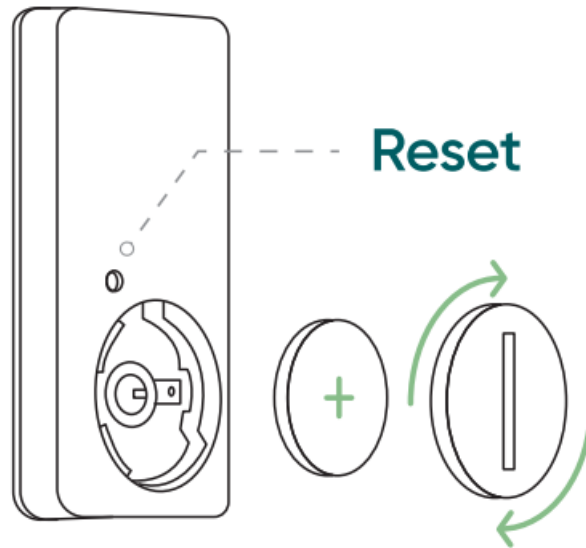

Note: consider that the adhesive is super strong before you stick it to any surface. Removing the adhesive might cause damage to the surface attached.

Troubleshooting

Restart

Have setup or control issues? Remove and re-insert the battery to restart,

Restore factory settings

If the restart doesn't help, restore factory settings.

1. Press and hold Restore button for seconds
2. Wait until the indicator blinks, then release:
3. Re-add your Scene Remote to the Treatife App. and re-assign scenes to buttons

FCC Caution

This device complies with part 15 of the FCC Rules.

Operation is subject to the following two conditions

1) This device may not cause harmful interference, and (2) this device must accept any interference received, including interference that may cause undesired operation.

Any Changes or modifications not expressly approved by the party responsible for compliance could void the user's authority to operate the equipment.

Note: This equipment has been tested and found to comply with the limits for a Class B digital device, pursuant to part 15 of the FCC Rules. These limits are designed to provide reasonable protection against harmful interference in a residential installation. This equipment generates and can radiate radio frequency energy and, if not installed and used in accordance with the instructions, may cause harmful interference to radio communications. However, there is no guarantee that interference will not occur in a particular installation. If this equipment does cause harmful interference to radio or television reception, which can be determined by turning the equipment off and on, the user is encouraged to try to correct the interference by one or more of the following measures:

- Rearrange or relocate the receiving antenna,
 - Increase the separation between the equipment and receiver.
 - Connect the equipment into an outlet on a circuit different from that to which the receiver is connected.
 - Consult the dealer or an experienced radio/ TV technician for help.
- This equipment complies with FCC radiation exposure limits set forth for an uncontrolled environment. This equipment should be installed and operated with minimum distance 20cm between the radiator & your body.

ISED Warning

This device complies with Innovation, Science, and Economic Development Canada licence-exempt RSS standards. Operation is subject to the following two conditions:

- (1) this device may not cause interference, and
- (2) this device must accept any interference, including interference that may cause undesired operation of the device:

"The device's compliance with RF exposure guidelines, users can obtain Canadian information on RF exposure and compliance. The minimum distance from body to use the device is 20 cm.

Documents / Resources

	<p>TREATLIFE Wireless Scene Switch Controller with Zigbee Hub [pdf] User Manual</p> <p>Wireless Scene Switch Controller with Zigbee Hub, Wireless, Scene Switch Controller with Zigbee Hub, Controller with Zigbee Hub, Zigbee Hub</p>
---	--

References

- [User Manual](#)