



# TRAXXAS TRA6929 Slash 2WD Clipless Body Conversion Kit Instruction Manual

[Home](#) » [Traxxas](#) » TRAXXAS TRA6929 Slash 2WD Clipless Body Conversion Kit Instruction Manual 

## Contents

- [1 TRAXXAS TRA6929 Slash 2WD Clipless Body Conversion Kit](#)
- [2 Clipless Conversion Kit Installation Instructions](#)
- [3 Installation](#)
- [4 Documents / Resources](#)



## TRAXXAS TRA6929 Slash 2WD Clipless Body Conversion Kit



## Clipless Conversion Kit Installation Instructions

### Tools needed:

- Tapered body reamer (part #3433 or #3433X, sold separately)
- 2.5mm hex wrench
- 2.0mm hex wrench

### Installation

1. Remove the truck body, and then remove the front and rear body mounts from the chassis by removing the 3x10mm FCS (2) and 2.5x12mm CS (2) (Fig. A).

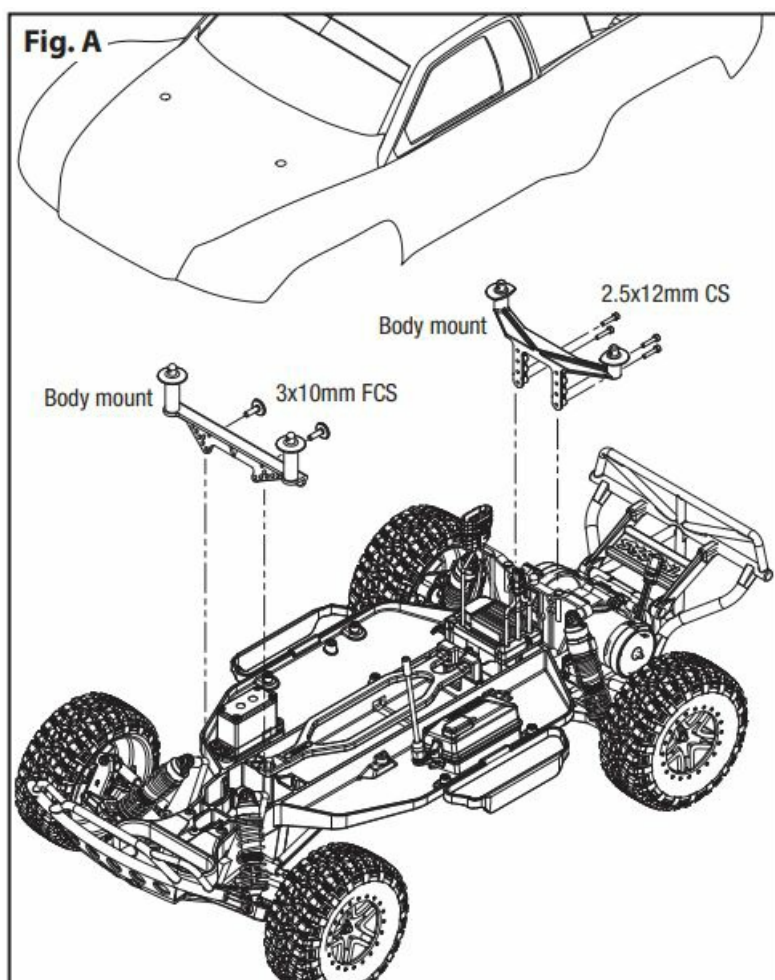

2. Peel the backing from the included self-adhesive front and rear cutting templates. Install the templates on the truck body, aligning the edges with the existing body post holes, windshield, and body lines as shown in Fig. B and C.

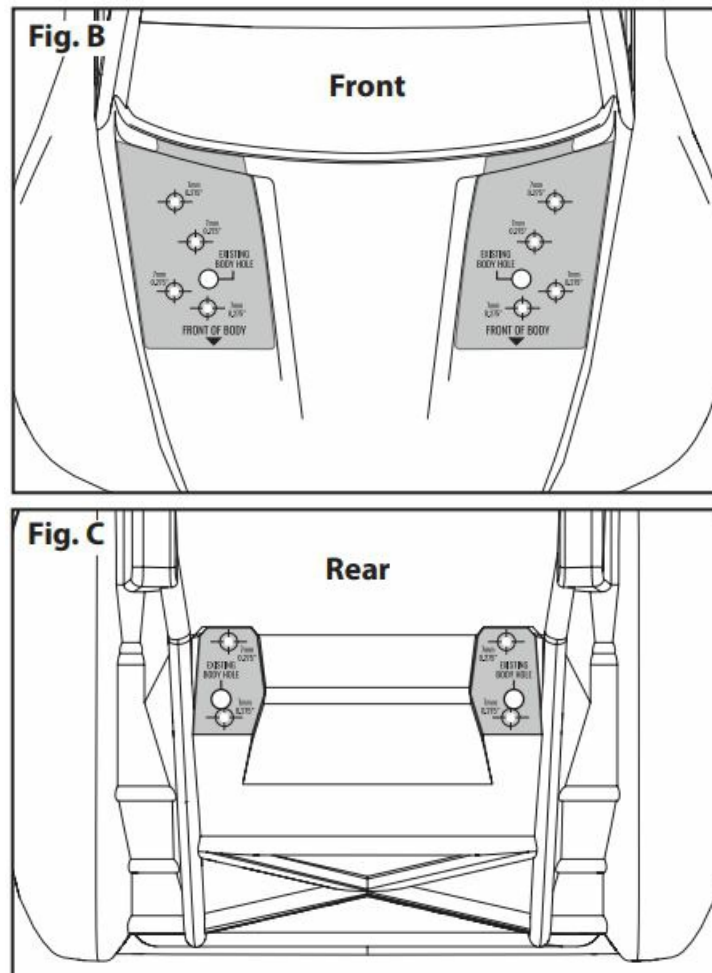

3. Using a tapered body reamer, carefully cut the holes in the truck body as shown on the templates for the screw bosses on the front and rear clipless latch mounts (note the hole diameters indicated on the templates and the corresponding diameter measurements on the body reamer).
4. Install the latch mounts on the truck body. Use the included 3x6mm CCS (4) for the two front latch mounts and 3x10mm BCS (2) and 3x8mm BCS (2) for the two rear latch mounts (Fig. D).

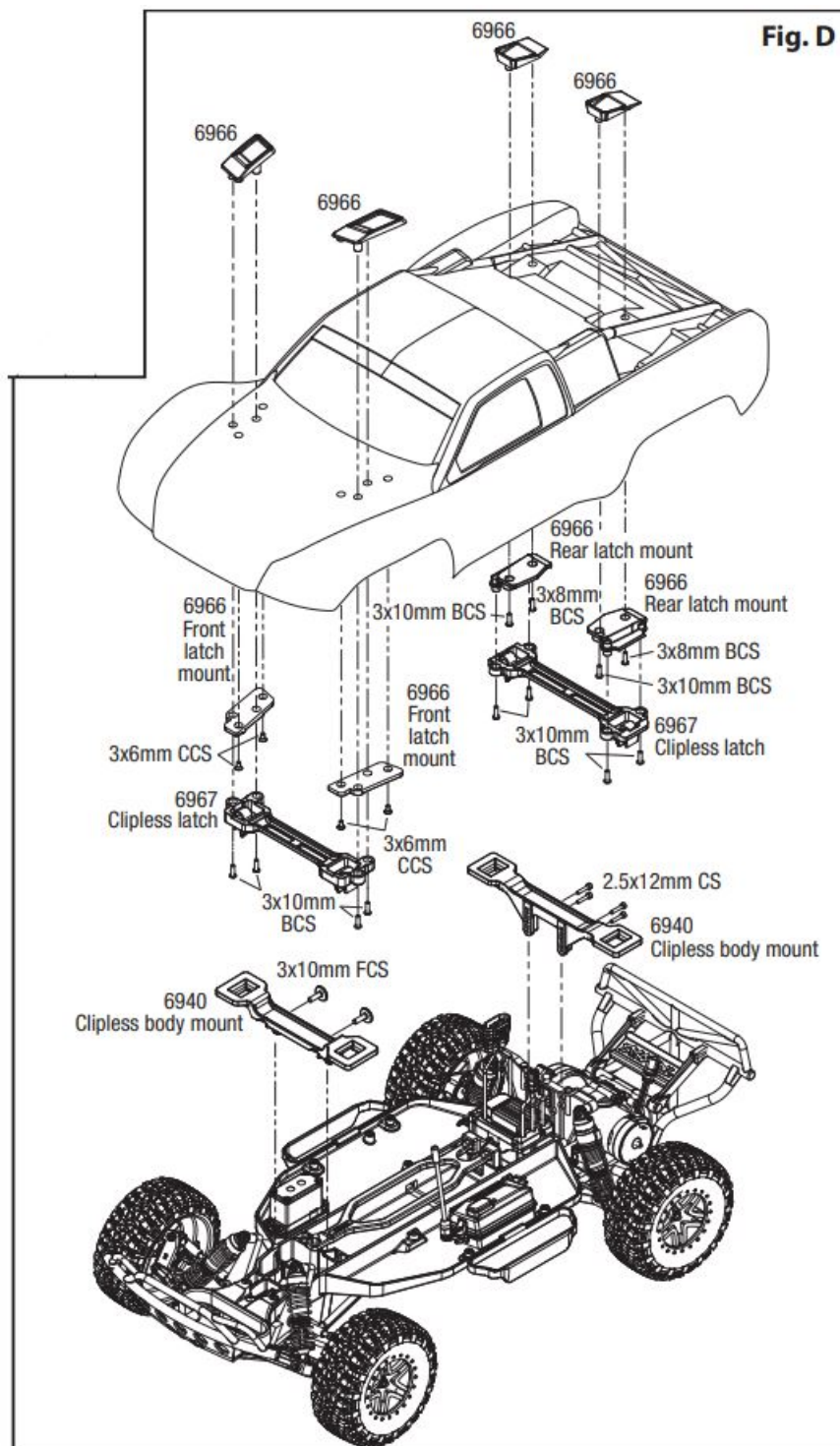

5. Install the front and rear clipless latches on the latch mounts using the included 3x10mm BCS (8) (Fig. D).
6. Install the front and rear clipless body mounts on the chassis using the included 3x10mm FCS (2) and 2.5x12mm CS (4) (Fig. D).
7. Position the body on the chassis. Align the front and rear of the body with the front and rear bumpers. Press down on the body above the latches until the latches snap into place.

### **Tapered Body Reamer Diameter Measurements**

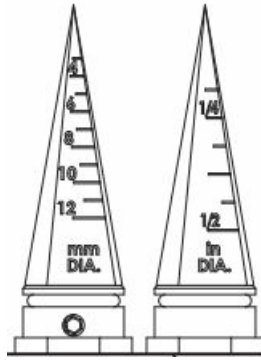

- Traxxas, 6250 Traxxas Way, McKinney, TX 75070,
- **Phone:** 972-549-3000,
- **Fax:** 972-549-3011,
- **e-mail:** [support@Traxxas.com](mailto:support@Traxxas.com)

## Documents / Resources



[TRAXXAS TRA6929 Slash 2WD Clipless Body Conversion Kit](#) [pdf] Instruction Manual  
TRA6929 Slash 2WD Clipless Body Conversion Kit, TRA6929, Slash 2WD Clipless Body Conversion Kit, 2WD Clipless Body Conversion Kit, Clipless Body Conversion Kit, Body Conversion Kit, Conversion Kit