

TRAXOR
TRAXOR
18542469
Workshop
Crane



TRAXOR 18542469 Workshop Crane Instruction Manual

[Home](#) » [TRAXOR](#) » TRAXOR 18542469 Workshop Crane Instruction Manual 

Contents

- 1 [TRAXOR 18542469 Workshop Crane](#)
- 2 [About these instructions and symbol descriptions](#)
- 3 [Safety and accident prevention rules](#)
- 4 [Performance specifications](#)
- 5 [Operation of the workshop crane](#)
- 6 [Maintenance and repair](#)
- 7 [Storage and transport](#)
- 8 [Disposal](#)
- 9 [Fault rectification](#)
- 10 [EC declaration of conformity](#)
- 11 [Warranty](#)
- 12 [Addresses](#)
- 13 [Legal Notice](#)
- 14 [Assembly of the workshop crane](#)
- 15 [FAQ](#)
- 16 [Documents / Resources](#)
 - 16.1 [References](#)
- 17 [Related Posts](#)

TRAXOR

TRAXOR 18542469 Workshop Crane



About these instructions and symbol descriptions

The information in these Operating Instructions is labelled as follows:



- DANGER Warning of personal injury or environmental damage.



- IMPORTANT Warning of property damage.



- NOTE Additional information.
- Numbers in illustrations (1, 2, 3 ...) refer to the corresponding numbers in brackets (1), (2), (3) ... in the text next to the item numbers in the tables.
- Instructions for which the order must be followed are numbered (1, 2, 3, ...).
- Lists are marked with bullet points (•, •, ...)

Safety and accident prevention rules

General safety instruction

- These operating instructions were prepared so that you can work safely with the equipment.
- People who are not familiar with these instructions should not perform these actions.
- Read these Operating Instructions thoroughly before use. Pay particular attention to the safety instructions.
- These Operating Instructions are intended for people with basic technical understanding of the use of equipment such as that described here.
- If you have no experience with such equipment, you should first get assistance from experienced persons.
- Keep all supplied documents with the equipment for future reference if required. Keep the purchase receipt for any warranty claims.
- If you lend or sell the equipment, supply all documentation with it.
- Observe the operating and maintenance instructions found in this manual.
- Children should be supervised to ensure that they do not play with the equipment.
- Mechanical maintenance should be performed at the prescribed intervals and in the prescribed scope.

- Following maintenance work, all dismantled protective devices must be properly reinstalled. The protective devices and their protective functions should be inspected by a competent person before using the machine.
- Defective equipment must be repaired promptly in order to minimize the extent of damage and avoid endangering the safety of the equipment.
- The workshop crane should only be used and operated under the conditions described in these operating instructions.
- Retrofits, changes or modifications to the equipment are strictly prohibited. They require consultation with and written approval by the manufacturer.
- If during operation (residual) hazards and risks become apparent which are not described in this manual, the operator is obliged to report this to the manufacturer.
- Never exceed the rated lifting weight of the jack.
- Use the workshop crane only on firm and level surfaces.
- Never operate or reach under a raised load if you have not taken additional precautionary measures to prevent the vehicle from rolling, slipping or tipping. The load should be well secured by safety stands when the desired lift height is reached, if work will be done on or below the raised load.
- Do not change the setting of the safety valve. Before each use check for proper functioning, especially the hydraulic oil level, and check for possible leaks.
- Under high pressure, escaping fluids (hydraulic oil) can penetrate the skin and cause serious injury! If injured contact a physician immediately! Risk of infection!
- Before working on the hydraulic system lower the equipment and de-pressurise the system!
- The workshop crane may be used only at points on the vehicle which are described as suitable in the vehicle's operating instructions.
- Keep all supplied documents with the equipment for future reference if required. Keep the purchase receipt for any warranty claims.
- If you lend or sell the equipment, supply all documentation with it.
- Observe the operating and maintenance instructions found in this manual.
- Children should be supervised to ensure that they do not play with the equipment.

Precautionary measures



- Always wear protective gloves when performing setup, maintenance and cleaning work on the equipment, to prevent injury from sharp parts.
- While working with and on the equipment wear protective work shoes that fit well.



- Before each use always perform a visual and function check of the equipment to identify damage and worn parts, and arrange for their repair by trained personnel before use.
- Before raising a load, make sure that the drain valve is closed.
- Ensure that the workshop crane is always on a solid and stable base before the load is lifted.
- Never work under a raised load supported only by the workshop crane.
- Lubricate all moving parts on the workshop crane regularly.
- If oil level is too low it should be replenished and the system bled before further use. Observe the instructions in this manual!
- The workshop crane may only be operated by persons 16 years or older. As an exception, use by a teenager is

permitted, when used in the course of training to attain skill under the supervision of an instructor.

Performance specifications

Intended use

The workshop crane is intended only for lifting vehicles, engines, transmissions and the like. Other loads, animals or humans must never be lifted or transported with the workshop crane. Components may be moved using the workshop crane only by swinging them out of their assembly position. Immediately after lifting or swinging a load, the load must be let down and secured before any work is done on a component of it. Never overload the workshop crane beyond the load specified in the following table. The manufacturer shall not be liable for damages caused by failure to comply with generally accepted rules as well as the instructions in this manual, including insufficient maintenance.

Technical specifications

Model	18542469			
Rated load (kg)	500	1000	1500	2000
Length of swinging arm (mm)	1370	1200	1030	860
Max. Stroke (mm)	1860			
Min. Height at max. rated load (mm)	405			
Net weight (kg)	90.5			

- Ambient temperature: -20 °C to +50 °C
- Hydraulic oil viscosity: international VG 15
- To protect against overloading and resulting accidents, the equipment should be operated by only one person.

Operation of the workshop crane

Preparation before first use

After opening the packaging check that all components are complete and undamaged. If components are missing or damaged, contact your dealer immediately and use the device only after approval by the dealer. Before the first use of the workshop crane it is necessary to vent the hydraulic circuit and possibly adjust the oil level.

Check the oil level

1. Turn the return valve counter-clockwise to lower the lifter all the way down.
2. Place the workshop crane on a horizontal surface and remove the filling screw.
3. The oil level should be at the bottom edge of the filling opening.
4. After filling in oil as necessary, screw the filling screw back in.
5. Bleed any air out before using the equipment.

DANGER: Insufficient oil or bleeding can cause the workshop crane to fail and drop loads. This can result in severe injury and property damage.

Bleeding the oil circuit

1. Turn the return valve counter-clockwise to open it.

2. Pump the cylinder lever 8 times across its entire stroke travel.
3. After bleeding, turn the return valve back clockwise to close it

DANGER: Air and insufficient oil in the hydraulic circuit can lead to a sudden drop of the load, resulting in serious injury.

DANGER: When operating, observe all safety instructions in Chapter 2 of this manual. For the jack points on the vehicle always refer the operating instructions of the vehicle. Never exceed the permissible loads and never go under the lifted vehicle unless it is supported by additional stands. Failure to comply may result in serious damage and fatal injury!!!

Lifting loads

Place the workshop crane under the load to be lifted. For the correct jack points on the vehicle, please refer to the vehicle manual. The vehicle must be secured against rolling away and the surface must be level and have sufficient load-bearing strength for the load to be lifted.

1. Turn the return valve clockwise to close it.

IMPORTANT: Do not turn the adjustment screw too far.

2. Position the workshop crane under the jack point, according to the vehicle operating instructions.
3. Insert the pump lever on the cylinder and operate it in full strokes, making sure that the load is on the jack point as completely as possible.
4. Pump the load to the desired height. Always pay attention to the stability of the vehicle and the workshop crane during pumping.

DANGER: Insufficient stability and incorrect positioning of the workshop crane may cause it to overturn.

5. After reaching the desired lift height, secure the vehicle with additional axle stands before commencing work on the vehicle.

Lowering loads

Always let down the load slowly and evenly. Avoid jerky lowering. This protects the pivot points and the hydraulic unit, and extends the life of the workshop crane.

DANGER: Before releasing, check that there are no tools or people under the suspended load. They can get caught and be damaged or badly injured.

1. Slowly and evenly turn the adjustment screw counter-clockwise until the load lowers. When you turn the adjustment screw clockwise again downward movement will stop. The pump lever can be placed on the adjustment screw to make turning it easier and more finely controllable.

NOTE: The wider you open the valve, the faster the load lowers.

2. When the vehicle is fully lowered, pull the workshop crane from under it.

NOTE: If necessary, depress the lift arm (never the bearing surface) by hand to release the workshop crane.

If the lifting arm cannot be completely lowered to the lowest position, there might be air in the hydraulic circuit. Before the next lifting, the workshop crane must be bled as described in

If this does not bring improvement, consult your dealer.

Maintenance and repair

General maintenance instructions

- Maintenance and repair work may be performed only by qualified personnel.
- Use only original spare and wear parts.
- Maintenance, cleaning and repair are permissible only when the workshop crane is lowered and not under load.
- If a paint touch-up is necessary, make sure not to obscure the instruction and product signs. If necessary, replace them with original spare parts.
- Fasteners must be regularly checked for tightness, and tightened as necessary.
- DANGER: Never perform different kinds of work at the same time and with multiple people.
- DANGER: Failure to follow maintenance instructions can lead to serious accidents and malfunctioning.
- DANGER: Do not let any part of the body get between moving parts.
- WICHTIG: Failure to follow the lubrication instructions can cause damage and malfunctions.

Maintenance plan

When in use, monthly maintenance is recommended. Observe the following points:

1. Spray multi-purpose lubricating oil on the coupling rod as well as moving bearing points.
2. Examine components for deformation, loose connections, wear, damage and oil leaks.
3. Clean the surface of the workshop crane and the type and information plates.
4. Check the oil level (Chap. 4.2 and 4.3).
5. Inspect the workshop crane for corrosion, and rub on a thin film of oil using a clean, soft cloth.
6. Avoid lubricating the piston rod. If the equipment is not use, always keep it inserted all the way in.

If there are abnormal motions and sounds, and after any overloading of the workshop crane, immediately go through the maintenance plan. In unclear situations, contact the nearest customer service point.

Storage and transport

Always keep the bottle jack in a dry and freeze-free room. Always lower the bottle jack all the way and store it on a horizontal surface. Check the condition of the bottle jack before storage and perform maintenance before taking it out of use, so it is ready quickly the next time you need it.

Disposal

The separate, environmentally friendly disposal of materials encourages recycling of materials. Therefore, after expiry of the normal service life, the equipment itself and all related components, including the lubrication, packaging and wear parts, should be disposed of at a recyclables collection point. Packaging, equipment and accessories are made of recyclable materials and should be disposed of accordingly. If the unit is no longer serviceable, make sure it is unusable before disposal.

DANGER: If you do not have the necessary expertise, engage a specialist for dismantling and disposal.

INJURY HAZARD! Always observe local disposal regulations!!!

Fault rectification

Fault	Possible cause	Remedy
Full stroke not possible	1. Oil level too low 2. Workshop crane is overloaded	1. Check oil level and replenish 2. Check load and adjust if necessary
Load cannot be lifted or held	1. Return valve is not closed 2. Oil tank seal is worn or defective	1. Close return valve 2. Inform customer service
Load cannot be lowered	1. Return valve is not closed 2. Components are bent or jammed	1. Carefully open return valve 2. Inform customer service

DANGER: If you do not have the necessary expertise, engage a specialist for dismantling and disposal. **INJURY HAZARD!**

EC declaration of conformity

The manufacturer,

Wilhelm Fricke SE Zum Kreuzkamp 7 DE-27404 Heeslingen hereby declares on its sole responsibility that the workshop crane Type/series identification: 18542469 is in conformity with the provisions of

2006/42/EU Directive on machinery

The product was developed in accordance with the following standards:

- PPP 59011A:2013
- Annex I 2006/42/EG
- Technical documentation is kept by:
- Mr. Eike Viebrock
- Wilhelm Fricke SE
- Zum Kreuzkamp 7
- DE-27404 Heeslingen

The serial number and model year are shown on the type plate of the equipment.

Heeslingen, 14.06.2024

Holger Wachholtz, Executive Board

Translation of the original declaration of conformity

Warranty

The warranty terms of Wilhelm Fricke SE, as can be found in the sales documents and the current version of the Terms and Conditions, apply. In case of questions, please contact the company's customer service line.

Addresses

Sales/Customer Service /

- Tel.: +49 (4281) 712 712
- Fax: +49 (4281) 712 700

Spare parts sales:

Postal and shipping address: Wilhelm Fricke SE Zum Kreuzkamp 7 DE-27404 Heeslingen

Legal Notice

Translation of the original operating instructions for Workshop crane
Manufacturer: Wilhelm Fricke SE – DE-27404 Heeslingen
1st edition September 2024
©2024 Wilhelm Fricke SE
Reproduction in whole or in part is prohibited without the written consent of the Wilhelm Fricke SE company.
All product names mentioned in these Operating Instructions are trademarks of their respective companies.
Printed on paper made from chlorine and acid-free bleached pulp.

Assembly of the workshop crane

The assembly work below may be performed only by persons with sufficient technical training and expertise, and with correct tools in good condition. Non-observance or incorrect assembly of the components can lead to serious accidents and severe property damage.

Before assembly examine all components for damage. If any components show signs of damage, bring them to your service dealer and clarify further procedure there. Assembly of such components can cause equipment failures resulting in injury and damage.

Assembly steps 18542469

1. Attach rollers (No. 33) to the base (No. 1) with bolts, washers, spring washers and nuts, but do not tighten the nuts.
- 2.

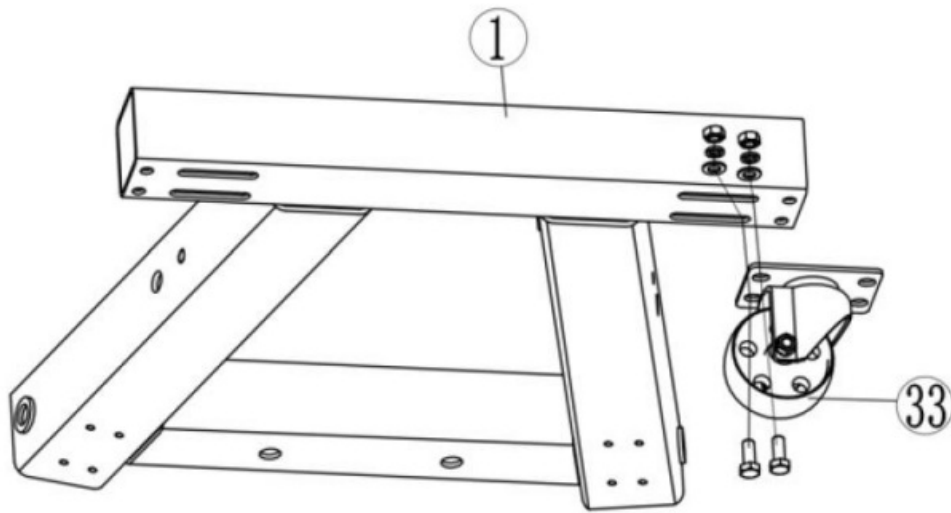

Push the rollers (No. 33) into the slots of the crosspiece (No.1).

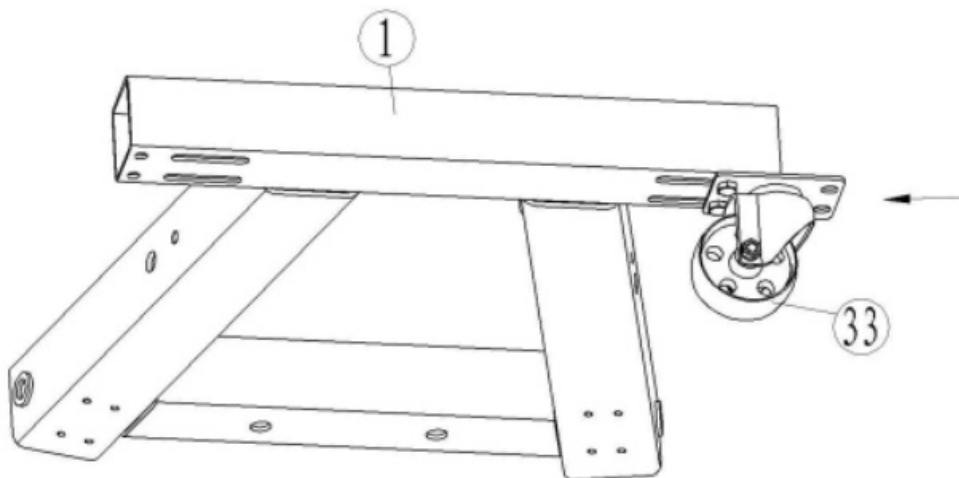

3. Push the rollers into position where the holes of the holder align with the holes on the base and then affix the rollers (No. 33) to the base with bolts, washers, spring washers and nuts, and tighten all four nuts.

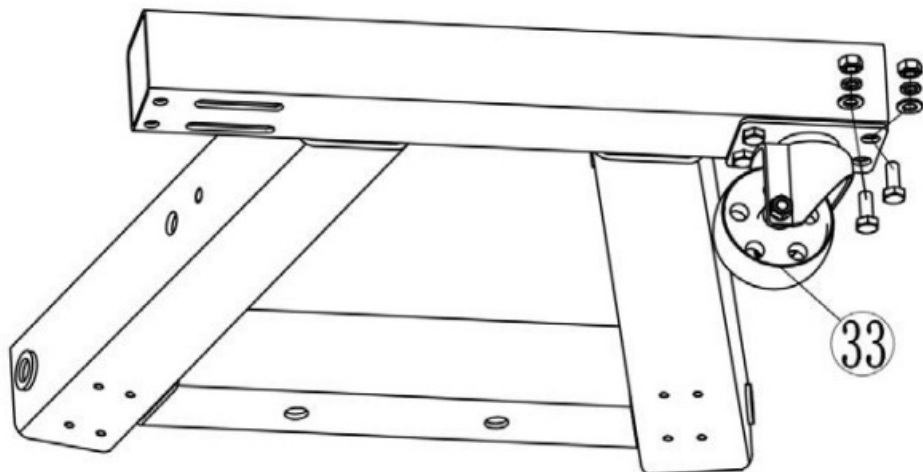

4. Attach the other rollers (No. 33) to the crosspiece (No. 1) with bolts, washers, spring washers and nuts Attach two rollers (No. 32) to the crosspiece (No. 1) with bolts (No.30) and spring washers (No.24). Tighten all nuts.

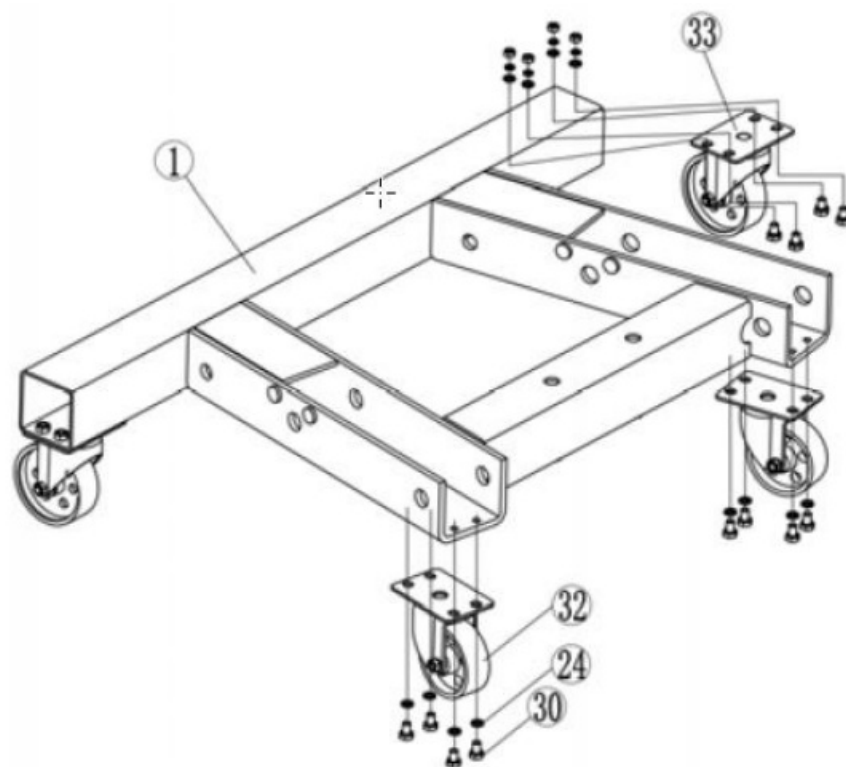

5. Affix the two wheels (No.33) to the forward support legs (No.2) with bolts, washers, spring washers and nuts, and tighten the nuts.

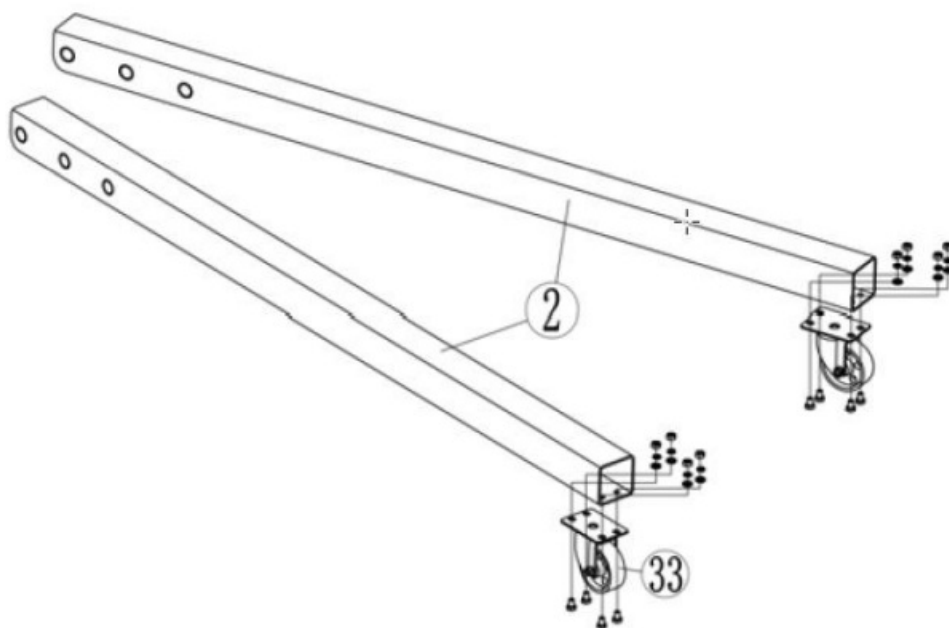

6. Slide (No. 2) before the bottom (No. 1).

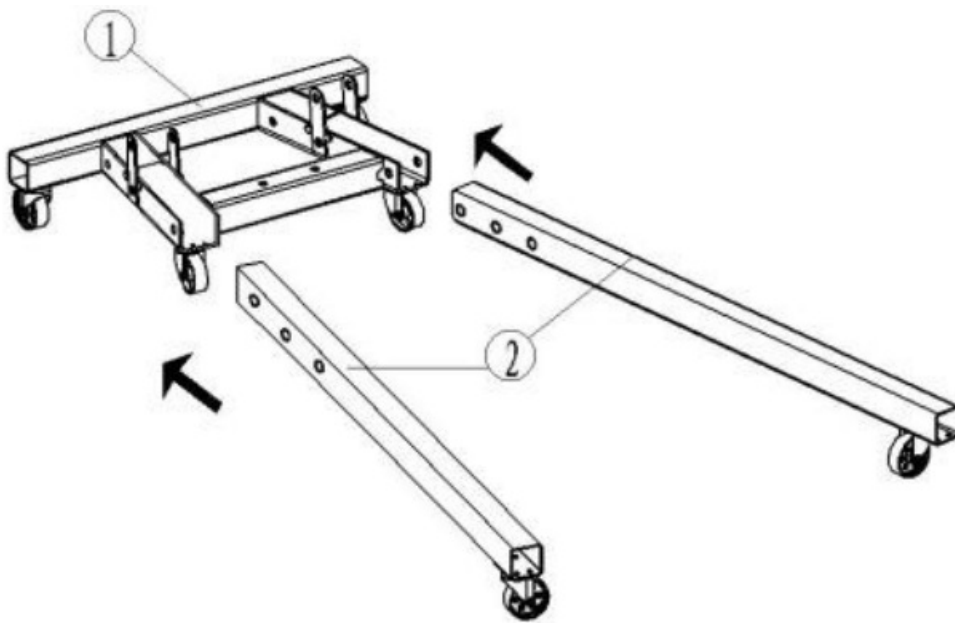

7. Affix the connection plates (No.35) to the frame base (No.1) and the forward support legs (No.2) with bolts (No.18), washers (No.22) and nuts (No.25). Secure the support legs (No.2) with eyebolts (No.28) and their cotter pins (No.36).

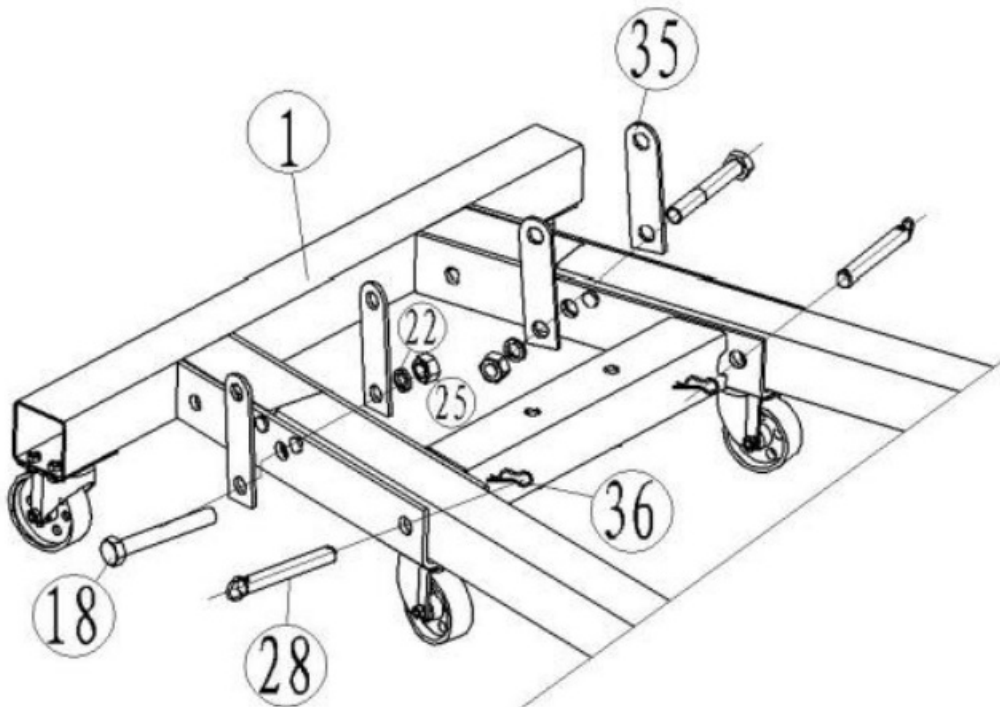

8. Use four bolts (No.29) and washers (No.24) to attach the grip (No. 34) to the spar (No. 9).

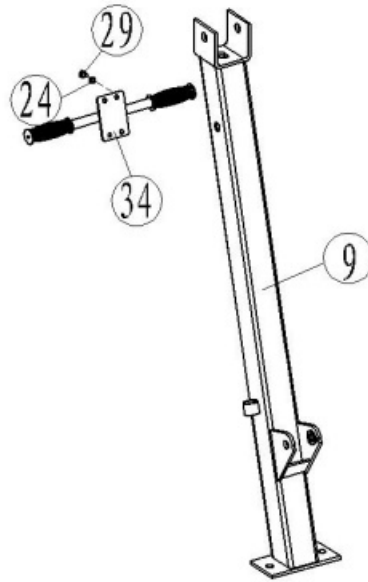

9. Use bolts (No.14), washers (No.21) and nuts (No.27) to attach the bottom of the spar (No.9) to the frame base (No.1). Do not yet tighten the nuts.

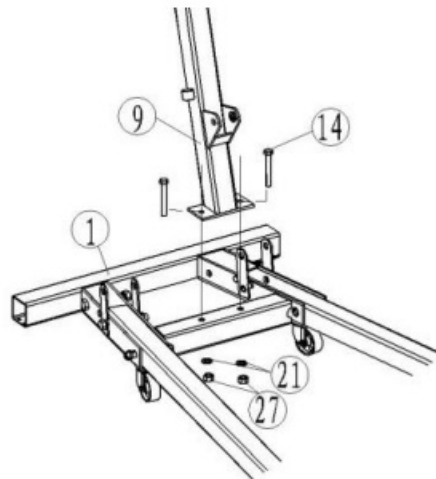

10. Using two bolts (No.17), washers (No.23) and nuts (No.26), attach the lower ends of the supports (No.5) to the frame base (No. 1). Then use bolts (No.15), washers (No.20) and nuts (No.26) to attach the upper ends of the supports to the spar (No. 9). Tighten all nuts, including those from the previous assembly steps.

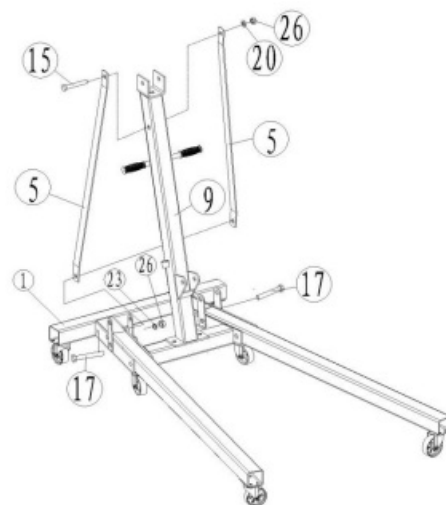

11. Using a bolt (No.10), washer (No.19) and nut (No.25), attach the boom (No. 3) to the upper side of the spar (No. 9). Tighten the nuts (No.25) but not too tight, so that the boom can still move freely.

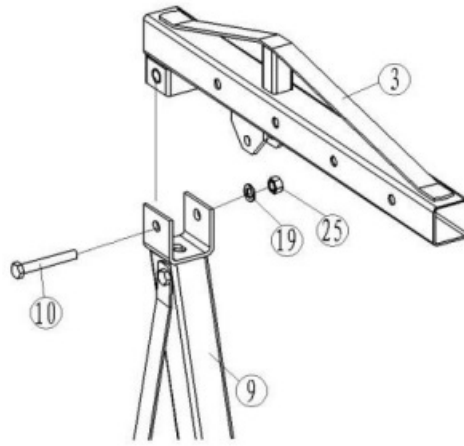

12. Using a bolt (No.12), washer (No.20) and nut (No.26), attach the upper end of the cylinder (No.6). Attach the spar (No.9) to the underside of the hydraulic cylinder with a bolt (No.13), washer (No.20) and nut (No.26).

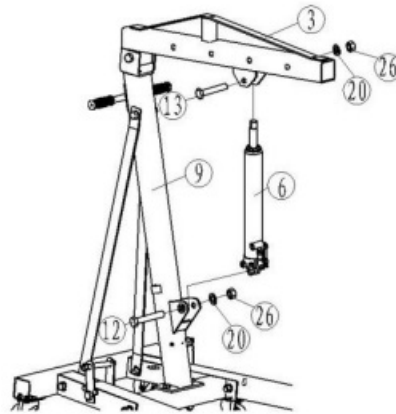

13. Push the boom extension (No.4) into the boom (No.3) and use a bolt (No.11), washer (No.20) and nut (No.26) to secure it at the desired load level. Using a bolt (No.16), washer (No.21) and nut (No.27), attach the hook and chain (No.8) to the end of the boom extension.

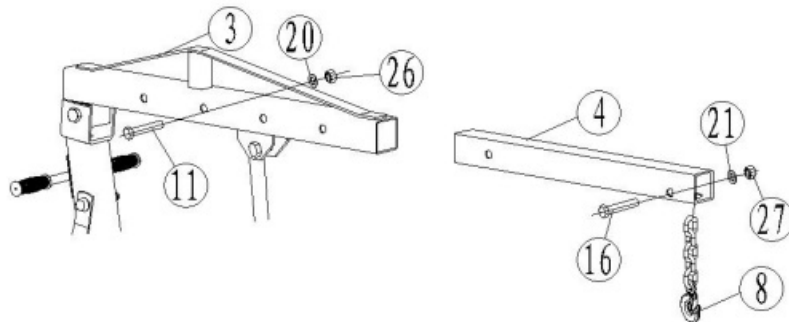

FAQ

- **Q: Can I use the workshop crane for lifting heavy objects?**

A: Yes, you can use the workshop crane for lifting tasks, but ensure you do not exceed the rated lifting weight specified in the manual.

- **Q: Is it necessary to perform maintenance on the workshop crane?**

A: Yes, regular mechanical maintenance should be performed at prescribed intervals to ensure safe operation of the equipment.

- **Q: What should I do if I notice any hazards during operation?**

A: If you encounter any hazards or risks not mentioned in the manual, report them promptly to the manufacturer for further guidance and assistance.

Documents / Resources



[TRAXOR 18542469 Workshop Crane](#) [pdf] Instruction Manual
18542469, 18542469 Workshop Crane, 18542469, Workshop Crane, Crane

References

- [User Manual](#)

Manuals+. [Privacy Policy](#)

This website is an independent publication and is neither affiliated with nor endorsed by any of the trademark owners. The "Bluetooth®" word mark and logos are registered trademarks owned by Bluetooth SIG, Inc. The "Wi-Fi®" word mark and logos are registered trademarks owned by the Wi-Fi Alliance. Any use of these marks on this website does not imply any affiliation with or endorsement.