

TRATAS
3729A Clipless
Body Conversion
Kit



TRATAS 3729A Clipless Body Conversion Kit Installation Guide

[Home](#) » [TRATAS](#) » TRATAS 3729A Clipless Body Conversion Kit Installation Guide 

Contents

- [1 TRATAS 3729A Clipless Body Conversion Kit](#)
- [2 Product Usage Instructions](#)
- [3 Kit contents:](#)
- [4 FAQs](#)
- [5 Documents / Resources](#)
 - [5.1 References](#)



TRATAS 3729A Clipless Body Conversion Kit



Specifications

- Part Number: 3734R
- Transmission Model: Magnum 272R

Product Usage Instructions

Installation Process

1. Remove Existing Components:

- Remove upper chassis by unscrewing 3x12mm screws (2) and 4x15mm screws (2).
- Remove front body mount by unscrewing 3x10mm screws (2).
- Remove 3x23mm screws (2) from the transmission housing.

2. Install New Components:

- Attach rear body mount support bracket to the transmission housing.
- Install body mount spacer onto the upper chassis using the included 3x8mm BCS (4).
- Secure the front body mount to the spacer and upper chassis using the included 3x10mm BCS (2).
- Secure the rear body mount on the rear shock tower using the included 2.5x10mm BCS (4).
- Secure the rear body mount to the support bracket using the included 3x10mm BCS (2).

3. Final Steps:

- Install self-adhesive cutting templates on the vehicle body and cut holes as indicated for latch mounts.
- Install clipless latch mounts on the body using the included 3x10mm screws (4).
- Install wing and rear clipless latch using 4x8mm CCS (3).

Rustler Clipless Body Conversion Kit Installation

Kit contents:

Covers Part #3734R

- Body mounts (front & rear)
- Front body mount spacer
- Support bracket (for Magnum 272R™ transmission)
- Support bracket (for 272 transmission)
- Upper chassis
- Front clipless latch
- Front latch mounts (left & right)
- Rear clipless latch
- 3x23mm button-head cap screws (BCS) (2)
- 3x10mm button-head cap screws (BCS) (6)
- 3x8mm button-head cap screws (BCS) (4)
- 2.5x10mm button-head cap screws (BCS) (4)

Tools required:

- Tapered body reamer (part #3433 or #3433X)
- 2.5mm hex wrench
- 2.0mm hex wrench

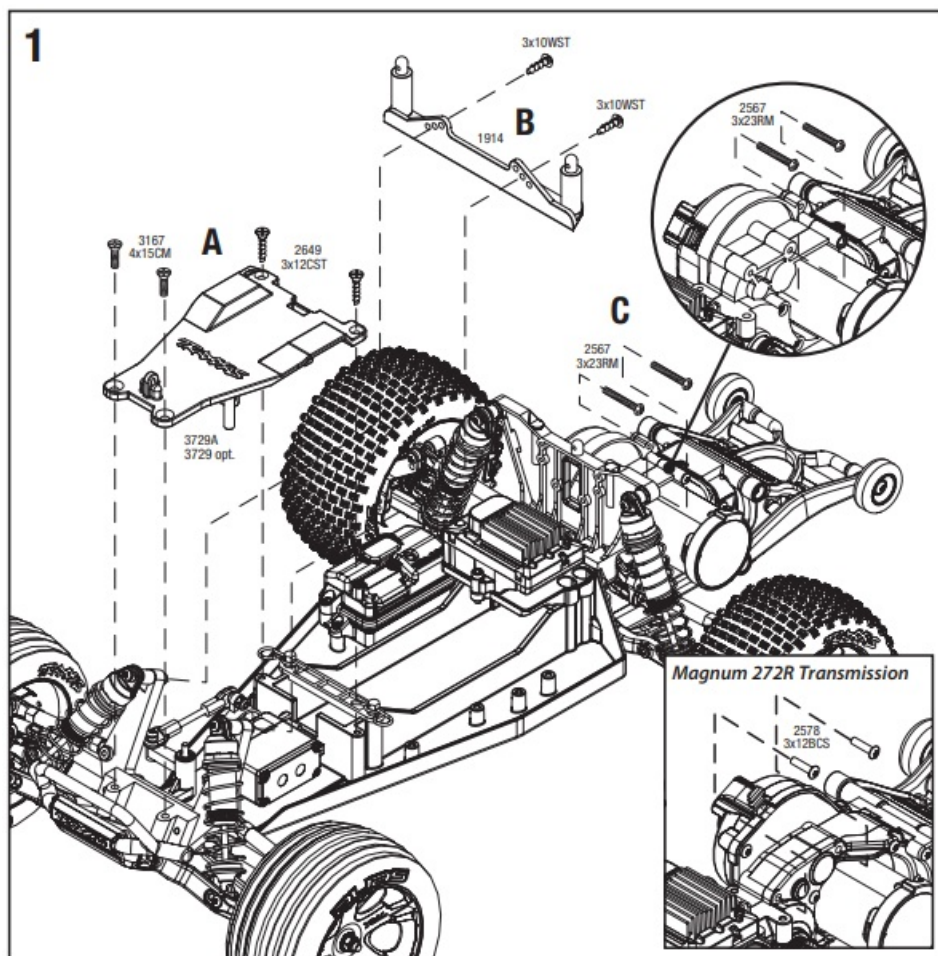

- 1A. Remove the existing upper chassis by removing the 3x12mm screws (2) and 4x15mm screws (2).
- 1B. Remove the existing front body mount from the shock towers by removing the 3x10mm screws (2).
- 1C. Remove the existing 3x23mm screws (2) from the transmission housing.

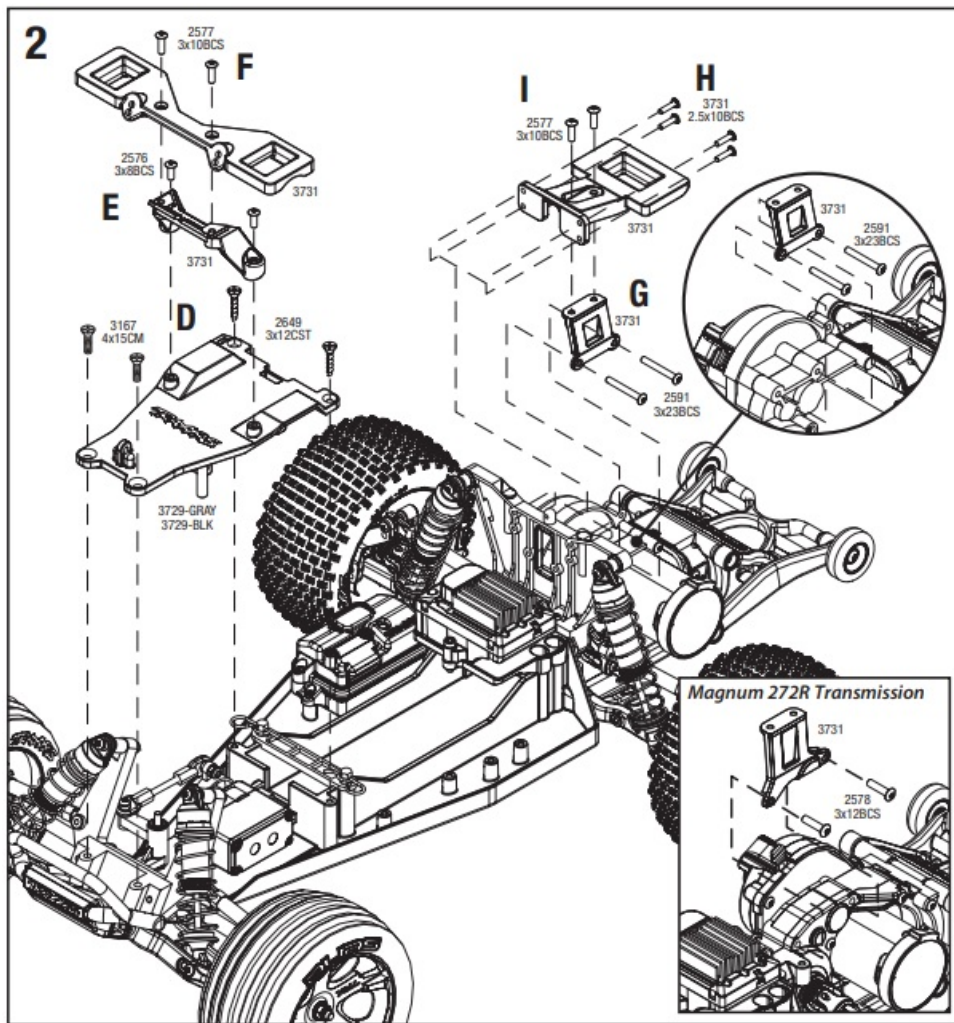

- 2D. Install the new upper chassis with the screws removed in step 1A.
- 2E. Install the included body mount spacer onto the upper chassis using the included 3x8mm BCS (4).
- 2F. Secure the front body mount to the spacer and upper chassis using the included 3x10mm BCS (2).
- 2G. Attach the rear body mount support bracket to the transmission housing using the included 3x23mm BCS (2).
- 2H. Install the rear body mount on the rear shock tower using the included 2.5x10mm BCS (4).
- 2I. Secure the rear body mount to the support bracket using the included 3x10mm BCS (2).

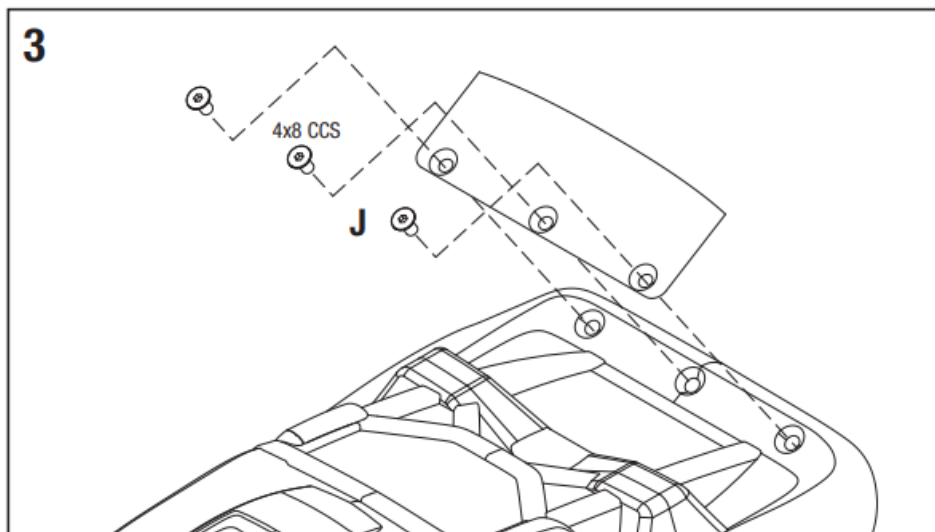

- 3J. Remove the 4x8mm CCS and plastic nuts (3) to remove the wing from the body.

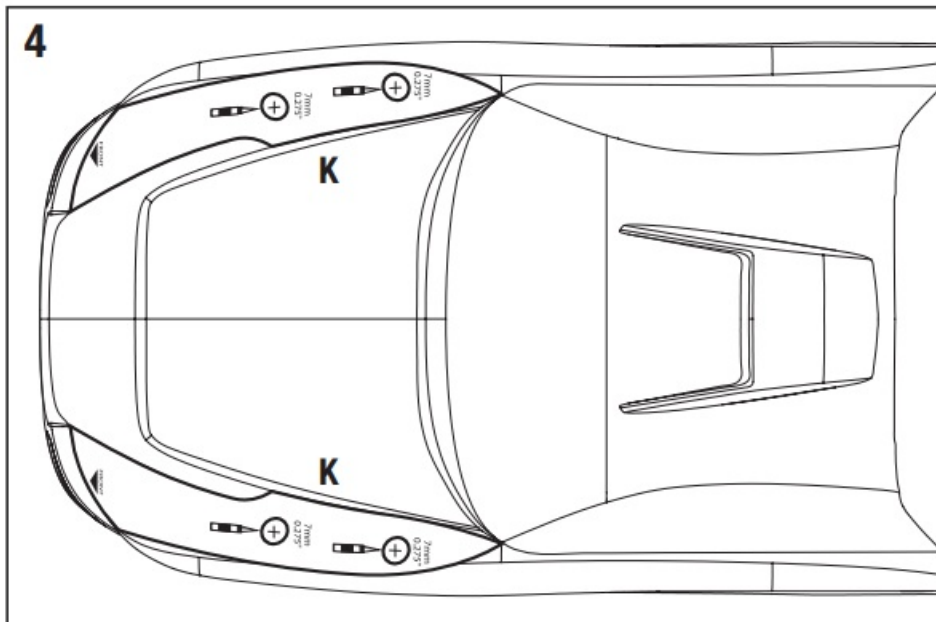

- 4K. Peel the backing from the included self-adhesive cutting templates. Install the templates on the vehicle body, aligning the edges with the existing body post holes and body lines. Using a tapered body reamer, carefully cut the holes in the truck body as shown on the templates for the screw bosses for the front and rear latch mounts (note the hole diameters indicated on the templates and the corresponding diameter measurements on the body reamer).

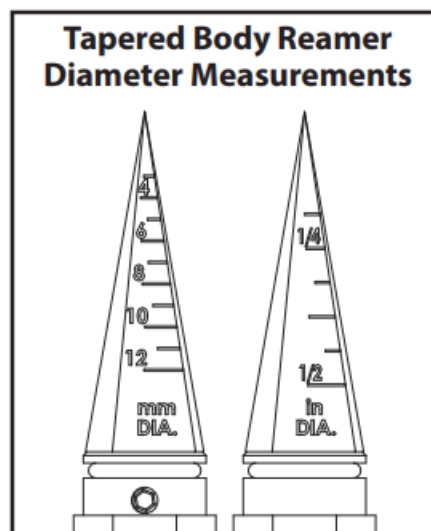

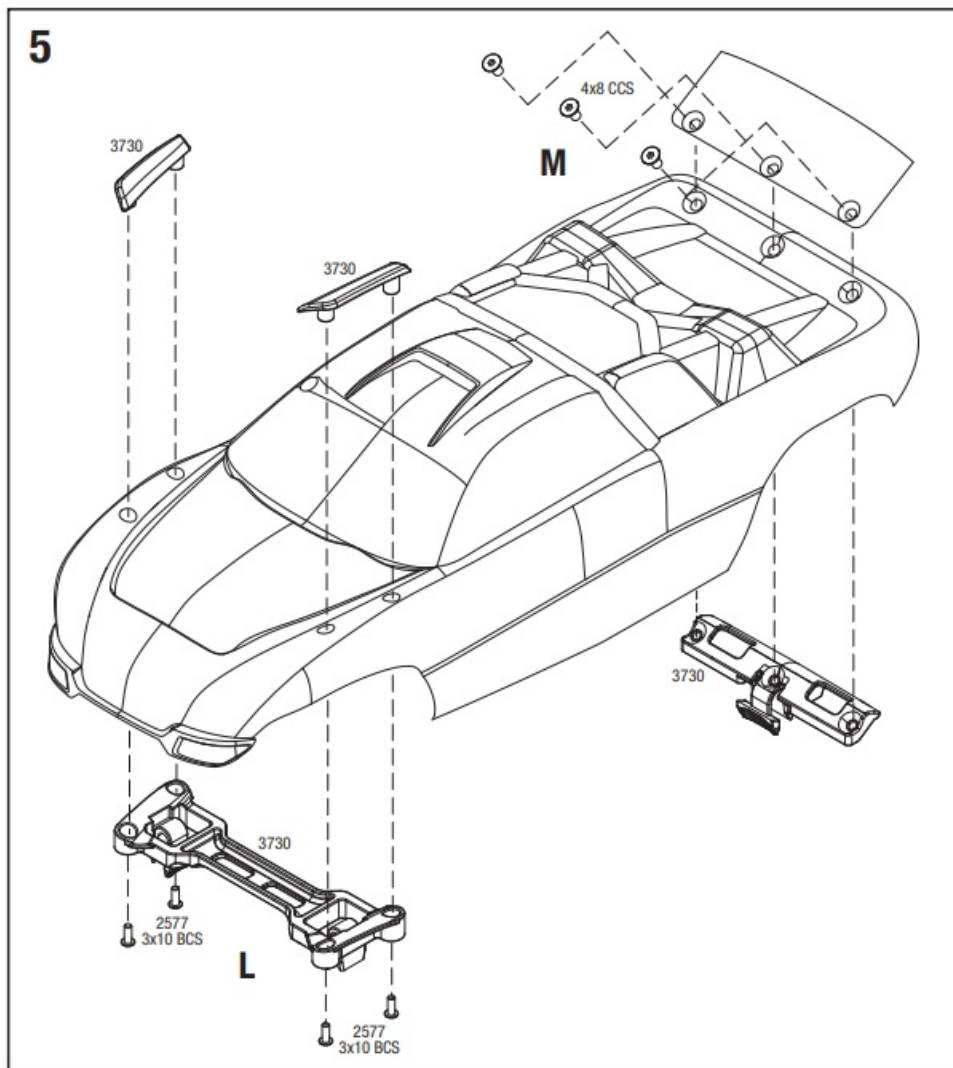

- 5L. Install the front clipless latch/latch mounts on the body. Use the included 3x10mm screws (4).
- 5M. Install the wing and the rear clipless latch on the body using the 4x8mm CCS (3) removed in step 3J.

CAUTION: RISK OF INJURY!

Use care with hobby knives, tapered reamers, and other cutting tools as they are extremely sharp and can cause severe injury, deep cuts, and/or punctures.

TRAXXAS.com

- Traxxas, 6250 Traxxas Way, McKinney, TX 75070, Phone: [972-549-3000](tel:972-549-3000), Fax: [972-549-3011](tel:972-549-3011), e-mail: support@Traxxas.com
- KC24056-R00 240829

FAQs

Q: What tools are needed for installation?

A: You will need hobby knives, tapered reamers, screwdrivers, and wrenches as specified in the manual.

Q: Is there a risk of injury during installation?

A: Yes, please exercise caution while using sharp tools like hobby knives and reamers to avoid injury.

Q: Where can I find additional support or contact Traxxas?

A: You can visit TRAXXAS.com or contact Traxxas customer support at the provided phone, fax, or email address.

Documents / Resources

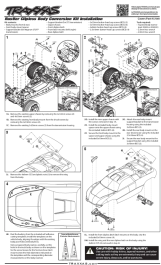

[TRATAS 3729A Clipless Body Conversion Kit](#) [pdf] Installation Guide
ZP5599_KC24056-R00-3734R, 3729A, 3729-GRAY, 3729-BLK, 3729A Clipless Body Conversion Kit, 3729A, Clipless Body Conversion Kit, Body Conversion Kit, Conversion Kit

References

- [User Manual](#)

Manuals+. [Privacy Policy](#)

This website is an independent publication and is neither affiliated with nor endorsed by any of the trademark owners. The "Bluetooth®" word mark and logos are registered trademarks owned by Bluetooth SIG, Inc. The "Wi-Fi®" word mark and logos are registered trademarks owned by the Wi-Fi Alliance. Any use of these marks on this website does not imply any affiliation with or endorsement.