

TRANSFORMERS 

**TRANSFORMERS TF-GK03
Gaming
Mechanical
Keyboard**



TRANSFORMERS TF-GK03 Gaming Mechanical Keyboard Instruction Manual

[Home](#) » [TRANSFORMERS](#) » TRANSFORMERS TF-GK03 Gaming Mechanical Keyboard Instruction Manual 

Contents

- 1 [TRANSFORMERS TF-GK03 Gaming Mechanical Keyboard](#)
- 2 [Packing list](#)
- 3 [Keyboard features](#)
- 4 [Keyboard Overview](#)
- 5 [Product parameter](#)
- 6 [Indicator Light Instructions](#)
- 7 [View Battery capacity](#)
- 8 [Mode switching](#)
- 9 [Device connection name](#)
- 10 [FCC Warning](#)
- 11 [Warranty Service](#)
- 12 [Product information](#)
- 13 [Vendor information](#)
- 14 [Documents / Resources](#)
 - 14.1 [References](#)
- 15 [Related Posts](#)



TRANSFORMERS TF-GK03 Gaming Mechanical Keyboard



Packing list

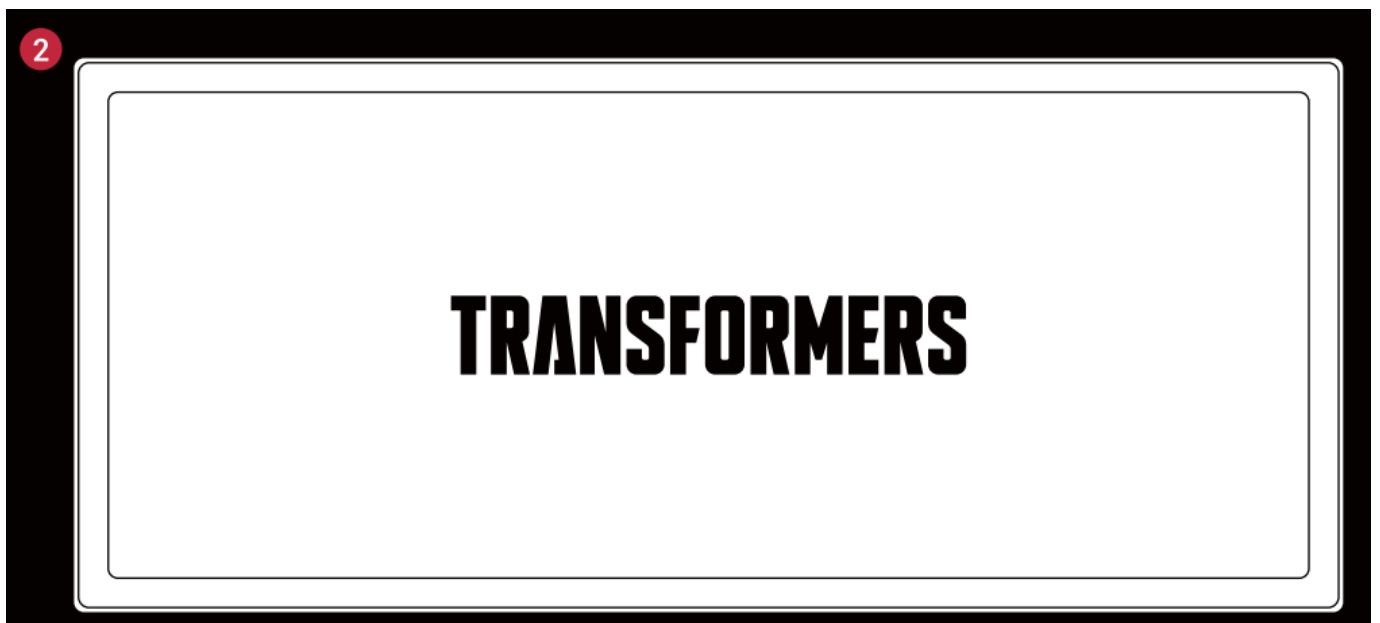

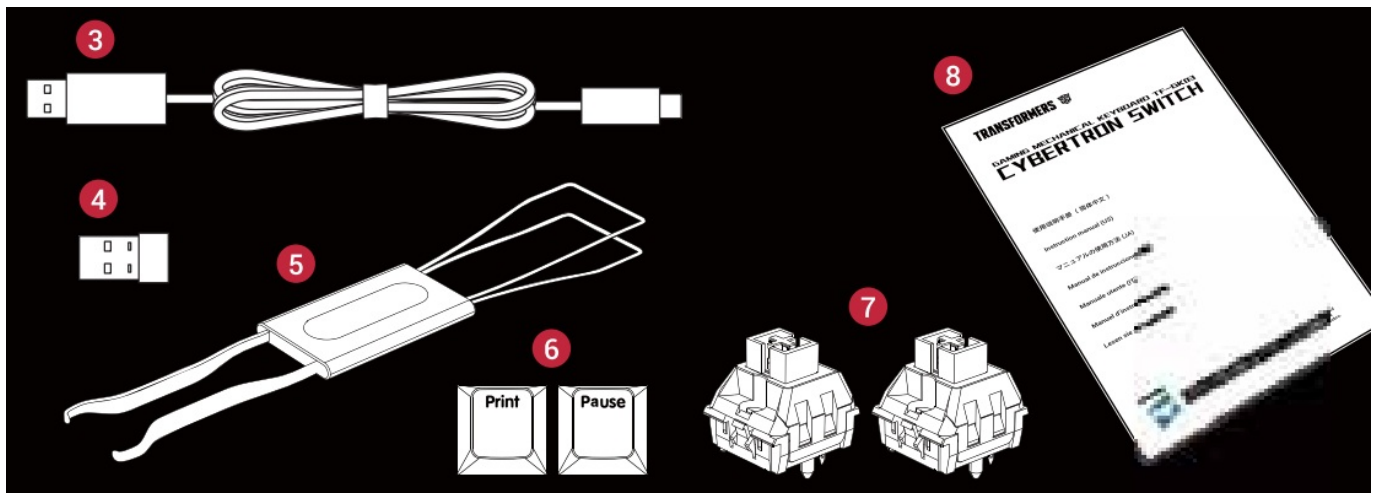

1. TF-GK01 Gaming mechanical keyboard
2. Keyboard cover
3. USB Type-C cable
4. USB Wireless Dongle / USB
5. 2-in-1 shaft and key puller
6. User manual and warranty card

Keyboard features



1. Wireless code Indicator Light 1 ,2,3
2. 2.4G Pairing Indicator Light
3. Multimedia-Knob
4. System Switch
5. Mode Switch
6. 2.4G receiver

Keyboard Overview





- Optional 2.4G, BT and wired connection modes for efficient multitasking advancement.
- Advanced anti-punch function with full key conflict-free support, providing stronger command readings in the heat of battle.
- Streamlined body, retaining functionality while keeping the desktop more concise.

- Adaptation system: Windows/MacOs.

Product parameter

- Number of keys: 1 01
- Product size:41 OXl 43X43MM
- Key life:50 million times
- Connection mode:2.4G/Wired/BT
- Battery capacity:5000mAh

Indicator Light Instructions

Indicator position	Function definition
Caps 	Caps Lock
Scr 	Scroll Lock
 	Charging and low voltage indication

View Battery capacity

View Battery capacity (battery operated in wireless mode): Press the combination key Fn+Enter, the backlight is off, and the digital keys 1 to 0 are on to show the power ratio. for example:l on, indicating 10% power, 1 and 2 on, indicating 20% power. And so on.



Mode switching

2.4G mode:

Receiver connected to the computer USB,keyboard boot dial to 2.4G position, you can automatically connect back to use. Forced code pairing: After the keyboard is turned on and dialed to the 2.4G position, the white light of the R key flashes slowly, long press the FN +R key combination 3-5S into the pairing mode, the R key light flashes quickly,insert the receiver, the pairing is successful and exit the code pairing,R keylight back to backlight mode. If you can not find the pairing device after 20s,automatically exit the pairing mode. No pairing code action 7 seconds

after the keyboard into sleep mode.



BT mode:

1. When the toggle switch is set to BT mode, short press the FN+Q/W/E key combination to switch between different devices;
2. Long press FN+Q/W/E key combination 3-5S, the keyboard enters the pair code pairing state, the corresponding key white light flashing, start to connect connected to BT devices, connected to the device, the corresponding key light to restore the backlight mode, if not connected to the device backlight 7 seconds after the light goes off, the keyboard enters sleep mode.



Device connection name

- Wired Connection name: Transformers Keyboard
- 2.4G Connection name: 2.4G Wireless Keyboard
- BT Connection name: TF-GK03-BT1. TF-GK03-BT2. TF-GK03-BT3

How to operate: key compound function

System adjustment:

Windows Key combinations			
Shortcut Keys	Function Definition	Shortcut Keys	Function Definition
F1	F1	Fn+F1	luminance -
F2	F2	Fn+F2	luminance +
F3	F3	Fn+F3	Task view
F4	F4	Fn+F4	My computer
F5	F5	Fn+F5	search
F6	F6	Fn+F6	Screenshot
F7	F7	Fn+F7	Previous song
F8	F8	Fn+F8	Play/pause
F9	F9	Fn+F9	Next song
F10	F10	Fn+F10	Sound off
F11	F11	Fn+F11	Volume -
F12	F12	Fn+F12	Volume +
Ctrl	Ctrl	Fn+ [{	Home
Win	Win	Fn+] }	End
Alt	Alt	Fn+ = +	Scroll

Mac Key combinations			
Shortcut Keys	Function Definition	Shortcut Keys	Function Definition
F1	luminance -	Fn+F1	F1
F2	luminance +	Fn+F2	F2
F3	Open task control	Fn+F3	F3
F4	Open the boot pad	Fn+F4	F4
F5	Short press to search Long press and hold to open Siri	Fn+F5	F5
F6	Screenshot	Fn+F6	F6
F7	Previous song	Fn+F7	F7
F8	Play/pause	Fn+F8	F8
F9	Next song	Fn+F9	F9
F10	Sound off	Fn+F10	F10
F11	Volume -	Fn+F11	F11
F12	Volume +	Fn+F12	F12
Ctrl	Control	Fn+ [{	Home
WIN	Option	Fn+] }	End
Alt	Command	Fn+ = +	Scroll

Light mode:

Mac/Windows Key combinations	
Shortcut Keys	Function Definition
Fn+Esc	Press and hold for 5 seconds to restore factory Settings
Fn+Ins	Turn on/off the backlight
Fn+Del	Switch color order
Fn+Backspace	Switch 20 light effect modes
Fn+ ↑	Backlight brightness +
Fn+ ↓	Backlight brightness -
Fn+ ←	Backlight speed slows down
Fn+ →	Backlight speed up

MAC/WIN System Functions:

Mac/Windows Key combinations	
Shortcut Keys	Function Definition
Fn+Q	Bluetooth Mode 1
Fn+W	Bluetooth Mode 2
Fn+E	Bluetooth Mode 3
Fn+R	2.4G Mode
Fn+WIN	Enable or disable the WIN function
<p>* Toggle the switch to the corresponding mode position to take effect. Toggle the toggle switch for 2.4G mode below, wired mode in the middle, and Bluetooth mode above.</p>	

FCC Warning

This equipment has been tested and found to comply with the limits for a class B digital device, pursuant to part 15 of the FCC Rules. These limits are designed to provide reasonable protection against harmful interference in a residential installation. This equipment generates, uses and can radiate radio frequency energy and, if not installed and used in accordance with the instructions, may cause harmful interference to radio communications. However, there is no guarantee that interference will not occur in a particular installation. If this equipment does cause harmful interference to radio or television reception, which can be determined by turning the equipment off and on, the user is encouraged to try to correct the interference by one or more of the following measures:

- Reorient or relocate the receiving antenna.
- Increase the separation between the equipment and receiver.
- Connect the equipment into an outlet on a circuit different from that to which the receiver is connected.
- Consult the dealer or an experienced radio/TV technician for help

Caution: Any changes or modifications to this device not explicitly approved by manufacturer could void your authority to operate this equipment.

This device complies with part 15 of the FCC Rules. Operation is subject to the following two conditions:

1. This device may not cause harmful interference, and
2. This device must accept any interference received, including interference that may cause undesired operation.

This equipment complies with FCC radiation exposure limits set forth for an uncontrolled environment. This equipment should be installed and operated with minimum distance 0cm between the radiator and your body.

Name and content of harmful substances in the product

Part name	Harmful substance					
	(Pb)	(Hg)	(Cd)	(Cr (VI))	(PBB)	(PBDE)
Structural components and electronic components	○	○	○	○	○	○
Small structural components such as shells	○	○	○	○	○	○
<p>This table is prepared in accordance with the provisions of SJ/T11364</p> <p>○: Indicates that the content of harmful substances in all homogeneous materials of the component is below the limit requirements specified in GB/T26572.</p> <p>X: indicates that the content of the hazardous substance in at least one homogeneous material of the component exceeds the limit requirements specified in GB26572.</p> <p>The components marked with "X" on the form cannot be replaced with harmful substances due to limitations in global technological development.</p>						
<p>This table is prepared in accordance with the provisions of SJ/T11364</p> <p>Printed circuit board components *: including printed circuit boards and their components, electronic components, etc;</p> <p>Depending on the product model, the product you purchased may not contain all of the above components.</p>						
<div>  <p>Electronic and electrical products sold within the territory of the People's Republic of China must be marked with this mark, the number in the mark represents the environmental protection life of the production under normal use.</p> </div>						

Warranty Service

Dear user, this warranty card is the proof of your future warranty application, please cooperate with the seller to fill it out and keep it for future use!

User info

- User name Email
- Contact number
- Postal code Mailing address

Product information

- Product name Product number
- Product barcode / Serial number / Batch number

Vendor information

- Name
- Address
- Contact number Postal code
- Sales date Invoice number
- Remark

Documents / Resources

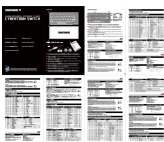
	<p>TRANSFORMERS TF-GK03 Gaming Mechanical Keyboard [pdf] Instruction Manual 2BAQF-TF-GK03, 2BAQFTFGK03, tf gk03, TF-GK03 Gaming Mechanical Keyboard, TF-GK03, Gaming Mechanical Keyboard, Mechanical Keyboard, Keyboard</p>
---	---

References

- [User Manual](#)

[Manuals+](#), [Privacy Policy](#)

This website is an independent publication and is neither affiliated with nor endorsed by any of the trademark owners. The "Bluetooth®" word mark and logos are registered trademarks owned by Bluetooth SIG, Inc. The "Wi-Fi®" word mark and logos are registered trademarks owned by the Wi-Fi Alliance. Any use of these marks on this website does not imply any affiliation with or endorsement.