



Training Desk Online Quiz Platform User Guide

[Home](#) » [Training Desk](#) » Training Desk Online Quiz Platform User Guide 

Contents

- [1 Training Desk Online Quiz Platform](#)
- [2 Product Information](#)
- [3 Product Usage Instructions](#)
- [4 FAQ](#)
- [5 Completing An Online Quiz](#)
- [6 Video upload questions](#)
- [7 Documents / Resources](#)
 - [7.1 References](#)



Training Desk Online Quiz Platform



Product Information

Specifications

- **Question Types:** Multiple choice, Written short answer, File upload, Video upload
- **Assessment Method:** Some questions will be marked by an assessor

Product Usage Instructions

Multiple Choice Questions

- Select one or more answers and click SUBMIT. You can retry incorrect answers.

Written Short Answer Questions

- Type your answer in the field and click SUBMIT for marking.

File Upload Questions

- Download the form, complete it, and upload it for marking. You can complete the form by printing, scanning, and uploading or by electronically completing and uploading.

Video Upload Questions

- Record a video of yourself following the detailed instructions provided. Use your device to record the video.

FAQ

Q: How do I know if I need to complete an online quiz?

A: If required, you will see all the questions listed when you enter the quiz.

Q: What happens if I get a question wrong on the quiz?

A: You can attempt the question again for multiple-choice questions. For written short-answer questions, you will receive feedback on your answer from the assessor.

Completing An Online Quiz

- There are 4 different types of questions that you may have to complete.
- Multiple choice
- Written short answer
- File upload
- Video upload
- Some of these question types will be marked by an assessor (if you are attending a face-to-face session after completing the online components, your assessor will be your trainer).
- If any questions are incorrect the assessor will provide you with feedback on your answer.
- When you first enter the quiz you will see all of the required questions listed.

100% Online Pre-Course Work - Provide CPR

COURSE OVERVIEW

Previous section
First Aid CPR Laws Ethics - Review

Next section
Pre-Course - Assessment Preparation - HLTA0005

Knowledge Assessment - Resuscitation V2

Question 1 of 20	Not yet answered	>
Question 2 of 20	Not yet answered	>
Question 3 of 20	Not yet answered	>
Question 4 of 20	Not yet answered	>
Question 5 of 20	Not yet answered	>
Question 6 of 20	Not yet answered	>
Question 7 of 20	Not yet answered	>
Question 8 of 20	Not yet answered	>
Question 9 of 20	Not yet answered	>
Question 10 of 20	Not yet answered	>

- Multiple-choice questions will require you to select either one (1) or more answers to the question. Once you have selected your answer option/s you must click SUBMIT. If you get a question wrong you can attempt it again.

Question

[Back to Questions](#)

Question 1 of 20

Which of the following must be adhered to when providing first aid in the workplace?

- ☐ Workplace policies and procedures
- ☐ Australian Resuscitation Council Guidelines
- ☐ WHS Act and Regulations and State/Territory Regulations
- ☐ All of the above

[Submit](#)[Skip Question](#)

- Written short answer questions will require you to type your answer into the field and click SUBMIT to send for marking.

Question

[Back to Questions](#)

Question 21 of 32

List at least three (3) items, signs, or symptoms that might indicate that a person who is unconscious, or incoherent, is from substance abuse (drugs and alcohol)?

B *I* U

Please type your answer.

[Submit](#)[Skip Question](#)

- File upload questions will require that you download a form or document that you need to complete and then upload it into the question for marking.
- You will be directed to download the form from the link in the question. The document can be completed in two (2) ways.
- Download, print, complete, scan and upload
- Download, save to your device, complete electronically, and upload

FIRST AID INCIDENT REPORT FORM

Scenario - A person known to suffer from asthma is short of breath and has a wheeze when breathing. You had to use the workplace first aid kit to treat the casualty with a reliever medication.

You treated the casualty using a blue/grey reliever and spacer, following the '4-Step Asthma Treatment Plan'.

The casualty still couldn't breathe normally, so you called for assistance from emergency services. Whilst waiting for emergency services to arrive, you continued treatment and monitored the casualty's vital signs.

Casualty vital signs:

- Fully conscious
- Weak pulse (99 BPM)
- Breathing is rapid but shallow (25 RPM)
- Skin colour is pale, feeling cold

Please download, save to your device and complete the first aid incident report form using the information from the scenario. Some areas have been filled in for you. All sections must be completed. Please use today's date and time as your reference.

[First Aid Incident Report Form](#)

Once completed and upload your form to this section for marking.

File Upload

Webcam

Upload Files to Submit
Drag files into this box or [click here](#)

Submit

Skip Question

Video upload questions

- Video upload questions will require you to take a video of yourself giving a verbal explanation and/or a physical demonstration.
- Each video upload question contains detailed instructions on how to complete the video upload and how to use your device (computer, phone, tablet) to record your video.

Question 6 of 32

Please make a video of yourself, briefly explaining: (no more than 1 minute)

- How would you approach a casualty that is aged or infirmed?
- What types of casualty assessment and communication techniques would you use when providing first aid for a casualty that is aged or infirmed?

How to undertake the video recording assessment:

Read the instructions and requirements for the video submission carefully:

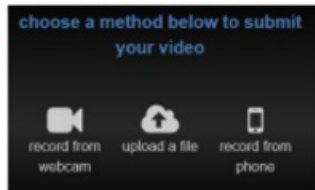

We recommend recording from your phone as the best option for submitting video recordings.

To submit a video you must record your video directly from a phone that has a camera **OR** have previously recorded a video **OR** have a webcam attached to your computer.

If a question requires a video recording, you will see the following screen within the question:

To record from your **phone** click on the phone icon on the video screen. **(Preferred method)**

- A message will appear on the video screen and ask you to enter your mobile phone number from which you are wanting to record your video from. Enter your number and then click the "Send mobile link" button.
- You will then receive a text message with a link to follow where you can directly record your video. You will require access to the internet in order to record and submit your video.
- Once you have recorded your video click "Submit" on your phone and wait until it has loaded/published your submission. Please be patient as there could be a small delay while your video uploads.
- Once it has published you need to click the "Submit" button on your computer screen to send the video for marking.

If you have **previously recorded** a video you can upload the file from your computer by clicking on the "upload a file" icon on the video screen.

- Once the video has loaded click the "Submit" button to send the video for marking.

To record from **webcam** select the camcorder icon on the video screen.

Once you have completed the video and it says that it has loaded/ published click on the "Submit" button underneath the video screen. Please be patient as there could be a small delay while your video uploads.

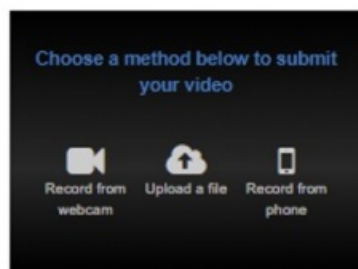

Submit

Skip Question

- This article was last updated on 03/05/2022
- trainingdesk.com.au

Documents / Resources



[Training Desk Online Quiz Platform](#) [pdf] User Guide
Online Quiz Platform, Online Quiz Platform, Quiz Platform, Platform

References

- [User Manual](#)

This website is an independent publication and is neither affiliated with nor endorsed by any of the trademark owners. The "Bluetooth®" word mark and logos are registered trademarks owned by Bluetooth SIG, Inc. The "Wi-Fi®" word mark and logos are registered trademarks owned by the Wi-Fi Alliance. Any use of these marks on this website does not imply any affiliation with or endorsement.