



TRAILFX DHS001B Drop Down Step Bars Installation Guide

[Home](#) » [TRAILFX](#) » TRAILFX DHS001B Drop Down Step Bars Installation Guide 







TrailFX Drop Down Step
Part No. DHS001B / DHS002B
Fits: 2015-2019 Chevrolet, GMC / Colorado / Canyon Crew
Cab & Ext Cab

Contents

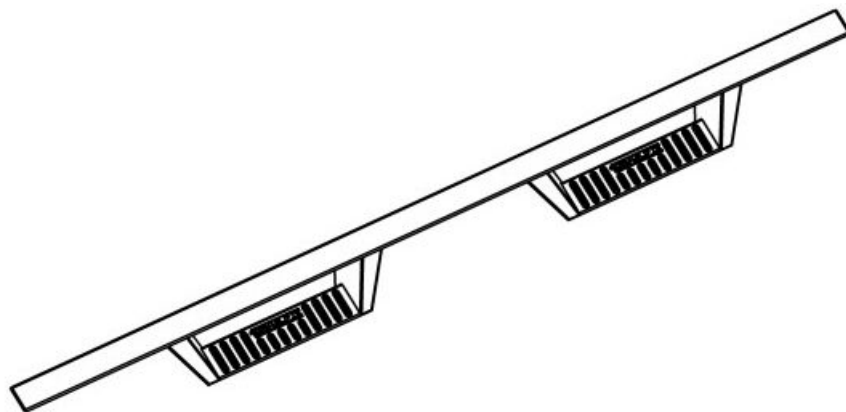
- [1 Product image](#)
- [2 Mounting Kit Images](#)
- [3 INSTALLATION PROCEDURE](#)
- [4 COMPLETE INSTALLATION](#)
- [5 PRODUCT CARE](#)
- [6 FAQ's](#)
- [7 Check out these other TrailFX Products!!](#)
- [8 Documents / Resources](#)
- [9 Related Posts](#)

Product image



	<p>TO AVOID BEING SCRATCHED, PLEASE PROTECT THE SURFACE OF THE TAILGATE VENT WAS COVERED CAREFULLY.</p>
	<p>REMOVE CONTENTS FROM BOX. VERIFY ALL PARTS ARE PRESENT.</p>
	<p>READ INSTRUCTIONS CAREFULLY BEFORE STARTING INSTALLATION.</p>
	<p>ALIGN THE STEP BARS AS DESIRED AND TIGHTEN ALL M10 FASTENERS TO 30 ft. – lb s., AND THEM8 FASTENERS TO 15 ft.-lbs.</p>



60 min



Cutting Not Re-
quired



Drilling Not
Required



support@trailfx.com



1 866 638 4870



POLISHED STAINLESS STEEL – LIMITED LIFETIME POWDER-COATED BLACK – 3 YEARS

PARTS LIST:			
Item	Qty	Part Description	Tools Needed
1	1	Step Bar Driver Side	13 MM SOCKET & WRENCH
2	1	Step Bar Passenger Side	14 MM SOCKET & WRENCH
3	3	Mounting Bracket Driver Side	15 MM SOCKET & WRENCH
4	3	Mounting Bracket Passenger Side	RATCHET
5	12	M8 Bolt	TORQUE WRENCH
6	12	M8 Lock Washer	
7	12	M8 Flat Washer	
8	12	M 10 Flange Bolt	
9	12	M 10 Flange Nut	
10	12	M8 Nut Clip	

Mounting Kit Images

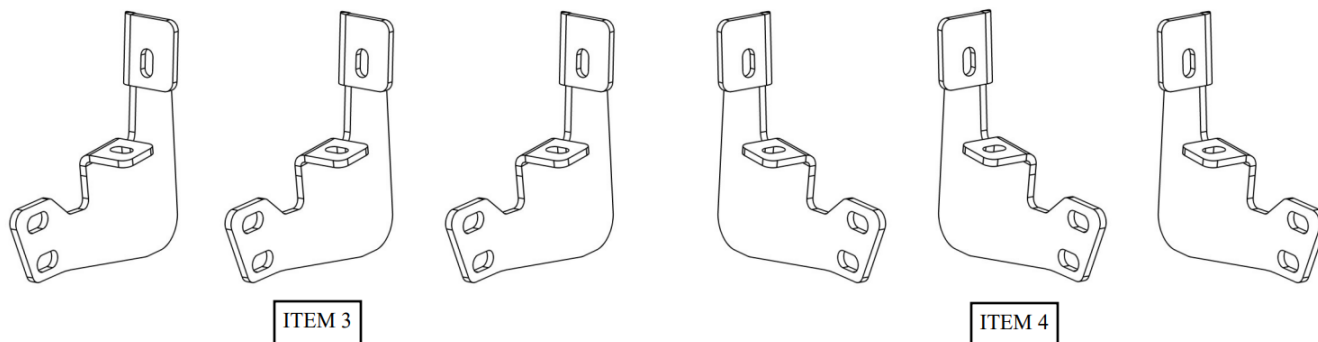

INSTALLATION PROCEDURE

1. Remove plastic plugs from the rocker panel.
2. Start at the front driver side of the vehicle and grab (2) M8 Nut clips (2) M8 hex head bolts, (2) M8 flat washer, and (2) M8 lock washer to driver mount bracket to the rocker panel. Assemble loosely. See Figures 1 and 2.

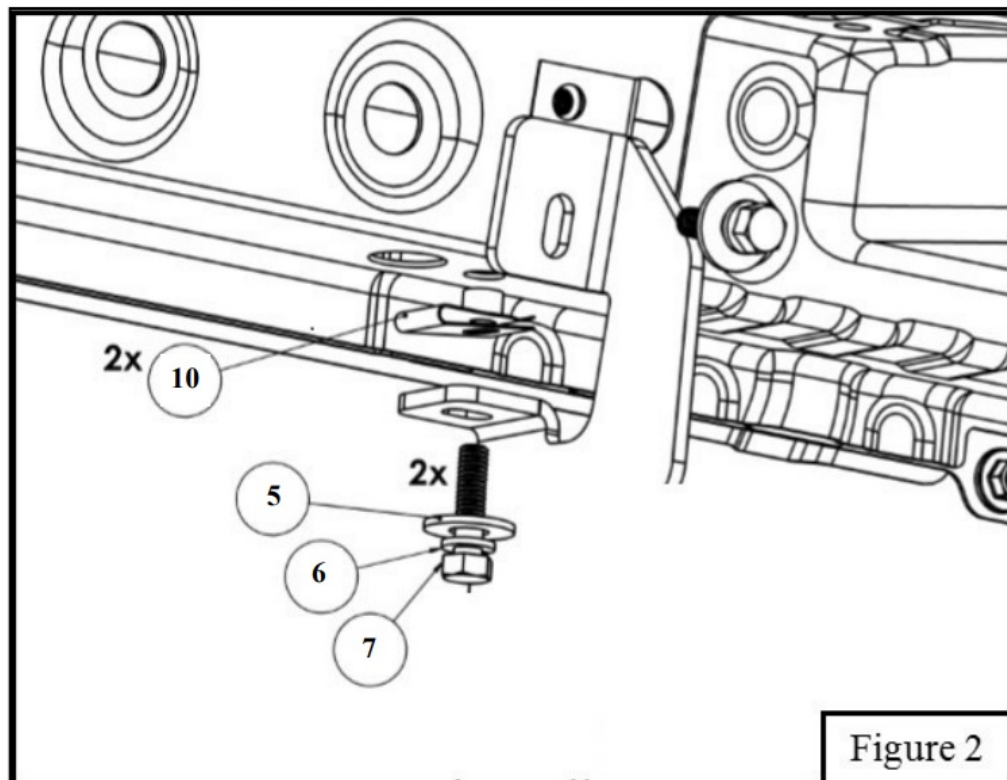
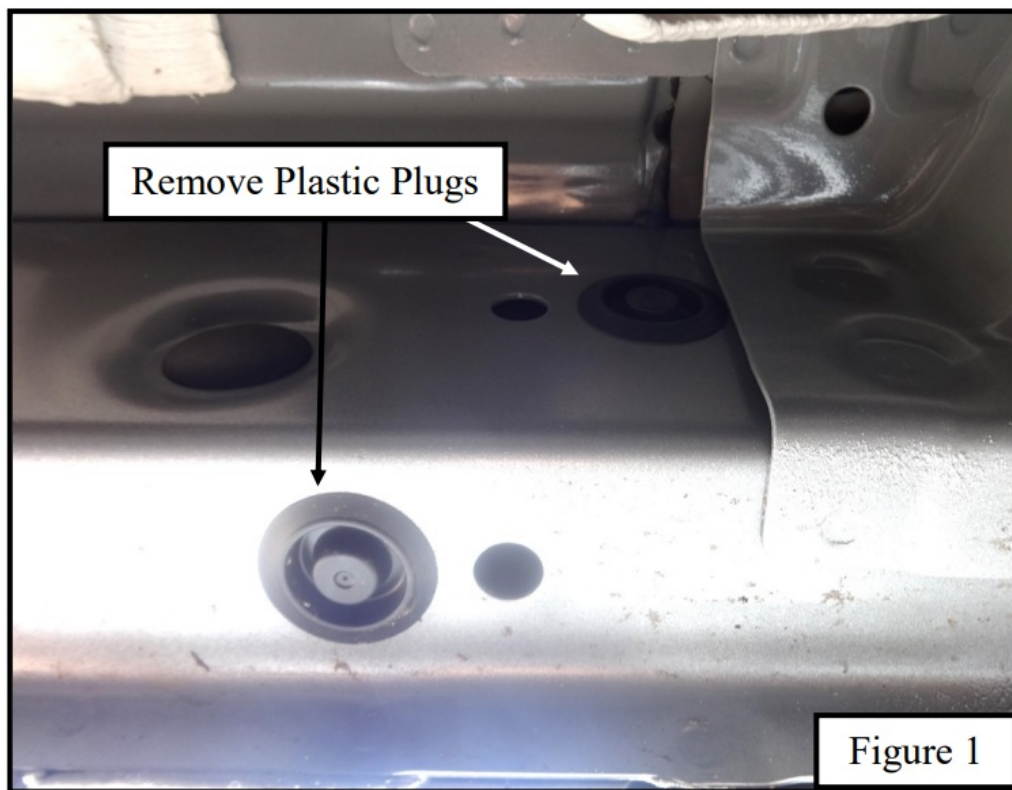

3. Repeat for the center and rear locations.
4. Repeat for the passenger side.
5. Grab Driver Side Bar and install loosely to mount brackets with (6) M10 Flange bolts and (6) Serrated Flange Nuts. See Figure 3.

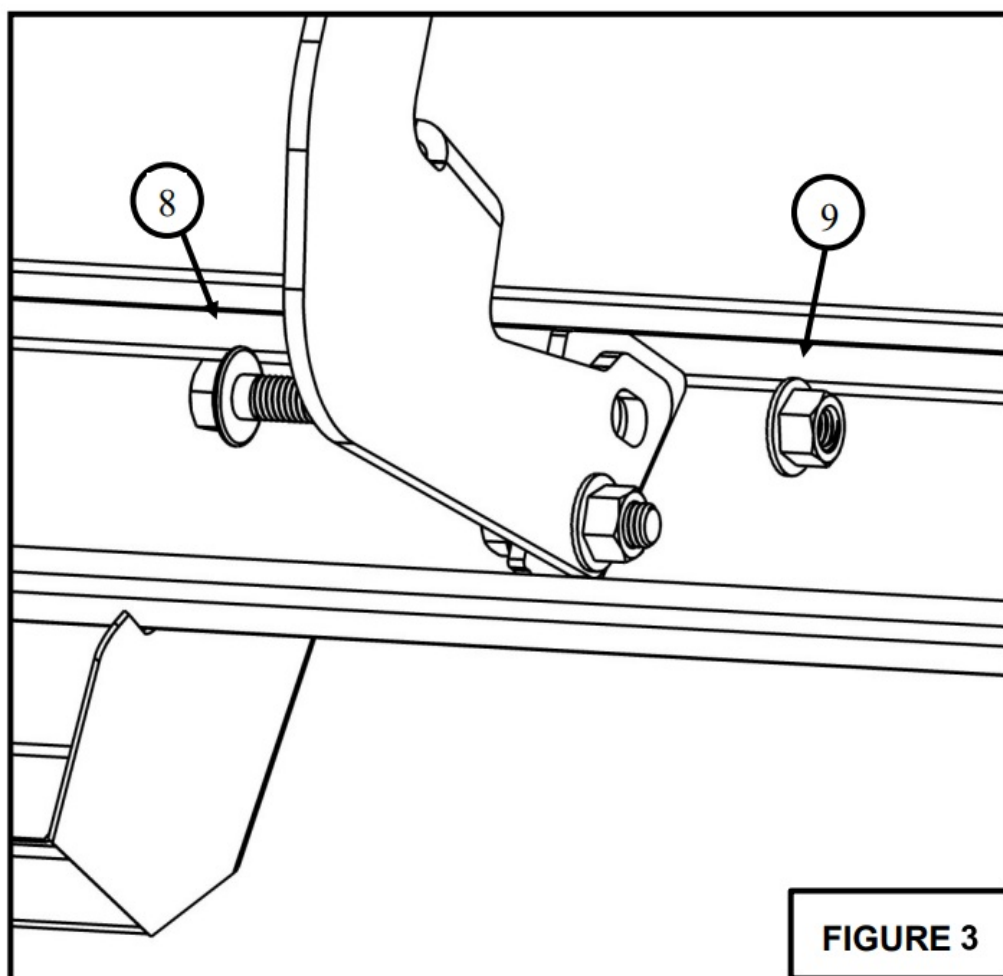

6. Repeat for the passenger side.
7. Align and adjust the step bars as needed and fully tighten all hardware.
8. See Figure 4 for reference.

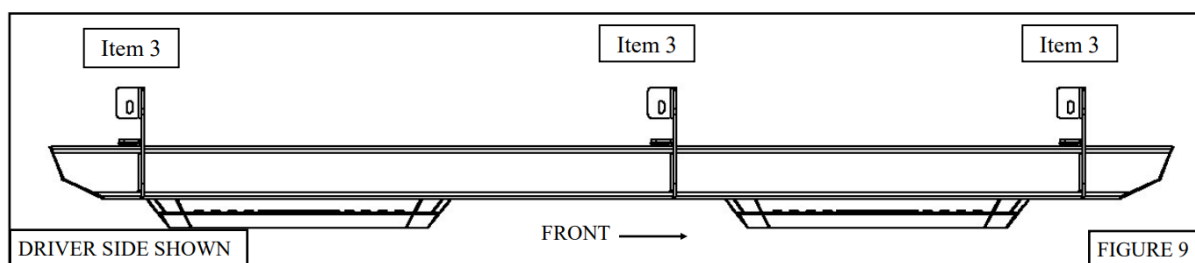

COMPLETE INSTALLATION



PRODUCT CARE

1. Periodically check the product to ensure all fasteners are tight and components are intact.
2. Mild soap may be used to clean the product.

FAQ's

1. **Mounting brackets are not getting Installed properly.**

In some cases Illustration images shown in the Installation manual may not be the exactly same as actual vehicle images, also if Driver / Passenger side mounting brackets are very identical in the design, suggest referring Parts Identification guide to avoiding fitment issue.

2. **Products are thumping/rattling after installation.**

Please ensure that all required mounting brackets/hardware are installed & tightened correctly. Suggest using white lithium / regular grease between the metal to metal contact surfaces.

3. **Missing / Excess Hardware.**

Recheck hardware count as per the part list.

4. **Product not installed properly.**

Ensure make model year, cab length, and bed size of your vehicle is listed in the application. All installation steps are followed correctly.

Check out these other TrailFX Products!!



WINCHES



LED LIGHTS



HD GRILLE GUARDS



BUMPERS



TOOL BOXES

Keystone Automotive Operations Inc. (KAO) warrants this product to be free of defects in material and workmanship at the time of purchase by the original retail consumer. KAO disclaims any other warranties, expresso implied, including the warranty of fitness for a particular purpose or intended use. If the product s found to be defective, KAO may replace or repair the product at our option, when the product is returned prepaid, with proof of purchase. Alteration to, improper installation or misuse of this product voids the warranty. KAO's liability is limited to repair or replacement of products found to be defective and specifically excludes liability for any incidental or consequential loss or damage.

www.TrailFX.com

Documents / Resources



[TRAILFX DHS001B Drop Down Step Bars](#) [pdf] Installation Guide
DHS001B, DHS002B, Drop Down Step Bars

[Manuals+](#)