



TRADEQUIP
6020T Workshop
Trolley Single
Drawer



TRADEQUIP 6020T Workshop Trolley Single Drawer Owner's Manual

[Home](#) » [TRADEQUIP](#) » TRADEQUIP 6020T Workshop Trolley Single Drawer Owner's Manual 

Contents

- 1 [TRADEQUIP 6020T Workshop Trolley Single Drawer](#)
- 2 [Product Usage Instructions](#)
- 3 [Specifications](#)
- 4 [IMPORTANT: READ ALL INSTRUCTIONS BEFORE USE](#)
- 5 [STANDARD OPERATING PROCEDURE](#)
- 6 [ASSEMBLY, OPERATION, PREVENTITIVE MAINTENANCE](#)
- 7 [BEFORE USE](#)
- 8 [OPERATION INSTRUCTIONS](#)
- 9 [MAINTENANCE AND SERVICING](#)
- 10 [SERVICE & REPAIR](#)
- 11 [PARTS LIST & DIAGRAM](#)
- 12 [WARRANTY](#)
- 13 [Documents / Resources](#)
 - 13.1 [References](#)
- 14 [Related Posts](#)



TRADEQUIP 6020T Workshop Trolley Single Drawer



Specifications

- Product Code: 6020T
- Product Name: Workshop Trolley Single Drawer
- Brand: TradeQuip
- Made in: China
- Warranty: 1 year trade guarantee

Product Usage Instructions

Safety Precautions

Before using the Workshop Trolley, ensure you adhere to the following safety precautions:

- Wear safety glasses
- Contain long loose hair
- Wear safety footwear
- Wear close-fitting/protective clothing
- Avoid wearing rings and jewelry

Assemble the Trolley:

1. Assemble on a flat, level, hard, and smooth surface capable of supporting the fully loaded trolley.
2. Attach Upper Shelf to Drawer Frame using provided hardware.
3. Attach casters to the lower shelf – two swivel casters on one side and two locking swivel casters on the other side.
4. Attach posts to each corner of the assembly and lower shelf.

5. Attach handles to each end.
6. Tighten all hardware and slide the drawer into the frame.

Your Workshop Trolley is now ready for use. Do not exceed the maximum load capacity.

FAQ

Q: What is the maximum load capacity of the Workshop Trolley?

A: The user manual advises not to exceed the product's rated maximum load capacity. Please refer to the manual for specific details regarding load limits.

Specifications

- Safe Working Capacity: 155kg
- Nett Weight: 25.5kg
- Overall Dims: 775x415x890mm
- Top Tray Dims: 695x405x65mm
- Drawer Dims: 635x320x80mm
- Drawer Capacity: 34kg
- Lower Tray Dims: 750x395x68mm

About the TradeQuip brand

The 'TradeQuip' brand of workshop equipment, is designed for use in a demanding workshop environment by professional users. With proven and trusted "Made for the Trade" reliability, 'TradeQuip' branded products offer the very best in performance for an affordable price. All backed by a 1 year trade guarantee across 1,000+ distributors Australia wide.

WARNING

IMPORTANT: READ ALL INSTRUCTIONS BEFORE USE

- Safety glasses must be worn when operating this equipment
- Safety footwear must be worn when operating this equipment
- Rings and jewellery must not be worn when operating this equipment
- Long loose hair must be contained when operating this equipment
- Close fitting/protective clothing must be worn when operating this equipment

WARNING

The instructions and warnings contained in this manual should be read and understood before using or operating this equipment. Do not allow anyone to use or operate this equipment until they have read this manual and have developed a thorough understanding of how this equipment works. Failure to observe any of the instructions contained in the manual could result in severe personal injury to the user or bystanders, or cause damage to the equipment and property. Keep this manual in a convenient and safe place for future reference.

Whilst every effort has been made to ensure accuracy of information contained in this manual, the TQB Brands Pty Ltd policy of continuous improvement determines the right to make modifications without prior warning.

0BSTANDARD OPERATING

STANDARD OPERATING PROCEDURE

DO NOT use this machine unless you have been trained and assessed to a competent level in its safe use and operation, and have been given permission to use this

SAFETY OPERATING INSTRUCTIONS

- Do not exceed the products rated maximum load capacity.
- Always distribute objects evenly on the Workshop Trolley. Uneven weight distribution could cause tipping.
- Do not lean or climb onto the Workshop Trolley.
- Only use this device for the purpose for which it has been designed.
- Do not modify any component of this equipment.
- DO NOT SIT, STAND OR CLIMB ON THIS ITEM.
- DO NOT STEP IN OR ON DRAWER/TRAY.
- NEVER roll this roller cabinet over a crack in the floor, a step or power cord when fully loaded.
- Do not allow children to play with or near this item. This item is NOT children's furniture.
- Do not exceed 155kg weight capacity.
- Do not exceed drawer weight capacity of 34kg.
- Evenly distribute load from bottom up. Uneven loading causes tipping.
- Be aware of dynamic loading! Sudden load movement may briefly create excess load causing tipping.
- Close and lock drawer before moving. Do not pull to move, push.
- Use only on a flat, level, hard and smooth surface capable of safely supporting a fully loaded unit.
- Do not lift using handle(s). Do not lift while loaded.
- Read instruction manual before assembly and/or use.
- When servicing, use only Tradequip identical replacement parts. Use of any other parts will void the warranty.
- Only use on a flat surface capable of supporting the Workshop Trolley and its rated maximum capacity load. It is easy to lose control of the Workshop Trolley if attempting to pull a load on a sloping or uneven surface.
- Use the right product for the job. There are certain applications for which the Workshop Trolley was designed. Do not modify the Workshop Trolley and do not use the Workshop Trolley for a purpose for which it was not intended.

ASSEMBLY, OPERATION, PREVENTITIVE MAINTENANCE

1. FEATURES

The Tradequip Single Drawer Workshop Trolley keep the tools you need for the job organised and easily accessible in its all-steel design. This mobile trolley provides mobile storage space and handles up to 155kg worth of tools, parts and equipment. Features include four smooth rolling swivel castors for easy maneuverability around your work area and a glossy powder coat finish for durability. A great mobile tool storage for any garage or workshop, this piece of kit is widely used for collecting and storing parts and/or tools when servicing vehicles and machinery etc.

2. ASSEMBLY

Unpacking: after removing the packing material, make sure the product is in perfect condition and that there are no visible damaged parts. The packaging materials (Polyethylene bags, polystyrene etc.), should be disposed of responsibly in an appropriate refuse collection container. These materials must not be left within the reach of children as they are potential sources of danger.

ASSEMBLE THE TROLLEY:

1. Assemble on a flat, level, hard and smooth surface capable of safely supporting a fully loaded Trolley.
2. Attach two Swivel Casters (7) to one side of Lower Shelf (5), using eight Carriage Bolts (11), Washers (15), and Lock Nuts (13).
3. Attach two Locking Swivel Casters (8) to other side, using eight Carriage Bolts (11), Washers (15), and Lock Nuts (13).
4. Attach Upper Shelf (2) to Drawer Frame (1), using four Bolts (12), eight Washers (15), and four Lock Nuts (13).
5. Lock the Locking Swivel Casters.

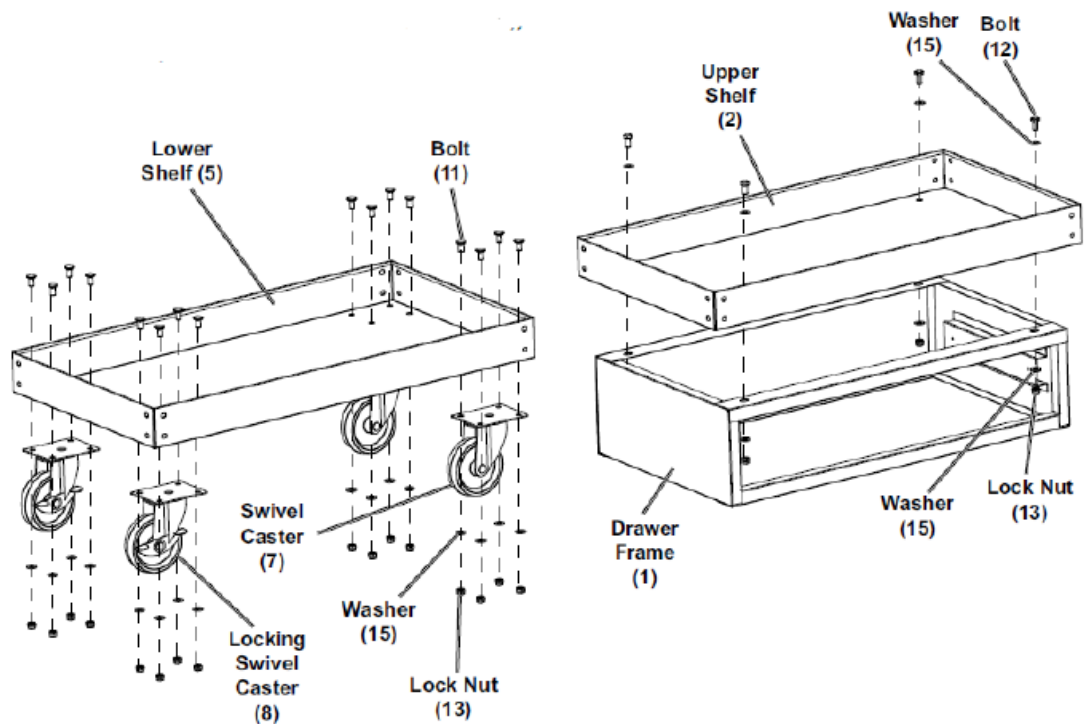

6. Attach one Post (3) to each corner of Drawer/Shelf assembly and Lower Shelf, using twenty four Bolts (10), Washers (16) and Lock Nuts (14) total, eight on top and sixteen on the bottom, as shown below.

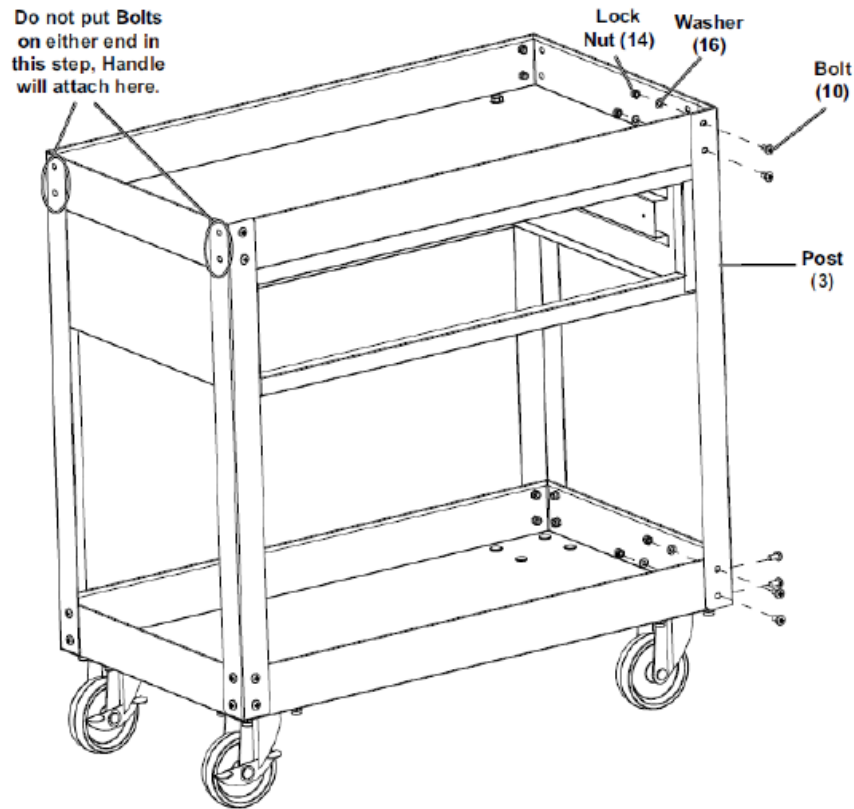

7. Attach one Handle (6) to each end, using eight Bolts (9), Washers (16), and Lock Nuts (14).
8. Tighten all hardware.
9. Slide Drawer (4) into Drawer Frame.

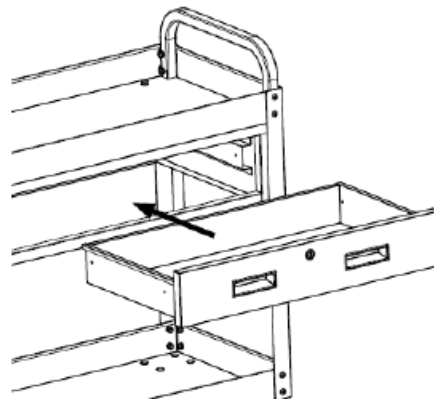
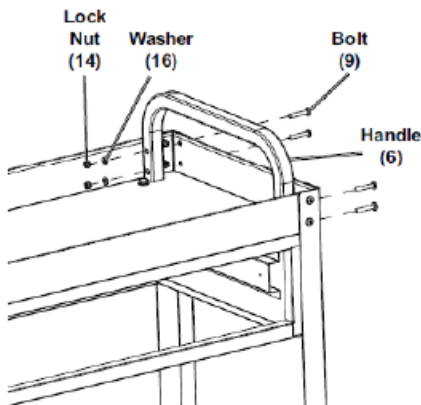

Your Workshop Trolley is ready for use.

Warning – Do not exceed the product's rated maximum load capacity.

BEFORE USE

Prior to each use conduct a visual inspection by checking for abnormal conditions, such as cracked joints and damaged, loose, or missing parts.

OPERATION INSTRUCTIONS

Read the ENTIRE IMPORTANT SAFETY INFORMATION section at the beginning of this document including all text under subheadings therein before set up or use of this product.

1. Fill the Trolley evenly, from bottom to top. Do not exceed weight capacities.

2. Close and lock Drawer.
3. Unlock Locking Swivel Casters.
4. Roll Trolley to a flat, level, hard and smooth surface capable of safely supporting a fully loaded Trolley. Do not roll Trolley over concrete seams or other rough/uneven surfaces.
5. Lock Locking Swivel Casters.

MAINTENANCE AND SERVICING

PERIODICALLY, inspect the general condition of the Trolley. Check for:

- loose hardware,
- misalignment or binding of moving parts,
- brake operation,
- caster swivel function and movement,
- cracked or broken parts,
- any other condition that may affect its safe operation.
- Wipe external surfaces of the Trolley with a clean cloth.
- Lubricate Drawer Slides as needed.

SERVICE & REPAIR

If the Workshop Trolley is found damaged in any way, or found to be worn or operates abnormally, it should be removed from service until repaired by an authorised service agent. Owners and / or operators should be aware that repair of this product may require specialised equipment and knowledge. Only authorised parts, labels, decals shall be used on this equipment. Annual inspection of the Workshop Trolley is recommended and can be made by an authorised repair facility to ensure that your equipment is in optimum condition and that the equipment has the correct decals and safety labels specified by the manufacturer

PARTS LIST & DIAGRAM

Part #	Description	QTY		Part #	Description	QTY
1	Drawer Frame	1		9	Bolt M6x35	8
2	Upper Shelf	1		10	Bolt M6x10	24
3	Post	4		11	Carriage Bolt M8x16	16
4	Drawer	1		12	Bolt M8x16	4
5	Lower Shelf	1		13	Lock Nut M8	20
6	Handle	2		14	Lock Nut M6	32
7	Swivel Caster	2		15	Washer Ø8	24
8	Locking Swivel Caster	2		16	Washer Ø6	32

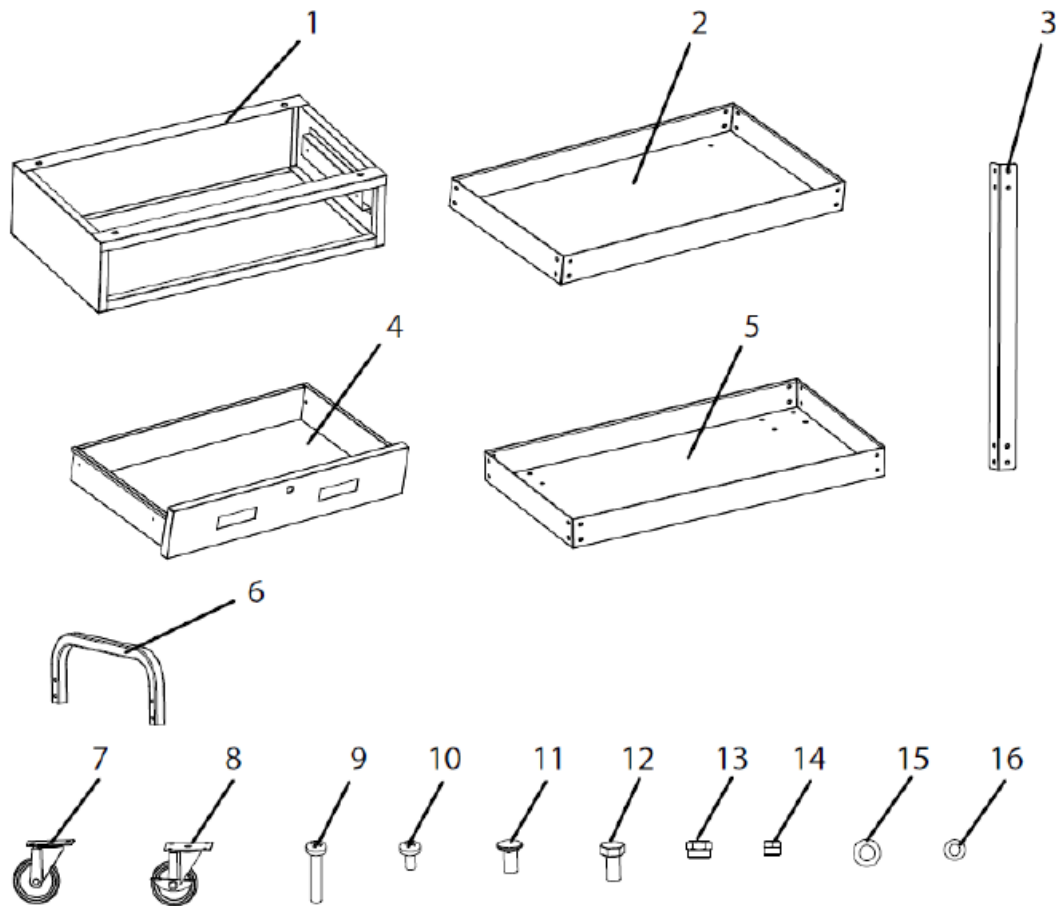

WARRANTY

- TradeQuip products have been carefully tested and inspected before shipment and are guaranteed to be free from defective materials and workmanship for a period of 12 months from the date of purchase except where tools are hired out when the guarantee period is ninety days from the date of purchase.
- Should this piece of equipment develop any fault, please return the complete tool to your nearest authorised warranty repair agent or contact TQB Brands Pty Ltd Warranty team – warranty@tqbbrands.com.au
- If upon inspection it is found that the fault occurring is due to defective materials or workmanship, repairs will be carried out free of charge. This guarantee does not apply to normal wear and tear, nor does it cover any damage caused by misuse, careless or unsafe handling, alterations, accident, or repairs attempted or made by any personnel other than the authorised TQB Brands Pty Ltd repair agent.
- This guarantee applies in lieu of any other guarantee expressed or implied and variations of its terms are not authorised.
- Your TQB Brands Pty Ltd guarantee is not effective unless you can produce upon request a dated receipt or invoice to verify your proof of purchase within the 12 month period.

Consumer Guarantee

Our goods come with a guarantee that cannot be excluded under the Australian Consumer Law. You are entitled to a replacement or refund for a major failure and compensation for any other reasonably foreseeable loss or damage. You are also entitled to have the goods repaired or replaced if the goods fail to be of acceptable quality and the failure does not amount to a major failure.

All images and illustrations shown are for reference purposes only. All information, specifications and illustrations in this manual are based on the latest information available at the time of publication and are subject to change

without notice. The information in this manual is periodically revised to ensure the latest information is included. Download the latest version of this manual and other related technical documentation from www.tqbbrands.com.au

Visit us at www.tqbbrands.com.au

Documents / Resources

	<p>TRADEQUIP 6020T Workshop Trolley Single Drawer [pdf] Owner's Manual 6020T Workshop Trolley Single Drawer, 6020T, Workshop Trolley Single Drawer, Trolley Single Drawer, Single Drawer, Drawer</p>
---	--

References

- [User Manual](#)

Manuals+, Privacy Policy

This website is an independent publication and is neither affiliated with nor endorsed by any of the trademark owners. The "Bluetooth®" word mark and logos are registered trademarks owned by Bluetooth SIG, Inc. The "Wi-Fi®" word mark and logos are registered trademarks owned by the Wi-Fi Alliance. Any use of these marks on this website does not imply any affiliation with or endorsement.