



TRACKER Active GPS Device User Guide

[Home](#) » [Tracker](#) » TRACKER Active GPS Device User Guide 

TRACKER

ACTIVE
Quick Start Guide



Contents

- [1 Active GPS Device](#)
- [2 Technical information:](#)
- [3 Documents / Resources](#)
 - [3.1 References](#)
- [4 Related Posts](#)

Active GPS Device

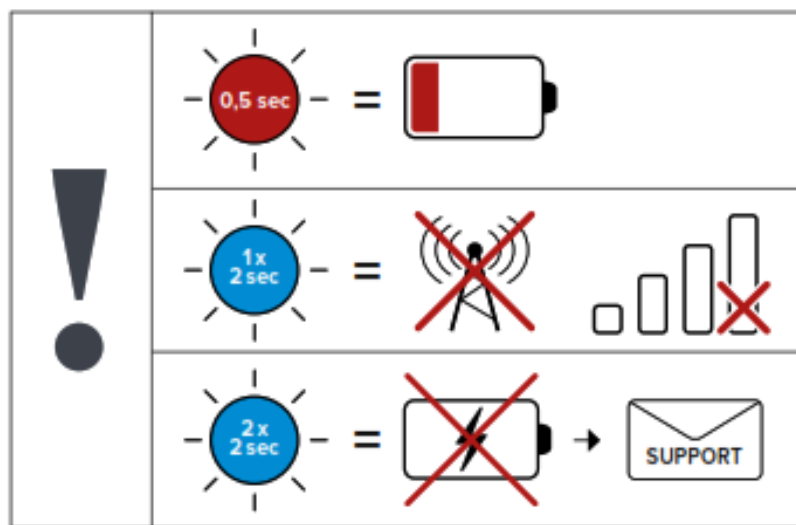
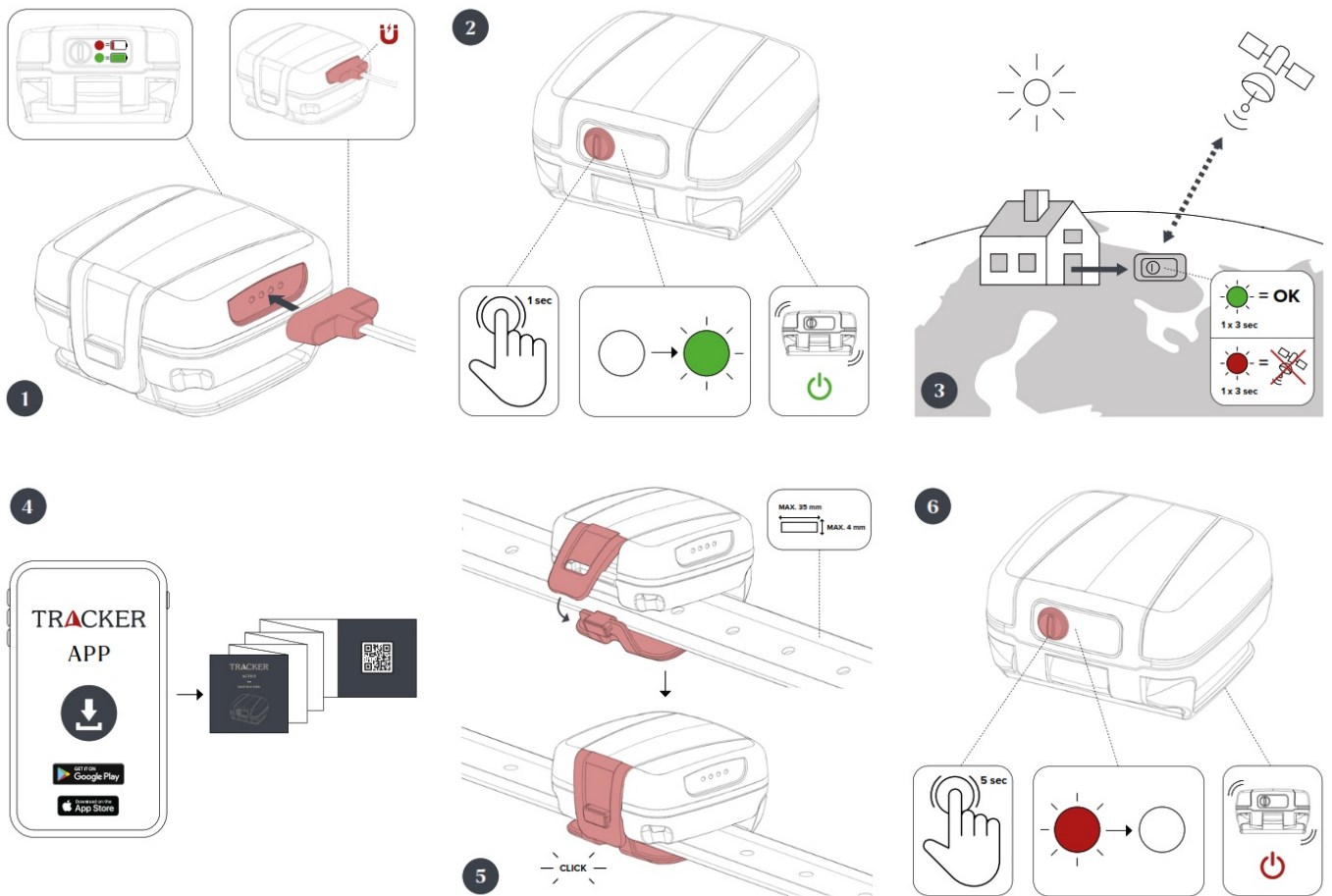

tracker.fi/support

Manufacturer

Tracker Oy
Take 6 90440
Kempele – Finland

Note! The device must be charged at least once every three months.

Note! The device may not be opened, and the SIM card is forbidden to be removed or changed. The SIM card is meant only for the Tracker Active device, and it cannot be used on any other device. Opening the device will immediately void the warranty. In suspected misuse, Tracker Oy has the right to terminate the device subscription without warning. The data usage for normal Tracker Active device location use is included in the device subscription plan.

Technical information:

Type:	Tracker Active
Battery type:	non-user replaceable 3.8V 800 mA
Operating temperature:	-20 °C ... + 60 °C
Charging temperature:	0 °C ... + 45 °C
Weight:	60 g
Waterproof:	0,5 m/60 min
Locating method:	GNSS
Network technology:	GSM 900/1800 MHZ

All rights reserved.

Hereby, Tracker Oy declares that the radio equipment type Tracker GSM 900/1800 MHz GNSS tracking device is in compliance with Directive 2014/53/EU.

More info: tracker.fi/support

The device has been manufactured on 13 August 2005.

At the end of its life cycle, the device must be taken to a recycling point for electric and electronic devices.

TRACKER

SHARE THE ADVENTURE



tracker.fi



tracker



tracker



Documents / Resources

	TRACKER Active GPS Device [pdf] User Guide Active GPS Device, Active, GPS Device, GPS, Active GPS
--	--

References

- [▲ Tracker ja Ultracom | Paikannuslaitteet metsästyskoiralle | Koiratutkat](#)
- [▲ Support : Tracker support](#)