

Traceable 5600013 3 Channel Timer User Guide

[Home](#) » [TRACEABLE](#) » Traceable 5600013 3 Channel Timer User Guide 

Traceable® 5600013 3 Channel Timer User Guide

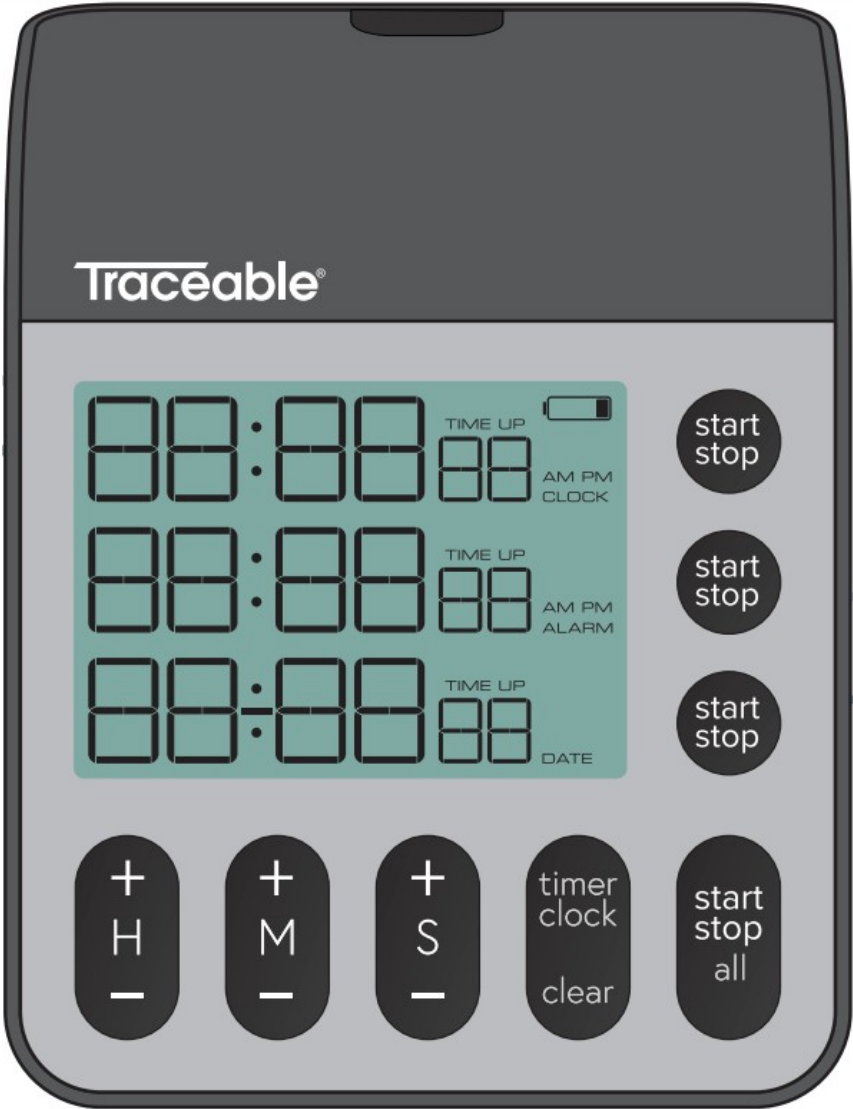

Contents

- 1 5600013 3 Channel Timer
- 2 INITIAL SETUP
- 3 SETTING A TIMER
- 4 Documents / Resources
 - 4.1 References
- 5 Related Posts

5600013 3 Channel Timer

Traceable® 3-Channel Timer

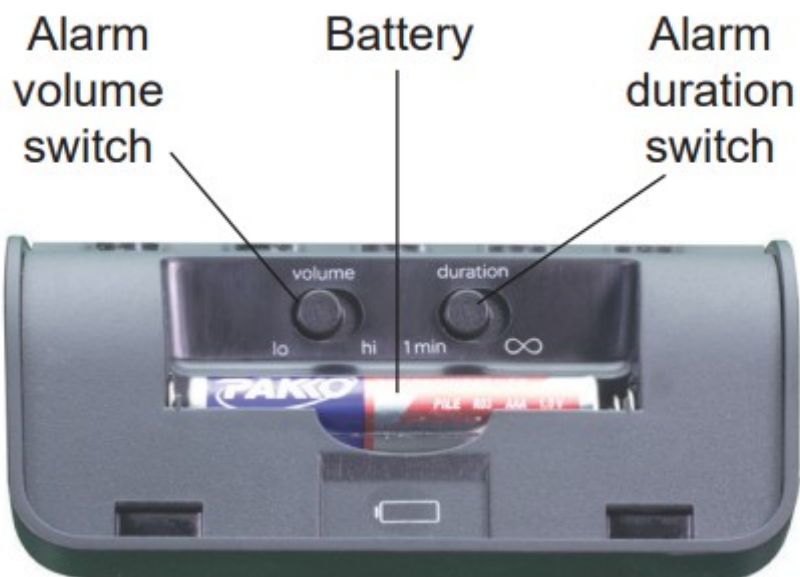
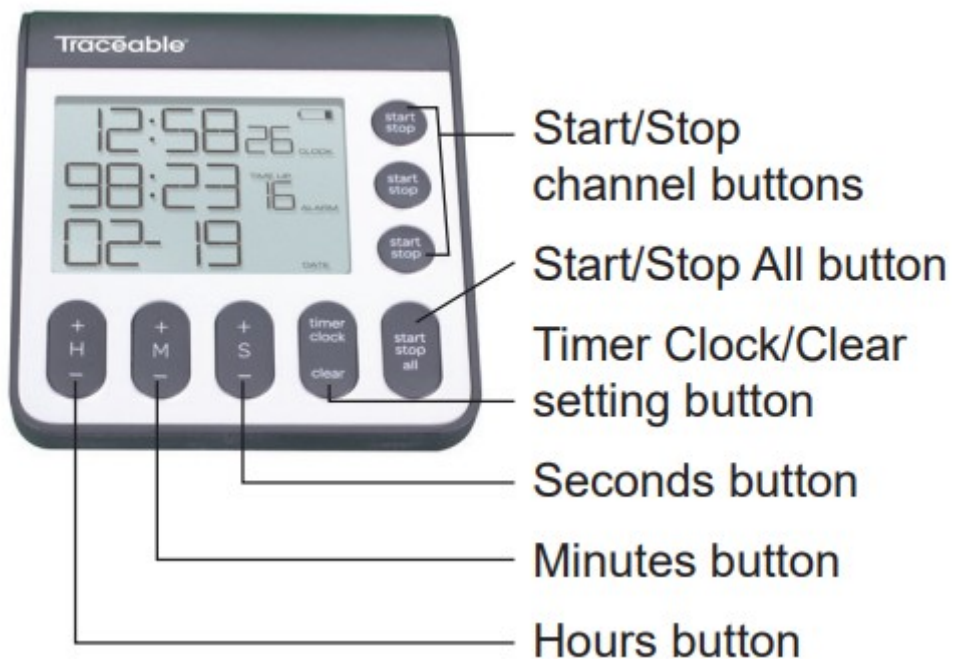

INITIAL SETUP

1. Remove battery cover and insert batteries.

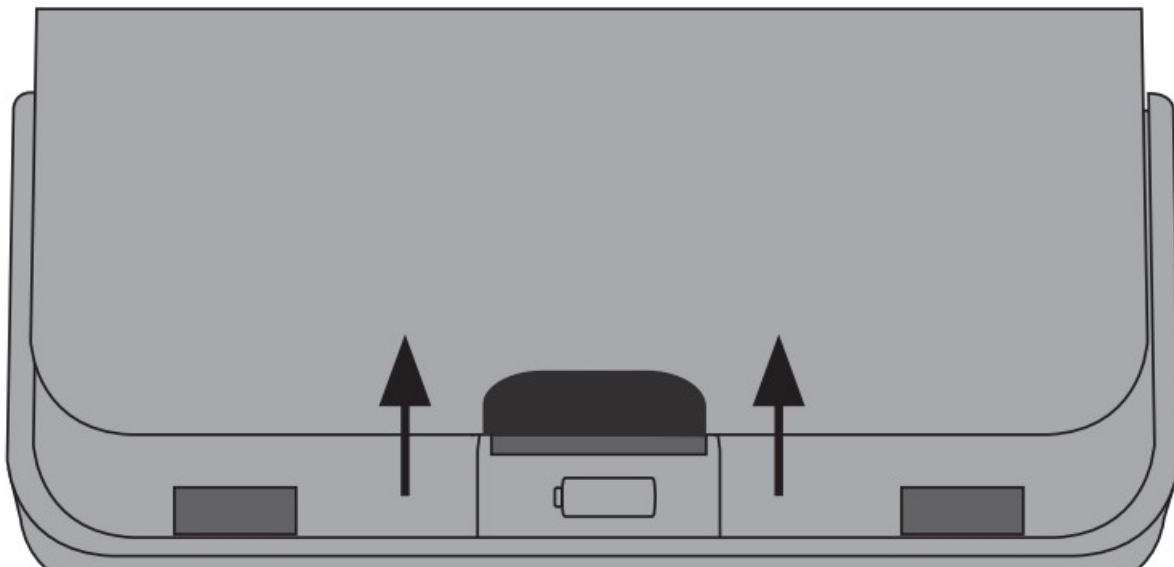

2. Use the volume slider to adjust buzzer volume.

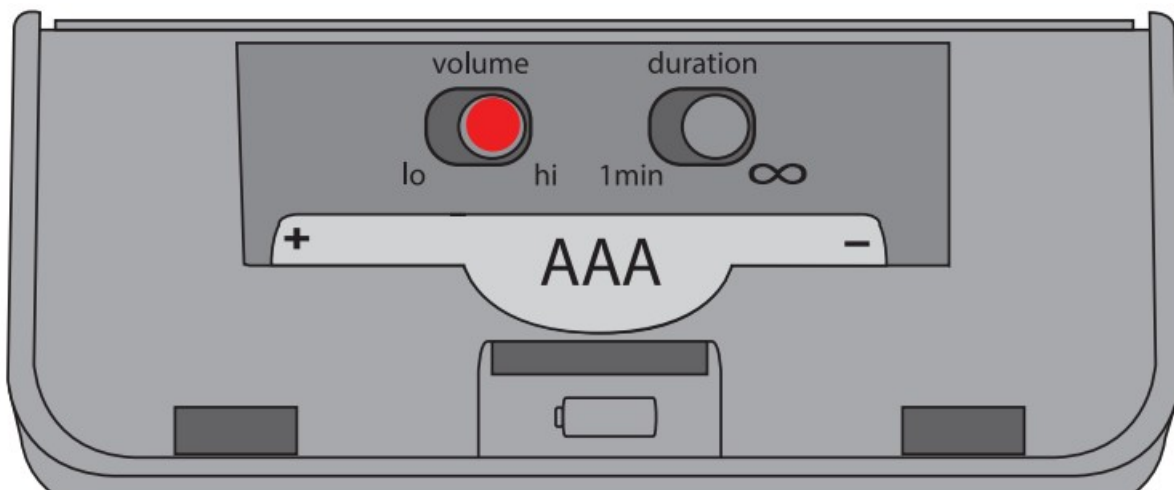

3. Use the duration slider to adjust alarm duration.

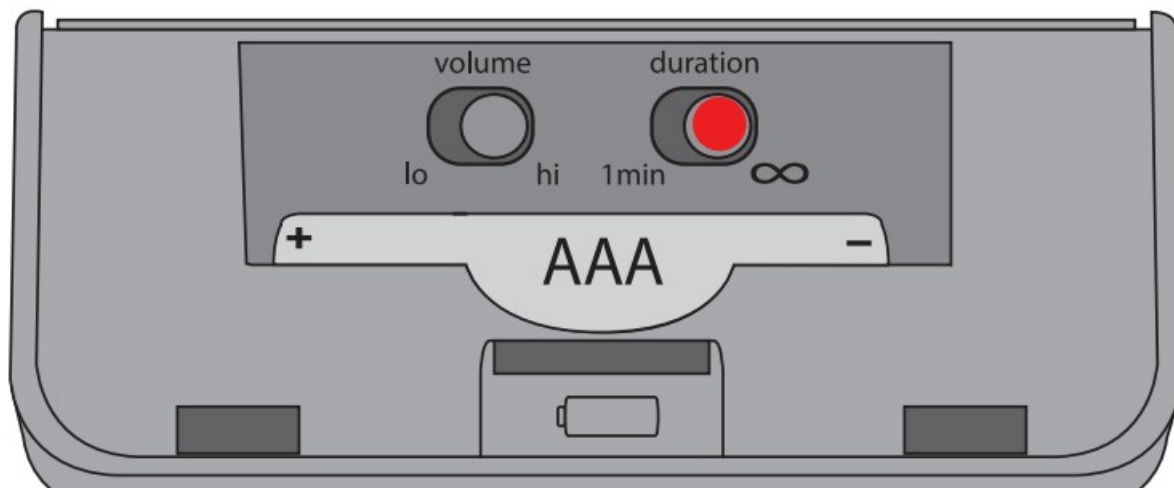

4. Replace battery cover.
5. Press TIMER/CLOCK until time appears on screen.



6. Hold TIMER/CLOCK until there is an audible beep.



7. Use H/M/S buttons to set time; press TIMER/CLOCK when done.

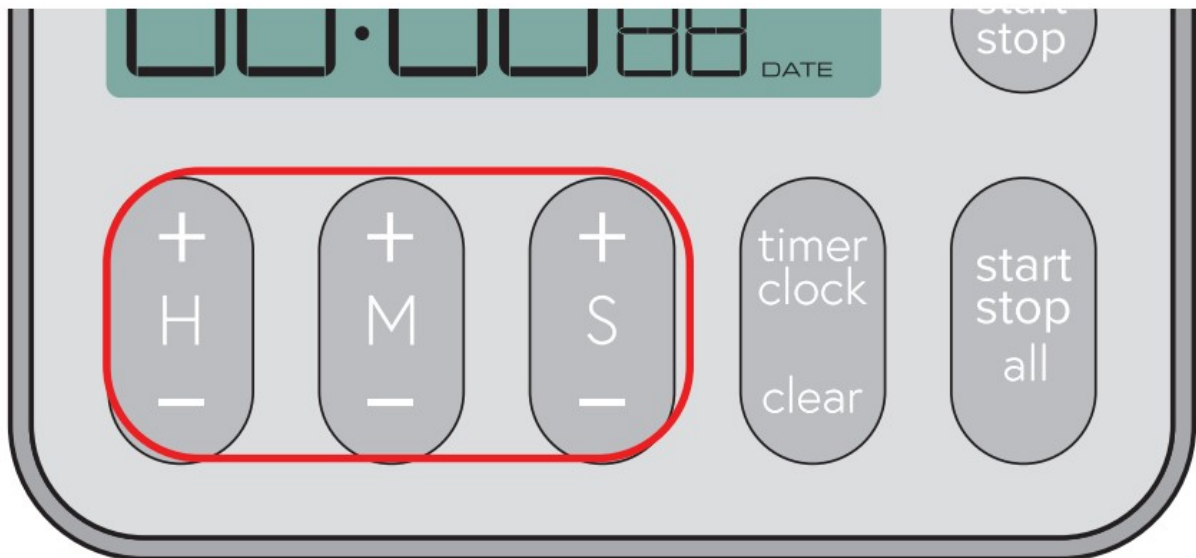

8. Use H/M/S buttons to configure alarm and date.

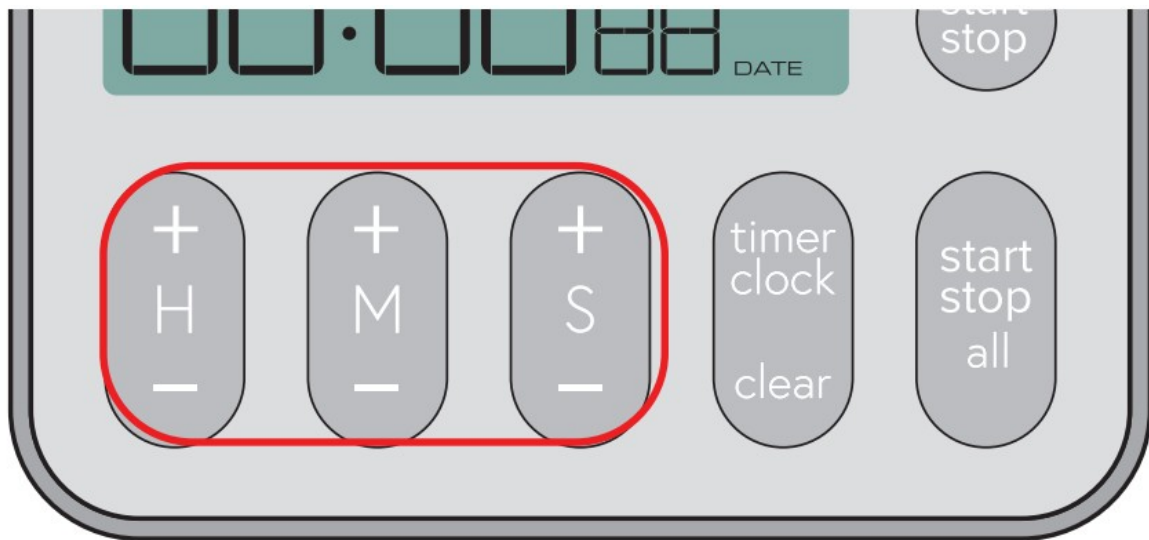

Note: To activate alarm, press START/STOP ALL button when ALARM is flashing. ALARM will appear on display if alarm is active.

SETTING A TIMER

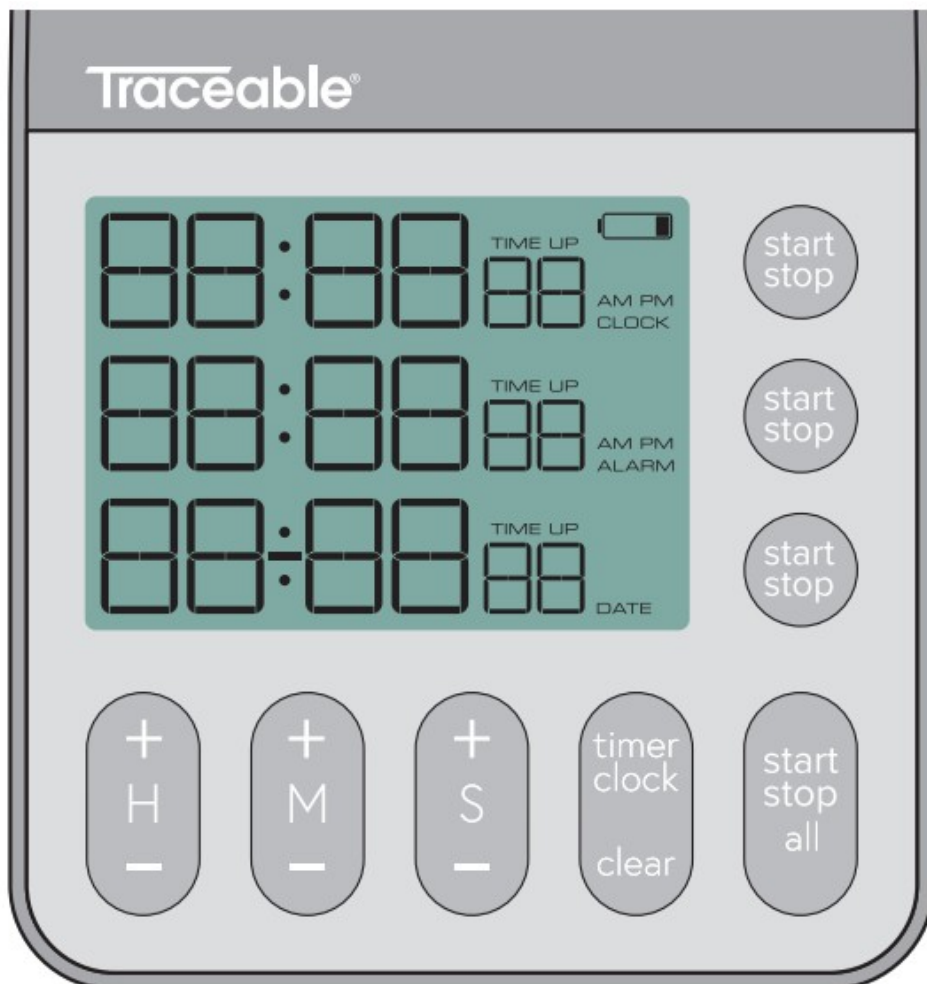

1. Press TIMER/CLOCK until timer is displayed.
2. Press and hold START/STOP on the timing channel to be configured.
3. Use H/M/S buttons to configure timer.
4. Press START/STOP on timing channel to set timer.

Note: To recall memory, simply press START/STOP button after the timer has alarmed.

STARTING A TIMER

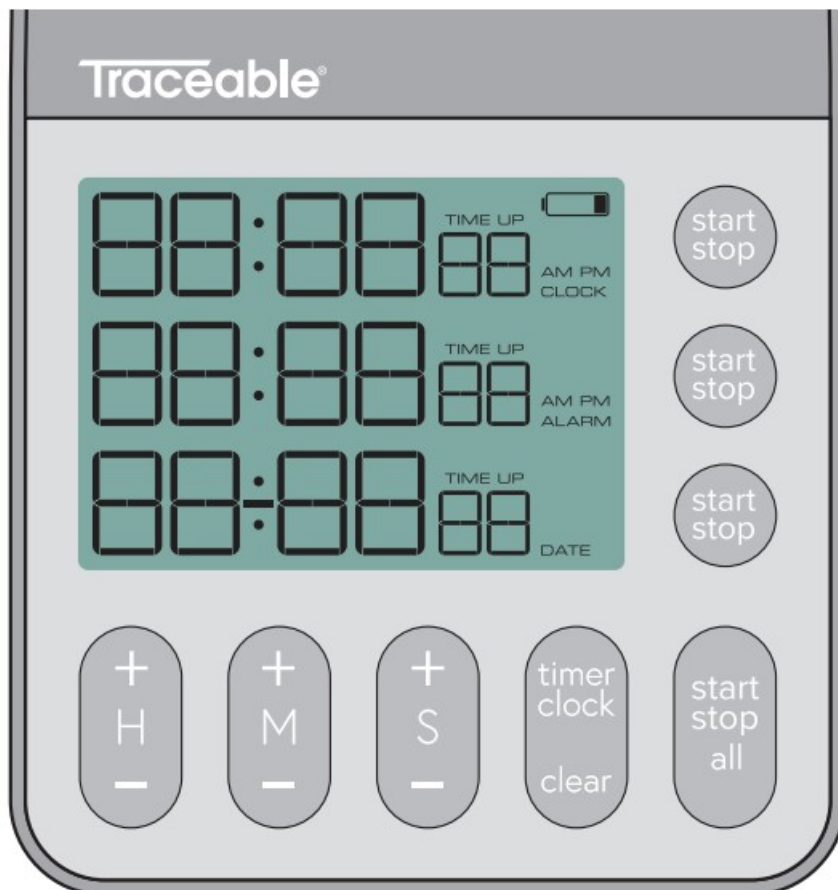

To start/stop an individual channel, press the START/STOP button for that channel.

To start/stop all channels, press the START/STOP ALL button

Note: If a channel has not been configured with a set time, pressing START/ STOP on that channel or START/STOP

ALL will start a count up and TIME UP will flash on that channel.

WARRANTY, SERVICE, OR RECALIBRATION

Traceable®

an antylia scientific company

12554 Old Galveston Rd. Suite B230

Webster, Texas 77598 USA

Ph. 281-482-1714

Fax 281-482-9448

support@traceable.com

traceable.com

Traceable®

Products are ISO 9001:2018 Quality-
Certified by DNV and ISO/IEC 17025:2017

Item No. 56000-13

Model No. 5665

©2022 1065T8_M_92-5665-00 Rev. 0 09022022
accredited as a Calibration Laboratory by A2LA.



[Traceable 5600013 3 Channel Timer](#) [pdf] User Guide
5600013 3 Channel Timer, 5600013, 3 Channel Timer, Channel Timer, Timer

References

- [TP Traceable Products](#)

[Manuals+.](#)