



# tp-link WLAN Bluetooth PCI Express Adapter Installation Guide

[Home](#) » [tp-link](#) » tp-link WLAN Bluetooth PCI Express Adapter Installation Guide 



Quick Installation Guide

WLAN Bluetooth PCI Express Adapter

Images may differ from actual products  
7106508989 REV1.0.1

## Contents

- [1 Connect to a Computer](#)
- [2 Install Drivers](#)
- [3 Join a Wireless Network](#)
- [4 Pair With Bluetooth Devices](#)
- [5 Documents / Resources](#)
  - [5.1 References](#)
- [6 Related Posts](#)

## Connect to a Computer

- a. Turn off your computer, unplug the power cable then remove the case panel.

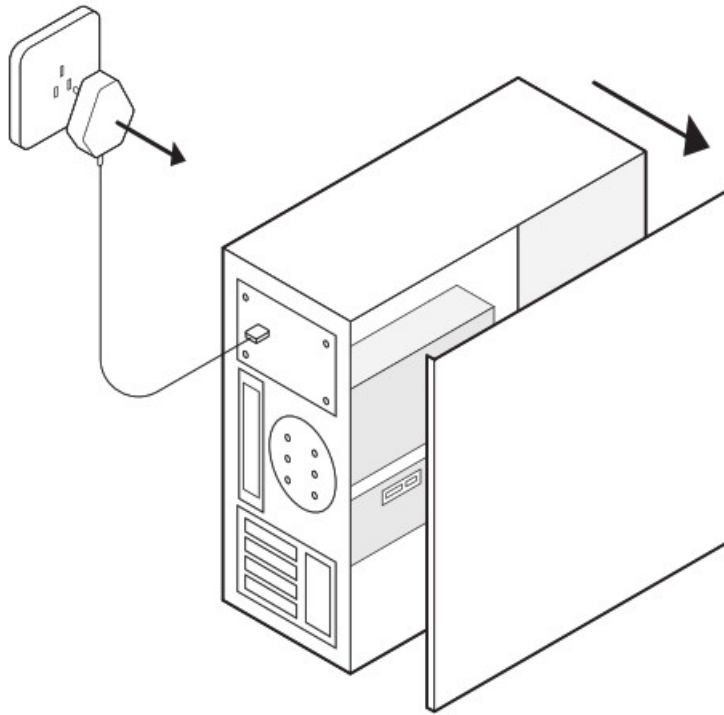

b. Connect the provided USB cable to the adapter.

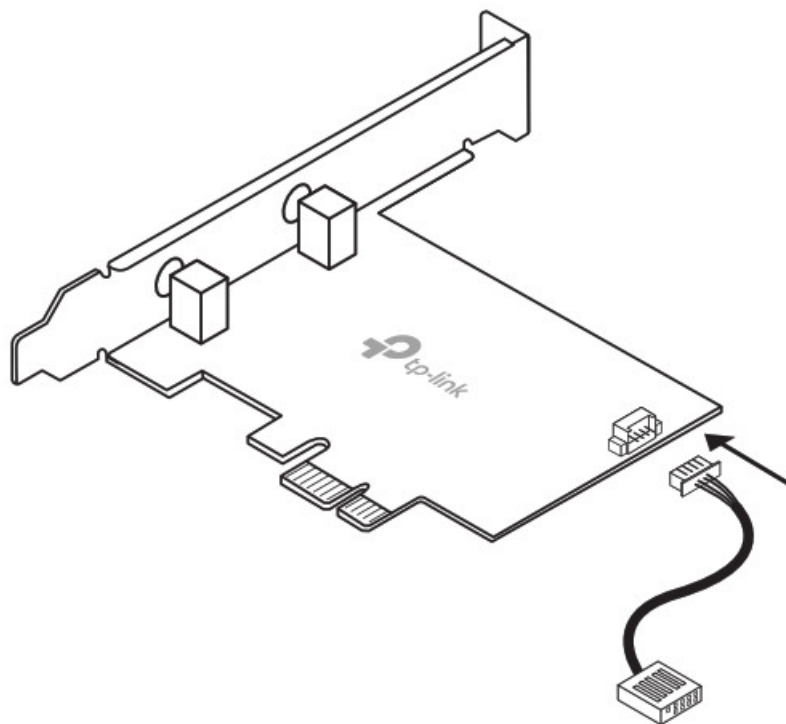

c. Locate an available PCIE X1 slot and carefully insert the adapter.

**Note:**

If the bracket is not suitable for your computer, detach it from the adapter's board and replace it with the low-profile bracket.

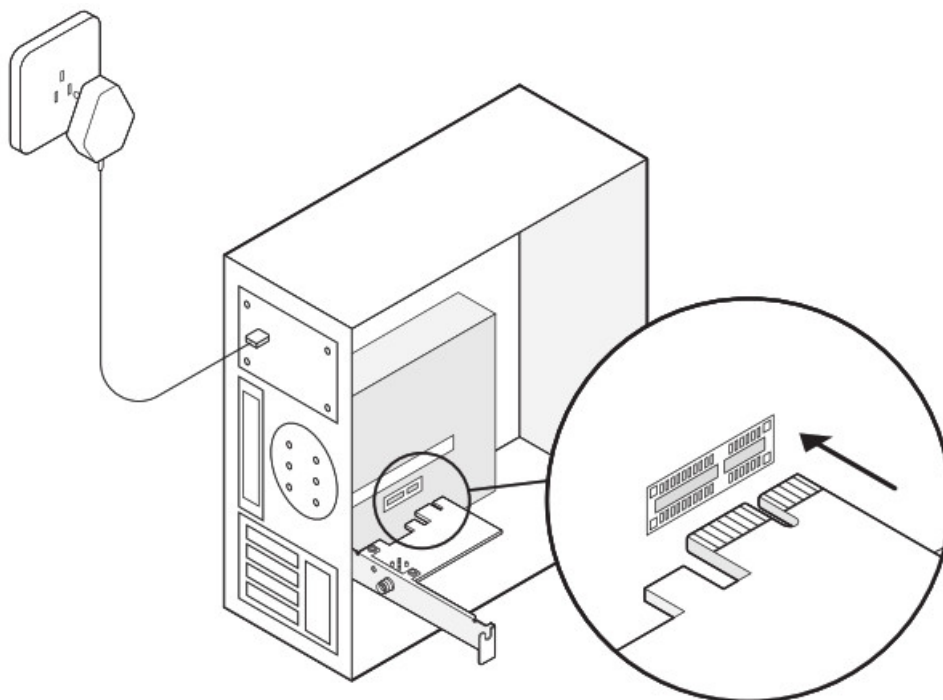

d. Locate an available F\_USB connector and carefully plug the USB cable into it.

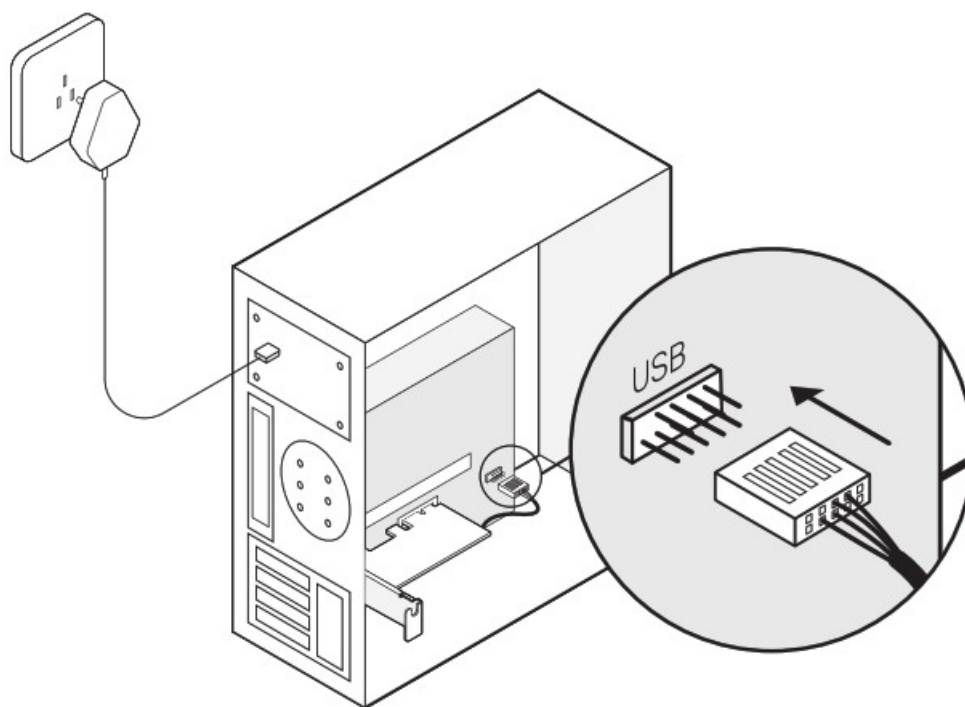

e. Connect the antenna(s) to the adapter.

**Note:**

To maximize performance, make sure the path between the antenna(s) and your router is clear.

f. Replace the case panel, plug in the power cable, and turn on your computer.

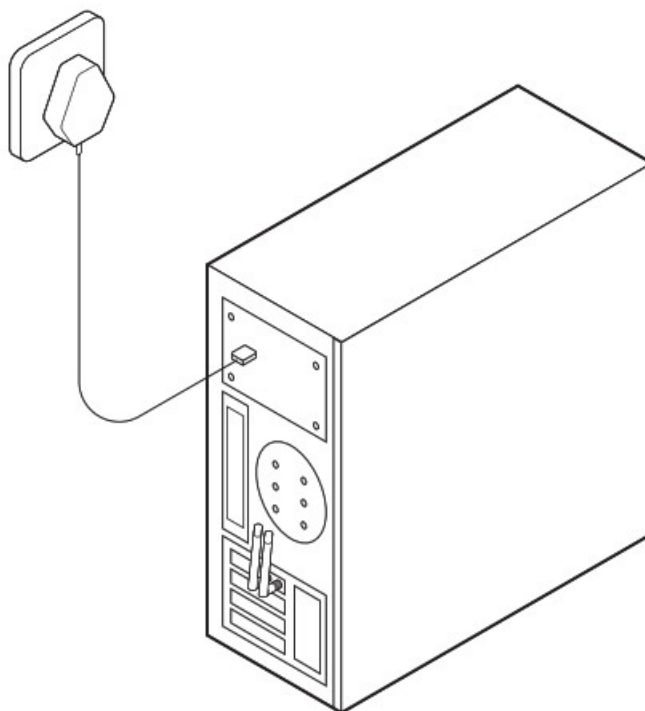

## Install Drivers

- Insert the CD and run the Autorun.exe.

### Note:



You can also check the new release and download the driver at <https://www.tp-link.com/support/download/>

- Install the Wi-Fi and Bluetooth drivers.

- **Wi-Fi:** Click  and follow the onscreen instructions to complete the Wi-Fi installation.

- **Bluetooth:** Click  and follow the onscreen instructions to complete the Bluetooth installation.

## Join a Wireless Network

- Click the network icon ( or ) on the taskbar.
- Select your Wi-Fi network, click Connect, and enter the password when prompted.

## Pair With Bluetooth Devices

- Right-click the  (Bluetooth) icon on the taskbar.  
If it's not displayed, turn on Bluetooth in your PC settings first.



- Select **Add a Bluetooth Device** or **Add a Device** to scan for available devices.
- Select your Bluetooth device from the list and follow the onscreen instructions to complete pairing.

### Note:

Make sure your device's Bluetooth is enabled and discoverable.



Specifications are subject to change without notice.

is a registered trademark of TP-Link Technologies Co., Ltd. Other brands and product names are trademarks or registered trademarks of their respective holders. No part of the specifications may be reproduced in any form or by any means or used to make any derivative such as translation, transformation, or adaptation without permission from TP-Link Technologies Co., Ltd. Copyright © 2020 TP-Link Technologies Co., Ltd. All rights reserved.



For technical support, the user guide and other information, please visit <https://www.tp-link.com/support/>

## Documents / Resources

|   |   |
|---|---|
|  | <a href="#">tp-link WLAN Bluetooth PCI Express Adapter</a> [pdf] Installation Guide<br>tp-link, WLAN, PCI Express Adapter |
|---|---|

## References

- [tp-link.com/fr/support/download/b](https://tp-link.com/fr/support/download/b)
- [TP-Link Product Support - Wireless Networking Equipment Support](#)
- [Download Center | TP-Link](#)