



tp-link VIGI InSight S3 Series Bullet Network Camera User Guide

[Home](#) » [tp-link](#) » [tp-link VIGI InSight S3 Series Bullet Network Camera User Guide](#) 

tp-link VIGI InSight S3 Series Bullet Network Camera User Guide



Contents

- [1 Chapter 1 Appearance](#)
- [2 Status LED Explanation](#)
- [3 Chapter 2 Installation](#)
- [4 Safety First](#)
- [5 Mount the Camera](#)
- [6 Install microSD Card \(Optional\)](#)
- [7 Connect Alarm/Audio Device \(Optional\)](#)
- [8 Waterproof \(Optional\)](#)
- [9 Chapter 3 Configuration](#)
- [10 Appendix FAQ](#)
- [11 References](#)

Chapter 1 Appearance

The figure is for demonstration purposes only. Your device may differ in appearance from the depicted.

InSight S345ZI

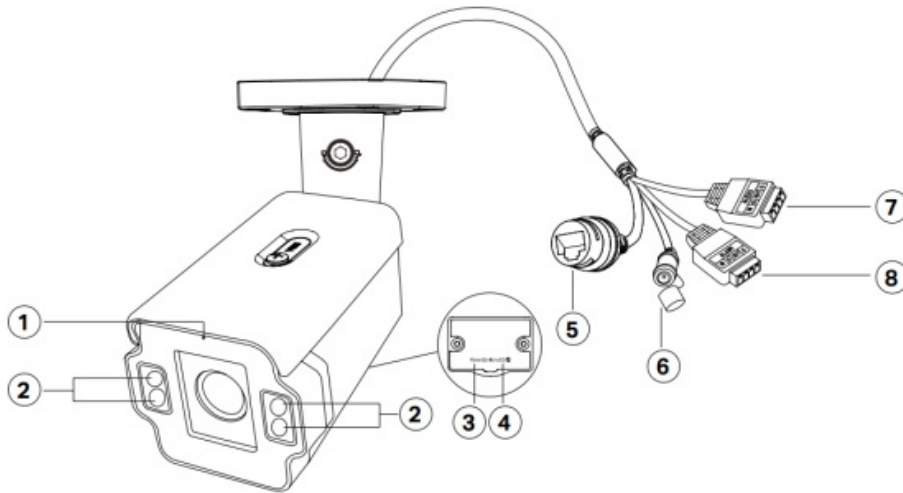

1. **Built-in Microphone**
2. **IR LED × 4**
3. **Reset:** Unfasten the two fixed screws to remove the cover. Press for 5 seconds to reset the camera to factory settings.
4. **microSD Card Slot:** Unfasten the two fixed screws to remove the cover. Insert a microSD card for local storage. Initialize the SD card via VIGI app or other management tools before recording videos.
5. **RJ45 Network Interface** (supports PoE)
6. **Power Supply Interface**
7. **Audio Interface**
8. **Alarm Interface**

InSight S345-4G

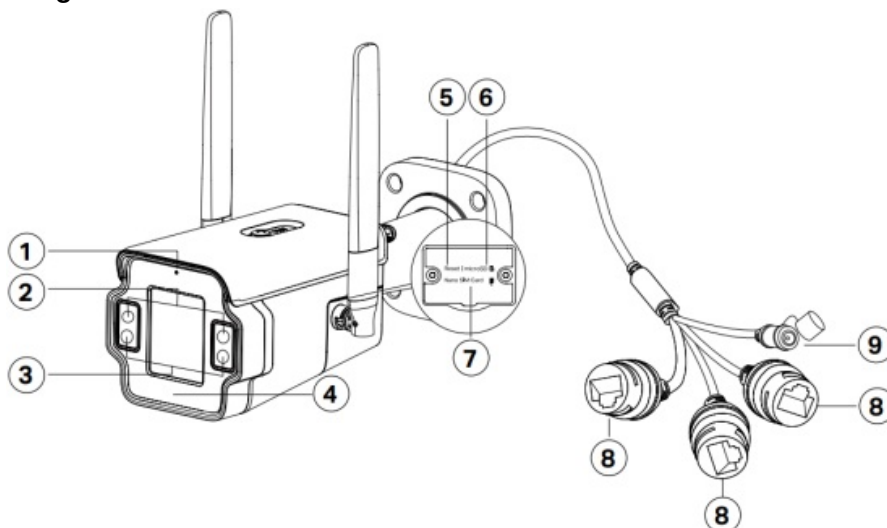

1. **Built-in Microphone**
2. **IR LED × 2**
3. **White LED × 2**
4. **Status LED**
5. **Reset:** Unfasten the two fixed screws to remove the cover. Press for 5 seconds to reset the camera to factory

settings.

6. **microSD Card Slot:** Unfasten the two fixed screws to remove the cover. Insert a microSD card for local storage. Initialize the SD card via VIGI app or other management tools before recording videos.
7. **Nano SIM Card Slot:** Unfasten the two fixed screws to remove the cover. Insert a nano SIM card for 4G network.
8. **RJ45 Network Interface**
9. **Power Supply Interface**

Status LED Explanation

Status	Description
Solid red	Starting up
Blink red and green	Connecting to network, mobile data used up or 4G network signal unstable
Blink green	SIM card not detected
Solid green	Connected to network, or Ethernet cable plugged in (for wired connection)
Blink red	Mobile data disabled, or Ethernet cable unplugged (for wired connection)
Blink red quickly	Camera resetting
Blink green quickly	Camera updating

InSight S385PI

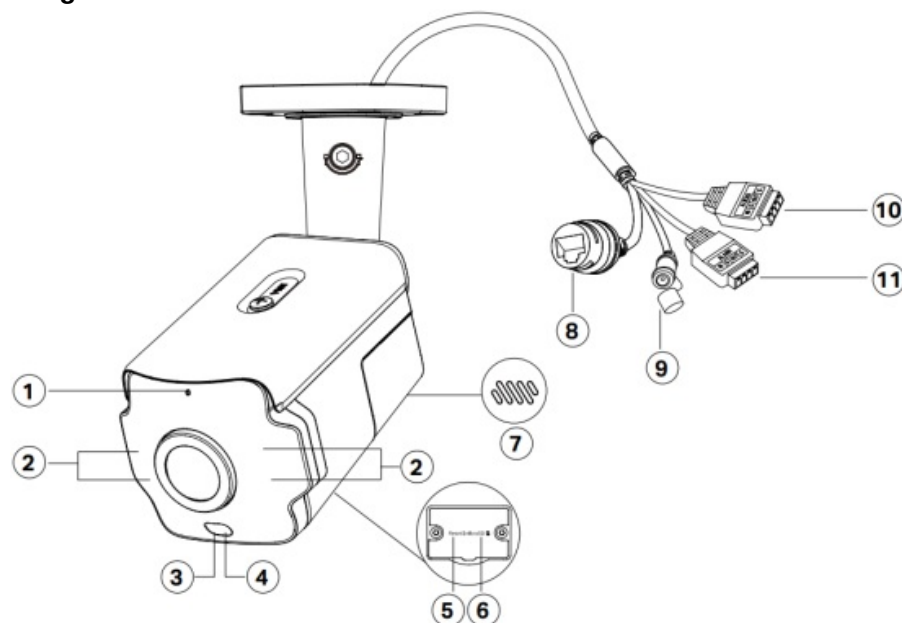

1. **Built-in Microphone**
2. **IR LED × 4**
3. **Red LED**
4. **Blue LED**
5. **Reset:** Unfasten the two fixed screws to remove the cover. Press for 5 seconds to reset the camera to factory settings.
6. **microSD Card Slot:** Unfasten the two fixed screws to remove the cover. Insert a microSD card for local

storage. Initialize the SD card via VIGI app or other management tools before recording videos.

7. **Speaker**

8. **RJ45 Network Interface** (supports PoE)

9. **Power Supply Interface**

10. **Audio Interface**

11. **Alarm Interface**

Chapter 2 Installation

Safety First

- Make sure your power supply matches your camera. The power source should comply with Power Source Class 2 (PS2) or Limited Power Source (LPS) of IEC 62368-1.
- Make sure that the wall is strong enough to withstand 4 times the weight of the camera and mounting bracket.
- Make sure the device is not connected to a power source when mounting and connecting cables.
- If you are uncertain or uncomfortable performing the installation, consult a qualified electrician.

Mount the Camera

1. Get ready

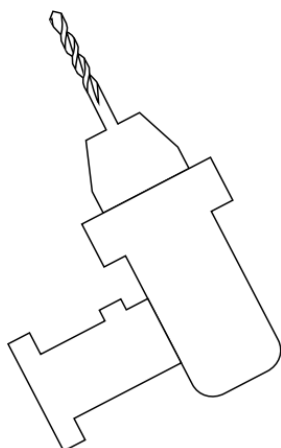
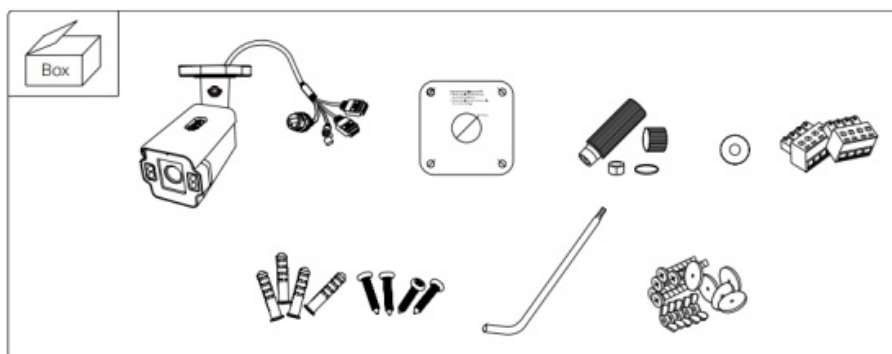

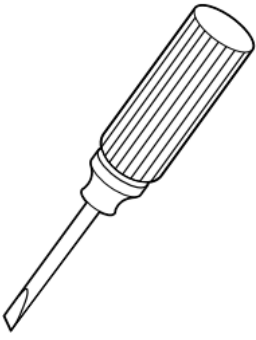

microSD Card (optional)

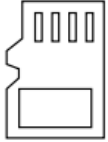

Nano SIM Card (For 4G Camera)

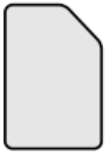

Waterproof Tape (optional)

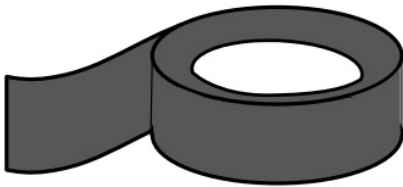

Pole Mounting Brackets (optional)

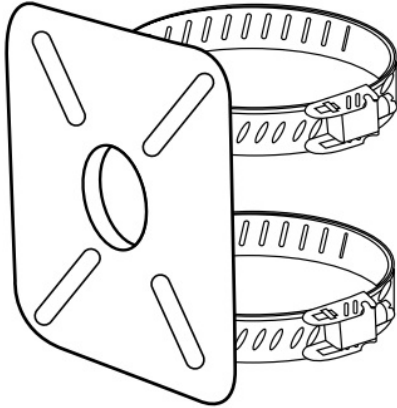

2. Choose the mounting method.

Option 1

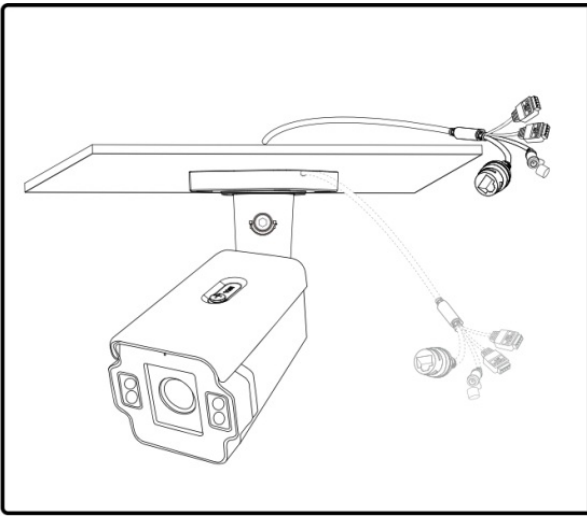

Option 2

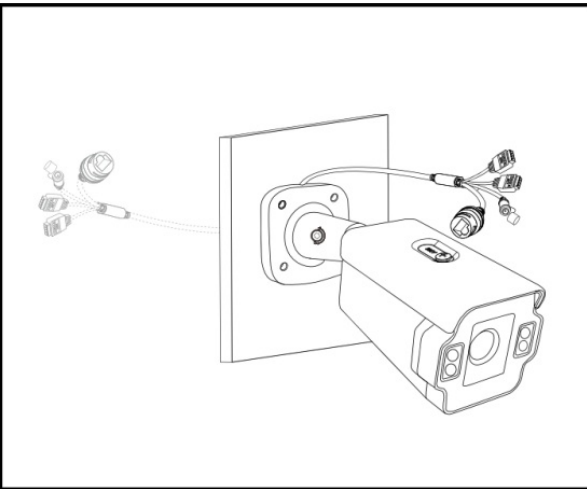

Option 3

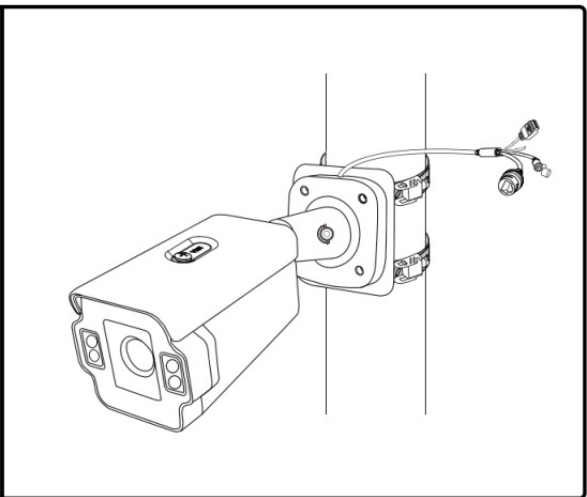

3. Mount the camera according to your desired mounting method.

- **Option 1 Ceiling Mounting**

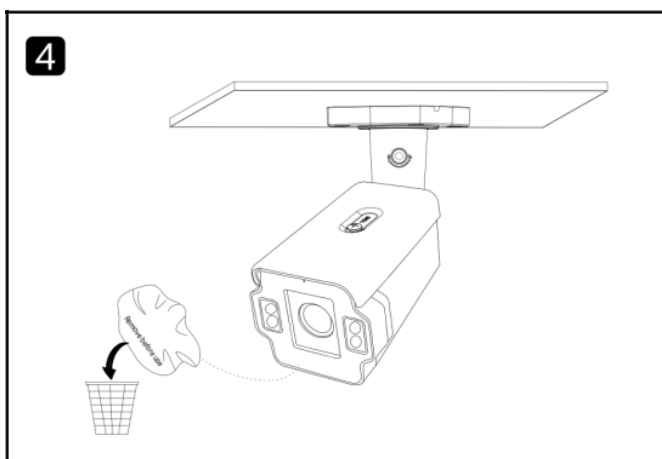
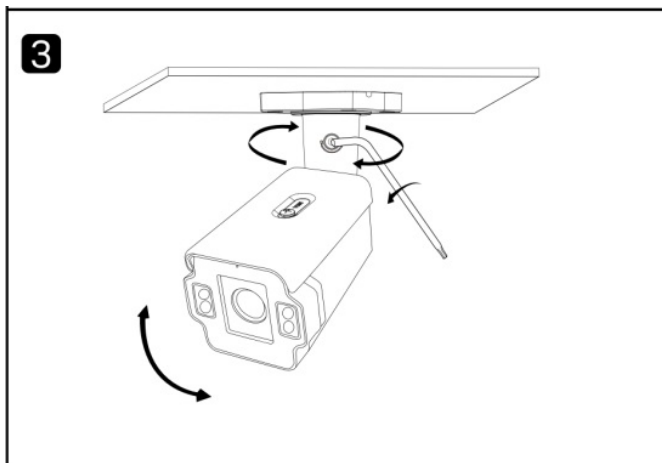
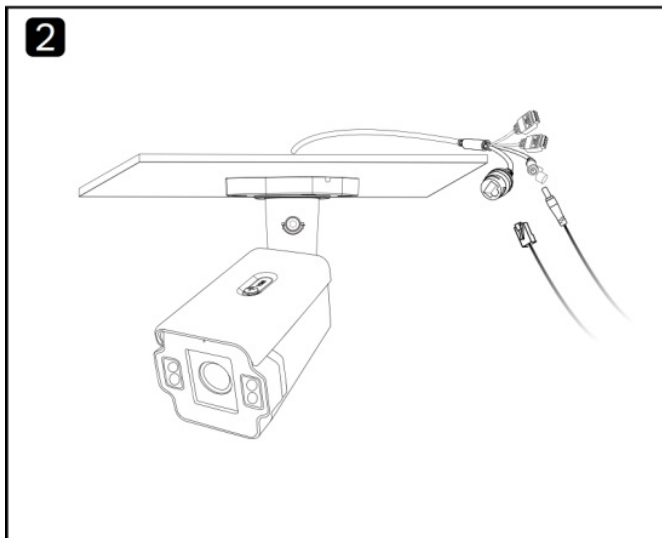
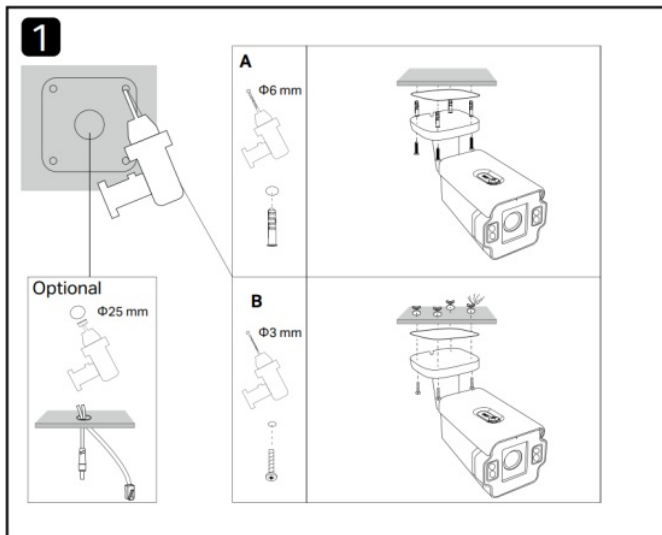

- Option 2 Wall Mounting

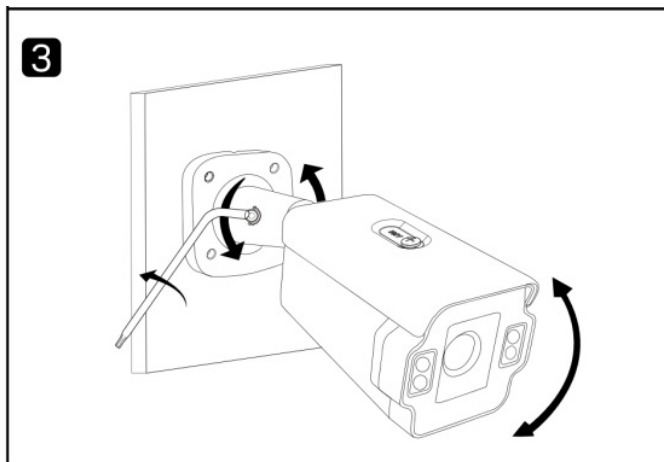
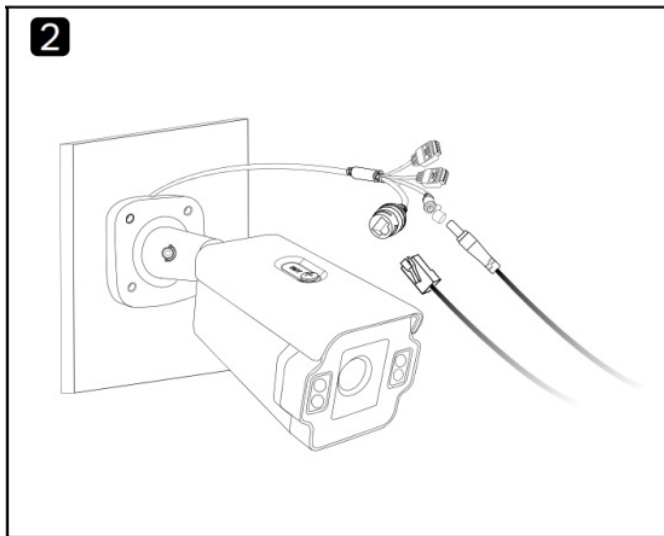
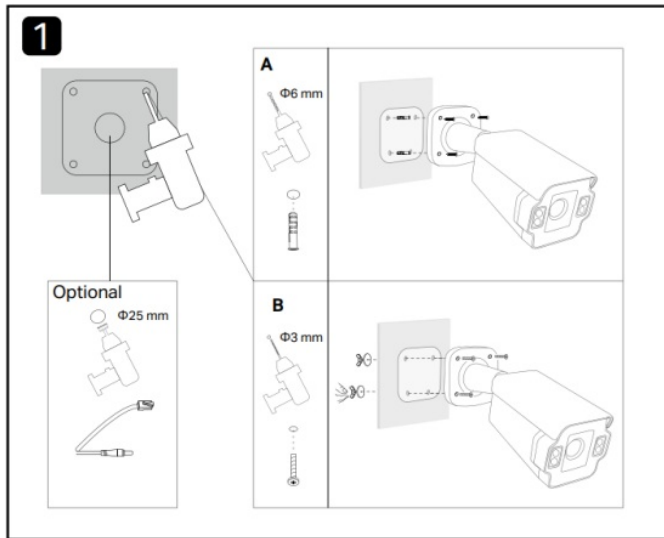

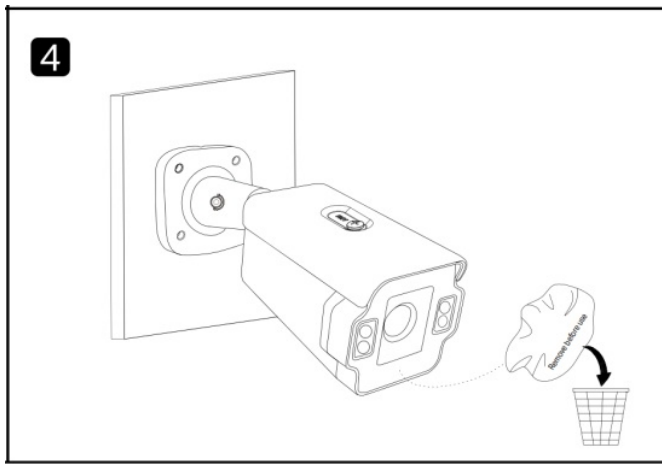

• **Option 3 Pole Mounting**

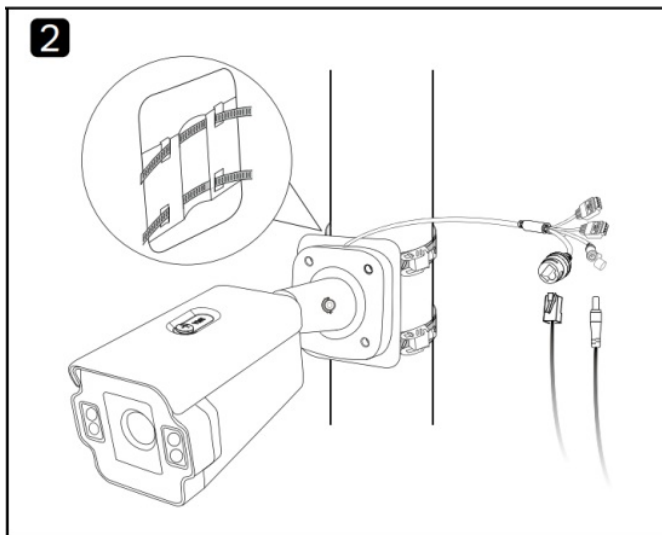
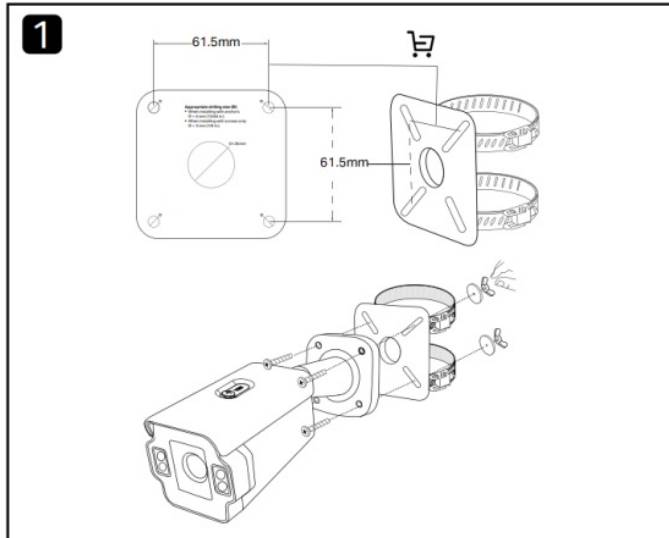

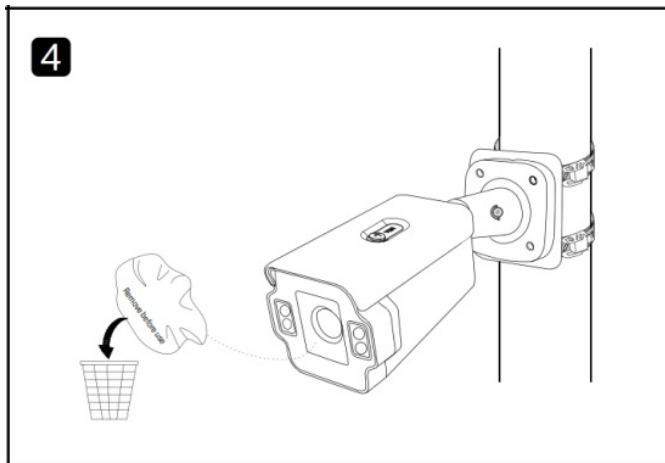
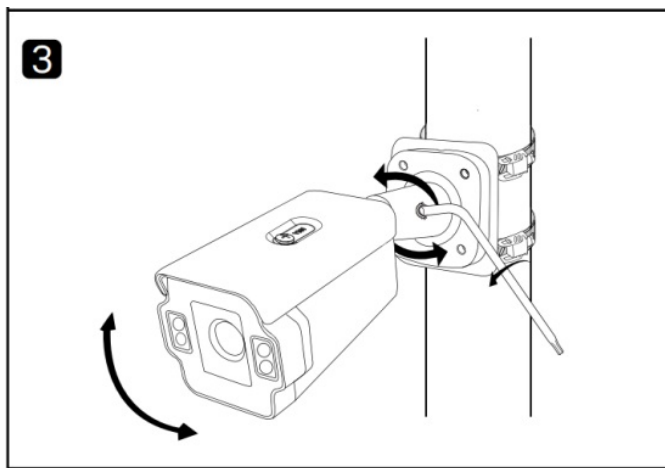

Install microSD Card (Optional)

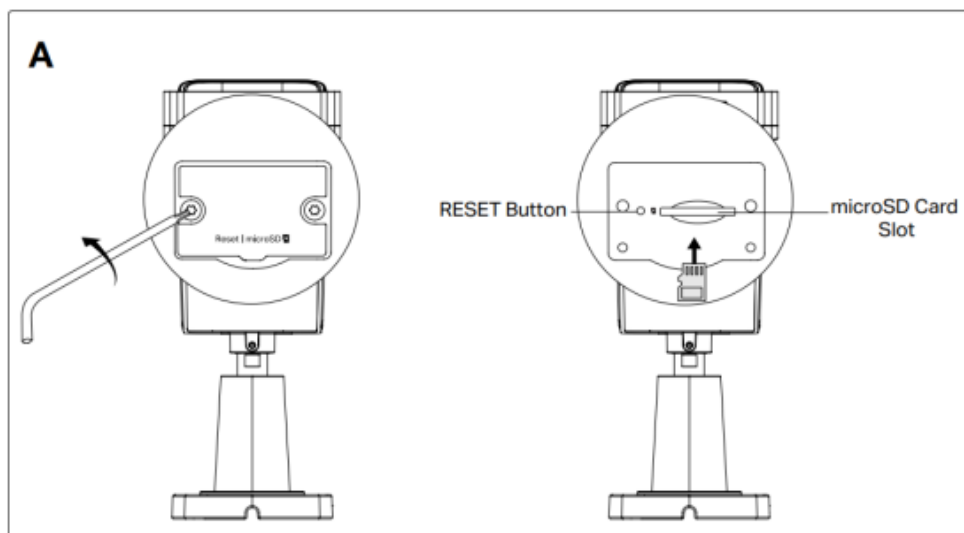

(For 4G Camera)

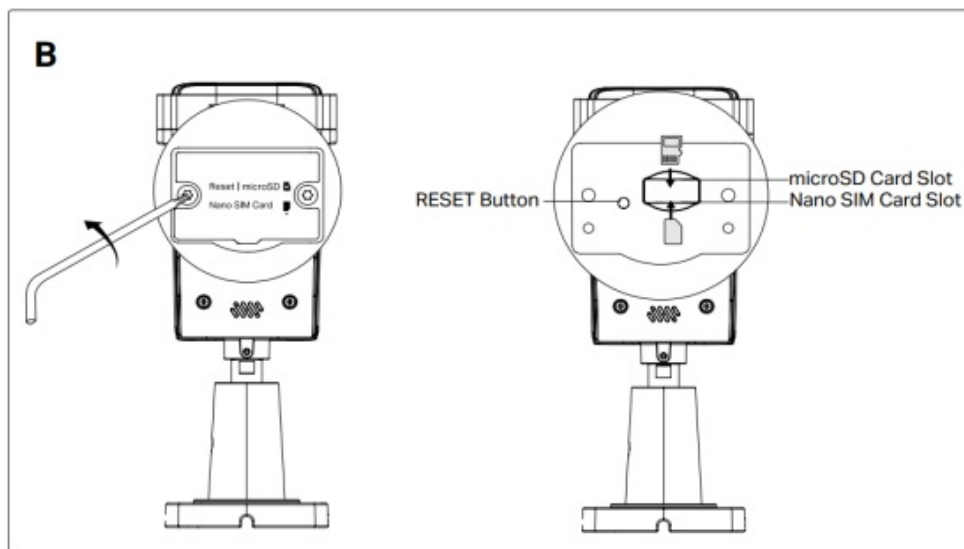

Connect Alarm/Audio Device (Optional)

Connect Alarm Device

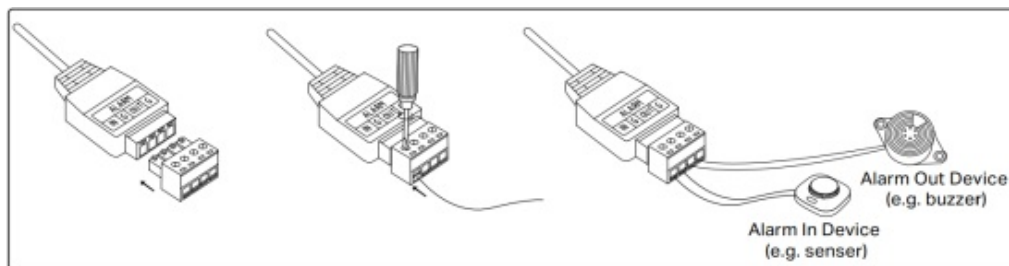

Scan for More Details



Connect Audio Device

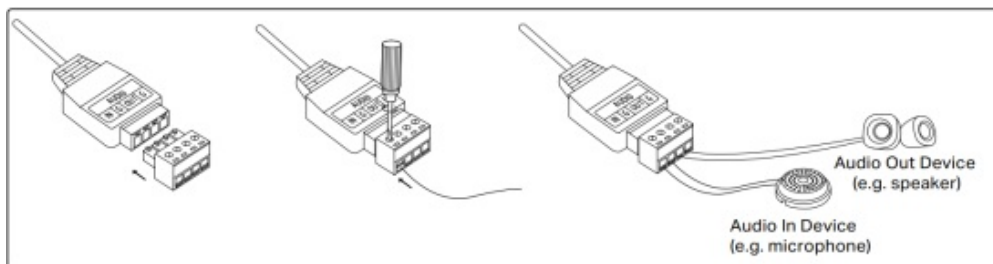

Scan for More Details



Note: It is recommended to waterproof the alarm/audio interface even if no alarm/audio equipment is connected.

Waterproof (Optional)

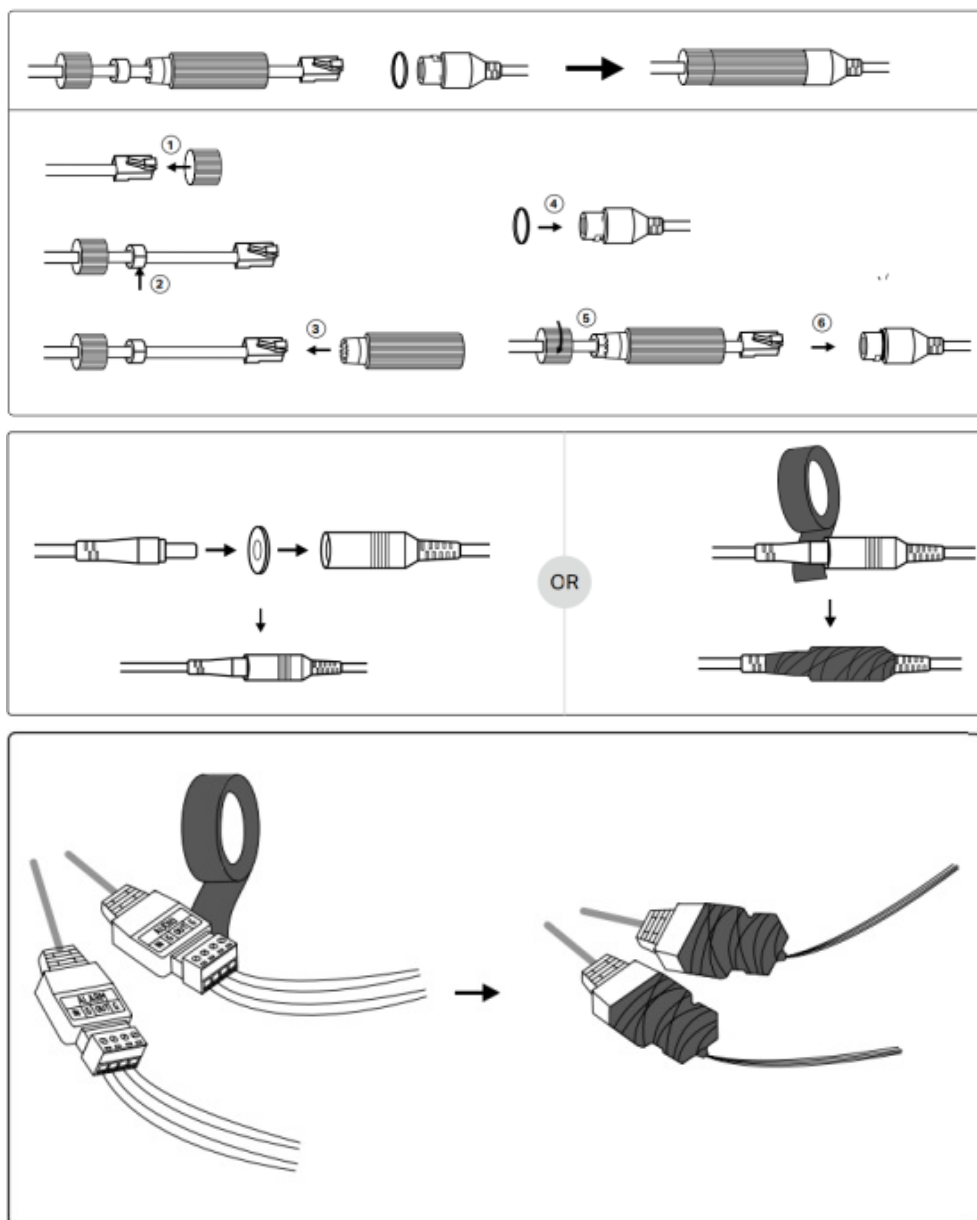

Chapter 3 Configuration

For Wired Camera

Here is a typical network topology. You can add and manage your devices via any of the methods.

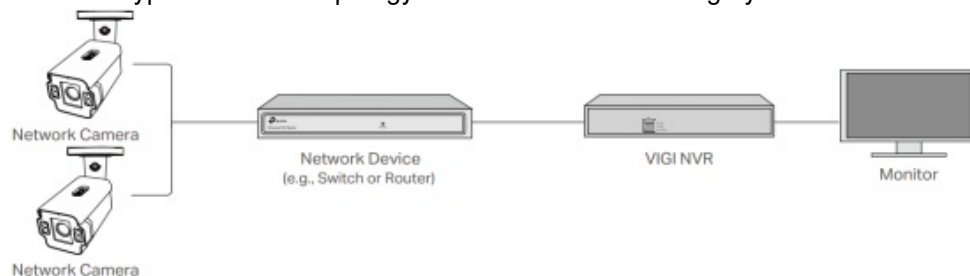

Via NVR

The camera works with an NVR for easier batch access and management. Here we use a VIGI NVR as an example.

1. Connect your cameras to the same network as your NVR.
2. Power on your cameras with the PoE power supply or an external power supply.
3. Right click on the Live View screen on the monitor, and click Add Camera.

4. Select your camera and click + to add your camera directly. If you have disabled Plug and Play on your NVR, create a password or use a preset password for your camera.

Note:

If you are using your cameras with other NVR brands, follow the steps below.

1. Power on your cameras and connect them to the network.
2. Activate the cameras using the TP-Link **VIGI** app or web management page.
3. Refer to the NVR's User Manual to add cameras.

Via VIGI App

You can remotely view live video, manage device, and get instant alerts via **VIGI** app.

1. Download and install the latest TP-Link VIGI app.



or



2. Open the app and log in with your TP-Link ID. If you don't have an account, sign up first.
3. Tap the + button on the top right and follow the app instructions to add your NVR.

Via Web

You can view live video and modify camera settings via a web browser.

1. Find the camera's IP address on your router's client page.
2. On your local computer, open a web browser and enter [\(https://camera'sIPAddress\)](https://camera'sIPAddress).
(<https://192.168.0.60.by.default>).
3. Select your Country/Region and Time Zone.
4. Set a password to activate the camera.

For 4G Camera

Here is a typical network topology. You can add and manage your devices via any of the methods.

Note: When using InSight S345-4G to provide network connections to two cameras simultaneously, ensure that its uplink bandwidth is at least 22 Mbps.

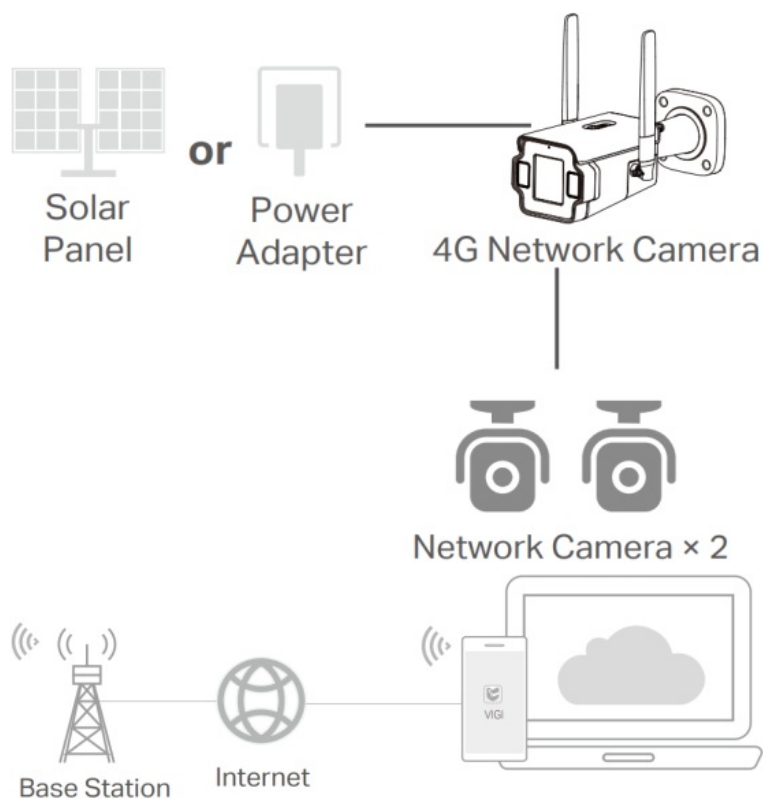

Via VIGI App

1. Download and install the latest TP-Link VIGI app.



or



2. Insert a Nano SIM card into the SIM card slot.
3. Connect the camera to the power socket via the provided power adapter or the solar panel, and wait until the LED is solid green.
4. Open the app and log in with your TP-Link ID. If you don't have an account, sign up first.
5. Tap the + button on the top right and follow the app instructions to add your NVR.

Note:

1. It is recommended that you insert a micro SD card for local storage. And initialize SD card via VIGI app or other management tools before recording videos.
2. For more detailed instructions, refer to the user guides at <https://www.tp-link.com/support/>

Via Web (for Wired Connection)

If you connect your camera to the network via an Ethernet cable, you can also access and manage your cameras via a web browser.

1. Find the camera's IP address on your router's client page.
2. On your local computer, open a web browser and enter <https://camera's.IPaddress.>
(<https://192.168.0.60.by.default>).
3. Select your Country/Region and Time Zone.
4. Set a password to activate the camera.

Via NVR (for Wired Connection)

If you connect your camera to the network via an Ethernet cable, you can also access and manage your cameras via NVR. Before you start, make sure the NVR is working properly.

1. Right click on the Live View screen and click Add Camera.
2. Select your camera and click + to add your camera directly. If you have disabled Plug and Play on your NVR, create a password or use a preset password for your camera.

Note:

If you are using your cameras with other NVR brands, refer to the NVR's User Manual to add cameras.

Appendix FAQ

User Guide

S345ZI, S345-4G, S385PI, VIGI InSight S3 Series Bullet Network Camera, VIGI InSight S3 Series, Bullet Network Camera, Network Camera, Camera

References

- [User Manual](#)

<

div class="57be77cde1a6ddba353152d58844f9cf" data-index="3" style="float: none; margin:10px 0 10px 0; text-align:center;">

[Manuals+](#), [Privacy Policy](#)

This website is an independent publication and is neither affiliated with nor endorsed by any of the trademark owners. The "Bluetooth®" word mark and logos are registered trademarks owned by Bluetooth SIG, Inc. The "Wi-Fi®" word mark and logos are registered trademarks owned by the Wi-Fi Alliance. Any use of these marks on this website does not imply any affiliation with or endorsement.