



TP-Link UE306 USB to Ethernet Network Adapter User Guide

[Home](#) » [tp-link](#) » TP-Link UE306 USB to Ethernet Network Adapter User Guide 📄

Contents

- [1 TP-Link UE306 USB to Ethernet Network Adapter User Guide](#)
- [2 ATTENTION](#)
- [3 Recycling](#)
- [4 Using the Adapter](#)
 - [4.1 Works with Nintendo Switch \(Supported by UE306 ONLY\)](#)
- [5 LED Explanation](#)
- [6 FAQ's](#)
- [7 Read More About This Manual & Download PDF:](#)
- [8 Documents / Resources](#)
 - [8.1 References](#)

TP-Link UE306 USB to Ethernet Network Adapter User Guide



ATTENTION

- When a product has a power button, the power button is one of the ways to shut off the product; when there is no power button, the only way to completely shut off power is to disconnect the product or the power adapter from the power source.
- Do not attempt to disassemble, repair, or modify the device. If you need service, please contact us.
- Keep the device away from water, fire, humidity, or hot environments.

Recycling

This product bears the selective sorting symbol for Waste electrical and electronic equipment (WEEE). This means that this product must be handled pursuant to European directive 2012/19/EU in order to be recycled or dismantled to minimize its impact on the environment.

User has the choice to give their product to a competent recycling organization or to the retailer when he buys new electrical or electronic equipment. TP-Link hereby declares that the device is in compliance with the essential requirements and other relevant provisions of directives 2014/30/EU, 2014/35/EU, 2009/125/EC, 2011/65/EU, and (EU)2015/863.

The original EU Declaration of Conformity may be found at <https://www.tp-link.com/en/support/ce/>

TP-Link hereby declares that the device is in compliance with the essential requirements and other relevant provisions of the Electromagnetic Compatibility Regulations 2016 and Electrical Equipment (Safety) Regulations 2016. The original UK Declaration of Conformity may be found at <https://www.tp-link.com/support/ukca/>



For technical support, replacement services, the user guide, and more information, please visit <https://www.tp-link.com/support>, or simply scan the QR code.

Using the Adapter

This adapter supports Plug and Play feature. Plug in and wait for seconds. Then this adapter is ready to use.

UE330, UE300 and UE200:

For Windows 7/8/8.1, please click to install a driver if prompted to do so. For Windows 7, please click CANCEL if prompted **"The program might not have installed correctly"** after installation.

For Mac OS X 10.8 and older versions, please download and install a driver from our official website www.tp-link.com, and search for the model number.

UE300C and UE306:

For Windows 7 and Mac OS X 10.9 to 10.15, please download and install a driver from our official website www.tp-link.com, and search for the model number. UE330, UE300 and UE200:

For Windows 7/8/8.1, please click to install a driver if prompted to do so. For Windows 7, please click CANCEL if prompted **"The program might not have installed correctly"** after installation.

For Mac OS X 10.8 and older version, please download and install a driver from our official website www.tp-link.com, and search for the model number.

UE300C and UE306:

For Windows 7 and Mac OS X 10.9 to 10.15, please download and install a driver from our official website www.tp-link.com, and search for the model number.

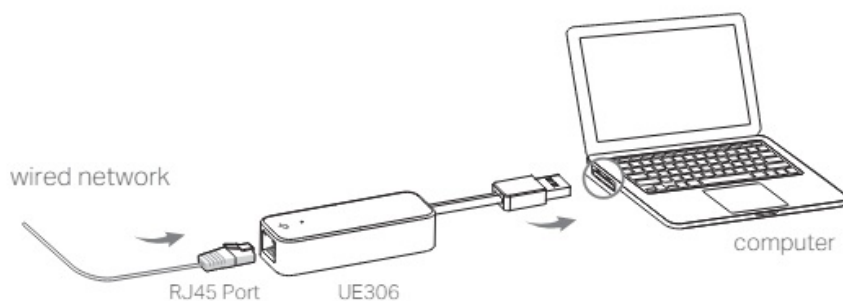

Works with Nintendo Switch (Supported by UE306 ONLY)

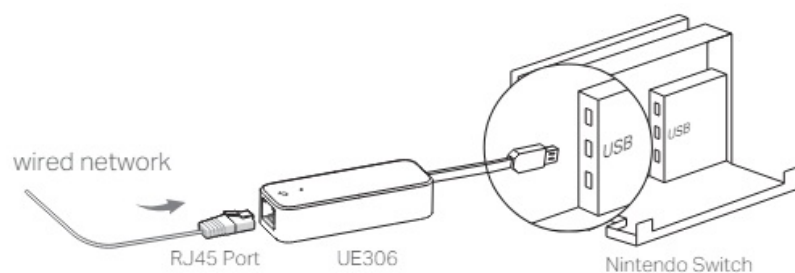

LED Explanation

LED (for UE330)	Status	Indication
White	On	The adapter is properly connected and the hub is ready to use
Yellow	On	The Ethernet cable is properly connected
Green	Flashing	Network data is being transferred

LED (for UE300C, UE300, UE200, UE306)

White	On	Both the adapter and Ethernet cable are properly connected
White	Flashing	Network data is being transferred

FAQ's

Does a USB to Ethernet adapter need drivers?

Use this adapter to instantly connect to a 10/100 Mbps network from the USB port on your desktop or laptop computer. Note: The driver software must be installed before you connect the adapter.

Does a USB to Ethernet adapter work both ways?

It is an active adapter – it contains a single “USB to Ethernet” chip which acts as a standard USB device on one end and as a standard Ethernet controller on the other end; it receives Ethernet frames and sends them over USB in a format that the driver will understand, and vice versa.

What is USB to Ethernet adapter used for?

USB Ethernet Adapters For Connecting Your Computer To The Internet. Ethernet Adapters allow you to connect your laptop directly to a Wi-Fi router or cable modem was one of the first to go. Indeed, laptops come with a Wi-Fi option, but you'll get a faster and more reliable connection by using a cable.

Does USB Ethernet adapter affect Internet speed?

Getting a faster adapter won't make your network faster if its speed is limited by your internet connection or other hardware on the network.

What is the transfer speed of the USB to Ethernet adapter?

USB 2.0 speeds are limited to 480 Mbps, so a USB 2.0 to Ethernet adapter has a maximum speed of 480 Mbps while a USB 3.0 to Ethernet adapter is usually limited to 1000 Mbps.

How do I know if my USB Ethernet adapter is working?

To check its status, right-click your computer's network adapter then select Properties. Once the adapter is enabled, there would be a This device is working properly notification if the adapter is working properly.

How does the Ethernet adapter work?

The adapters (at least two) plug into your wall sockets and use Ethernet cables to connect to your router at one end and your device at the other (TV, games console, PC whatever it may be). This provides a physical connection between your device and router as opposed to the wireless connection provided by your Wi-Fi.

Can I use USB to connect to the Ethernet cable?

Image result In situations like these, if there is a wired Ethernet network available you can connect to it using the USB-A or USB-C port on your laptop and a USB to Gigabit Ethernet Adapter. Plug the adapter into your laptop's USB port and use a Cat5e/6 Ethernet patch cable to connect the RJ45 end to the network.

Is USB to Ethernet stable?

Some USB-to-Ethernet adapters provide speeds that are significantly faster than a standard wireless connection or an older network card. Additionally, a wired connection is more secure, more stable, and more reliable than a wireless connection.

Is USB to Ethernet slower than Ethernet?

Depending on the cable specification, a USB or Ethernet cable can both support high data transfer speeds. In general, for the fastest speeds, USB is capable of surpassing Ethernet.

What is the difference between USB and Ethernet connection?

The main difference between USB and Ethernet is their purpose. USB is used for connecting peripherals like keyboards, mice, printers, and more while Ethernet was developed for networking or the interconnection of multiple computers with the intent of transferring information.

What USB type is Ethernet?

If you're looking for a way to connect your laptop, tablet, or phone to the internet using an ethernet cable, you can use a USB-C to Ethernet adapter.

Does Ethernet increase Internet speed?

While a number of variables determine the actual speed of a WiFi connection and an Ethernet connection, Ethernet is almost always faster than WiFi.

How fast is Ethernet data transfer?

A standard Ethernet network can transmit data at a rate of up to 10 Megabits per second (10 Mbps). Other LAN types include Token Ring, Fast Ethernet, Gigabit Ethernet, 10 Gigabit Ethernet, Fiber Distributed Data Interface (FDDI), Asynchronous Transfer Mode (ATM), and LocalTalk.

Is the Ethernet adapter wireless?

From Ethernet adapters to network interface card options and more, network adapters allow devices to connect to a local computer network through either WiFi (wireless) or Ethernet (wired) formats.

Download this PDF Link: [TP-Link UE306 USB to Ethernet Network Adapter User Guide](#)

Read More About This Manual & Download PDF:

Documents / Resources

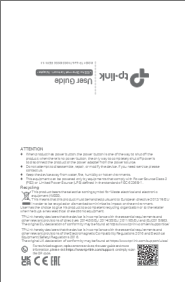
	<p>TP-Link UE306 USB to Ethernet Network Adapter [pdf] User Guide UE306 USB to Ethernet Network Adapter, UE306, USB to Ethernet Network Adapter, Ethernet Network Adapter, Network Adapter, Adapter</p>
---	---

References

- [WiFi Networking Equipment for Home & Business | TP-Link](#)
- [CE Regulatory Compliance | TP-Link](#)
- [TP-Link Product Support - Wireless Networking Equipment Support](#)
- [Regulatory Compliance | TP-Link](#)
- [User Manual](#)

[Manuals+](#), [Privacy Policy](#)

This website is an independent publication and is neither affiliated with nor endorsed by any of the trademark owners. The "Bluetooth®" word mark and logos are registered trademarks owned by Bluetooth SIG, Inc. The "Wi-Fi®" word mark and logos are registered trademarks owned by the Wi-Fi Alliance. Any use of these marks on this website does not imply any affiliation with or endorsement.