

 tp-link
**TD-W8951ND Wireless DSL
Modem Router**



tp-link TD-W8951ND Wireless DSL Modem Router Installation Guide

[Home](#) » [tp-link](#) » tp-link TD-W8951ND Wireless DSL Modem Router Installation Guide 

Contents

- [1 TP-Link TD-W8951ND Wireless DSL Modem Router](#)
- [2 Specifications](#)
- [3 Product Usage Instructions](#)
 - [3.1 Connect the Hardware](#)
 - [3.2 Configure via Web Browser](#)
 - [3.3 Tether App](#)
 - [3.4 Safety Information](#)
 - [3.5 Frequently Asked Questions](#)
- [4 Documents / Resources](#)
 - [4.1 References](#)
- [5 Related Posts](#)



TP-Link TD-W8951ND Wireless DSL Modem Router



Specifications

- **Product:** Wireless DSL Modem Router
- **Manufacturer:** TP-Link
- **Support:** <https://www.tp-link.com/support>

Product Usage Instructions

Connect the Hardware

If you don't need the phone service, follow these steps to connect the modem router:

- Connect the modem router to the phone jack using the provided phone cable.
- Ensure all necessary components are connected: Power Adapter, Phone Cable, DSL Splitter, and optional Phone.
- Turn on the modem router and wait for 2 minutes for the Power and DSL LEDs to stabilize.

Configure via Web Browser

Follow these steps to configure the modem router using a web browser:

- **Wired Connection:** Connect your computer to one of the LAN ports using an Ethernet cable
- **Wireless Connection:** Use the SSID and Wireless Password found on the product label to connect wirelessly.
- Open a web browser and enter either <http://tplinkmodem.net> or 192.168.1.1 in the address bar.
- Create a password for future logins or use 'admin' as both username and password for some routers.
- Access Quick Setup or Quick Start page to complete the initial configuration following the instructions provided.

Connect the Hardware

If you don't need the phone service, just directly connect the modem router to the phone jack with the provided phone cable, then follow steps 3 and 4 to complete the hardware connection.

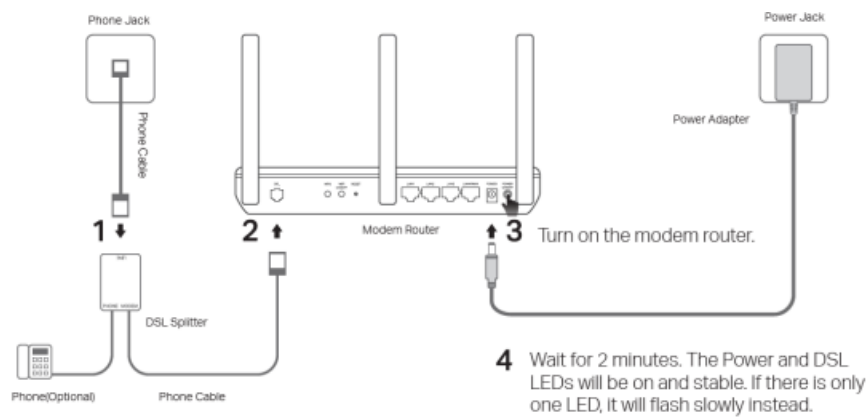

The image may differ from the actual product.

Note:

If the LED status is different, please refer to FAQ > Q2.

Configure via Web Browser

Connecting your computer to the modem router via a wired or wireless connection

Wired

Connect your computer to the LAN (or 1/2/3/4) port using an Ethernet cable.

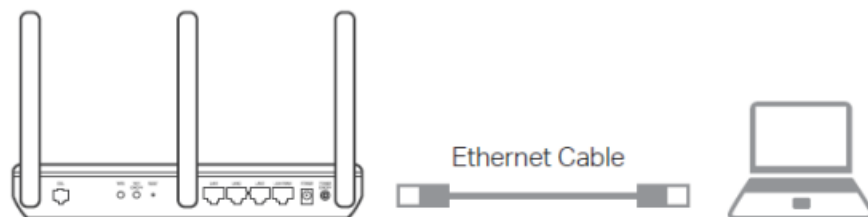

Wireless

Connect wirelessly by using the SSID (network name) and Wireless Password printed on the product label at the bottom of the modem router.

Configuring the modem router via a web browser A Launch a web browser and type in <http://tplinkmodem.net> or 192.168.1.1.

Note:

- A If the login page does not appear, please refer to FAQ.



- B Create a password for future login attempts, or use admin for both username and password for some routers.
- C Go to Quick Setup or Quick Start page and follow the step-by-step instructions to complete the initial configuration.



Now you can enjoy your internet.

Already Have a Modem?

If you already have a modem or your internet comes directly from an Ethernet wall outlet, you can switch to Wireless Router mode. Follow the steps below and set up.

1. Connect your computer to the router (LAN 1/2/3 port) via a wired or wireless connection. Note: The SSIDs (network names) and wireless password are printed on the product label.
2. Configuring the modem router via a web browser
 - A Launch a web browser and type in <http://tplinkmodem.net> or 192.168.1.1. Note: If the login page does not appear, please refer to FAQ > Q1.



- B Create a password for future login attempts, or use admin for both username and password for some routers.
3. Connect the modem to the router's WAN port via an Ethernet cable.

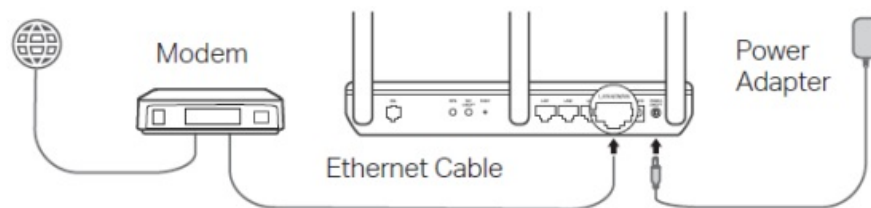

4. Go to WAN > WAN Configuration to change the WAN PHYSICAL TYPE and finish the setup.



Now you can enjoy your internet. For more advanced settings, refer to the User Guide on TP-Link's official website at www.tp-link.com.

Tether App

- The TP-Link Tether app provides a simple, intuitive way to access and manage your router.
- You can block unwelcome devices, set up Parental Controls, configure your wireless settings, and more.
- Scan the QR code to download the TP-Link Tether app from the Apple App Store or Google Play.



Note: Tether is not supported by some routers. Please check the app description before downloading.

Safety Information

- Keep the device away from water, fire, humidity, or hot environments.

- Do not attempt to disassemble, repair, or modify the device. If you need service, please contact us.
- Do not use a damaged charger or USB cable to charge the device.
- Do not use any chargers other than those recommended.
- Do not use the device where wireless devices are not allowed.
- The adapters shall be installed near the equipment and shall be easily accessible.

Please read and follow the above safety information when operating the device. We cannot guarantee that no accidents or damage will occur due to improper use of the device. Please use this product with care and operate at your own risk.

- For TP-Link Branded Products Only.
- For information about warranty period, policy, and procedures, please visit <https://www.tp-link.com/en/support>.
- THIS WARRANTY GIVES YOU SPECIFIC LEGAL RIGHTS, AND YOU MAY HAVE OTHER RIGHTS THAT VARY FROM STATE TO STATE (OR BY COUNTRY OR PROVINCE). TO THE EXTENT ALLOWED BY LOCAL LAW, THIS WARRANTY AND THE REMEDIES SET FORTH ARE EXCLUSIVE AND ARE INSTEAD OF ALL OTHER WARRANTIES, REMEDIES, AND CONDITIONS.
- TP-Link warrants the TP-Link branded hardware product contained in the original packaging against defects in materials and workmanship when used normally by TP-Link's guidelines for some period which depends on the local service from the date of original retail purchase by the end-user purchaser.

TP-Link hereby declares that the device complies with the essential requirements and other relevant provisions of directives (EU)2015/863, 2014/53/EU, 2009/125/EC, and 2011/65/EU. The original EU declaration of conformity may be found at <https://www.tp-link.com/en/support/ce/>.

Frequently Asked Questions

Q1. What can I do if the login page does not appear?

1. A1. If the computer is set to a static or fixed IP address, change the settings to obtain an IP address automatically from the modem router.
2. A2. Verify that <http://tplinkmodem.net> is correctly entered in the web browser and press Enter.
3. A3. Use another web browser and try again.
4. A4. Reboot your modem router and try again.
5. A5. Disable and enable the active network adapter.

Q2. What can I do if the LED status is not correct?

1. A1. Check your cables and make sure they are all plugged in correctly, including the telephone lines and power adapter.
 2. A2. Restore your modem router to its factory default settings.
 3. A3. Remove the DSL splitter, directly connect the modem router to the phone jack, and then reconfigure the modem router by following the instructions in this Quick Installation Guide.
 4. A4. Contact your ISP to verify if the DSL line is in good status.
 5. A5. If you have tried all the suggestions above and the problem still exists, contact our Technical Support.
- Q3. What can I do if I cannot access the internet?

6. A1. Make sure the telephone and Ethernet cables are plugged in correctly.
7. A2. Try to log in to the web management page of the modem router using the default address at <http://tplinkmodem.net>. If you can, try the following answers. If you cannot, change your computer to obtain an IP address automatically from the modem router.
8. A3. Consult your ISP and make sure all the VPI/VCI (or VLAN ID), Connection Type, username, and password are correct. If they are not, replace them with the correct settings and try again.
9. A4. Restore the modem router to its factory default settings and reconfigure the modem router by following the instructions in this Quick Installation Guide.
10. A5. If you have tried all the suggestions above and the problem still exists, contact our Technical Support.

Q4. What can I do if I forget my password?

Web management page password:

A. Refer to FAQ > Q5 to reset the router, and then create a password for future login attempts, or use admin for both username and password for some routers.

Wireless network password:

1. A1. The default Wireless Password/PIN is printed on the product label of the modem router.
2. A2. If the default wireless password has been changed, log in to the web management page of the router to retrieve or reset your wireless password.

Q5. How do I restore the modem router to its factory default settings?

1. A1. With the modem router powered on, press and hold down the RESET button of the modem router until there is an obvious change of LEDs, and then release the button.
2. A2. Log in to the web management page of the modem router and go to the system management page to restore the modem router.

Q7: What should I do if the login page does not appear when configuring via web browser?

If the login page does not appear, try the following troubleshooting steps:

1. Ensure you have entered the correct IP address (<http://tplinkmodem.net> or 192.168.1.1).
2. Check your network connection.
3. Clear your browser cache and cookies.

Documents / Resources

	tp-link TD-W8951ND Wireless DSL Modem Router [pdf] Installation Guide TD-W8951ND, TD-W8951ND Wireless DSL Modem Router, Wireless DSL Modem Router, DSL Modem Router, Modem Router, Router
-------------------------------------------------------------------------------------	--------------------------------------------------------------------------------------------------------------------------------------------------------------------------------------------------------------

References

- [🔗 TP-Link Nederland – Wi-Fi Netwerkkapparatuur voor Thuis & Bedrijfsomgevingen](#)
- [🌐 Trying to configure the Modem? | TP-Link](#)
- [🔗 TP-Link Australia - WiFi Networking Equipment for Home & Business](#)

- [!\[\]\(fd4127b9e2af37bd6ea0fa06afa8e6d8_img.jpg\) TP-Link France – Un meilleur WiFi partout](#)
- [!\[\]\(3278d6283d12f18012b5aa7d40747611_img.jpg\) TP-Link Portugal - Equipamento Rede WiFi para Casa e Escritório](#)
- [!\[\]\(bb96b32142ec45f72f12316beae3ef61_img.jpg\) TP-Link Deutschland - Netzwerklösungen für Privat- und Businessanwender](#)
- [!\[\]\(a75d0d7d1ac0ea815a0c027a77b137d5_img.jpg\) Support | TP-Link](#)
- [!\[\]\(adab168ecea4e2ae40993afba3fcd26e_img.jpg\) TP-Link España - Equipos de red Wi-Fi para el hogar y para empresas](#)
- [!\[\]\(e95ea1a0e297340f96c3d715d76d8c23_img.jpg\) Support | TP-Link](#)
- [!\[\]\(0e0cdd76cf8fb3c858658faf72d7f324_img.jpg\) Support | TP-Link](#)
- [!\[\]\(c7bdebfc2a52eab4f6683b0c1c0c28d2_img.jpg\) TP-Link](#)
- [!\[\]\(8a5c092736ceaf7cfeed23b17ea5e6ff_img.jpg\) CE Regulatory Compliance | TP-Link](#)
- [!\[\]\(dd896e8effa212be4a7431ac3e5bf510_img.jpg\) Support | TP-Link](#)
- [!\[\]\(1136f3a14b3ba5842784adf33e611db1_img.jpg\) Support | TP-Link](#)
- [!\[\]\(d536ae100fbef949d5488b8fe23458f5_img.jpg\) TP-Link Norway - WiFi Networking Equipment for Home & Business](#)
- [!\[\]\(ca07eb06779edef206c13bdfc2c41b40_img.jpg\) Support | TP-Link](#)
- [!\[\]\(7e7914364faa22e4d6649c877c7e723a_img.jpg\) Support | TP-Link](#)
- [User Manual](#)

[Manuals+](#), [Privacy Policy](#)

This website is an independent publication and is neither affiliated with nor endorsed by any of the trademark owners. The "Bluetooth®" word mark and logos are registered trademarks owned by Bluetooth SIG, Inc. The "Wi-Fi®" word mark and logos are registered trademarks owned by the Wi-Fi Alliance. Any use of these marks on this website does not imply any affiliation with or endorsement.