



tp-link RV10 Plus Robot Vacuum and Mop User Manual

[Home](#) » [tp-link](#) » tp-link RV10 Plus Robot Vacuum and Mop User Manual 



User Manual
Robot Vacuum & Mop
+ Smart Auto-Empty Dock

Setup Videos

Scan QR code or visit



<https://www.tp-link.com/support/setup-video/#robot-vacuum>

Contents

- [1 Overview](#)
- [2 Auto-Empty Dock](#)
- [3 Documents / Resources](#)
 - [3.1 References](#)
- [4 Related Posts](#)

Overview

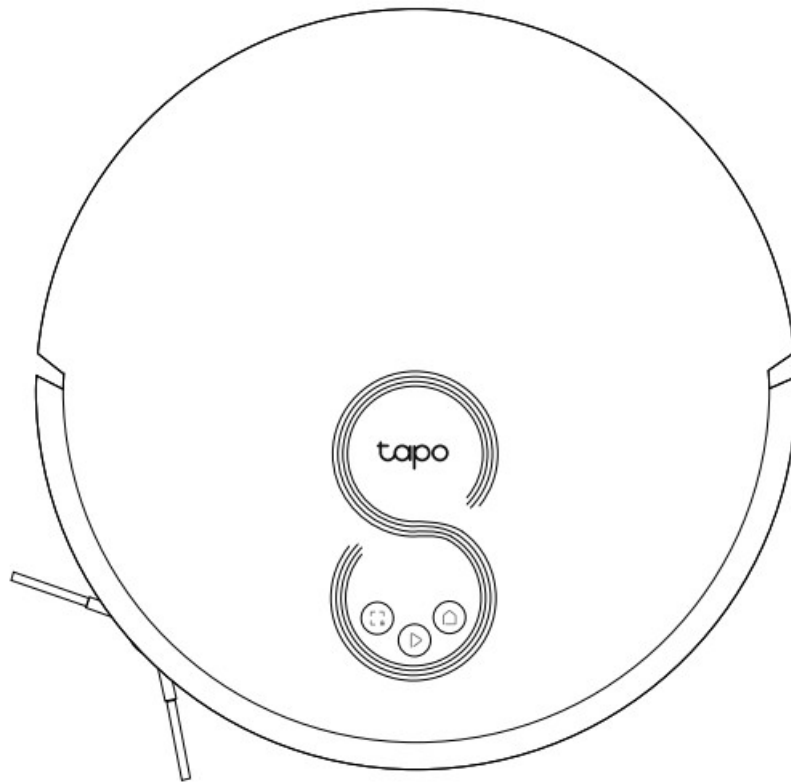

Power/Clean

- Press once: Start/pause cleaning.
- Press and hold for 5 seconds: Turn on/off the robot vacuum.
- For the first use, slide the power switch from OFF to ON to turn on.



Dock

- Return to the dock to charge.
- Empty the bin when docked.



Spot Cleaning/Child Lock

- Press once: Start spot cleaning.
- Press and hold for 5 seconds: Turn on/off the child lock.



Combination Button

- Press and hold simultaneously for 5 seconds:
Enter setup mode to configure network.
- Press and hold simultaneously for 10 seconds:

Restore to factory default settings.



LED

- Red: Battery level < 20%; Error
- Orange: Battery level between 20% and 80%
- Green: Battery level > 80%

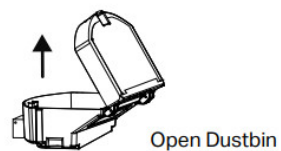
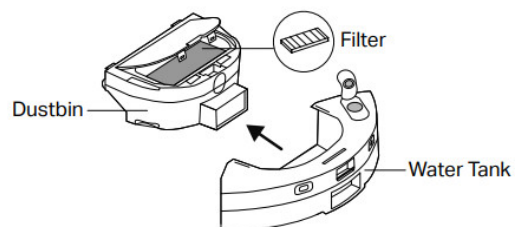
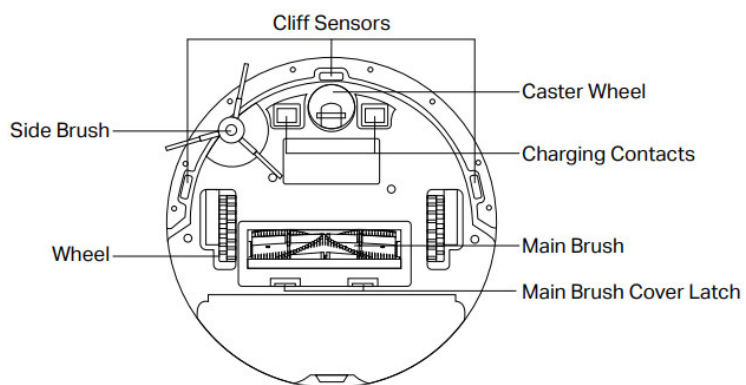
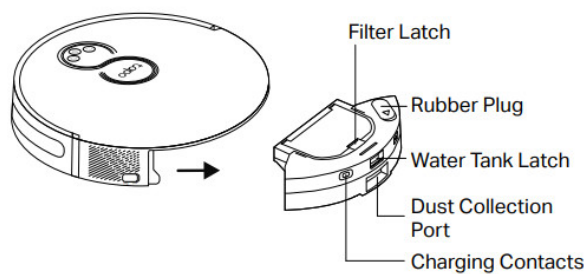
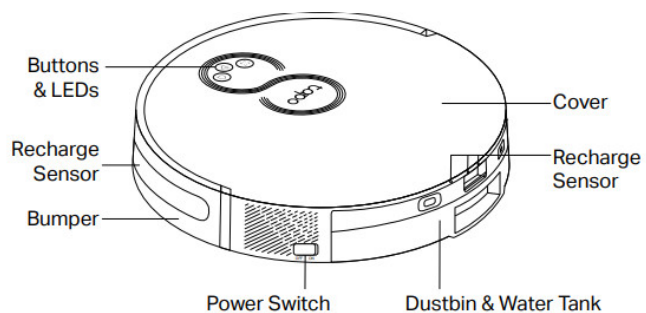

Auto-Empty Dock

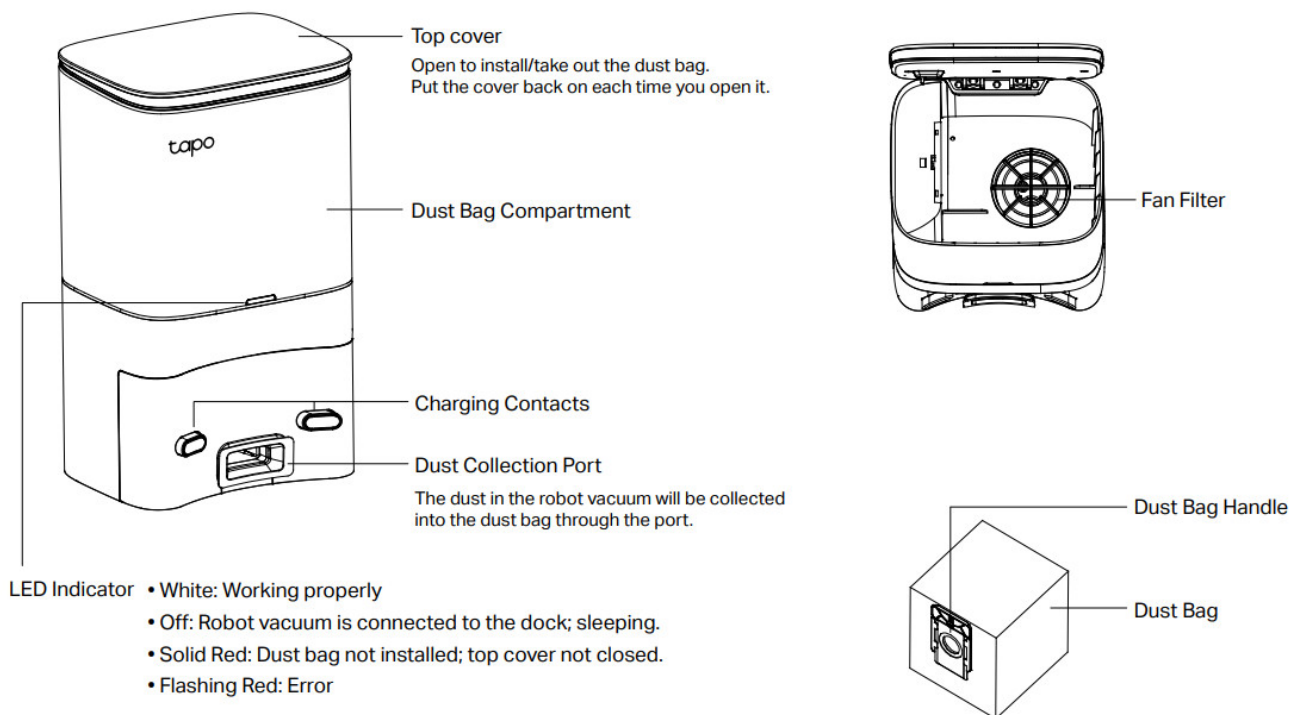

Position the Dock

Place the dock on a level surface, flat against a wall, without obstacles within 1.5m (4.9ft) in front and 0.5m (1.6ft) on left and right.

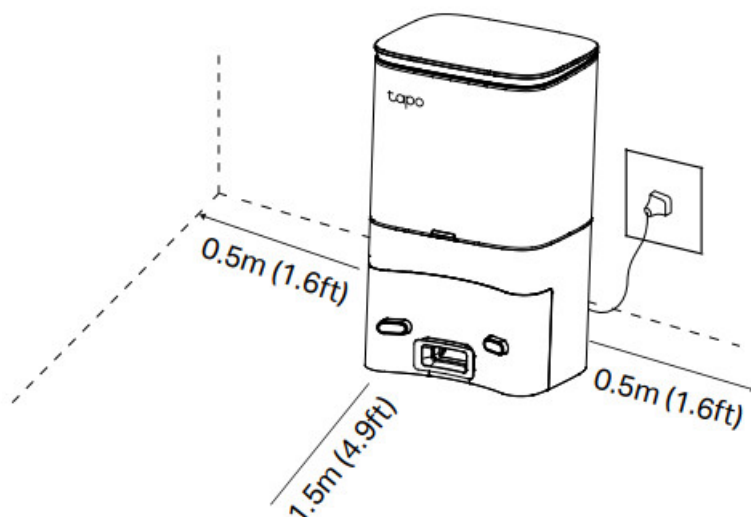

Notes

- To ensure a better user experience, make sure the area is with good Wi-Fi signal.
- Do not place it in direct sunlight. Ensure the area around the dock is free of clutter to improve docking performance.
- To prevent the risk of your robot vacuum falling downstairs, ensure that the dock is placed at least 1.2m (4 ft) away from stairs.
- Always keep the dock powered on, otherwise the robot vacuum will not automatically return. And do not move the dock frequently.
- Place a waterproof pad to prevent the mop from wetting the floor when the robot vacuum is being charged.

Remove Protective Strip

Remove the protective strips on both sides of the front bumper.

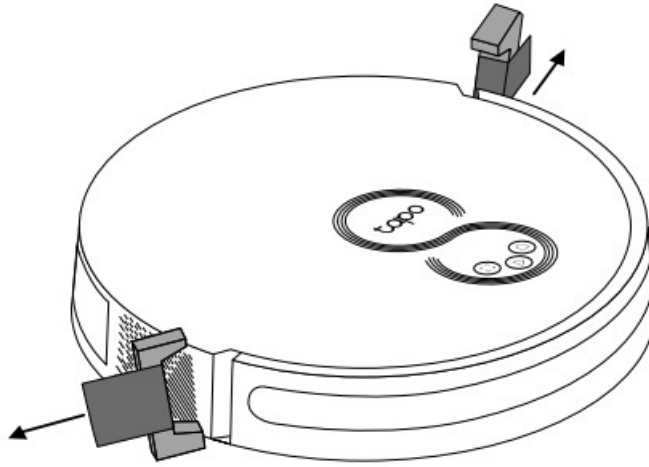

Remove Protective Film

Remove the protective film on the front bumper.

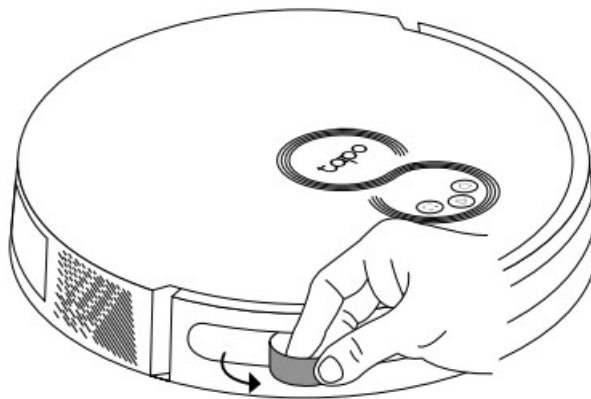

Power On and Charge

1. Slide the power switch from OFF to ON to turn on your robot vacuum.

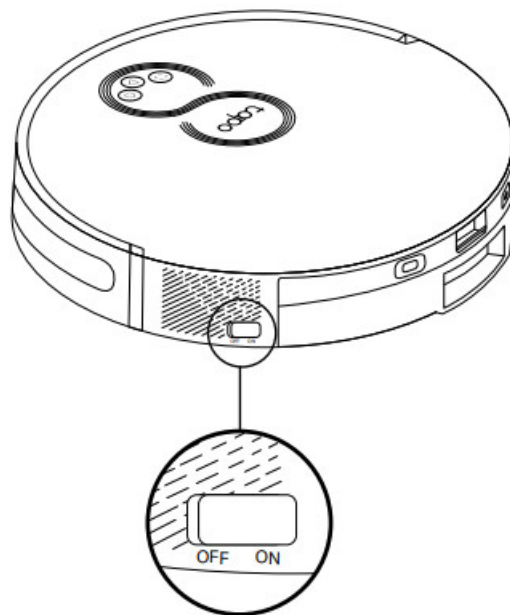

2. Place the robot vacuum on the charging dock or tap to send it back to the dock to charge. It will return to the dock at the end of a cleaning job and whenever it needs to recharge.

Notes

- When the LED of the charging dock flashes 3 times and then goes out, the charging will begin.

- We recommend that you charge the robot vacuum fully for about 4 hours prior to starting the first cleaning job.
- If the robot vacuum is paused for 10 minutes, it will automatically enter sleep mode and the cleaning job will be canceled.

Download the Tapo App and Connect to Wi-Fi

1. Download the Tapo app from the App Store or Google Play, then log in.



<https://www.tp-link.com/support/setup-video/#robot-vacuum>

2. Open the Tapo app, tap + icon, and select your model.

Follow the step-by-step instructions to easily set up your robot vacuum.

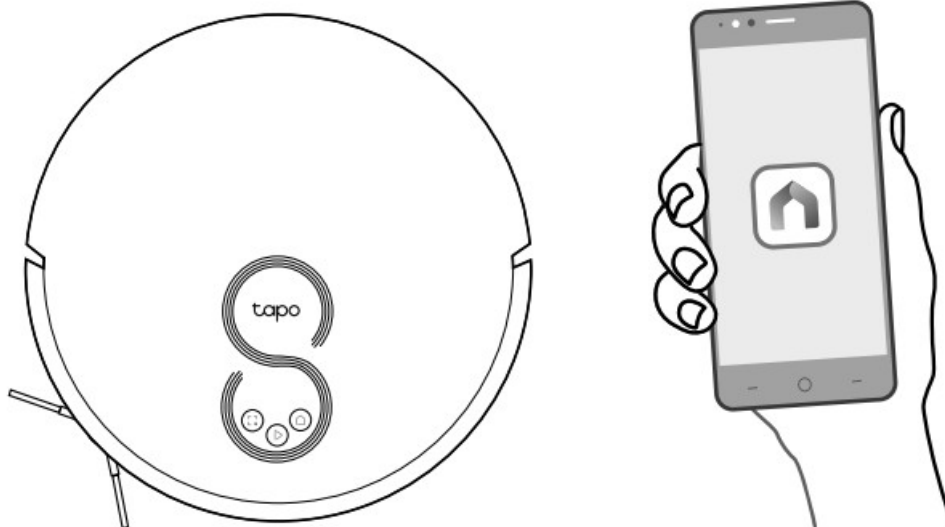

Troubleshooting & Voice Prompts for Issues: <https://www.tp-link.com/support/faq/3525/>

For Robot Vacuum:

TP-Link hereby declares that the device is in compliance with the essential requirements and other relevant provisions of directives 2014/53/EU, 2009/125/EC, 2011/65/EU and (EU)2015/863.

The original EU Declaration of Conformity may be found at <https://www.tapo.com/support/ce/>.

TP-Link hereby declares that the device is in compliance with the essential requirements and other relevant provisions of the Radio Equipment Regulations 2017.

The original UK Declaration of Conformity may be found at <https://www.tapo.com/support/ukca/>

For Auto-Empty Dock / Battery:

TP-Link hereby declares that the device is in compliance with the essential requirements and other relevant provisions of directives 2014/30/EU, 2014/35/EU, 2009/125/EC, 2011/65/EU and (EU)2015/863. The original EU declaration of conformity may be found at <https://www.tapo.com/en/support/ce/>



TP-Link hereby declares that the device is in compliance with the essential requirements and other relevant provisions of the Electromagnetic Compatibility Regulations 2016 and Electrical Equipment (Safety) Regulations 2016. The original UK declaration of conformity may be found at <https://www.tapo.com/support/ukca/>

Need some help?

Visit www.tapo.com/support/

for technical support, user guides, FAQs, warranty & more

Documents / Resources

| | |
|---|--|
|  | tp-link RV10 Plus Robot Vacuum and Mop [pdf] User Manual RV10 Plus, RV30 Plus, RV10 Plus Robot Vacuum and Mop, RV10 Plus, Robot Vacuum and Mo p, Vacuum and Mop, Mop |
|  | tp-link RV10 Plus Robot Vacuum and Mop [pdf] User Manual RV10 Plus, RV30 Plus, RV10 Plus Robot Vacuum and Mop, RV10 Plus, Robot Vacuum and Mo p, Mop, Robot Vacuum, Vacuum |

References

-  [Anatel — Agência Nacional de Telecomunicações](#)
-  [Support | Tapo](#)
-  [Regulatory Compliance | Tapo](#)
-  [Regulatory Compliance | Tapo](#)
-  [UKCA | Tapo](#)
-  [Answers to All Your Questions on TP-Link Robot Vacuum](#)

Manuals+.