



TP Link EAP610GP Gpon Access Point Installation Guide

[Home](#) » [tp-link](#) » TP Link EAP610GP Gpon Access Point Installation Guide 

TP Link EAP610GP Gpon Access Point



Contents

- [1 Network Topology](#)
- [2 Hardware Connection](#)
- [3 Hardware Installation](#)
- [4 Software Configuration](#)
- [5 Safety Information](#)
- [6 Warranty](#)
- [7 Customer Support](#)
- [8 Documents / Resources](#)
 - [8.1 References](#)
- [9 Related Posts](#)

Network Topology

Note: Images may differ from your actual product.

A typical network topology for the GPON AP is shown below.

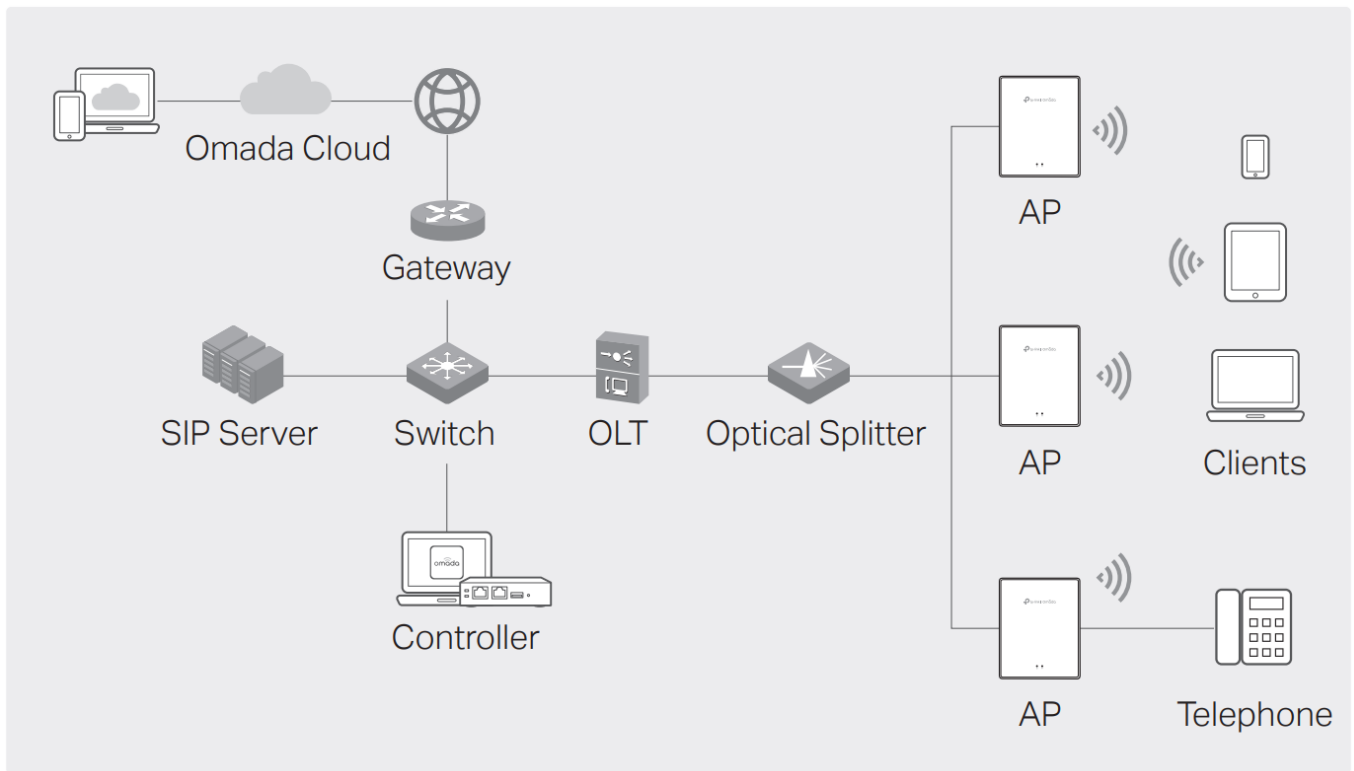

Hardware Connection

Connect the hardware based on the provided accessories.

Note: Accessories and operations may vary by model. For details, refer to the product manual.

1. Remove the anti-dust plug, and connect your optical fiber to the AP's GPON Port. Route excess fiber behind the device.
2. Connect your telephone to the AP's FXS port. If you don't need telephone service, skip this step.
3. Connect the AP to power.
 - If the AP has a Power port, connect the AP to your power socket with the power adapter.
 - If the AP has an AC Power Input port, connect the AP to your AC power cable with cord end terminals.

Warning: The product can only be installed by skilled person!

Hardware Installation

Install the AP based on the provided accessories. If your AP supports multiple installation options, you can choose one according to your needs.

Note: Accessories and operations may vary by model. For details, refer to the product manual.

Option 1: Desktop Mounting

1. Attach the multi-functional base to the AP.

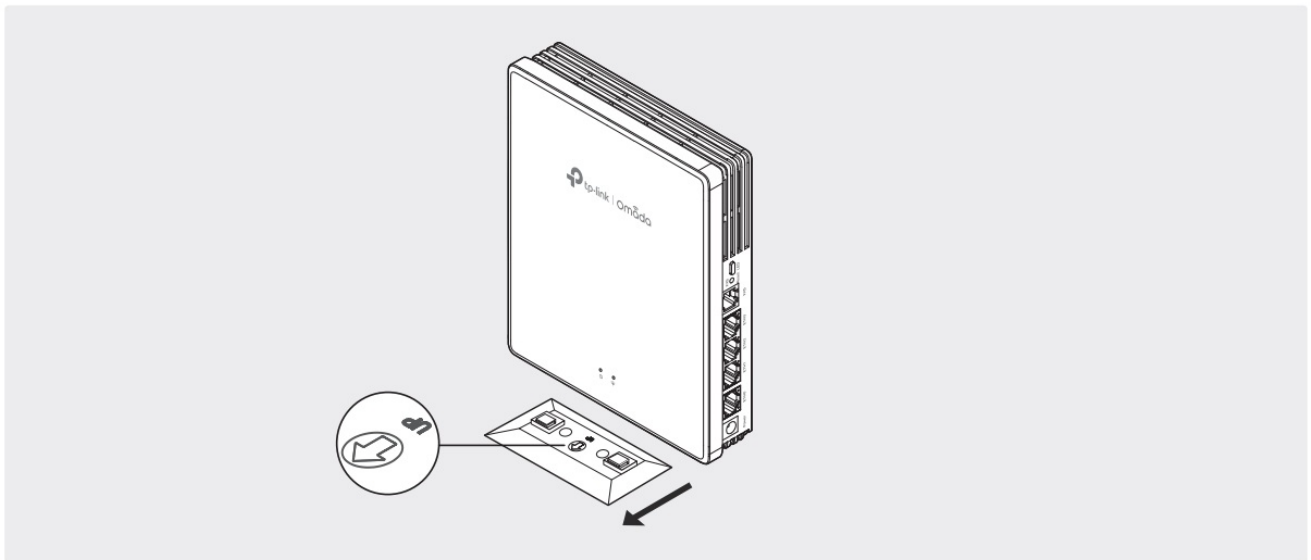

2. Place the AP vertically on a horizontal surface (such as a desktop or shelf) that is out of children's reach.

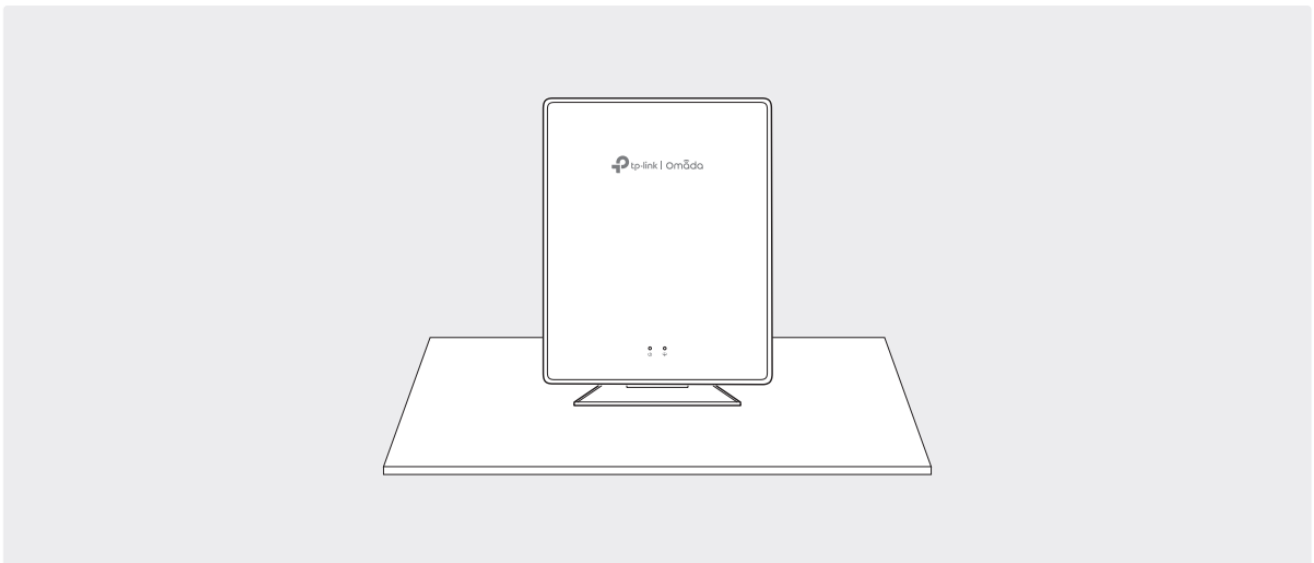

Option 2: Wall Mounting

1. Secure the multi-functional base to the wall in the correct direction with screws.

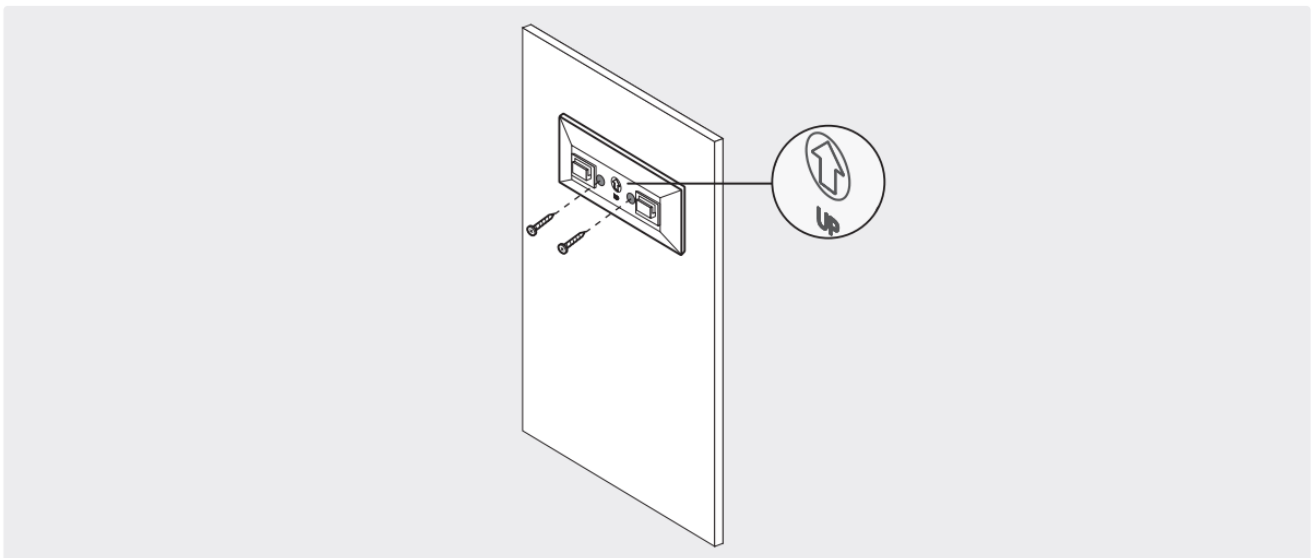

2. Attach the AP to the base.

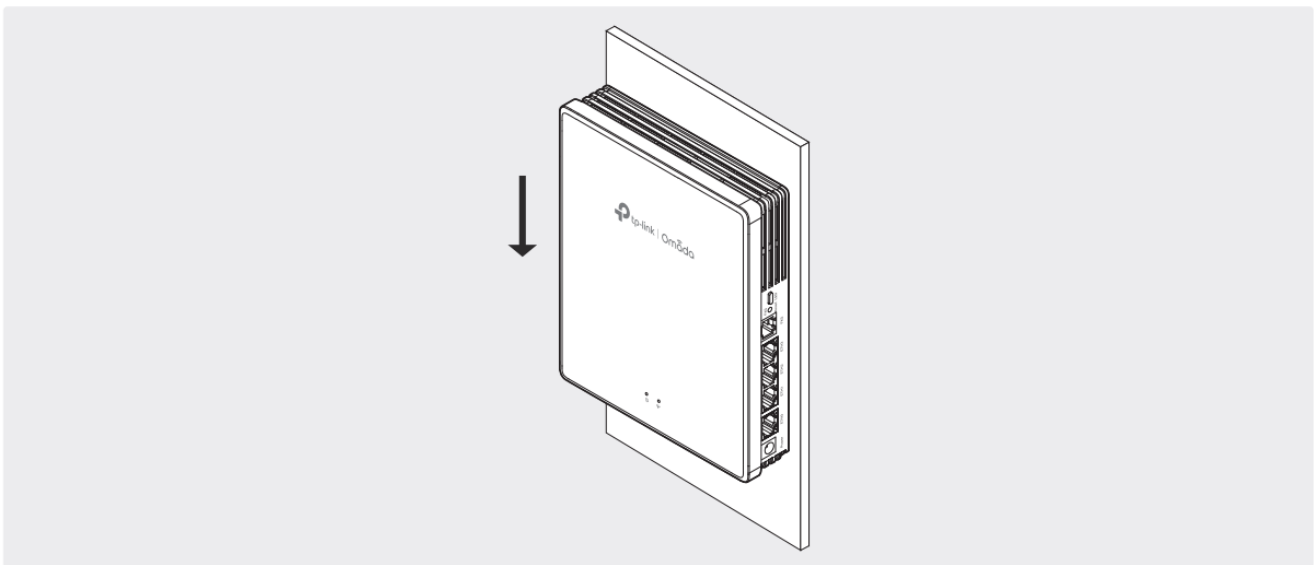

Option 3: Junction Box Mounting

1. Secure the mounting bracket to a junction box in the correct direction with screws.

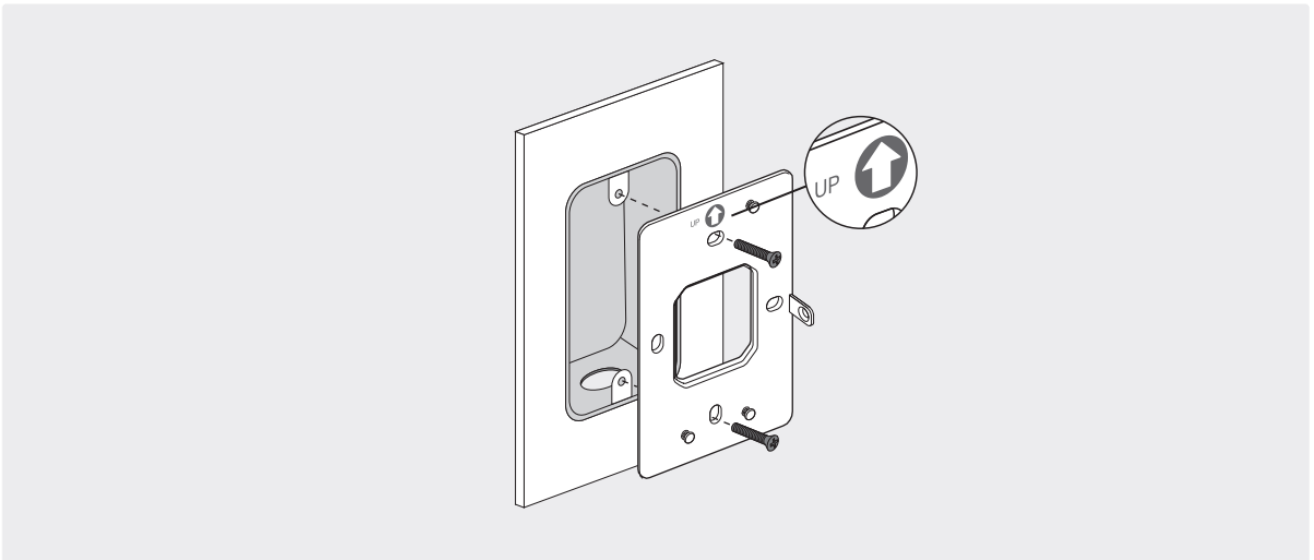

2. Attach the AP to the bracket. Some models may have a screw hole to further secure the product via screw.

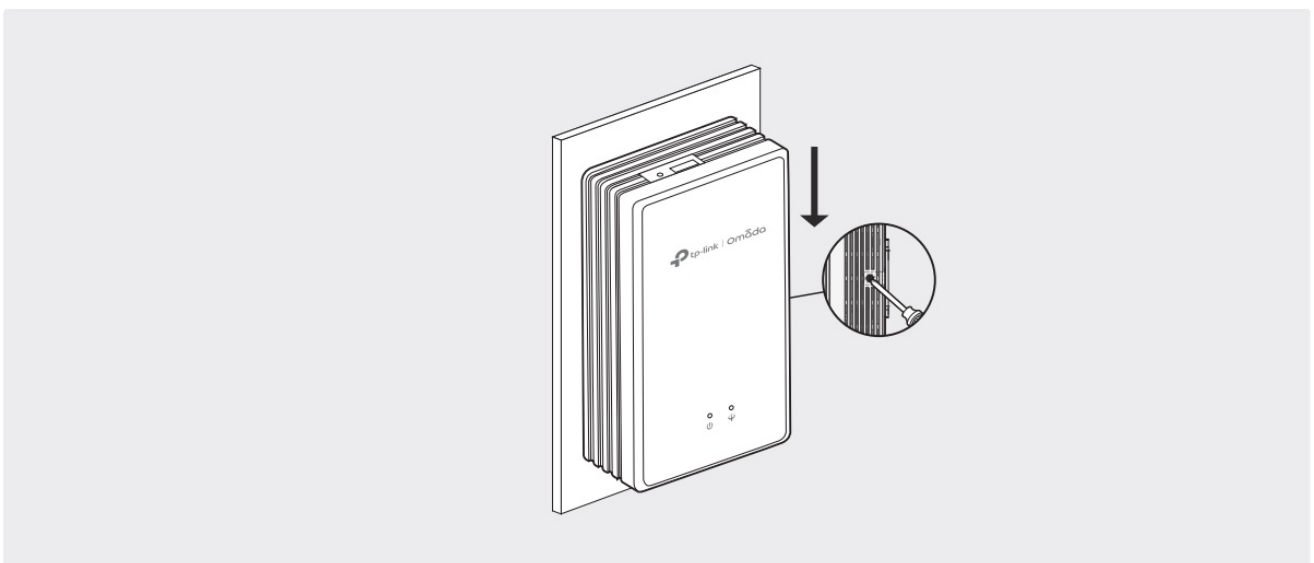

Software Configuration

Option 1: Standalone Configuration

1. Connect your device to an AP by using its default SSIDs.
2. Launch a web browser and visit <http://tplinkeap.net>. Use admin for both Username and Password to log in.
3. Follow web instructions to configure the AP. You need to register the GPON AP and configure basic settings.

Option 2: Batch Configuration via Controller

1. Get a Controller from <https://www.tp-link.com> or contact the sales staff.
2. Launch the Controller and follow the configuration wizard to create a primary wireless network.
3. Adopt APs in the Controller management interface. You need to register the GPON APs and configure basic settings.

Safety Information

Keep the device away from water, fire, humidity or hot environments.

- Do not attempt to disassemble, repair, or modify the device. If you need service, please contact us.
- Do not use the device where wireless devices are not allowed

For models with chargers/adapters:

- Do not use damaged charger or USB cable to charge the device.
- Do not use any other chargers than those recommended.
- Adapter shall be installed near the equipment and shall be easily accessible.

Please read and follow the above safety information when operating the device. We cannot guarantee that no accidents or damage will occur due to improper use of device. Please use this product with care and operate at your own risk.

TP-Link hereby declares that the device is in compliance with the essential requirements and other relevant provisions of directives (EU)2015/863, 2014/53/EU, 2009/125/EC and 2011/65/EU.

The original EU declaration of conformity may be found at <https://www.tp-link.com/support/ce/>

Warranty

For TP-Link Branded Products Only. For the information about warranty period, policy and procedures, please visit <https://www.tp-link.com/en/support>

THIS WARRANTY GIVES YOU SPECIFIC LEGAL RIGHTS, AND YOU MAY HAVE OTHER RIGHTS THAT VARY FROM STATE TO STATE (OR BY COUNTRY OR PROVINCE).

TO THE EXTENT ALLOWED BY LOCAL LAW, THIS WARRANTY AND THE REMEDIES SET FORTH ARE EXCLUSIVE AND IN LIEU OF ALL OTHER WARRANTIES, REMEDIES AND CONDITIONS.

TP-Link warrants the TP-Link branded hardware product contained in the original packaging against defects in materials and workmanship when used normally in according with TP-Link' s guidelines for some period which depends on the local service from the date of original retail purchase by the end-user purchaser.

Customer Support

For technical support, the user guide and other information, please visit <https://www.tp-link.com/support/?type=smb>, or simply scan the QR code.



Documents / Resources

<div data-bbox="135 1178 183 1189"> tp-link</div> <div data-bbox="148 1270 258 1274">Installation Guide</div> <div data-bbox="177 1292 237 1296">GPON Access Point</div>	<div data-bbox="314 1274 1348 1326"><p>TP Link EAP610GP Gpon Access Point [pdf] Installation Guide</p><p>EAP610GP Gpon Access Point, EAP610GP, Gpon Access Point, Access Point, Point</p></div>
---	---

References

- [!\[\]\(00454fbbe8db418db0de5eebfa916a08_img.jpg\) WiFi Networking Equipment for Home & Business | TP-Link](#)
- [!\[\]\(fd0f3d0c9a8d9b3ff3951bcf7c4bf0c0_img.jpg\) Support | TP-Link](#)
- [!\[\]\(e0cf2596b7f15139c12c58233ba748a6_img.jpg\) Support | TP-Link](#)
- [!\[\]\(7229103dad454bef452b933d3e01b45a_img.jpg\) Support | TP-Link](#)
- [!\[\]\(32dc4fd1d8720a74b95d374e8ccedb9f_img.jpg\) Support | TP-Link](#)
- [!\[\]\(48a23a052e2d439163363b6592817d27_img.jpg\) Support | TP-Link](#)
- [!\[\]\(93c6912adf4f8e7e05aabb5d1aff902e_img.jpg\) Support | TP-Link](#)
- [!\[\]\(b9953ed32faeff89b19f343a71b817c3_img.jpg\) Support | TP-Link](#)
- [!\[\]\(8432437104541bd9cf7a582c7928bc37_img.jpg\) Support | TP-Link](#)
- [!\[\]\(183a56d2980bd71b9e8bf8f04ca5ec26_img.jpg\) Support | TP-Link](#)

- [🔗 Support | TP-Link](#)
- [🔗 Support | TP-Link](#)
- [🔗 TP-Link Product Support - Wireless Networking Equipment Support](#)
- [🔗 CE | TP-Link](#)
- [User Manual](#)

[Manuals+](#), [Privacy Policy](#)

This website is an independent publication and is neither affiliated with nor endorsed by any of the trademark owners. The "Bluetooth®" word mark and logos are registered trademarks owned by Bluetooth SIG, Inc. The "Wi-Fi®" word mark and logos are registered trademarks owned by the Wi-Fi Alliance. Any use of these marks on this website does not imply any affiliation with or endorsement.