



Contents [[hide](#)]

- [1 Tourtecs GoCom4 Motorcycle Bluetooth Communication Intercom](#)
- [2 ABOUT](#)
- [3 INSTALLATION](#)
- [4 GET STARTED](#)
- [5 FM Radio On/Off & Station Switchable](#)
- [6 PHONE FUNCTIONS](#)
- [7 INTERCOM PAIRING](#)
- [8 INTERCOM & CELLPHONE MUSIC](#)
- [9 LANGUAGE SWITCH](#)
- [10 Product Parameters](#)
- [11 STATEMENT & WARRANTY](#)
- [12 Warranty](#)
- [13 Frequently Asked Questions](#)
- [14 Documents / Resources](#)
 - [14.1 References](#)

Tourtecs

Tourtecs GoCom4 Motorcycle Bluetooth Communication Intercom



ABOUT

Product Details

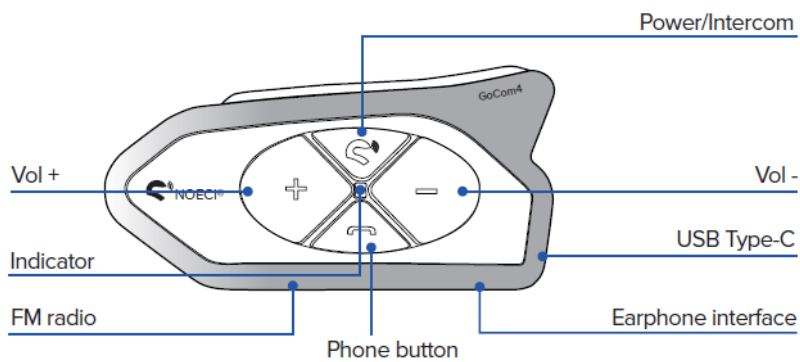

Package Contents

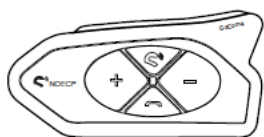

Headset Main Unit

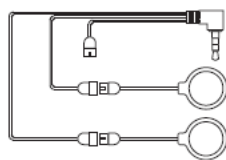

HD Speaker

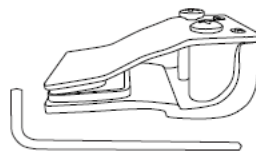

Helmet Clamp & Allen Wrench



Charging cable



Wired Boom Mic



Wired Soft Mic

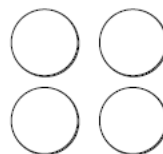

Velcro * 4



User Manual

INSTALLATION

1. Use the hex key to loosen the helmet clamp and attach and fix it to the rim of the helmet.
2. Insert the GoCom4 model into the slot of the clamp and fix it.

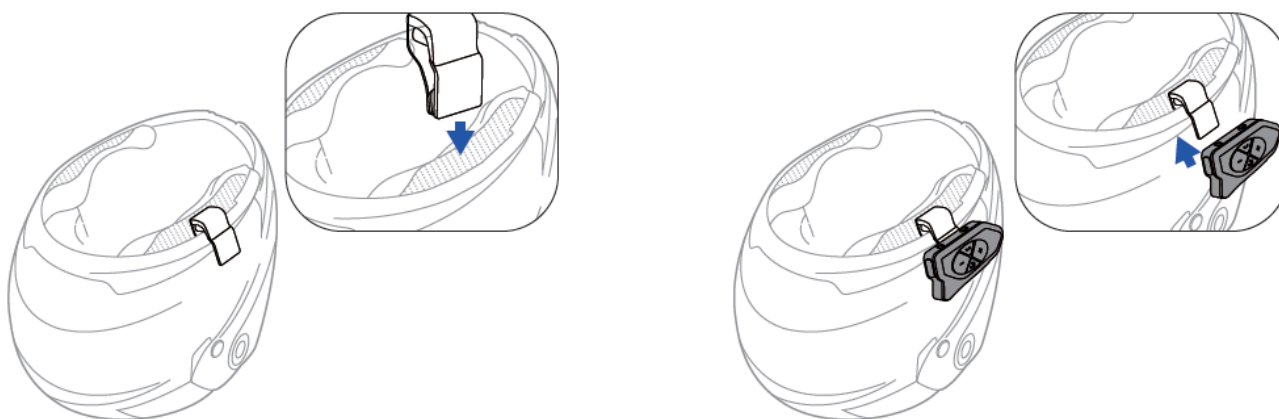

3. Stick the velcro to the inside of the helmet and attach the headphones and microphone to it.
4. Connect the speaker and microphone plugs to the GoCom4 model. Start using the communication system.

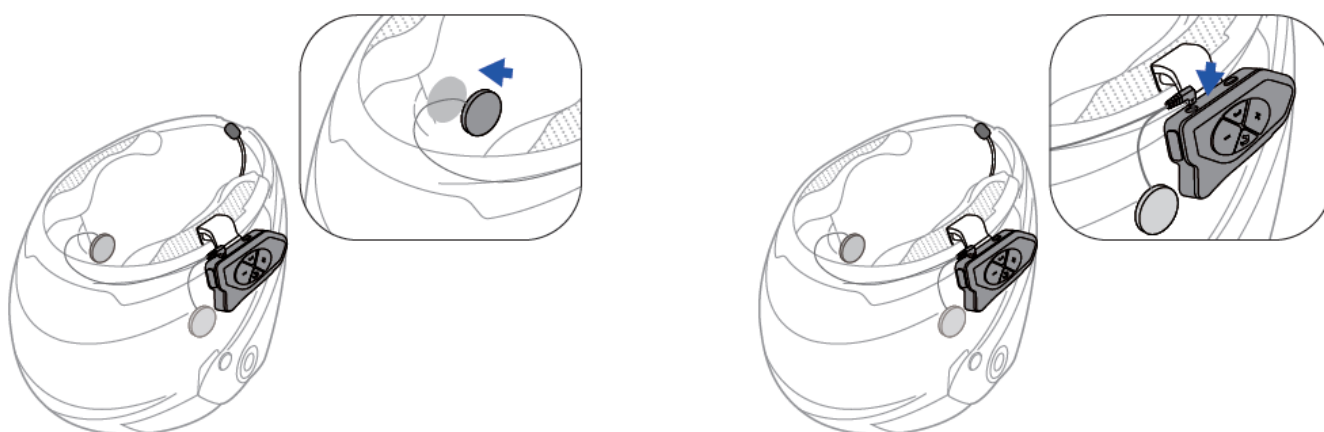

GET STARTED

Operation Instruction

The following symbols are used in this manual for illustration purposes:



Single-click



Double-click



1s Long press



Press simultaneously



5s Press simultaneously

Power On/Off

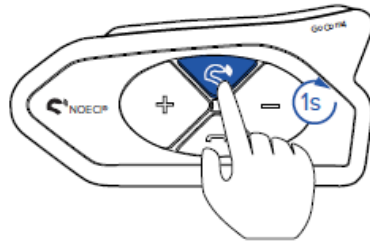

Power On

? "Power on"

■ Blue light

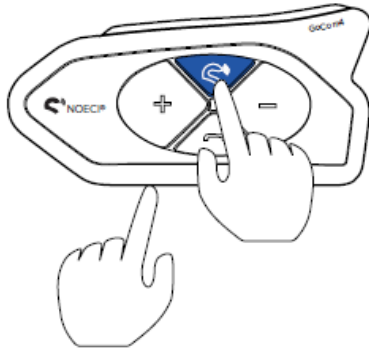

Power Off

Press the "Power" and "FM" buttons simultaneously

■ Light off

Protective Film & Reset

Before use, you can peel off the protective film on the front.

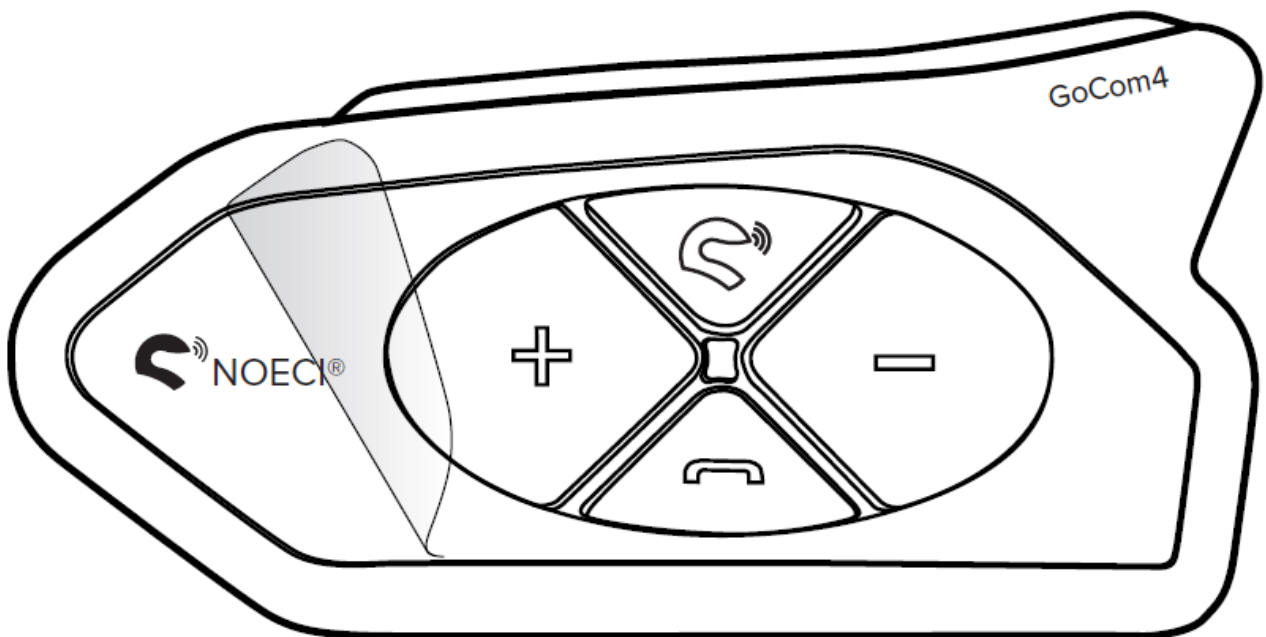

Factory Reset

Long press the "+" and "-" buttons at the same time for 5s.

■ Red light last for 2s then Blue light on

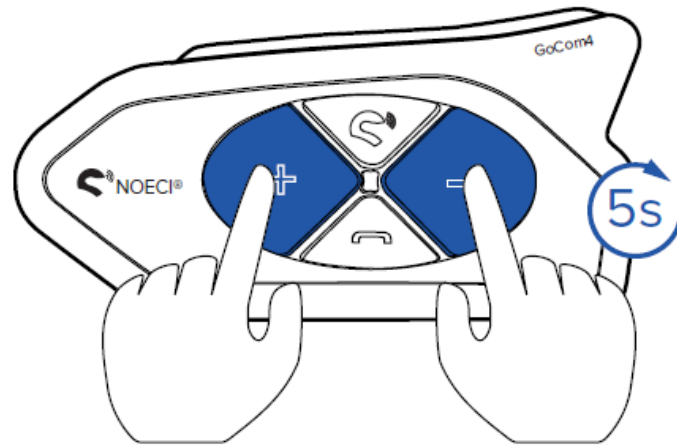

Low Battery Indication / Charging Indication

- Red light flashes twice each 2 mins

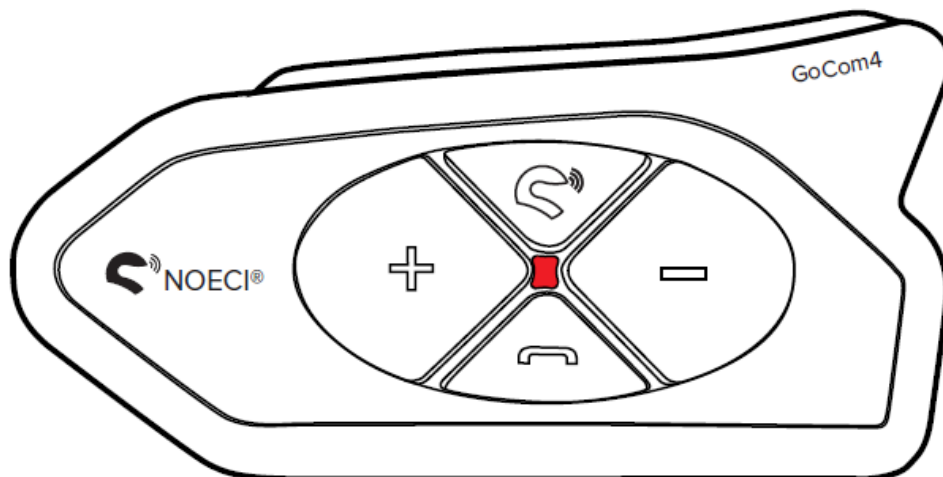

Charging

- Red light always on

Full-charged

- Light off

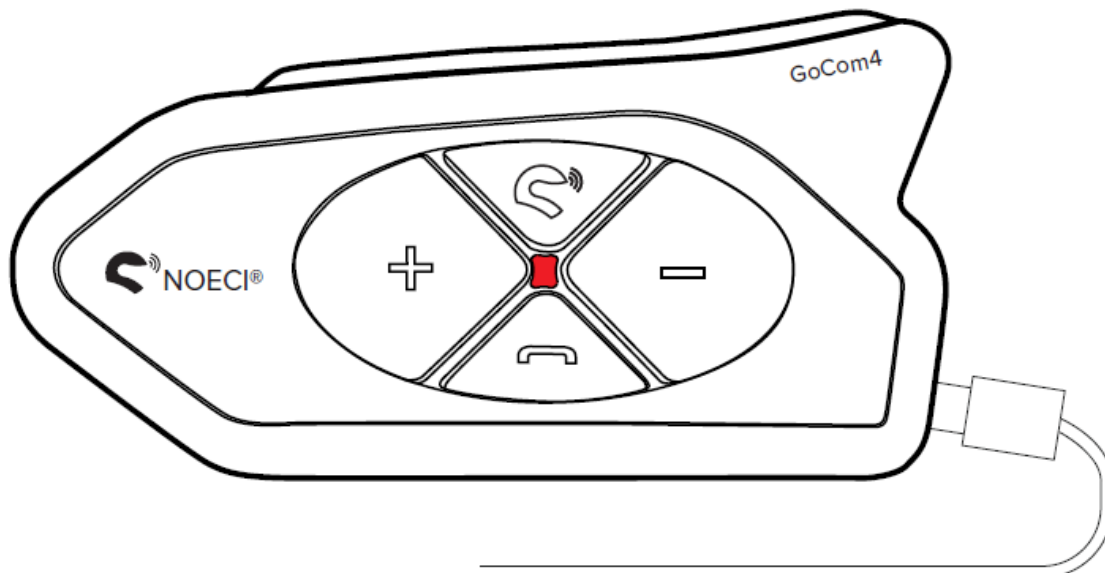

FM Radio On/Off & Station Switchable

When FM is turned on, it will automatically search for an FM station. Intercom and FM can be used simultaneously.

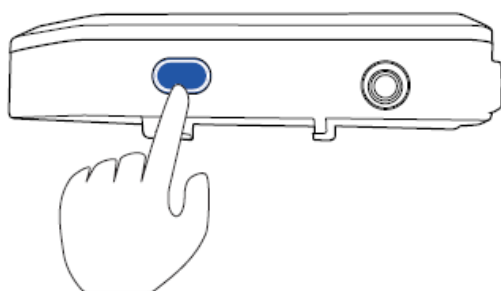

Single click to open the FM.

? "FM on"

Click again to turn-off the FM.

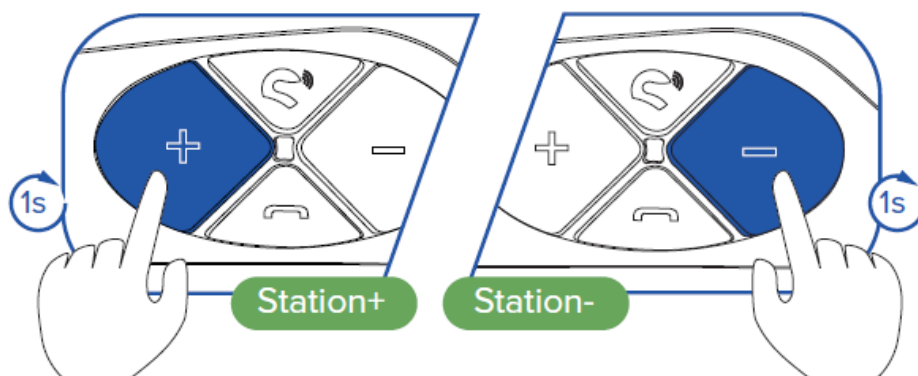

? "FM off"



PHONE FUNCTIONS



Phone Pairing

Long-press the “Phone” button for 5s to enter the pairing mode.

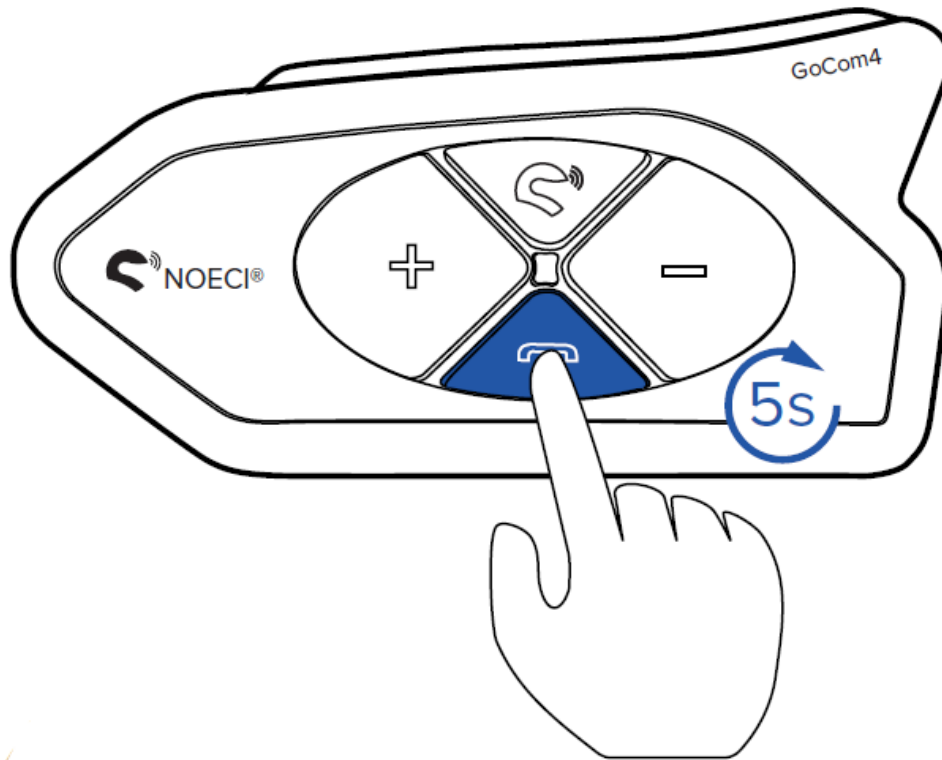
-  “Phone pairing”
-  Red & Blue lights quick flash



Open your cellphone Bluetooth, search and pair the “GoCom4”.

-  “Pairing successful”
-  Blue light flashes slowly

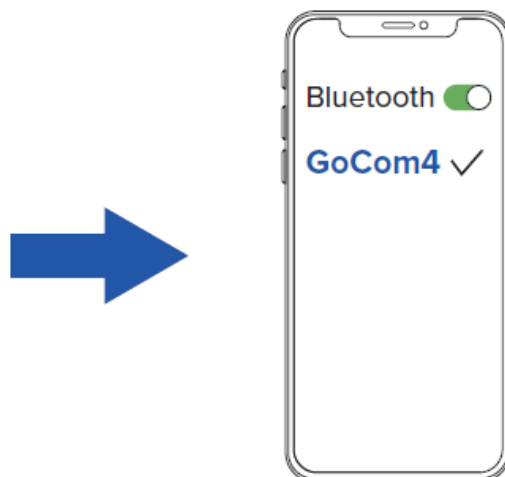

Music Playing

Single click the “Phone” button to play / pause the music.

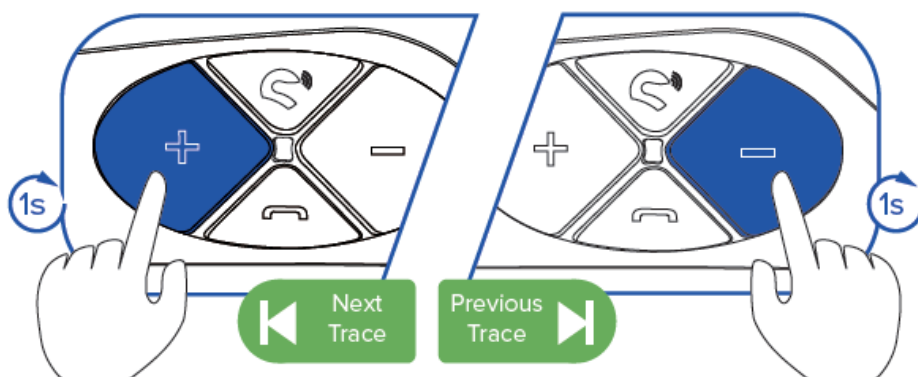
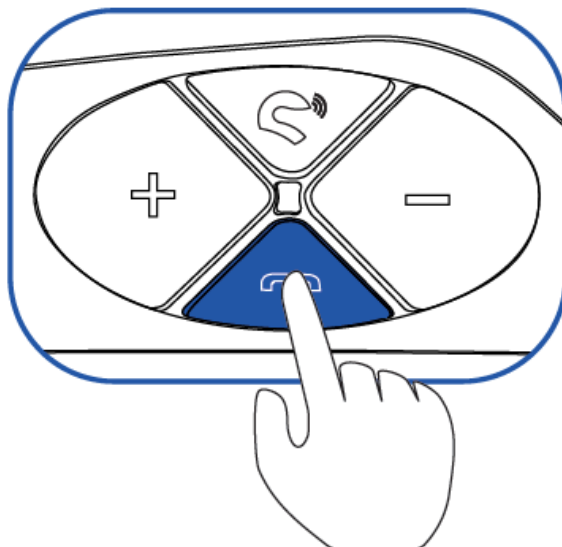

Voice Assistant

Press the “Phone” button for 1s to active the Siri / Google assistant.

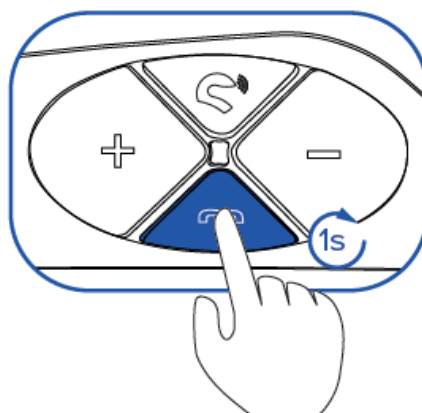

Speak into the microphone when the voice assistant answers.



Phone Call Operations

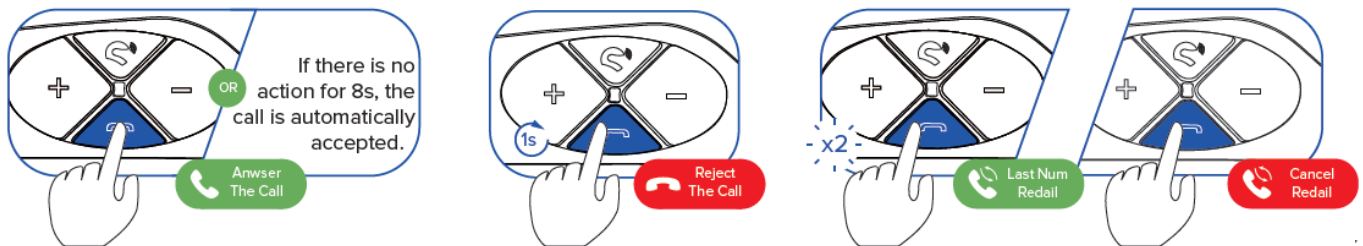

INTERCOM PAIRING

Two Intercom Pairing

1. Long press the “Power” button for 1s to power on both GoCom4.

- ? “Power on”
-  Blue light

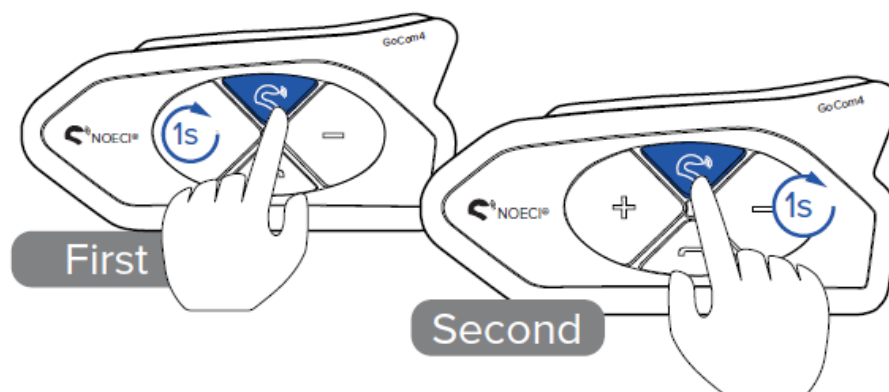

2. Press the “Power” and “Vol+” keys for 1s on the 1st intercom and “Power” and “Vol-” keys for 1s on the 2nd intercom. Both GoCom4 search and connect automatically.

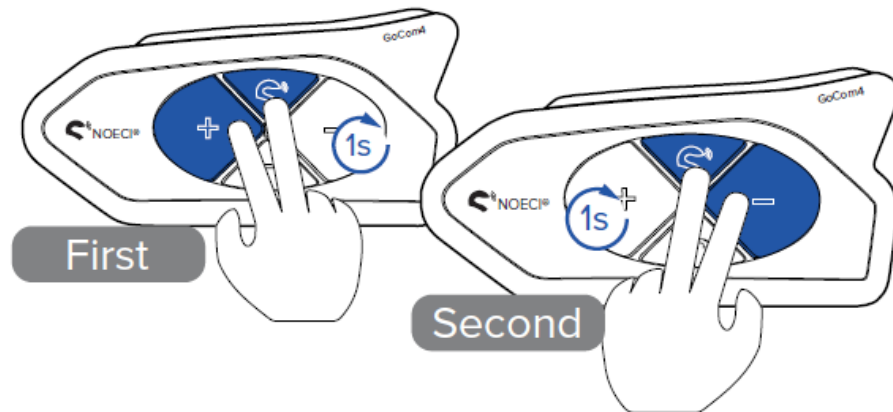

- ? “Intercom A pairing”
- ? “Pairing successful”
-  Red & Blue lights quick flash
- ? “Intercom B pairing”
- ? “Pairing successful”
-  Red & Blue lights quick flash

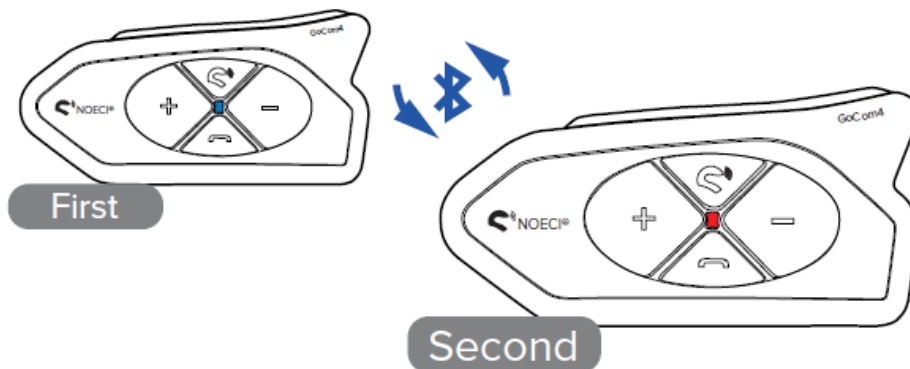

3. After successful pairing, communication can be started.

If pairing fails, reset both models and start again from step 1.











- ? “Intercom A connected”
-  Blue light flashes slowly
- ? “Intercom B connected”
-  Red light flashes slowly

Three Intercom Pairing



1. Regard those three GoCom4 as the “First”, “Second” and “Third”. Long press the “Power” and “Vol+” buttons for 1s on the First Intercom and the “Power” and “Vol-”



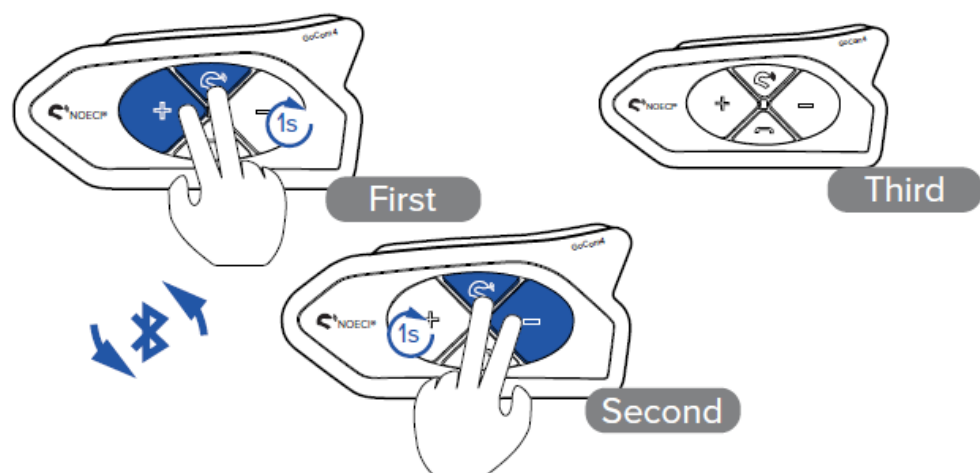



buttons for 1s on the Second Intercom. Both GoCom4 search and connect automatically.

-  "Intercom A pairing"
-  "Pairing successful"
-  "Intercom A connected"
-  Blue light flashes slowly
-  "Pairing successful"
-  "Intercom B pairing"
-  "Pairing successful"
-  "Intercom B connected"
-  Red light flashes slowly





2. Long press the "Power" and "Vol+" buttons for 5s on the Second Intercom and the "Power" and "Vol-" buttons for 1s on the Third Intercom. Both GoCom4 search and connect automatically.

-  "Intercom A pairing"
-  "Pairing successful"

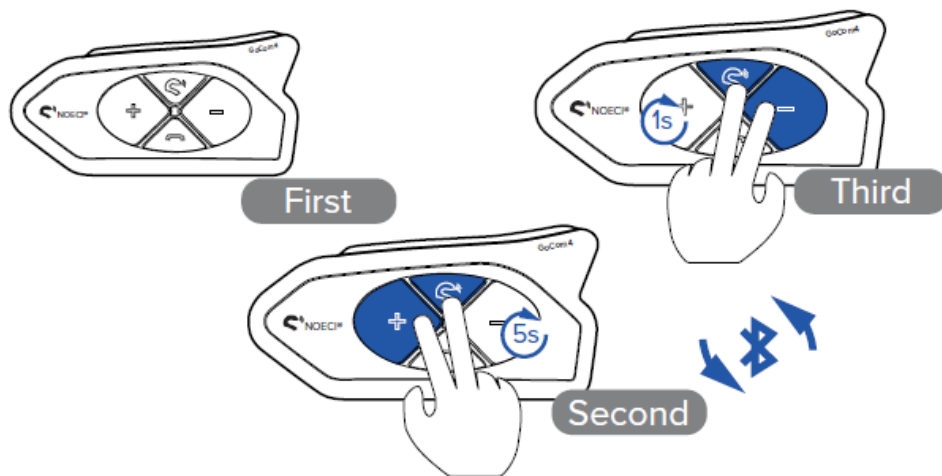
-  “Intercom A connected”
-  Blue light flashes slowly
-  “Intercom B pairing”
-  “Pairing successful”
-  “Intercom B connected”
-  Red light flashes slowly











3. Simply clicking the “Power” button on any of the three GoCom4s will automatically connect. Communication can be started.

- **First:**  Blue light flashes slowly
- **Second:**  Red & Blue lights flash alternately slowly
- **Third:**  Red light flashes slowly

Four Intercom Pairing

1. Pair the “First”, “Second” and “Third” intercom as explained in 6.2 “Three Intercom Pairing”. Do not press the “Power” button at the end to start the communication of three devices.
2. Long press the “Power” and “Vol+” buttons for 5s on the Third Intercom and the “Power” and “Vol-” buttons for 1s on the Fourth Intercom. Both GoCom4 search and



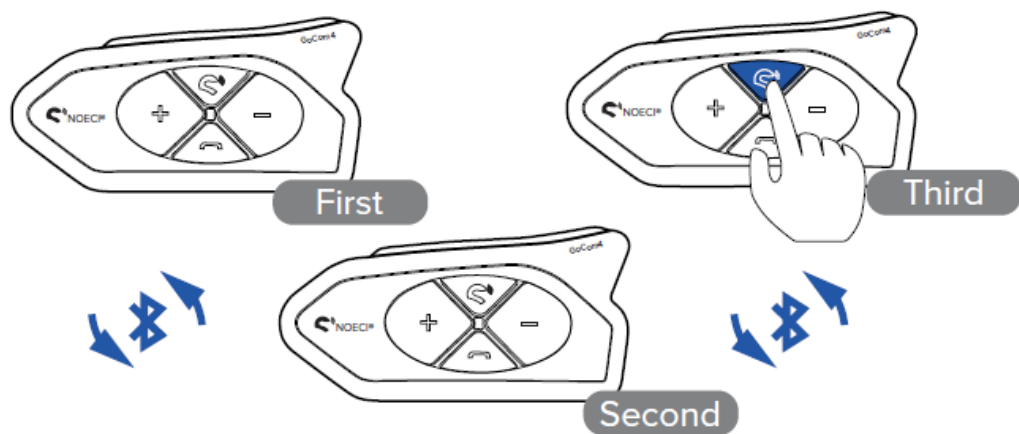

connect automatically.

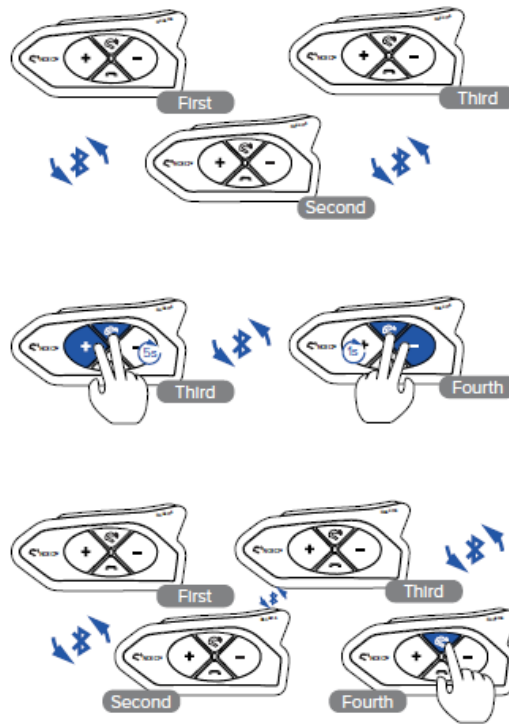
-  "Intercom A pairing"
-  "Pairing successful"
-  "Intercom A connected"
-  Blue light flashes slowly
-  "Intercom B pairing"
-  "Pairing successful"
-  "Intercom B connected"
-  Red light flashes slowly







3. Simply clicking the “Power” button on any of the four GoCom4s will automatically connect. Communication can be started.

- First:  Blue light flashes slowly
- Second:  Red & Blue lights flash alternately slowly
- Third:  Red & Blue lights flash alternately slowly
- Fourth:  Red light flashes slowly

Pair with Other Intercom

1. Power on the GoCom4, long press the “Power” and “Vol+” buttons at the same time for 1s until the red and blue lights flash.

-  “Intercom A pairing”
-  Red & Blue lights quick flash

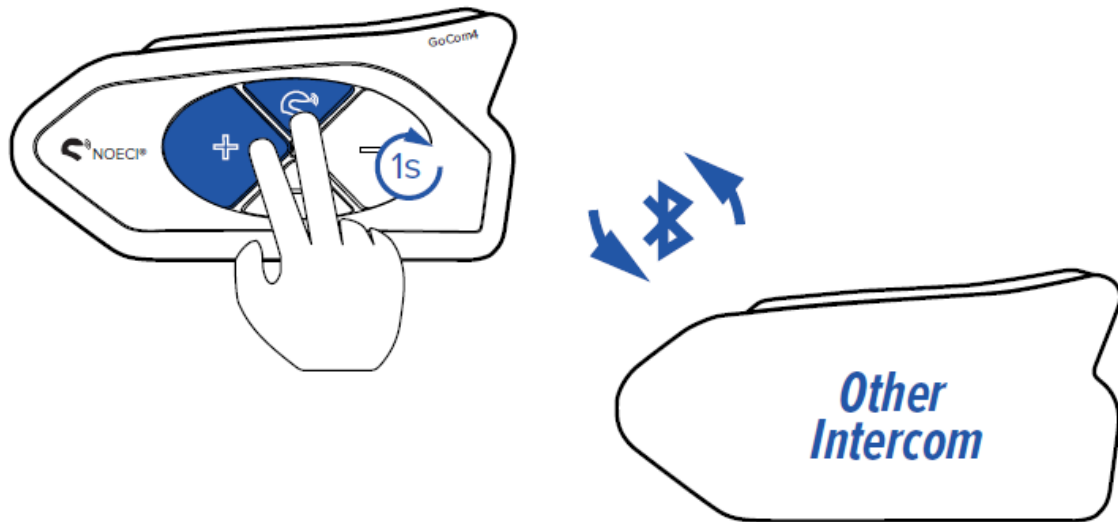

2.



Use your other Bluetooth intercom and enter the Bluetooth pairing mode.

3. The GoCom4 will automatically search for the other intercom and get connected for communication.

If the connection fails several times, please contact the manufacturer of the other intercom and check whether universal pairing with the device is

-  "Pairing successful"
-  "Intercom A connected"
-  Blue light flashes slowly

Intercom Disconnection & Re-connection

Long-press the "Power" button for 1s, the currently intercom would be dis- connected.

-  "Intercom A disconnected"

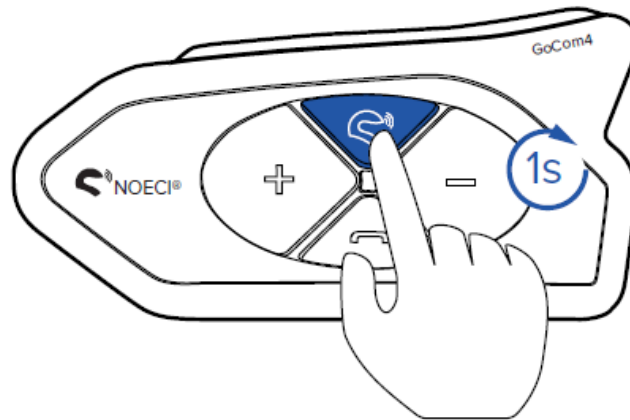

After disconnected, single press the “Power” button, the currently intercom would be reconnected.

? “Intercom A connected”

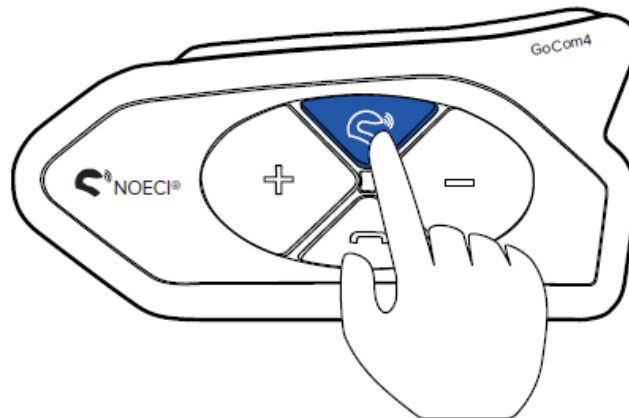



INTERCOM & CELLPHONE MUSIC

1. After successful pairing of GoCom4 and smartphone, press the “Power” and “Vol-” buttons for 1s until the red and blue light flashes.

- ? “Intercom A pairing”
-  Red & Blue lights quick flash

2. Connect the other GoCom4 model as described in 6.1 “Two Intercom Pairing”.

- “Intercom A connected”
-  Blue light flashes slowly
- ? “Intercom B connected”
-  Blue light flashes slowly

3. Now you can use the communication and the music / navigation at the same time.

If there is already a connection to another intercom, it can be disconnected to establish the connection to the smartphone. Then reconnect the other intercom.

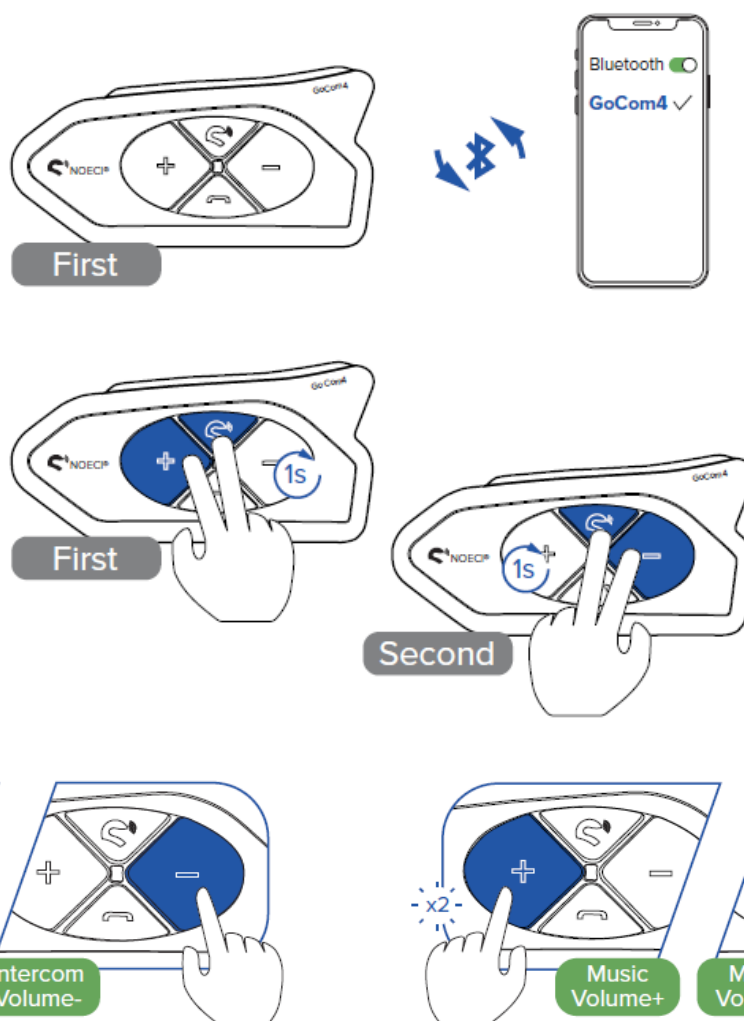

AUDIO SHARING (Ideally for driver and passenger)



Basic Sharing

1. First, connect the GoCom4 model to your smartphone and play music after pairing is

complete.

- “Phone pairing”
- Red & Blue lights quick flash
- “Pairing successful”
- Blue light flashes slowly

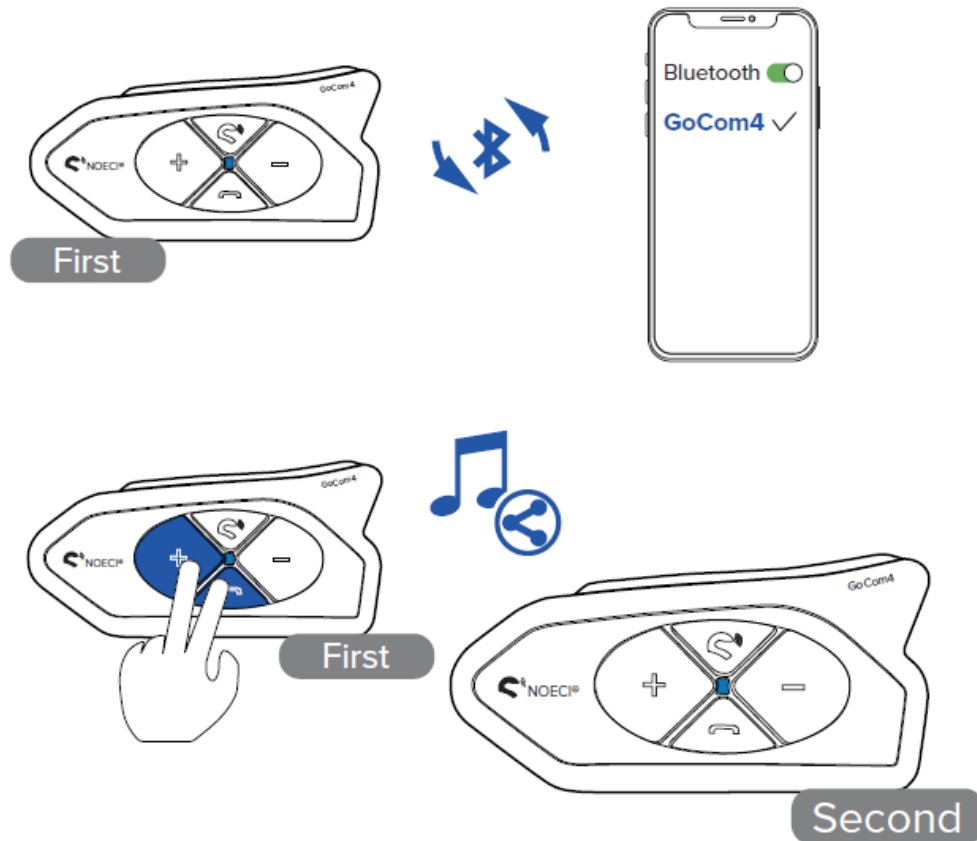

2. Power on another GoCom4 model, then press the “Vol+” and “Phone” buttons simultaneously on the First Intercom. It will start the audio sharing function. Once the Second Intercom hears “Audio share”, both GoCom4 could enjoy the same music / audio.







- “Audio share”
- Blue light
- “Du Du”
- Blue light

Audio Sharing & Two Intercom Talking

1. Follow the steps of 8.1 Basic Sharing to enable audio sharing of two GoCom4 units.
2. Follow the step of 6.1 Two Intercom Pairing to pair both GoCom4 units and start intercom communication.

When two units are paired in intercom mode, audio sharing is paused. Press the

“Phone” key again to start audio.

-  “Intercom A pairing”
-  “Intercom A connected”
-  Blue light flashes slowly
-  “Intercom B pairing”
-  “Intercom B connected”
-  Red light flashes slowly

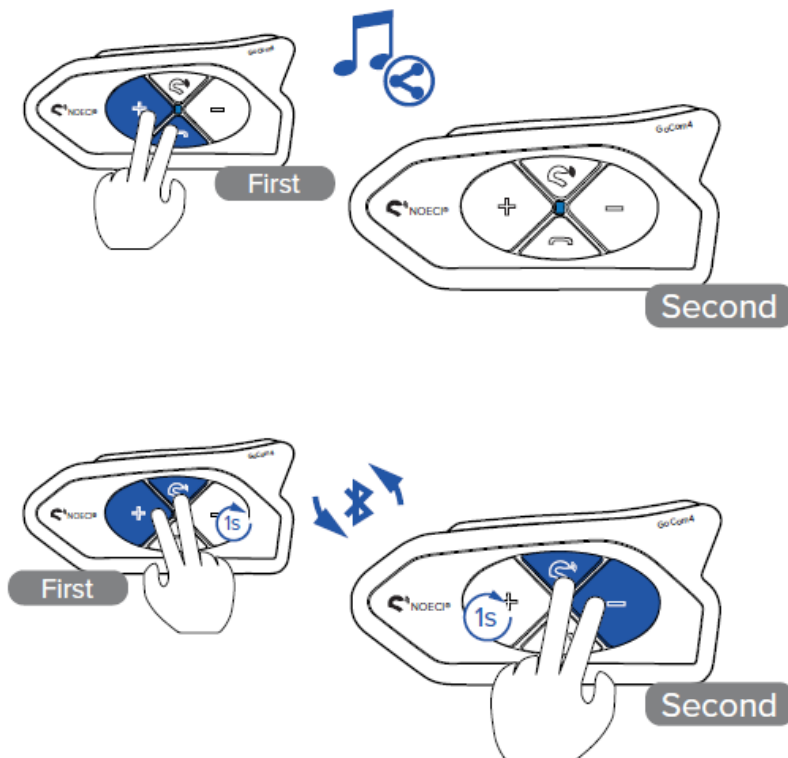

3. You can also pair the intercoms first and then connect the smartphone for the audio sharing function.

It is recommended not to use the Audio Sharing function when four GoCom4 units are communicating with each other.

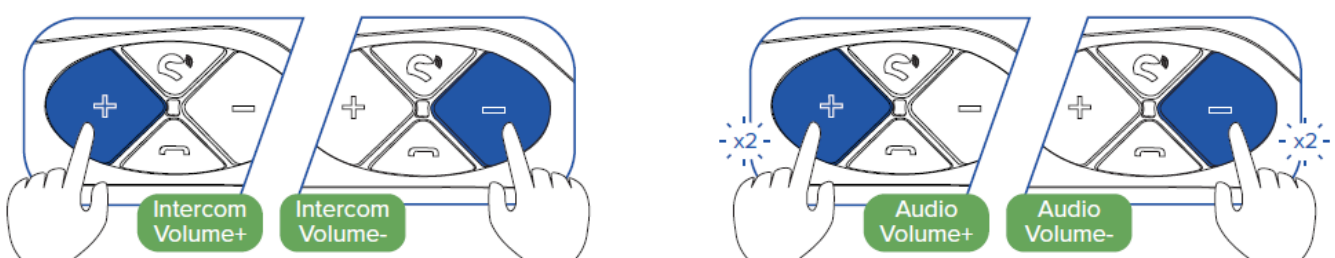

LANGUAGE SWITCH

Long-press the “Phone” and “FM” buttons for 5s until hearing Di – Di sounds from the speaker. The intercom by then already switched the current language to the next one. The default setting is English language.



- **Bluetooth chip:** Qualcomm
- **Max distance of 4:** 1500m
- **Battery capacity:** 500mAh
- **Operating voltage:** 3.0V~4.2V
- **Standby time:** 250H
- **FM brands:** 60 MHz~108 MHz
- **Speaker frequency response:** 40Hz~20KHz
- **Earphone connector:** 3.5mm
- **Distortion:** $\leq 0.2\%$
- **Device weight:** 47g
- **Operating temperature:** -30°C~60°C
- **Charger spec.:** DC 5V/1A

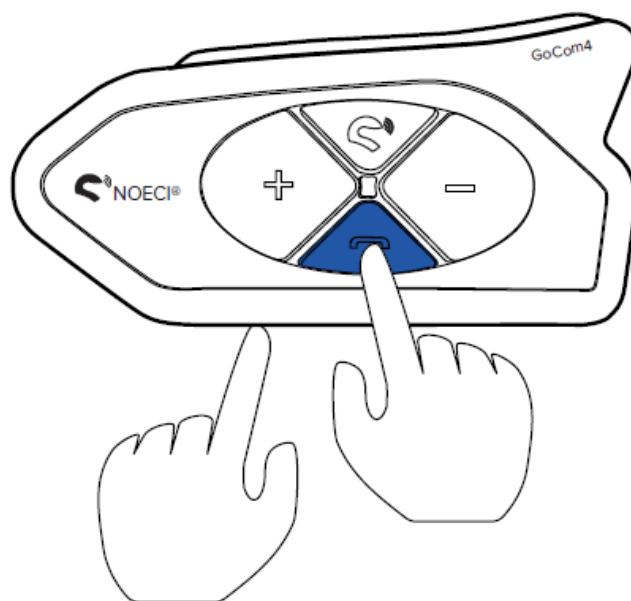

Product Parameters

- **Bluetooth version:** BT 5.1
- **Intercom distance:** 500m
- **Max phone BT distance:** 30m
- **Battery life:** ≥500 times
- **Intercom time:** 12~15H
- **Charging time:** 2~3H
- **Speaker spec.:** Φ40/20mW/32Ω
- **Mic sensitivity:** -40±3dB
- **Audio S/N ratio:** ≥75dB
- **Material:** ABS+PC
- **Waterproof:** IP65
- **Charging interface:** Type-C

WARNING

The use of the device will impair your ability to hear other sounds and others around you. Listening to music or speaking on a telephone may prevent you from hearing others around you and distract you from riding safely. The use of such device while riding may endanger you and others, and its use, in some areas, could not be allowed.

- Using this device at a high volume may result in permanent hearing loss.
- If you experience ringing in your ear or any other hearing related pain, reduce the volume or discontinue using this device. With continued use at high volume, your ears may become accustomed to the sound level, which may result in permanent damage to your hearing.
- Please use this device at a safe volume level.

STATEMENT & WARRANTY

FCC Statement

Changes or modifications not expressly approved by the party responsible for compliance could void the user's authority to operate the equipment. This equipment has been tested and found to comply with the limits for a Class B digital device, pursuant to part 15 of the FCC Rules. These limits are designed to provide reasonable protection against harmful interference in a residential installation. This equipment generates uses and can radiate radio frequency energy and, if not installed and used in accordance with

the instructions, may cause harmful interference to radio communications. However, there is no guarantee that interference will not occur in a particular installation. If this equipment does harmful interference to radio or television reception, which can be determined by turning the equipment off and on, the user is encouraged to try to correct the interference by one or more of the following measures:

- Reorient or relocate the receiving antenna.
- Increase the separation between the equipment and receiver.
- Connect the equipment into an outlet on a circuit different from that to which the receiver is connected.
- Consult the dealer or an experienced radio / TV technician for help

Changes or modifications not expressly approved by the party responsible for compliance could void the user's authority to operate the equipment. This device complies with Part 15 of the FCC Rules. Operation is subject to the following conditions.

1. This device may not cause harmful interference, and
2. This device must accept any interference received, including interference that may cause undesired operation.

Warranty

In normal use, one year warranty from the date of purchase. Any disassemble, modification will void the warranty.

ATTENTION

Installing equipment on the helmet is a modification of the helmet, which may cause the helmet's warranty to fail or hinder the helmet's function. This may cause danger in the event of accidents, so please fully understand the facts when using the helmet. If not, please return the product.

- Before driving, please make sure that the product is firmly and correctly mounted on the helmet. If the product falls off during driving, it will cause injury or accident.
- To ensure riding safety, please use this product carefully while on the road to avoid serious body injury, death or injury.

- In order to ensure the communication distance when riding, please try to use it in an open place.
- In the case of rain, please put the device jack down, USB rubber plug tight; During use, ensure that the headphone jack is fully plugged into the device to prevent water from entering the device.
- The battery capacity will change with the temperature. When the battery is used at low temperature or below 0° C, the battery life of the product may attenuate to different degrees.
- If the electronic function fails, please power off and try again.
- When using this product when operating vehicles or vehicles, the safety precautions of the vehicle manufacturer must be observed.

Frequently Asked Questions

How do I pair my phone with the GoCom4?

Press and hold the Phone button for 5 seconds until red and blue lights blink rapidly. Pairing is successful when the blue light blinks slowly.

How do I play music using the GoCom4?

Simply single click the Phone button to play or pause music.

Documents / Resources

	<p>Tourtecs GoCom4 Motorcycle Bluetooth Communication Intercom [pdf] In struction Manual</p> <p>GoCom4 Motorcycle Bluetooth Communication Intercom, GoCom4, Motor cycle Bluetooth Communication Intercom, Bluetooth Communication Inter com, Communication Intercom, Intercom</p>
---	---

References

- [User Manual](#)

■ Tourtecs

🔗 Bluetooth Communication Intercom, Communication Intercom, GoCom4, GoCom4 Motorcycle Bluetooth Communication Intercom, Intercom, Motorcycle Bluetooth Communication Intercom, Tourtecs

Leave a comment

Your email address will not be published. Required fields are marked *

Comment *

Name

Email

Website

☐ Save my name, email, and website in this browser for the next time I comment.

Post Comment

Search:

Search

[Manuals+](#) | [Upload](#) | [Deep Search](#) | [Privacy Policy](#) | [@manuals.plus](#) | [YouTube](#)

This website is an independent publication and is neither affiliated with nor endorsed by any of the trademark owners. The "Bluetooth®" word mark and logos are registered trademarks owned by Bluetooth SIG, Inc. The "Wi-Fi®" word mark and logos are registered trademarks owned by the Wi-Fi Alliance. Any use of these marks on this website does not imply any affiliation with or endorsement.

