



TOURATECH R 1250 Road Prototype Build Instructions

[Home](#) » [Touratech](#) » TOURATECH R 1250 Road Prototype Build Instructions 

Contents

- [1 TOURATECH R 1250 Road Prototype Build](#)
- [2 Mounting instructions](#)
- [3 Documents / Resources](#)
 - [3.1 References](#)
- [4 Related Posts](#)

TOURATECH R 1250 Road Prototype Build

INSTRUCTION MANUAL

We recommend having the installation carried out in a workshop with appropriately trained personnel.



Achtung | Caution | Attention | Attenzione | Atención



Bemerkung | Note | Remarque | Nota | Observaciones



Warnung | Warning | Avertissement | Avvertenza | Advertencia



Flüssigkeit | Liquid | Liquide | Líquido | Líquido



Drehmoment | Torque | Couple | Momento torcente | Par de apriete



Schablone | Template | Pochoir | Dima | Plantilla



2 Personen | 2 Persons | 2 Personnes | 2 Persone | 2 Personas



Original Motorradteil | Original motorcycle part | Pièce d'origine |
Pezzo motocicletta originale | Pieza original de la motocicleta.

| Nm | | | |
|------|--------------|------------|----|
| | Steel 8.8 | Inox A2 | |
| M 4 | 2,7 | 0,8 | Nm |
| M 5 | 5,5 | 1,7 | Nm |
| M 6 | 9,7 | 3,0 | Nm |
| M 8 | 23,0 | 7,9 | Nm |
| M 10 | 47,0 | 14,0 | Nm |
| M 12 | 80,0 | 24,0 | Nm |
| M 14 | 130,0 | -,- | Nm |
| M 16 | 196,0 | 59,0 | Nm |
| M 18 | 270,0 | -,- | Nm |
| M 20 | 385,0 | 114,0 | Nm |

These instructions are written based on our current state of knowledge. Information is provided without any guarantee as to its accuracy. Subject to technical modifications.

The order of assembly steps must be followed.

Touratech accepts no liability for incorrectly fitted parts and resulting material damage or personal injury!

Please observe applicable road vehicle (construction and use) regulations as well as EC/ECE Directives and applicable laws in your country. If parts are fitted which require inspection and/or approval after fitting, take your vehicle to a testing station immediately and have the vehicle papers updated.

- Check and if necessary tighten all bolted connections after 50 km.
- Standard tightening torques in Nm for bolted connections with strength class 8.8.
- For special tightening torques refer to a workshop with appropriately trained personnel !
- Please take into account that fitting panniers, crash bars, foot peg lowering kits (rider and pillion), Kickstand enlargement plate, front spoilers and engine guards may restrict the bike's lean angle!
- If modifications are made to the fairing, stem, handlebar, fairing parts, etc., ensure that electrical wiring, brake lines, accelerator and clutch cables are refitted correctly. Check clearance, both sides with full steering lock .
- Always disconnect the battery when working on the electrics!
- We recommend cutting protective film to size and applying it to impact areas that are likely to be chipped by stones.
- Work on the brake system and suspension should always be carried out in a workshop with appropriately trained personnel.
- The maximum load on luggage racks is 5 kg! Luggage racks Zega Pro TC is 10 kg!
- If other original accessories or aftermarket accessories are used, ensure clearance, fitment and do not come into contact with other parts!
- Apply conventional lubricant to stainless steel bolts prior to assembly.
- PDF fitting instructions also can be downloaded from the Touratech webshop.

Mounting instructions

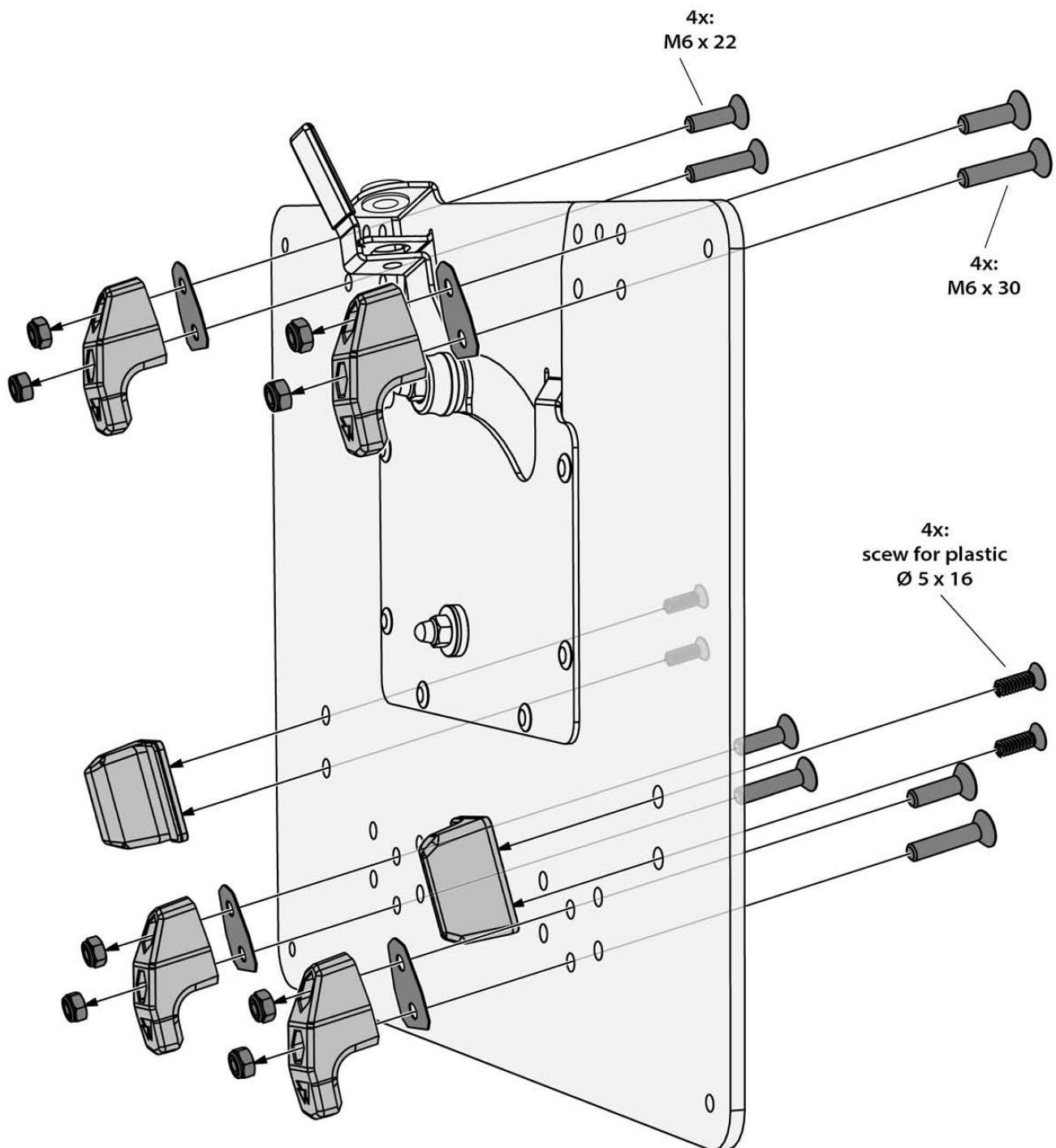

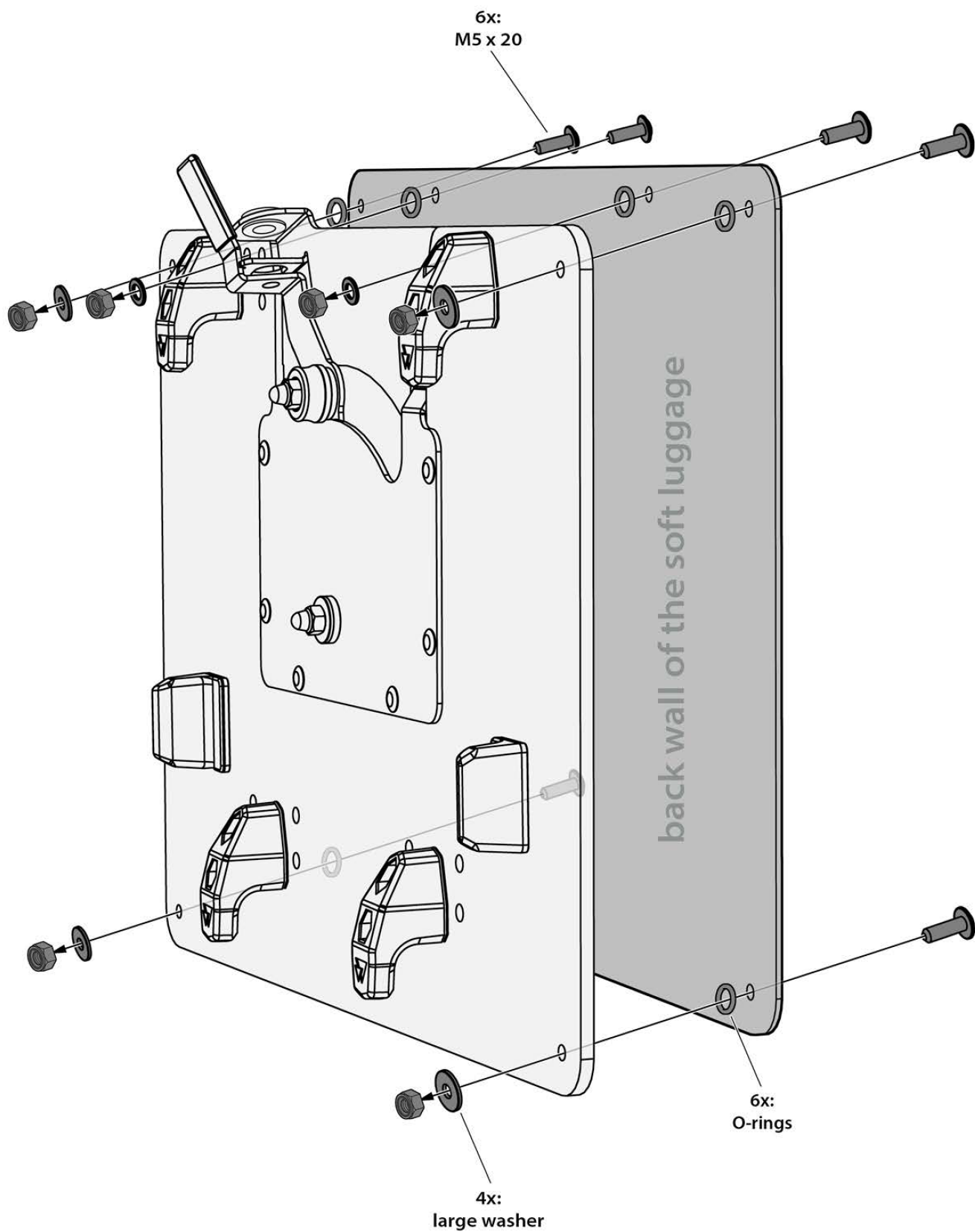

No
carrying
strap

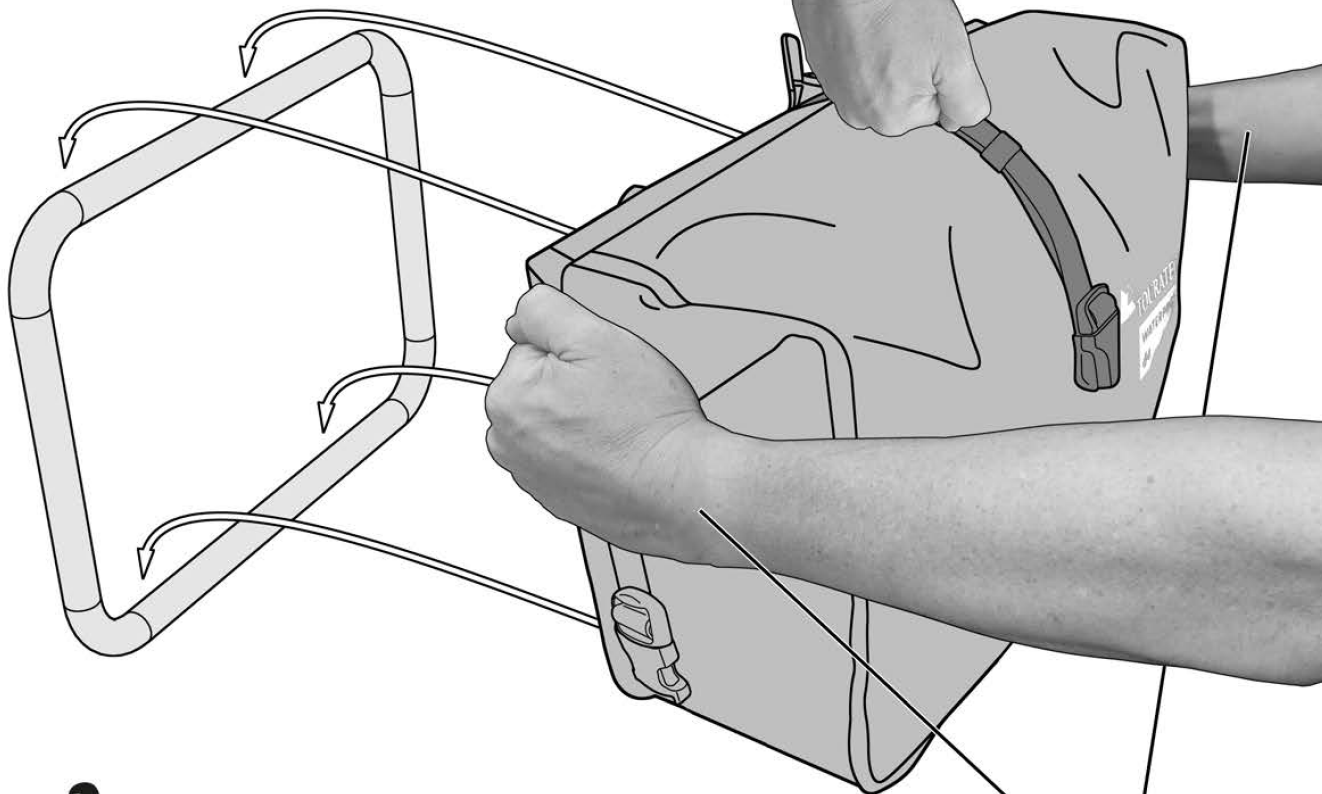

Vmax : 130 km/h

max : 10 kg per side pocket



Hang with both hands

Optional luggage lock 01-055-0601-0

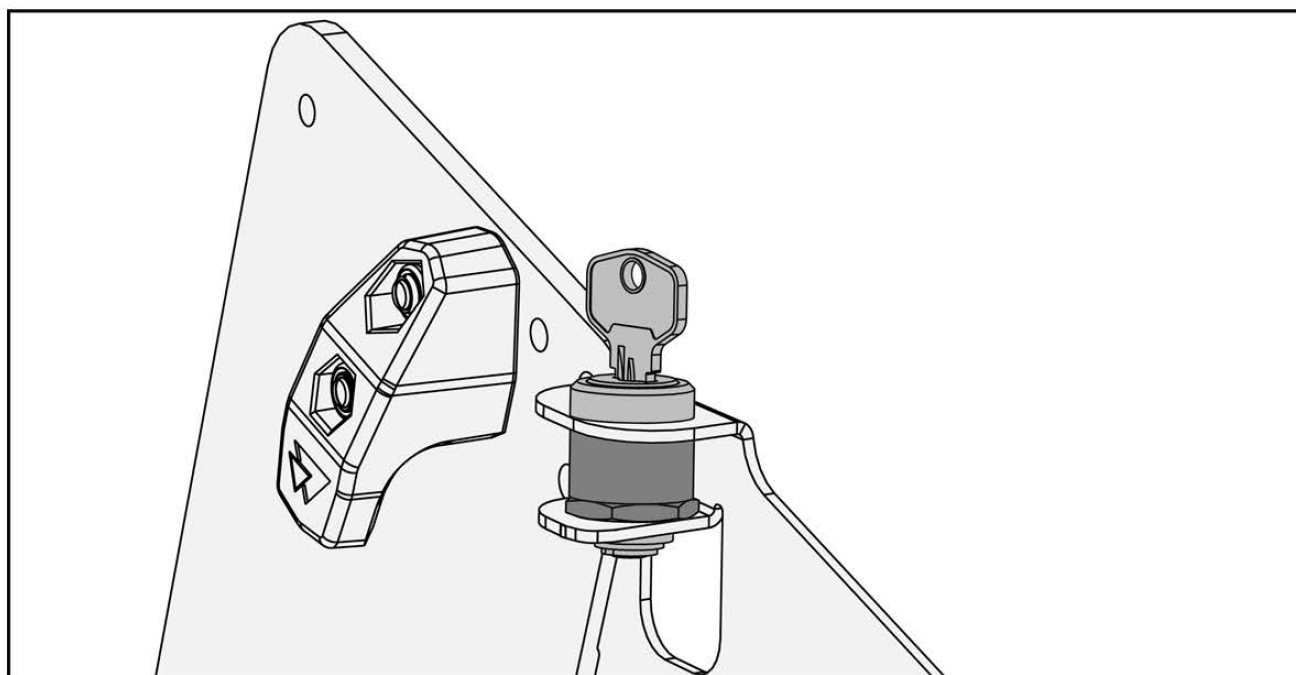
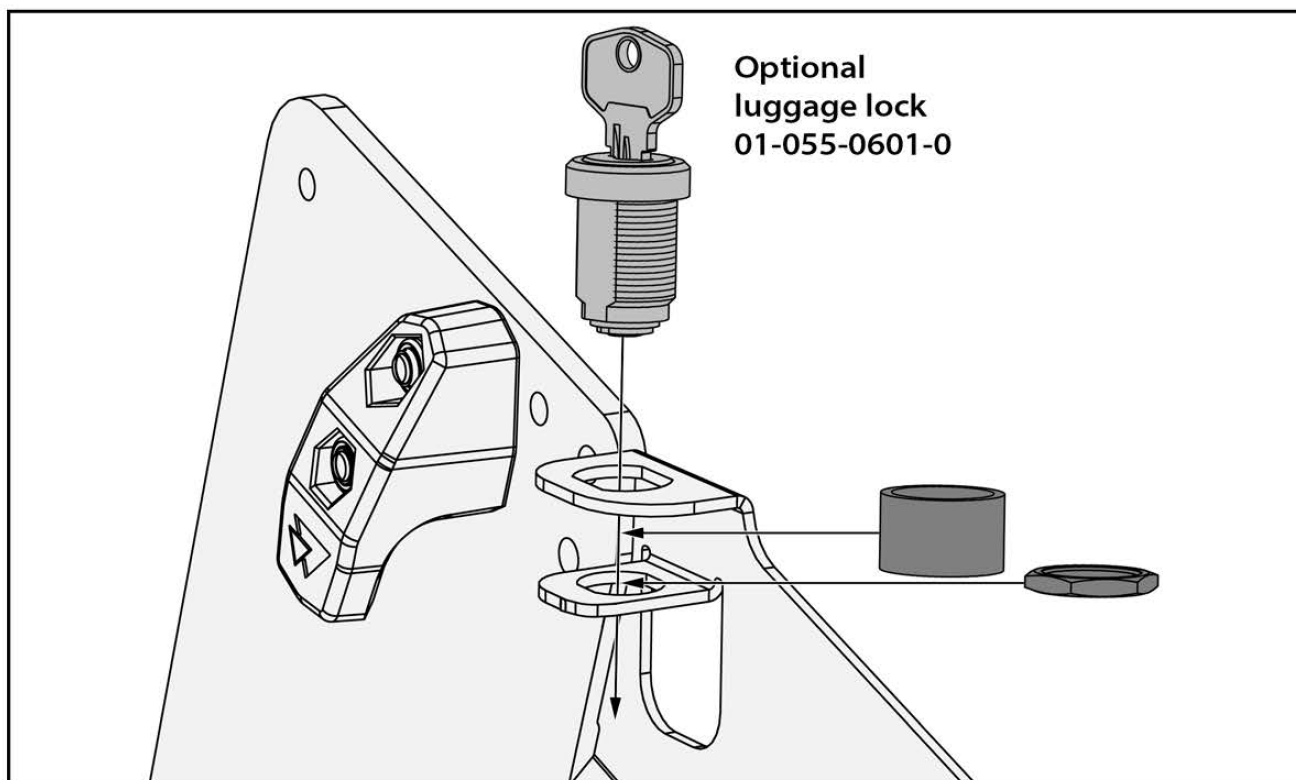

© April 2024 by: Touratech GmbH, Germany

Documents / Resources

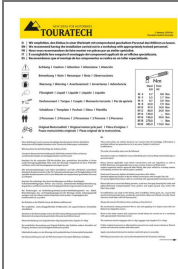

[TOURATECH R 1250 Road Prototype Build](#) [pdf] Instructions
R 1250 Road Prototype Build, R 1250, Road Prototype Build, Prototype Build, Build

References

- [User Manual](#)

Manuals+, Privacy Policy

This website is an independent publication and is neither affiliated with nor endorsed by any of the trademark owners. The "Bluetooth®" word mark and logos are registered trademarks owned by Bluetooth SIG, Inc. The "Wi-Fi®" word mark and logos are registered trademarks owned by the Wi-Fi Alliance. Any use of these marks on this website does not imply any affiliation with or endorsement.