

How to properly download upgrade firmware of CPE

Contents

- [1 How to properly download upgrade firmware of CPE](#)
- [2 Preparation](#)
- [3 Set up steps](#)
- [4 DOWNLOAD](#)
- [5 Related Posts](#)

How to properly download upgrade firmware of CPE

It is suitable for: **All TOTOLINK CPE**

Preparation

★ Before downloading files, please confirm the hardware version of your device and choose the corresponding firmware version to upgrade.

★ Wrong firmware version may damage your device and no warranty.

Set up steps

STEP-1: Guide for Hardware Version

For most TOTOLINK CPE, you can see two bar coded stickers at the front of the device, the character string started with Model No.(for example CP300) and ended with hardware Version (for example V2.0) is the serial number of your device.

See below:

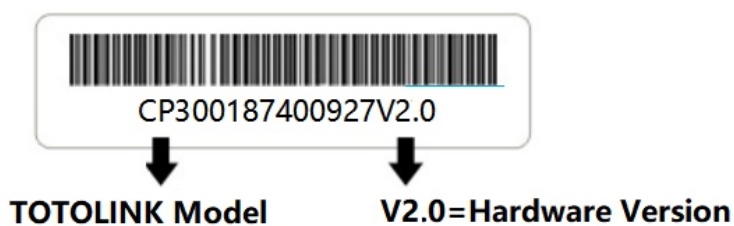

STEP-2:

Open browser, enter www.totolink.net Download the required files.

For example, if your hardware version is V2.0 , please download V2 version.

Note: If the hardware version is V1, V1 will be hidden.

TOTOLINK The Smartest Network Device

PRODUCTS SUPPORT ABOUTS US NEWS

CP300 Overview Tech Specs HD Image **Download**

NO	Name	Version	Updated	Download
1	CP300_QIG	Ver1.0		↓
2	CP300_datesheet	Ver1.0		↓
3	CP300 V2.0 Fireware	V2.0.4		↓

Hardware version (V2.0) **Firmware version** (V2.0.4)

PRODUCTS: Router, Adapter, Range Extender, CPE, Switch, PON SFUs & HGUs, Accessory, Powerline Adapter

SUPPORT: Download Center, FAQ, WEB Emulators, Video, APP, E-mail Technical Support

Factory & Lab, Contact us

COPYRIGHT © TOTOLINK ALL RIGHT RESERVED1 |

STEP-3:

Unzip the file, correct upgrade file name is suffixed with "**web**" or "**bin**" (except for some special models)

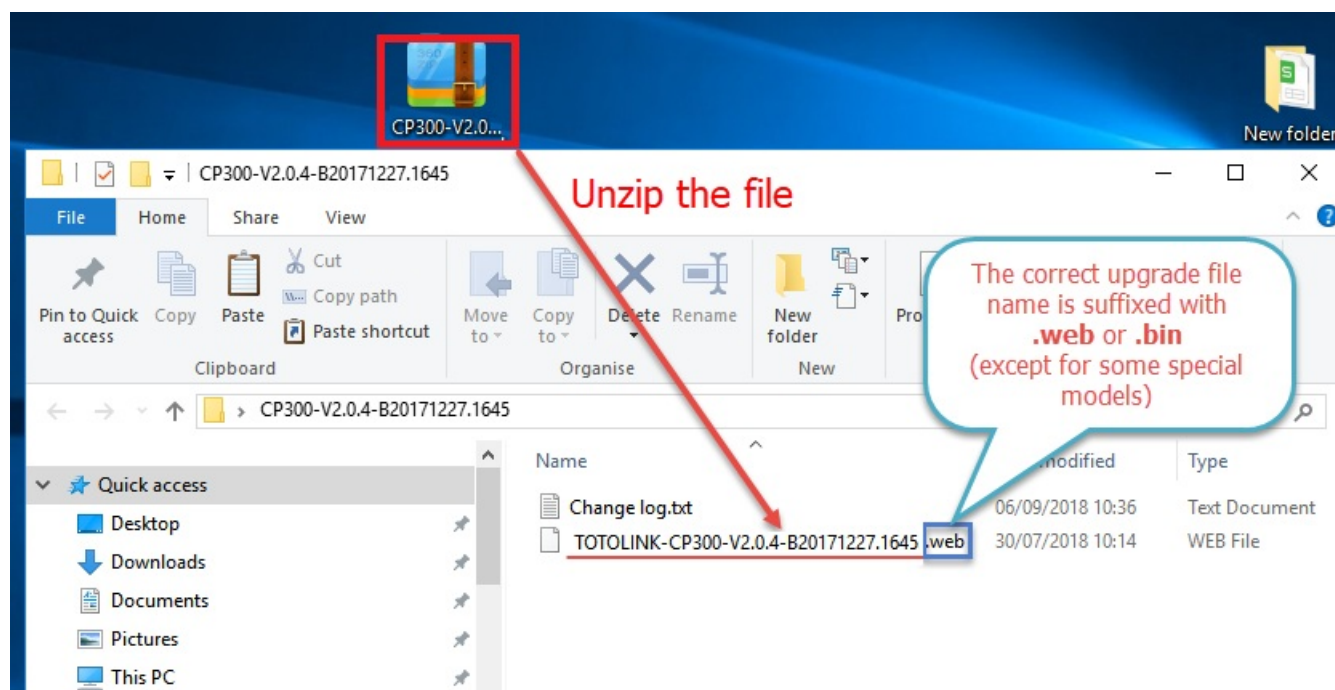

DOWNLOAD

How to properly download upgrade firmware of CPE – [[Download PDF](#)]