



TOSHIBA TW-BL85A2 Series Front Loading Washing Machine Owner's Manual

[Home](#) » [Toshiba](#) » TOSHIBA TW-BL85A2 Series Front Loading Washing Machine Owner's Manual 

Contents

- [1 TOSHIBA TW-BL85A2 Series Front Loading Washing Machine](#)
- [2 Product Information](#)
- [3 SAFETY INSTRUCTIONS](#)
- [4 INSTALLATION](#)
- [5 OPERATIONS](#)
- [6 MAINTENANCES](#)
- [7 Trouble Shooting](#)
- [8 Technical Specifications](#)
- [9 Documents / Resources](#)
- [10 Related Posts](#)

TOSHIBA

TOSHIBA TW-BL85A2 Series Front Loading Washing Machine



Product Information

The Front Loading Washing Machine is available in multiple models: TW-BL85A2 Series, TW-BL95A4 Series, TW-BL105A4 Series, and TW-BL115A2 Series. This washing machine comes with various features and options to provide efficient and convenient laundry care.

Contents

- Safety Instructions
- Installation
- Operations
- Maintenances

Safety Instructions

For your safety, it is essential to follow the instructions provided in this manual. Failure to do so may result in fire, electric shock, property damage, personal injury, or loss of life. The manual includes symbols to indicate potential dangers and corresponding signal words.

Installation

The installation process involves product description and proper setup.

Product Description

The washing machine consists of various components, including:

- Water supply hose

- Detergent dispenser
- Top cover
- Control panel
- Power supply cord
- Drum
- Door
- Drain pump filter
- Drain hose
- **Accessories:** Transport hole plug, supply hose cold water, drain hose support (optional), owner's manual, rat resistance spanner assembly, screw (optional), container (optional), panel (optional)

Installation Area

Ensure that the washing machine is installed in a suitable area.
Follow the recommended guidelines for spacing and ventilation.

Unpacking the Washing Machine

1. Remove the cardboard box and styrofoam packing.
2. Lift the washing machine and remove the base packing. Make sure the small triangle "W> 20mm" is aligned correctly.

Operations

The washing machine offers various operational features and programs for efficient use.

Quick Start

Refer to page 15 of the manual for quick start instructions.

Before Each Washing

Follow the guidelines provided on page 16 of the manual to prepare the washing machine before each use.

Detergent Dispenser

Page 17 of the manual provides information on how to use the detergent dispenser effectively.

Control Panel

Refer to page 18 of the manual for detailed instructions on using the control panel and selecting desired settings.

Option

Page 19 of the manual explains the available options and how to utilize them during washing cycles.

Programmes

The washing machine offers various programmed settings for different types of laundry. Refer to page 26 of the manual for details on available programs and their usage.

Maintenances

To ensure proper functioning and longevity of the washing machine, regular maintenance is required.

Cleaning and Care

Page 31 of the manual provides instructions on cleaning and care procedures for the washing machine.

Troubleshooting

If any issues arise during operation, refer to page 34 of the manual for troubleshooting guidelines.

Technical Specifications

For detailed technical specifications of the washing machine, refer to page 35 of the manual.

Read This Manual

- Read and follow the instructions carefully.
- Keep the operation instructions handy for future use .

SAFETY INSTRUCTIONS

Safety Instructions

- This appliance is not intended for use by persons (including children) with reduced physical, sensory or mental capabilities or lack of experience and knowledge unless they have been given supervision or instruction concerning use of the appliance by a person responsible for their safety.
- Children should be supervised to ensure that they do not play with the appliance.
- If the supply cord is damaged, it must be replaced by the manufacturer, its service agent or similarly qualified persons in order to avoid a hazard.
- The new hose sets supplied with the appliance are to be used and the old hose sets should not be reused.
- The openings must not be obstructed by a carpet.
- This appliance is intended to be used in households.
- The maximum permissible inlet water pressure is 1 MPa.

The minimum permissible inlet water pressure is 0.05 MPa.

For your safety, the information in this manual must be followed to minimize the risk of fire or explosion, electric shock, or to prevent property damage, personal injury or loss of life. Explanation of the symbols:

Warning!

This combination of symbol and signal words indicates a potentially dangerous situation that may result in death or serious injuries unless it's avoided.

Caution!

This combination of symbol and signal words indicates a potentially dangerous situation that may result in slight or minor injuries or damage to property and the environment.

Note!

This combination of symbol and signal word indicates a potentially dangerous situation which may result in slight or minor injuries

Warning!

The electric shock!

- If the supply cord is damaged, it must be replaced by the manufacturer, its service agent, or similarly qualified persons in order to avoid a hazard.
- The new hose-sets supplied with the appliance must be used and the old hose-sets must not be used.
- Before maintenance, unplug the appliance.
- Always unplug the machine and turn off the water supply after use. The standard inlet water pressure: 0.05MPa~1MPa.
- This appliance must be grounded. In the event of malfunction or breakdown, grounding will reduce the risk of electric shock by providing a path of least resistance for electric current.
- This appliance is equipped with a cord having an equipment-grounding conductor and grounding plug. The plug must be plugged into an appropriate outlet that is properly installed and grounded under all local codes and ordinances.

Improper connection for the appliance when using not grounded outlet or when the GND terminal of the outlet is not suitable with the GND terminal of the power plug, can result in a risk of electric shock. Check with a qualified electrician or service person if you are in doubt as to whether the appliance is properly grounded.

- Do not modify the plug provided with the appliance. If it does not fit the outlet, have a proper outlet installed by a qualified electrician.
- Make sure that the water and electrical devices are connected by a qualified technician following the manufacturer's instructions and local safety regulations.
- Pull out its plug from the power socket before cleaning or maintenance.
- Do not use any socket with a rated current less than that appliance. Never pull out the power plug with a wet hand.
- Please remember to disconnect the water and power supply immediately after the clothes are washed.

Risk to children!

- Pull out its plug from the power socket before cleaning or maintenance.
- Do not use any socket with a rated current less than that of the appliance. Never pull out the power plug with a wet hand.
- Please remember to disconnect the water and power supply immediately after the clothes are washed

Risk to children!

- The appliance can be used by children aged from 8 years and persons with reduced physical, sensory or mental capabilities or or lack of experience and knowledge if they have been given supervision or instruction concerning use of the appliance in a safe way and understand the hazards involved.
- Children shall not play with the appliance.
- Cleaning and user maintenance shall not be done by children without supervision.
- Children of less than 3 years should be supervised to ensure that they do not play with appliances.
- Animals and children may climb into the machine. Check the machine before every operation.
- Children should be supervised so that they do not play with the appliance.
- Pull out its plug from the power socket before cleaning or maintenance.
- Do not use any socket with a rated current less than that of the appliance. Never pull out the power plug with a wet hand.
- Please remember to disconnect the water and power supply immediately after the clothes are washed.
- Glass doors may be very hot during the operation. Keep children and pets far away from the machine during the operation.
- Remove all packages and transport bolts before using the appliance. Otherwise, serious damage may result.
- The plug must be accessible after installation.

Risk of explosion!

- Items that have been soiled with substances such as cooking oil, acetone, alcohol, petrol, kerosene, spot removers, turpentine, wax, and wax removers should be washed in hot with an extra amount of detergent.

Caution!

Installing the product!

- The appliance is for indoor use only.
- It isn't intended to be built-in using.
- The openings must not be obstructed by a carpet.
- The appliance shall not be installed in the bathroom or very wet rooms as well as in rooms with explosive or explosive corrosive gases.
- The appliance with a single inlet valve only can be connected to the cold water supply.
- The plug must be accessible after installation.
- The appliance must not be installed behind a lockable door, a sliding door or a door with a hinge on the opposite side to that of the washer dryer.

Remove all packages and transport bolts before using the appliance. Otherwise, serious damage may result.

Risk of damaging appliance!

- Your product is only for home use and is only designed

for the textiles suitable for machine washing.

- Do not climb up and sit on top cover of the machine.
- Do not lean against the machine door.
- Cautions in transporting the appliance:
 1. Transport bolts shall be reinstalled to the machine by a specialized person.
 2. The accumulated water shall be drained out of the machine.
 3. Handle the machine carefully. Never hold each protruded part on the machine while lifting. The machine door can not be used as the handle during the conveyance.
 4. This appliance is heavy. Transport with care.
 5. Hands shall not be inserted into the running drum.
- Please do not close the door with excessive force. If it is found difficult to close the door, please check if the clothes are put in or distributed well.
- It is forbidden to wash carpets.

Operating the appliance!

- Before washing the clothes at the first time, the product shall be operated in one round of the whole procedure without the clothes inside. The suggested program is "DRUM CLEAN".
- Flammable and explosive or toxic solvents are forbidden. Gasoline and alcohol etc. Shall not be used as detergents. Please only select the detergents suitable for machine washing, especially for front-load washing machines.
- Make sure that all pockets are emptied. Sharp and rigid items such as coins, brooches, nails, screws or stones, etc. may cause serious damage to this machine.
- Please check whether the water inside the drum has been drained before opening its door. Please do not open the door if there is any water visible.
- Be careful of burning when the product drains hot washing water.
- Never refill the water by hand during washing.
- After the program is completed, Please wait for two minutes to open the door.
- Fabric softeners, or similar products, should be used as specified by the fabric softener instructions.
- Remove all objects from pockets such as lighters and matches before using the appliance.

INSTALLATION

Product Description

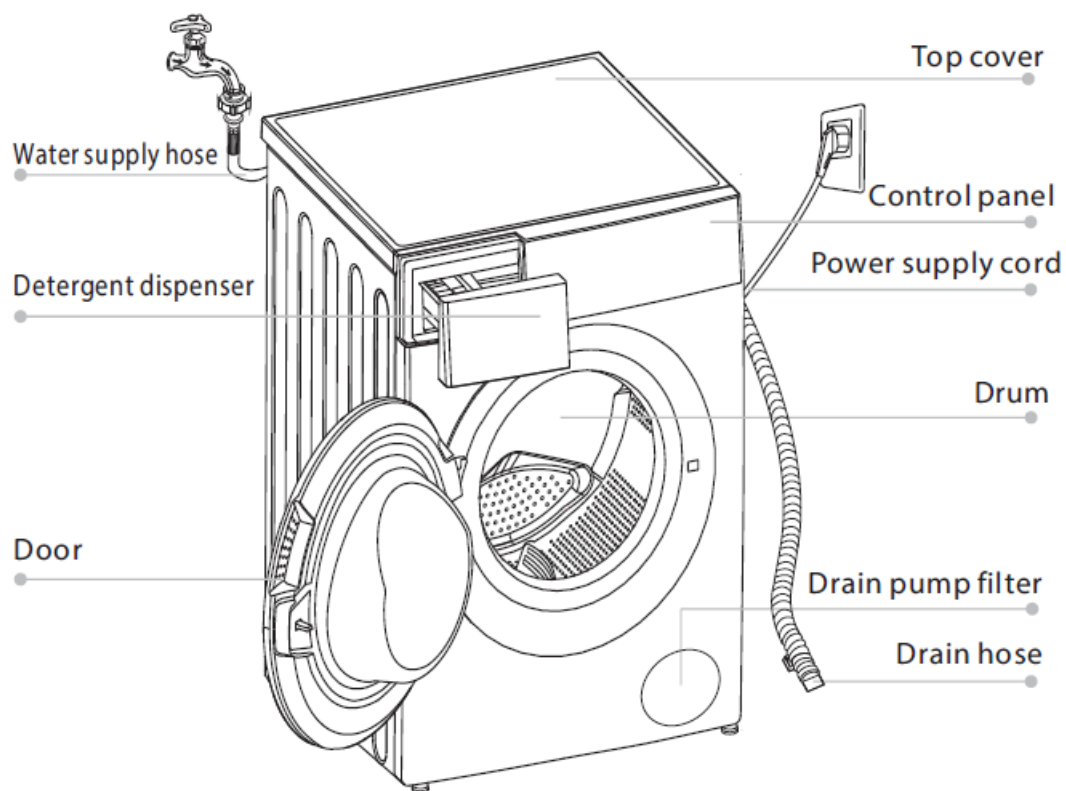

Note!

- The product line chart is for reference only, please refer to the real product as standard.

Accessories

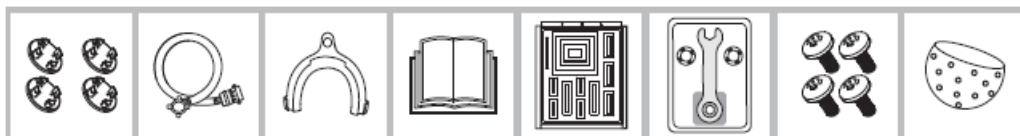

Installation area

Warning!

- Stability is important to prevent the product from wandering!
- Make sure that the product should not stand on the power cord.

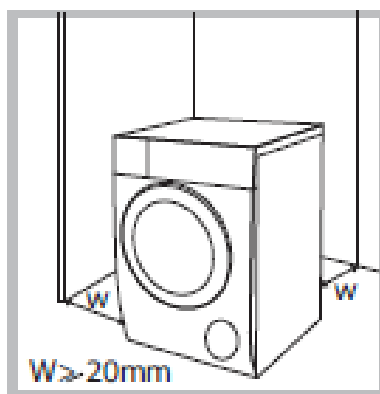

Before installing the machine, the location characterized as follows shall be selected:

1. Rigid, dry, and level surface
2. Avoid direct sunlight
3. Sufficient ventilation
4. Room temperature is above 0 C
5. Keep far away from the heat resources such as coal or gas.

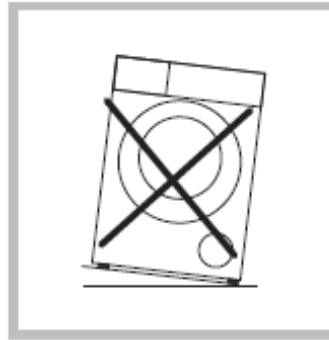

Unpacking the washing machine

Warning!

- Packaging material (e.g. Films, Styrofoam) can be dangerous for children.
- There is a risk of suffocation! Keep all packaging well away from children.

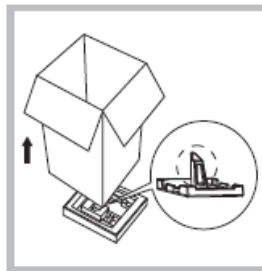

1. Remove the cardboard box and styrofoam packing.
2. Lift the washing machine and remove the base packing. Make sure the small triangle foam is removed with the bottom one together. If not, lay the unit down with side surface, then remove the small foam from the unit bottom manually.
3. Remove the tape securing the power supply cord and drain hose.
4. Remove the inlet hose from the drum.

Remove transport bolts

Warning!

- You must remove the transport bolts from the backside before using the product.
- You'll need the transport bolts again if you move the product, so make sure you keep them in a safe place.

Please take the following steps to remove the bolts:

1. Loosen 4 bolts with a spanner and then remove them.
2. Cover the hole with transport hole plugs.

3. Keep the transport bolts properly for future use.

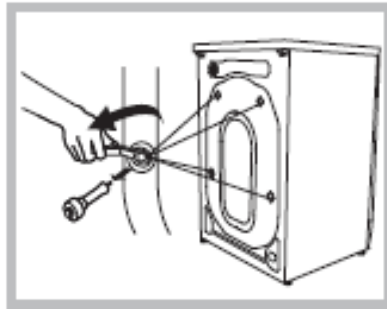

Levelling the washing machine

Warning!

- Check with the gradienter if the machine placement is balanced and steady.
- If there is no gradient, check the balance as per the following method.

1. If it's balanced from left to right.

- Take a long stick, and tie a rope at the end of it. Bind a heavy object at the end of the rope.
- Hang the rope from the top cover of the machine. Adjust the legs till the difference between 'a' and 'b' is less than 1cm.

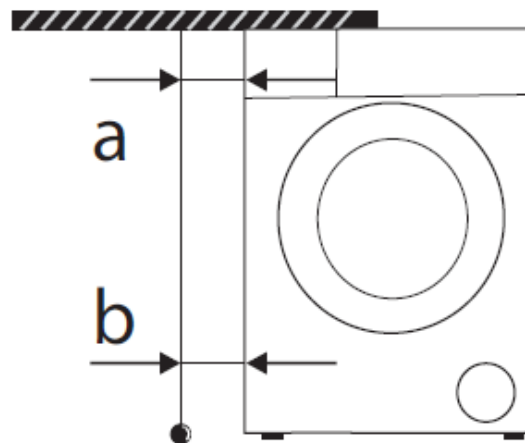

2. If it's balanced from front to back

- Put the stick at the middle of the control panel, and hang the rope in front of the machine.
- Keep 10cm away from the rope end to the control panel edge. Adjust the legs till 'c' is 3.5~4.5cm ('c' is the distance from rope to the bottom of the front cover).

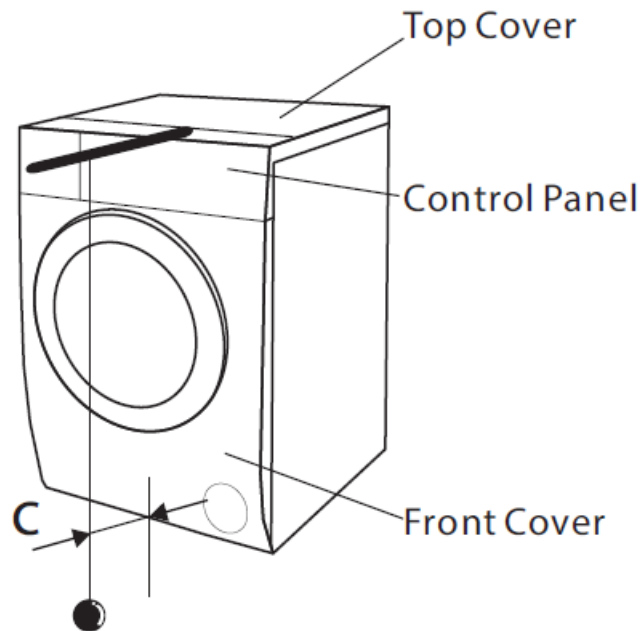

Warning!

- The lock nuts on all four feet must be screwed tightly against the housing.
1. Check if the legs are closely attached to the cabinet. If not, please turn them to their original positions and tighten the nuts.
 2. Loosen the lock nut turn the feet until it close contact with the floor.
 3. Adjust the legs and lock them with a spanner, making sure the machine is steady.

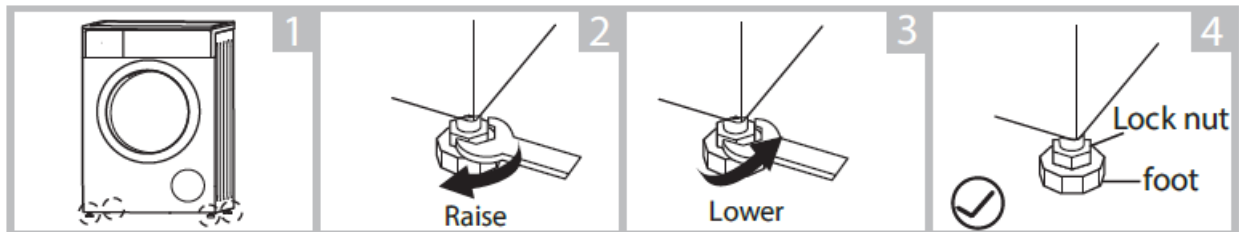

Connect Water Supply Hose

Warning!

- To prevent leakage or water damage, follow the instructions in this chapter
- Do not kink, crush, modify or sever water inlet hose.

Connect the inlet pipe as indicated, There are two ways to connect the inlet pipe.

1. Connection between ordinary tap and inlet hose.

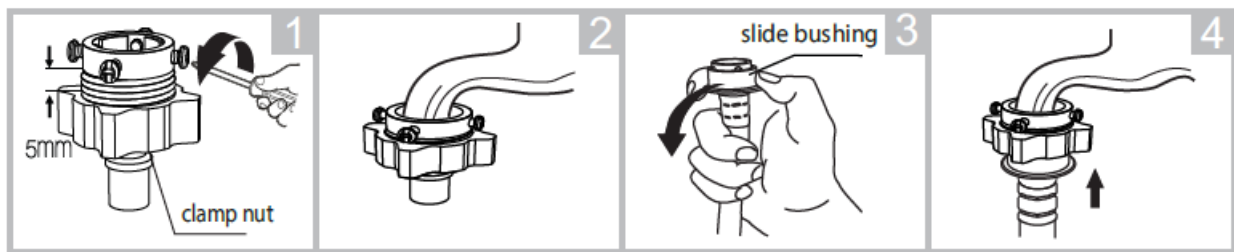

Loosen clamp nut and four bolts

Press the tap end tightly to the rubber ring inside the clamp, and then, tighten the 4 bolts

Press slide bushing, insert inlet hose into connecting base

Connection finished

2. Connection between screw tap and inlet hose

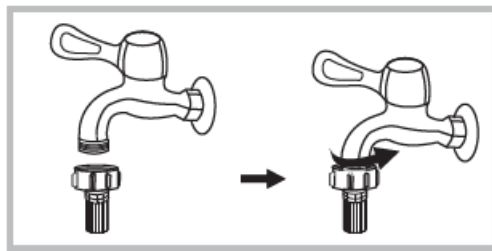

Tap with threads and inlet hose

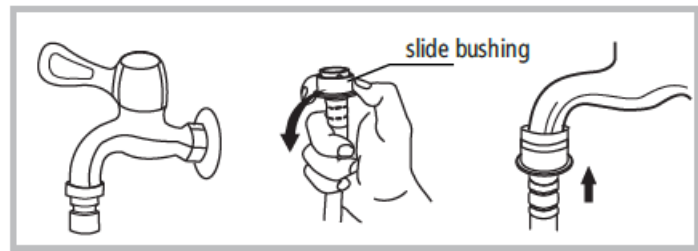

Special tap for washing machine

Connect the other end of the inlet pipe to the inlet valve at the backside of the product and fasten the pipe tightly clockwise

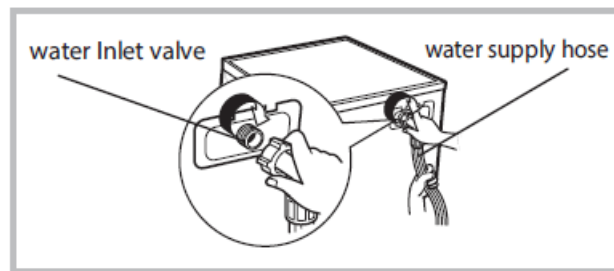

Drain Hose

Warning!

- Do not kink or protract the drain hose.
- Position the drain hose properly, otherwise, damage might result of water leakage.

There are two ways to place the end of the drain hose:

1. There are two ways to place the end of the drain hose:
2. Connect it to the branch drain pipe of the trough.

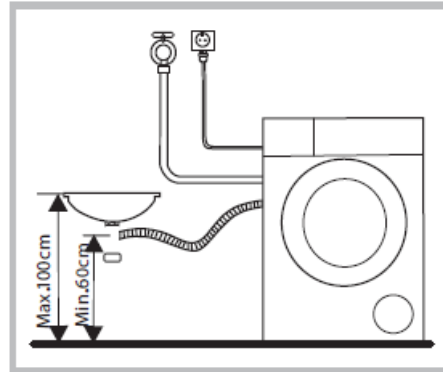
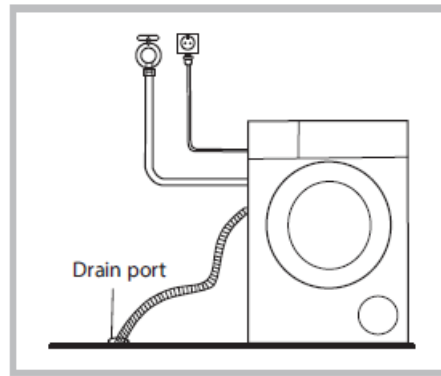

Note!

- If the machine has drain hose support, please install it like the following.

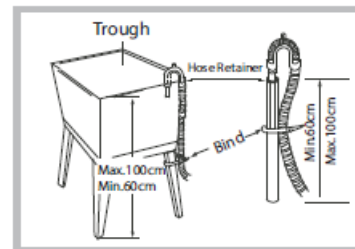
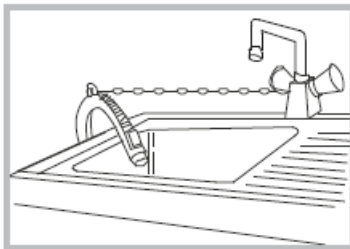

Warning!

- When installing a drain hose, fix it properly with a rope.
- If the drain hose is too long, do not force it into the washing machine as it will cause abnormal noises.

OPERATIONS

Quick Start Caution!

- Before washing, please make sure it's installed properly.
- Before washing at the first time, the washing machine shall be operated in one round of the whole procedure without clothes in as follows. The suggested program is "DRUM CLEAN".

Before Washing

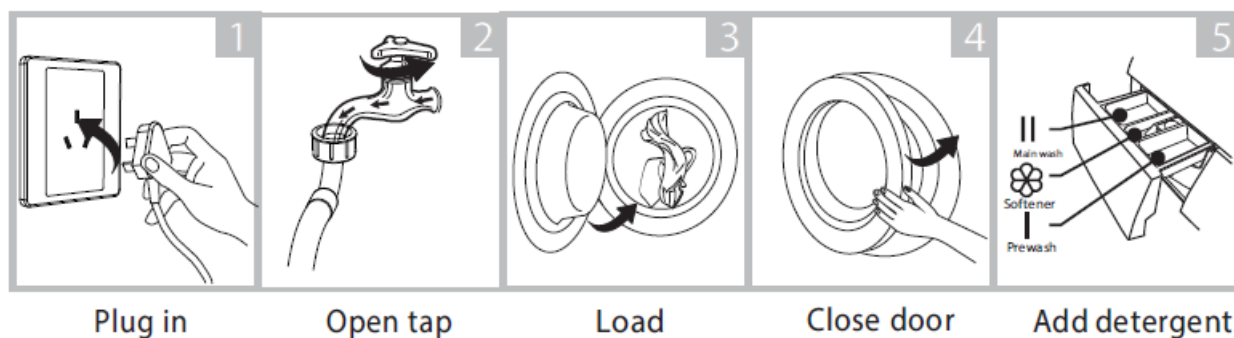

Note!

- Detergent only need to be added in “case I “after selecting pre-washing for machines with this function.

Washing

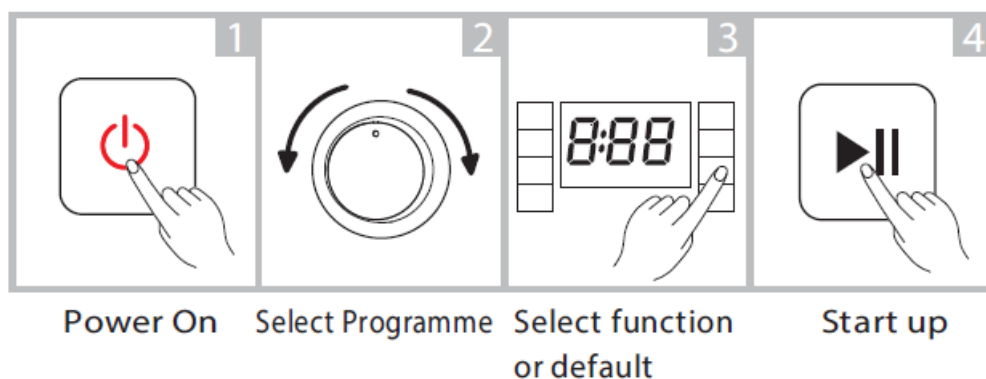

Note!

- If default is selected, step 3 can be skipped.

After Washing

Buzzer beep or “End” on display.

Before Each Washing

- The working condition of the washer should be (0-40)°C. If used under 0°C, the inlet valve and draining system may be damaged. If the machine is placed under a condition of 0°C or less, then it should be transferred to normal ambient temperature to ensure the water supply hose and drain hose are not frozen before use.
- Please check the labels and the explanation of using detergent before wash. Use non-foaming or less-foaming detergent suitable for machine washing properly.

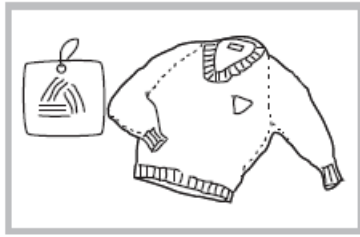

Check the label

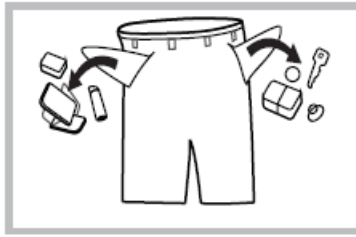

Take out the items out of the pockets

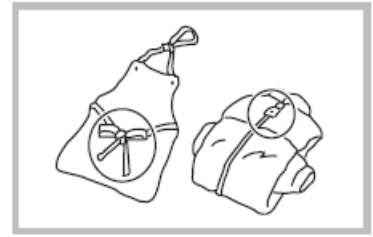

Knot the longstrips,zip or button

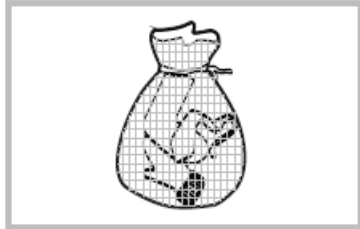

Put small clothes into the pillow slip



Turn easy-pilling and long-pile fabric inside out

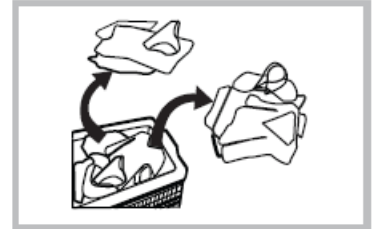





Separate clothes with different textures

Warning!

- When washing a single clothes, it may easily cause great imbalance and give alarm. Therefore it is suggested to add one or two more clothes to be washed together so that the washing process can be done smoothly.
- Don't wash the clothes soaked in kerosene, gasoline, alcohol and other flammable materials.

Detergent Dispenser

-  Pre-wash
-  Main wash
-  Softener
-  Release the button to pull out the dispenser

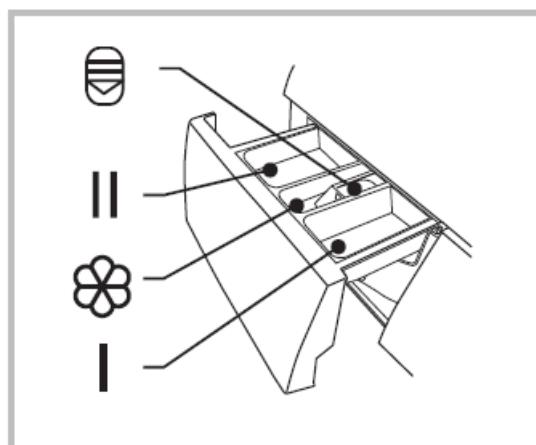

Caution!

- To prevent the powder detergent from remaining in the dispenser under low water pressure, charge the powder detergent into the container, then put the container into the drum.

- Detergent only need to be added in “case I “after selecting pre-washing for machines with this function.

Programme	I	II	☼	Programme	I	II	☼
COTTON	○	●	○	STEAM WASH	○	●	○
GREATWAVES	○	●	○	SPORTSWEAR		●	○
MIX	○	●	○	WOOL		●	○
RINSE&SPIN			○	ECO WASH		●	○
SPIN ONLY				WASH 45'		●	○
DRUM CLEAN				QUICK 15'		●	○

- ● Means must
- ○ Means optional

Note!

- As for the agglomerated or ropy detergent or additive, before they are poured into the detergent box, it is suggested to use some water for dilution to prevent the inlet of the detergent box from being blocked and overflowing while filling water.
- Please choose the suitable type of detergent for the various washing temperatures to get the best washing performance with less water and energy consumption.

Control Panel

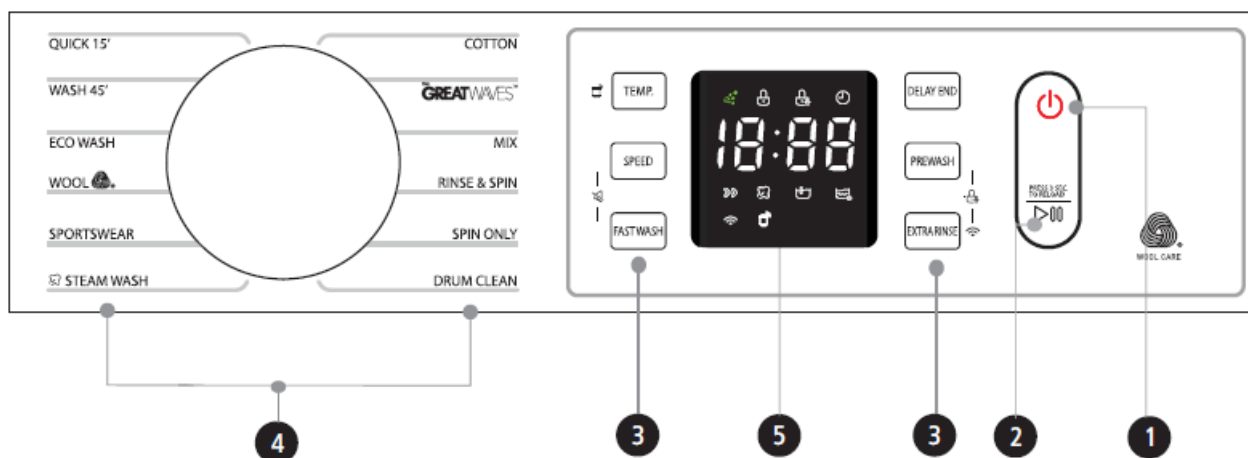

Note!

- The chart is for reference only, Please refer to real product as standard.

1. On/Off

The product is switched on or off.

2. Start/Pause

Press the button to start or pause the washing cycle.

3. Option

This allows you to select an additional function and will light when selected.

4. Programmes

Available according to the laundry type.

5. Display

The display shows the settings, estimated time remaining, options, and status messages for your washer. The display will remain on through the cycle.

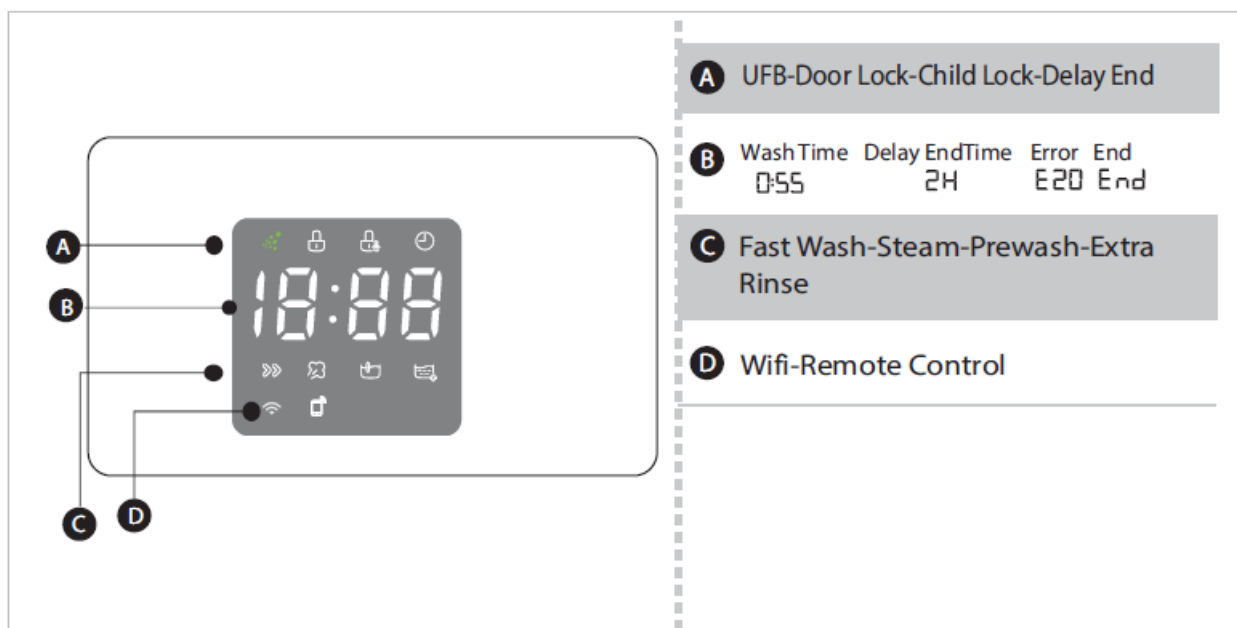

Option

PREWASH

The Prewash function can get an extra wash before the main wash, it is suitable for washing the dust that rises to the surface of the clothes; You need to put detergent into Case (I) when selecting it.

EXTRA RINSE

The laundry will undergo an extra rinse once after you select it.

FAST WASH

The function can decrease the washing time.

DELAY END

Set the Delay end function:

1. Select a programme
2. Press the DELAY END button to choose the time (the delaying end time is 1-24 H.)
3. Press [Start/Pause] to commence the delay operation

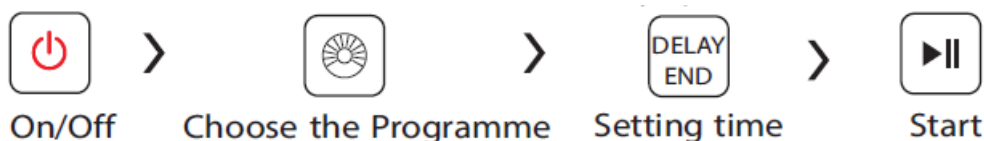

Cancel the Delay function:

Press the DELAY END button until the display is 0H. It should be pressed before starting the program. If the programme already started, should press the button to reset the programme

STEAM

Steam function is only selectable from the app. For the program STEAM WASH, the steam function is on by default

Caution!

- If there is any break in the power supply while the machine is operating, a special memory stores the selected programme and when the power is restarted, press the [Start/Pause] button the program will continue (for some machines you can directly run the previous program without pressing the [Start/Pause] button).

OPERATIONS

Programme	Option				
	FAST WASH	DELAY END	PREWASH	EXTRA RINSE	STEAM
COTTON	<input type="radio"/>	<input type="radio"/>	<input type="radio"/>	<input type="radio"/>	<input type="radio"/>
GREAT WAVES	<input type="radio"/>	<input type="radio"/>	<input type="radio"/>	<input type="radio"/>	
MIX	<input type="radio"/>	<input type="radio"/>	<input type="radio"/>	<input type="radio"/>	<input type="radio"/>
RINSE & SPIN		<input type="radio"/>		<input type="radio"/>	
SPIN ONLY		<input type="radio"/>			
DRUM CLEAN		<input type="radio"/>			
STEAM WASH	<input type="radio"/>	<input type="radio"/>	<input type="radio"/>		<input checked="" type="radio"/>
SPORTSWEAR		<input type="radio"/>		<input type="radio"/>	
WOOL		<input type="radio"/>		<input type="radio"/>	
ECO WASH		<input type="radio"/>		<input type="radio"/>	
WASH 45'		<input type="radio"/>		<input type="radio"/>	
QUICK 15'		<input type="radio"/>			

- “○” Means selectable, ● Means default ON
- STEAM is only selectable from the app.
- For the program STEAM WASH, the steam function is on by default

Other Functions

RELOAD



- This operation can be executed during the washing progress. When the drum is still rolling and there is a large amount of water with a high temperature in the drum. The state is unsafe and the door cannot be opened forcefully. To press [Start/Pause] for 3 sec. to reload, and start the clothes adding in the midway function. Please follow the steps as below:

1. Wait until the drum stops rotation.

- The door lock is unlocked.
- Close the door when the clothes are reloaded and press the [Start/Pause] button.

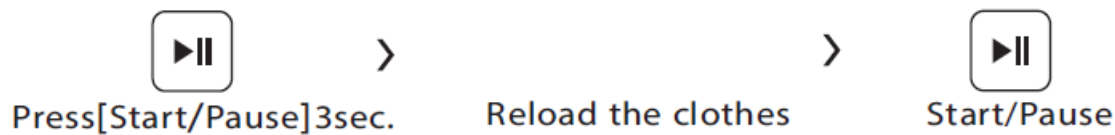

Caution!

- Don't use the Reload function when the water level is over the lower edge of the door or the water temperature is high

CHILD LOCK

To avoid misoperation by children.

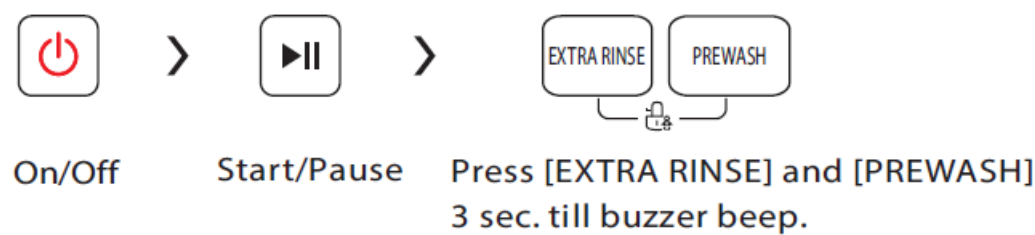

Caution!

- Press the two button 3sec. also to release the function.
- The “Child Lock” will lock all buttons except [On/Off].
- The child lock will remain effective when the power is resumed.

SPEED

- Press the [SPEED] button to change the spin speed.
- You can also turn off the WiFi function by pressing the button for 3 seconds.

Program	Default Speed(rpm)	Program	Default Speed(rpm)
COTTON	800	STEAM WASH	1000
GREAT WAVES	1000	SPORTSWEAR	800
MIX	800	WOOL	600
RINSE & SPIN	1000	ECO WASH	800
SPIN ONLY	1000	WASH 45'	800
DRUM CLEAN	—	QUICK 15'	800

TEMP.

Press the button to regulate the temperature(Cold,20°C 30°C, 40°C 60°C 90°C
The display shows “—” means the temperature is cold.



• **MUTE THE BUZZER**

Press the [SPEED] and [FAST WASH] buttons for 3sec., the buzzer is mute.

To act the buzzer function, press the button again for 3 seconds. The setting will be kept until the next reset.

Caution!

- After Muting the buzzer function, the sounds will not be activated anymore.



• **UFB Function**

- Ultra Fine Bubble (UFB) is an invisibly small Nano size air bubble that is smaller than a fiber gap of cotton.
- UFB delivers surfactants to stains deep inside the cloth. Thus UFB promotes the easy removal of stains.
- All washing programs with the UFB function.



• **WiFi**

Press [EXTRA RINSE] 3 seconds, and the washing machine will be connected to the internet on your smartphone. The details of the Wi-Fi connection, please check the next page. This is the Wi-Fi switch if you want to make your appliance connect to the internet. You need to turn on the “Wi-Fi” button.



• **Remote Control**

This is the switch of the remote control, if you want to use your smartphone to control the washing machine remotely, you need to hold [TEMP.] 3seconds. Considering the safe operation of washing machines, the The smartphone remote control should meet the following conditions:

1. The appliance should connect to the internet;
2. The door of the drum should be closed. Remark:
 - If the door is open in any time, the remote control function will be a failure.
 - The remote control function is turned off at the end of each cycle automatically,
 - if you want to use the remote control function again, you need to turn on it again

Instructions to Connection with the TSmartLife App

Before you start, make sure that:

1. Your smartphone is connected to home WiFi network, and you know the network password.
2. Make sure you are near the home appliance.
3. The 2.4GHz band wireless signal is enabled on your wireless router.

Follow the below steps to enter the remote control state

Download the TSmartLife App

On an app market (Google Play Store, Apple App Store), search for “TSmartLife” and find the TSmartLife app. Download and install it on your phone. You can also download the app by scanning the QR code below.



Register and log in

Open the TSmartLife app, and create a new account to start (you can also register through a third-party account). If you already had an existing account, use the account to log in.



Connect your devices to TSmartLife

1. Please make sure your mobile phone is connected to WiFi. If not, go to Settings and turn on the wireless connection, select and connect to a WiFi. Also please turn on the Bluetooth on your phone. If not, goto Settings and turn it on.
2. Please power on your devices.
3. Open the TSmartLife app on your phone.
4. If a message of "Smart devices discovered nearby" appears, click to add.



5. If no message appears, select "+" on the page and select your device in the list of nearby devices available. If your device is not listed, please add your device manually by the device category and device model.



6. Connect your device to WiFi according to the instructions on app. If the connection fails, please follow the instructions provided by the app to continue with the operation.



WiFi Status Light

	Slowly flashing	Waiting for connection
	Quickly flashing	Connecting
	Quickly flashing solid	Connected to your wireless router

Notes

- Make sure your devices are powered on.
- Keep your mobile phone close enough to your device when you are connecting the network to your device.
- Connect your mobile phone to the wireless network at home, and make sure you know the password of the WiFi.
- Check if your router supports 2.4 GHz WiFi band and turn it on. If you are not sure whether the router supports 2.4 GHz band, please contact the router manufacturer.
- The device cannot connect to the WiFi that requires authentication, and it usually appears in public area such as hotels, restaurants, etc. Please connect to a WiFi that does not require authentication.
- It is recommended to use a WiFi name that only contains letters and numbers. If your WiFi name contains special characters, please modify it in the router.
- Turn off the WLAN+ (Android) or WLAN Assistant (iOS) function of your mobile phone when connecting network to your devices.
- In the case that your device connected to WiFi before but it needs to reconnect, please click “+” on app Home page, and add your device again by the device category and model according to the instructions on app.

Programs are available according to the laundry type.

COTTON	Hard-wearing textiles, heat-resistant textiles made of cotton or linen.
MIX	Mixed load consisting of textiles made of cotton and synthetics.
GREATWAVES	Can washing brightly colored clothes, it can protect the colors better. Lower temp. water still achieve great cleaning performance.
ECO WASH	This program is suitable for energy saving wash
WASH 45'	This programme is suitable for washing not very dirty clothes, save more energy and washing time.
QUICK 15'	This procedure is suitable for washing few and not very dirty clothes quickly.
SPIN ONLY	Extra spin with selectable spin speed.
WOOL	Hand or machine-washable wool or richwool textiles. Especially gentle wash programme to prevent shrinkage, longer programme pauses .
RINSE & SPIN	Extra rinse with spin.
DRUM CLEAN	This program is specially set in this machine to clean the drum and tube. It applies 90°C high temperature sterilization to make the drum and tube more clean. When this procedure is performed, the clothes or other washing cannot be added. When proper amount of chlorine bleaching agent is put in, the barrel cleaning effect will be better. The customer can use this procedure regularly according to the need.
STEAM WASH	Steam is applicable for daily laundries. The steam can deeply penetrate the fiber, which effectively eliminates bacteria and germs, preventing odors and protecting your health.
SPORTSWEAR	Washing the activewear.

- The wool wash cycle of this machine has been approved by The Woolmark Company for the washing of machine-washable wool products provided that the products are washed according to the instructions on the garment label and those issued by the manufacturer of this washing machine.
- M1906-10kg and 10.5kg.
- M1709-9kg and 9.5kg.
- M1661-8kg and 8.5kg.
- M2134-6kg, 7kg, and 7.5kg.

Washing Programmes Table

Program	Load(kg)	Temp.(°C)	Default Time
	10.5	Default	10.5
			1200
COTTON	10.5	40	1:18
GREAT WAVES	5.0	20	3:47
MIX	10.5	40	1:10
RINSE & SPIN	10.5	–	0:20
SPIN ONLY	10.5	–	0:12
DRUM CLEAN	–	90	1:18
STEAM WASH	5.0	40	1:48
SPORTSWEAR	5.0	20	0:45
WOOL	2.0	40	1:07
ECO WASH	2.0	30	0:57
WASH 45'	2.0	30	0:45
QUICK 15'	2.0	Cold	0:15

Note!

The parameters in this table are only for the user's reference. The actual parameters may be different with the parameters in above mentioned table.

Washing Programmes Table

Programme	Load(kg)	Temp.(°C)	Default Time
	9.5	Default	9.5
			1400
COTTON	9.5	40	1:18
GREATWAVES	4.5	20	3:47
MIX	9.5	40	1:10
RINSE & SPIN	9.5	–	0:20
SPIN ONLY	9.5	–	0:12
DRUM CLEAN	–	90	1:18
STEAM WASH	4.5	40	1:48
SPORTSWEAR	4.5	20	0:45
WOOL	2.0	40	1:07
ECO WASH	2.0	30	0:57
WASH 45'	2.0	30	0:45
QUICK 15'	2.0	Cold	0:15

Note!

- The parameters in this table are only for the user's reference. The actual parameters may be different with the parameters in above mentioned table.

Washing Programmes Table

Program	Load(kg)	Temp.(°C)	Default Time
	8.5	Default	8.5
			1400
COTTON	8.5	40	1:18
GREAT WAVES	4.0	20	3:47
MIX	8.5	40	1:10
RINSE & SPIN	8.5	–	0:20
SPIN ONLY	8.5	–	0:12
DRUM CLEAN	–	90	1:18
STEAM WASH	4.0	40	1:48
SPORTSWEAR	4.0	20	0:45
WOOL	2.0	40	1:07
ECO WASH	2.0	30	0:57
WASH 45'	2.0	30	0:45
QUICK 15'	2.0	Cold	0:15

Note!

The parameters in this table are only for the user's reference. The actual parameters maybe different from the parameters in above mentioned table.

Program	Load(kg)	Temp.(°C)	Default Time
	7.5	Default	7.5
			1200
COTTON	7.5	40	1:18
GREAT WAVES	3.5	20	3:47
MIX	7.5	40	1:10
RINSE & SPIN	7.5	–	0:20
SPIN ONLY	7.5	–	0:12
DRUM CLEAN	–	90	1:18
STEAM WASH	3.5	40	1:48
SPORTSWEAR	3.5	20	0:45
WOOL	2.0	40	1:07
ECO WASH	2.0	30	0:57
WASH 45'	2.0	30	0:45
QUICK 15'	2.0	Cold	0:15

Note!

The parameters in this table are only for the user's reference. The actual parameters may be different from the parameters in above mentioned table.

MAINTENANCES

Cleaning And Care

Warning!

- Before your maintenance starts, please unplug the machine and close the tap.

Cleaning The Cabinet

Proper maintenance on the washing machine can extend its working life. The surface can be cleaned with diluted non-abrasive neutral detergents when necessary. If there is any water overflow, use the dry cloth to wipe it off immediately. No sharp items are allowed.



Note!

- Formic acid and its diluted solvents or equivalent are forbidden, such as alcohol, solvents or chemical products, etc.

Cleaning The Drum

The rusts left inside the drum by the metal articles shall be removed immediately with chlorine-free detergents. Never use steel wool.

Note!

Don't put laundry in the washing machine during the drum cleaning.

Cleaning The Gasket And Glass

Wipe the glass and gasket after each wash to remove lint and stains. If lint builds up it can cause leaks. Remove any coins, buttons and other objects from the gasket after each wash.

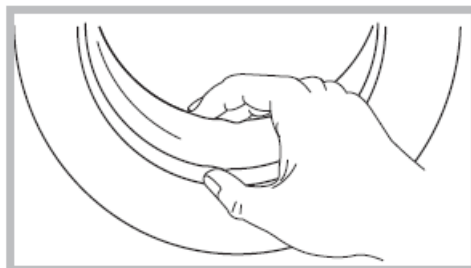

Cleaning The Inlet Filter

Note!

- The inlet filter must be cleaned if there is less water.

Washing the filter in the water supply hose

1. Close the tap.
 2. Remove the water supply hose from the tap.
 3. Clean the filter.
 4. Reconnect the water supply hose.
- Cleaning The Inlet Filter
 - The inlet filter must be cleaned if there is less water.

Washing the filter in the washing machine:

1. Screw off the inlet pipe from the backside of the machine.
2. Pull out the filter with long nose pliers and reinstall it after being washed.
3. Use the brush to clean the filter.
4. Reconnect the inlet pipe.

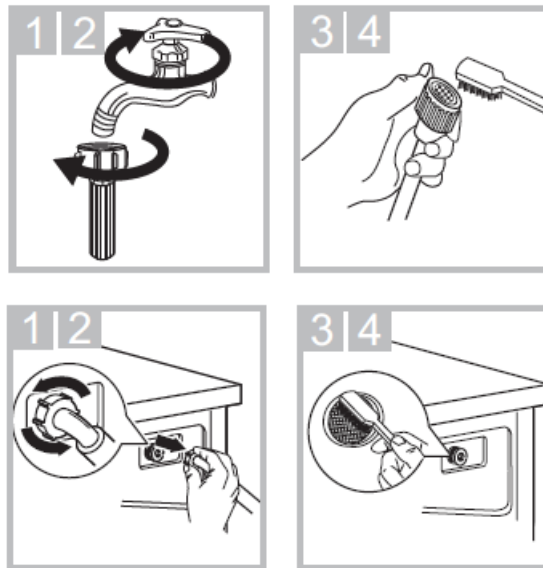

Clean The Detergent Dispenser

1. Press down the arrow location on the softener cover inside the dispenser drawer.
2. Lift the clip up take out the softener cover and wash all grooves with water.
3. Restore the softener cover and push the drawer into position.

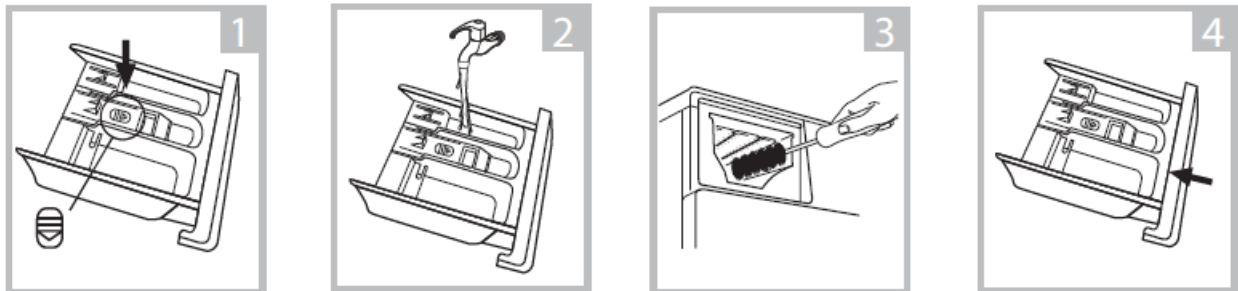

Note!

- Do not use alcohol, solvents or chemical products to clean the machine.

Cleaning The Drain Pump Filter

Warning!

- Be careful of the hot water!
- Allow the water to cool down.
- Unplug the machine to avoid electrical shock before maintenance.
- Drain pump filter can filter the lints and small foreign matter from the washing.
- Clean the filter periodically to ensure the normal operation of the washing machine.

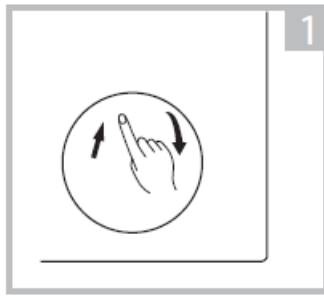

Open the lower cover cap

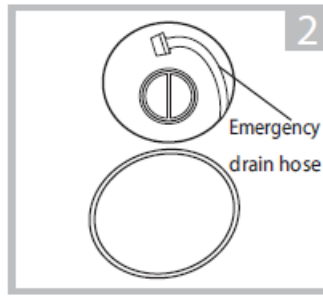

Pull out the emergency drain hose, and take off the hose cap

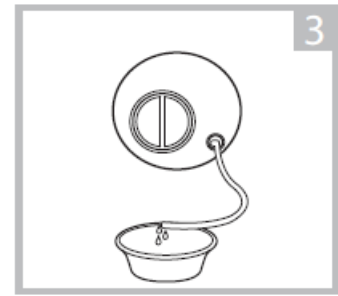

After water runs out, reset the drain hose

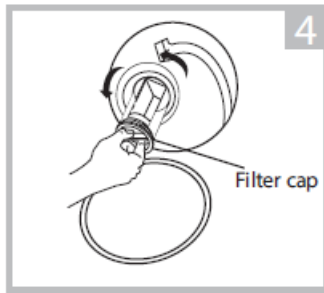

Open the filter cap by turning to the counter clockwise

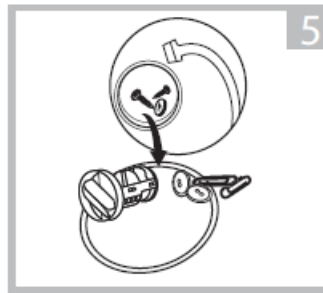

Remove extraneous matter

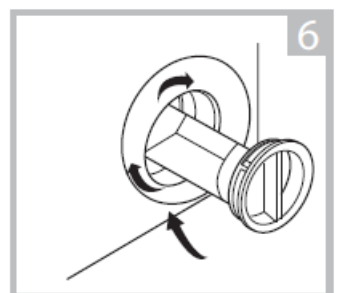

Close the filter cap and the lower cover cap

Caution!

- Make sure that filter cap and emergency drain hose are reinstalled properly, filter cap should be inserted aligning to hole plates otherwise water may leak.
- When the appliance is in use and depending on the program selected there can be hot water in the pump. Never remove the pump cover during a wash cycle, always wait until the appliance has finished the cycle, and is empty. When replacing the filter cap, ensure it is securely re-tightened.

Trouble Shooting

The start of the appliance does not work or it stops during operation. First try to find a solution to the problem, If not, contact the service centre.

Description	Reason	Solution
Washing machine cannot start up	Door is not closed properly	Restart after the door is closed Check if the clothes is stuck
Door can't be opened	Washer's safety protection design is working	Disconnect the power, restart the product
Water leakage	The connection between inlet pipe or outlet hose is not tight	Check and fasten water pipes Check outlet hose
Detergent residues in the box	Detergent is dampened or agglomerated	Clean and wipe the detergent box
Indicator or display does not light	Electrical power cord may not be plugged in or connection may be loose.	Make sure plug fits tightly in wall outlet. Check the power plug is connected correct.
Abnormal noise		Check if the fixing (bolts) have been removed Check it's installed on a solid and level floor

Description	Reason	Solution
E30	Door is not closed properly	Restart after the door is closed Check if the clothes is stuck
E10	Water injecting problem while washing	Check if the water pressure is too low Straighten the water pipe Check if the inlet valve filter is blocked
E21	Overtime water draining	Check if the drain hose is blocked
E12	Water overflow	Stop using the washing machine and call the service center for repair
EXX	Others	Please try again first, call up service line if there are still troubles

Note!

After the check, activate the appliance. If the problem occurs or the display shows other alarm codes again, contact the service.

Technical Specifications

Power Supply: 220-240V~,50Hz

MAX.Current: 10A

Standard Water Pressure: 0.05MPa~1MPa

Model	Washing Capacity	Dimension (W*D*H mm)	Net Weight	Rated Power
TW-BL115A2 Series	10.5kg	595*605*850	62kg	1950W
TW-BL105A4 Series	9.5kg	595*630*850	71kg	1950W
TW-BL95A4 Series	8.5kg	595*630*850	68kg	1950W
TW-BL85A2 Series	7.5kg	595*475*850	57kg	1950W

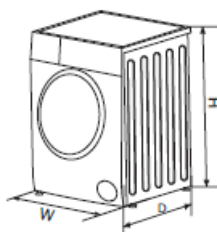

Documents / Resources

<div><div>TOSHIBA</div><div>FRONT LOADING WASHING MACHINE</div><div>OWNER'S MANUAL</div><div>MODEL: TW-BL85A2 Series TW-BL85A2 Series TW-BL105A2 Series TW-BL105A2 Series</div><div>Read This Manual Read carefully for safe and correct use. Proper use, maintenance and cleaning are essential.</div></div>	<p>TOSHIBA TW-BL85A2 Series Front Loading Washing Machine [pdf] Owner's Manual TW-BL85A2 Series Front Loading Washing Machine, TW-BL85A2 Series, Front Loading Washi ng Machine, Loading Washing Machine, Washing Machine, Machine</p>
---	--