



Contents [[hide](#)]

[1 TOSHIBA AS3 Application](#)

[2 Connections](#)

[3 Explanation](#)

[4 Programming](#)

[5 Verification](#)

[6 Documents / Resources](#)

[6.1 References](#)

TOSHIBA

TOSHIBA AS3 Application



Sleep Function (Non-PID control)

How to program and operate AS3 with the sleep function

Estimated Time: 15 Minutes

Level: 2

Prerequisite:

AS3 Application Note 1.1.1

Navigating Menus & Parameters

Connections

STEP A

The sleep function on the VFAS3 is used for energy saving and elongating the lifespan of the motor. This function puts the drive to sleep when there is no demand for mass flow, which would decrease the run time for the motor and prolong the lifespan.

Sleep function over a run cycle per respective diagram below.

run command is turned OFF.

Check Your Work

Check your understanding of the condition required to enable or disable the Sleep function.

Programming

STEP C

Program the Lower Limit Frequency.

The lower limit frequency will determine the frequency at which the drive will go to sleep.

Parameter	Description	Default Value	New Value
F013	LL: Lower Limit Frequency	0.0	Choose New LL Value

Program the Sleep detection time.

The drive will need to run at the lower limit for the set period of time to go into a sleep state.

Parameter	Description	Default Value	New Value
F256	Sleep Detection Time	0.0	Choose New Value

(If applicable) Program the Sleep detection hysteresis. This will be the threshold value that will awake the drive from the sleep cycle.

Parameter	Description	Default Value	New Value
F391	Sleep Detection Hysteresis	0.0	Choose New Value

(If applicable) Program the Sleep detection time at startup. This will automatically stop the drive upon start-up if there is a load issue preventing the drive to ramp past the lower limit frequency.

Parameter	Description	Default Value	New Value
F259	Sleep Detection Time at Start-up	0.0	Choose New Value

Check Your Work

Verify parameter change was made by verifying new value programmed.

Verification

STEP D

Program the following below.

Parameter	Description	Default Value	New Value
F013	LL: Lower Limit Frequency	0.0	20.0 Hz

Parameter	Description	Default Value	New Value
-----------	-------------	---------------	-----------

F256	Sleep Detection Time	0.0	5.0 s
------	----------------------	-----	-------

Parameter	Description	Default Value	New Value
F391	Sleep Detection Hysteresis	0.0	5.0 Hz

Start at the main operation screen below and follow the steps as shown.

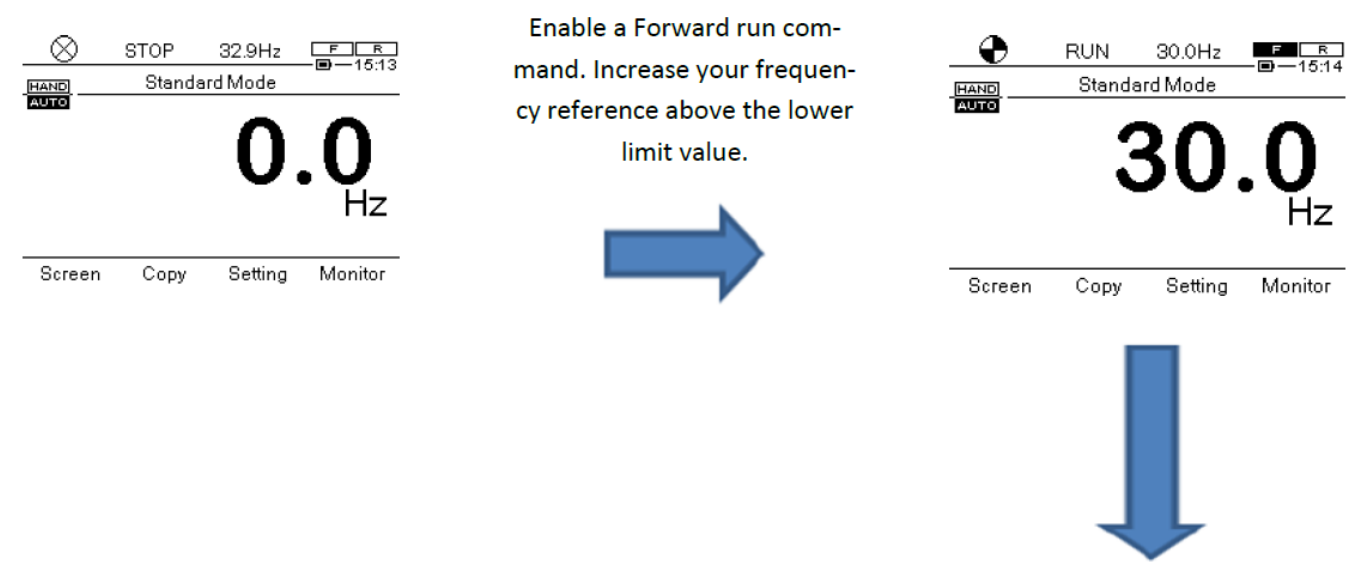

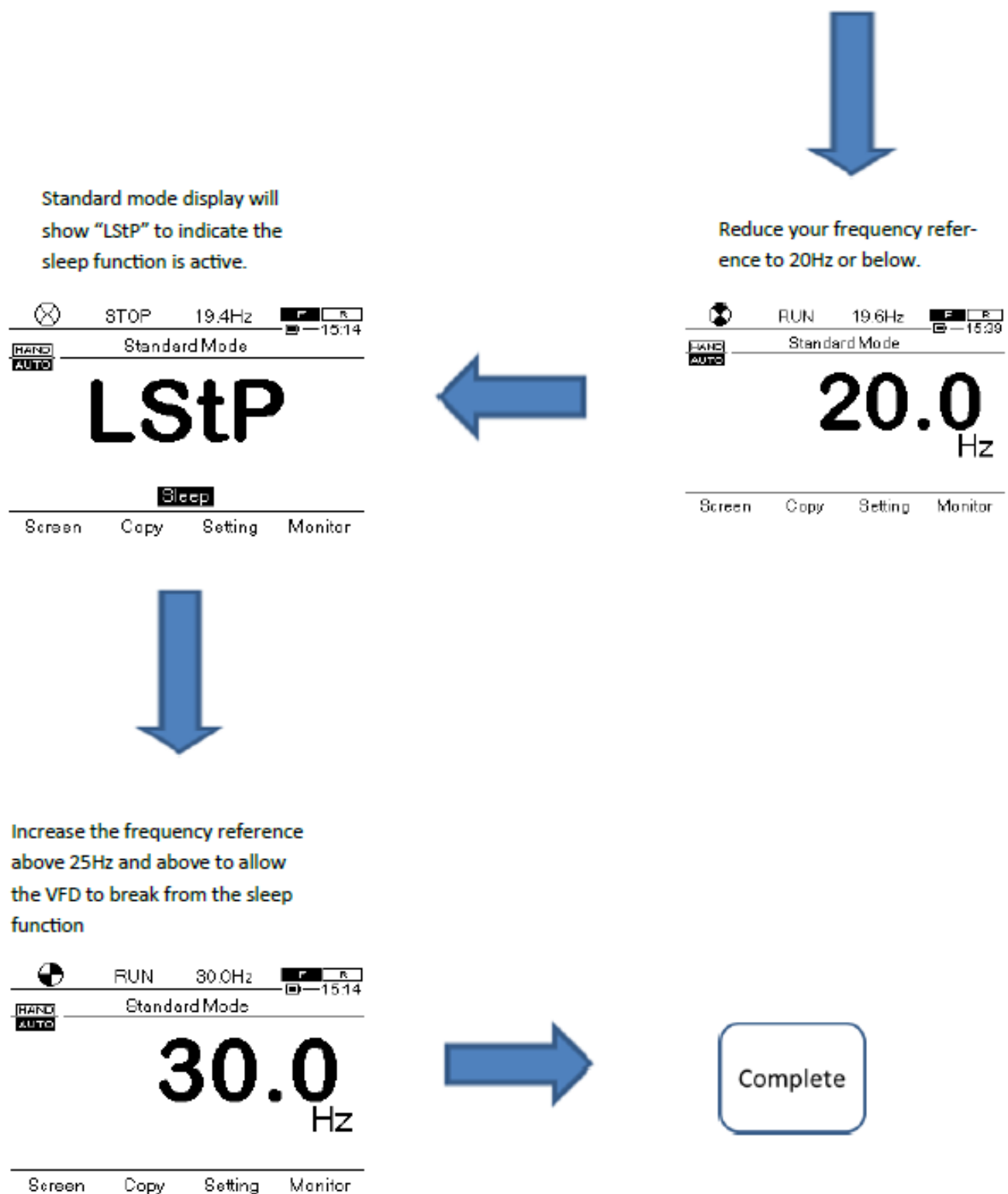

Documents / Resources

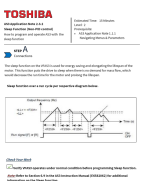
	TOSHIBA AS3 Application [pdf] Owner's Manual AS3 Application, AS3, Application
---	---

References

- [User Manual](#)

Application, AS3, AS3 Application,

Toshiba Toshiba

Leave a comment

Your email address will not be published. Required fields are marked *

Comment *

Name

Email

Website

☐ Save my name, email, and website in this browser for the next time I comment.

Post Comment

Search:

Search

[Manuals+](#) | [Upload](#) | [Deep Search](#) | [Privacy Policy](#) | [@manuals.plus](#) | [YouTube](#)

This website is an independent publication and is neither affiliated with nor endorsed by any of the trademark owners. The "Bluetooth®" word mark and logos are registered trademarks owned by Bluetooth SIG, Inc. The "Wi-Fi®" word mark and logos are registered trademarks owned by the Wi-Fi Alliance. Any use of

these marks on this website does not imply any affiliation with or endorsement.