



**51838 Flex
Force Power
System 60V
MAX String
Trimmer**



TORO 51838 Flex Force Power System 60V MAX String Trimmer Instruction Manual

[Home](#) » [Toro](#) » TORO 51838 Flex Force Power System 60V MAX String Trimmer Instruction Manual 

Contents

- [1 TORO 51838 Flex Force Power System 60V MAX String Trimmer](#)
- [2 Product Information](#)
- [3 Product Usage Instructions](#)
- [4 Frequently Asked Questions](#)
- [5 Introduction](#)
- [6 Safety-Alert Symbol](#)
- [7 Setup](#)
- [8 Installing the Auxiliary Handle](#)
- [9 Product Overview](#)
- [10 Specifications](#)
- [11 Operation](#)
- [12 Adjusting the Auxiliary Handle Position](#)
- [13 Charging the Battery Pack](#)
- [14 Operating Tips](#)
- [15 Maintenance](#)
- [16 Replacing the Trimmer Head](#)
- [17 Storage](#)
- [18 Troubleshooting](#)
- [19 Warning Information](#)
- [20 Documents / Resources](#)
 - [20.1 References](#)



TORO 51838 Flex Force Power System 60V MAX String Trimmer



Product Information

Specifications

- **Model No.:** 51838 / 51838T
- **Serial No.:** 324000001 and Up
- **Additional Information:** Model 51838T does not include a battery or a charger.

Product Usage Instructions

Safety Guidelines

Safety-Alert Symbol: The safety-alert symbol shown in the manual and on the machine is crucial to follow to prevent accidents.

Important Safety Instructions

- Read all safety warnings, instructions, illustrations, and specifications provided with the machine to prevent electric shock, fire, or serious injury.
- Keep the work area clean and well-lit to avoid accidents caused by clutter or darkness.
- Avoid operating machines in explosive atmospheres to prevent sparks that could ignite flammable substances.
- Keep children and bystanders away while operating the machine to maintain control.
- Use an extension cord suitable for outdoor use when operating the machine outdoors to reduce the risk of electric shock.

- If operating in a damp location, use a residual current device (RCD) for added electric shock protection.
- Always have your machine serviced by qualified personnel using identical replacement parts to maintain safety.
- Do not service damaged battery packs; seek assistance from the manufacturer or authorized service providers.
- Wear long trousers while operating the machine to protect exposed skin from injury due to thrown objects.

Frequently Asked Questions

- **Q: What should I do if I need service or additional information?**
 - **A:** Contact an Authorized Service Dealer or the manufacturer Customer Service with your product's model and serial numbers ready for assistance.
- **Q: Where can I find more resources for product safety and operation training?**
 - **A:** Visit www.Toro.com for safety training materials, accessory information, dealer locations, and product registration.

Introduction

- This trimmer is intended to be used by residential homeowners to trim grass as needed outdoors. It is designed to use Flex-Force™ 60V lithium-ion battery packs.
- These battery packs are designed to be charged only by Flex-Force 60V lithium-ion battery chargers. Using this product for purposes other than its intended use could prove dangerous to you and bystanders.
- **Important:** If you are using this machine with a battery pack that is 8.0 Ah or greater you must install a quick-release harness Model 139-5334 (not included) for proper support and balance.
- Do not use other harnesses or multiple harnesses when operating the machine.
- Model 51838T does not include a battery or a charger.
- Read this information carefully to learn how to operate and maintain your product properly and to avoid injury and product damage. You are responsible for operating the product properly and safely.
- Visit www.Toro.com for product safety and operation training materials, accessory information, help finding a dealer, or to register your product.
- Whenever you need service, genuine manufacturer parts, or additional information, contact an Authorized Service Dealer or the manufacturer Customer Service and have the model and serial numbers of your product ready.
- Figure 1 identifies the location of the model and serial numbers on the product. Write the numbers in the space provided.
- **Important:** With your mobile device, you can scan the QR code on the serial number decal (if equipped) to access warranty, parts, and other product information.

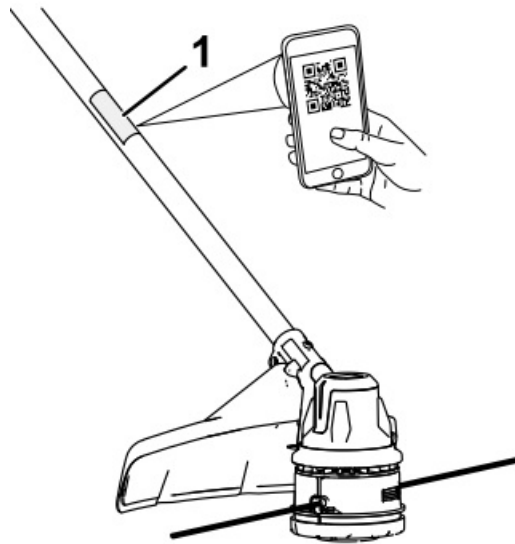

Figure 1

1. Model number, serial number, and QR code location

- Model No. _____
- Serial No. _____

Safety-Alert Symbol

The safety alert symbol (Figure 2) shown in this manual and on the machine identifies important safety messages that you must follow to prevent accidents.



Figure 2

Safety-alert symbol

- The safety-alert symbol appears above information that alerts you to unsafe actions or situations and is followed by the words DANGER, WARNING, or CAUTION.
- **DANGER** indicates an imminently hazardous situation that, if not avoided, will result in death or serious injury.
- **WARNING** indicates a potentially hazardous situation that, if not avoided, could result in death or serious injury.
- **CAUTION** indicates a potentially hazardous situation which, if not avoided, may result in minor or moderate injury.
- This manual uses two other words to highlight information. Important calls attention to special mechanical information and Note emphasizes general information worthy of special attention.

Safety

- **WARNING** Read all safety warnings, instructions, illustrations, and specifications provided with this machine.
- Failure to follow all instructions listed below may result in electric shock, fire and/or serious injury.
- Save all warnings and instructions for future reference.
- The term “machine” in all the warnings refers to your mains-operated (corded) machine or battery-operated (cordless) machine.

1. Work area safety

1. Keep the work area clean and well-lit. Cluttered or dark areas invite accidents.
2. Do not operate machines in explosive atmospheres, such as in the presence of flammable liquids, gases, or dust. Machines create sparks which may ignite the dust or fumes.
3. Keep children and bystanders away while operating a machine. Distractions can cause you to lose control.

2. Electrical safety

1. Machine plugs must match the outlet. Never modify the plug in any way. Do not use any adapter plugs with earthed (grounded) machines. Unmodified plugs and matching outlets will reduce the risk of electric shock.
2. Avoid body contact with earthed or grounded surfaces, such as pipes, radiators, ranges, and refrigerators. There is an increased risk of electric shock if your body is earthed or grounded.
3. Do not expose machines to rain or wet conditions. Water entering a machine will increase the risk of electric shock.
4. Do not abuse the cord. Never use the cord for carrying, pulling, or unplugging the machine. Keep the cord away from heat, oil, sharp edges, or moving parts. Damaged or entangled cords increase the risk of electric shock.
5. When operating a machine outdoors, use an extension cord suitable for outdoor use. The use of a cord suitable for outdoor use reduces the risk of electric shock.
6. If operating a machine in a damp location is unavoidable, use a residual current device (RCD) protected supply. The use of an RCD reduces the risk of electric shock.

3. Personal safety

1. Stay alert, watch what you are doing, and use common sense when operating a machine. Do not use a machine while you are tired or under the influence of drugs, alcohol, or medication. A moment of inattention while operating machines may result in serious personal injury.
2. Use personal protective equipment. Always wear eye protection. Protective equipment such as a dust mask, non-skid safety shoes, hard hat, or hearing protection used for appropriate conditions reduces personal injuries.
3. Prevent unintentional starting. Ensure the switch is in the OFF position before connecting to the power source and/or battery pack, picking up or carrying the tool. Carrying machines with your finger on the switch or energizing machines that have the switch on invites accidents.
4. Remove any adjusting key or wrench before turning the machine on. A wrench or a key left attached to a rotating part of the machine may result in personal injury.
5. Do not overreach. Keep proper footing and balance at all times. This enables better control of the machine in unexpected situations.
6. Dress properly. Do not wear loose clothing or jewelry. Keep your hair and clothing away from moving parts. Loose clothes, jewelry, or long hair can be caught in moving parts.
7. If devices are provided for the connection of dust extraction and collection facilities, ensure these are connected and properly used. The use of dust collection can reduce dust-related hazards.
8. Do not let familiarity gained from the frequent use of tools allow you to become complacent and ignore tool safety principles. A careless action can cause severe injury within a fraction of a second.

4. Machine use and care

1. Do not force the machine. Use the correct machine for your application. The correct machine will do the

job better and safer at the rate for which it was designed.

2. Do not use the machine if the switch does not turn it on and off. Any machine that cannot be controlled with the switch is dangerous and must be repaired.
3. Disconnect the plug from the power source and/or remove the battery pack, if detachable, from the machine before making any adjustments, changing accessories, or storing machines. Such preventive safety measures reduce the risk of starting the machine accidentally.
4. Store idle machines out of the reach of children and do not allow persons unfamiliar with the machine or these instructions to operate the machine. Machines are dangerous in the hands of untrained users.
5. Maintained machines and accessories. Check for misalignment or binding of moving parts, breakage of parts, and any other condition that may affect the machine's operation. If damaged, have the machine repaired before use. Many accidents are caused by poorly maintained machines.
6. Keep cutting tools sharp and clean. Properly maintained cutting tools with sharp cutting edges are less likely to bind and are easier to control.
7. Use the machine, accessories, tool bits, etc. under these instructions, taking into account the working conditions and the work to be performed. Use of the machine for operations different from those intended could result in a hazardous situation.
8. Keep handles and grasping surfaces dry, clean, and free from oil and grease. Slippery handles and grasping surfaces do not allow for safe handling and control of the tool in unexpected situations.

5. Battery tool use and care

1. Recharge only with the charger specified by the manufacturer. A charger that is suitable for one type of battery pack may create a risk of fire when used with another battery pack.
2. Use machines only with specifically designated battery packs. Use of any other battery packs may create a risk of injury and fire.
3. When the battery pack is not in use, keep it away from other metal objects, like paper clips, coins, keys, nails, screws, or other small metal objects, that can make a connection from one terminal to another.
 - Shorting the battery terminals together may cause burns or a fire.
4. Under abusive conditions, liquid may be ejected from the battery; avoid contact. If contact accidentally occurs, flush with water. If liquid contacts the eyes, additionally seek medical help. Liquid ejected from the battery may cause irritation or burns.
5. Do not use a battery pack or tool that is damaged or modified. Damaged or modified batteries may exhibit unpredictable behavior resulting in fire, explosion, or risk of injury.
6. Do not expose a battery pack or tool to fire or excessive temperature. Exposure to fire or temperature above 130 °C (265 °F) may cause explosion.
7. Follow all charging instructions and do not charge the battery pack or tool outside the temperature range specified in the instructions.
 - Charging improperly or at temperatures outside the specified range may damage the battery and increase the risk of fire.

6. Service

1. Have your machine serviced by a qualified repair person using only identical replacement parts. This will ensure that the safety of the machine is maintained.
2. Never service damaged battery packs. Service of battery packs should only be performed by the manufacturer or authorized service providers.

7. String Trimmer Safety

1. Do not use the machine in bad weather conditions, especially when there is a risk of lightning. This

decreases the risk of being struck by lightning.

2. Thoroughly inspect the area for wildlife where the machine is to be used. Wildlife may be injured by the machine during operation.
3. Thoroughly inspect the area where the machine is to be used and remove all stones, sticks, wires, bones, and other foreign objects. Thrown objects can cause personal injury.
4. Before using the machine, always visually inspect to see that the cutter or blade and the cutter or blade assembly are not damaged. Damaged parts increase the risk of injury.
5. Follow instructions for changing accessories. Improperly tightened blade securing nuts or bolts may either damage the blade or result in it becoming detached.
6. The rated rotational speed of the blade must be at least equal to the maximum rotational speed marked on the machine. Blades running faster than their rated rotational speed can break and fly apart.
7. Wear eye, ear, head, and hand protection. Adequate protective equipment will reduce personal injury by flying debris or accidental contact with the cutting line or blade.
8. While operating the machine, always wear non-slip and protective footwear. Do not operate the machine when barefoot or wearing open sandals. This reduces the chance of injury to the feet from contact with the moving cutters or lines.
9. While operating the machine, always wear safety footwear. Do not operate the machine when barefoot or wearing open sandals. This reduces the chance of injury to the feet from contact with a moving cutter, line, or blade.
10. While operating the machine, always wear long trousers. Exposed skin increases the likelihood of injury from thrown objects.
11. Keep bystanders away while operating the machine. Thrown debris can result in serious personal injury.
12. Always use two hands when operating the machine. Holding the machine with both hands will avoid loss of control.
13. Hold the machine by the insulated gripping surfaces only, because the cutting line or blade may contact hidden wiring.
 - Cutting lines or blades contacting a “live” wire may make exposed metal parts of the machine “live” and could give the operator an electric shock.
14. Always keep proper footing and operate the machine only when standing on the ground. Slippery or unstable surfaces may cause a loss of balance or control of the machine.
15. Do not operate the machine on excessively steep slopes. This reduces the risk of loss of control, slipping, and falling which may result in personal injury.
16. When working on slopes, always be sure of your footing, always work across the face of slopes, never up or down, and exercise extreme caution when changing direction. This reduces the risk of loss of control, slipping, and falling which may result in personal injury.
17. Keep all parts of the body away from the cutter, line, or blade when the machine is operating. Before you start the machine, make sure the cutter, line, or blade is not contacting anything. A moment of inattention while operating the machine may result in injury to yourself or others.
18. Do not operate the machine above waist height. This helps prevent unintended cutter or blade contact and enables better control of the machine in unexpected situations.
19. When cutting brushes or saplings that are under tension, be alert for springback. When the tension in the wood fibers is released, the brush or sapling may strike the operator and/or throw the machine out of control.

20. Use extreme caution when cutting brush and saplings. The slender material may catch the blade and be whipped toward you or pull you off balance.
21. Maintain control of the machine and do not touch cutters, lines or blades, and other hazardous moving parts while they are still in motion. This reduces the risk of injury from moving parts.
22. Carry the machine with the machine switched off and away from your body. Proper handling of the machine will reduce the likelihood of accidental contact with a moving trimmer cutter, line, or blade.
23. Only use replacement cutters, lines, cutting heads, and blades specified by the manufacturer. Incorrect replacement parts may increase the risk of breakage and injury.

Safety and Instructional Decals

Safety decals and instructions are easily visible to the operator and are located near any area of potential danger. Replace any decal that is damaged or missing.



161-7083

- **Warning—read** the Operator's Manual; wear eye protection; wear hearing protection; never fit metal cutting parts; stay away from moving parts; keep all guards in place; do not operate in wet conditions.

60V MAX* 𐀀 STRING TRIMMER / DÉBROUSSAILLEUSE À FIL / DESBROZADORA



1





2



15 m (50 ft)

*60VDC MAXIMUM / 54VDC NOMINAL
*60 VDC MAXIMUM / 54 VDC NOMINALE
*60 VDC MÁXIMA / 54 VDC NOMINAL

THE TORO COMPANY
8111 Lyndale Avenue South
Bloomington, MN 55420-1196 USA

MAXIMUM ROTATIONAL FREQUENCY
LA FRÉQUENCE DE ROTATION MAXIMALE
LA FRECUENCIA DE ROTACIÓN MÁXIMA
n_o:5800 min⁻¹

PATENT: www.ttcopats.com
Country of Origin: China



Intertek
5013579

Conforms to / Conforme aux normes / Conformato
a UL STD. 62841-1 & 62841-4-4
Certified to / Certifié selon la norme
/ Certificado según la norma
CSA STD. C22.2 No. 62841-1
& C22.2 No. 62841-4-4.

Model:
Modèle / Modelo : **51838**

Date Code:
Code de date / Código de fecha :

Serial Number:
Numéro de série / Número de Serie :



INSERT
QR CODE
HERE

161-7077 decal161-7077b

- **Warning**—remove the battery pack before performing maintenance.
- **Thrown object hazard**—keep bystanders at least 15 m (50 ft) away.

60V MAX* 𐀀 STRING TRIMMER / DÉBROUSSAILLEUSE À FIL / DESBROZADORA



1





2



15 m (50 ft)

*60VDC MAXIMUM / 54VDC NOMINAL
*60 VDC MAXIMUM / 54 VDC NOMINALE
*60 VDC MÁXIMA / 54 VDC NOMINAL

THE TORO COMPANY
8111 Lyndale Avenue South
Bloomington, MN 55420-1196 USA

MAXIMUM ROTATIONAL FREQUENCY
LA FRÉQUENCE DE ROTATION MAXIMALE
LA FRECUENCIA DE ROTACIÓN MÁXIMA
n_o:5800 min⁻¹

PATENT: www.ttcopats.com
Country of Origin: China



Intertek
5013579

Conforms to / Conforme aux normes / Conformato
a UL STD. 62841-1 & 62841-4-4
Certified to / Certifié selon la norme
/ Certificado según la norma
CSA STD. C22.2 No. 62841-1
& C22.2 No. 62841-4-4.

Model:
Modèle / Modelo : **51838T**

Date Code:
Code de date / Código de fecha :

Serial Number:
Numéro de série / Número de Serie :



INSERT
QR CODE
HERE

161-7078 decal161-7078b

- **Warning**—remove the battery pack before performing maintenance.
- **Thrown object hazard**—keep bystanders at least 15 m (50 ft) away.

⚠ WARNING To reduce risk of injury to persons, remove battery pack when not in use. For household use only.
Store indoors. For use with TORO Flex-Force battery model: 88925. See instruction manual for other compatible TORO 60v batteries.

⚠ AVERTISSEMENT Pour réduire les risques de blessures corporelles, retirez la batterie quand vous ne l'utilisez pas. Réservez à l'usage domestique.
Remisez à l'intérieur. À utiliser avec la batterie TORO Flex-Force modèle : 88925.

⚠ ADVERTENCIA Para reducir el riesgo de lesiones a personas, retire la batería cuando no esté en uso. Únicamente para uso doméstico.
Almacenar en espacios interiores. Usar con la batería Flex-Force modelo 88925 de TORO. Consulte el manual de instrucciones para obtener información sobre otras baterías TORO de 60 V compatibles.

⚠ WARNING: Cancer and Reproductive Harm - www.P65Warnings.ca.gov. For more information, please visit www.ttoro.com/CAProp65

⚠ AVERTISSEMENT: Cancer et Troubles de l'appareil reproducteur - www.P65Warnings.ca.gov.
Pour plus d'informations, veuillez visiter www.ttoro.com/CAProp65

⚠ ADVERTENCIA: Cáncer y Daño Reproductivo - www.P65Warnings.ca.gov. Para obtener más información, visite www.ttoro.com/CAProp65

decal161-7051b

161-7051

⚠ CAUTION TO REDUCE THE RISK OF INJURY, USER MUST READ AND UNDERSTAND INSTRUCTION MANUAL.
Charge only Flex-Force 60v Li-Ion rechargeable battery. Other types of batteries may burst causing personal injury and damage.
DANGER: risk of electric shock. Do not expose to liquid, vapor, or rain. Do not interconnect output terminal. For indoor use only.

⚠ ATTENTION POUR RÉDUIRE LES RISQUES DE BLESSURE, L'UTILISATEUR DOIT LIRE ET COMPRENDRE LE MODE D'EMPLOI. Utiliser uniquement pour les batteries rechargeables type Flex-Force 60v Li-Ion. D'autres types de batteries pourraient exploser et causer des blessures ou des dommages.
DANGER : risque de décharge électrique. Ne pas exposer à des liquides, à la vapeur ou à la pluie. Ne pas interconnecter la borne de sortie. Pour usage intérieur uniquement.

⚠ PRECAUCIÓN PARA REDUCIR EL RIESGO DE LESIONES, EL USUARIO DEBE LEER Y COMPRENDER EL MANUAL DE INSTRUCCIONES. Cargue únicamente baterías recargables de ion-litio Flex-Force de 60 V. Otros tipos de batería pueden explotar y causar lesiones personales y daños materiales.
PELIGRO: Riesgo de descarga eléctrica. No exponer a líquidos, vapor o lluvia. No interconectar un terminal de salida. Para uso en espacios interiores únicamente.

decal161-3788

161-3788

- The battery pack is charging.
- The battery pack is fully charged.

- The battery pack is over or under the appropriate temperature range.
- Battery pack charging fault



decal161-3775

161-3775



161-3774 decal161-3774

- Battery charge status

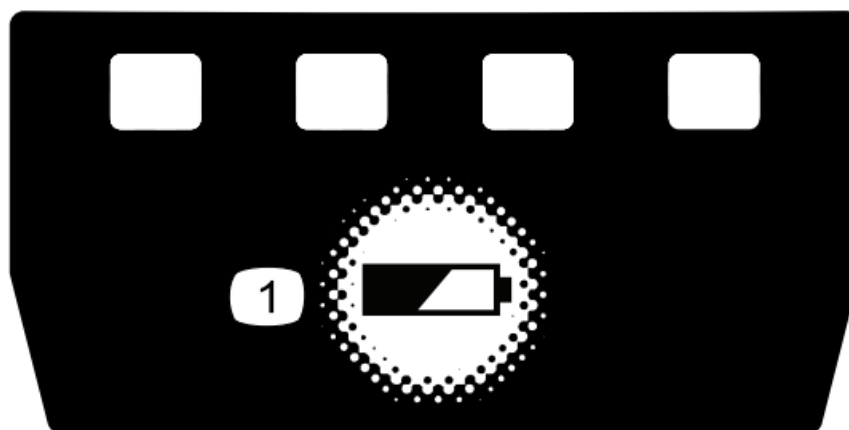

161-3764 decal161-3764



145-8287 decal145-8287

1. Read the Operator's Manual.
2. Call2Recycle® battery recycling program
3. Recycle the battery
4. Do not dispose improperly
5. Keep away from open fire or flames
6. Do not expose to rain
7. Electrical shock hazard

Setup

Loose Parts

Use the chart below to verify that all parts have been shipped.

Procedure	Description	Qty.	Use
1	Connector knob	1	Unfold the shaft.
2	Auxiliary handle assembly	1	Install the auxiliary handle.
3	Guard	1	Install the guard.

Important: The battery pack is not fully charged when you purchase it. Before using the tool for the first time, refer to Charging the Battery Pack.

Unfolding the Shaft

Parts needed for this procedure:

1. Connector knob

Procedure

1. Unfold the shaft (A of Figure 3).
2. Secure the shaft together at the coupler using the connector knob (B of Figure 3).

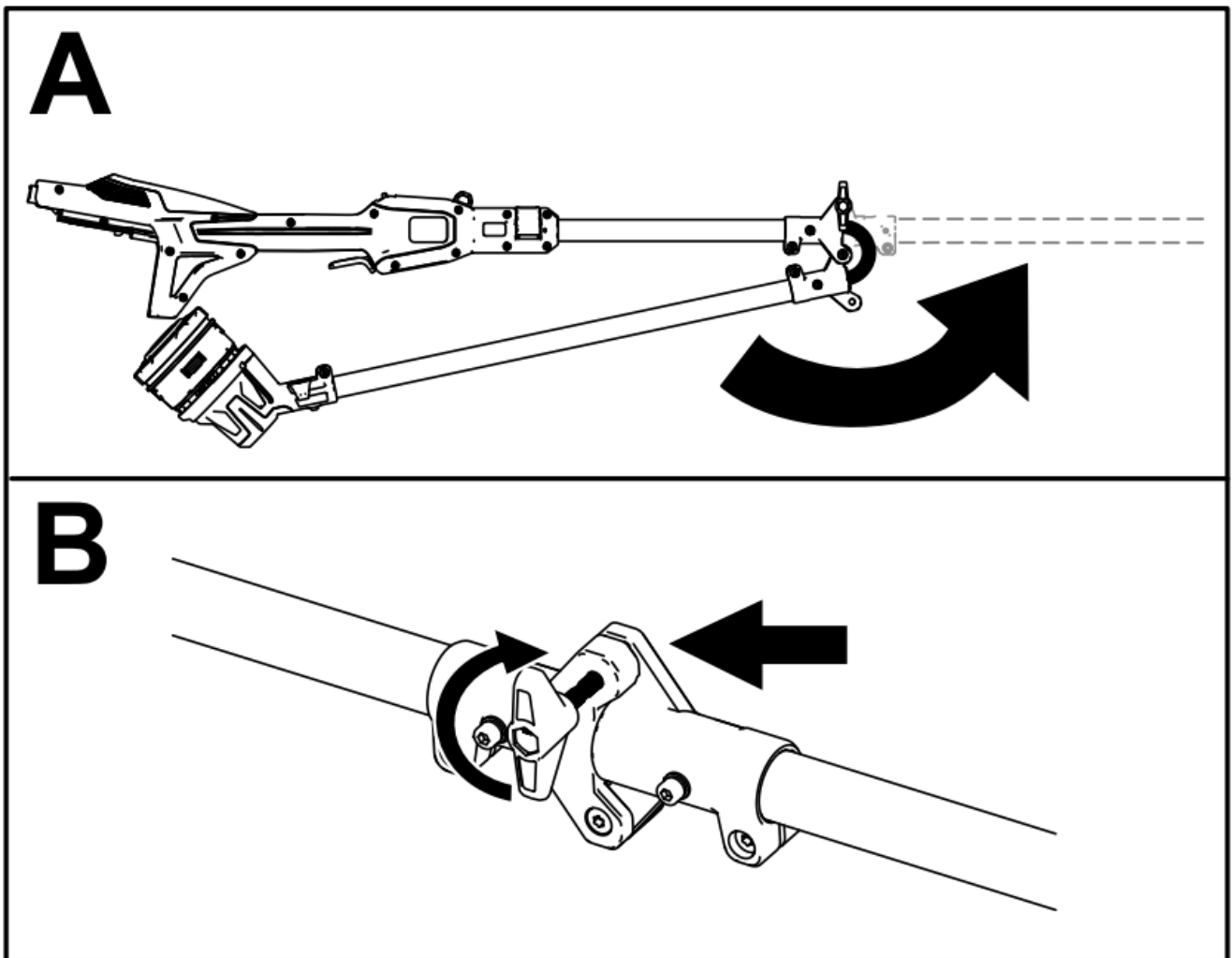

Figure 3 g507675

Installing the Auxiliary Handle

Parts needed for this procedure:

1. Auxiliary handle assembly

Procedure

1. Separate the auxiliary handle from the handle bracket by unscrewing the handle-lock knob and removing the bolt (A of Figure 4).
 - **Important:** The bolt may be wedged into the plastic of the handle; lightly tap the bottom of the bolt until it is free from the handle.

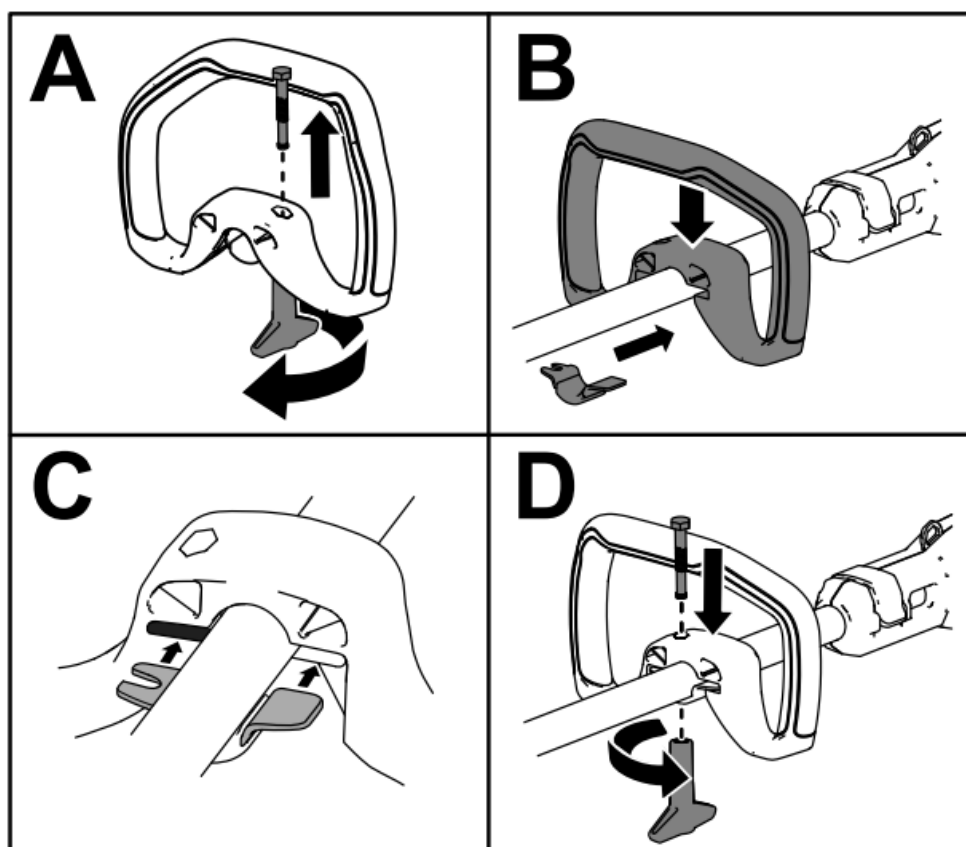

Figure 4 g507673

2. Align the handle bracket with the auxiliary handle (B of Figure 4).
3. Slide the handle bracket into the slot on the auxiliary handle (C of Figure 4).
4. Secure the lower handle bracket to the auxiliary handle with the handle-lock knob and the previously removed bolt (D of Figure 4).

Installing the Guard

Parts are needed for this procedure.

1. Guard

Procedure

Secure the guard onto the base of the trimmer with the 2 screws.

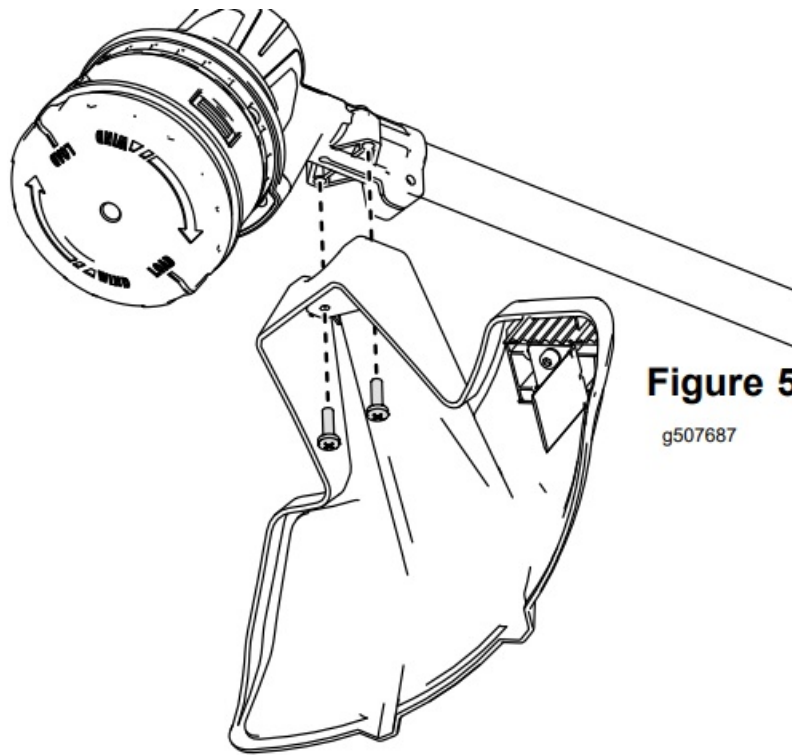

Figure 5

g507687

Product Overview

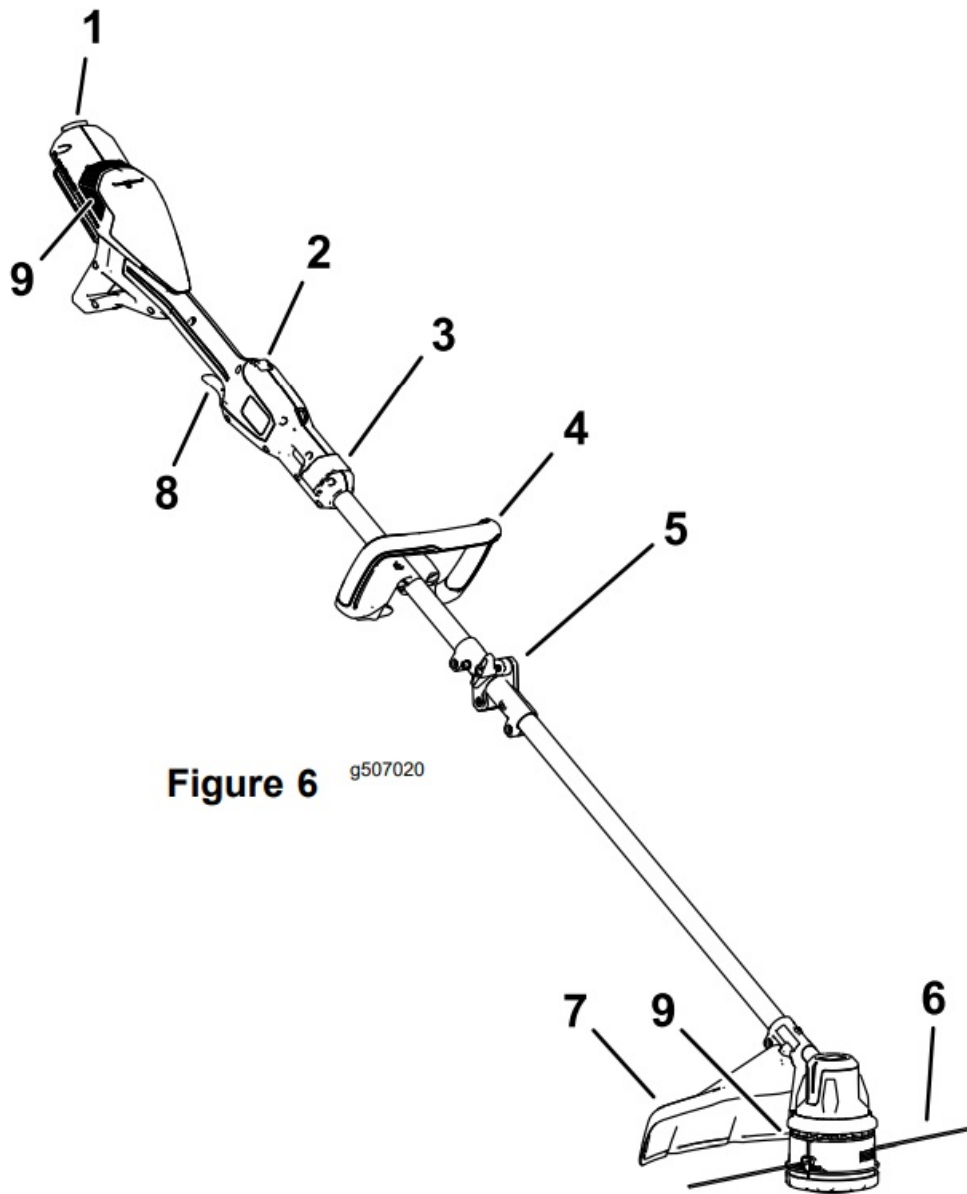

Figure 6 g507020

1. Battery latch
2. Lockout switch
3. Telescoping latch
4. Auxiliary handle
5. Mid-shaft coupler
6. Cutting line
7. Guard
8. Run trigger
9. Trimmer vents

Specifications

Model	51838/T
Rated Voltage	60V DC maximum, 54 VDC nominal usage
Charger Type	Flex-Force 60V lithium-ion chargers
Battery Type	Flex-Force 60V lithium-ion batteries*

If you are using this machine with a battery pack that is 8.0 Ah or greater, you must install a quick-release harness Model 139-5334 (not included).

Appropriate Temperature Ranges

Charge/store the battery pack at	5°C (41°F) to 40°C (104°F)*
Use the battery pack at	-30°C (-22°F) to 49°C (120°F)
Use the trimmer at	0°C (32°F) to 49°C (120°F)
Store the trimmer at	0°C (32°F) to 49°C (120°F)*

- Charging time will increase if you do not charge the battery within this range.
- Store the tool, battery pack, and battery charger in an enclosed clean, dry area.

Attachments/Accessories

- A selection of Toro-approved attachments and accessories is available for use with the machine to enhance and expand its capabilities.
- Contact your Authorized Service Dealer or authorized Toro distributor or go to www.Toro.com for a list of all approved attachments and accessories.
- To ensure optimum performance and continued safety certification of the machine, use only genuine Toro replacement parts and accessories. Replacement parts and accessories made by other manufacturers could be dangerous.

Operation

Starting the Trimmer

1. Ensure that the vents on the trimmer are clear of any dust and debris.
2. Align the cavity in the battery pack with the tongue on the power head (Figure 7).
3. Push the battery pack into the power head until the battery locks into the latch (Figure 7).

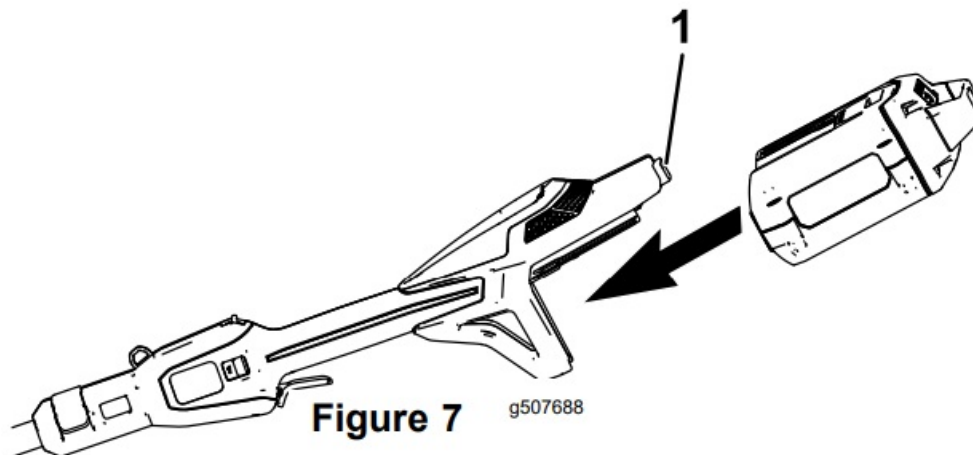

1. Battery latch

4. To start the trimmer, pull back the lockout switch, then squeeze the variable-speed trigger (Figure 8).
- **Note:** Slide the speed range switch to change the speed of the trimmer.

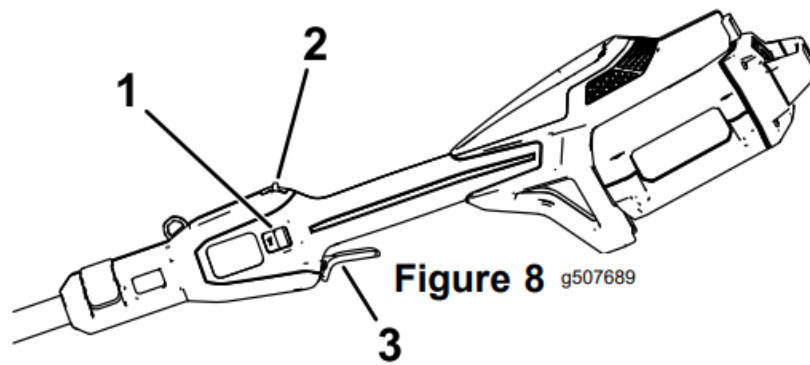

1. Speed range switch
2. Lockout switch
3. Variable-speed trigger

Shutting Off the Trimmer

- To shut off the trimmer, release the trigger and the lockout switch.
- Whenever you are not using the trimmer or are transporting the trimmer to or from the work area, remove the battery pack.

Removing the Battery Pack from the Trimmer

- Press the battery latch to release the battery pack and slide the battery pack out of the machine (Figure 9).

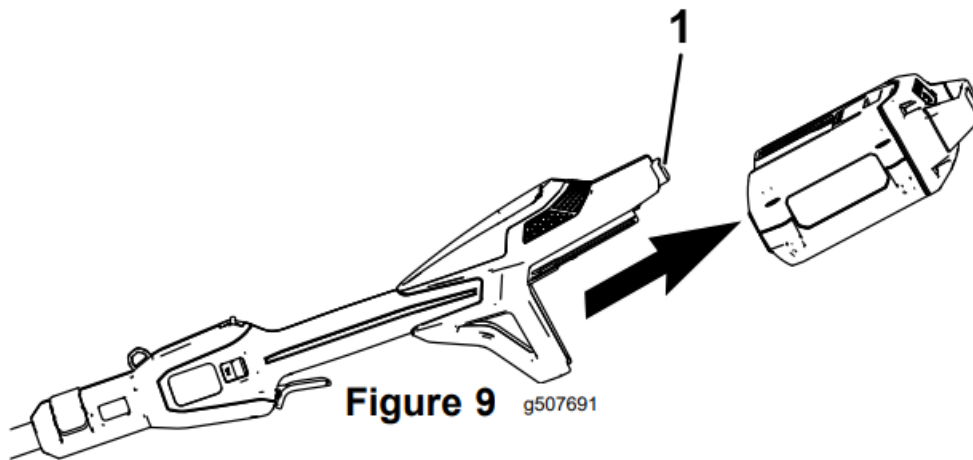

1. Battery latch

Adjusting the Auxiliary Handle Position

1. Loosen the handle-lock knob on the bottom of the auxiliary handle.
2. Adjust the position of the auxiliary handle on the shaft until the trimmer can be held in a neutral, comfortable position while operating.
3. Tighten the handle-lock knob to secure the auxiliary handle in place.

Adjusting the Shaft Length

1. Open the telescoping latch at the front of the handle.

2. Extend or retract the shaft until the trimmer can be held in a neutral, comfortable position while operating.
3. Close the telescoping latch to secure the shaft.

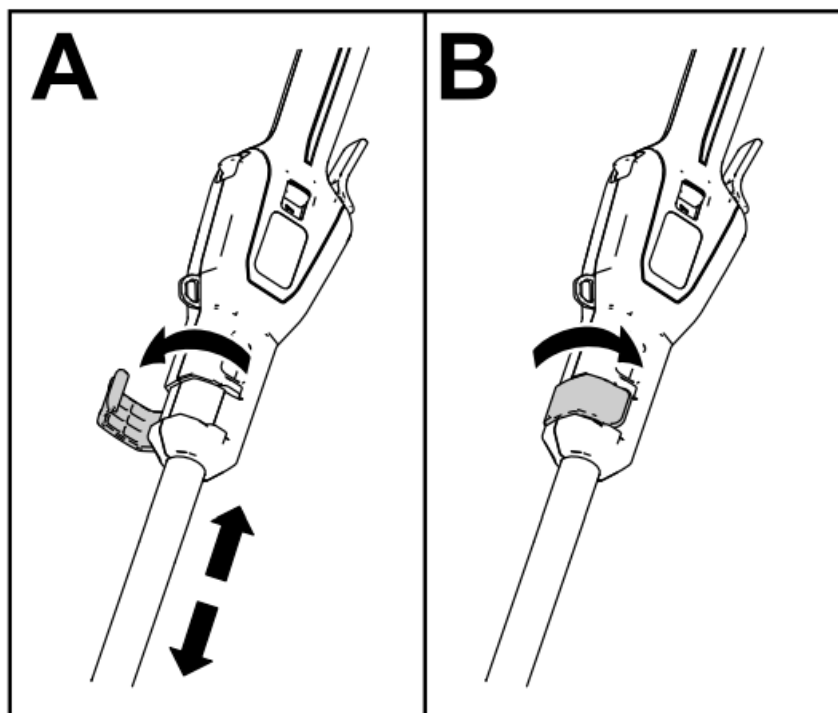

Figure 10 g507705

Advancing the Line Using the Bump Feed

1. Run the tool at full throttle.
2. Tap the bump head on the ground to advance the line. The line advances each time the bump head is tapped.
 - **Important:** Do not hold the bump head on the ground while running the trimmer.
 - **Note:** The line trimming cut-off blade on the grass deflector cuts the line to the correct length.
 - **Note:** If the line is worn too short, you may not be able to advance the line by tapping it on the ground. If so, release both the trigger and the lockout switch and refer to Advancing the Line Manually.

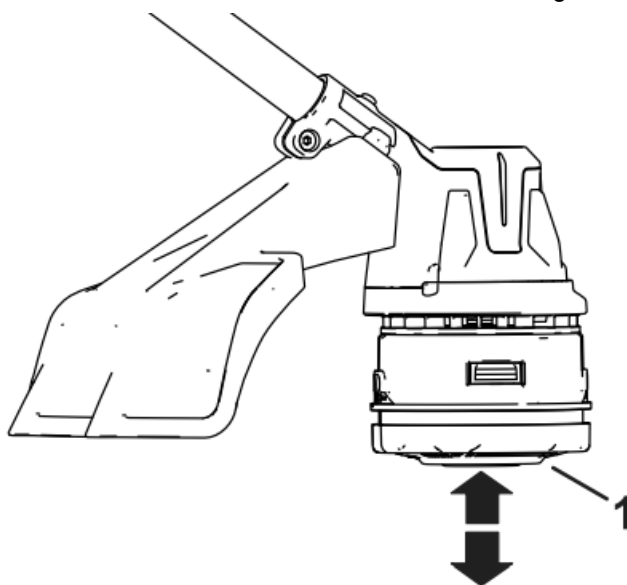

Figure 11 g507693

Advancing the Line Manually

Remove the battery pack from the trimmer, then push the bump head at the base of the spool retainer while pulling on the trimmer line to manually advance the line.

Using the Shoulder Harness

- **Important:** If you are using the string trimmer with an 8.0 Ah or greater battery pack installed, install a shoulder harness (not included).
- Do not use the shoulder harness if you are powering the string trimmer with the backpack and backpack tether; use only the backpack harness.
- Connect the clip on the shoulder harness to the attachment eye on top of the handle (Figure 12).

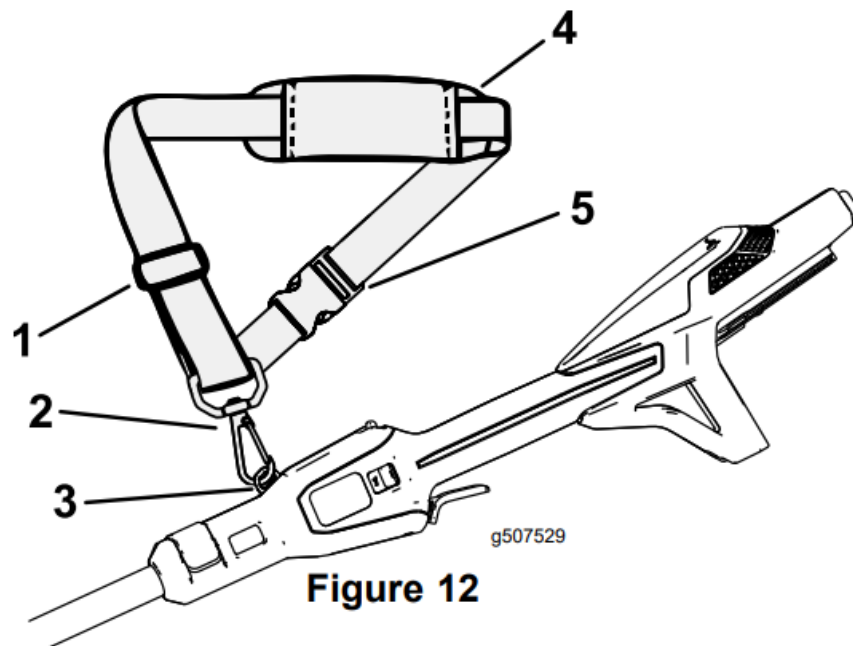

1. Strap adjuster
2. Pivot clip
3. Attachment eye
4. Shoulder pad
5. Quick-release buckle

- The strap length is adjustable; slide the strap adjuster up to decrease the length of the strap, or down to increase the length of the strap (Figure 12).
- If you ever need to rapidly remove the harness, disconnect the quick-release buckle as follows.

1. Press in on the sides of the buckle (A of Figure 13).
2. Allow the buckle to disconnect (B of Figure 13).

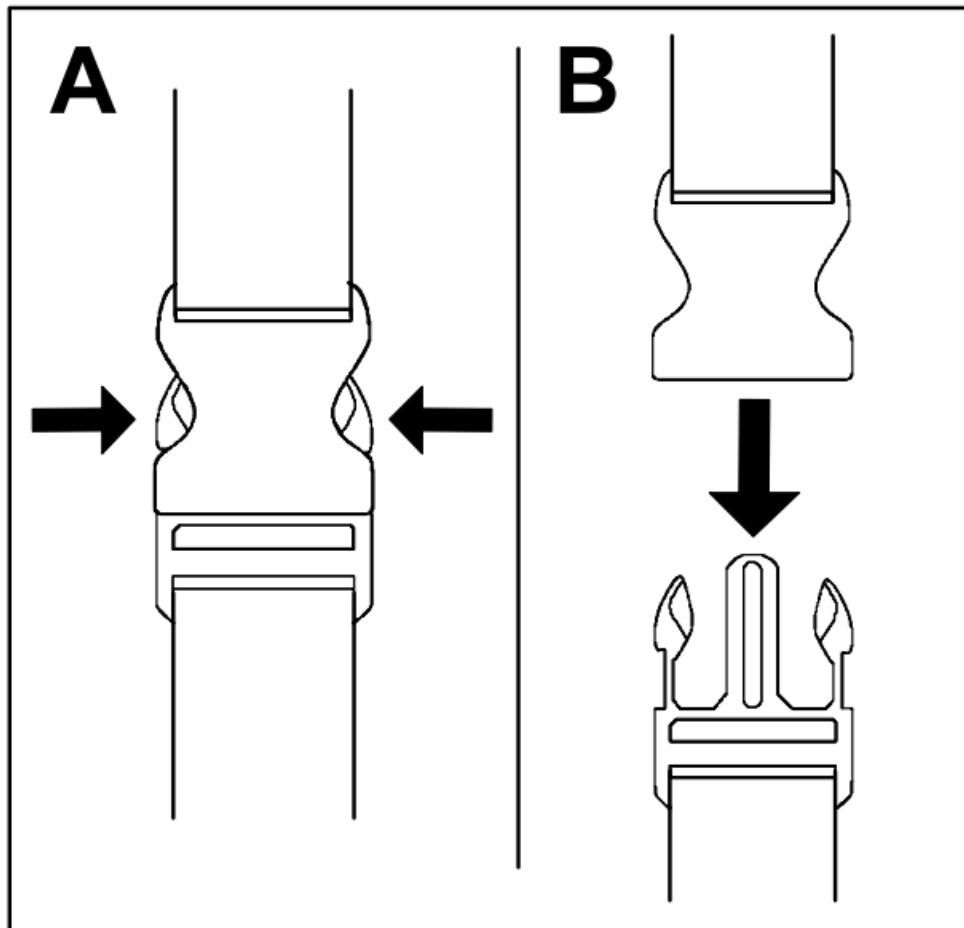
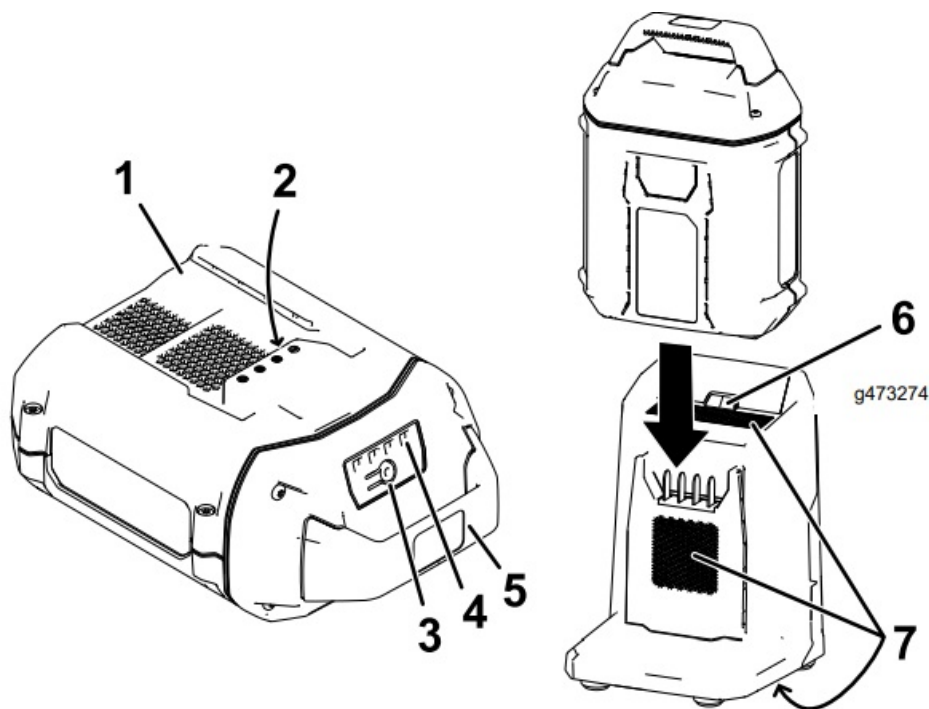

Figure 13 g340477

Charging the Battery Pack

- **Important:** The battery pack is not fully charged when you purchase it. Before using the tool for the first time, place the battery pack in the charger and charge it until the LED display indicates the battery pack is fully charged. Read all safety precautions.
- **Important:** Charge the battery pack only in temperatures that are within the appropriate range; refer to Specifications.
- **Note:** At any time, press the battery-charge indicator button on the battery pack to display the current charge (LED indicators).

1. Ensure that the vents and charging terminals on the battery pack and charger are clear of any dust and debris.



1. Battery-pack cavity
2. Battery-pack terminals
3. Battery-charge-indicator button
4. LED indicators (current charge)
5. Handle
6. Charger LED indicator light
7. Charger venting areas

2. Line up the cavity in the battery pack (Figure 14) with the tongue on the charger.
3. Slide the battery pack into the charger until it is fully seated (Figure 14).
4. To remove the battery pack, slide the battery backward out of the charger.
5. Refer to the following table to interpret the LED indicator light on the battery charger.

Indicator light	Indicates
Off	No battery pack inserted
Green blinking	The battery pack is charging
Green	The battery pack is charged
Red	Battery pack and/or battery charger is over or under the appropriate temperature range
Red blinking	Battery pack charging fault*

- Refer to Troubleshooting for more information.
- **Important:** The battery pack can be left on the charger for short periods between uses.
- If the battery pack will not be used for longer periods, remove the battery pack from the charger; refer to Storage.

Operating Tips

- Keep the trimmer tilted toward the area being cut; this is the best cutting area.

- The string trimmer cuts when you move it from right to left. This prevents the trimmer from throwing debris at you.
- Use the tip of the cutting line to do the cutting; do not force the trimmer head into uncut grass.
- Wire and picket fences can cause the cutting line to wear rapidly and even break. Stone and brick walls, curbs, and wood can also cause the cutting line to wear rapidly.
- Avoid trees and shrubs. The cutting line can easily damage tree bark, wood moldings, siding, and fence posts.

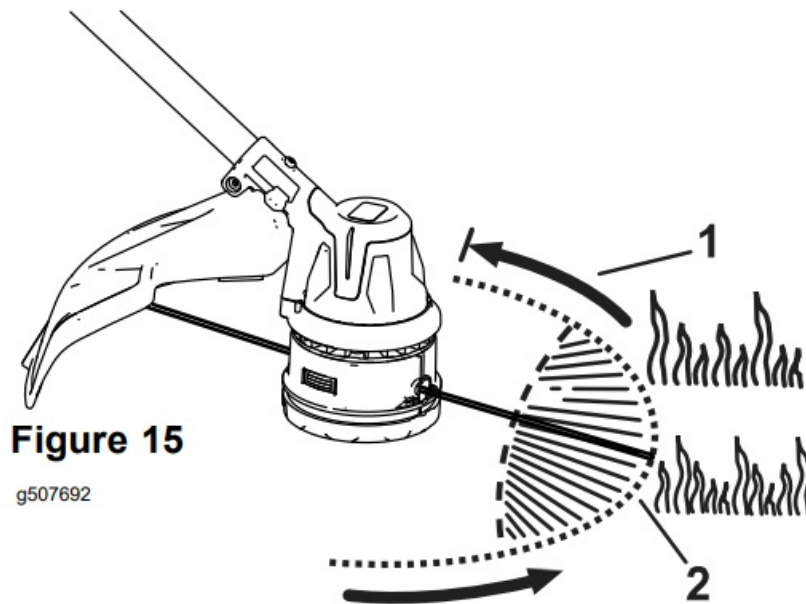

1. Direction of rotation
2. Cutting line path

Maintenance

After each use of the trimmer, complete the following:

1. Remove the battery pack from the trimmer.
2. Wipe the trimmer clean with a damp cloth. Do not hose the trimmer down or submerge it in water.
 - **CAUTION** The line cutoff blade on the deflector is sharp and can cut you.
 - Do not use your hands to clean the deflector shield and blade.
3. Wipe or scrape clean the cutting head area any time there is an accumulation of debris.
4. Check and tighten all fasteners. If any part is damaged or lost, repair or replace it.
5. Brush debris away from air intake vents on the power head and the exhaust on the motor housing to prevent the motor from overheating.

Replacing the Cutting Line

Use only a 2.0 mm (0.080 inches) diameter monofilament cutting line or a 2.4 mm (0.095 inches) diameter twisted monofilament cutting line from Toro.

1. Remove the battery pack from the trimmer.
2. Remove any existing line on the spool by repetitively pressing the bump head while pulling the line out equally from both sides of the bump head.
3. Cut a piece of line that is no longer than 7.3 m (24 ft). Important: Do not overload the spool.

- **Important:** Do not use any other gauge or type of line, as this could damage the trimmer.

4. Press and turn the bump head in the direction shown by the arrows (clockwise) on the bottom of the bump head until the marks on the side of the bump head align with the marks beneath the eyelets (Figure 16).
5. Insert 1 end of the line straight into the eyelet and push the line through until it comes out of the eyelet on the other side.

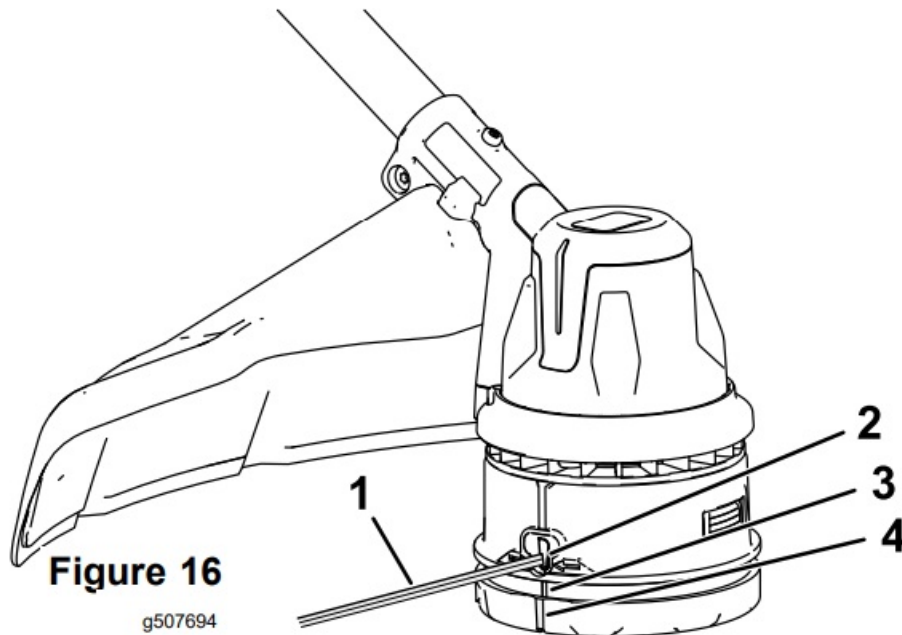

1. Cutting line
2. Eyelet
3. Eyelet alignment mark
4. Bump head alignment mark

- **Important:** Do not disassemble the trimmer head.

6. Pull the line through the eyelets until there is an equal length of line on each side of the trimmer head.
7. Hold the string trimmer in place with one hand. With your other hand, turn the bottom of the trimmer head in the direction shown by the arrows (clockwise) on the bottom of the bump head to wind the line; leave about 152 mm (6 inches) extending beyond the eyelet on each side.

Replacing the Trimmer Head

1. Remove the battery pack from the trimmer.
2. Insert a small-diameter tool (such as a screwdriver) through the motor housing and into the groove in the fan to secure the trimmer head so it does not freely rotate (Figure 17).

- **Note:** With the tool inserted in the hole, rotate the trimmer head until you feel the rod fall into the groove.

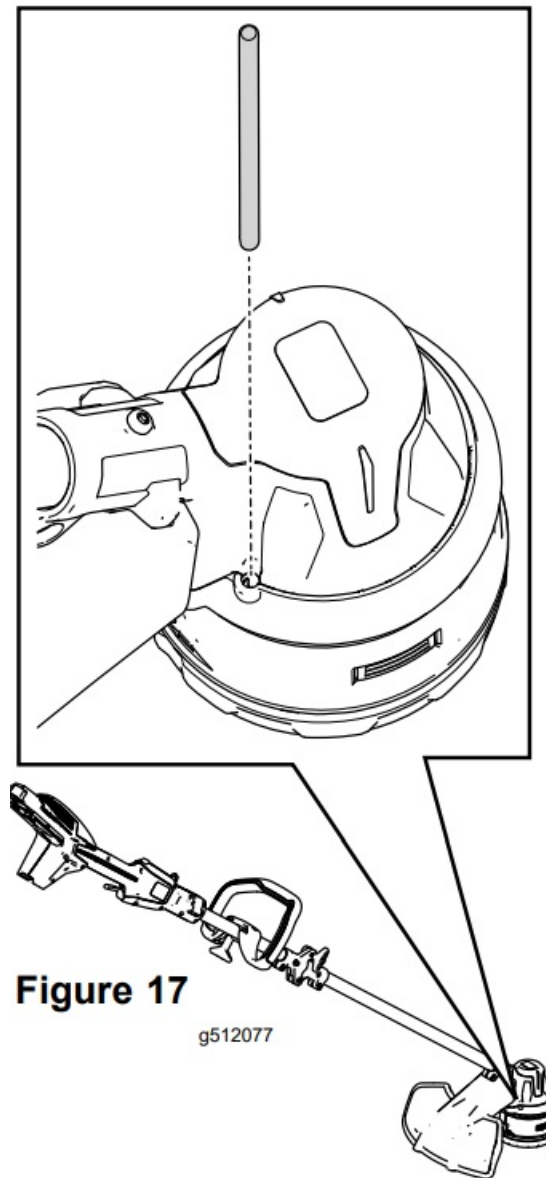

3. With a tool securing the trimmer head, rotate the trimmer head counterclockwise to remove it from the threaded gearcase post (Figure 18).

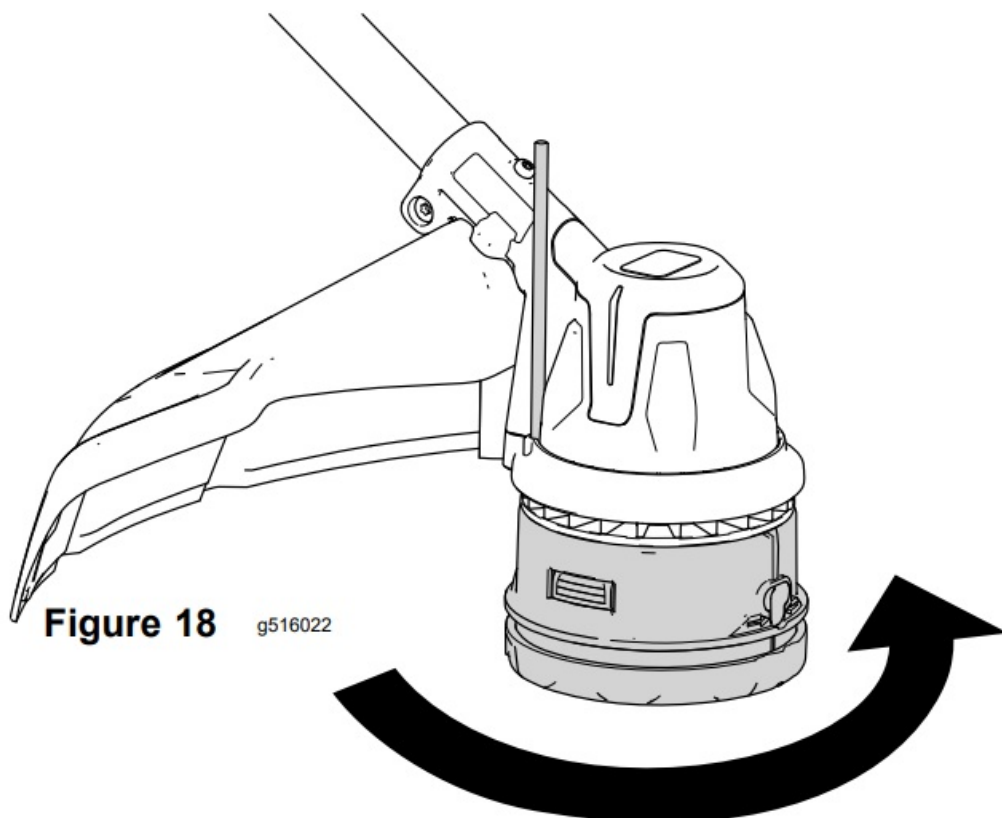

4. To install the new trimmer head, rotate it clockwise onto the gearcase post while securing the fan with a tool.

Storage

- **Important:** Store the machine, battery pack, and charger only in temperatures that are within the appropriate range; refer to Specifications.
- **Important:** If you are storing the machine for a year or longer, remove the battery pack from the machine and charge the battery pack until 1 or 2 LED indicators turn green on the battery.
- Do not store a fully charged or fully depleted battery. When you are ready to use the machine again, charge the battery pack until the left indicator light turns green on the charger or all 4 LED indicators turn green on the battery.
- Disconnect the machine from the power supply (i.e., remove the battery pack) and check for damage after use.
- Clean all foreign material from the machine.
- Do not store the machine or charger with the battery pack installed.
- When not in use, store the machine, battery pack, and battery charger out of the reach of children.
- Keep the machine, battery pack, and battery charger away from corrosive agents such as garden chemicals and de-icing salts.
- To reduce the risk of serious personal injury, do not store the battery pack outside or in vehicles.
- Store the machine, battery pack, and battery charger in an enclosed clean, dry area.
- When the machine is folded for storage, do not hang it from the electrical wire harness.

Troubleshooting

- Perform only the steps described in these instructions. All further inspection, maintenance, and repair work must be performed by an authorized service center or a similarly qualified specialist if you cannot solve the problem yourself.
- Always remove the battery from the tool when troubleshooting, inspecting, maintaining, or cleaning the tool.

Problem	Possible Cause	Corrective Action
The tool does not run or does not run continuously.	1. The battery is not fully installed in the tool.	1. Remove and then replace the battery into the tool, making sure that it is fully installed and latched.
	2. The battery pack is not charged.	2. Remove the battery pack from the tool and charge it.
	3. The battery pack is over or under the appropriate temperature range.	3. Move the battery pack to a place where it is dry and the temperature is between 5°C (41°F) and 40°C (104°F).
	4. There is moisture on the leads of the battery pack.	4. Allow the battery pack to dry or wipe it dry.
	5. The battery pack is damaged.	5. Replace the battery pack.
	6. There is another electrical problem with the tool.	6. Contact an Authorized Service Dealer.
The tool does not reach full power or the motor housing is getting hot.	1. The battery pack charge capacity is too low.	1. Remove the battery pack from the tool and fully charge the battery pack.
	2. The air vents are blocked.	2. Clean the air vents.

Problem	Possible Cause	Corrective Action
The tool is producing excessive vibration or noise.	1. There is debris under the grass shield or in the bump head housing on the trimmer.	1. Clean any debris from under the grass shield or in the bumphead housing.
	2. The spool is not properly wound.	2. Advance the line using the bump head and/or remove the line on the spool and wind the spool again.
The bump head does not advance the line.	1. The trimmer is out of line.	1. Add more lines to the bumphead.
	2. The line is tangled in the bump head housing.	2. Remove the bump head cover and untangle the line.

	3. There is debris under the grass shield or in the bump head housing on the trimmer.	3. Clean any debris from under the grass shield or in the bumphead housing.
The battery pack loses charge quickly.	1. The battery pack is over or under the appropriate temperature range.	1. Move the battery pack to a place where it is dry and the temperature is between 5°C (41°F) and 40°C (104°F).
	2. The trimmer is overloaded.	2. Trim at a slower pace.
The battery charger is not working.	1. The battery charger is over or under the appropriate temperature range.	1. Unplug the battery charger and move it to a place where it is dry and the temperature is between 5°C (41°F) and 40°C (104°F).
	2. The outlet that the battery charger is plugged into does not have power.	2. Contact your licensed electrician to repair the outlet.
The LED indicator light on the battery charger is red.	1. The battery charger and/or battery pack are over or under the appropriate temperature range.	1. Unplug the battery charger and move the battery charger and battery pack to a place where it is dry and the temperature is between 5°C (41°F) and 40°C (104°F).

Problem	Possible Cause	Corrective Action
The LED indicator light on the battery charger is blinking red.	1. There is an error in the communication between the battery pack and the charger.	<p>1. Remove the battery pack from the battery charger, unplug the battery charger from the outlet, and wait 10 seconds. Plug the battery charger into the outlet again and place the battery pack on the battery charger. If the LED indicator light on the battery charger is still blinking red, repeat this procedure.</p> <p>If the LED indicator light on the battery charger is still blinking red after 2 attempts, properly dispose of the battery pack at a battery recycling facility.</p>
	2. The battery pack is weak.	2. Properly dispose of the battery pack at a battery recycling facility.

Warning Information

California Proposition 65 Warning Information

What is this warning?

- You may see a product for sale that has a warning label like the following.
- WARNING:** Cancer and Reproductive [Harm—www.p65Warnings.ca.gov](http://www.p65Warnings.ca.gov).

What is Prop 65?

- Prop 65 applies to any company operating in California, selling products in California, or manufacturing products that may be sold in or brought into California. It mandates that the Governor of California maintain and publish a list of chemicals known to cause cancer, birth defects, and/or other reproductive harm. The list, which is updated annually, includes hundreds of chemicals found in many everyday items. The purpose of Prop 65 is to inform the public about exposure to these chemicals.
- Prop 65 does not ban the sale of products containing these chemicals but instead requires warnings on any product, product packaging, or literature with the product. Moreover, a Prop 65 warning does not mean that a product violates any product safety standards or requirements. The California government has clarified that a Prop 65 warning “is not the same as a regulatory decision that a product is ‘safe’ or ‘unsafe.’”
- Many of these chemicals have been used in everyday products for years without documented harm.
- For more information, go to <https://oag.ca.gov/prop65/faqs-view-all>.
- A Prop 65 warning means that a company has either (1) evaluated the exposure and has concluded that it exceeds the “no significant risk level”; or (2) has chosen to provide a warning based on its understanding of the presence of a listed chemical without attempting to evaluate the exposure.

Does this law apply everywhere?

- Prop 65 warnings are required under California law only. These warnings are seen throughout California in a wide range of settings, including but not limited to restaurants, grocery stores, hotels, schools, and hospitals, and on a wide variety of products.
- Additionally, some online and mail-order retailers provide Prop 65 warnings on their websites or in catalogs.

How do the California warnings compare to federal limits?

- Prop 65 standards are often more stringent than federal and international standards.
- Various substances require a Prop 65 warning at levels that are far lower than federal action limits.
- For example, the Prop 65 standard for warnings for lead is 0.5 µg/day, which is well below the federal and international standards.

Why don't all similar products carry the warning?

- Products sold in California require Prop 65 labeling while similar products sold elsewhere do not.
- A company involved in a Prop 65 lawsuit settlement may be required to use Prop 65 warnings for its products, but other companies making similar products may have no such requirement.
- The enforcement of Prop 65 is inconsistent.
- Companies may elect not to provide warnings because they conclude that they are not required to do so under Prop 65; a lack of warnings for a product does not mean that the product is free of listed chemicals at similar levels.

Why does Toro include this warning?

- Toro has chosen to provide consumers with as much information as possible so that they can make informed decisions about the products they buy and use. Toro provides warnings in certain cases based on its knowledge of the presence of one or more listed chemicals without evaluating the level of exposure, as not all the listed chemicals provide exposure limit requirements. While the exposure from Toro products may be negligible or well within the “no significant risk” range, out of an abundance of caution,
- Toro has elected to provide the Prop 65 warnings. Moreover, if Toro does not provide these warnings, it could be sued by the State of California or by private parties seeking to enforce Prop 65 and subject to substantial penalties. Rev
- **Register at www.Toro.com. Original Instructions**
- For assistance, please see www.Toro.com/support for instructional resources or contact your Authorized Service Dealer before returning this product.

Documents / Resources

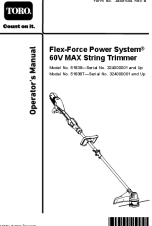
	<p>TORO 51838 Flex Force Power System 60V MAX String Trimmer [pdf] Instruction Manual 51838, 51838T, 51838 Flex Force Power System 60V MAX String Trimmer, 51838, Flex Force Power System 60V MAX String Trimmer, Force Power System 60V MAX String Trimmer, System 60V MAX String Trimmer, MAX String Trimmer, String Trimmer</p>
---	---

References

- [!\[\]\(849840539e55921a3851a4ff96d7400d_img.jpg\) p65Warnings.ca.gov](https://p65Warnings.ca.gov)
- [User Manual](#)

[Manuals+](#), [Privacy Policy](#)

This website is an independent publication and is neither affiliated with nor endorsed by any of the trademark owners. The "Bluetooth®" word mark and logos are registered trademarks owned by Bluetooth SIG, Inc. The "Wi-Fi®" word mark and logos are registered trademarks owned by the Wi-Fi Alliance. Any use of these marks on this website does not imply any affiliation with or endorsement.