



652918 Level Sensor



TORK 652918 Level Sensor Instructions

[Home](#) » [TORK](#) » TORK 652918 Level Sensor Instructions 

Contents

- [1 TORK 652918 Level Sensor](#)
- [2 Description](#)
- [3 CONTENTS](#)
- [4 Installation Instructions](#)
- [5 Replace Battery](#)
- [6 FCC STATEMENT](#)
- [7 CONTACT](#)
- [8 Documents / Resources](#)
 - [8.1 References](#)



TORK 652918 Level Sensor

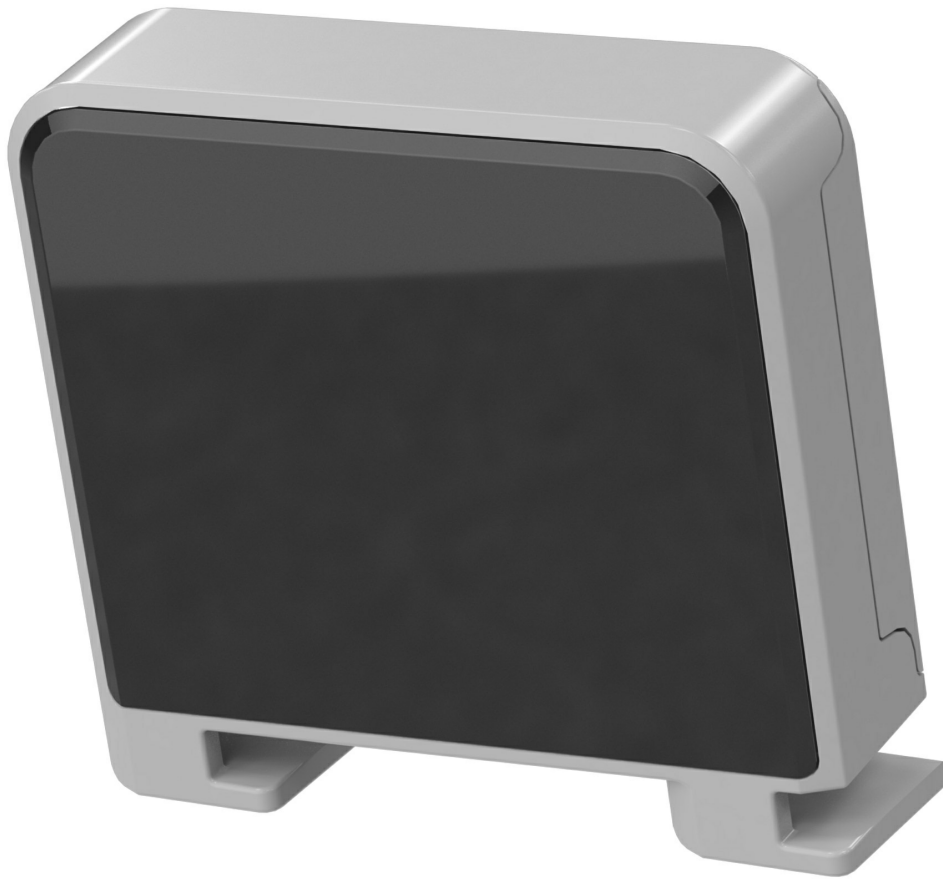

Description

The Tork Level Sensor is used within Tork-connected dispensers with the Tork Vision Cleaning application to display data that indicates when a dispenser needs refilling. The data can also be provided through the Tork Vision API. Retrofit of various Tork dispensers possible. This product requires a Tork gateway.

- Sleek design, wireless, with a long battery lifespan
- Reports when a dispenser needs refilling
- Provides consumption data

CONTENTS

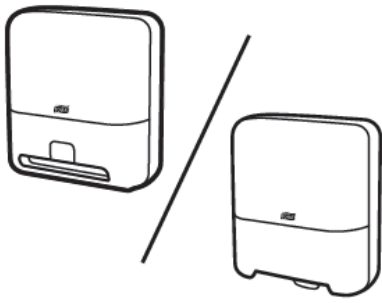

Tork Matic Elevation H1

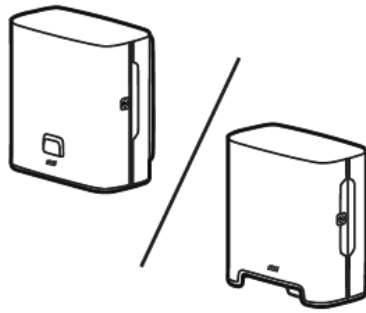

Tork Matic Image Design H1

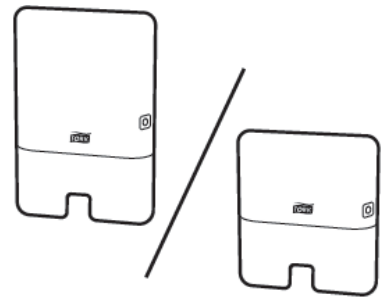

**Tork Xpress Elevation H2
and H2 Mini**



Tork Xpress Image Design H2

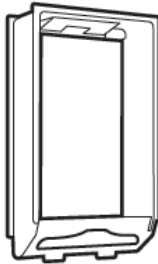

**Tork Med/Large Recessed
Cabinet H2**



Tork Elevation Mini Jumbo T2

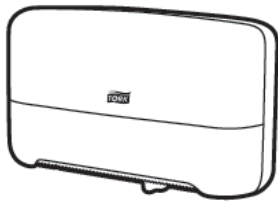

**Tork Elevation Twin
Mini Jumbo T2**



**Tork Image Design
Mini Jumbo T2**

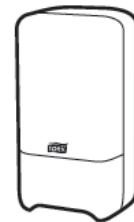

**Tork Elevation Twin
Mid-sized T6**

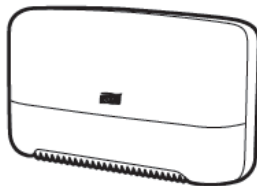

**Tork Elevation T7 OptiServe
2-roll horizontal**



**Tork Elevation T7 OptiServe
2-roll vertical**

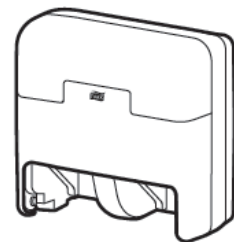

**Tork Elevation T7 OptiServe
4-roll**



Tork Elevation Bin B1

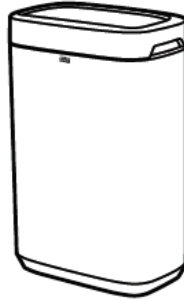

Tork Image Design Bin B1



Replace battery

Installation Instructions

Level Sensor – Tork Matic Elevation H1

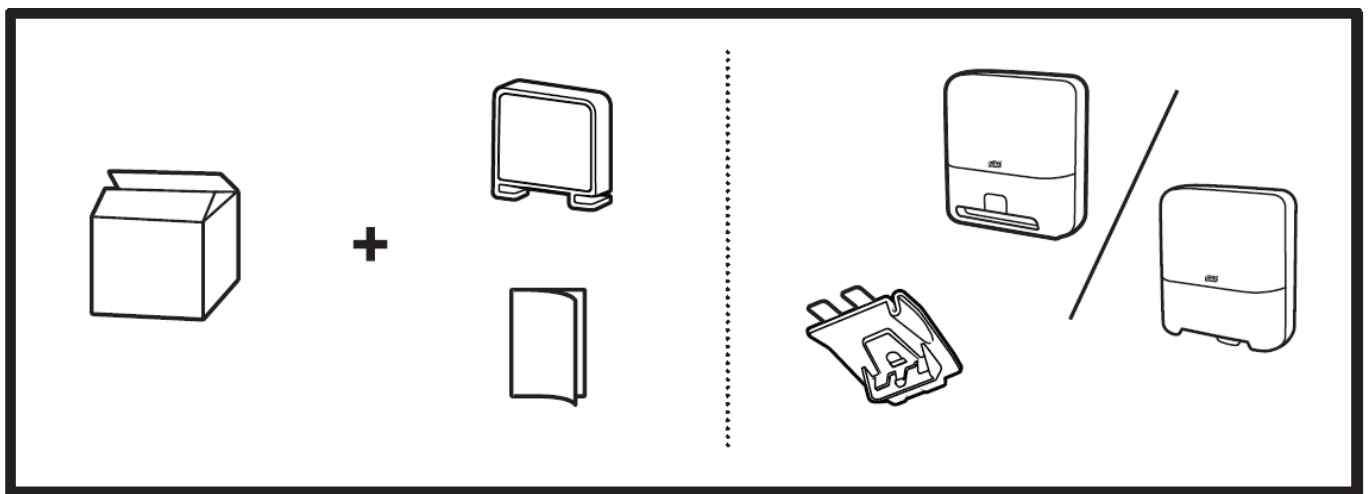

1

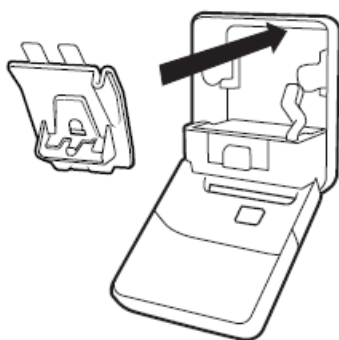

2

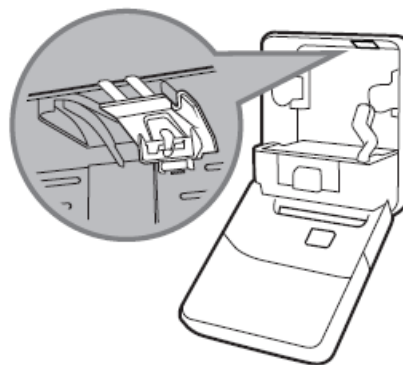

3



4

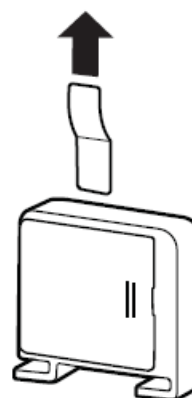

Level Sensor - Tork Matic Elevation H1

5

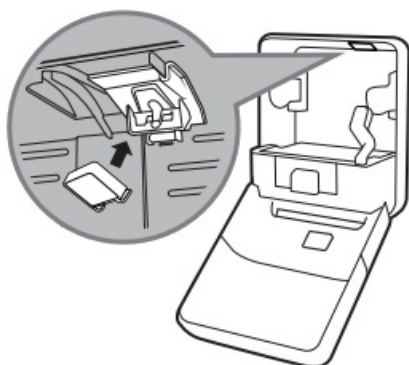

6

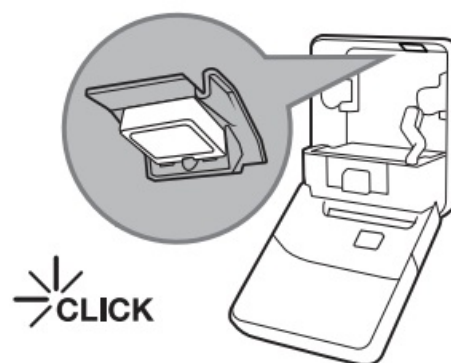

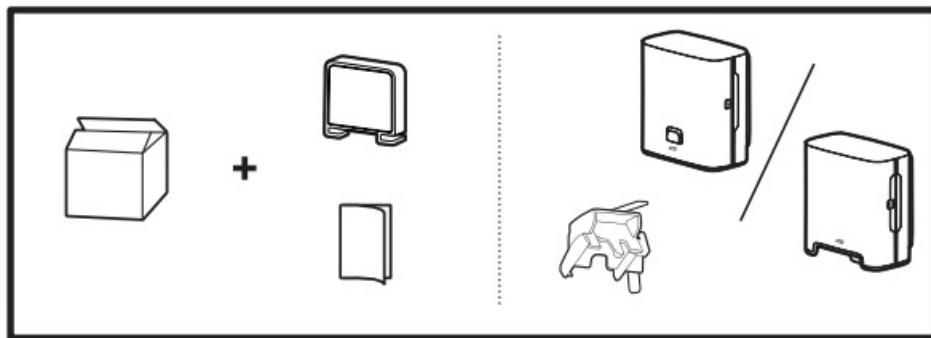

1

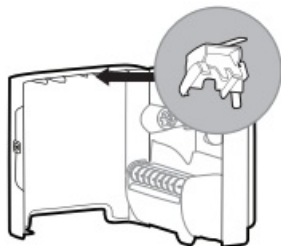

2

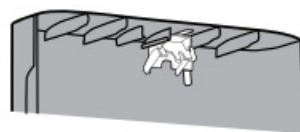

3



4

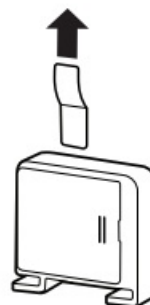

5



6

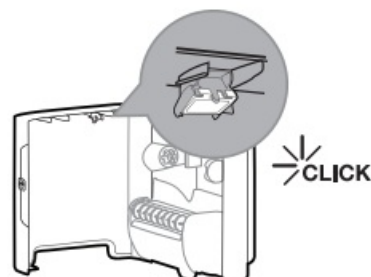

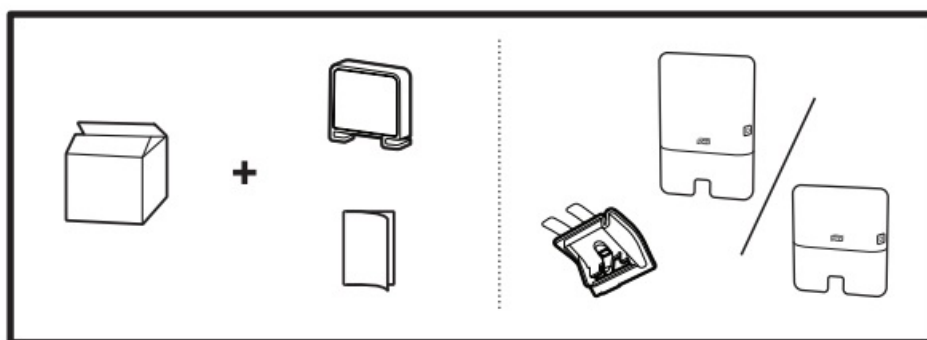

1

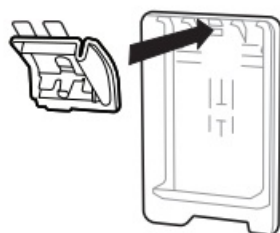

2

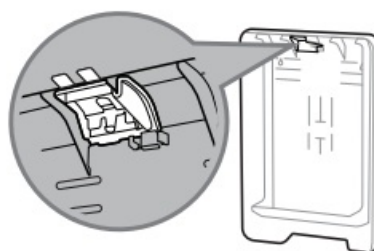

3

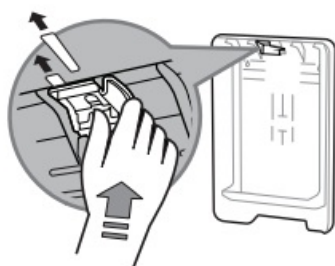

4



5

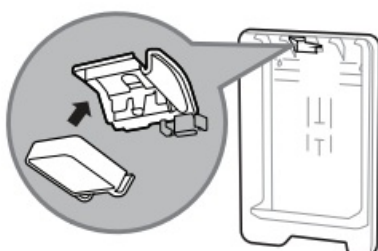

6

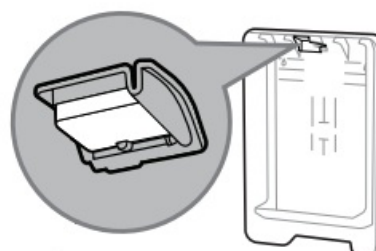

CLICK

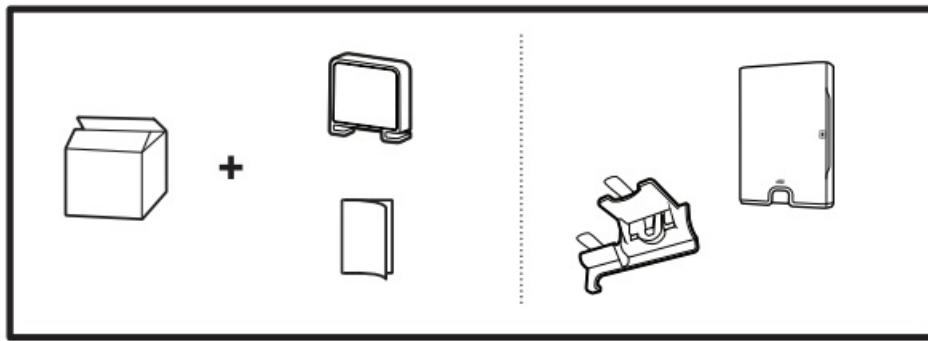

1

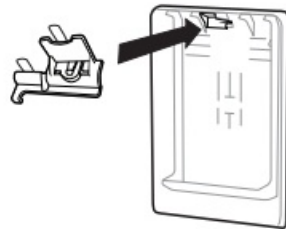

2

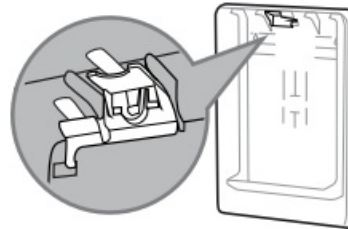

3



4



5

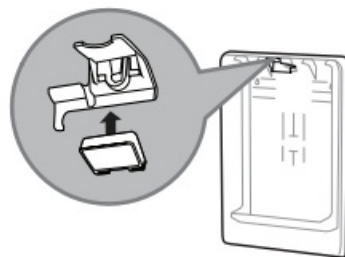

6

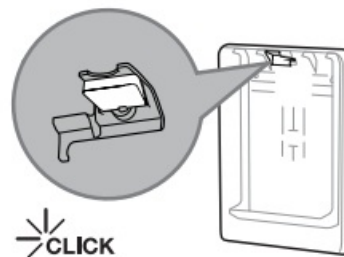

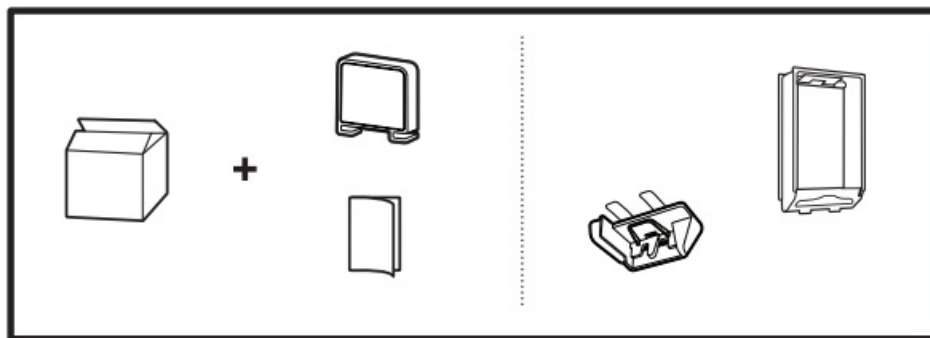

1

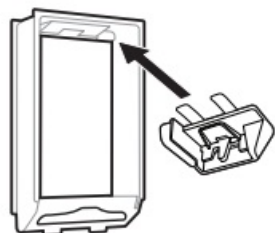

2

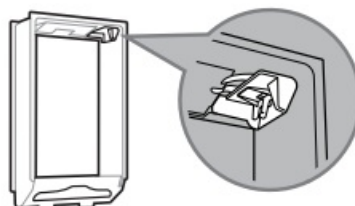

3

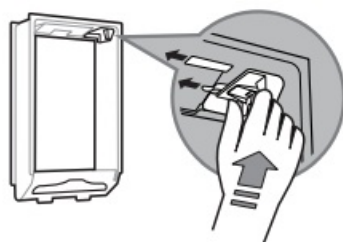

4



5

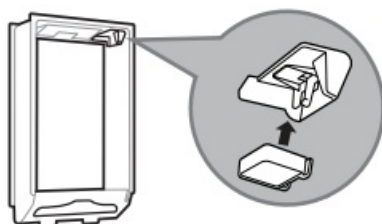

6

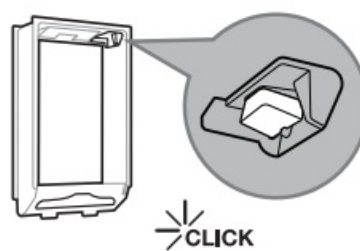

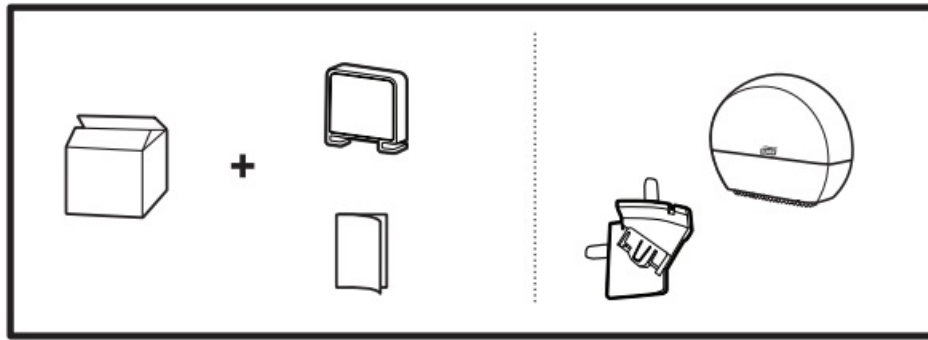

1



2

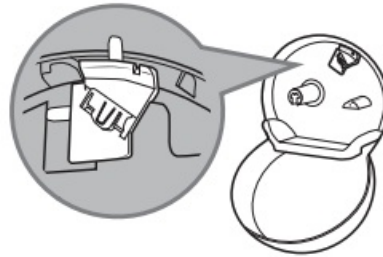

3

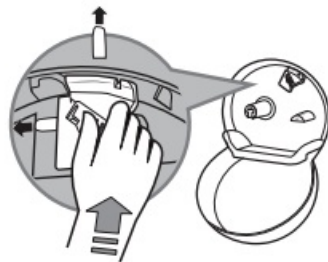

4



Level Sensor - Tork Elevation Mini Jumbo T2

5

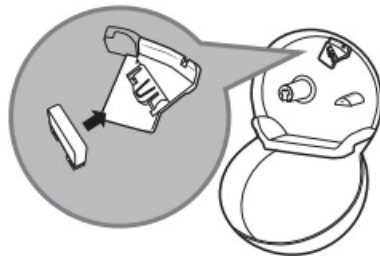

6

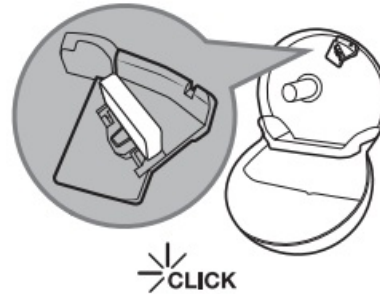

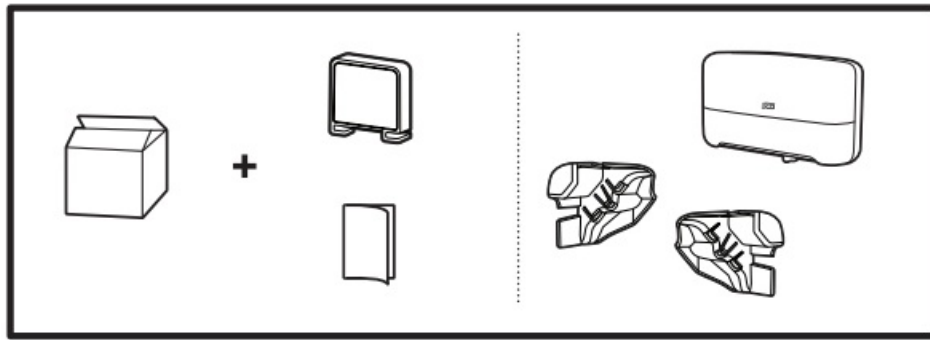

1

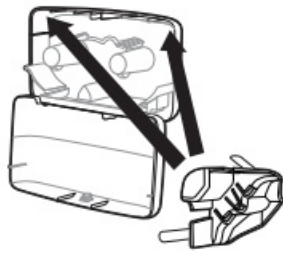

2

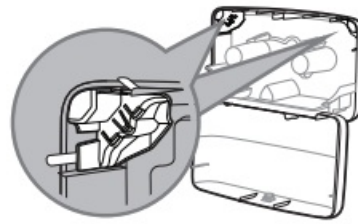

3

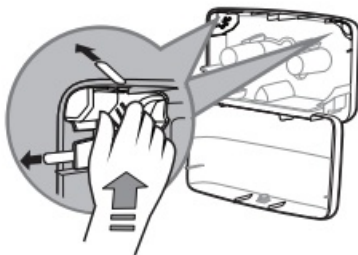

4

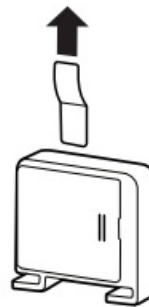

5

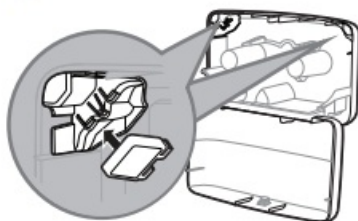

6

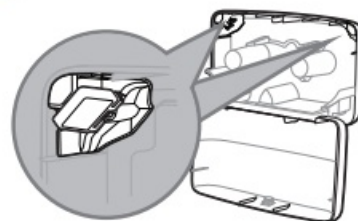

CLICK

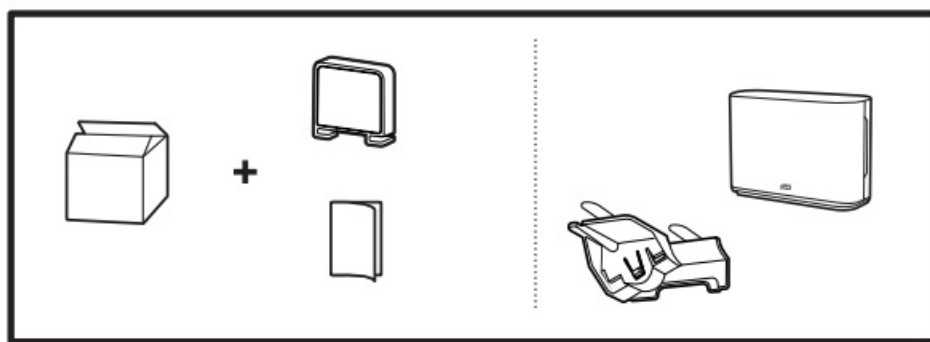

1

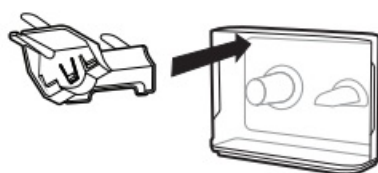

2

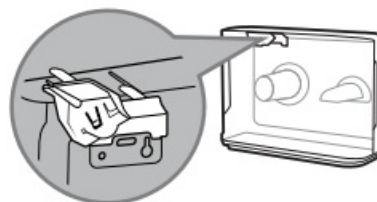

3

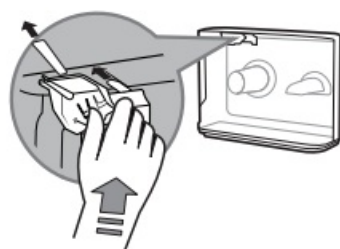

4



5

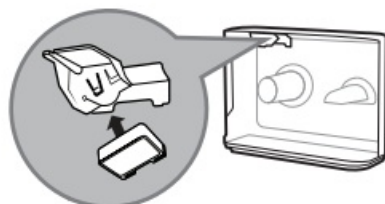

6

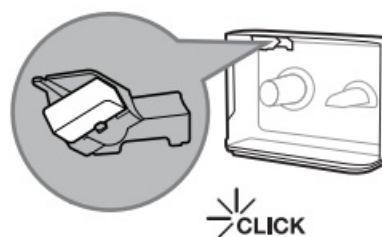

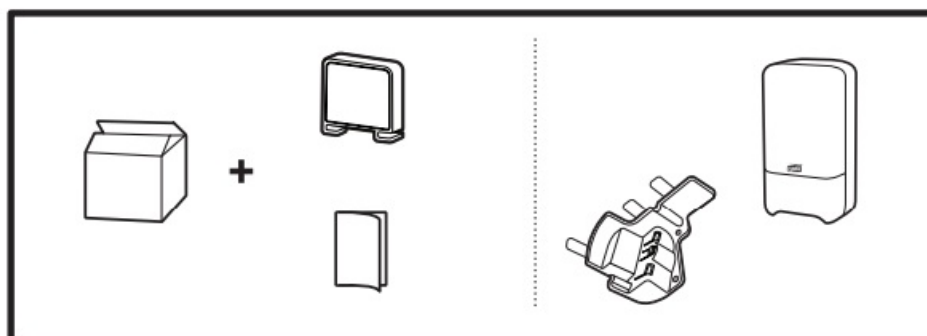

1

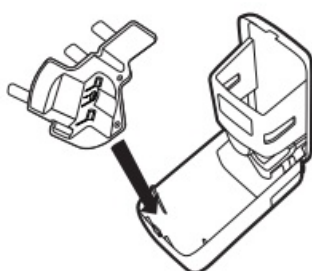

2

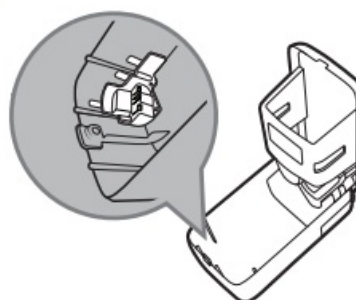

3

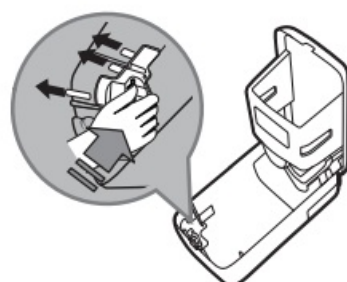

4



Level Sensor - Tork Elevation Twin Mid-sized T6

5

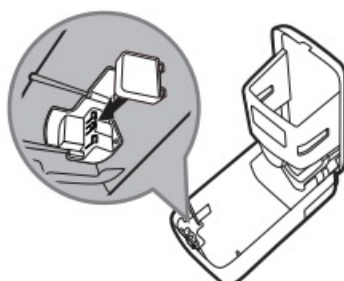

6

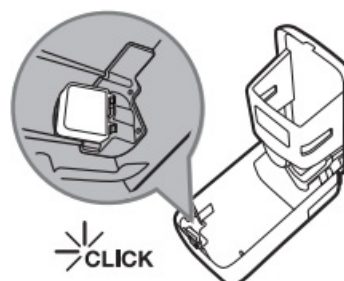

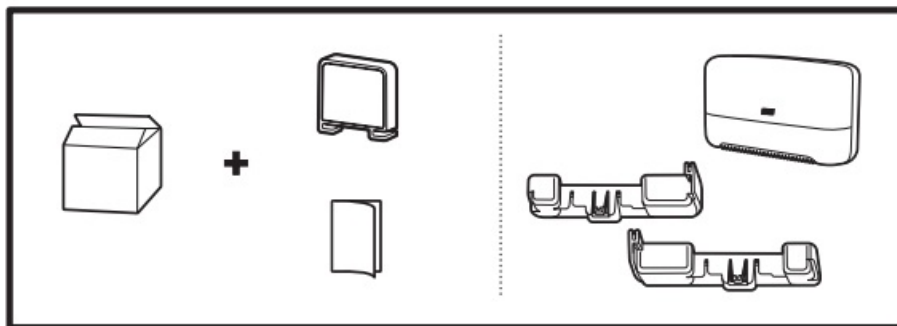

1

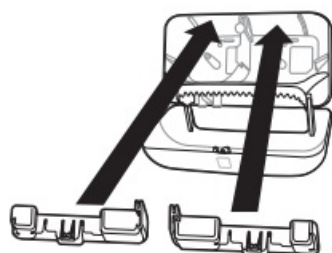

2

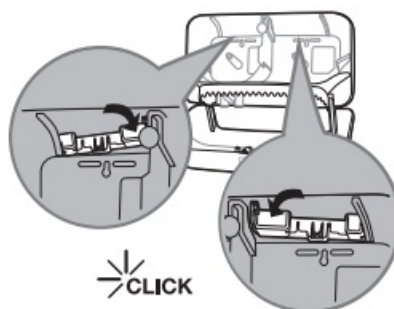

3



4

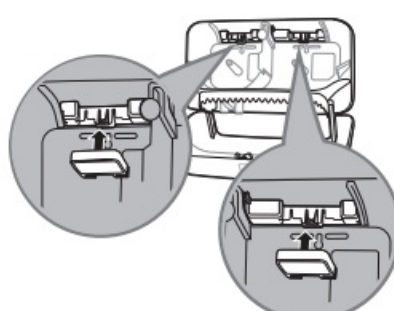

Level Sensor - Tork Elevation T7 OptiServe 2-roll horizontal

5

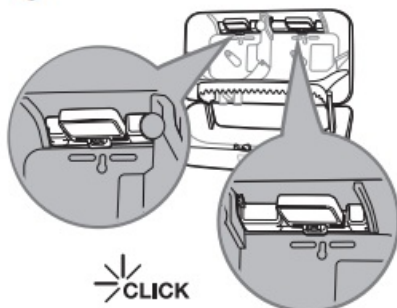

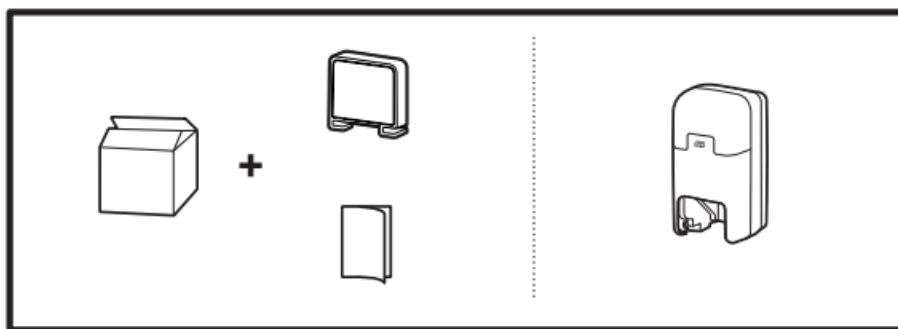

1



2

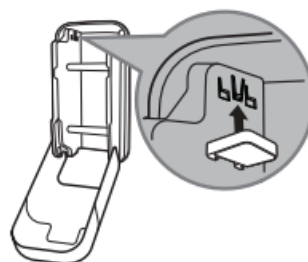

3

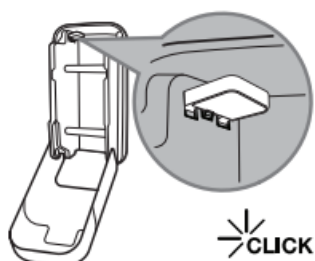

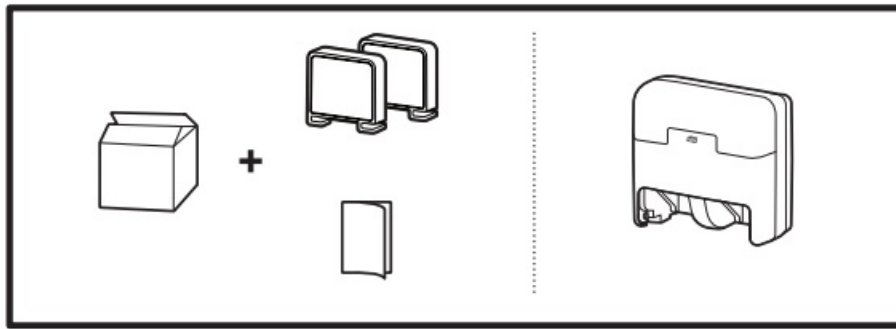

1



2

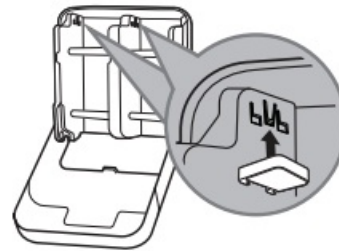

3

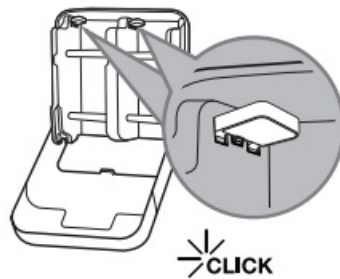

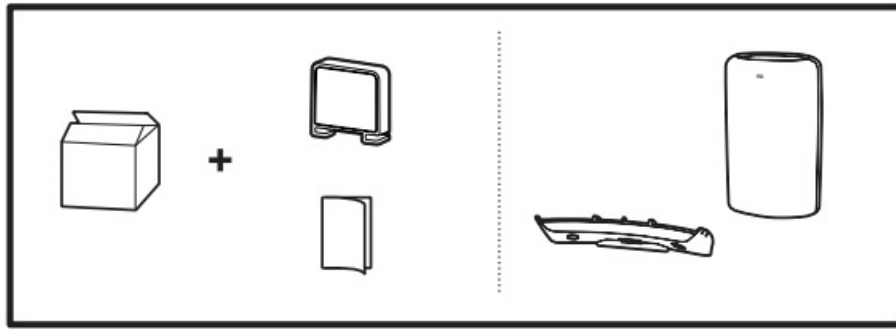

1



2



3



4

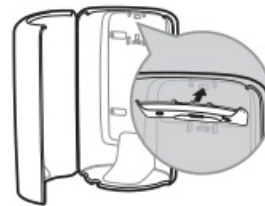

5

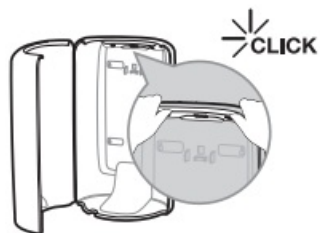

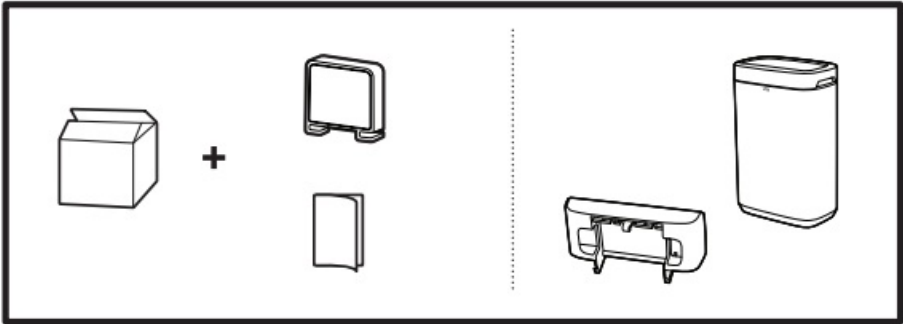

1

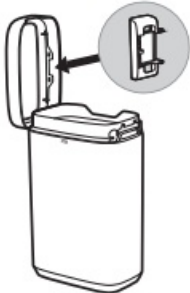

2

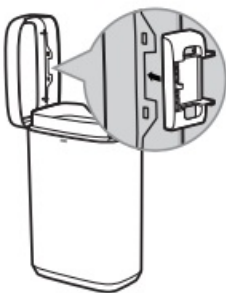

3

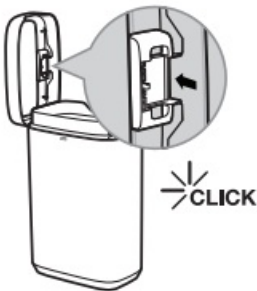

4



Level Sensor - Tork Image Design Bin B1

5

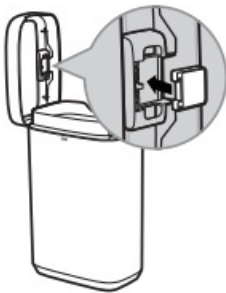

6

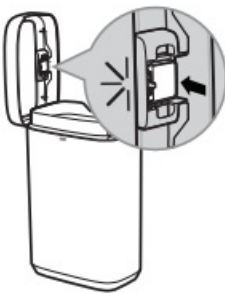

Replace Battery

Level Sensor – Replace Battery

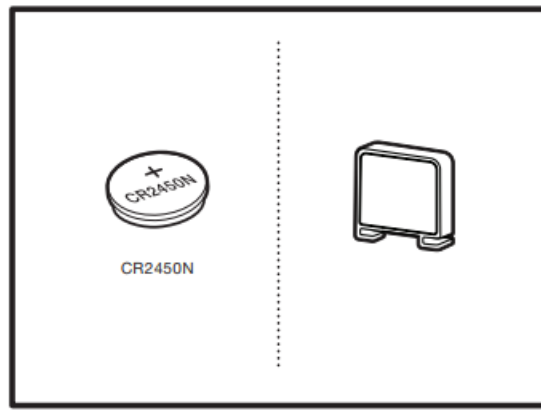

1

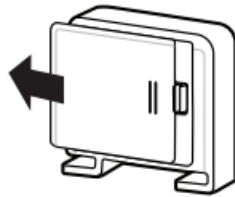

2

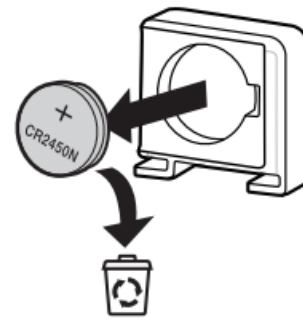

3

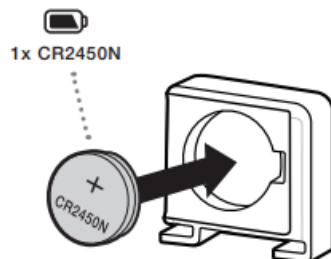

4

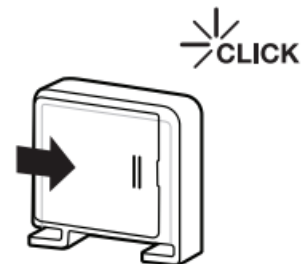

FCC STATEMENT

Changes or modifications to the equipment not expressly approved by the party responsible for compliance could void the user's authority to operate the equipment.

This device complies with Part 15 of the FCC Rules. Operation is subject to the following two conditions:

1. this device may not cause harmful interference, and
2. this device must accept any interference received, including interference that may cause undesired operation.

NOTE: This equipment has been tested and found to comply with the limits for a Class B digital device, under Part 15 of the FCC Rules.

These limits are designed to provide reasonable protection against harmful interference in a residential installation. This equipment generates, uses, and can radiate radio frequency energy and, if not installed and used under the

instructions, may cause harmful interference to radio communications. However, there is no guarantee that interference will not occur in a particular installation. If this equipment does cause harmful interference to radio or television reception, the user is encouraged to contact Essity for support.

This equipment complies with FCC and ISED radiation exposure limits set forth for an uncontrolled environment. This equipment should be installed and operated with a minimum distance of 20 cm between the radiator and the human body.

FCC ID: 2ABK3-652918 (article number 652918)

IC

This device complies with Industry Canada's license-exempt RSSs. Operation is subject to the following two conditions:

1. This device may not cause interference; and
2. This device must accept any interference, including interference that may cause undesired operation of the device.

Industry Canada ICES-003 Compliance Label: CAN ICES-3 (A)/NMB-3 (A)

CONTACT

- Manufactured by Essity Hygiene and Health AB SE-405 03 Göteborg, Sweden
- Visiting address: Mölndals Bro 2, Mölnda

UK

- Essity UK Limited
- South Elds Road, Dunstable, Bedfordshire, LU6 3EJ, UK +44 1582 677400

North America

- Distributed by Essity HMS North America Inc 2929 Arch Street Suite 2600
- Philadelphia, PA 19104
- www.essity.com, www.torkglobal.com
- Made in Sweden

Documents / Resources

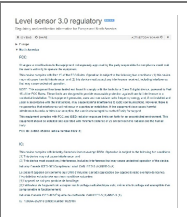
	<p>TORC 652918 Level Sensor [pdf] Instructions 2ABK3-652918, 2ABK3652918, 652918 Level Sensor, 652918, Level Sensor, Sensor</p>
---	--

References

- [User Manual](#)

Manuals+. Privacy Policy

This website is an independent publication and is neither affiliated with nor endorsed by any of the trademark owners. The "Bluetooth®" word mark and logos are registered trademarks owned by Bluetooth SIG, Inc. The "Wi-Fi®" word mark and logos are registered trademarks owned by the Wi-Fi Alliance. Any use of these marks on this website does not imply any affiliation with or endorsement.