



Contents [[hide](#)]

- [1 TopVision TP-B01 Wifi Camera](#)
- [2 Specifications](#)
- [3 Product Usage Instructions](#)
- [4 Installation](#)
- [5 Operation](#)
- [6 Connection Instructions](#)
- [7 Installation guide](#)
- [8 Voice broadcast instructions](#)
- [9 Camera reset](#)
- [10 Device connection](#)
- [11 Device sharing](#)
- [12 Rotation control](#)
- [13 PTZ and functions](#)
- [14 A1 function](#)
- [15 Warranty Card](#)
- [16 FAQs](#)
- [17 Documents / Resources](#)
 - [17.1 References](#)



TOPVISION[®]



Specifications

- **Model:** TP-B01
- **Antenna Type:** Supplied antenna
- **Compliance:** FCC's RF Exposure guidelines

Product Usage Instructions

FCC Caution

- Connect the equipment to an outlet on a circuit that is different from the one to which the receiver is connected.
- Consult the dealer or an experienced radio/TV technician for help.
- To maintain compliance with the FCC's RF Exposure guidelines, this equipment should be installed and operated with a minimum distance between the radiator and your body.
- Use only the supplied antenna.

Installation

1. Locate a power outlet on a circuit different from the one the receiver is connected to.

2. Connect the equipment to the power outlet.
3. Ensure the supplied antenna is properly attached for optimal performance.

Operation

1. Turn on the equipment using the power button.
2. Adjust settings as needed for your desired operation.
3. Avoid placing the equipment too close to your body to comply with FCC guidelines.

Please read the Manual carefully before using the product and keep it properly.

Connection Instructions

Connect the power interface and the power socket with the power cord.

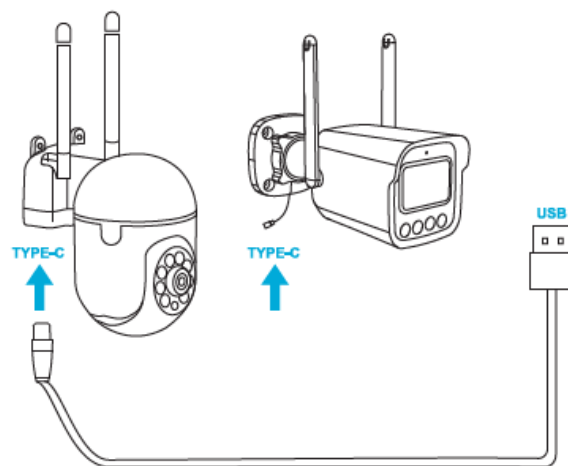

Installation guide

Choose a location

Please install the camera in a location where the field of view is not blocked, and make sure that the location of the camera has a good wifi signal.

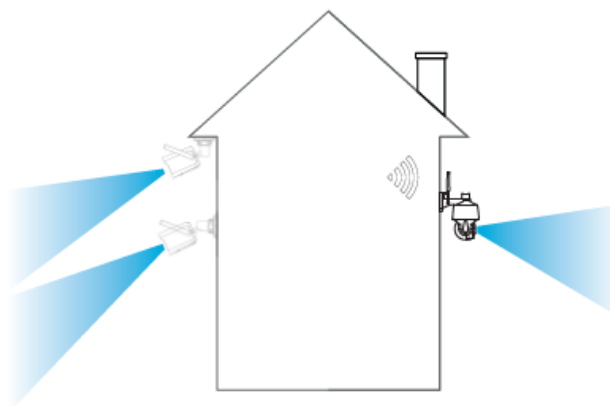

Voice broadcast instructions

Device status	Voice broadcast
Normal start	Network connection is successful, please open the APP to add a device
Normal reset	The reset is complete, the device is about to restart
Abnormal reset	Reset failed, please reset after connecting to the Internet or delete the device on the APP
QR code network configuration	Identify broadcast ding~
Alarm broadcast	Alarm sound

Camera reset

When the camera is powered on, press and hold the reset button for 3-5 seconds until you hear a voice prompt and a prompt sound of “reset is complete, the device will be restarted soon”; that is, the reset is successful.

Device connection

Download the APP

Scan the QR code below to download and install the APP.



Register and log in to the APP

1. Please register for an APP account and log in.
2. If you have already registered, please log in directly.

Connection method—Bluetooth

1. Find the device Bluetooth, and click iConnect.” Find the device
2. Click “+Add, i the Bluetooth page, and click jump to figure 2. Connect. “

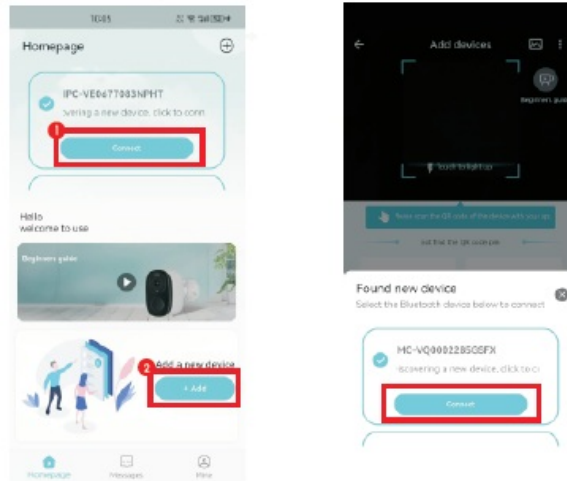

3. Select WiFi, enter the correct password, and click “Next.”
4. Waiting for connection,

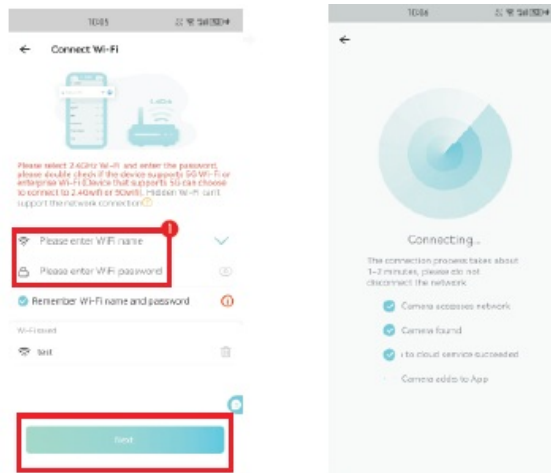

Connection method—Scan the QR code

1. Is Click “+” to add device,
2. Scan the QR code on the camera label.

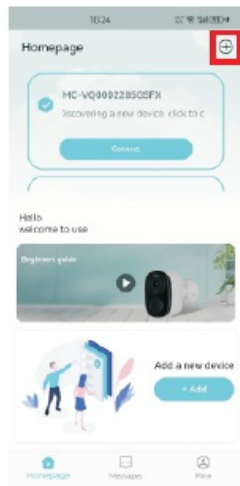

3. Upon hearing a sound or seeing the indicator light flashing, check and click “Next.”
4. Select WiFi, enter the correct password, and click “Next.”

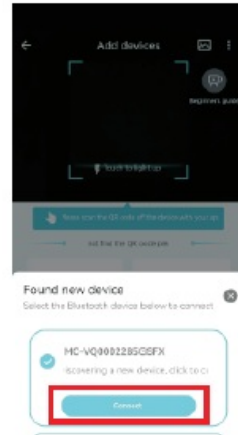

5. Align the QR code with the camera.
6. Click on the input box, customize the device name, and click “Get started.”

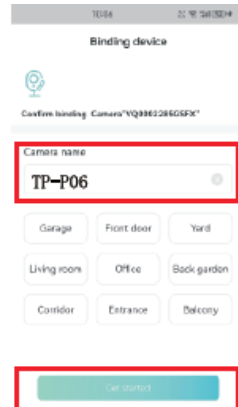

Device sharing

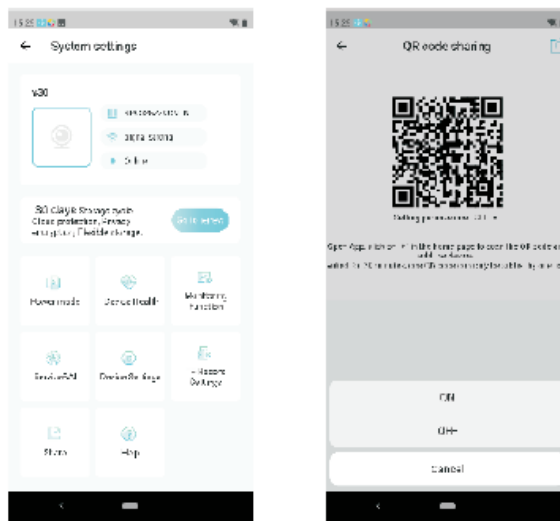

With open permission of Device sharing, the person being shared can set the function of the device. If the permission is turned off, you can only watch the video, and cannot set the function.

Rotation control

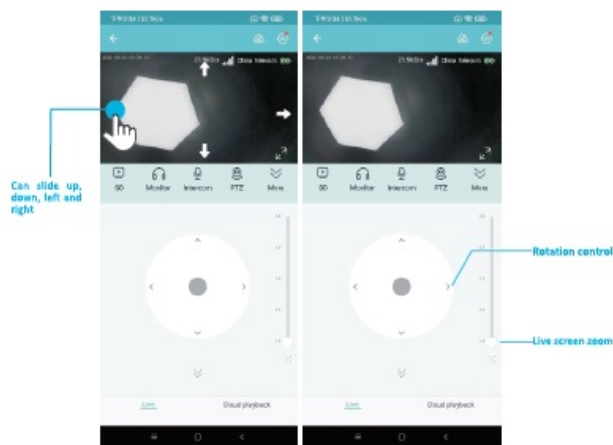

PTZ and functions

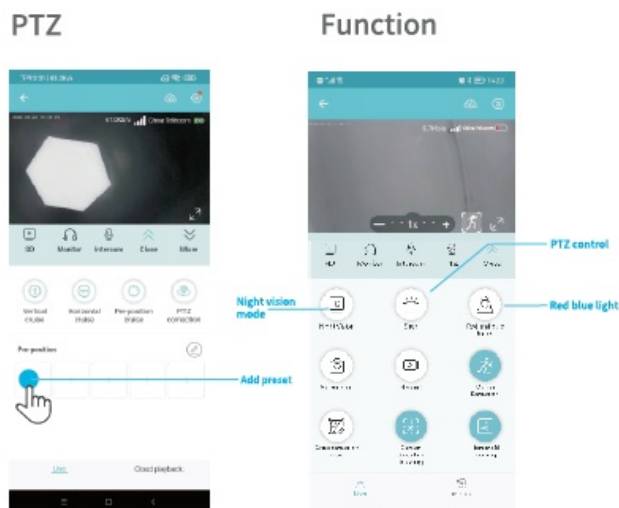

A1 function

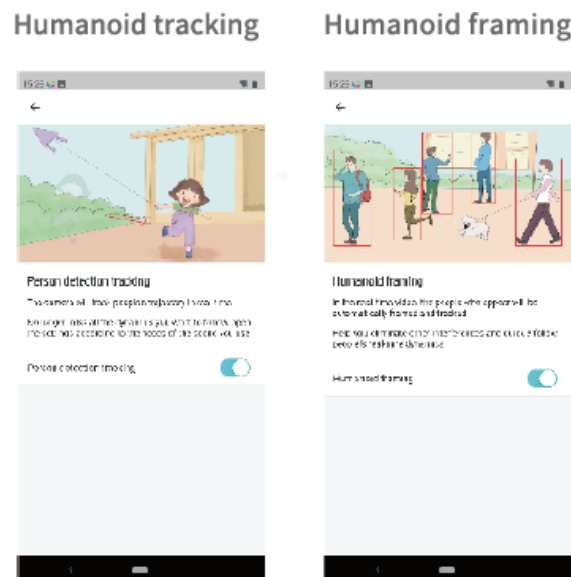

Warranty Card

User name: _____

Address: _____

Telephone: _____

Fax: _____

Post code: _____

E-mail: _____

Product model (Model): _____

Product Number (S/N): _____

Production Date: _____

Purchase Date: _____

If you have other requirements, please fill in below:

Dealer: _____ Telephone: _____

Distribution unit: (seal)

QUALIFIED CERTIFICATE

QC: PASS

FCC Caution:

This device complies. With part 15 of the FCC Rules.

The operation is subject to the following two conditions:

1. This device may not cause harmful interference
2. This device must accept any interference received, including interference that may cause undesired operation. Any changes or modifications not expressly approved by the party responsible for compliance could void the users' authority to operate the

equipment.

NOTE: This equipment has been tested and found to comply with the limits for a Class B digital device, pursuant to Part 15 of the FCC Rules. These limits are designed to provide reasonable protection against harmful interference in a residential installation. This equipment generates, uses, and can radiate radio frequency energy and, if not installed and used according to the instructions, may cause harmful interference to radio communications. However, there is no guarantee that interference will not occur in a particular installation.

If this equipment does cause harmful interference to radio or television reception, which can be determined by turning the equipment off and on, the user is encouraged to try to correct the interference by one or more of the following measures :

- Reorient or relocate the receiving antenna.
- Increase the separation between the equipment and receiver.
- Connect the equipment to an outlet or circuit different from the one on which the cord is connected.
- Consult the dealer or an experienced radio/TV technician for help.

To maintain compliance with the FCC's RF Exposure guidelines, this equipment should be installed and operated with a minimum distance of 20cm between the radiator and your body.

Use only the supplied antenna.

FAQs

Will the camera display a red light after turning on the night vision function?

The built-in IR LED lights, when the night vision is turned on, the camera only displays some faint red lights, but the picture quality is still clear in the dark environment.

How far should the camera be from the router?

After testing, the Wi-Fi connection distance can normally reach 150 meters in an open area. But the actual situation depends on the strength of the Wi-Fi and its surroundings (thick walls, electromagnetic devices, and large metal objects can all cause interference to the Wi-Fi signal). If the camera connection is weak or unstable, place the camera as close to the router as possible.

What should I do if the equipment fails?

Long press the power button to restart the camera, If there is no response, you can open the USB silicone cover at the bottom of the camera, long press the reset button to reset, and then long press the power button to restart the camera.

Documents / Resources

	TopVision TP-B01 Wifi Camera [pdf] User Manual 2BK5B-TP-B01, 2BK5BTPB01, TP-B01 Wifi Camera, TP-B01, Wifi Camera, Camera
---	---

References

- [User Manual](#)

2BK5B-TP-B01, 2BK5BTPB01, camera, Topvision, TP-B01, TP-B01 Wifi Camera, WiFi
TOPVISION Camera

Leave a comment

Your email address will not be published. Required fields are marked *

Comment *

Name

Email

Website

☐ Save my name, email, and website in this browser for the next time I comment.

Post Comment

Search:

e.g. whirlpool wrf535swhz

Search

[Manuals+](#) | [Upload](#) | [Deep Search](#) | [Privacy Policy](#) | [@manuals.plus](#) | [YouTube](#)

This website is an independent publication and is neither affiliated with nor endorsed by any of the trademark owners. The "Bluetooth®" word mark and logos are registered trademarks owned by Bluetooth SIG, Inc. The "Wi-Fi®" word mark and logos are registered trademarks owned by the Wi-Fi Alliance. Any use of these marks on this website does not imply any affiliation with or endorsement.